

STATE OF NORTH CAROLINA DIVISION OF HIGHWAYS

PROJ. REFERENCE NO.	SHEET NO.
B-5116	X-0

Approximate quantities only. Unclassified excavation, borrow excavation, fine grading, clearing and grubbing, and removal of existing asphalt pavement will be paid for at the lump sum price for "Grading".

NOTE: EMBANKMENT COLUMN DOES NOT INCLUDE BACKFILL FOR UNDERCUT

CROSS-SECTION SUMMARY

Station	Uncl. Exc.	Embt																	
L	(cu. yd.)	(cu. yd.)																	
12+30.00	0	0																	
12+50.00	1	1																	
13+00.00	3	8																	
13+50.00	7	20																	
14+00.00	10	76																	
14+50.00	9	137																	
15+00.51	10	165																	
Station	Uncl. Exc.	Embt																	
L	(cu. yd.)	(cu. yd.)																	
16+93.49	0	0																	
17+50.00	38	103																	
18+00.00	27	37																	
18+50.00	8	7																	

Note: Earthwork quantities are calculated by the Roadway Design Unit. These earthwork quantities are based in part on subsurface data provided by the Geotechnical Engineering Unit.

8/23/99



PROJ. REFERENCE NO.
B-5116

SHEET NO.
X-1

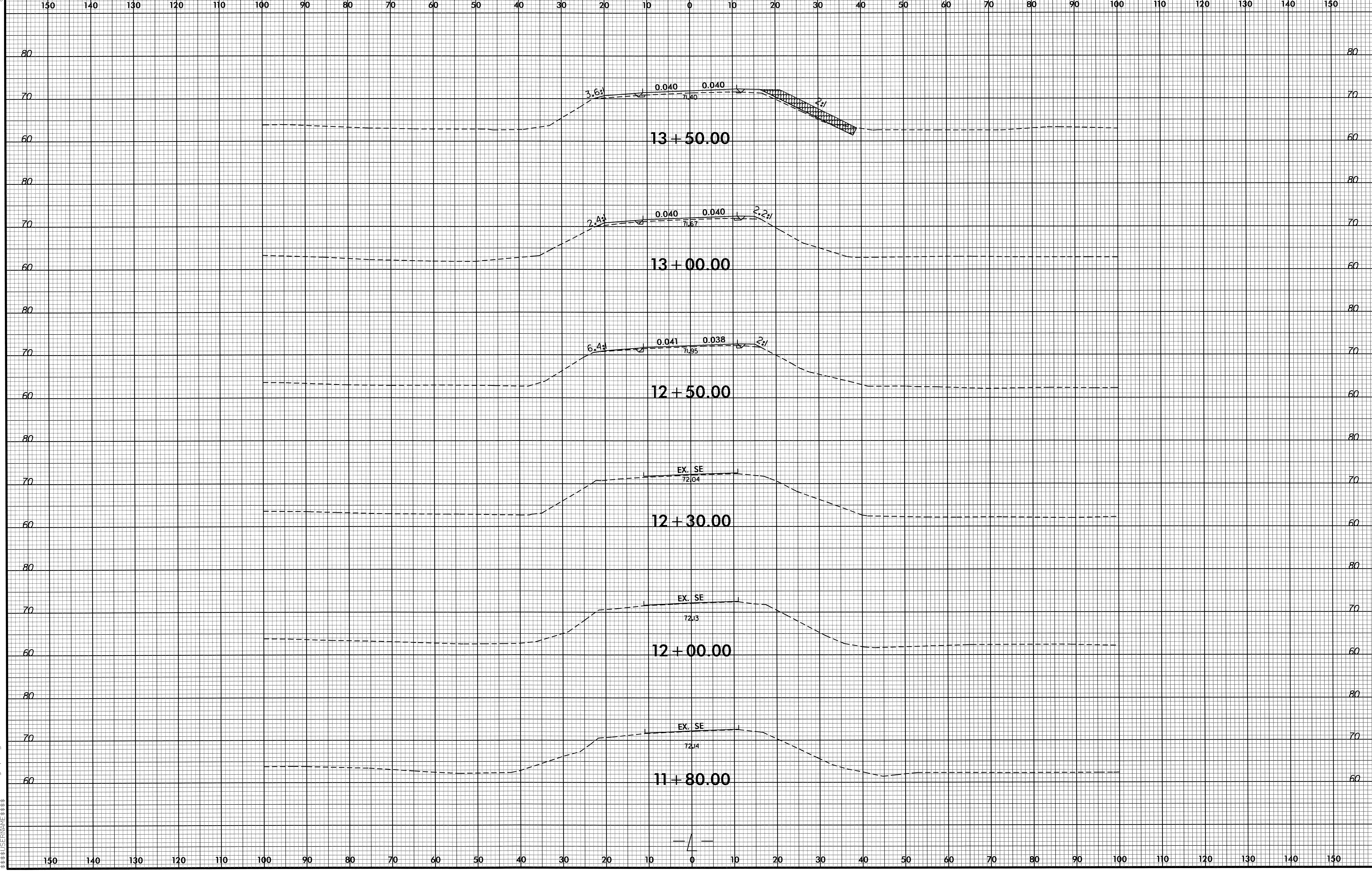

12-SEP-2011 14:00
RA:\CONSTR\X\116\B5116_Rdy_xp1.dgn
333/SERVEN/E 433

10

1

8/23/99

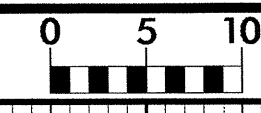

PROJ. REFERENCE NO.	SHEET NO.
B-5116	X-2

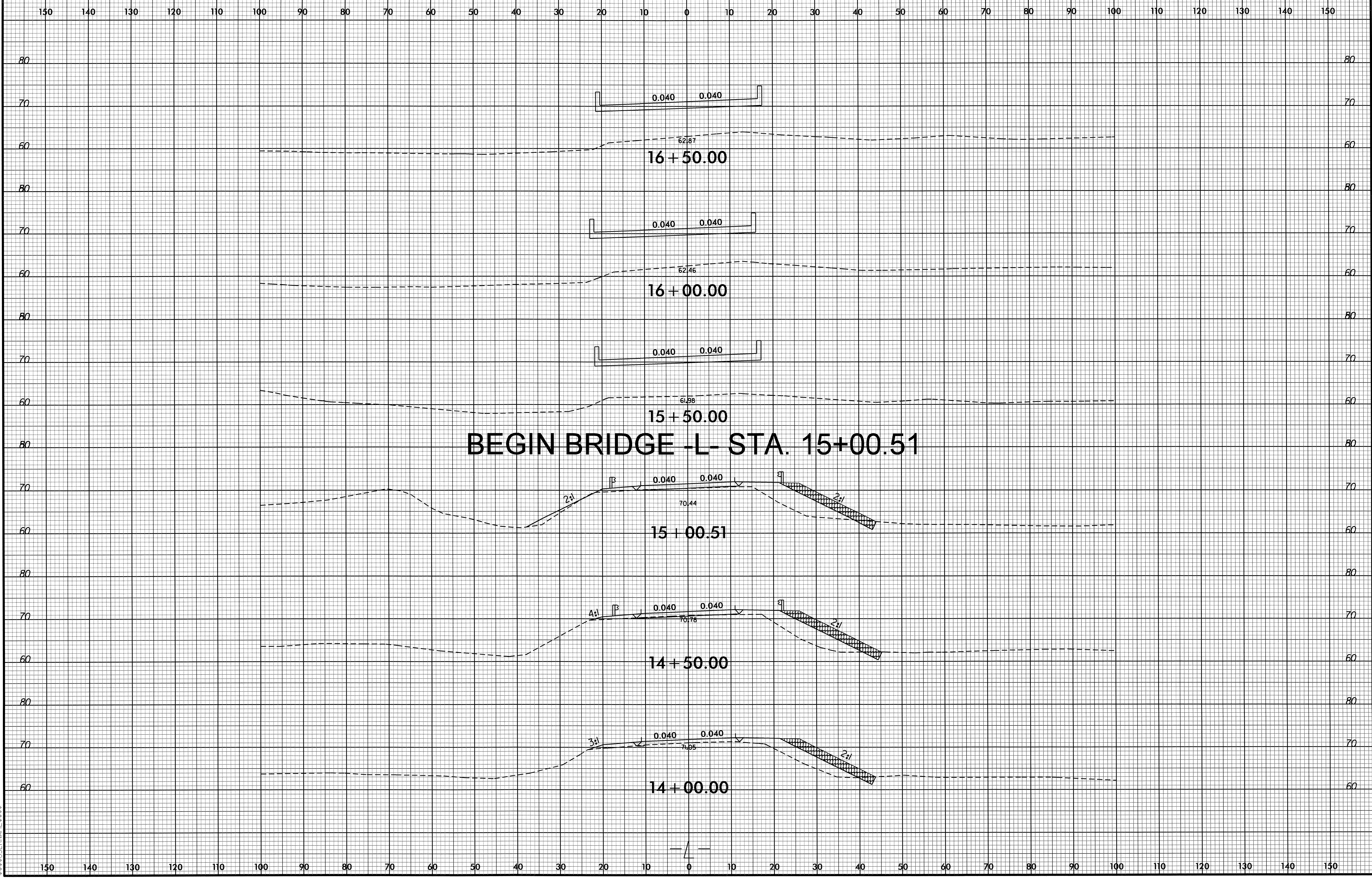

10

10

D:\SEP-2011\1400
R1\PROJECT\XVS\B5116_Rdy_xpl.dgn
\$\$\$\$\$USERNAME\$\$\$\$\$

150 140 130 120 110 100 90 80 70 60 50 40 30 20 10 0 10 20 30 40 50 60 70 80 90 100 110 120 130 140 150

8/23/99

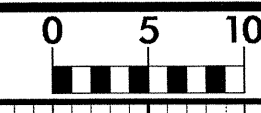

PROJ. REFERENCE NO.	SHEET NO.
B-5116	X-3

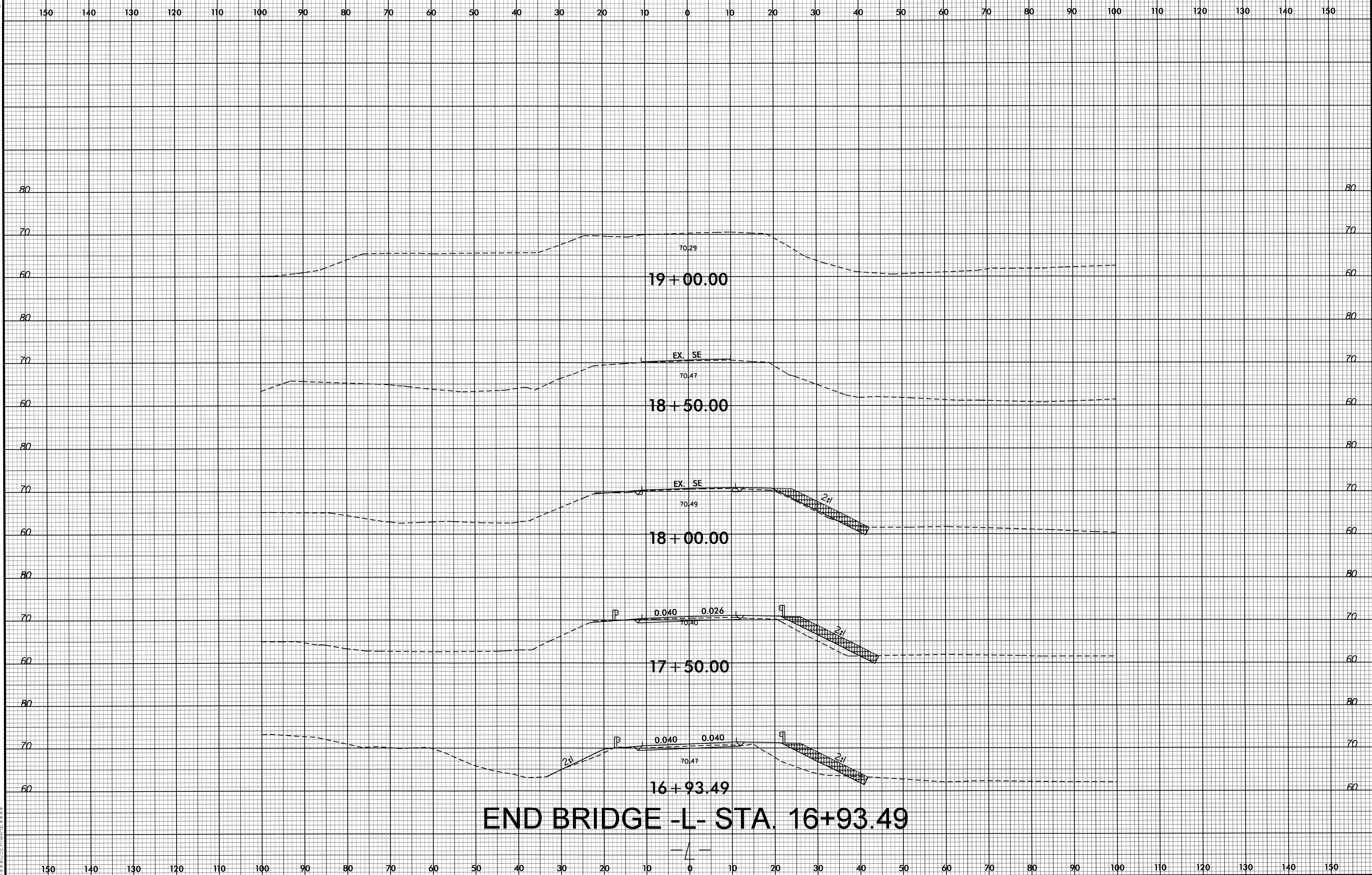

END BRIDGE -L- STA. 16+93.49

2:SEP-2011 14:00
 P:\6\PROJECTS\B5116_Rdy_xpl.dgn
 5:58:57 PM
 11/16/11