

**TIP PROJECT: B-4673**

STATE OF NORTH CAROLINA  
DIVISION OF HIGHWAYS  
  
PLAN FOR PROPOSED  
HIGHWAY EROSION CONTROL

**WAYNE COUNTY**

**LOCATION: BRIDGE NO. 120 OVER WALNUT CREEK ON SR 1728**

**TYPE OF WORK: GRADING, PAVING, DRAINAGE, AND STRUCTURE**

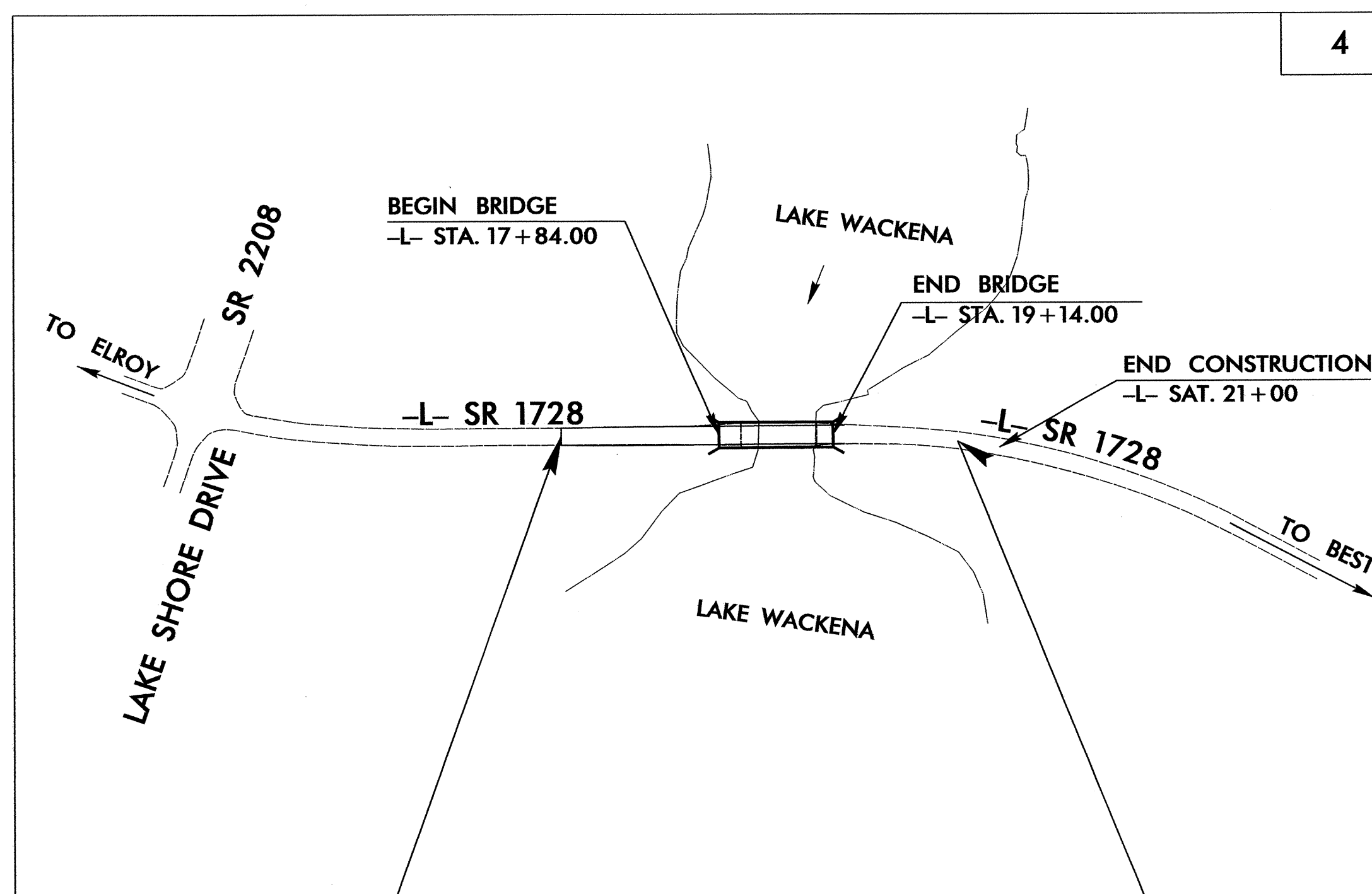
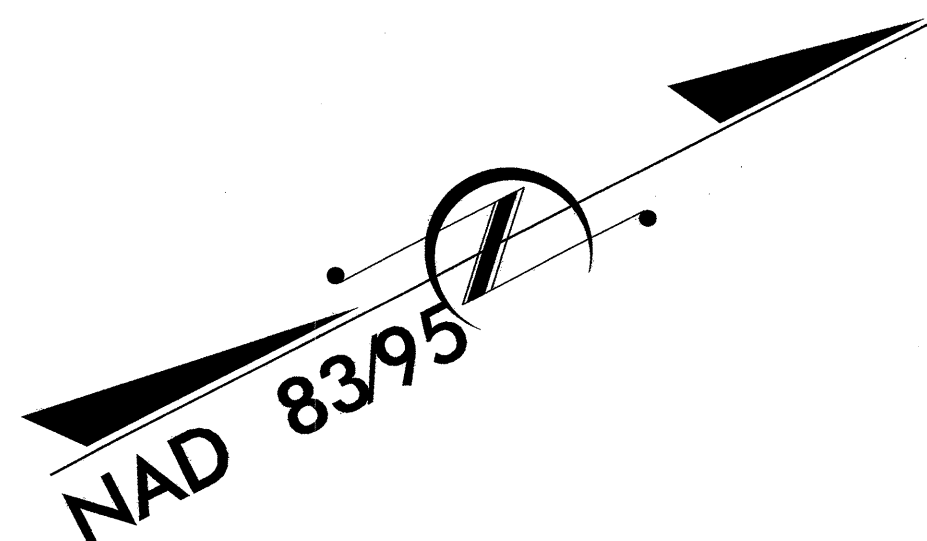

STA. 15+80.00 -L- BEGIN TIP PROJECT B-4673

STA. 20+50.00 -L- END TIP PROJECT B-4673

STATE	STATE PROJECT REFERENCE NO.	SHEET NO.	TOTAL SHEETS
N.C.	B-4673	EC-1	
STATE PROJ. NO.	F.A. PROJ. NO.	DESCRIPTION	

**EROSION AND SEDIMENT CONTROL MEASURES**

Std. #	Description	Symbol
1630.03	Temporary Silt Ditch	TD
1630.05	Temporary Diversion	TD
1605.01	Temporary Silt Fence	III III III
1606.01	Special Sediment Control Fence	III III III
1622.01	Temporary Berms and Slope Drains	III III III
1633.01	Silt Basin Type B	III III III
1633.01	Temporary Rock Silt Check Type-A	III III III
1633.01	Temporary Rock Silt Check Type-A with Matting and Polyacrylamide (PAM)	III III III
1633.01	Temporary Rock Silt Check Type-B	III III III
1633.01	Wattle/Coir Fiber Wattle	III III III
1633.01	Wattle/Coir Fiber Wattle with Polyacrylamide (PAM)	III III III
1634.01	Temporary Rock Sediment Dam Type-A	III III III
1634.02	Temporary Rock Sediment Dam Type-B	III III III
1635.01	Rock Pipe Inlet Sediment Trap Type-A	III III III
1635.02	Rock Pipe Inlet Sediment Trap Type-B	III III III
1630.04	Stilling Basin	III III III
1630.06	Special Stilling Basin	III III III
1632.01	Rock Inlet Sediment Trap: Type A	III III III
1632.02	Type B	III III III
1632.03	Type C	III III III
1630.04	Skimmer Basin	III III III
1630.04	Tiered Skimmer Basin	III III III
1630.04	Infiltration Basin	III III III

**THIS PROJECT CONTAINS EROSION CONTROL PLANS FOR CLEARING AND GRUBBING PHASE OF CONSTRUCTION.**

**THIS PROJECT HAS BEEN DESIGNED TO SENSITIVE WATERSHED STANDARDS.**

**ENVIRONMENTALLY SENSITIVE AREA(S) EXIST ON THIS PROJECT**

*Refer To E. C. Special Provisions for Special Considerations.*

**GRAPHIC SCALE**

0  
PLANS

0  
PROFILE (HORIZONTAL)

0  
PROFILE (VERTICAL)

ROADSIDE ENVIRONMENTAL UNIT  
DIVISION OF HIGHWAYS  
STATE OF NORTH CAROLINA

Prepared in the Office of:  
**ROADSIDE ENVIRONMENTAL UNIT**  
1 South Wilmington St.  
Raleigh, NC 27611  
**2006 STANDARD SPECIFICATIONS**

Roadway Standard Drawings

The following roadway english standards as appear in "Roadway Standard Drawings"- Roadway Design Unit - N. C. Department of Transportation - Raleigh, N. C., dated July 18, 2006 and the latest revision thereto are applicable to this project and by reference hereby are considered a part of these plans.

1605.01 Temporary Silt Fence	1632.03 Rock Inlet Sediment Trap Type C
1606.01 Special Sediment Control Fence	1633.01 Temporary Rock Silt Check Type A
1607.01 Gravel Construction Entrance	
1622.01 Temporary Berms and Slope Drains	

27-JUL-2011 15:4  
R:\env\proj\2011\154\11a\b-4673\_r-dj\_tah.dgn  
nchan AT PERN258446

PROJECT REFERENCE NO. B-4673	SHEET NO. EC-2
RW SHEET NO.	
ROADWAY DESIGN ENGINEER	HYDRAULICS ENGINEER

# TEMPORARY ROCK SILT CHECK TYPE 'A' WITH EXCELSIOR MATTING AND POLYACRYLAMIDE (PAM)

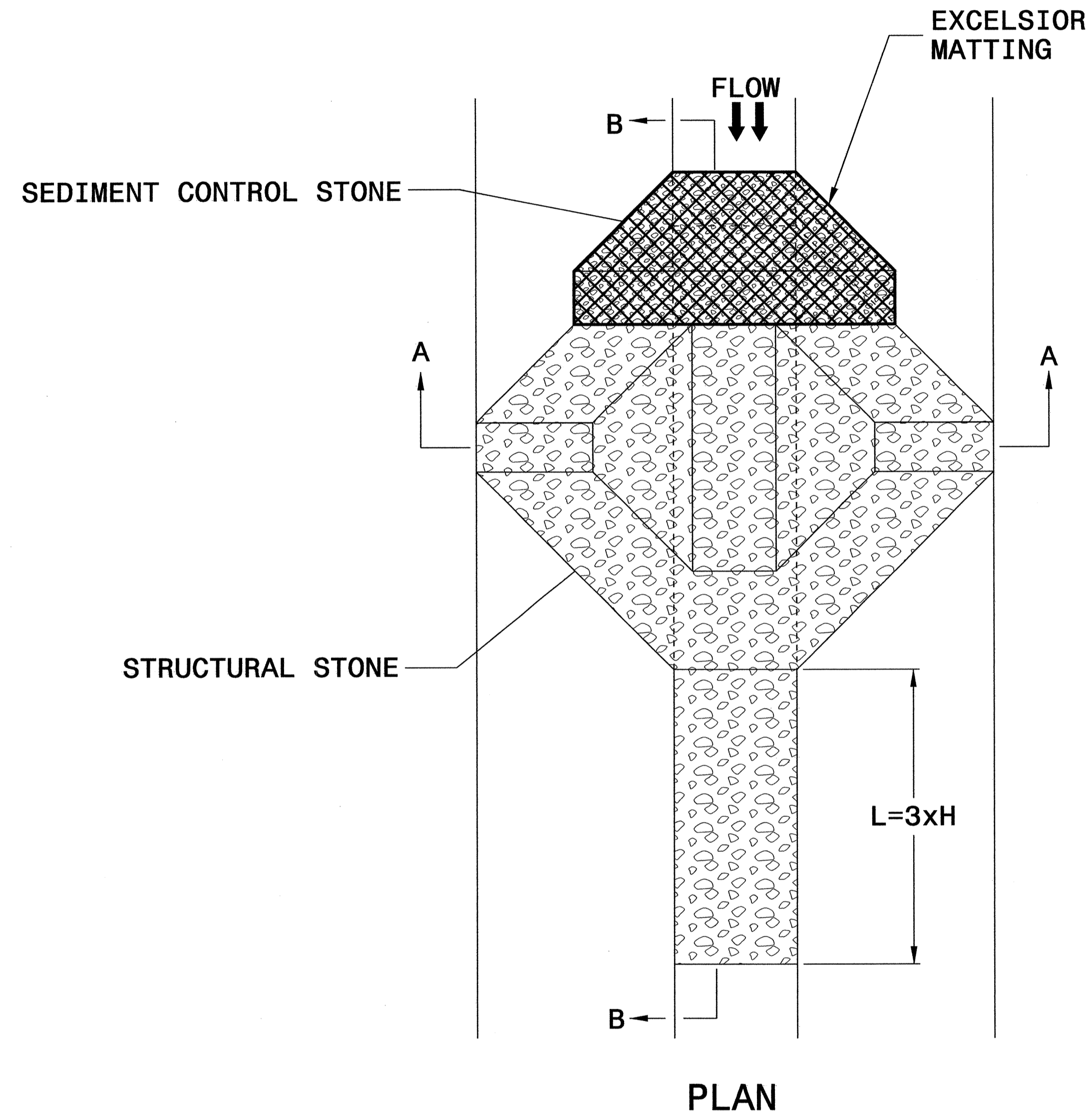

## NOTES

USE EXCELSIOR FOR MATTING MATERIAL AND ANCHOR MATTING SECTION AT TOP AND BOTTOM WITH CLASS B STONE.

PRIOR TO POLYACRYLAMIDE (PAM) APPLICATION, OBTAIN A SOIL SAMPLE FROM PROJECT LOCATION, AND FROM OFFSITE MATERIAL, AND ANALYZE FOR APPROPRIATE PAM FLOCCULANT TO BE APPLIED TO EACH ROCK SILT CHECK.

INITIALLY APPLY 3.5 OUNCES OF POLYACRYLAMIDE (PAM) TO TOP OF MATTING SECTION AND AFTER EVERY RAINFALL EVENT THAT EQUALS OR EXCEEDS 0.50 INCHES.

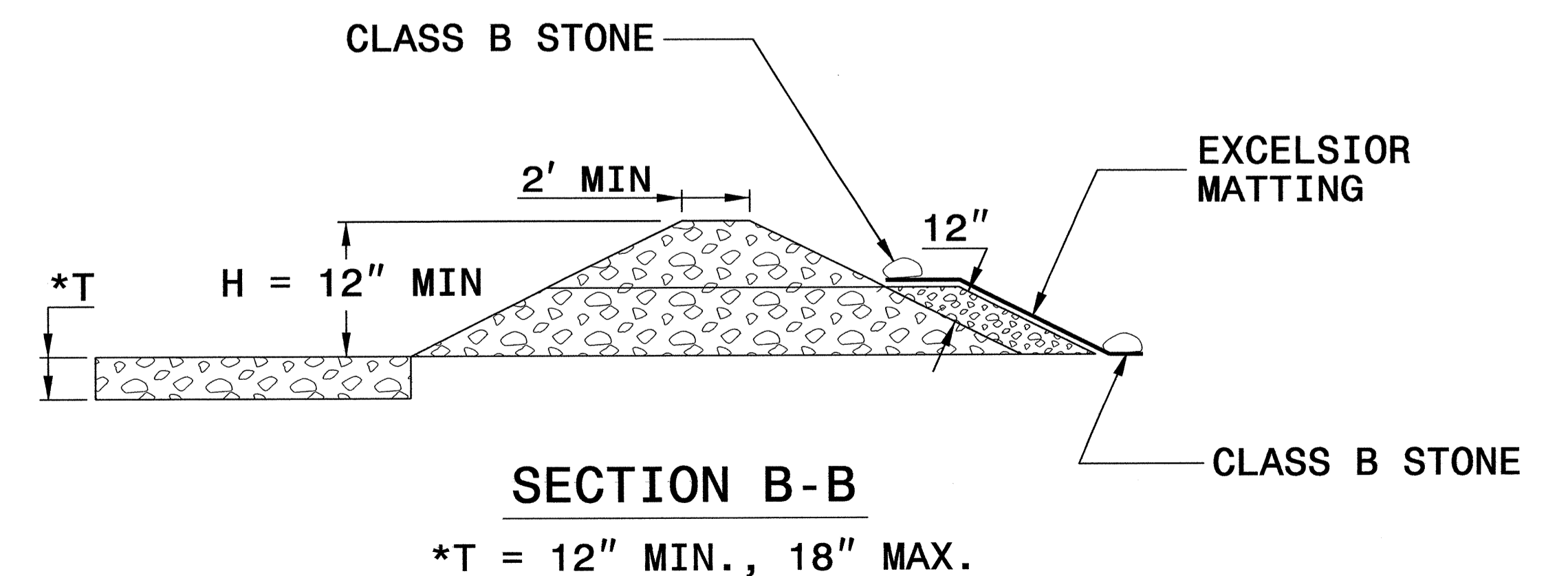
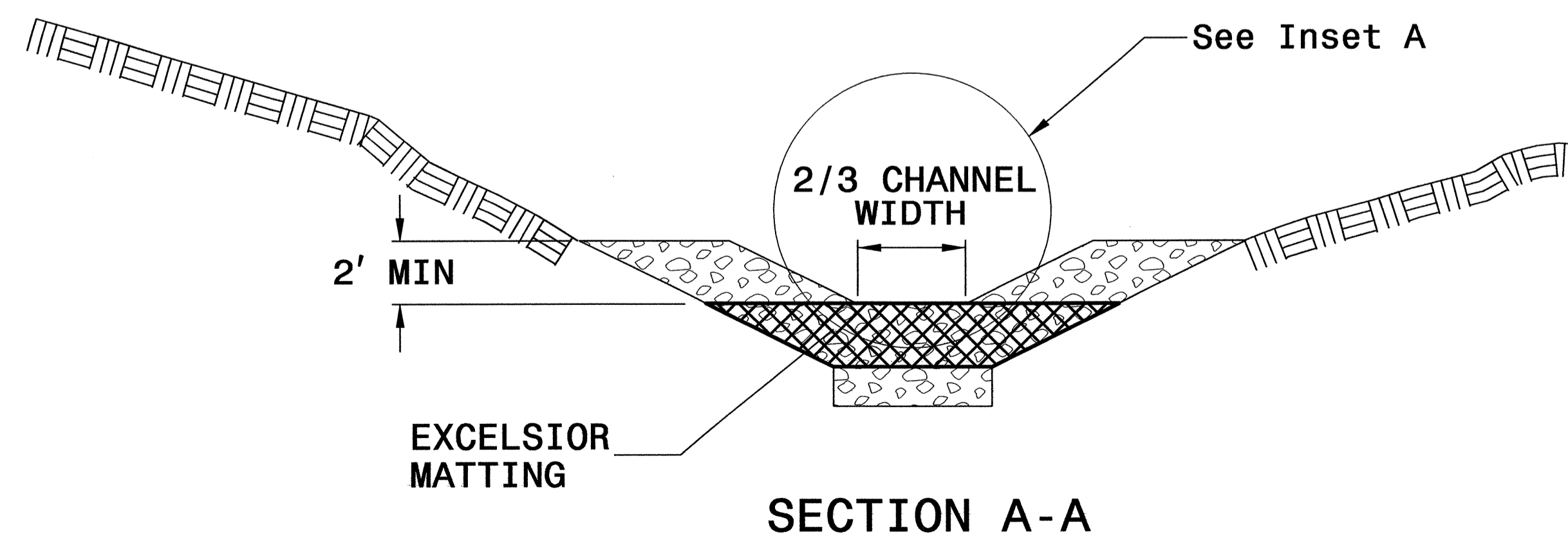
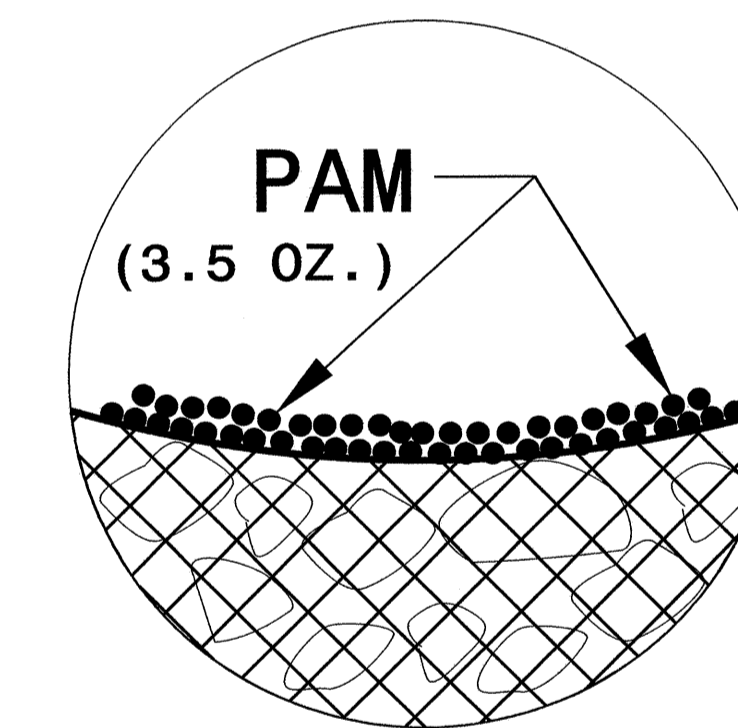

NOT TO SCALE

PROJECT REFERENCE NO. B-4673	SHEET NO. EC-2A
RW SHEET NO.	
ROADWAY DESIGN ENGINEER	HYDRAULICS ENGINEER

# MATTING INSTALLATION DETAIL

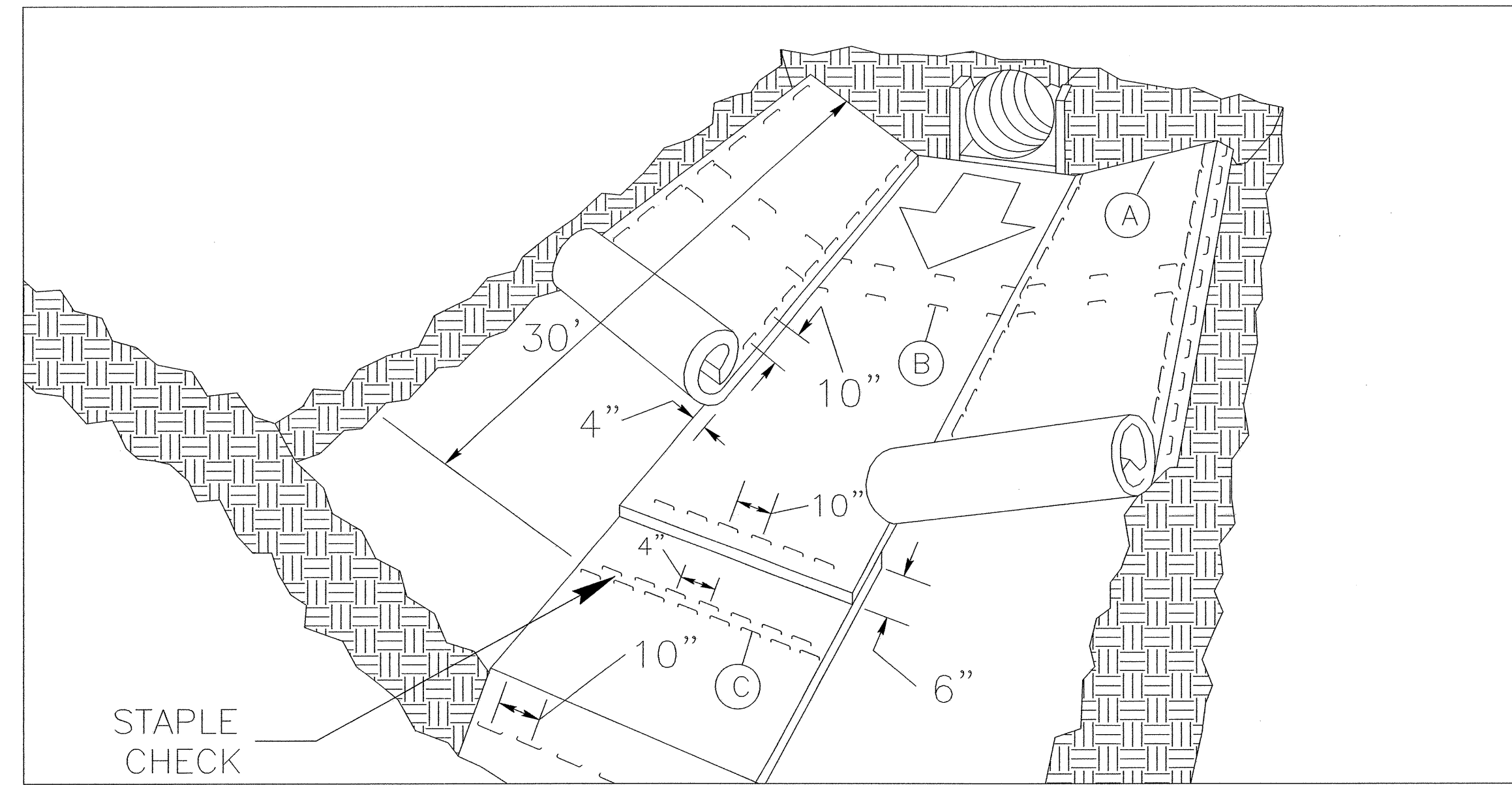

**MATTING IN DITCHES**

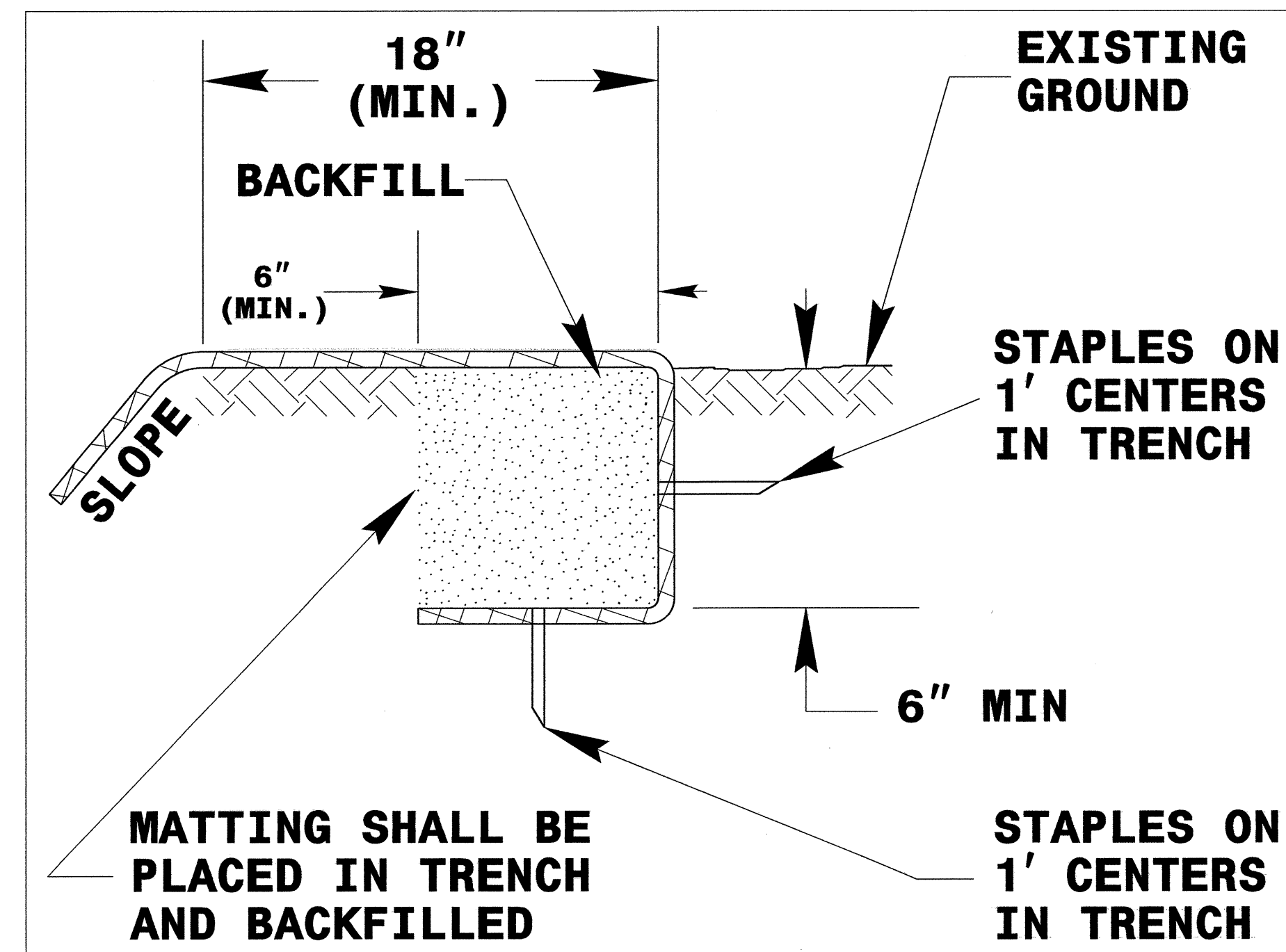
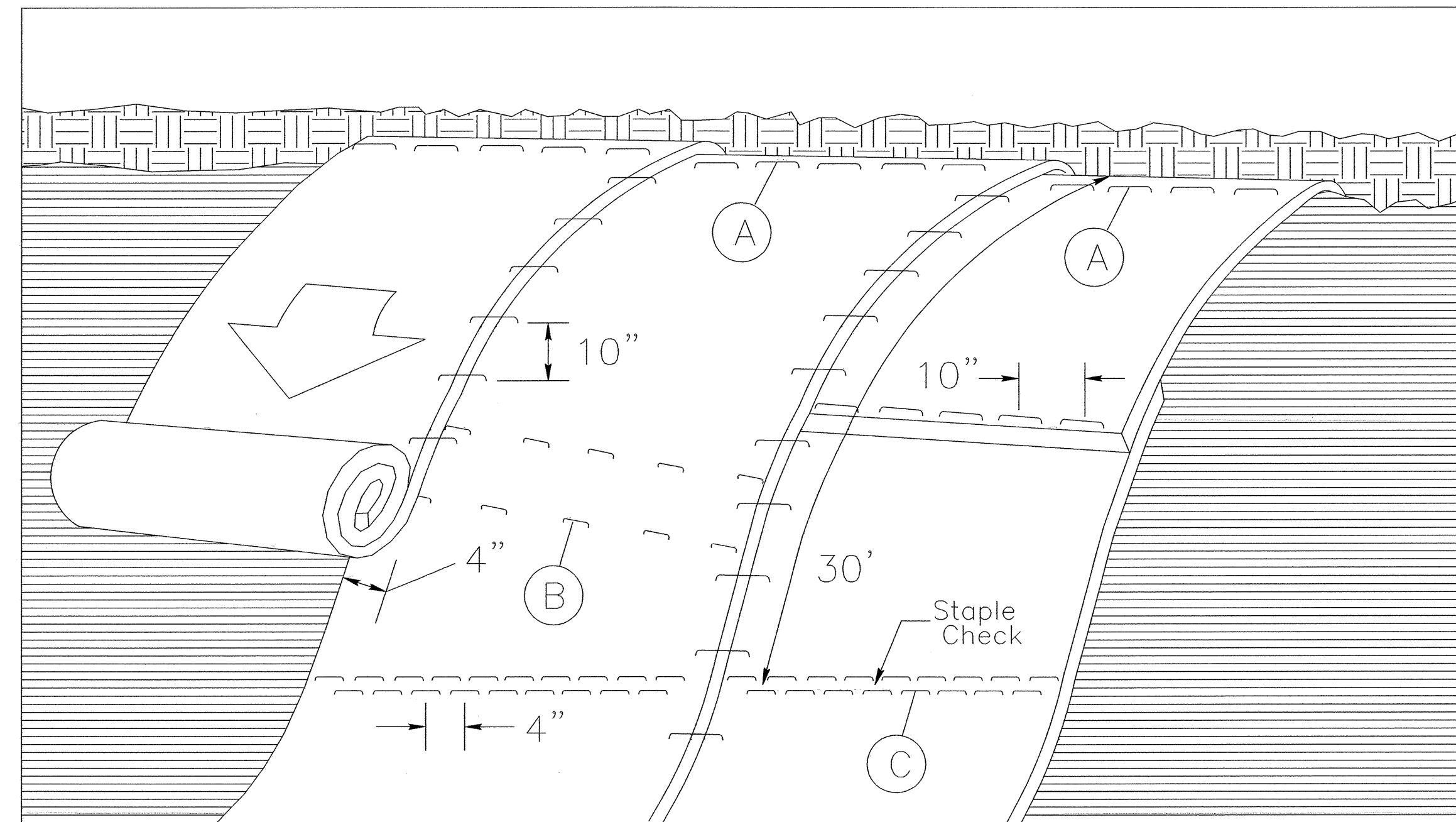

DIAGRAM (A)



**MATTING ON SLOPES**

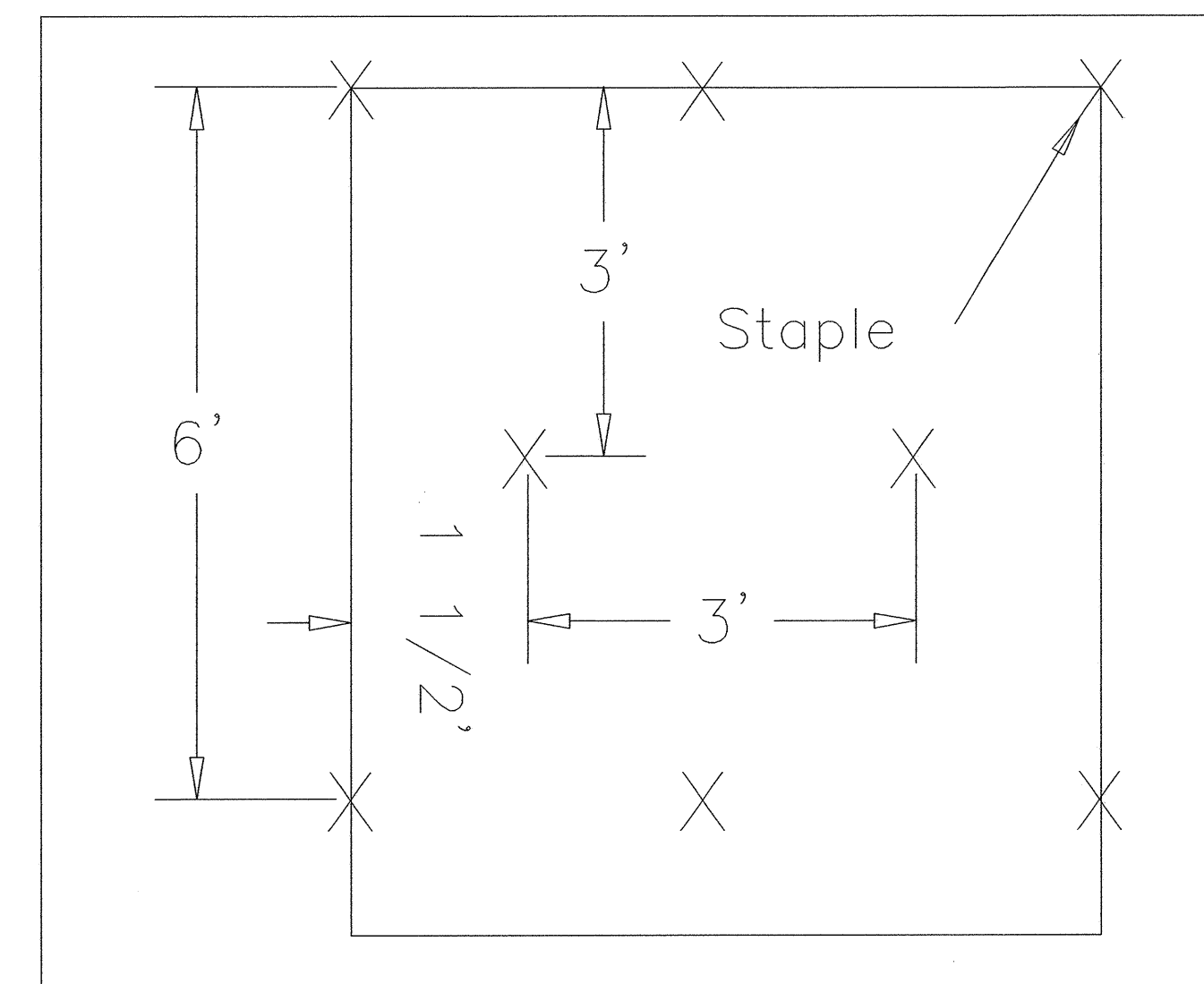

DIAGRAM (B)

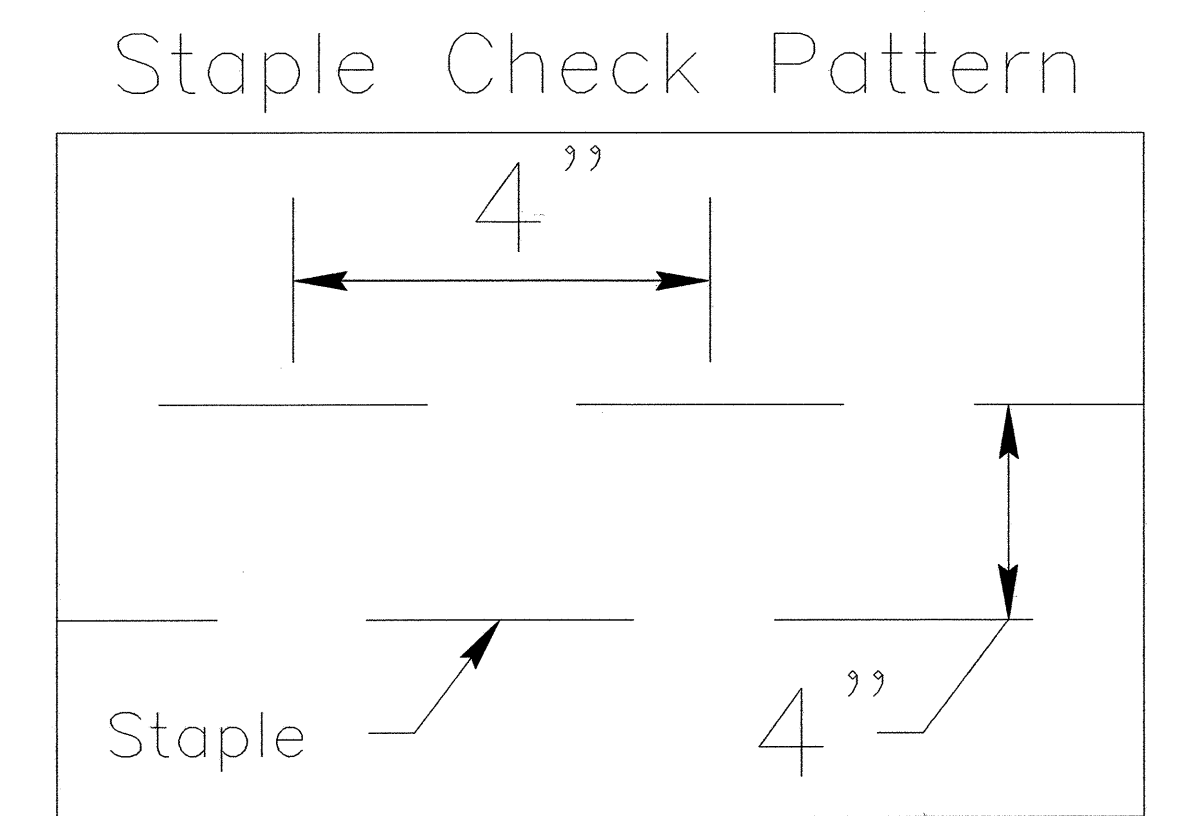

DIAGRAM (C)

**NOTES:**

THIS DETAIL APPLIES TO STRAW, EXCELSIOR, AND PERMANENT SOIL REINFORCEMENT MAT (PSRM) INSTALLATION.

STAPLES SHALL BE NO. 11 GAUGE STEEL WIRE FORMED INTO A "U" SHAPE WITH A MINIMUM THROAT WIDTH OF 1 INCH AND NOT LESS THAN 6 INCHES IN LENGTH.

NOT TO SCALE



5/14/95

CLEARING AND GRUBBING  
EROSION CONTROL FOR  
CONSTRUCTION SHEET 4

NOTE:  
PLACE TEMPORARY ROCK SEDIMENT DAMS TYPE - B  
AND TEMPORARY ROCK SILT CHECKS TYPE - A AT  
DRAINAGE OUTLETS.

NOTE: SALVAGE EXISTING "NO FISHING FROM HIGHWAY" SIGNS  
AND RE-ERECT SIGNS AFTER CONSTRUCTION.

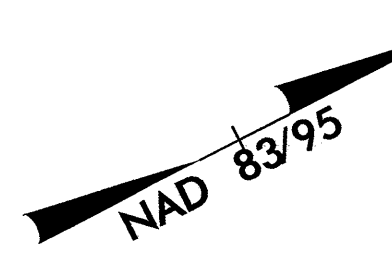

PROJECT REFERENCE NO. B-4673	SHEET NO. EC-4/CONST.4
RW SHEET NO.	
ROADWAY DESIGN ENGINEER	HYDRAULICS ENGINEER

FOR -L- PROFILE SEE SHEET 5

STA. 20+50 -L- END TIP PROJECT B-4673

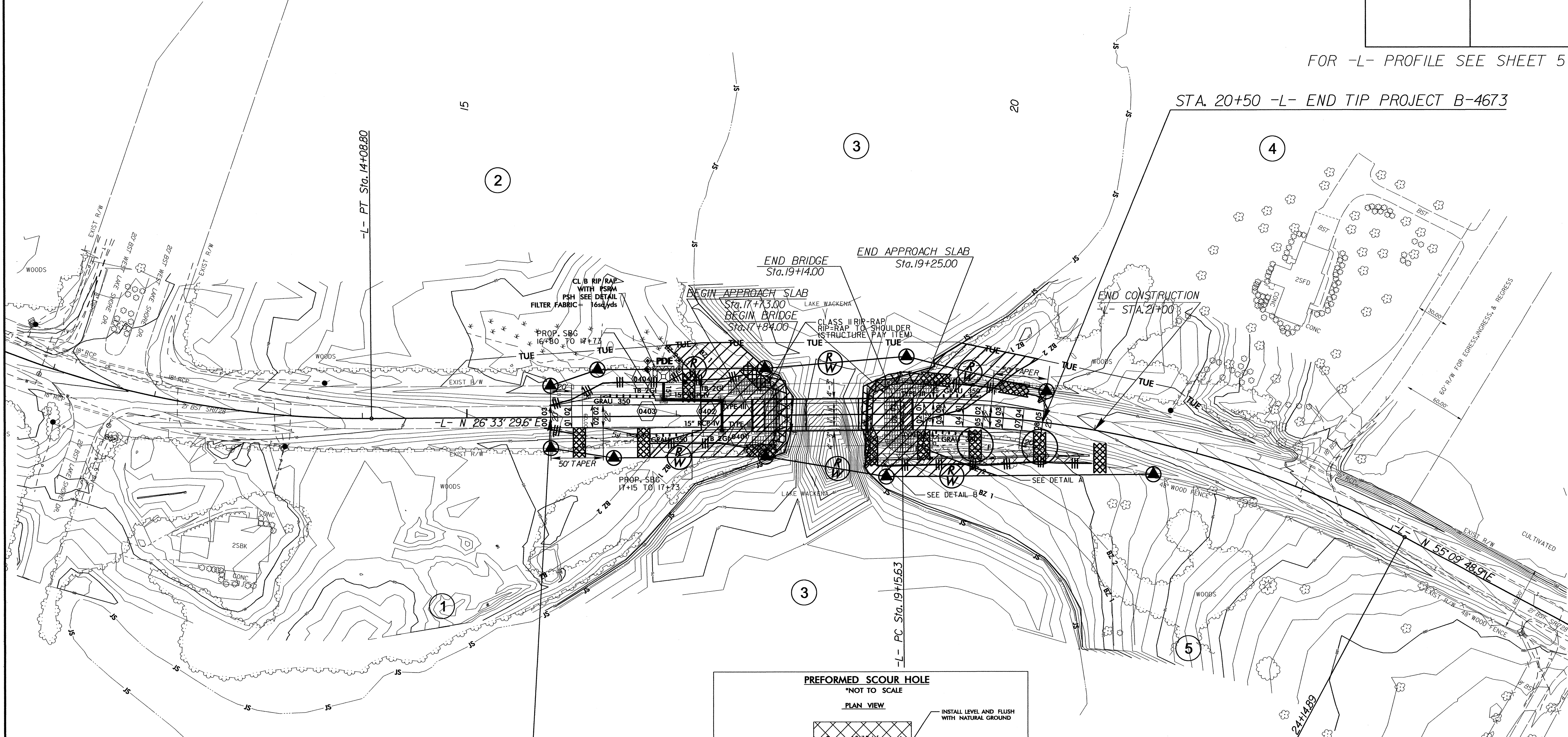

STA. 15+80 -L- BEGIN TIP PROJECT B-4673

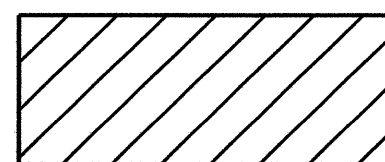

ENVIRONMENTALLY SENSITIVE AREA  
SEE PROJECT SPECIAL PROVISIONS

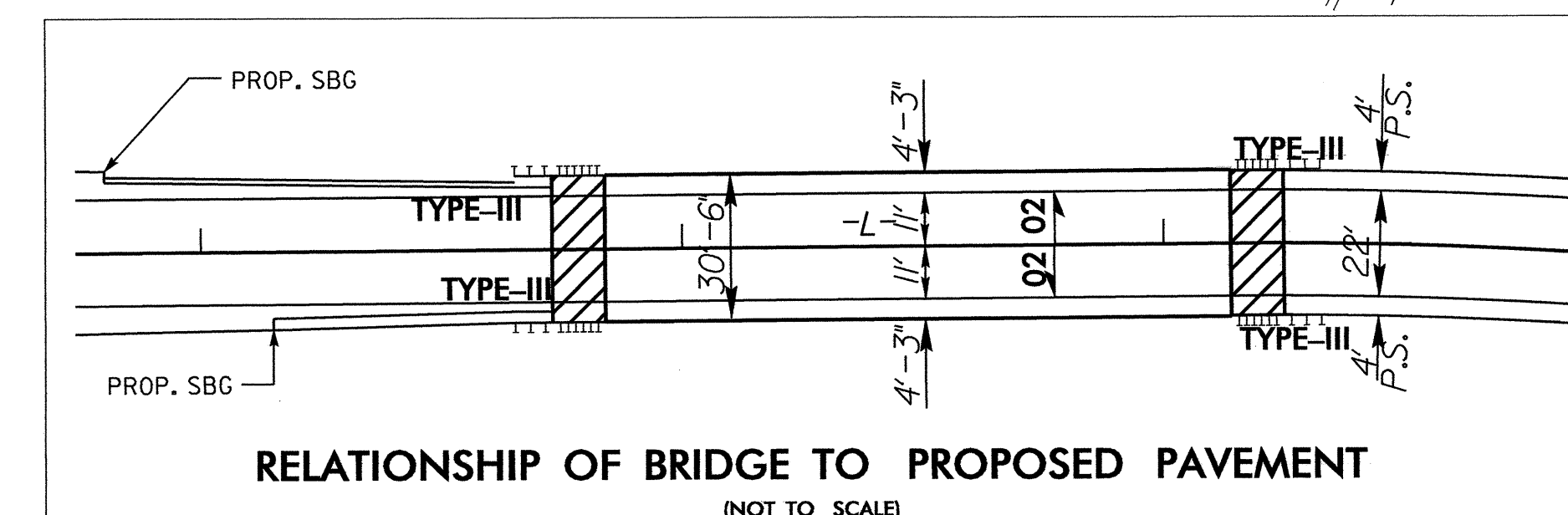
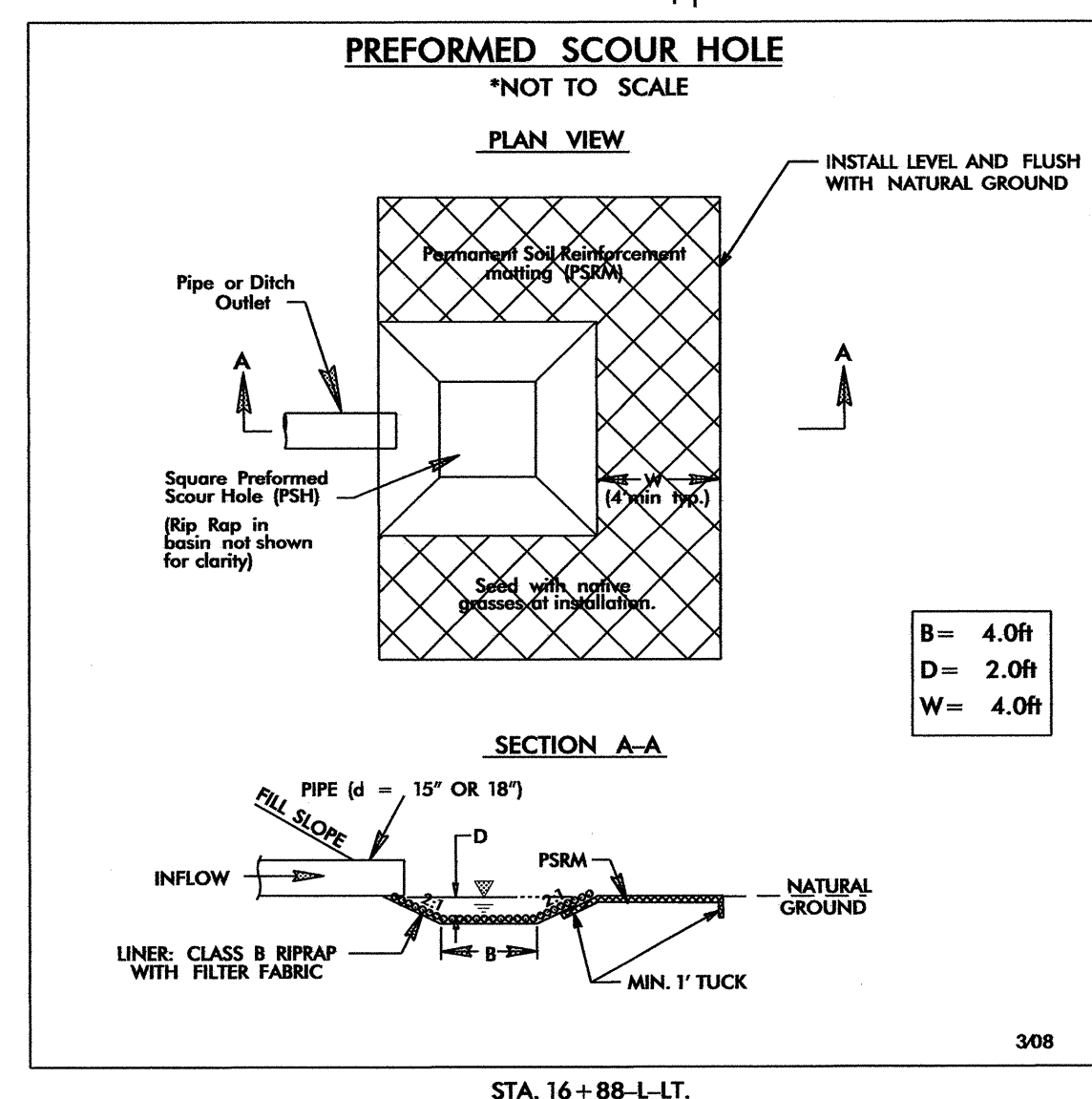
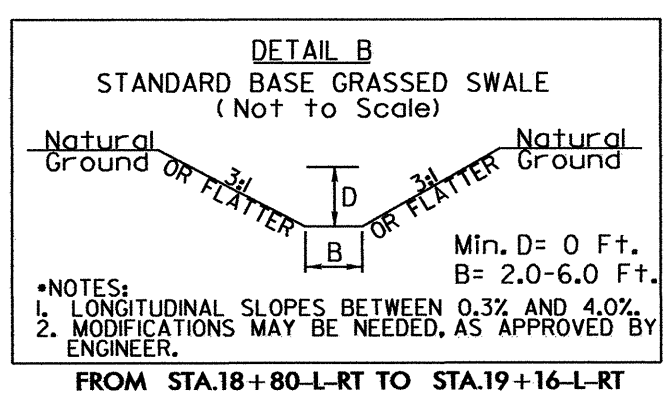
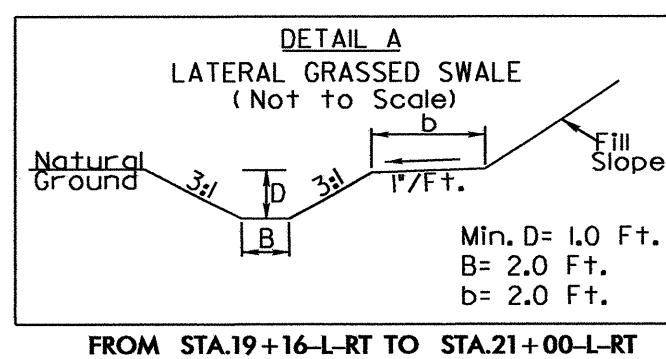

28-JUL-2011 12:48  
RA:\envr\proj\B4673-EC.dwg  
R:\envr\proj\B4673-EC.dwg

PROJECT REFERENCE NO. B-4673	SHEET NO. EC-5/CONST.4
RW SHEET NO.	
ROADWAY DESIGN ENGINEER	HYDRAULICS ENGINEER

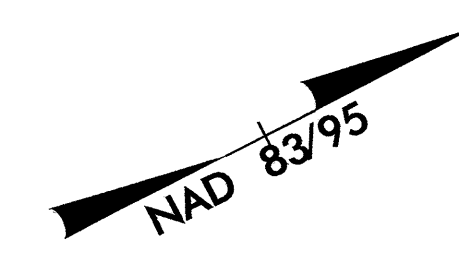

NOTE: SALVAGE EXISTING "NO FISHING FROM HIGHWAY" SIGNS AND RE-ERECT SIGNS AFTER CONSTRUCTION.

FOR -L- PROFILE SEE SHEET 5

STA. 20+50 -L- END TIP PROJECT B-4673

STA. 15+80 -L- BEGIN TIP PROJECT B-4673

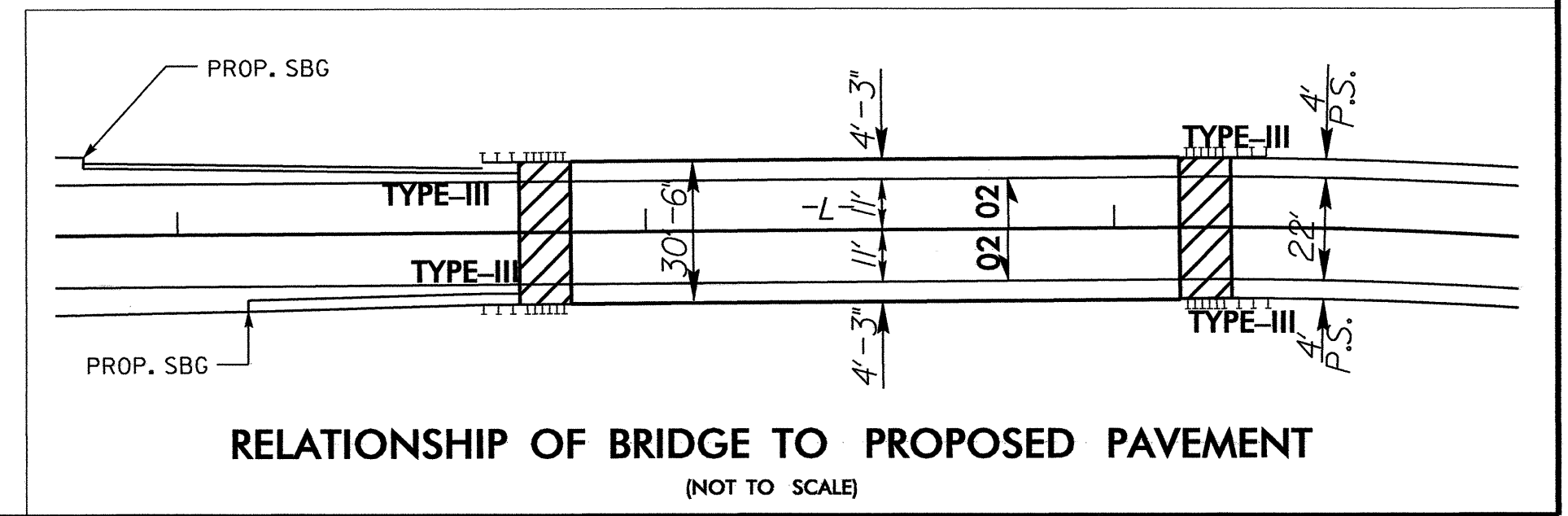
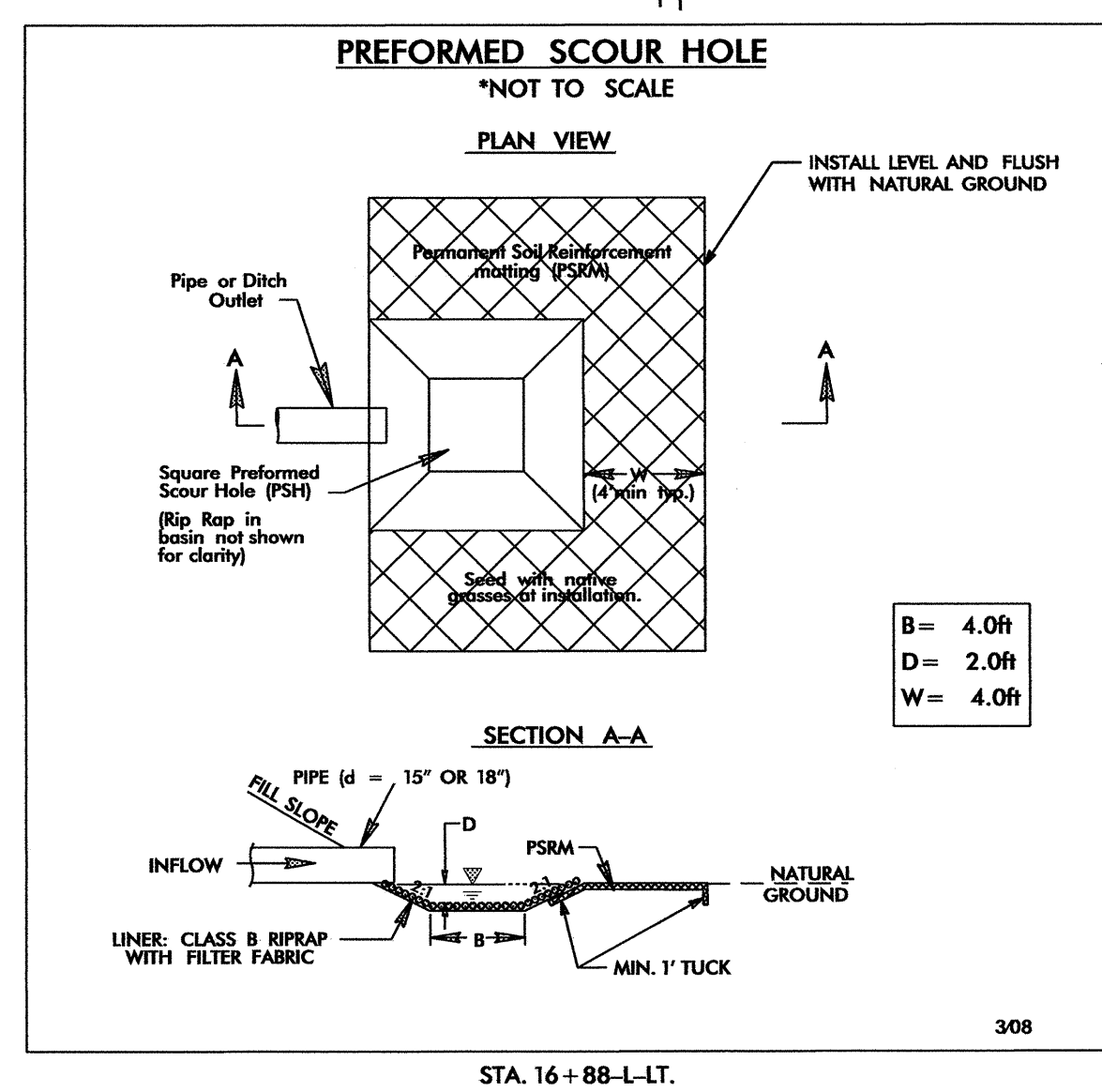
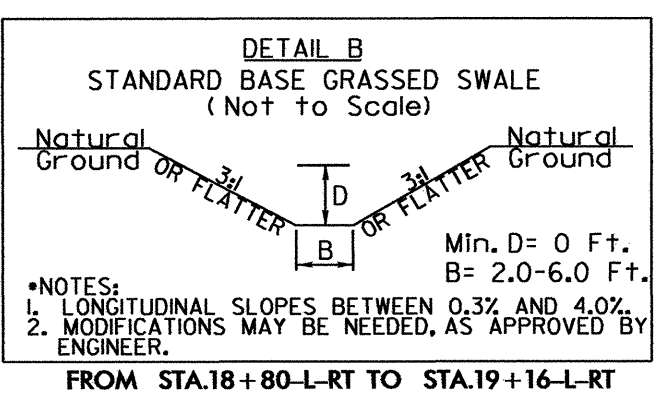
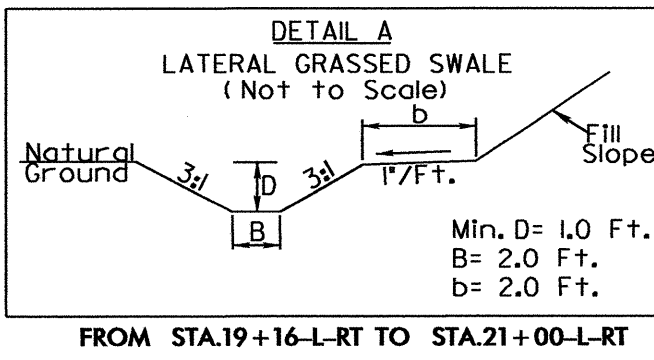
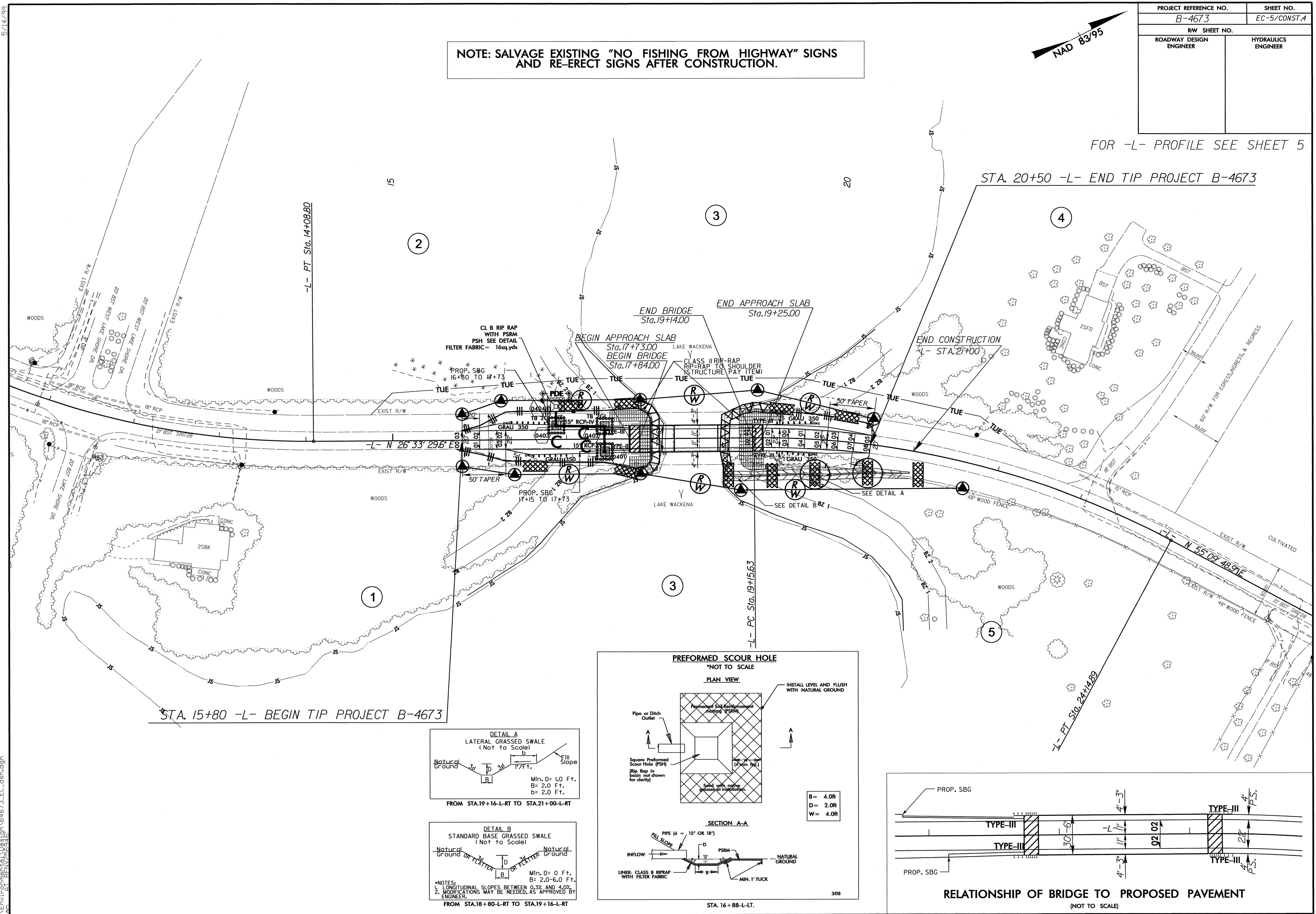

5/14/99  
28-JUL-2011 12:48  
R:\envi\p\p\design\B4673\_EC\_dsm.dgn  
HENRY