

202

203

204

205

206

207

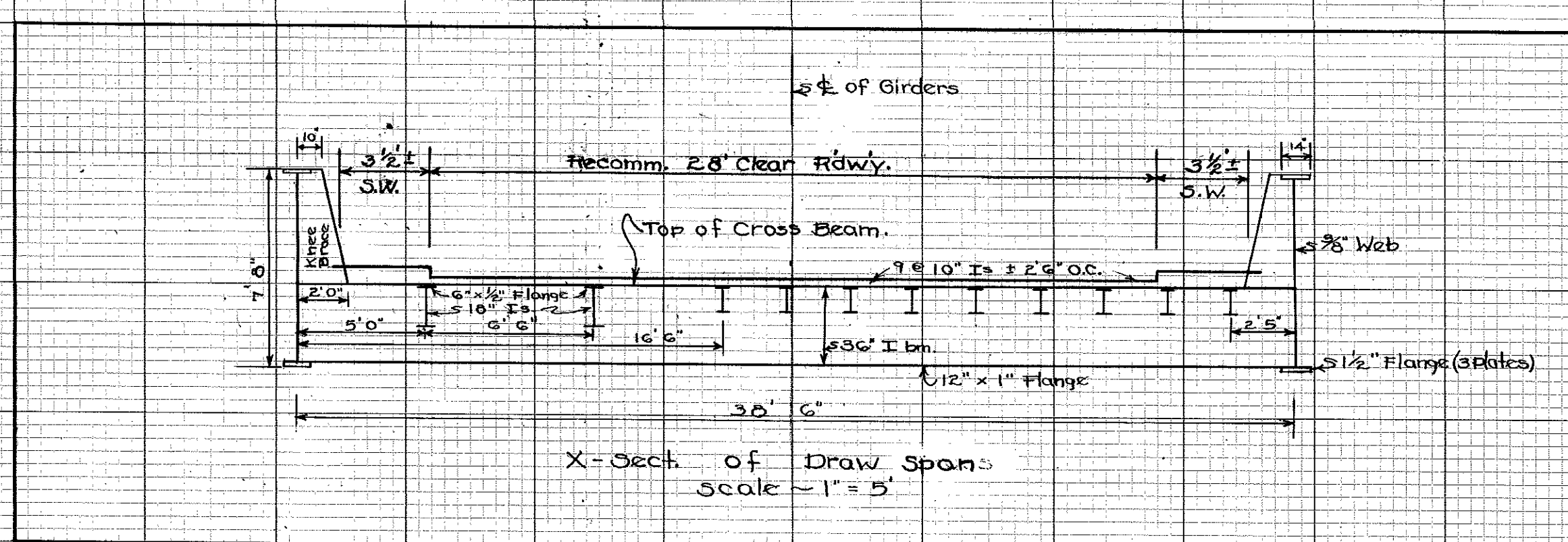
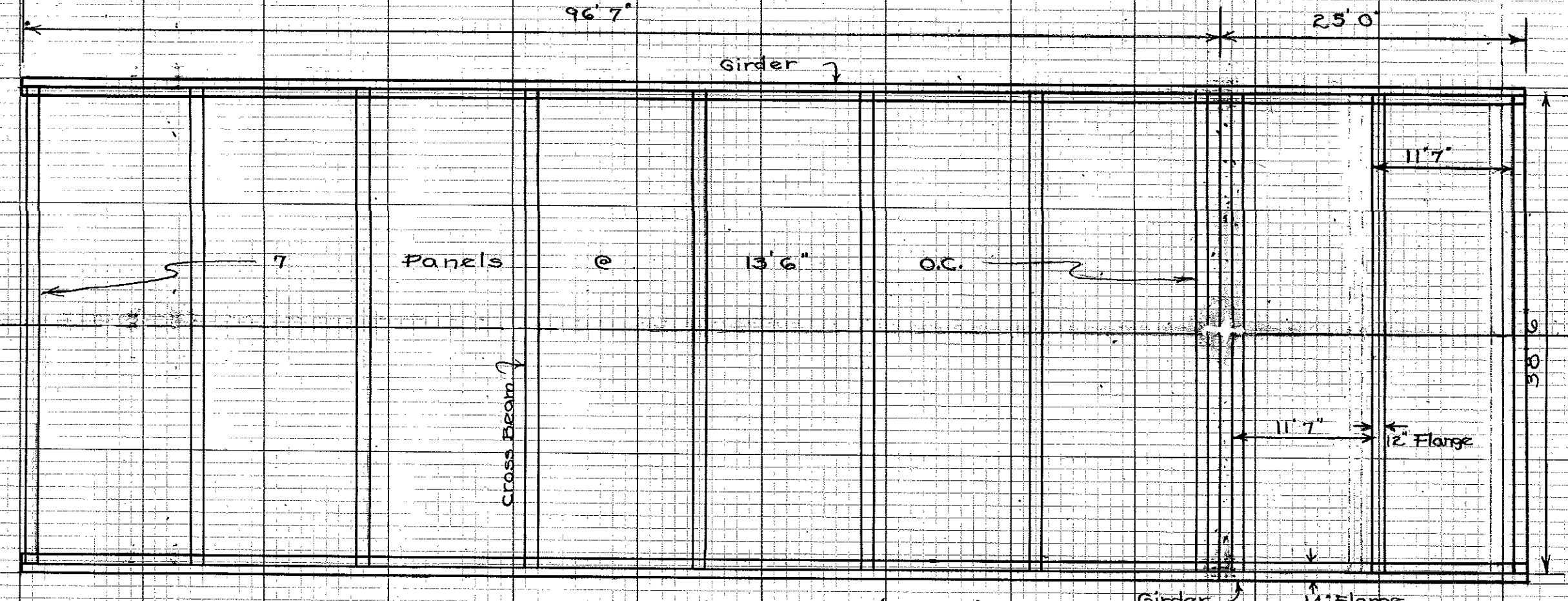
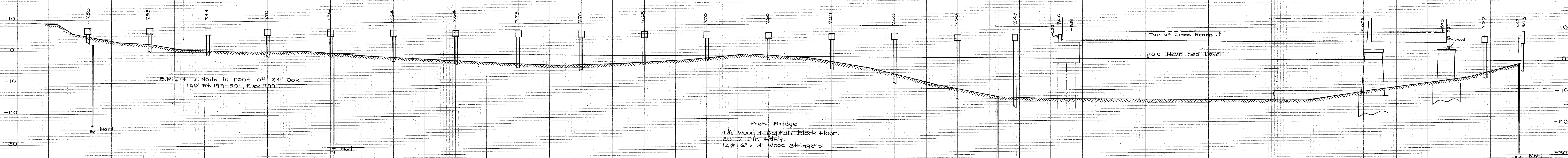

**BRIDGE OVER INLAND WATERWAY
AT WRIGHTVILLE BEACH**
Scale ~ 1" = 10"
Max Collins, Jr. Dec. 1951



B.M. #14 2 Nails in root of 2.4" Oak
120' Rt. 199+50, Elev. 7.99

Pres. Bridge
4 1/2" Wood + Asphalt block floor.
20' 0" Clr. rdwy.
12 @ 6" x 14" Wood stringers.

Plan View Draw (Truss) span
Scale - 1" = 10"
Longitudinal Beams Not Shown

X-Section of Draw Span
Scale - 1" = 5"

Extend All Piers on Lt. to provide for 26' rdwy + 4' S.W. Lt. + Rt.

3 (Conc.) Pile Bents
8' x 8' O.C.
Caps 1' 2" deep.