

PROJ. REFERENCE NO.	SHEET NO.
B-4551	X-1

STATE OF NORTH CAROLINA  
DIVISION OF HIGHWAYS

CROSS-SECTION SUMMARY

NOTE: EMBANKMENT COLUMN DOES NOT INCLUDE BACKFILL FOR UNDERCUT

Station	Uncl. Exc. (cu. yd.)	Embt (cu. yd.)	Station	Uncl. Exc. (cu. yd.)	Embt (cu. yd.)	Station	Uncl. Exc. (cu. yd.)	Embt (cu. yd.)
-L-			-Y-			-Y1-		
15+00.00	0	0	11+00.00	0	0	14+00.00	0	0
15+50.00	0	0	11+50.00	11	2	14+50.00	0	0
16+00.00	0	0	12+00.00	3	57	15+00.00	75	1
16+50.00	0	0	12+50.00	5	222	15+50.00	28	3
17+00.00	0	0	13+00.00	4	381			
17+50.00	19	44	13+50.00	1	275			
18+00.00	31	48						
18+50.00	37	55						
19+00.00	36	69						
19+50.00	30	96						
20+00.00	29	123						
20+50.00	23	136						
21+00.00	16	121						
21+50.00	8	63						
21+96.43	0	0						
23+22.51	0	0						
23+50.00	1	52						
24+00.00	20	87						
24+50.00	34	146						
25+00.00	23	164						
25+50.00	20	145						
26+00.00	20	106						
26+50.00	21	66						
27+00.00	23	40						
27+50.00	29	24						
28+00.00	21	10						

Approximate quantities only. Unclassified excavation, borrow excavation, fine grading, clearing and grubbing, removal of existing pavement, and breaking of existing pavement will be paid for at the lump sum price for "Grading".

	<b>DRMP</b>	DYER, RIDDLE, MILLS & PRECOURT, INC.
	ENGINEERS • PLANNERS • SCIENTISTS	5950 FAIRVIEW RD., S-320
		CHARLOTTE, NC 28210
		704-332-2289 NC LICENSE NO. C-2213

8/23/99

150 140 130 120 110 100 90 80 70 60 50 40 30 20 10 0 10 20 30 40 50 60 70 80 90 100 110 120 130 140 150

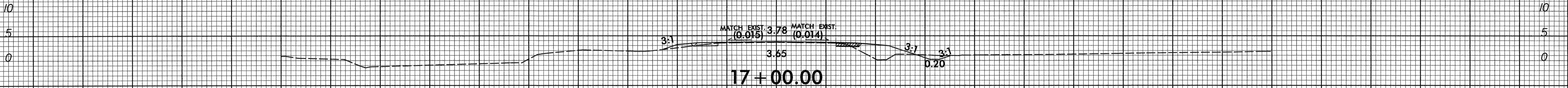
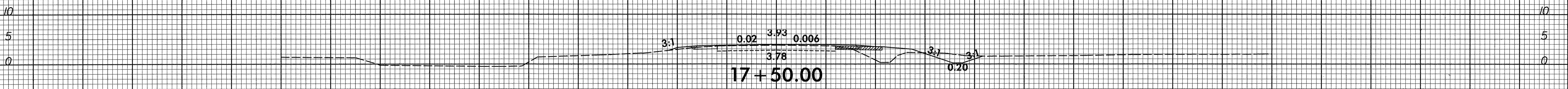
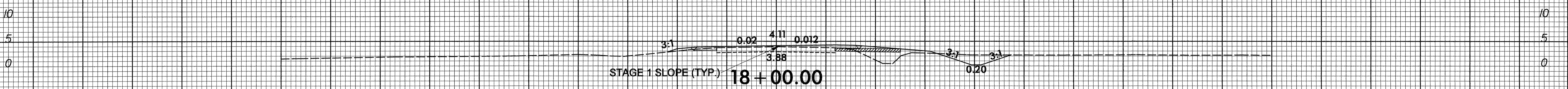
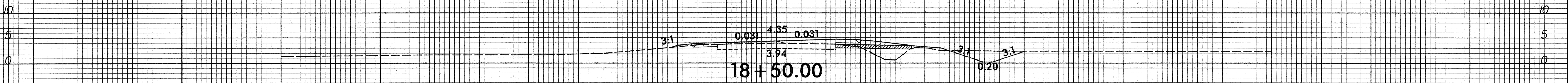

BEGIN PROJECT STA 16+85.00

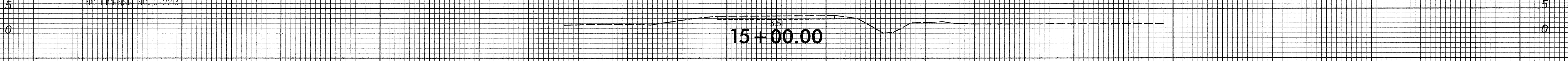
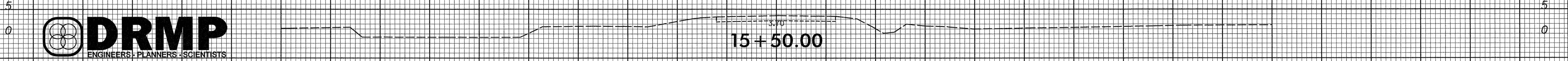
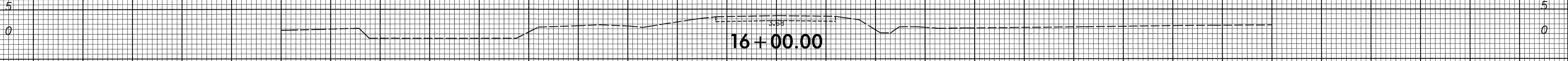
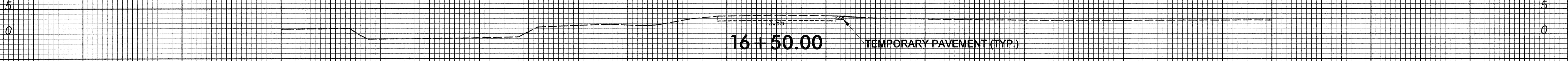

150 140 130 120 110 100 90 80 70 60 50 40 30 20 10 0 10 20 30 40 50 60 70 80 90 100 110 120 130 140 150

**DRMP**  
ENGINEERS • PLANNERS • SCIENTISTS

DYER, RIDDLE, MILLS & PRECOURT, INC.  
5950 FAIRVIEW RD., SUITE 320  
CHARLOTTE, NORTH CAROLINA 28210  
(704) 332-2289  
NC LICENSE NO. C-2213

10/5/06 AP 12/26/2011

8/23/19  
10:55:18 AM  
2/26/2011

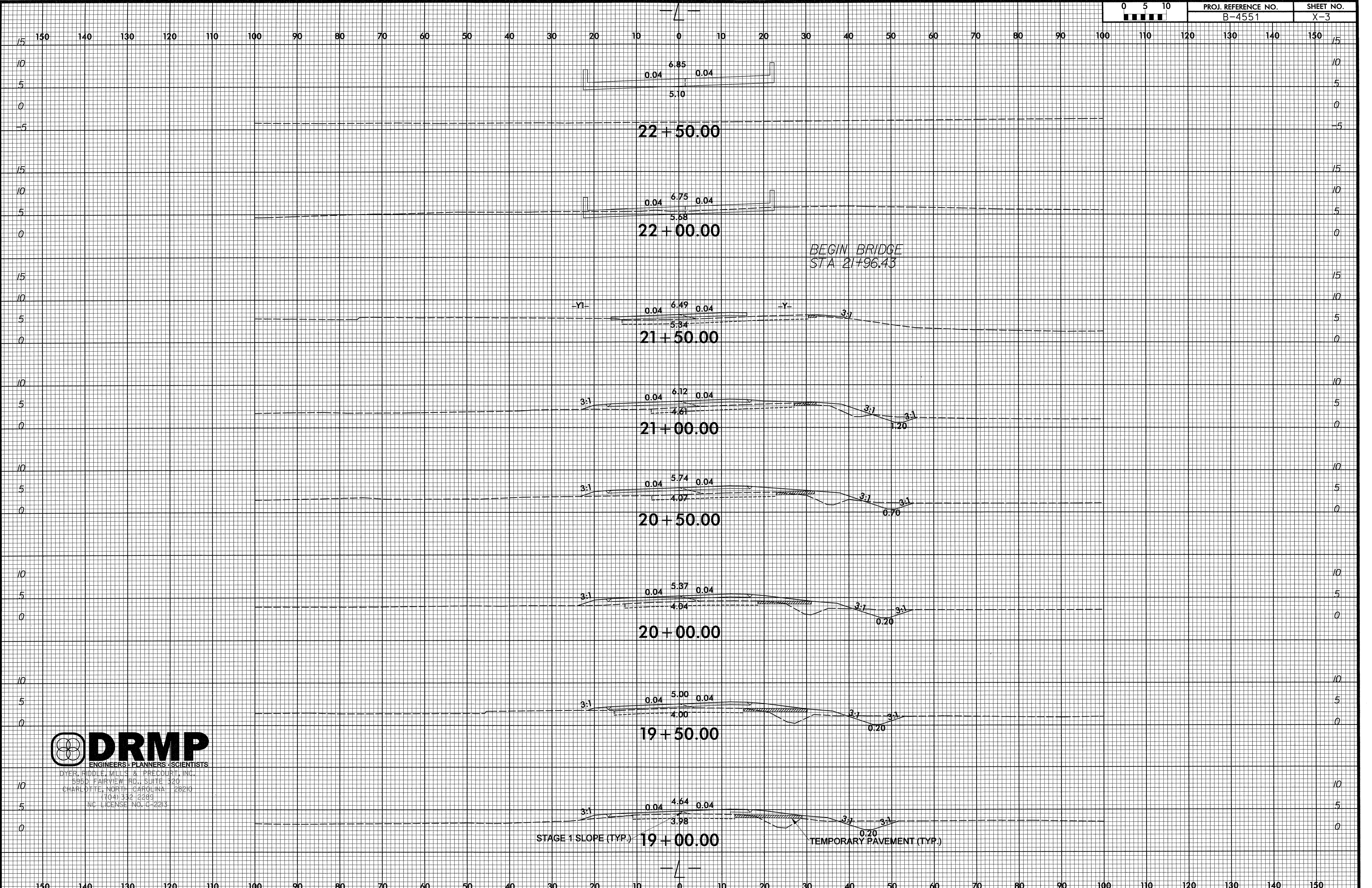

**DRMP**  
ENGINEERS • PLANNERS • SCIENTISTS  
DYER, RIDDLE, MILLS & PRECOURT, INC.  
5950 FAIRVIEW RD., SUITE 320  
CHARLOTTE, NORTH CAROLINA 28210  
(704) 332-2289  
NC LICENSE NO. C-2213

8/23/99

0 5 10

PROJ. REFERENCE NO.  
B-4551

SHEET NO.  
X-4

150 140 130 120 110 100 90 80 70 60 50 40 30 20 10 0 10 20 30 40 50 60 70 80 90 100 110 120 130 140 150

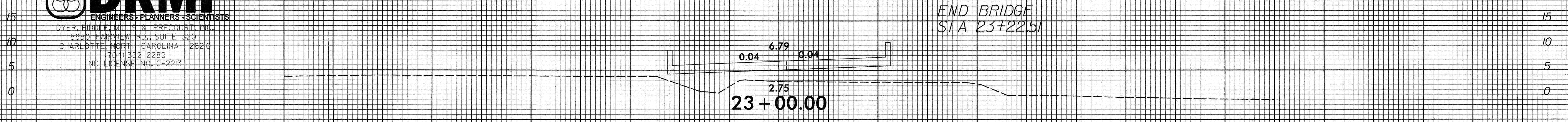
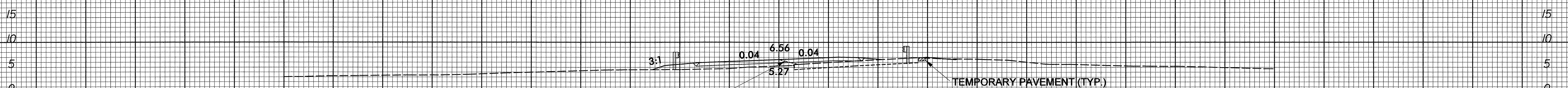
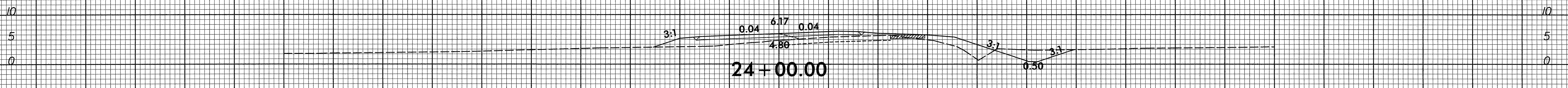
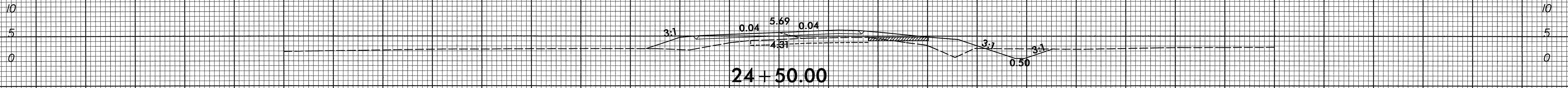
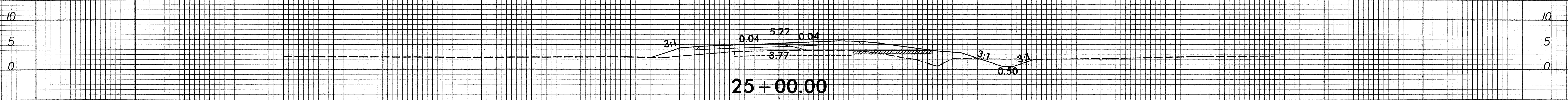
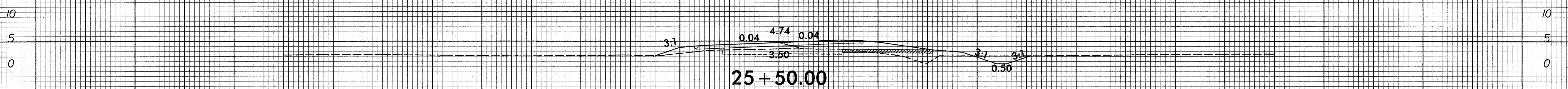
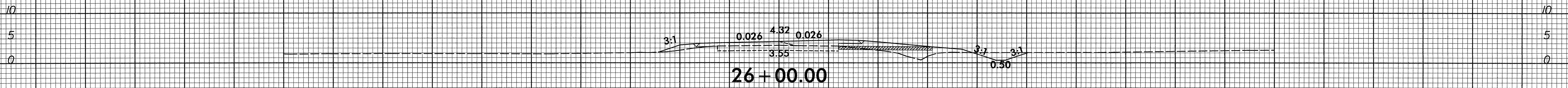

END BRIDGE  
S/A 23+22.51

**DRMP**  
ENGINEERS · PLANNERS · SCIENTISTS  
DYER, RIDDLE, MILLS & PRECOURT, INC.  
5950 FAIRVIEW RD., SUITE 320  
CHARLOTTE, NORTH CAROLINA 28210  
(704) 332-2289  
NC LICENSE NO. C-2213

18:56:20 AM 7/26/2011

150 140 130 120 110 100 90 80 70 60 50 40 30 20 10 0 10 20 30 40 50 60 70 80 90 100 110 120 130 140 150

8/23/05

0 5 10  
[Scale bar]

PROJ. REFERENCE NO.  
B-4551

SHEET NO.  
X-5

150 140 130 120 110 100 90 80 70 60 50 40 30 20 10 0 10 20 30 40 50 60 70 80 90 100 110 120 130 140 150

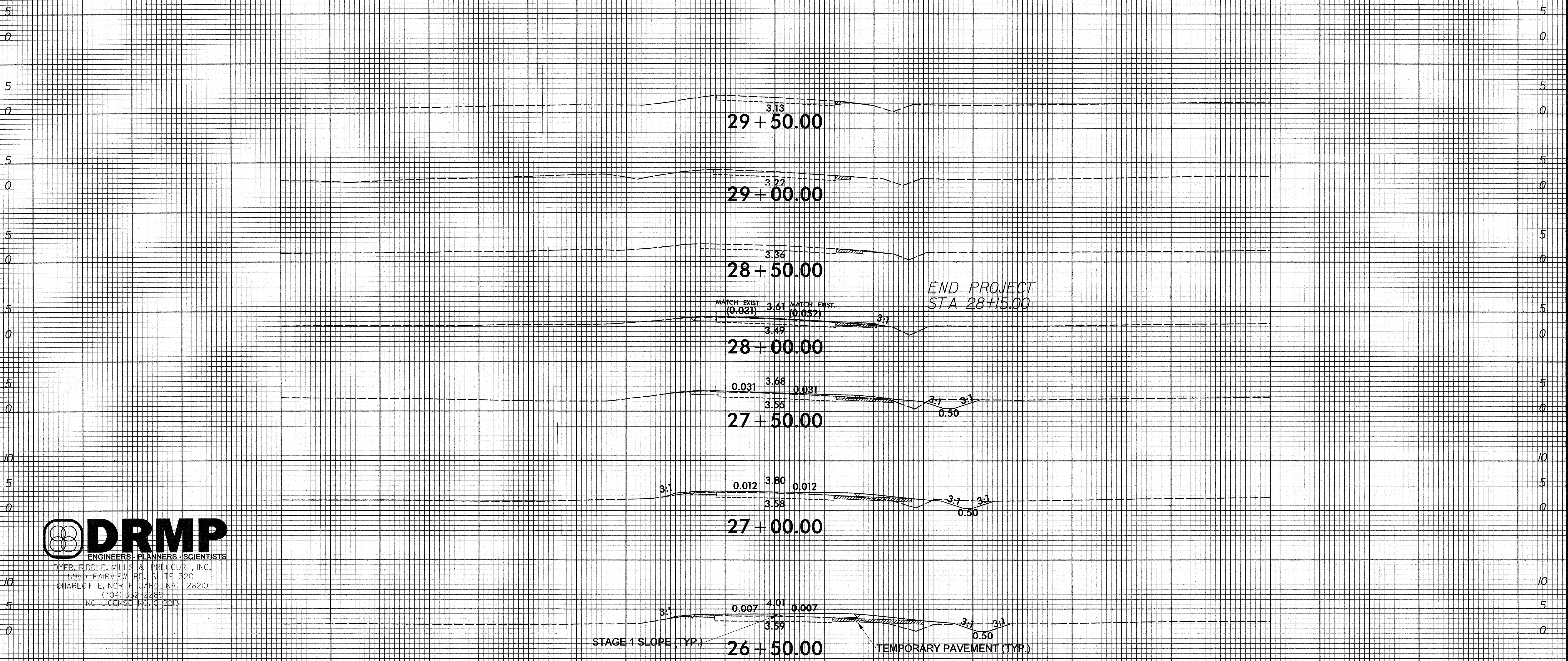

**DRMP**  
ENGINEERS · PLANNERS · SCIENTISTS  
DYER, RIDGLE, MILLS & PRECOURT, INC.  
5950 FAIRVIEW RD., SUITE 320  
CHARLOTTE, NORTH CAROLINA 28210  
(704) 332-2289  
NC LICENSE NO. C-2213

10:57:05 AM  
7/26/2011

150 140 130 120 110 100 90 80 70 60 50 40 30 20 10 0 10 20 30 40 50 60 70 80 90 100 110 120 130 140 150

8/23/95

-Y- SR 1164

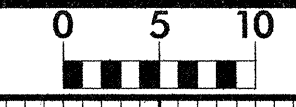

PROJ. REFERENCE NO.	SHEET NO.
B-4551	X-6

150 140 130 120 110 100 90 80 70 60 50 40 30 20 10 0 10 20 30 40 50 60 70 80 90 100 110 120 130 140 150

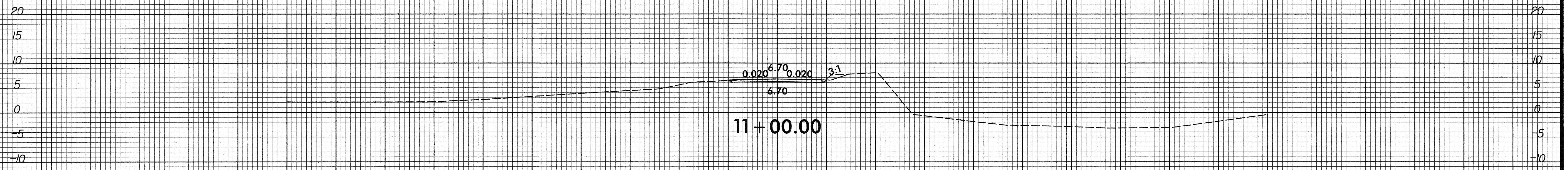
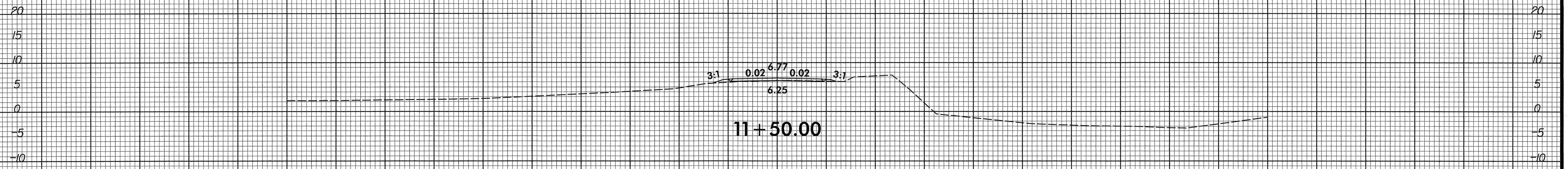
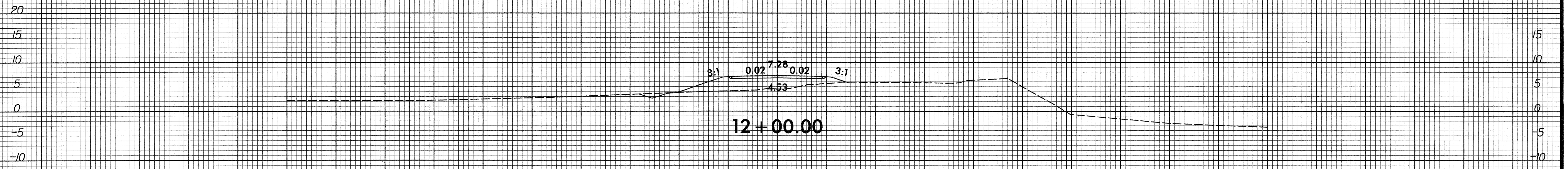

BEGIN CONSTRUCTION  
STA 11+00.00

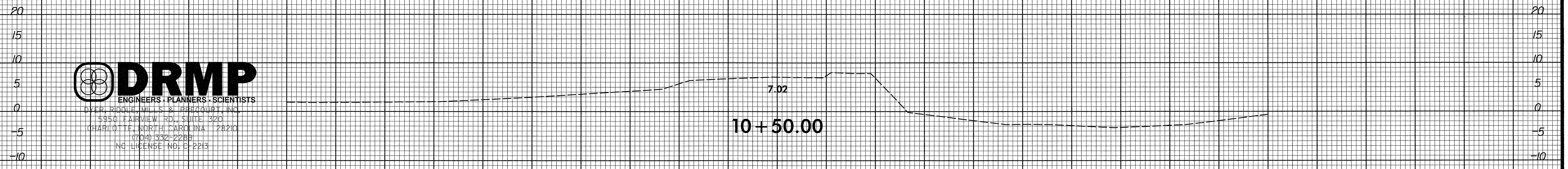

-Y- SR 1164

150 140 130 120 110 100 90 80 70 60 50 40 30 20 10 0 10 20 30 40 50 60 70 80 90 100 110 120 130 140 150

**DRMP**  
ENGINEERS • PLANNERS • SCIENTISTS  
OVER, RIDGE, MILLS & BEECHCOURT, INC.  
5950 FAIRVIEW RD., SUITE 320  
CHARLOTTE, NORTH CAROLINA 28210  
(704) 332-2288  
NC LICENSE NO. C-2213

10:45:50 AM 7/26/2011

8/23/96

-Y- SR 1164

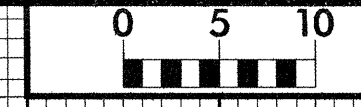

PROJ. REFERENCE NO. B-4551	SHEET NO. X-7
-------------------------------	------------------

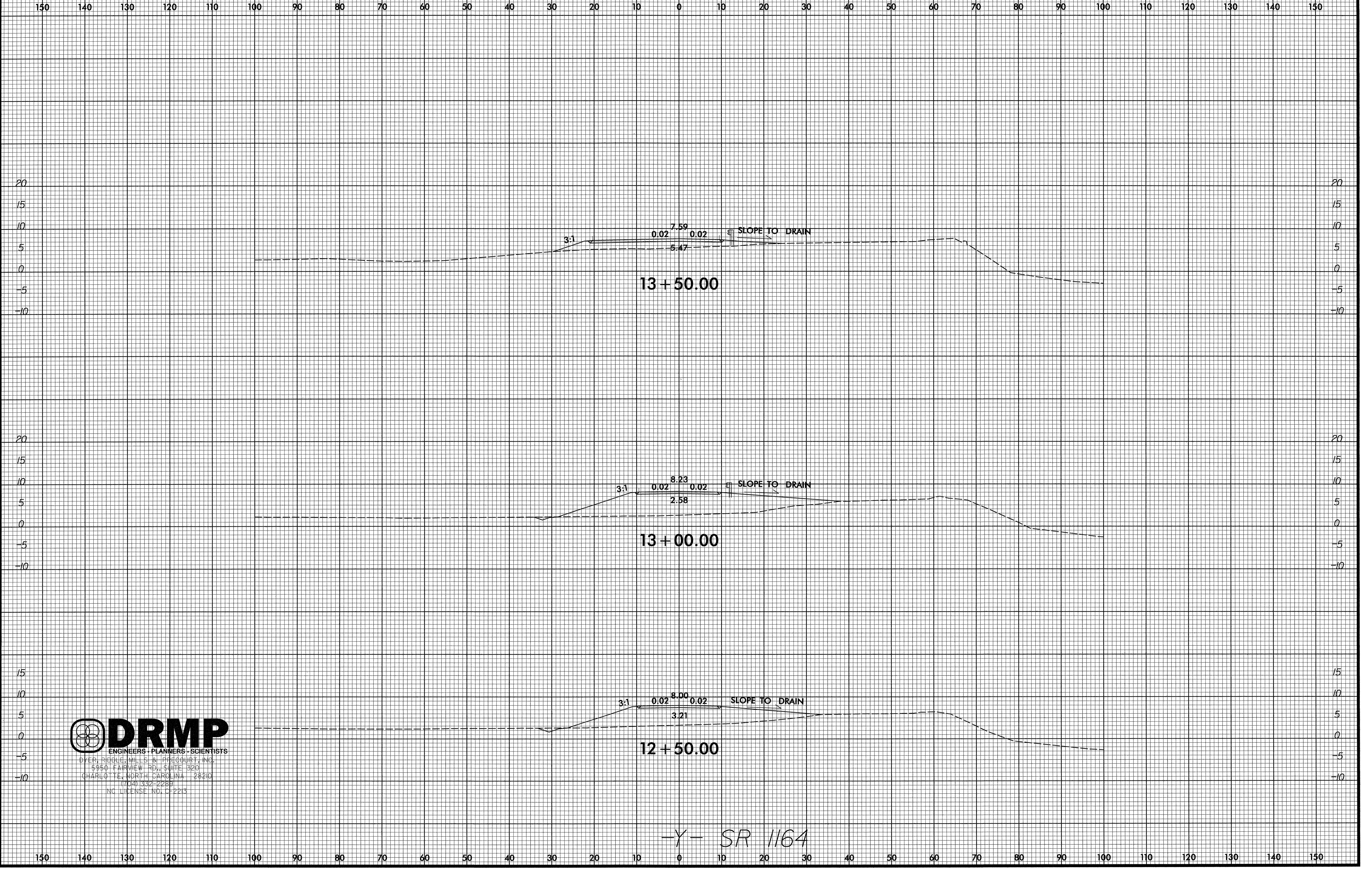

**DRMP**  
 ENGINEERS • PLANNERS • SCIENTISTS  
 DYER, RIDGLE, MILLS & PEECOURT, INC.  
 5950 FAIRMVIEW RD., SUITE 320  
 CHARLOTTE, NORTH CAROLINA 28210  
 (704) 332-2288  
 NC LICENSE NO. CE2213

-Y- SR 1164

10:16:44 AM 8/28/2011

8/23/15

-YI- SR 1330



PROJ. REFERENCE NO.  
B-4551

SHEET NO.  
X-8

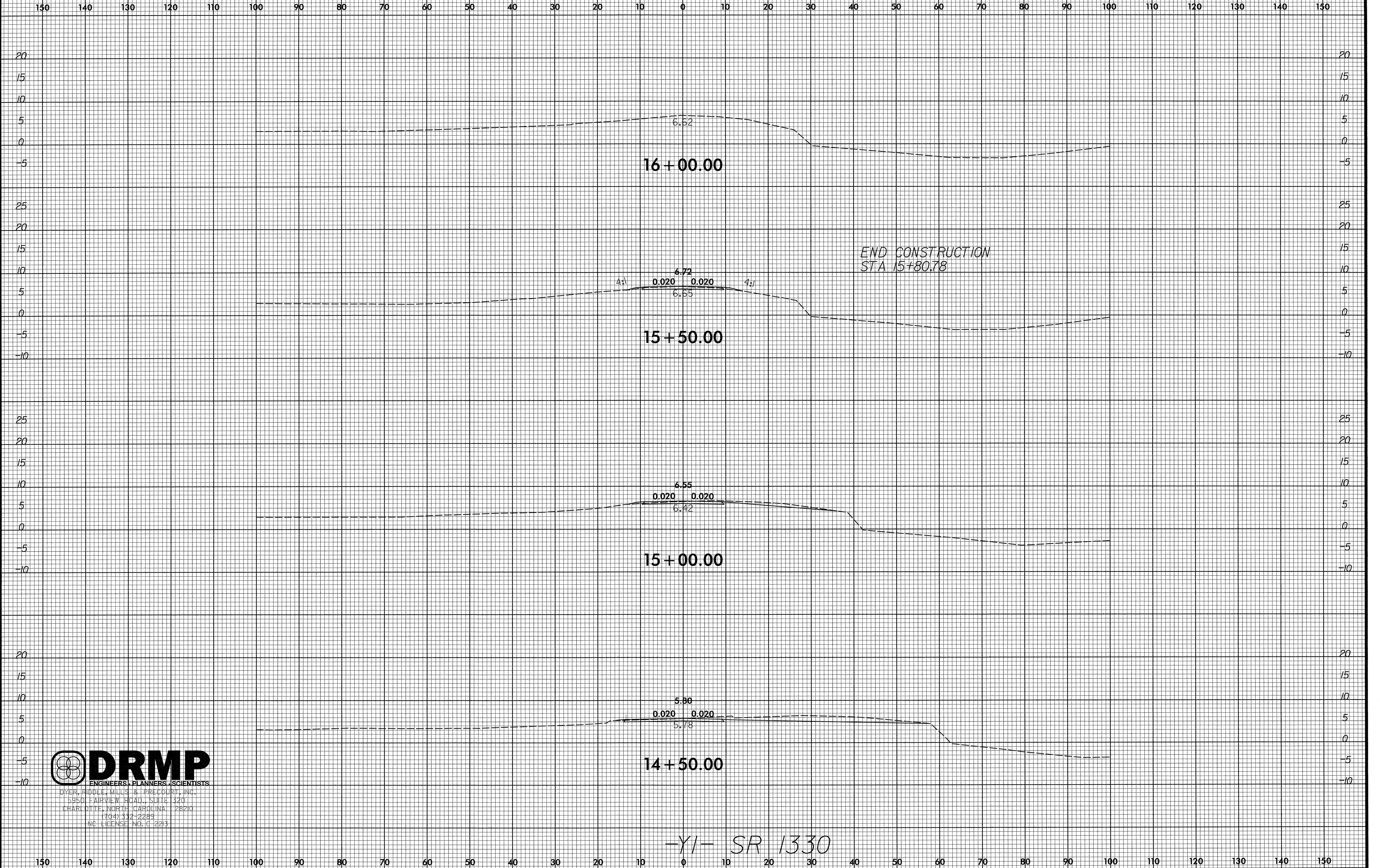

**DRMP**  
ENGINEERS, PLANNERS, SCIENTISTS  
DYER, HIDDLE, MILLS & PRECOURT, INC.  
5950 FAIRVIEW ROAD, SUITE 320  
CHARLOTTE, NORTH CAROLINA 28210  
(704) 332-2283  
NC LICENSE NO. C-2213

-YI- SR 1330

10/22/15 10:52 AM 10/26/2011