

T.I.P. NO.	SHEET NO.
B-4551	UC-1

STATE OF NORTH CAROLINA
DIVISION OF HIGHWAYS

UTILITY CONSTRUCTION PLANS
HYDE COUNTY

LOCATION: BRIDGE NO. 45 OVER A CANAL ON US 264

TYPE OF WORK: UTILITIES RELOCATION

TIP PROJECT: B4551

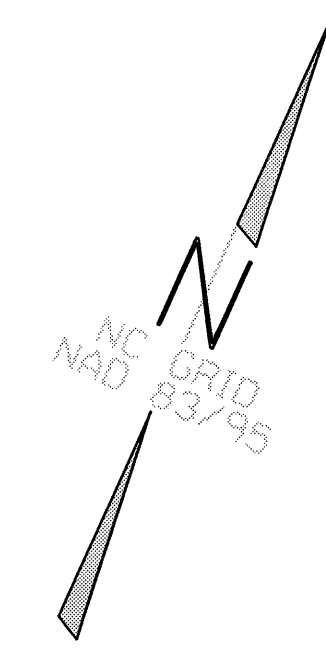
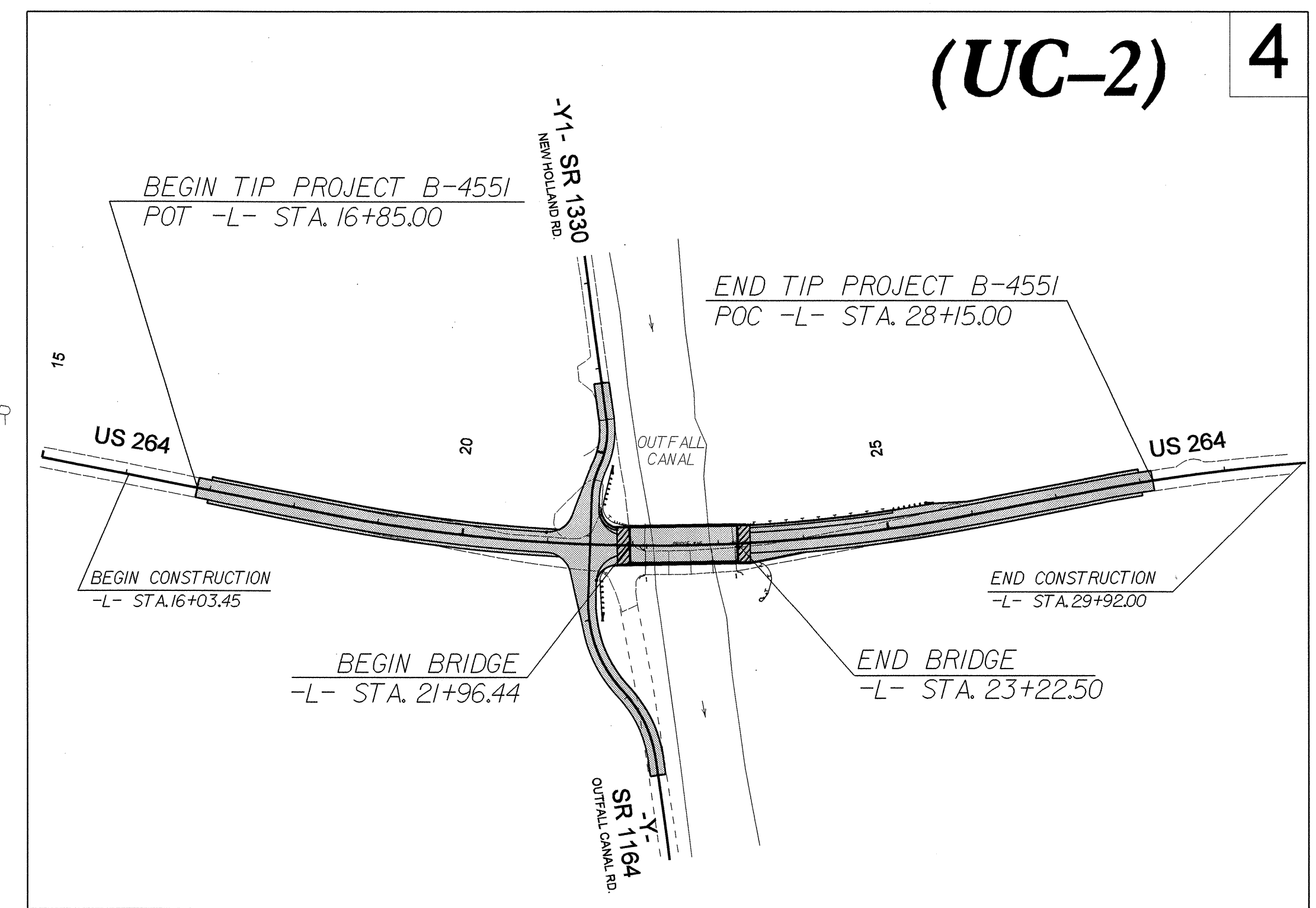
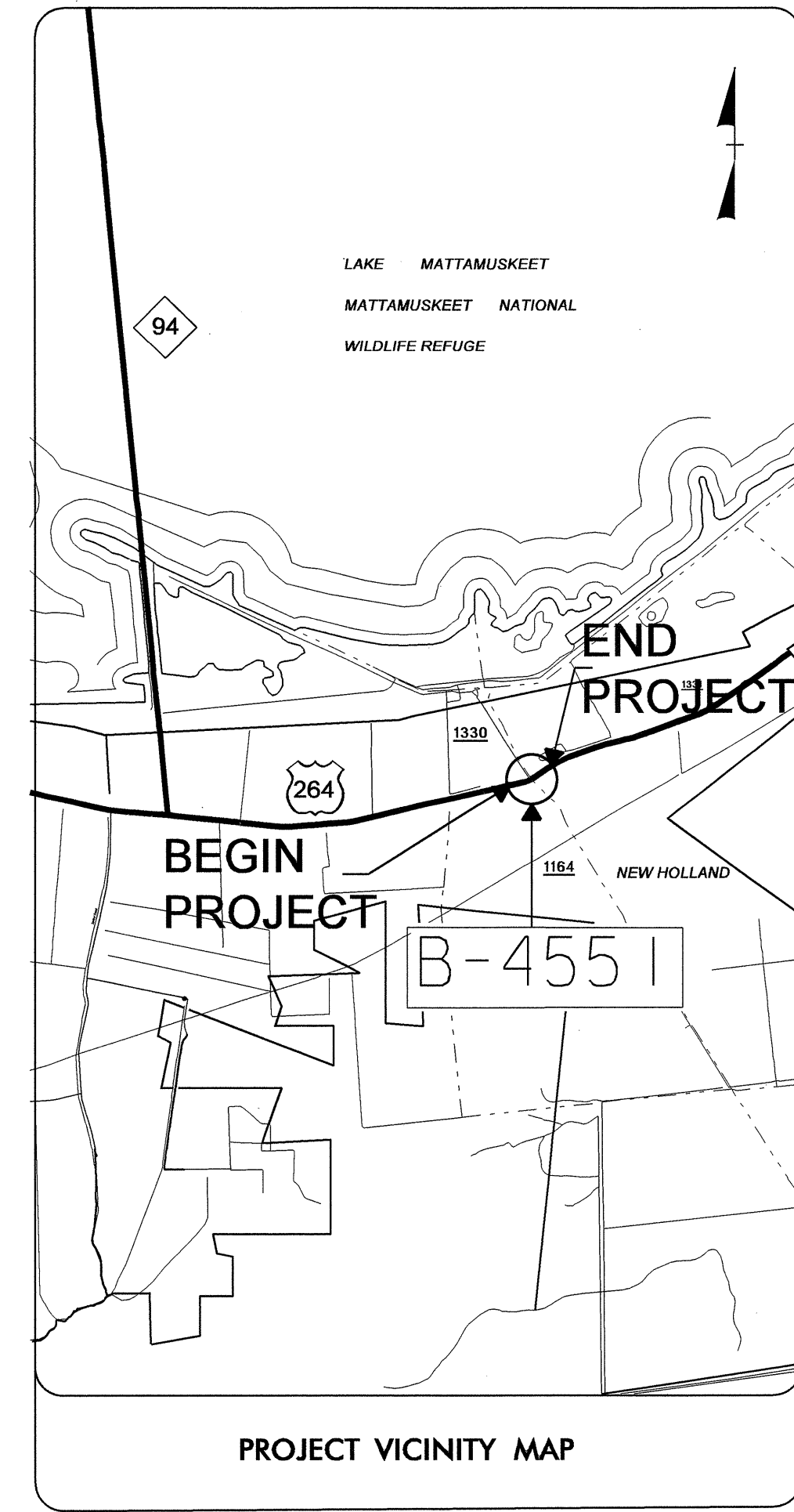

2006 STANDARD SPECIFICATIONS

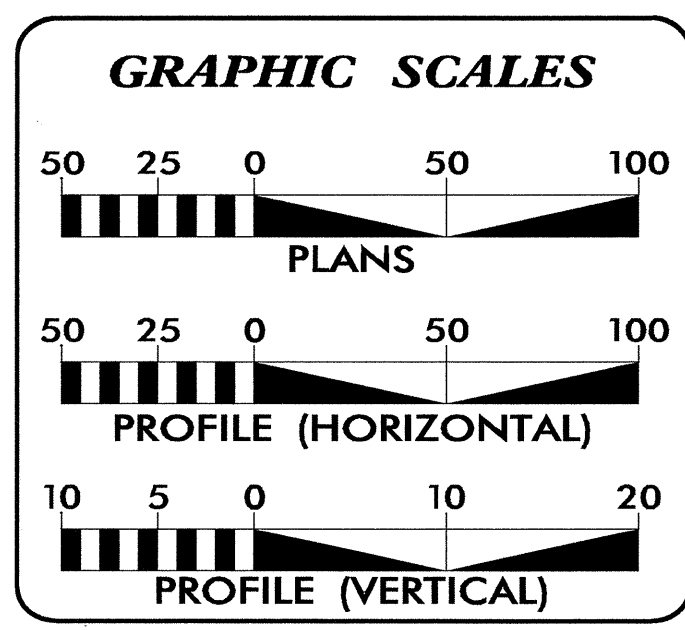

SHEET NO.	DESCRIPTION
UC-1	TITLE SHEET
UC-2	UTILITY CONSTRUCTION PLAN SHEET

WATER AND SEWER OWNERS ON PROJECT

(1) HYDE COUNTY WATER DISTRICT (WATER)

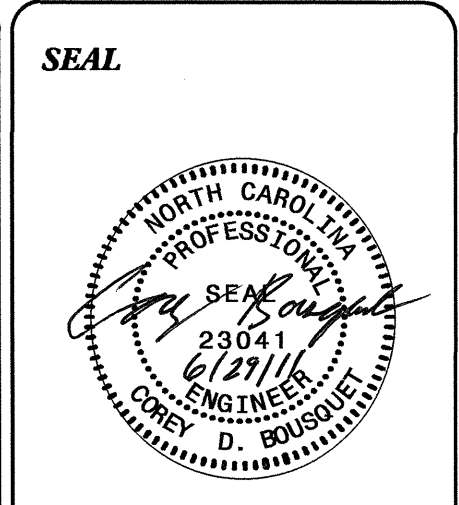

PREPARED IN THE OFFICE OF:
DIVISION OF HIGHWAYS
UTILITIES ENGINEERING SECTION

1591 MAIL SERVICES CENTER
RALEIGH NC 27699-1591
PHONE (919) 250-4128
FAX (919) 250-4119

Roger Worthington, P.E. UTILITIES SECTION ENGINEER
Corey Bousquet, P.E. UTILITIES SQUAD LEADER PROJECT ENGINEER
Nabil Hamdan UTILITIES PROJECT DESIGNER

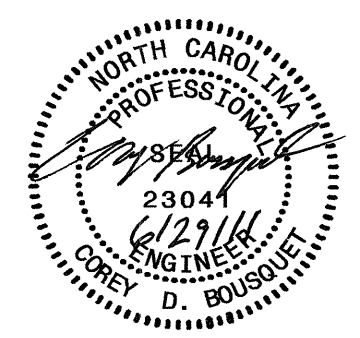

UTILITY CONSTRUCTION

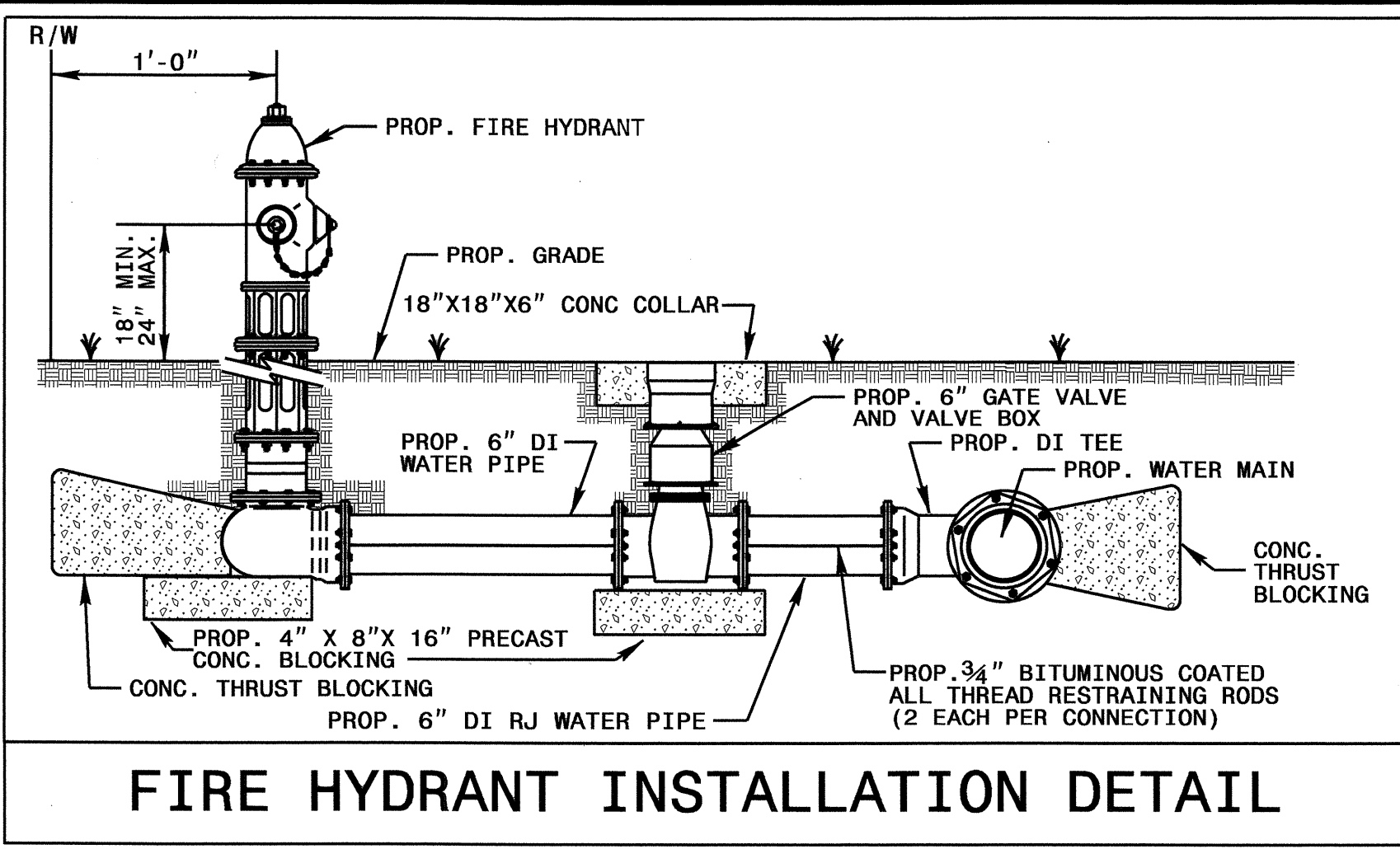
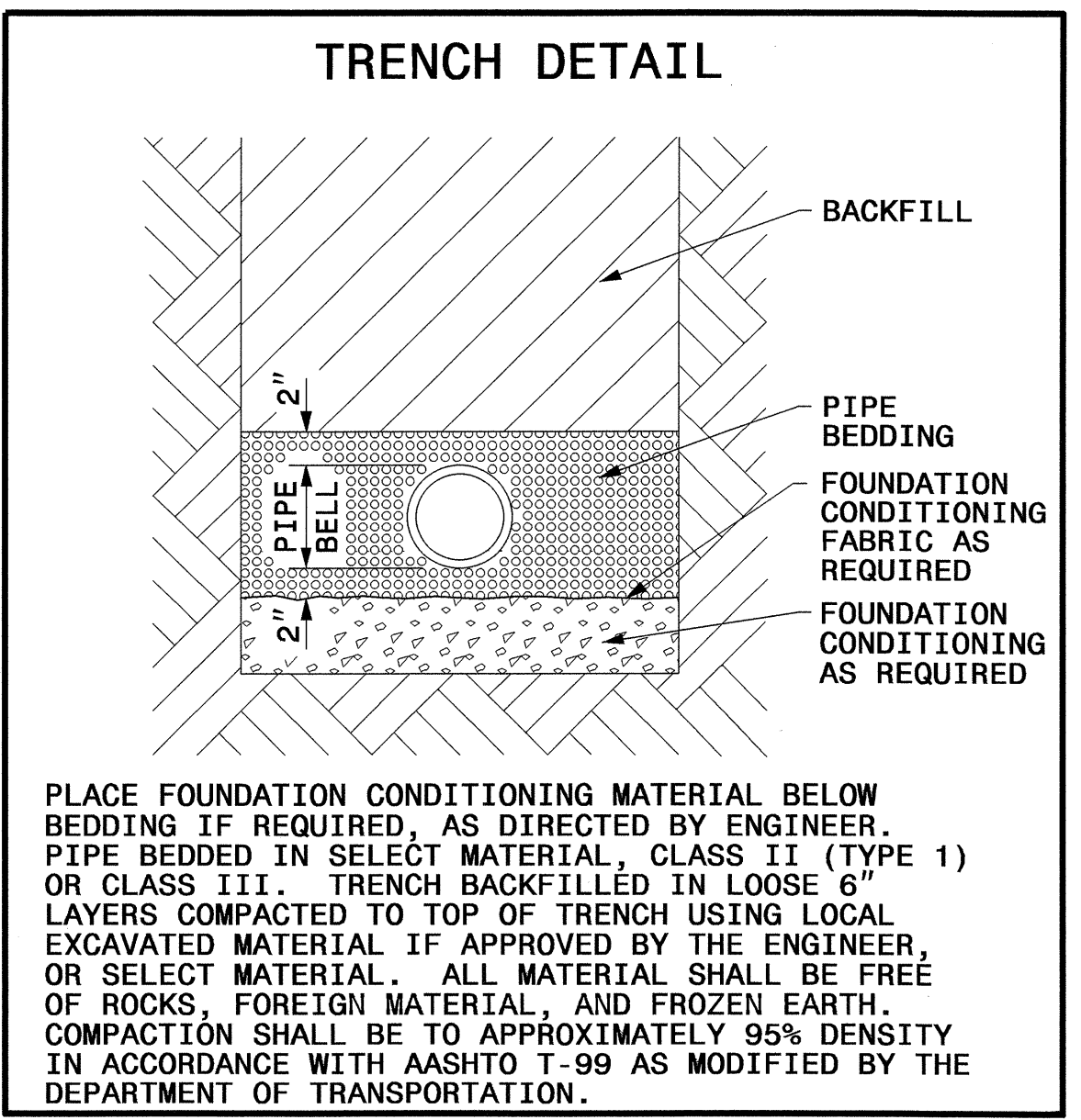

MAXIMUM TRENCH WIDTH AT TOP OF PIPE	
NOMINAL PIPE SIZE (INCHES)	TRENCH WIDTH (INCHES)
4	28
6	30
8	32
10	34
12	36
14	38
16	40
18	42
20	44
24	48
30	54
36	60
42	66
48	72
54	78

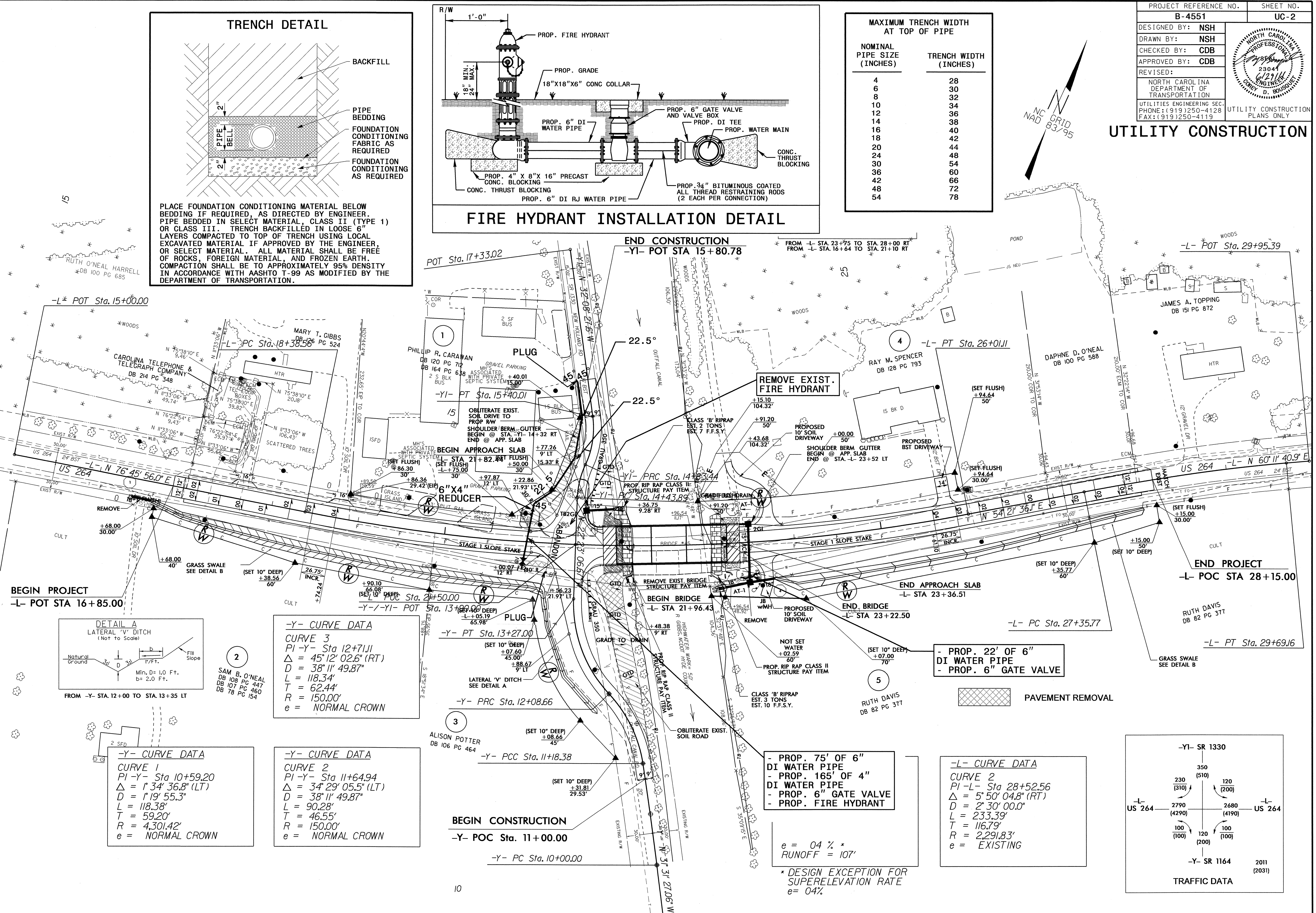
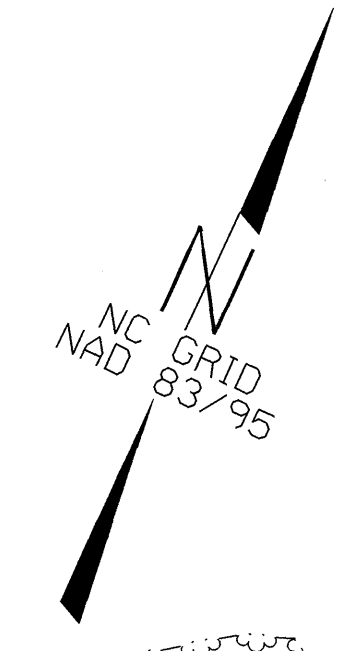

5/14/99

29-JUN-2011 13:59 R:\114-29-JUN-2011\359-...UC02.dgn

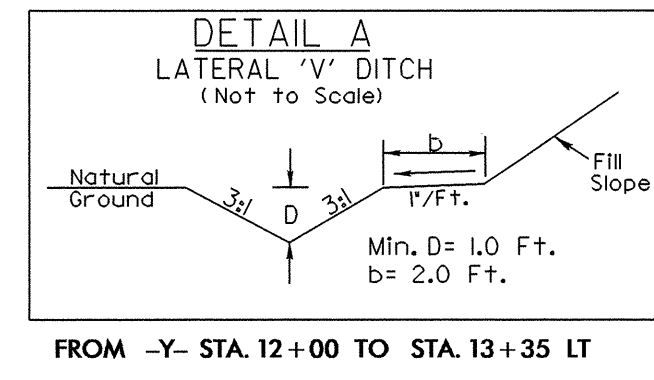

-Y- CURVE DATA

CURVE 3
 PI -Y- Sta 12+71.11
 $\Delta = 45^\circ 12' 02.6''$ (RT)
 $D = 38^\circ 11' 49.87''$
 $L = 118.34'$
 $T = 62.44'$
 $R = 150.00'$
 $e = \text{NORMAL CROWN}$

-Y- CURVE DATA

CURVE 1
 PI -Y- Sta 10+59.20
 $\Delta = 1^\circ 34' 36.8''$ (LT)
 $D = 1^\circ 19' 55.3''$
 $L = 118.38'$
 $T = 59.20'$
 $R = 4,301.42'$
 $e = \text{NORMAL CROWN}$

-Y- CURVE DATA

CURVE 2
 PI -Y- Sta 11+64.94
 $\Delta = 34^\circ 29' 05.5''$ (LT)
 $D = 38^\circ 11' 49.87''$
 $L = 90.28'$
 $T = 46.55'$
 $R = 150.00'$
 $e = \text{NORMAL CROWN}$

PROP. 75' OF 6" DI WATER PIPE
 PROP. 165' OF 4" DI WATER PIPE
 PROP. 6" GATE VALVE
 PROP. FIRE HYDRANT

$e = 04\% \times$
 $RUNOFF = 107'$

* DESIGN EXCEPTION FOR SUPERELEVATION RATE
 $e = 04\%$

-L- CURVE DATA

CURVE 2
 PI -L- Sta 28+52.56
 $\Delta = 5^\circ 50' 04.8''$ (RT)
 $D = 2^\circ 30' 00.0''$
 $L = 233.39'$
 $T = 116.79'$
 $R = 2,291.83'$
 $e = \text{EXISTING}$

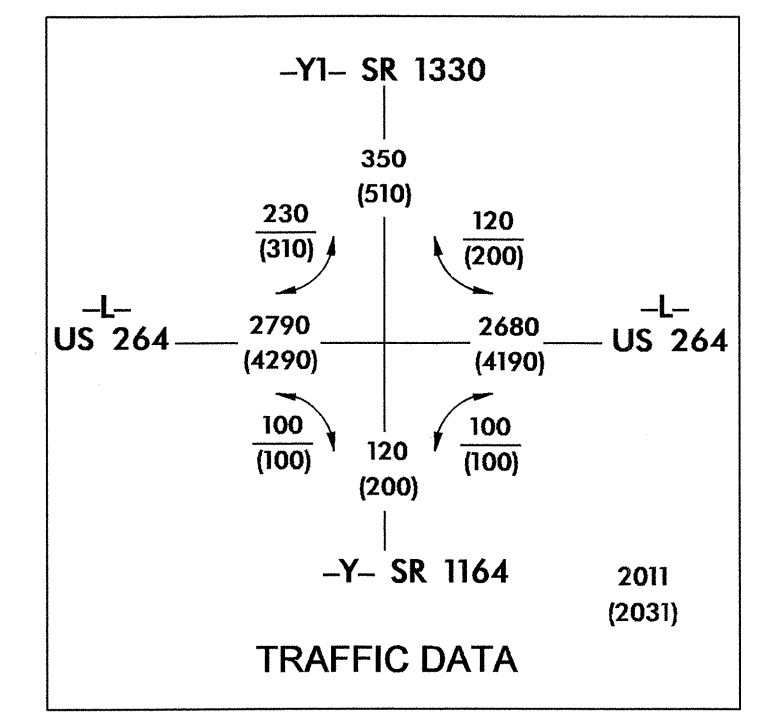

T.I.P. NO.	SHEET NO.
B-4551	UO-1

STATE OF NORTH CAROLINA
DIVISION OF HIGHWAYS

**UTILITIES BY OTHERS PLANS
HYDE COUNTY**

LOCATION: BRIDGE NO. 45 OVER A CANAL ON US 264

TYPE OF WORK: UTILITIES RELOCATION

TIP PROJECT: B-4551

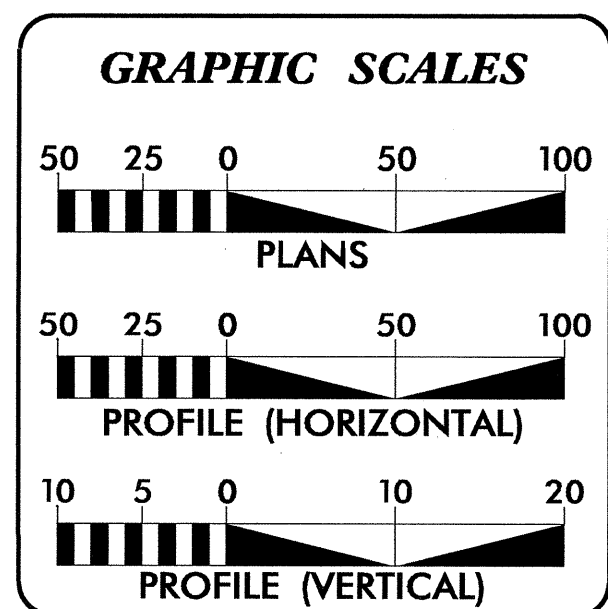
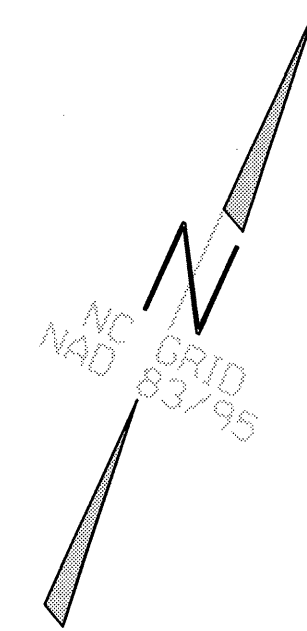
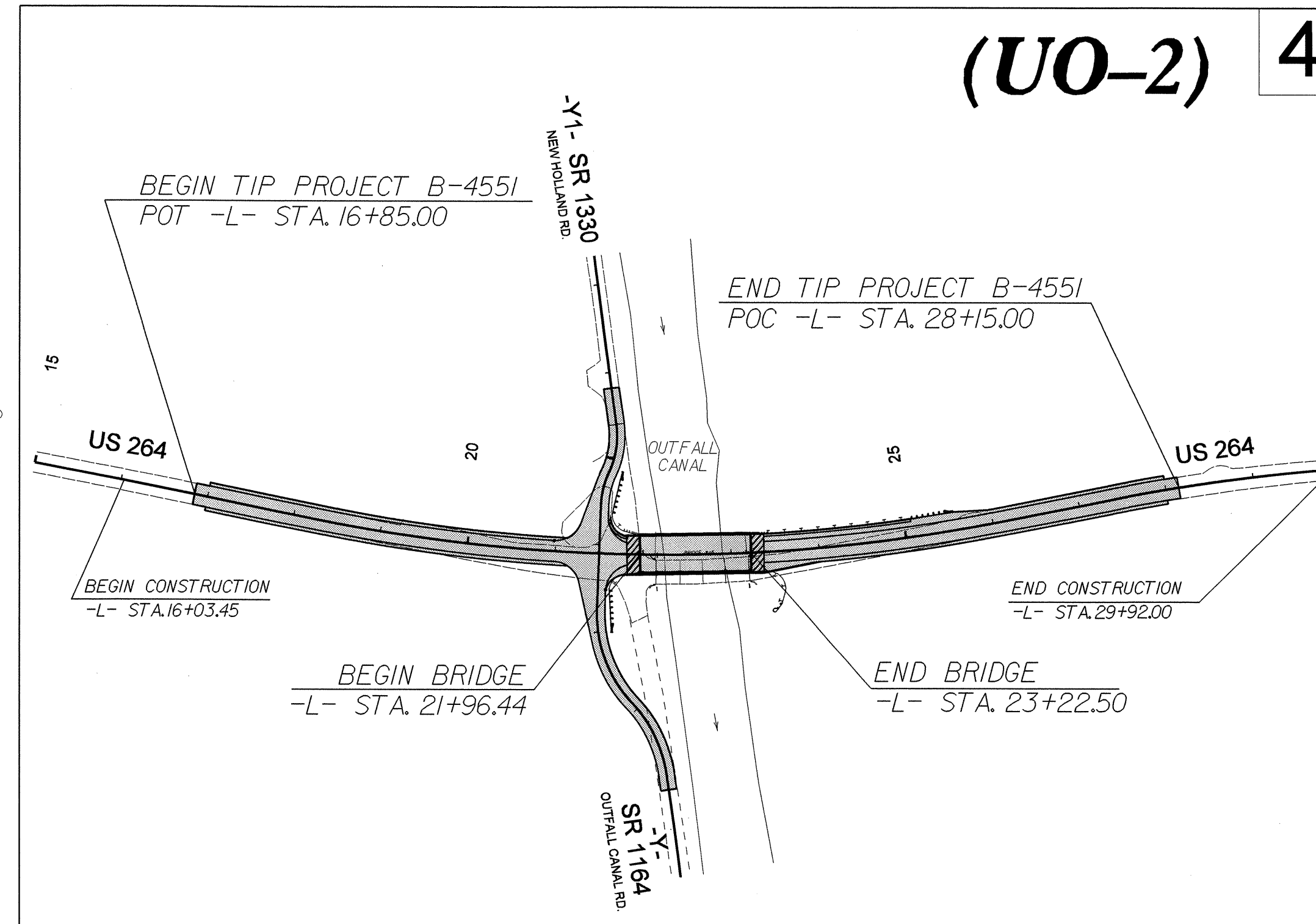
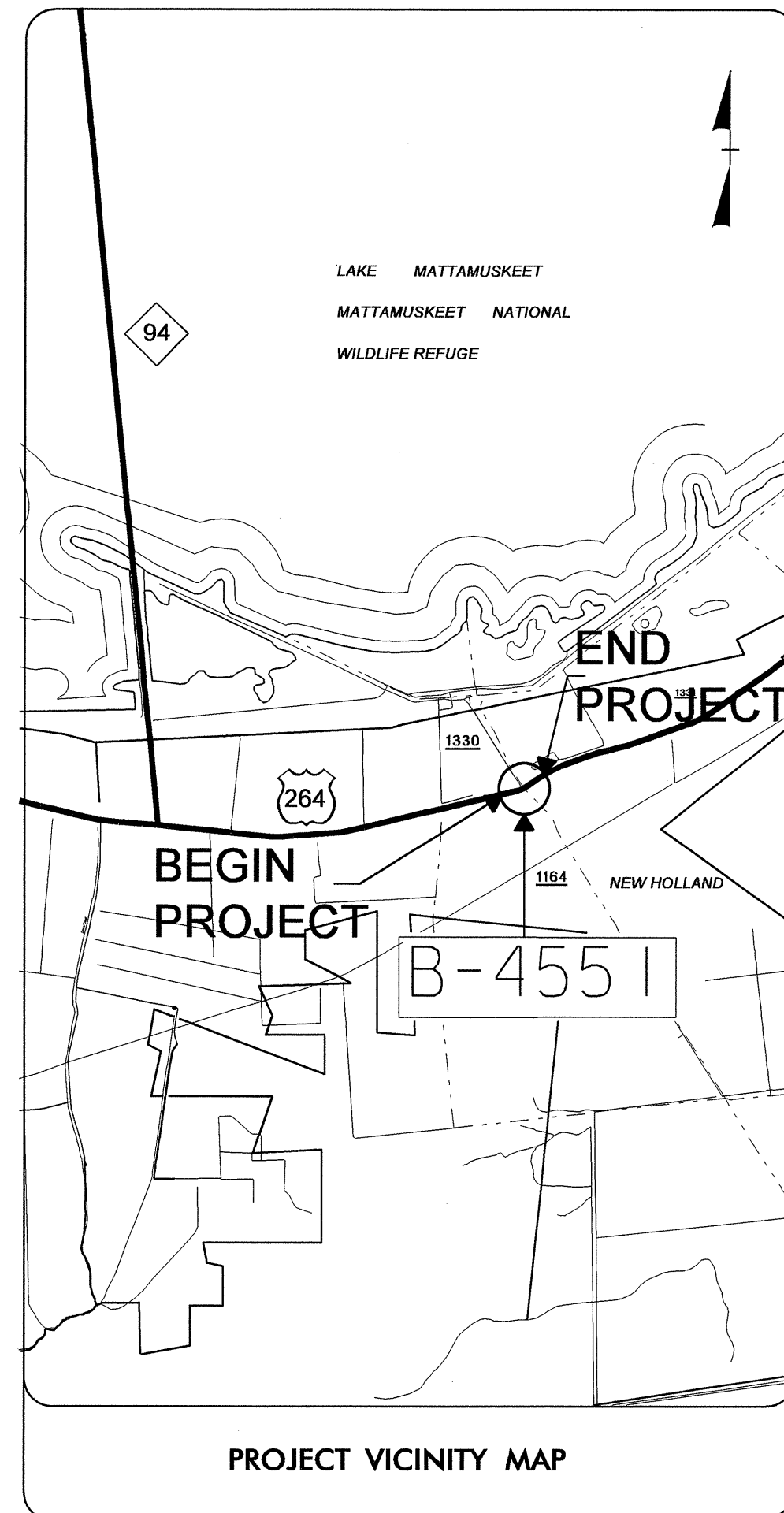

INDEX OF SHEETS	
SHEET NO.	DESCRIPTION
UO-1	TITLE SHEET
UO-2	UTILITY BY OTHERS PLAN SHEET

UTILITY OWNERS ON PROJECT
(1) TIDELAND EMC - (POWER)
(2) CENTURYLINK - (TELEPHONE)

DEPARTMENT OF TRANSPORTATION

PREPARED IN THE OFFICE OF:
**DIVISION OF HIGHWAYS
UTILITIES ENGINEERING
SECTION**

1591 MAIL SERVICES CENTER
RALEIGH NC 27699-1591
PHONE (919) 250-4128
FAX (919) 250-4119

Roger Worthington, P.E. UTILITIES SECTION ENGINEER
Corey Bousquet, P.E. UTILITIES SQUAD LEADER PROJECT ENGINEER
Nabil Hamdan UTILITIES PROJECT DESIGNER

09/08/99
29-JUN-2011 11:49
R:\Utilities\RDY-Ut\Proj\B4551\RDY-t.sh.dgn
\$\$\$\$\$USERNAME\$\$\$\$\$

UTILITIES BY OTHERS

NOTE:
ALL PROPOSED UTILITY WORK SHOWN ON THIS SHEET WILL BE DONE BY OTHERS

-YI- CURVE DATA
CURVE 1
 PI -YI- Sta 14+63.93
 $\Delta = 22^{\circ} 39' 32.5''$ (RT)
 $D = 57^{\circ} 17' 44.8''$
 $L = 39.55'$
 $T = 20.04'$
 $R = 100.00'$
 $e = \text{NORMAL CROWN}$

-YI- CURVE DATA
CURVE 2
 PI -YI- Sta 15+12.51
 $\Delta = 32^{\circ} 24' 53.5''$ (LT)
 $D = 57^{\circ} 17' 44.8''$
 $L = 56.57'$
 $T = 29.07'$
 $R = 100.00'$
 $e = \text{NORMAL CROWN}$

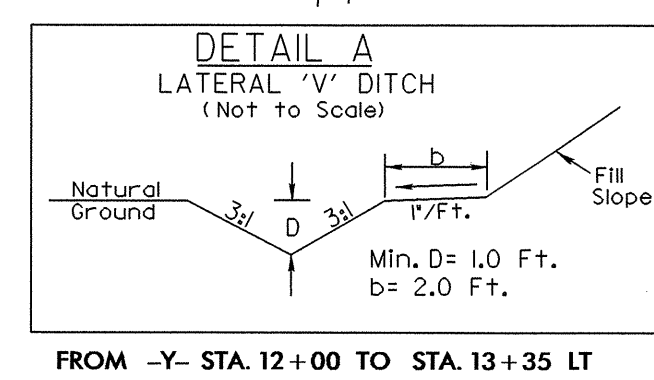
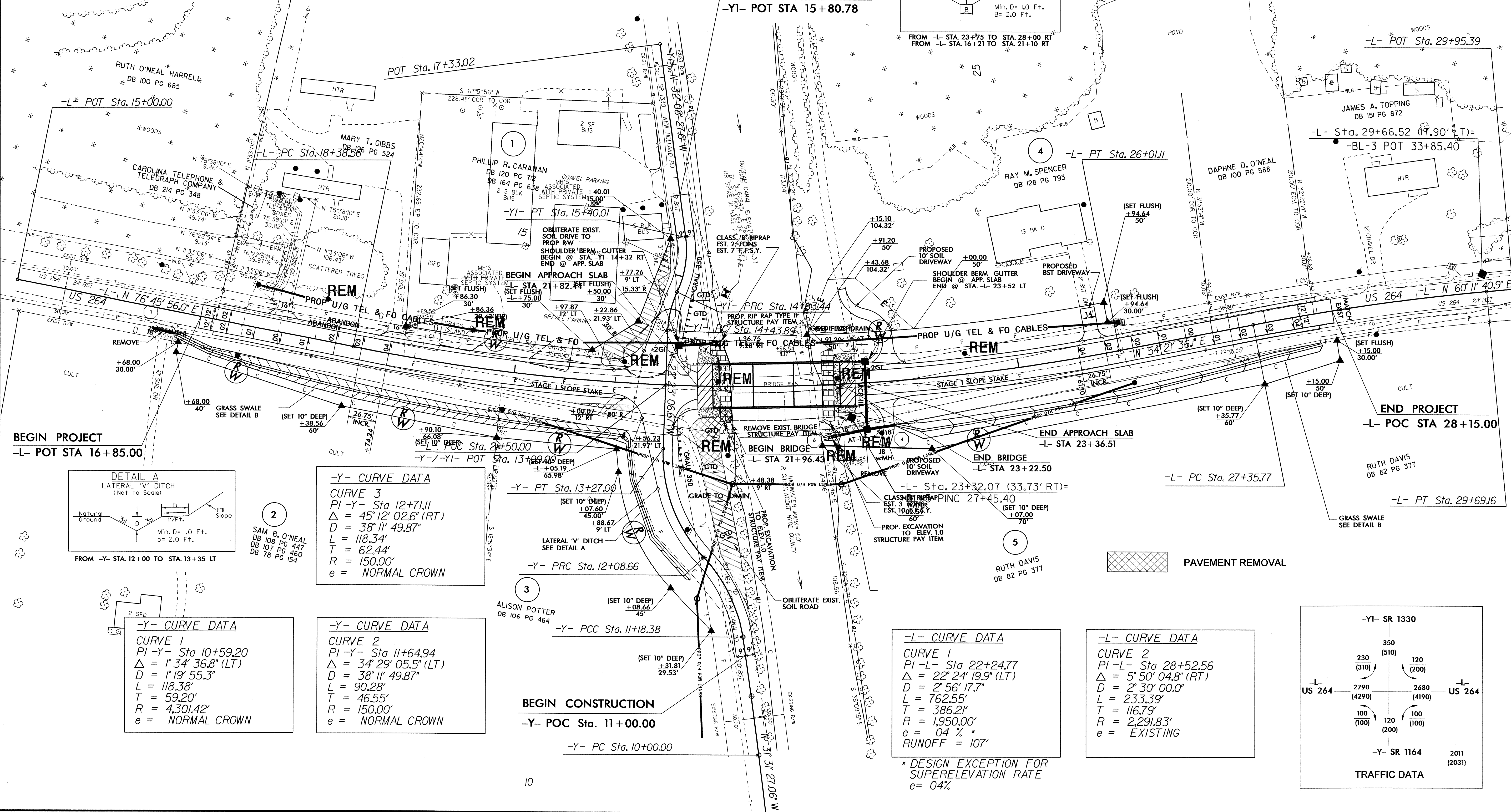
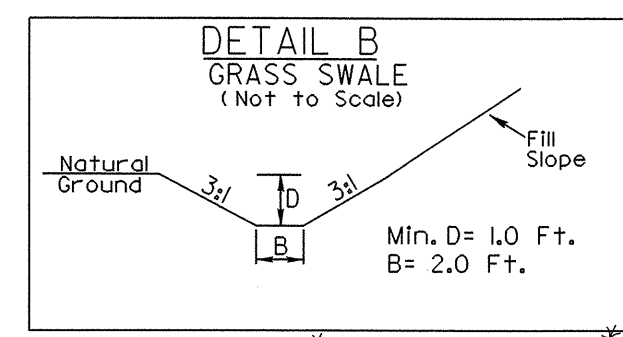
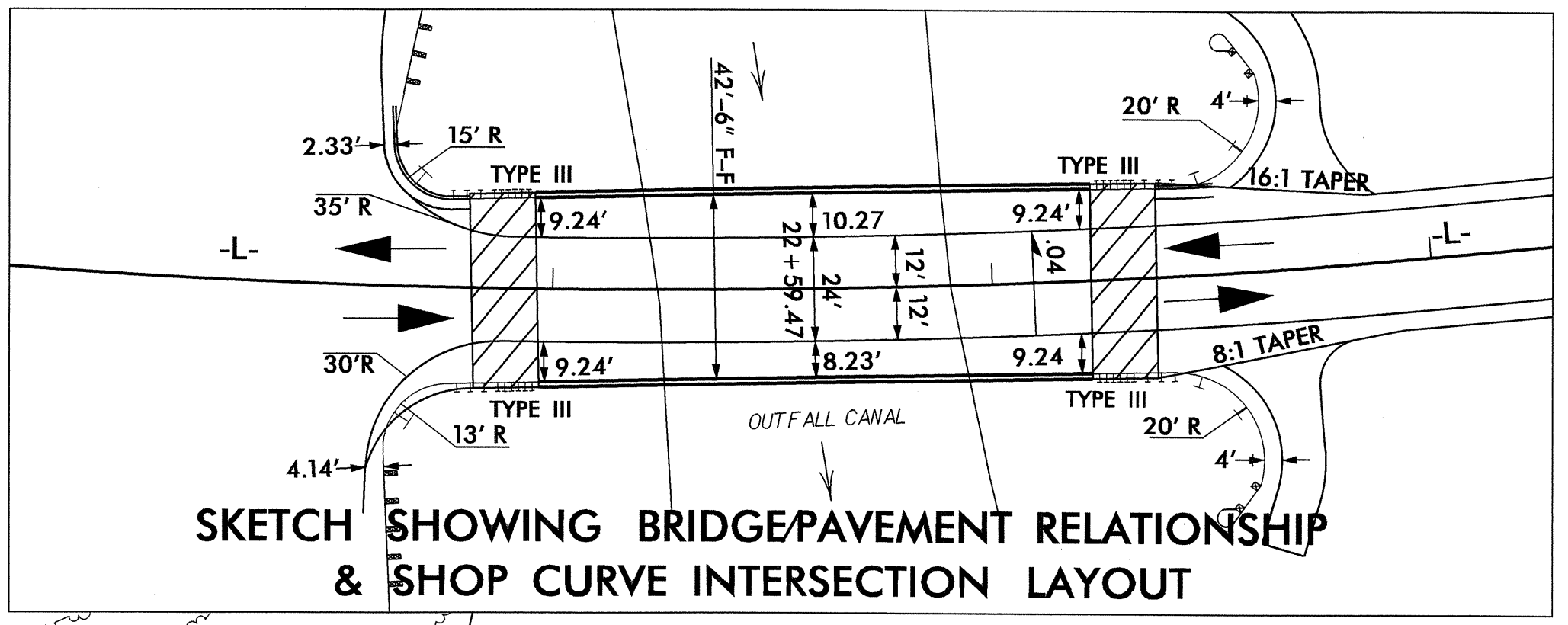

-Y- CURVE DATA
CURVE 3
 PI -Y- Sta 12+71.11
 $\Delta = 45^{\circ} 12' 02.6''$ (RT)
 $D = 38^{\circ} 11' 49.8''$
 $L = 118.34'$
 $T = 62.44'$
 $R = 150.00'$
 $e = \text{NORMAL CROWN}$

-Y- CURVE DATA
CURVE 1
 PI -Y- Sta 10+59.20
 $\Delta = 1^{\circ} 34' 36.8''$ (LT)
 $D = 1^{\circ} 19' 55.3''$
 $L = 118.38'$
 $T = 59.20'$
 $R = 4,301.42'$
 $e = \text{NORMAL CROWN}$

-Y- CURVE DATA
CURVE 2
 PI -Y- Sta 11+64.94
 $\Delta = 34^{\circ} 29' 05.5''$ (LT)
 $D = 38^{\circ} 11' 49.8''$
 $L = 90.28'$
 $T = 46.55'$
 $R = 150.00'$
 $e = \text{NORMAL CROWN}$

-L- CURVE DATA
CURVE 1
 PI -L- Sta 22+24.77
 $\Delta = 22^{\circ} 24' 19.9''$ (LT)
 $D = 2^{\circ} 56' 17.7''$
 $L = 762.55'$
 $T = 386.21'$
 $R = 1,950.00'$
 $e = 0.4\%$
 $\text{RUNOFF} = 107'$

-L- CURVE DATA
CURVE 2
 PI -L- Sta 28+52.56
 $\Delta = 5^{\circ} 50' 04.8''$ (RT)
 $D = 2^{\circ} 30' 00.0''$
 $L = 233.39'$
 $T = 116.79'$
 $R = 2,291.83'$
 $e = \text{EXISTING}$

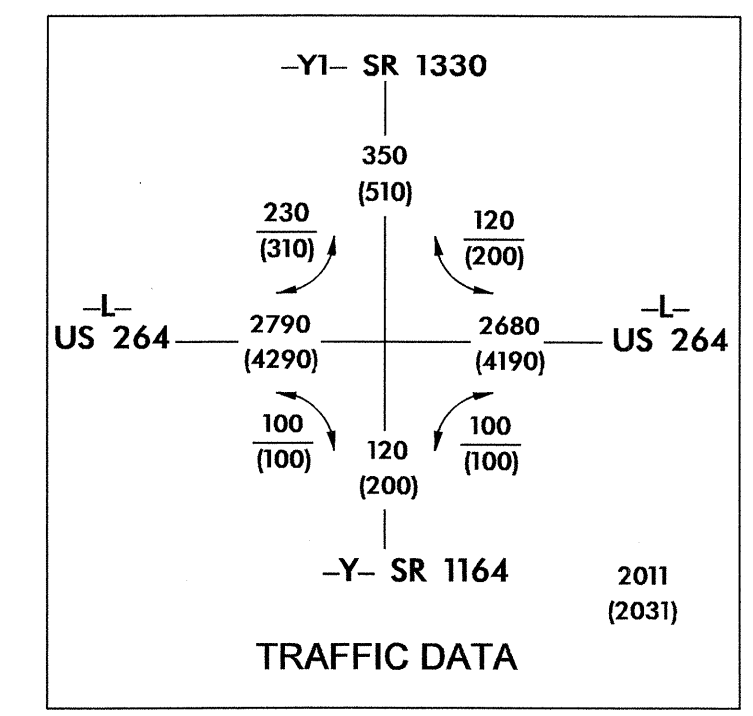

* DESIGN EXCEPTION FOR SUPERELEVATION RATE $e = 0.4\%$

5/14/99
R:\u1128-JUN-20\11519\B4551-rdy-psh-U002.dgn