

TIP PROJECT: B-4522

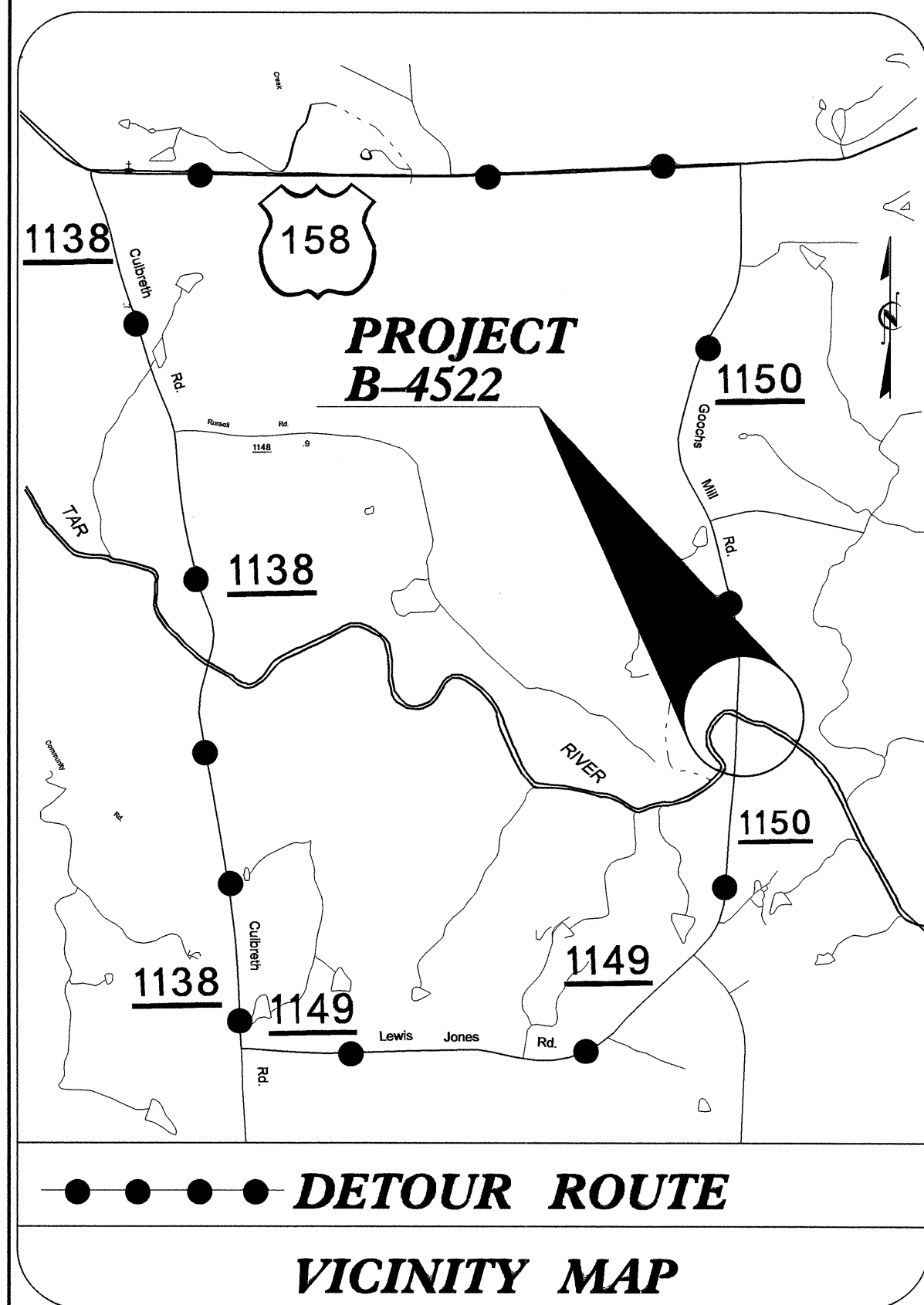

STATE OF NORTH CAROLINA
DIVISION OF HIGHWAYS

**UTILITIES BY OTHERS PLANS
GRANVILLE COUNTY**

LOCATION: BRIDGE 102 OVER THE TAR RIVER ON SR 1150
TYPE OF WORK: UTILITY RELOCATION

T.I.P. NO.	SHEET NO.
B-4522	UO-1

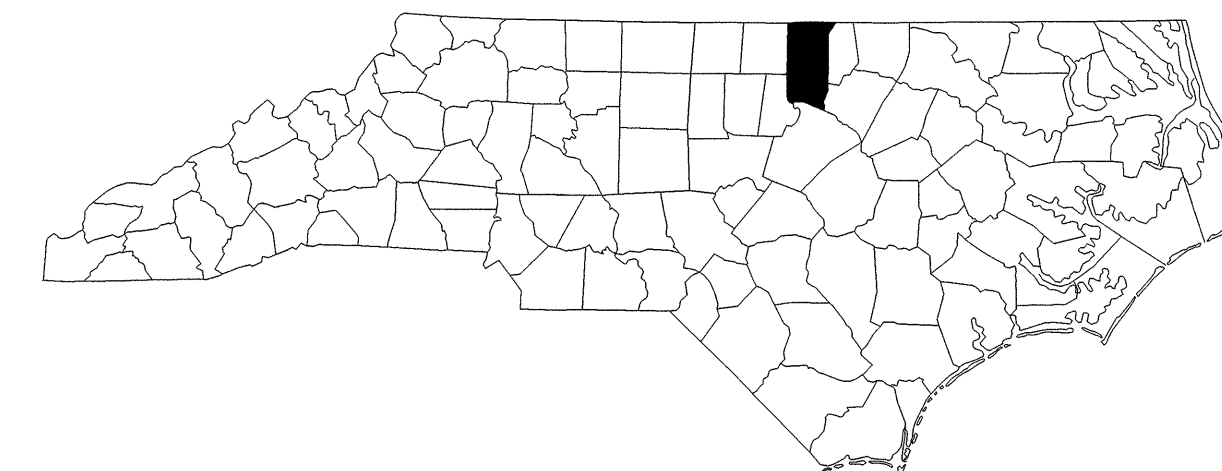
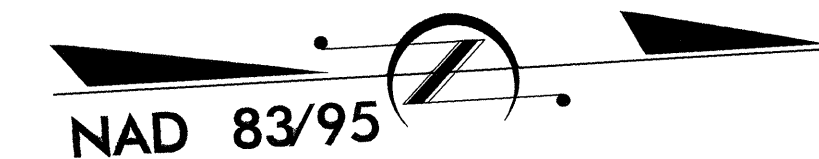

**-L- STA 13+75.00 BEGIN
TIP PROJECT B-4522**

TO SR 1138

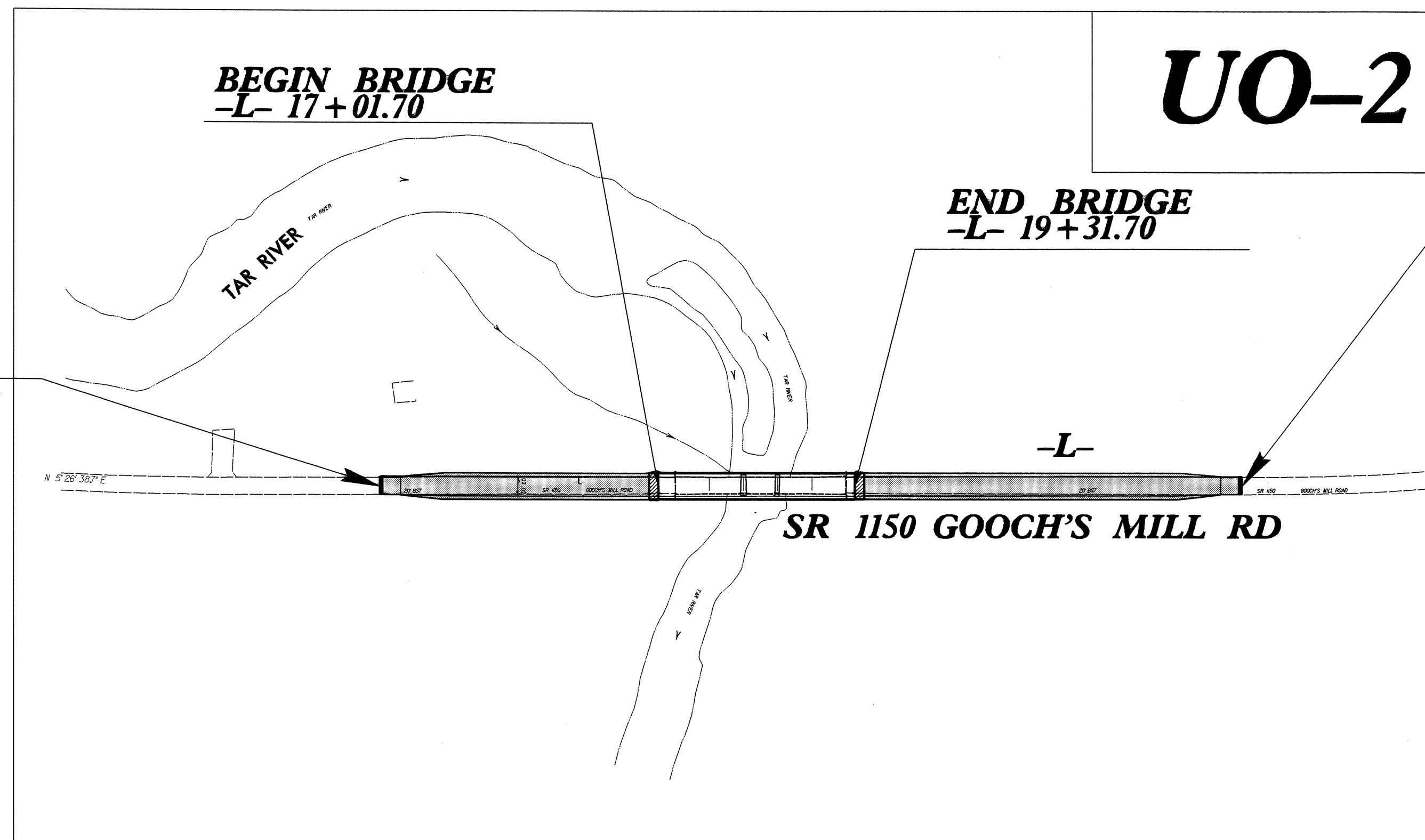

THERE IS NO CONTROL OF ACCESS ON THIS PROJECT.

THIS PROJECT IS NOT WITHIN ANY MUNICIPAL BOUNDARIES

CLEARING ON THIS PROJECT SHALL BE PERFORMED TO THE LIMITS ESTABLISHED BY METHOD III.

CONTRACT:

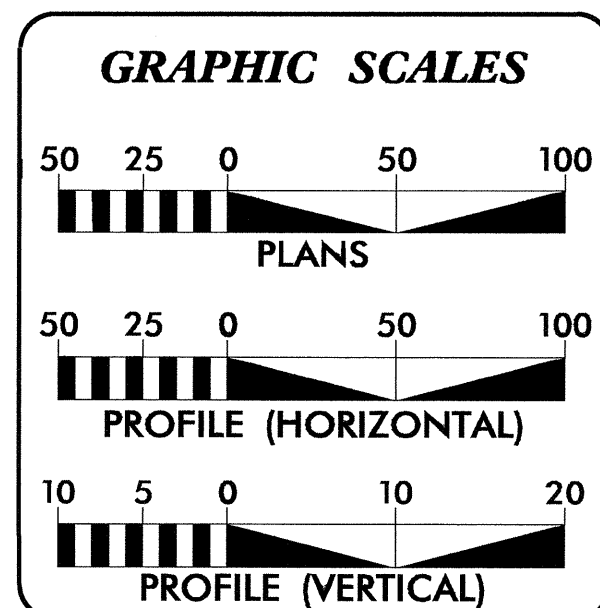

SHEET NO.	DESCRIPTION
UO-1	TITLE SHEET
UO-2	UTILITY BY OTHERS PLAN SHEET

UTILITY OWNERS ON PROJECT
(1) TELEPHONE - EMBARQ

PREPARED IN THE OFFICE OF:
**DIVISION OF HIGHWAYS
UTILITIES UNIT**

1555 MAIL SERVICES CENTER
RALEIGH NC 27699-1555
PHONE (919) 250-4128
FAX (919) 250-4119

Roger Worthington, P.E. UTILITIES SECTION ENGINEER
Steve McKee, P.E. UTILITIES SQUAD LEADER PROJECT ENGINEER
Donald Proper UTILITIES PROJECT DESIGNER

UTILITIES BY OTHERS

NOTE:
ALL PROPOSED UTILITY WORK
SHOWN ON THIS SHEET WILL
BE DONE BY OTHERS

25

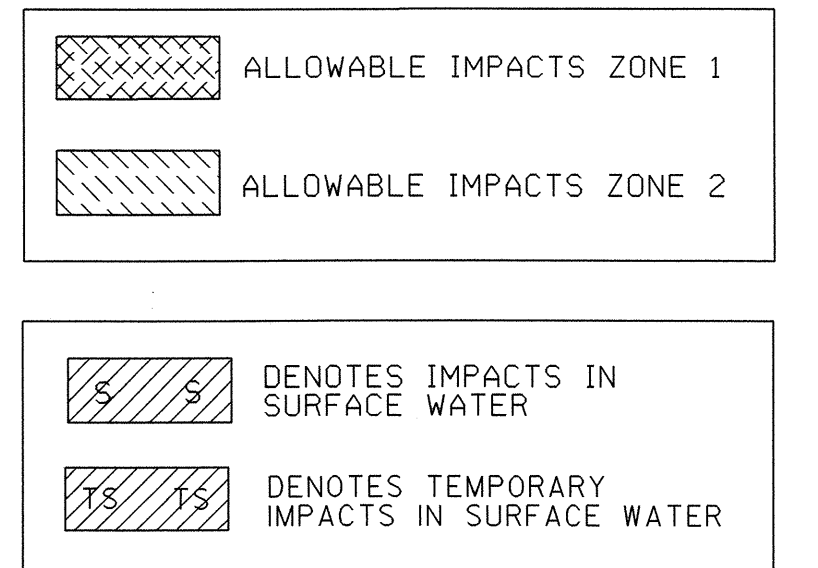

-L-	
PI Sta 11+10.36	PI Sta 25+73.69
Δ = 2° 05' 33.3" (LT)	Δ = 7° 29' 05.3" (LT)
D = 1° 26' 47.3"	D = 2° 44' 36.8"
L = 144.67'	L = 272.81'
T = 72.34'	T = 136.60'
R = 3,961.08'	R = 2,088.37'

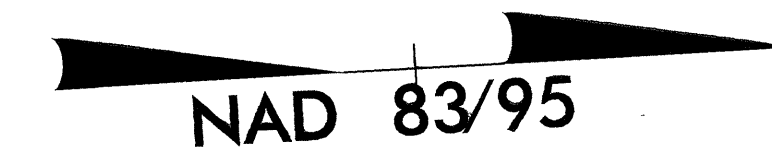

SITE 1

NOTE: TEMPORARY
CAUSEWAYS ARE NOT
TO BE INSTALLED IN THE
STREAM AT THE SAME TIME.

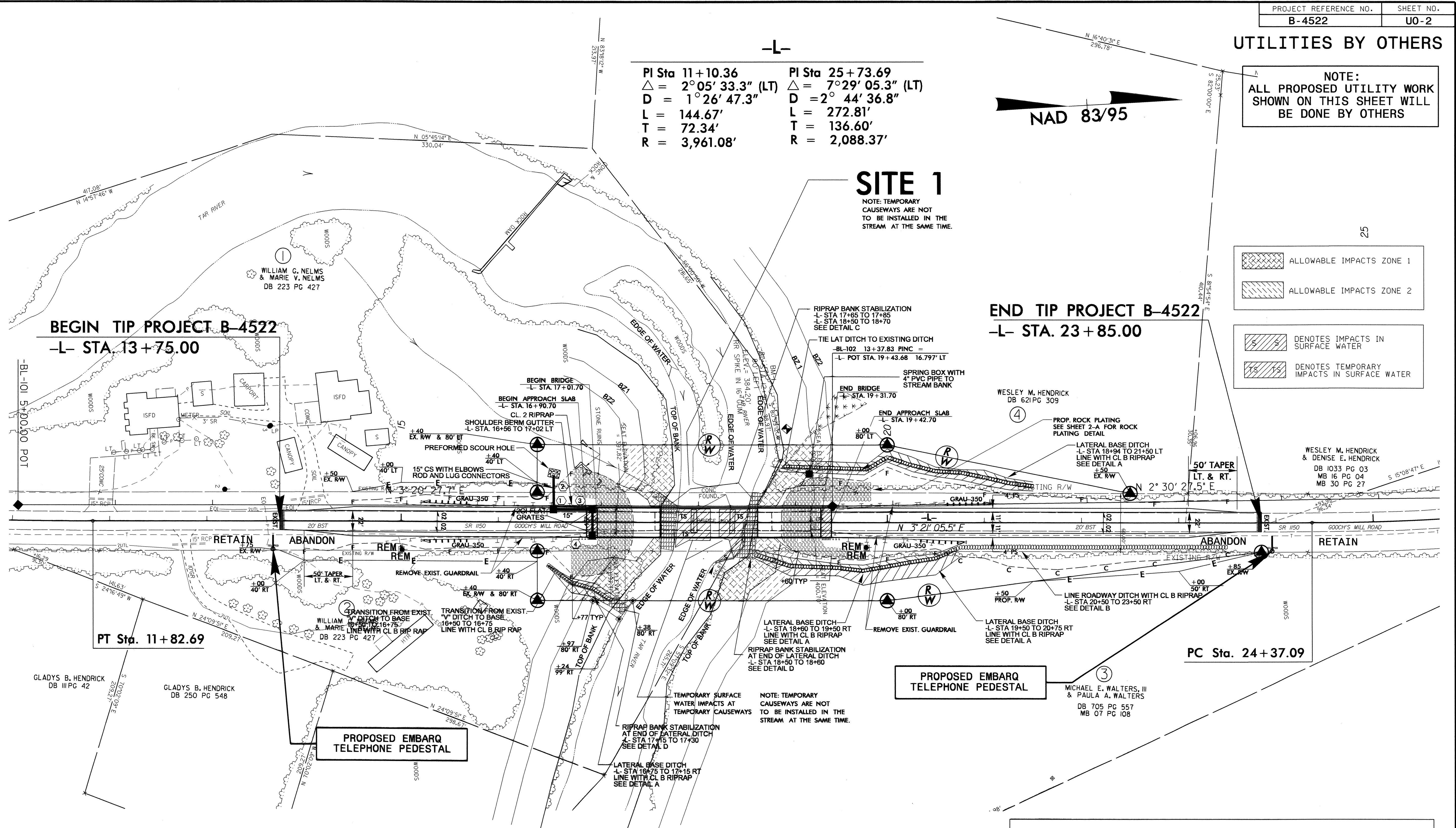

BEGIN TIP PROJECT B-4522
-L- STA. 13+75.00

END TIP PROJECT B-4522
-L- STA. 23+85.00

GLADYS B. HENDRICK
DB III PG 42

GLADYS B. HENDRICK
DB 250 PG 548

**PROPOSED EMBARQ
TELEPHONE PEDESTAL**

**PROPOSED EMBARQ
TELEPHONE PEDESTAL**

MICHAEL E. WALTERS, III
& PAULA A. WALTERS
DB 705 PG 557
MB 07 PG 108

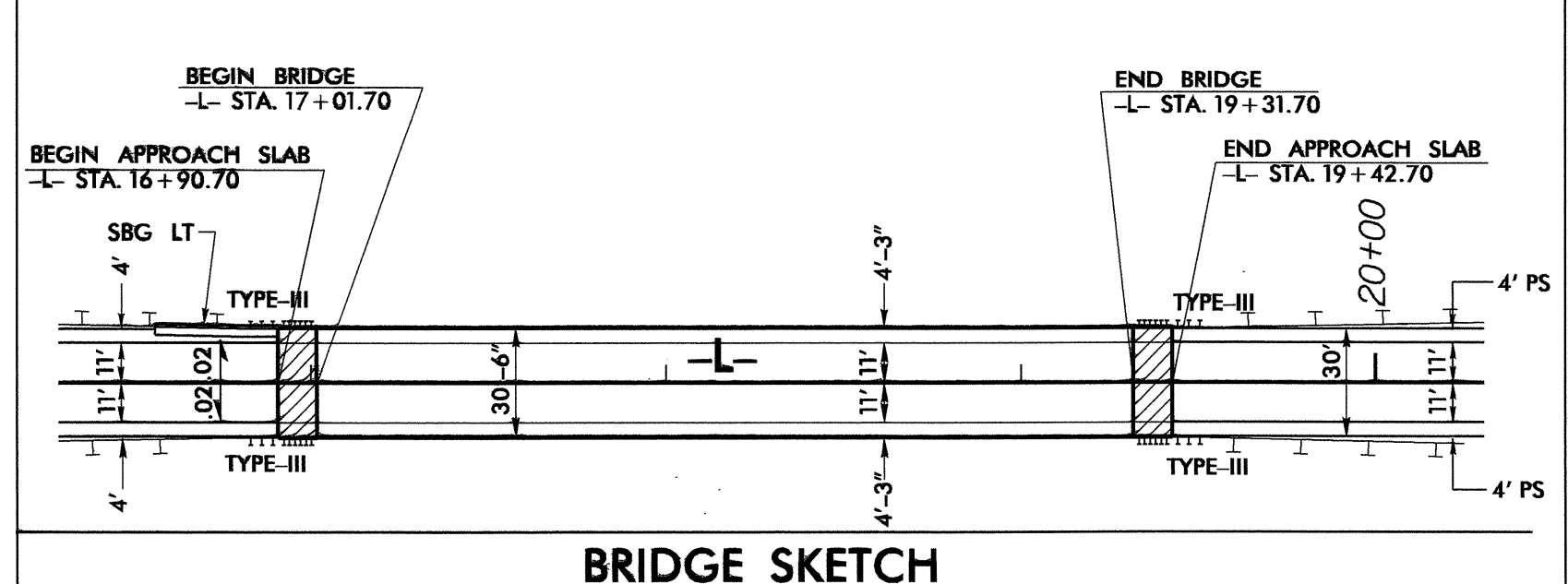
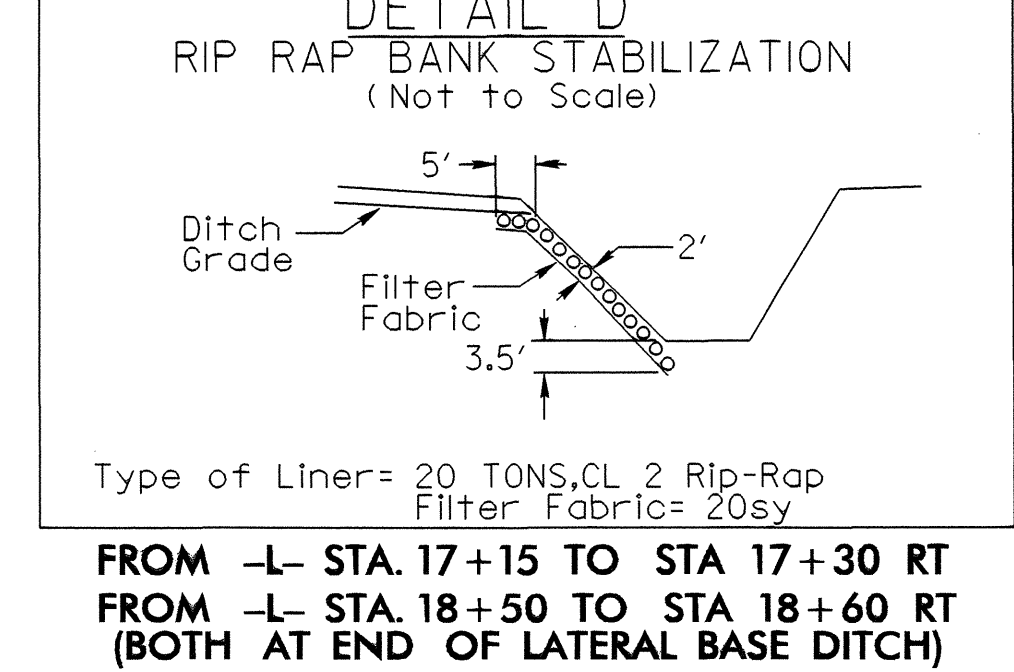
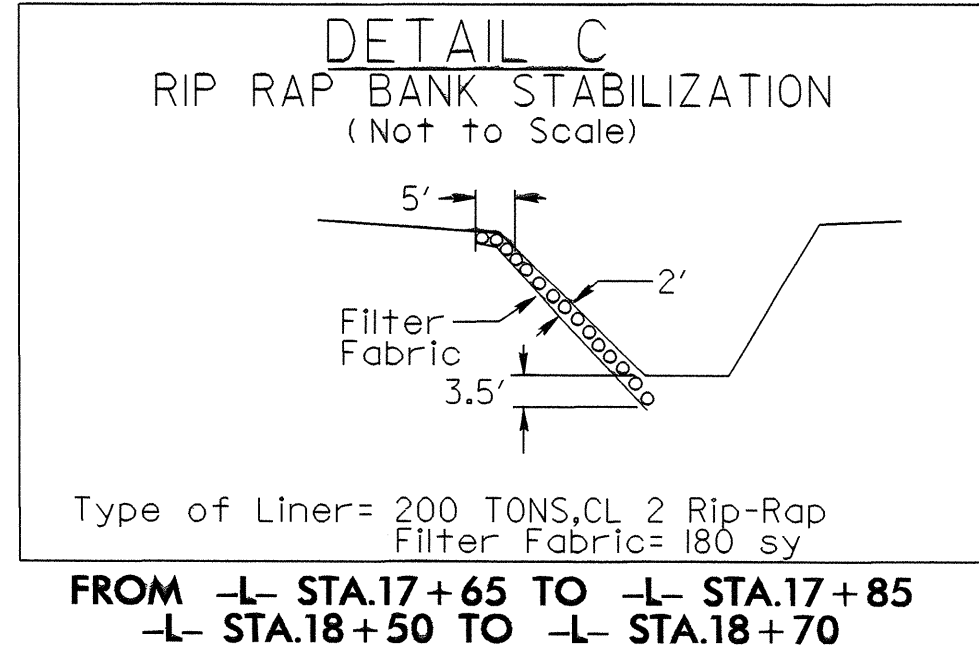
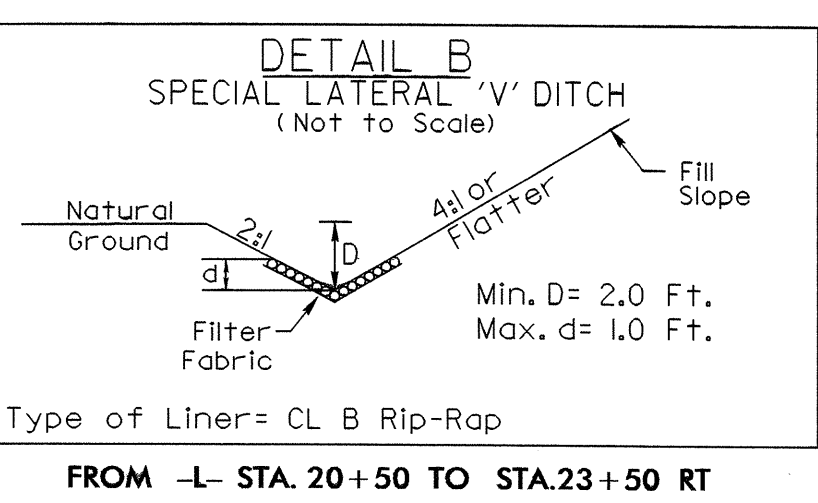
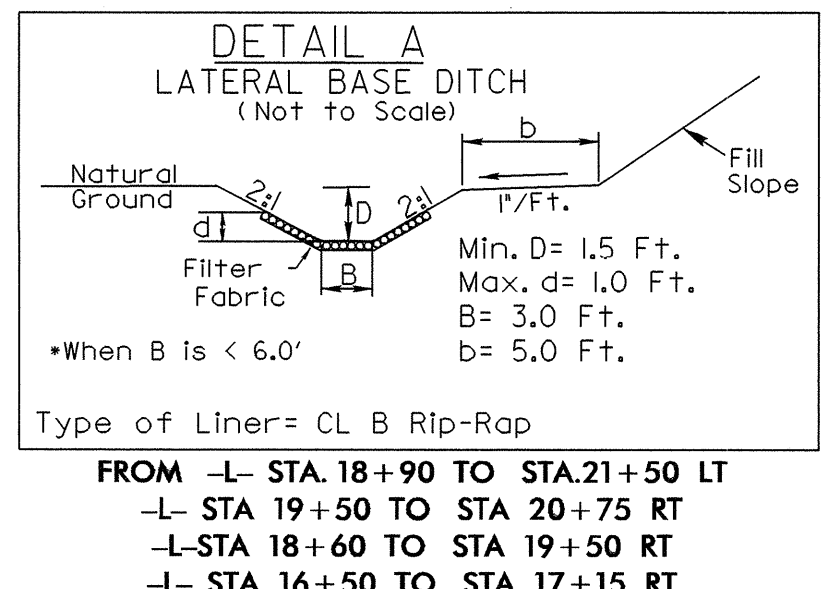

5/14/99
23-NOV-2010 14:39
R:\11-11-00\B-4522\01\B-4522-01.dgn
PROJECT: B-4522