

STATE OF NORTH CAROLINA
DIVISION OF HIGHWAYS

TRANSPORTATION MANAGEMENT PLAN

HAYWOOD COUNTY

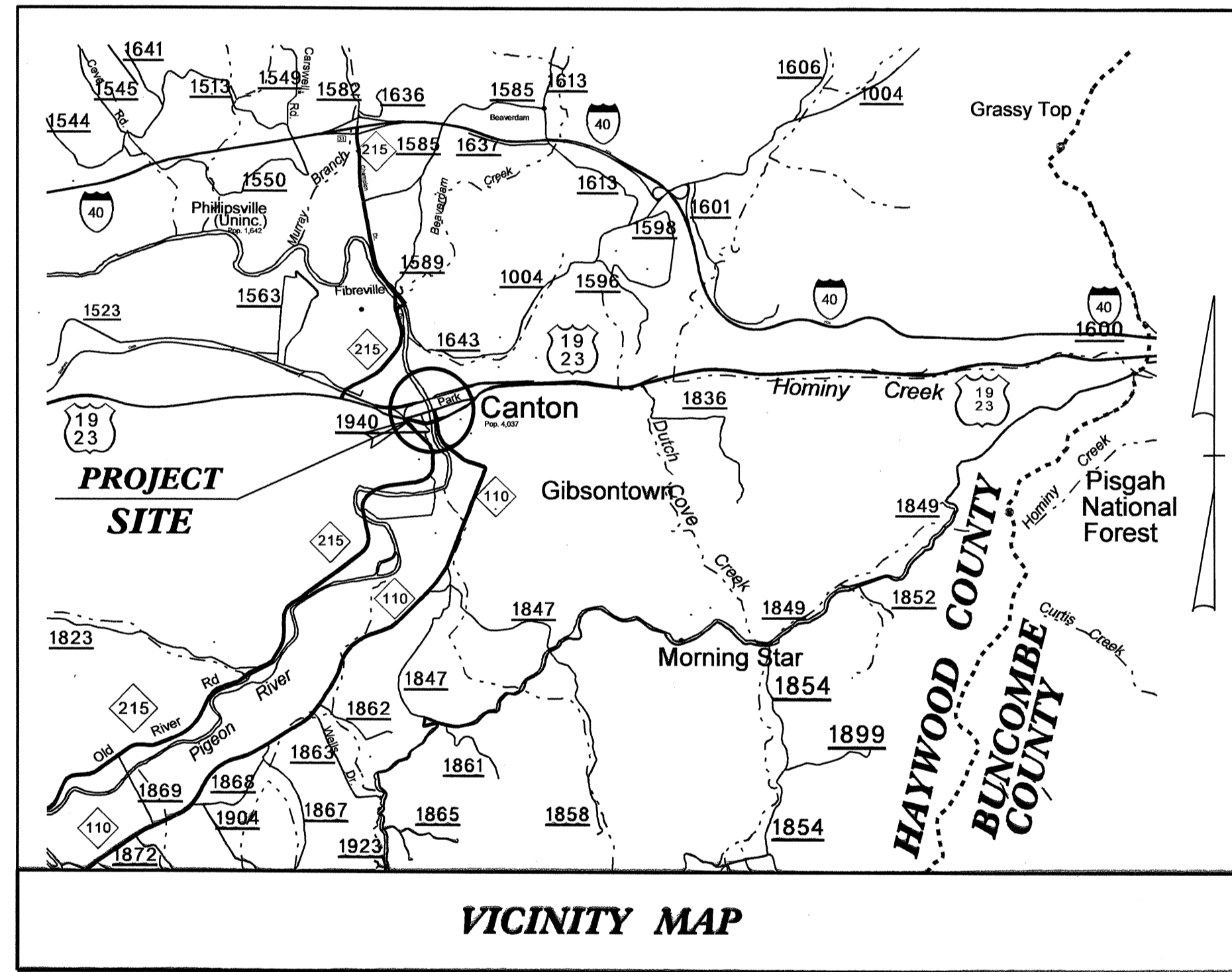
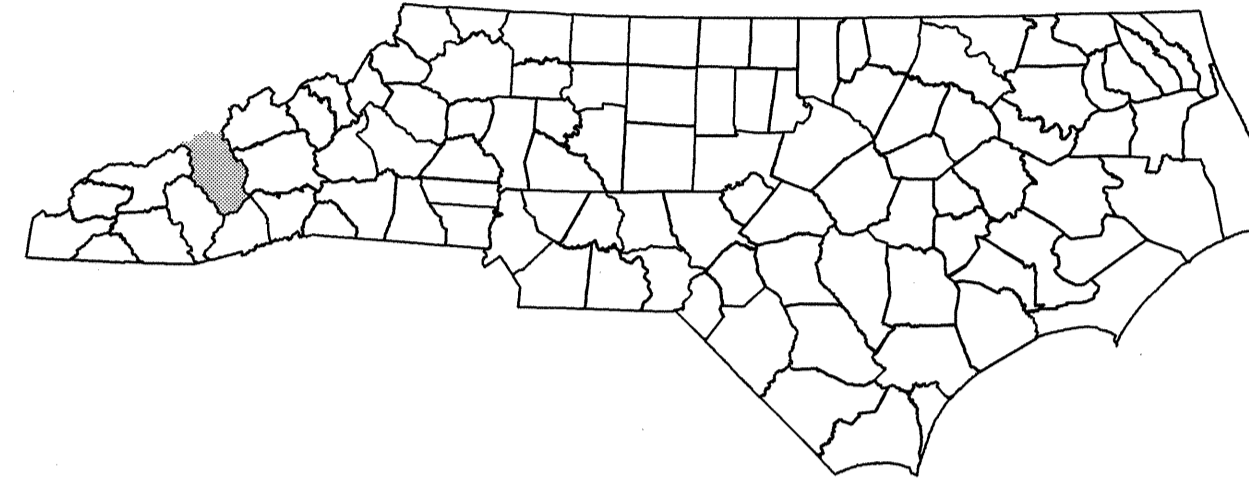

THIS PROJECT IS WITHIN THE MUNICIPAL BOUNDARIES OF THE TOWN OF CANTON

INDEX OF SHEETS

SHEET NO.	TITLE
TMP-1	TITLE SHEET, AND INDEX OF SHEETS
TMP-1A	LIST OF APPLICABLE ROADWAY STANDARD DRAWINGS, LEGEND, AND TEMPORARY PAVEMENT MARKING LEGEND
TMP-1B, TMP-1C	TRANSPORTATION OPERATIONS AND GENERAL NOTES
TMP-2A	SPECIAL SIGN DESIGN
TMP-3	PHASING
TMP-4 THRU TMP-6	PHASE I DETAILS
TMP-7, TMP-8	PHASE II DETAILS
TMP-9	NC 215 DETOUR ROUTES

SHEET NO.
TMP-1

B-3656

TIP PROJECT:

23-AUG-2010 06:48
\\dot\dfsroot\01\Proj\TIPPr-jects-B\B3656\Traffic\TrafficControl\TCP\B-3656_TC_TMP-1.dgn
KBroadwell AT WZTC237451

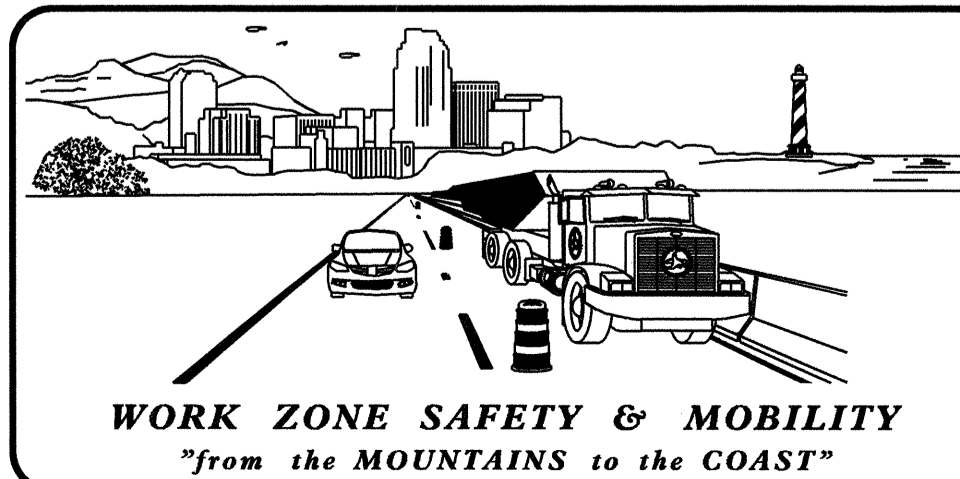

N.C.D.O.T. WORK ZONE TRAFFIC CONTROL
1580 MAIL SERVICE CENTER (MSC) RALEIGH, NC 27699-1580
1020 BIRCH RIDGE DRIVE, RALEIGH, NC 27610 (DELIVERY)
PHONE: (919) 250-4094 FAX: (919) 250-4098

J. S. BOURNE, P.E. STATE TRAFFIC MANAGEMENT ENGINEER
G. L. GETTIER, P.E. TRAFFIC CONTROL PROJECT ENGINEER
J. W. GILSTRAP TRAFFIC CONTROL PROJECT DESIGN ENGINEER
KEN BROADWELL TRAFFIC CONTROL DESIGN ENGINEER



APPROVED: _____
DATE: _____

SEAL

ROADWAY STANDARD DRAWINGS

THE FOLLOWING ROADWAY STANDARDS AS SHOWN IN "ROADWAY STANDARD DRAWINGS" - PROJECT SERVICES UNIT - N.C. DEPARTMENT OF TRANSPORTATION - RALEIGH, N.C., DATED JULY 2006 ARE APPLICABLE TO THIS PROJECT AND BY REFERENCE HEREBY ARE CONSIDERED A PART OF THESE PLANS:

STD. NO.	TITLE
1101.02	TEMPORARY LANE CLOSURES
1101.03	TEMPORARY ROAD CLOSURES
1101.04	TEMPORARY SHOULDER CLOSURES
1101.05	WORK ZONE VEHICLE ACCESSES
1101.11	TRAFFIC CONTROL DESIGN TABLES
1110.01	STATIONARY WORK ZONE SIGNS
1110.02	PORTABLE WORK ZONE SIGNS
1115.01	FLASHING ARROW PANELS
1130.01	DRUMS
1135.01	CONES
1145.01	BARRICADES
1150.01	FLAGGING DEVICES
1165.01	TRUCK MOUNTED IMPACT ATTENUATOR
1180.01	SKINNY-DRUM
1205.01	PAVEMENT MARKINGS - LINE TYPES & OFFSETS
1205.02	PAVEMENT MARKINGS - 2 LANE & MULTILANE ROADWAYS
1205.04	PAVEMENT MARKINGS - INTERSECTIONS
1205.05	PAVEMENT MARKINGS - TURN LANES
1205.06	PAVEMENT MARKINGS - THRU LANE DROPS
1205.07	PAVEMENT MARKINGS - PEDESTRIAN CROSSWALKS
1205.08	PAVEMENT MARKINGS - SYMBOLS & WORD MESSAGES
1250.01	PAVEMENT MARKER SPACING
1251.01	RAISED PAVEMENT MARKERS - (TEMPORARY & PERMANENT)

LEGEND

GENERAL

- DIRECTION OF TRAFFIC FLOW
- EXIST. PVMT.
- NORTH ARROW
- PROPOSED PVMT.
- WORK AREA
- REMOVAL

TRAFFIC CONTROL DEVICES

- BARRICADE (TYPE III)
- CONE
- DRUM SKINNY DRUM TUBULAR MARKER
- TEMPORARY CRASH CUSHION
- FLASHING ARROW PANEL (TYPE C)
- FLAGGER
- LAW ENFORCEMENT
- TRUCK MOUNTED IMPACT ATTENUATOR (TMIA)
- CHANGEABLE MESSAGE SIGN

TEMPORARY SIGNING

- PORTABLE SIGN
- STATIONARY SIGN
- STATIONARY OR PORTABLE SIGN

SIGNALS

- EXISTING
- MOD - MODIFIED
- OFF - TURNED OFF OR COVERED

TEMPORARY PAVEMENT MARKING

PAINT	
PA	WHITE EDGELINE (4")
PB	YELLOW EDGE LINE (4")
PD	2 FT. WHITE MINISKIP (4")
PE	WHITE SOLID LANE LINE (4")
PI	YELLOW DOUBLE CENTER (4")
PX	WHITE CROSSWALK (8")
PS	WHITE CROSSWALK (24")
P4	WHITE STOPBAR (24")
QA	↶ (LEFT ARROW)
QB	↷ (RIGHT ARROW)
QC	→ (STRAIGHT ARROW)
QD	↷ (COMBO STRAIGHT/RIGHT ARROW)
QE	↶ (COMBO STRAIGHT/LEFT ARROW)
QF	↷ (COMBO LEFT/RIGHT ARROW)
QG	↷ (COMBO STRAIGHT/LEFT/RIGHT ARROW)
QM	▲ YIELD LINE ("SHARKS TEETH")
SI	ONLY (ALPHANUMERIC CHARACTER)

23-AUG-2010 06:47
 \\dot\afs\00101\PrCo\TIPPr\jects-B\3656\Tr\offic\Tr\offic\Control\TCP\B-3656-TC-TMP-1.dgn
 Kbroodwell AT WZTC237451

APPROVED:	DATE:			ROADWAY STANDARD DRAWINGS & LEGEND
	23-Aug-10			

TRANSPORTATION OPERATIONS

CONSTRUCTION

UTILIZE MAIN STREET AS AN OFF-SITE DETOUR TO REMOVE & REPLACE EXISTING BRIDGE NO. 419 AND APPROACHES ON PARK STREET.

CONSTRUCT PARK STREET & PENLAND STREET AND REALIGN SORRELLS STREET.

TMP DESIGN PARAMETERS

CONSTRUCT TEMPORARY DETOUR (SORRELLS STREET) FOR A ONE-WAY TRAFFIC PATTERN.

MODIFY/REVISE/DEACTIVATE EXISTING TRAFFIC SIGNALS ON MAIN STREET FOR A TWO-LANE, TWO-WAY TRAFFIC PATTERN.

CHANGE EXISTING PAVEMENT MARKINGS & MARKERS ON MAIN STREET FOR A TWO-LANE, TWO-WAY TRAFFIC PATTERN AND A ONE-WAY TRAFFIC PATTERN ON REED STREET.

INSTALL TUBULAR MAKERS AND DETOUR SIGNS FOR NEW TEMPORARY TRAFFIC PATTERNS ON MAIN STREET, PARK STREET, REED STREET AND DETOUR (SORRELLS STREET).

REDIRECT "ALL TRUCK TRAFFIC 3 AXLES OR MORE" SOUTH OF CANTON FROM NC 215 NORTH TO UTILIZE NC 110 NORTH (SEE TMP-9).

GENERAL NOTES

CHANGES MAY BE REQUIRED WHEN PHYSICAL DIMENSIONS IN THE DETAIL DRAWINGS, STANDARD DETAILS AND ROADWAY DETAILS ARE NOT ATTAINABLE TO MEET FIELD CONDITIONS, OR RESULT IN DUPLICATE, OR UNDESIRABLE OVERLAPPING OF DEVICES. MODIFICATION MAY INCLUDE: MOVING, SUPPLEMENTING, COVERING OR REMOVAL OF DEVICES, AS DIRECTED BY THE ENGINEER.

THE FOLLOWING GENERAL NOTES APPLY AT ALL TIMES FOR THE DURATION OF THE CONSTRUCTION PROJECT EXCEPT WHEN OTHERWISE NOTED IN THE PLAN OR AS DIRECTED BY THE ENGINEER.

TIME RESTRICTIONS

A) DO NOT CONDUCT ANY HAULING OPERATIONS AGAINST THE FLOW OF TRAFFIC OF AN OPEN TRAVELWAY UNLESS THE HAULING OPERATION IS PROTECTED BY BARRIER OR GUARDRAIL OR AS DIRECTED BY THE ENGINEER.

LANE AND SHOULDER CLOSURE REQUIREMENTS

B) REMOVE LANE CLOSURE DEVICES FROM THE LANE WHEN WORK IS NOT BEING PERFORMED BEHIND THE LANE CLOSURE OR WHEN A LANE CLOSURE IS NO LONGER NEEDED, OR AS DIRECTED BY THE ENGINEER.

C) WHEN PERSONNEL AND/OR EQUIPMENT ARE WORKING WITHIN 15 FT OF AN OPEN TRAVEL LANE, CLOSE THE NEAREST OPEN SHOULDER USING ROADWAY STANDARD DRAWING NO. 1101.04 UNLESS THE WORK AREA IS PROTECTED BY BARRIER OR GUARDRAIL OR A LANE CLOSURE IS INSTALLED.

D) WHEN PERSONNEL AND/OR EQUIPMENT ARE WORKING ON THE SHOULDER ADJACENT TO AN UNDIVIDED FACILITY AND WITHIN 5 FT OF AN OPEN TRAVEL LANE, CLOSE THE NEAREST OPEN TRAVEL LANE USING ROADWAY STANDARD DRAWING NO. 1101.02 UNLESS THE WORK AREA IS PROTECTED BY BARRIER OR GUARDRAIL.

WHEN PERSONNEL AND/OR EQUIPMENT ARE WORKING ON THE SHOULDER ADJACENT TO A DIVIDED FACILITY AND WITHIN 10 FT OF AN OPEN TRAVEL LANE, CLOSE THE NEAREST OPEN TRAVEL LANE USING ROADWAY STANDARD DRAWING NO. 1101.02 UNLESS THE WORK AREA IS PROTECTED BY BARRIER OR GUARDRAIL.

E) WHEN PERSONNEL AND/OR EQUIPMENT ARE WORKING WITHIN A LANE OF TRAVEL OF AN UNDIVIDED OR DIVIDED FACILITY, CLOSE THE LANE ACCORDING TO THE TRAFFIC MANAGEMENT PLANS, ROADWAY STANDARD DRAWINGS OR AS DIRECTED BY THE ENGINEER. CONDUCT THE WORK SO THAT ALL PERSONNEL AND/OR EQUIPMENT REMAIN WITHIN THE CLOSED TRAVEL LANE.

F) DO NOT WORK SIMULTANEOUSLY WITHIN 15 FT ON BOTH SIDES OF AN OPEN TRAVELWAY, RAMP OR LOOP WITHIN THE SAME LOCATION UNLESS PROTECTED WITH GUARDRAIL OR BARRIER.

G) PROVIDE TRAFFIC CONTROL FOR APPROPRIATE LANE CLOSURES FOR SURVEYING DONE BY THE DEPARTMENT.

PAVEMENT EDGE DROP OFF REQUIREMENTS

H) BACKFILL AT A 6:1 SLOPE UP TO THE EDGE AND ELEVATION OF EXISTING PAVEMENT IN AREAS ADJACENT TO AN OPENED TRAVEL LANE THAT HAS A DROP-OFF AS FOLLOWS:

BACKFILL DROP-OFFS THAT EXCEED 2 INCHES ON ROADWAYS WITH POSTED SPEED LIMITS OF 45 MPH OR GREATER.

BACKFILL DROP-OFFS THAT EXCEED 3 INCHES ON ROADWAYS WITH POSTED SPEED LIMITS LESS THAN 45 MPH.

BACKFILL WITH SUITABLE COMPACTED MATERIAL, AS APPROVED BY THE ENGINEER, AT NO EXPENSE TO THE DEPARTMENT.

I) DO NOT EXCEED A DIFFERENCE OF 2 INCHES IN ELEVATION BETWEEN OPEN LANES OF TRAFFIC FOR NOMINAL LIFTS OF 1.5 INCHES. INSTALL ADVANCE WARNING "UNEVEN LANES" SIGNS (W8-11) 200 FT IN ADVANCE AND A MINIMUM OF ONCE EVERY HALF MILE THROUGHOUT THE UNEVEN AREA.

TRAFFIC PATTERN ALTERATIONS

J) NOTIFY THE ENGINEER TWENTY ONE (21) CALENDAR DAYS PRIOR TO ANY TRAFFIC PATTERN ALTERATION.

SIGNING

K) INSTALL ADVANCE WORK ZONE WARNING SIGNS WHEN WORK IS WITHIN 40 FT FROM THE EDGE OF TRAVEL LANE AND NO MORE THAN THREE (3) DAYS PRIOR TO THE BEGINNING OF CONSTRUCTION.

L) PROVIDE PERMANENT SIGNING.

M) PROVIDE SIGNING AND DEVICES REQUIRED TO CLOSE THE ROAD ACCORDING TO THE ROADWAY STANDARD DRAWINGS AND TRAFFIC MANAGEMENT PLANS.

PROVIDE SIGNING REQUIRED FOR THE OFF-SITE DETOUR ROUTE AS SHOWN IN THE TRAFFIC MANAGEMENT PLANS.

N) COVER OR REMOVE ALL SIGNS AND DEVICES REQUIRED TO CLOSE THE ROAD WHEN ROAD CLOSURE IS NOT IN OPERATION.

COVER OR REMOVE ALL SIGNS REQUIRED FOR THE OFF-SITE DETOUR WHEN THE DETOUR IS NOT IN OPERATION.

O) ENSURE ALL NECESSARY SIGNING IS IN PLACE PRIOR TO ALTERING ANY TRAFFIC PATTERN.

TRAFFIC CONTROL DEVICES

P) SPACE CHANNELIZING DEVICES IN WORK AREAS NO GREATER IN FEET THAN TWICE THE POSTED SPEED LIMIT (MPH), EXCEPT 10 FT ON-CENTER IN RADII, AND 3 FT OFF THE EDGE OF AN OPEN TRAVELWAY, WHEN LANE CLOSURES ARE NOT IN EFFECT. WHEN SKINNY DRUMS ARE ALLOWED REFER TO SECTION 1180 OF STANDARD SPECIFICATIONS FOR ROADS AND STRUCTURES OR AS SHOWN IN THE PLANS.

Q) PLACE TYPE III BARRICADES WITH "ROAD CLOSED" SIGN R11-2 ATTACHED OF SUFFICIENT LENGTH TO CLOSE ENTIRE ROADWAY.

R) PLACE ADDITIONAL SETS OF THREE CHANNELIZING DEVICES (DRUMS, CONES OR SKINNY DRUMS) PERPENDICULAR TO THE EDGE OF TRAVELWAY ON 150 FT CENTERS WHEN UNOPENED LANES ARE CLOSED TO TRAFFIC.

23-AUG-2010 06:48 \\dot\dfsroot\0\Proj\TIP\Projects-B\B3656\TrafficControl\TCP\B-3656_TC_TMP-1.dgn kbroodwell AT WZTC237451

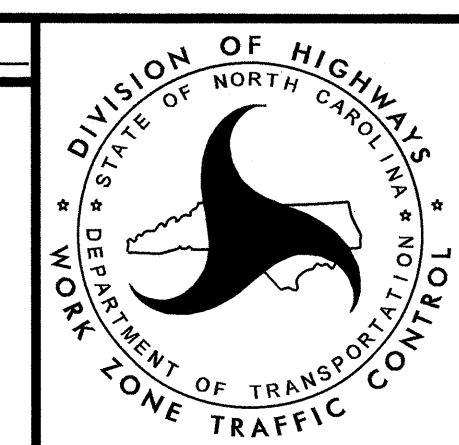
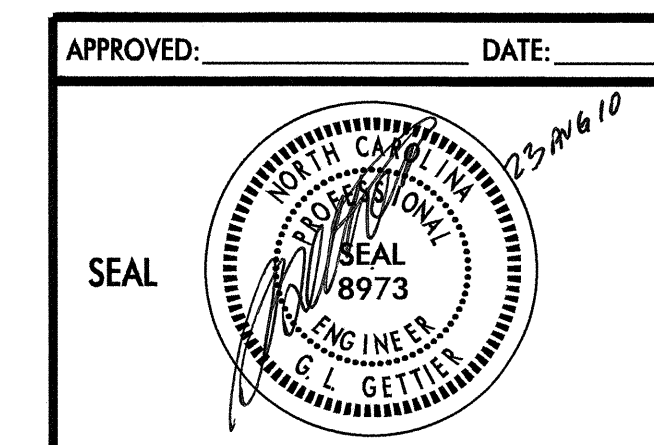

**TRANSPORTATION
OPERATIONS AND
GENERAL NOTES**

GENERAL NOTES CONT'D

PAVEMENT MARKINGS AND MARKERS

- S) INSTALL PAVEMENT MARKINGS AND PAVEMENT MARKERS ON THE FINAL SURFACE AS SHOWN IN THE PAVEMENT MARKING PLAN.
- T) INSTALL TEMPORARY PAVEMENT MARKINGS AND TEMPORARY PAVEMENT MARKERS ON INTERIM LAYERS OF PAVEMENT AS FOLLOWS:

ROAD NAME	MARKING	MARKER
1. ALL ROADS	PAINT	TEMPORARY RAISED

- U) PLACE ONE APPLICATION OF PAINT FOR TEMPORARY TRAFFIC PATTERNS. PLACE A SECOND APPLICATION OF PAINT SIX (6) MONTHS AFTER THE INITIAL APPLICATION AND EVERY SIX MONTHS AS DIRECTED BY THE ENGINEER.
- V) TIE PROPOSED PAVEMENT MARKING LINES TO EXISTING PAVEMENT MARKING LINES.
- W) REMOVE/REPLACE ANY CONFLICTING/DAMAGED PAVEMENT MARKINGS AND MARKERS BY THE END OF EACH DAY'S OPERATION.

TEMPORARY/FINAL SIGNALS

- X) SHIFT AND REVISE ALL SIGNAL HEADS AS SHOWN ON THE SIGNAL PLANS.

MISCELLANEOUS

- Y) LAW ENFORCEMENT MAY BE USED TO MAINTAIN TRAFFIC THROUGH THE WORK AREA AND/OR INTERSECTIONS, AS DIRECTED BY THE ENGINEER.
- Z) ALL WHEEL CHAIR RAMP LOCATIONS SHALL BE DERIVED FROM STATIONING SHOWN ON PAVEMENT MARKING PLANS OR AS DIRECTED BY THE ENGINEER IN COORDINATION WITH THE SIGNING AND DELINEATION UNIT.
- AA) CONTRACTOR SHALL MAINTAIN SIDEWALK ACCESS AT ALL TIME AS STATED IN THE PHASING. CONTRACTOR SHALL BE RESPONSIBLE TO PROVIDE TEMPORARY SIDEWALKS (CONCRETE, ASPHALT, OR OTHER SUITABLE MATERIAL AS APPROVED BY THE ENGINEER) AT ALL LOCATIONS WHERE THE OPEN PEDESTRIAN TRAVELWAY HAS BEEN REMOVED FOR CONSTRUCTION OPERATIONS (UTILITIES, DRAINAGE, ETC.).
- BB) ENGINEER WILL NOTIFY THE OVERSIZE/OVERWEIGHT PERMIT UNIT AT 919-733-4740 (MS. TAMMY C. DENNING AND/OR MS. JOY WIGGINS) THREE WEEKS PRIOR TO TRAFFIC BEING PLACED IN THE TEMPORARY TWO-LANE TRAFFIC PATTERN ON MAIN STREET (US 19-23 NB) AND WHEN TRAFFIC IS PLACED INTO THE PROPOSED DIVIDED TRAFFIC PATTERN (SEE PHASE I, STEP 3 AND PHASE III, STEP 1).

23-AUG-2010 06:49
 \\dot\dfsroot\01\Proj\TIP\Projects-B\B3656\TrafficControl\TCP\B-3656_TC_TMP-1.dgn
 kbroadwell AT WZTC237451

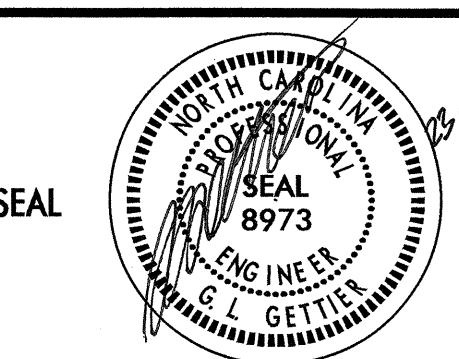
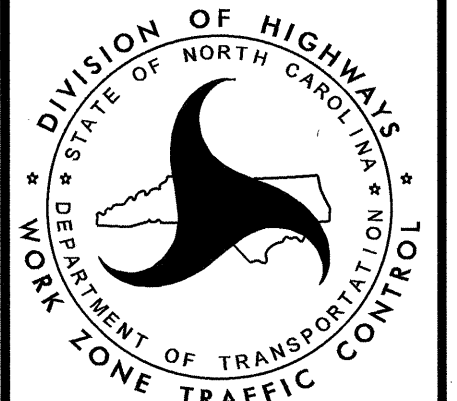
APPROVED: _____ DATE: _____ 		<h1 style="margin: 0;">TRANSPORTATION OPERATIONS AND GENERAL NOTES</h1>
--	---	---

SIGN NUMBER: SP10206	BACKG COLOR: Fluorescent Orange	DESIGN BY: JGM	CHECKED BY:	DATE: Jun 25, 2010	
TYPE: STATIONARY	COPY COLOR: Black	PROJECT ID: B-3656	DIV: 14		
QUANTITY: SEE PLANS	SYMBOL	X	Y	WID	HT
SIGN WIDTH: 3'-6"					
HEIGHT: 2'-0"					
TOTAL AREA: 7.0 Sq.Ft.					
BORDER TYPE: INSET					
RECESS: 0.47"					
WIDTH: 0.63"					
RADII: 1.5"					
NO. Z BARS:	MAT'L: 0.080" (2.0 mm) ALUMINUM				
LENGTH:					
USE NOTES: 1,2					
1. Legend and border shall be direct applied black non-reflective sheeting.					
2. Background shall be Type VII, VIII, or IX (prismatic) fluorescent orange retroreflective sheeting.					

BORDER
R=1.5"
TH=0.63"
IN=0.47"

Spacing Factor is 1 unless specified otherwise

Letter spacings are to start of next letter													Series/Size
	A	L	L	T	R	U	C	K	S				Text Length
	6.8	3.1	2.6	2	4	2.6	2.9	3	3	2.7	2.2	6.8	C 2000 28.3
	3		A	X	L	E	S						C 2000 19.3
	11.3	2.2	4	2.8	2.9	2.6	2.5	2.2	11.3				C 2000 21
	10.5	3.2	2.2	4	3.4	3.2	2.9	2	10.5				

FILENAME: Sign Design NORTH CAROLINA D.O.T. SIGN DETAIL

23-AUG-2010 06:51
 \\dot\dfsroot\01\Proj\TIP\Projects-B\B3656\TrafficControl\TCP\B-3656_TC_TMP-2a.dgn
 kbroadwell AT WZTC237451

APPROVED: _____ DATE: _____			SPECIAL SIGN DESIGN

PHASING

PHASE I

- STEP 1: - CONTRACTOR SHALL PLACE "ROAD WORK AHEAD" AND "END ROAD WORK" SIGNS AS SHOWN ON SHEETS TMP-4 AND TMP-5 A MAXIMUM OF 3 DAYS PRIOR TO BEGINNING ANY WORK.
- CONTRACTOR SHALL SET UP STAGING AREAS. SEE SHEETS TMP-4 AND TMP-5.
- STEP 2: - CONTRACTOR SHALL UTILIZE LANE CLOSURES PER RSD 1101.02, SHEETS 2 & 3 OF 9 TO CONSTRUCT -DET- UP TO THE EDGE AND ELEVATION OF EXISTING AT BOTH ENDS OF -DET-. SEE SHEET TMP-4 AND THE CONSTRUCTION PLANS.
- CONTRACTOR SHALL INSTALL DETOUR SIGNING AS SHOWN ON SHEETS TMP-5, TMP-6, AND TMP-9 AND COVER.

NOTE: CONTRACTOR SHALL REVIEW AND RECORD THE EXISTING PAVEMENT MARKINGS AND MARKERS PRIOR TO CONSTRUCTION. USE THIS RECORD OF EXISTING PAVEMENT MARKINGS AND MARKERS IN CONJUNCTION WITH THE ROADWAY STANDARD DRAWINGS AND THE FINAL PAVEMENT MARKING PLANS TO RE-ESTABLISH THE PROPOSED PAVEMENT MARKINGS AND MARKERS AT THE END OF CONSTRUCTION, UNLESS OTHERWISE DIRECTED BY THE ENGINEER.

- STEP 3: - CONTRACTOR SHALL WORK IN A CONTINUOUS MANNER USING ROADWAY STANDARD DRAWING NUMBER 1101.02 SHEETS 1, 2, 3, 4 & 5 OF 9 AND LAW ENFORCEMENT:
- INSTALL TEMPORARY PAVEMENT MARKINGS AND TEMPORARY PAVEMENT MARKERS AS SHOWN ON SHEETS TMP-5 AND TMP-6.
 - MODIFY THE EXISTING SIGNALS AT THE FOLLOWING INTERSECTIONS (SEE SHEETS TMP-5, TMP-6 AND THE SIGNAL PLANS): MAIN ST. & PENLAND ST., MAIN ST. & PISGAH DR./SORRELLS ST.
 - DEACTIVATE OR COVER THE EXISTING SIGNAL AT MAIN ST. & PARK ST./ REED ST. INTERSECTION. SEE SHEET TMP-5 AND THE SIGNAL PLANS.
 - INSTALL DRUMS, TYPE III BARRICADES, ALL REMAINING SIGNAGE, AND PLACE TRAFFIC ONTO THE DETOURS AND TEMPORARY TRAFFIC PATTERNS AS SHOWN ON SHEETS TMP-5, TMP-6, & TMP-9.
- STEP 4: - CONTRACTOR, AWAY FROM TRAFFIC, SHALL BEGIN DEMOLITION OF THE EXISTING BRIDGE AND BEGIN CONSTRUCTION OF THE PROPOSED BRIDGE (SEE CONSTRUCTION PLANS).
- CONTRACTOR SHALL, AWAY FROM TRAFFIC AND/OR USING LANE CLOSURES PER RSD 1101.02 SHEET 1 OF 9, CONSTRUCT UP TO BUT NOT INCLUDING THE FINAL LAYER OF SURFACE COURSE (INCLUDING PROPOSED CURB AND GUTTER AND DRAINAGE) AS FOLLOWS:
 - RIGHT SIDE OF -L- (PARK ST.) FROM STA. 11+50+/- TO STA. 15+90+/- . SEE SHEET TMP-5 AND THE CONSTRUCTION PLANS.
 - BOTH SIDES OF -L- (PARK ST.) FROM STA. 15+90+/- TO THE BEGINNING OF THE PROPOSED BRIDGE. SEE SHEET TMP-5 AND THE CONSTRUCTION PLANS.
 - -Y3- (PENLAND ST.). SEE SHEET TMP-5 AND THE CONSTRUCTION PLANS.
 - BOTH SIDES OF -L- (PARK STREET) ROADWAY FROM THE END OF THE BRIDGE TO STA. 19+90+/- . SEE SHEET TMP-6 AND THE CONSTRUCTION PLANS.
 - LEFT SIDE OF -L- (PARK ST.) FROM STA. 19+90+/- TO STA. 22+00+/- . SEE SHEET TMP-6 AND THE CONSTRUCTION PLANS.
 - -Y4- (SORRELLS ST.). SEE SHEET TMP-6 AND THE CONSTRUCTION PLANS.

PHASE II

- STEP 1: - THE FOLLOWING SHALL BE COMPLETED IN ONE WORK PERIOD.
- CONTRACTOR SHALL, USING LANE CLOSURES PER RSD 1101.02 SHEET 1 OF 9:
 - INSTALL TEMPORARY PAVEMENT MARKINGS AND TEMPORARY PAVEMENT MARKERS ON -L- (PARK ST.), -Y3- (PENLAND ST.) AND -Y4- (SORRELLS ST.) AS SHOWN ON SHEETS TMP-7 AND TMP-8.
 - INSTALL DRUMS, TYPE III BARRICADES, AND SIGNAGE, AND PLACE TRAFFIC ONTO THE NEW TEMPORARY TRAFFIC PATTERN AS SHOWN ON SHEETS TMP-7 & TMP-8.
- STEP 2: - CONTRACTOR SHALL, AWAY FROM TRAFFIC AND/OR USING LANE CLOSURES PER RSD 1101.02 SHEET 1 OF 9, CONSTRUCT UP TO, BUT NOT INCLUDING THE FINAL LAYER OF SURFACE COURSE (INCLUDING PROPOSED CURB AND GUTTER AND DRAINAGE) AS FOLLOWS:
- LEFT SIDE OF -L- (PARK STREET) ROADWAY FROM STA. 11+50+/- TO STA. 15+90+/- . SEE SHEET TMP-7 AND THE CONSTRUCTION PLANS.
 - RIGHT SIDE OF -L- (PARK STREET) ROADWAY FROM STA. 19+90+/- TO STA. 22+00+/- .
 - CONTRACTOR, AWAY FROM TRAFFIC, SHALL COMPLETE CONSTRUCTION OF THE PROPOSED BRIDGE BEGUN IN PHASE I, STEP 4.
 - DEMOLISH -DET- THEN GRADE AND SEED THE AREA AND REPAIR SORRELLS ST. AS DIRECTED BY THE ENGINEER.

PHASE III

- STEP 1: - CONTRACTOR SHALL WORK IN A CONTINUOUS MANNER USING ROADWAY STANDARD DRAWING NUMBER 1101.02 SHEETS 1, 2, 3, 4 & 5 OF 9 AND LAW ENFORCEMENT:
- PLACE THE FINAL LAYER OF SURFACE COURSE ON -L- (PARK ST.), -Y3- (PENLAND ST.) AND -Y4- (SORRELLS ST.). SEE CONSTRUCTION PLANS.
 - PLACE THE FINAL PAVEMENT MARKINGS AND FINAL PAVEMENT MARKERS ON -L- (PARK ST.), -Y3- (PENLAND ST.), -Y4- (SORRELLS ST.), AND MAIN ST. AS SHOWN ON THE FINAL PAVEMENT MARKING PLANS.
 - RETURN SIGNALS TO THE ORIGINAL TRAFFIC PATTERNS (SEE SIGNAL PLANS) AND OPEN ALL ROADS TO THE FINAL TRAFFIC PATTERN.
- STEP 2: - REMOVE ALL TRAFFIC CONTROL, DETOUR SIGNAGE AND TRAFFIC CONTROL DEVICES.

23-AUG-2010 06:49
 \\dot\dfs\00\0\Proj\TIP\Projects-B\B3656\Traffic\TrafficControl\TCP\B-3656.TC.TMP-1.dgn
 kbroadwell AT WZTC237451

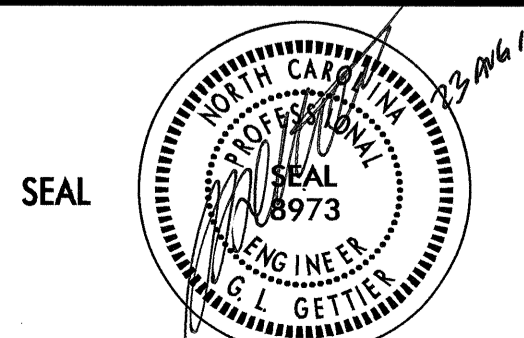
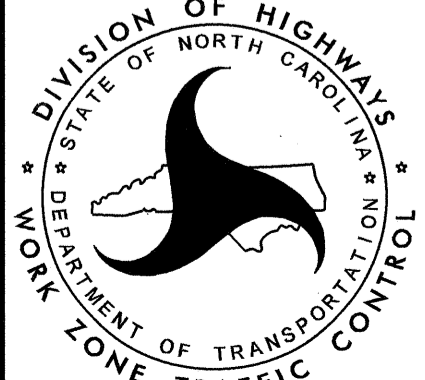
APPROVED: _____ DATE: _____ 		PHASING
--	---	---------

TYPE III
BARRICADES OR
TEMP. FENCING
AS DIRECTED
BY THE ENGINEER

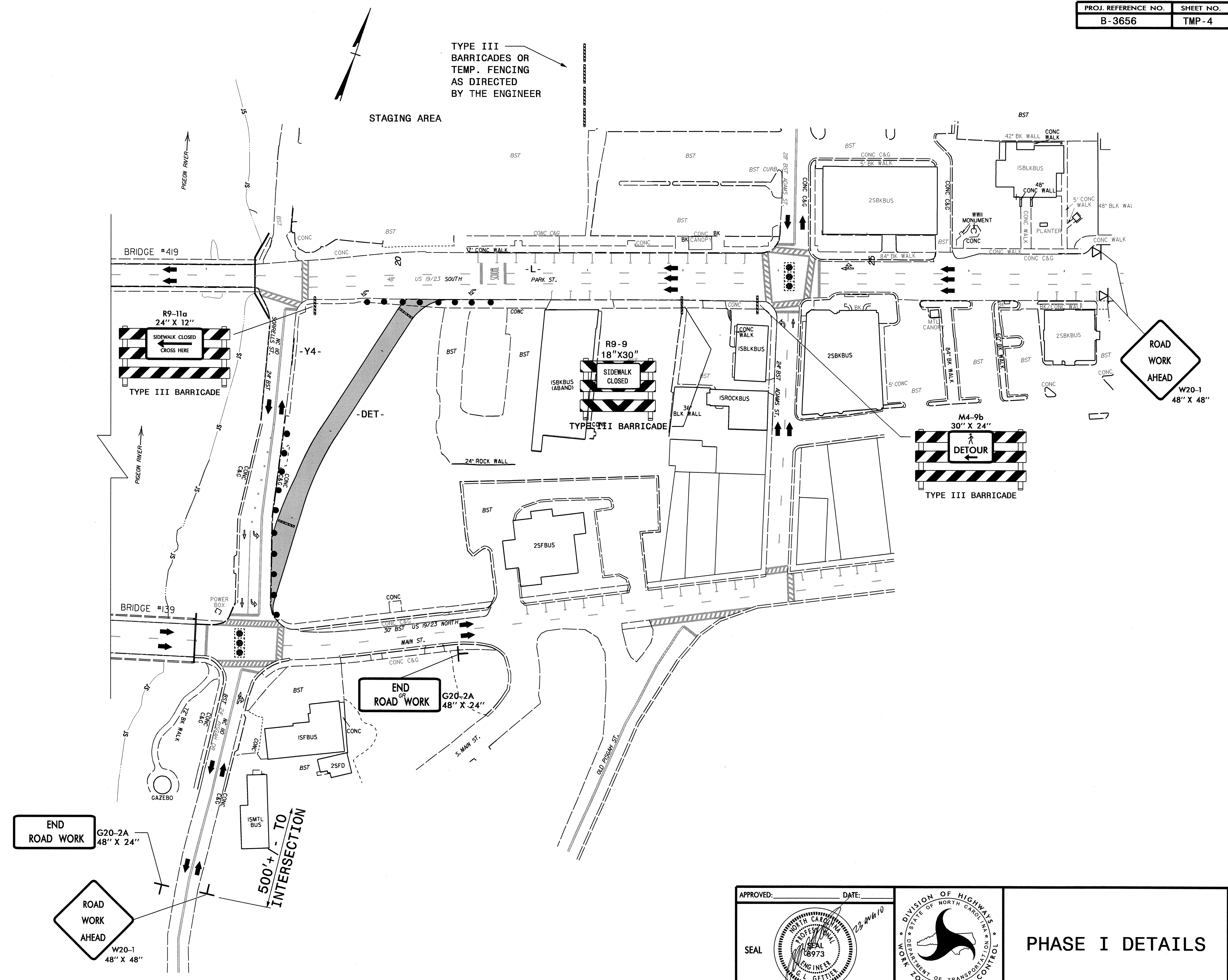

23-AUG-2010 06:58
 \\dot\dfsroot\proj\TIP\Projects-B\B3656\TrafficControl\B3656-TC-TMP-4.dgn
 kbroadwell AT WZTC23745

APPROVED: _____ DATE: _____

SEAL

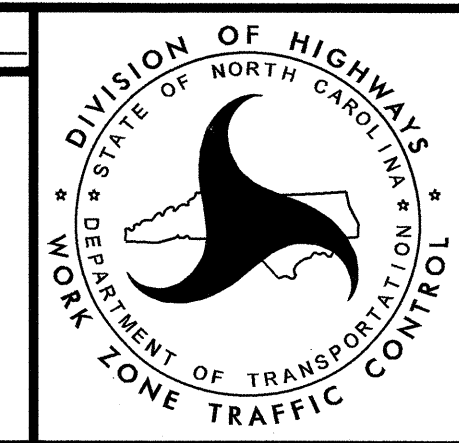

PHASE I DETAILS

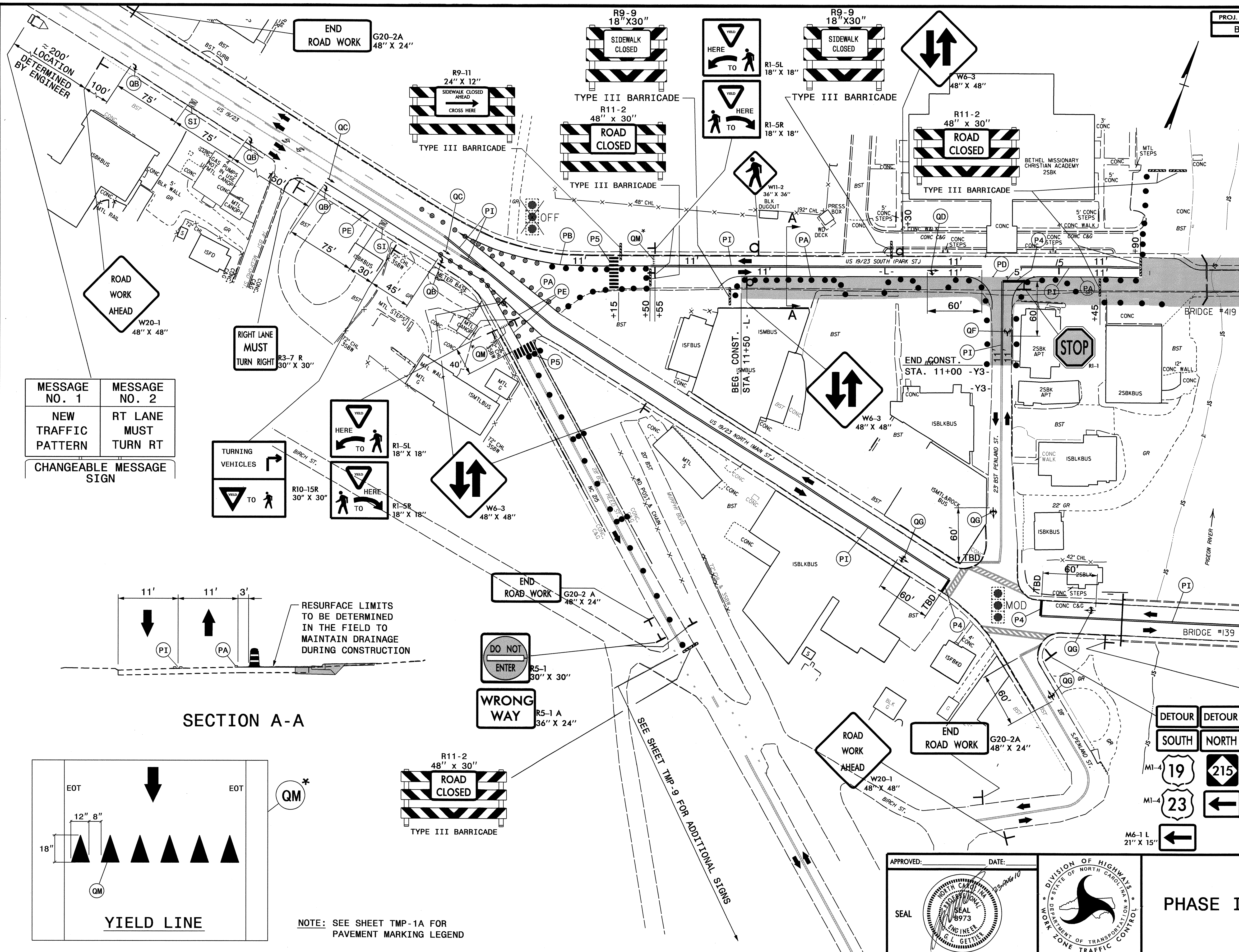

MESSAGE NO. 1	MESSAGE NO. 2
NEW TRAFFIC PATTERN	RT LANE MUST TURN RT
CHANGEABLE MESSAGE SIGN	

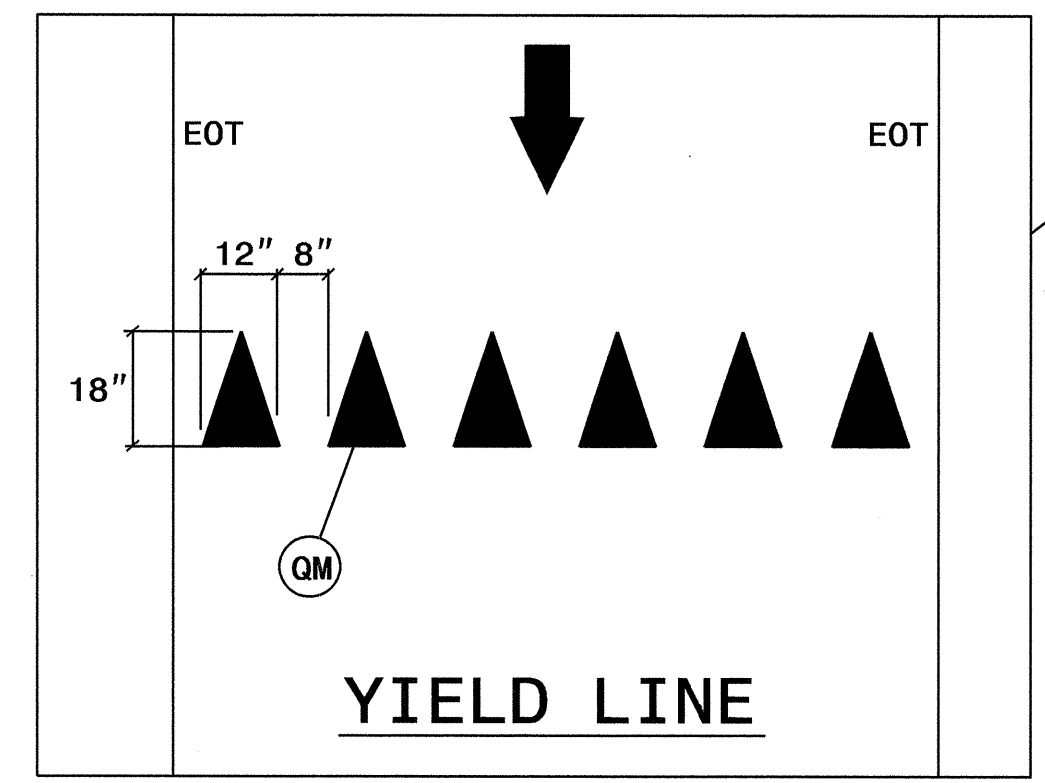
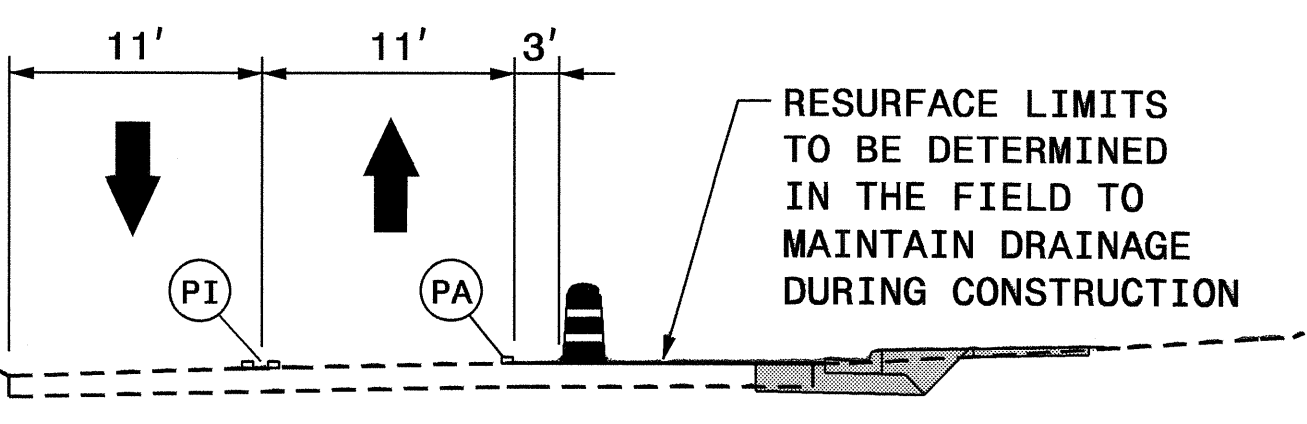
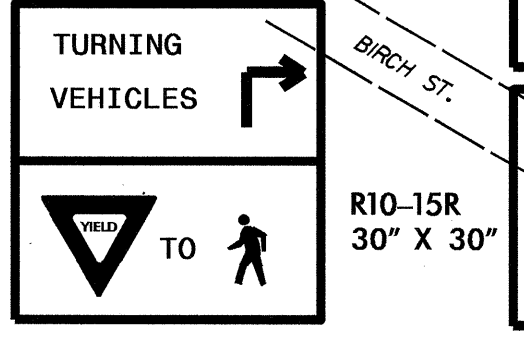

NOTE: SEE SHEET TMP-1A FOR PAVEMENT MARKING LEGEND

- DETOUR SOUTH M4-8 24" X 12"
- DETOUR NORTH M3-1 24" X 12"
- M1-4 19 M1-5 215
- M1-4 23 M6-1 L 21" X 15"
- M6-1 L 21" X 15"

MATCH LINE STA. 17+00 - L - SEE SHEET TMP-6

APPROVED: _____ DATE: _____

SEAL: [Professional Engineer Seal]

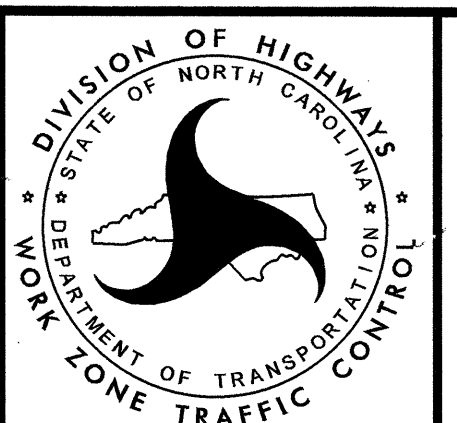

PHASE I DETAILS

23-AUG-2010 06:57 \\dot\dfsrooftop\Proj\TIP\Projects\B3656\TrafficControl\CP\B-3656-TC-TMP-5.dgn kbr roadwell AT WZTC237451

MESSAGE NO. 1	MESSAGE NO. 2
US 19/23 NC 215 DETOUR	MERGE TO LEFT LANE
CHANGEABLE MESSAGE SIGN	

SECTION A-A

MATCH LINE STA. 17+00 - L-
SEE SHEET TMP-5

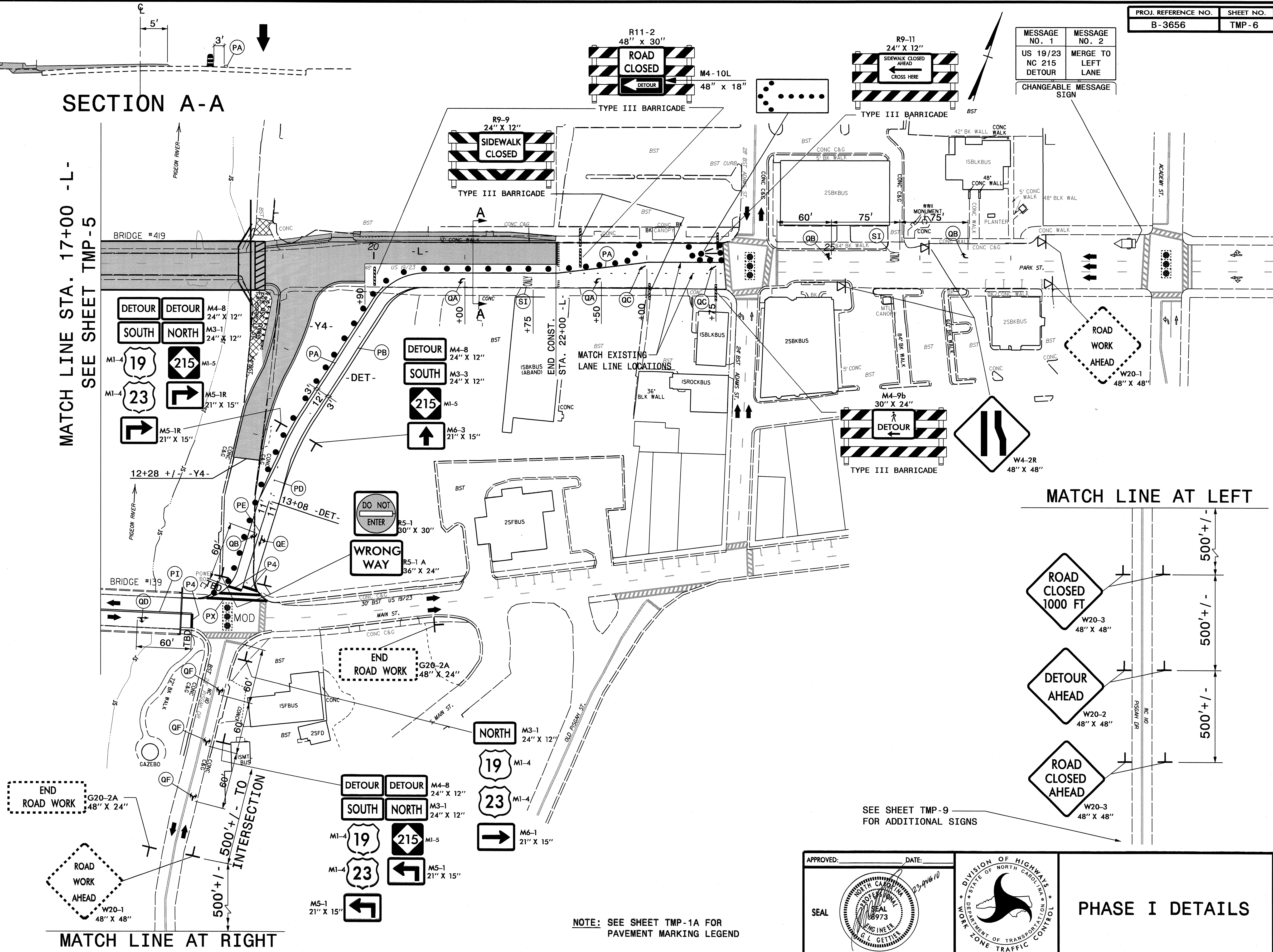

MATCH LINE AT LEFT

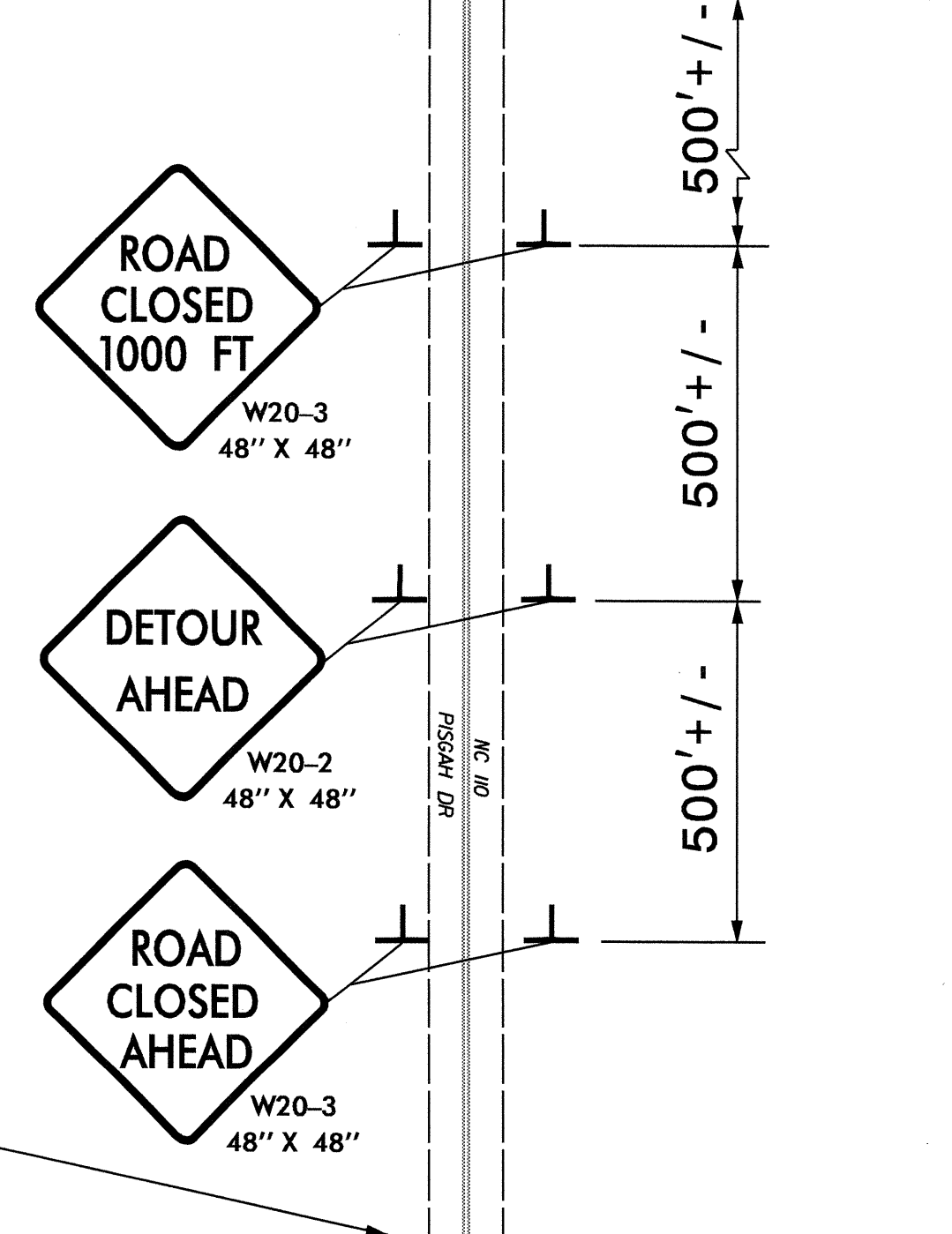

SEE SHEET TMP-9 FOR ADDITIONAL SIGNS

MATCH LINE AT RIGHT

NOTE: SEE SHEET TMP-1A FOR PAVEMENT MARKING LEGEND

APPROVED: _____ DATE: _____

SEAL

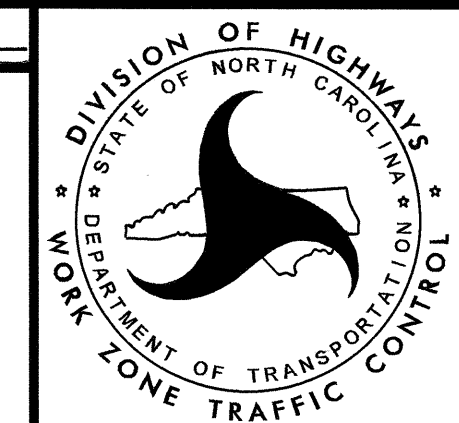

PHASE I DETAILS

23-AUG-2010 06:56
\\dot\dfs\0070\N\Projects\B\3656\Traffic\TrafficControl\CPAB-3656-TC-TMP-6.dgn
Kbrodwell AT WZTC237451

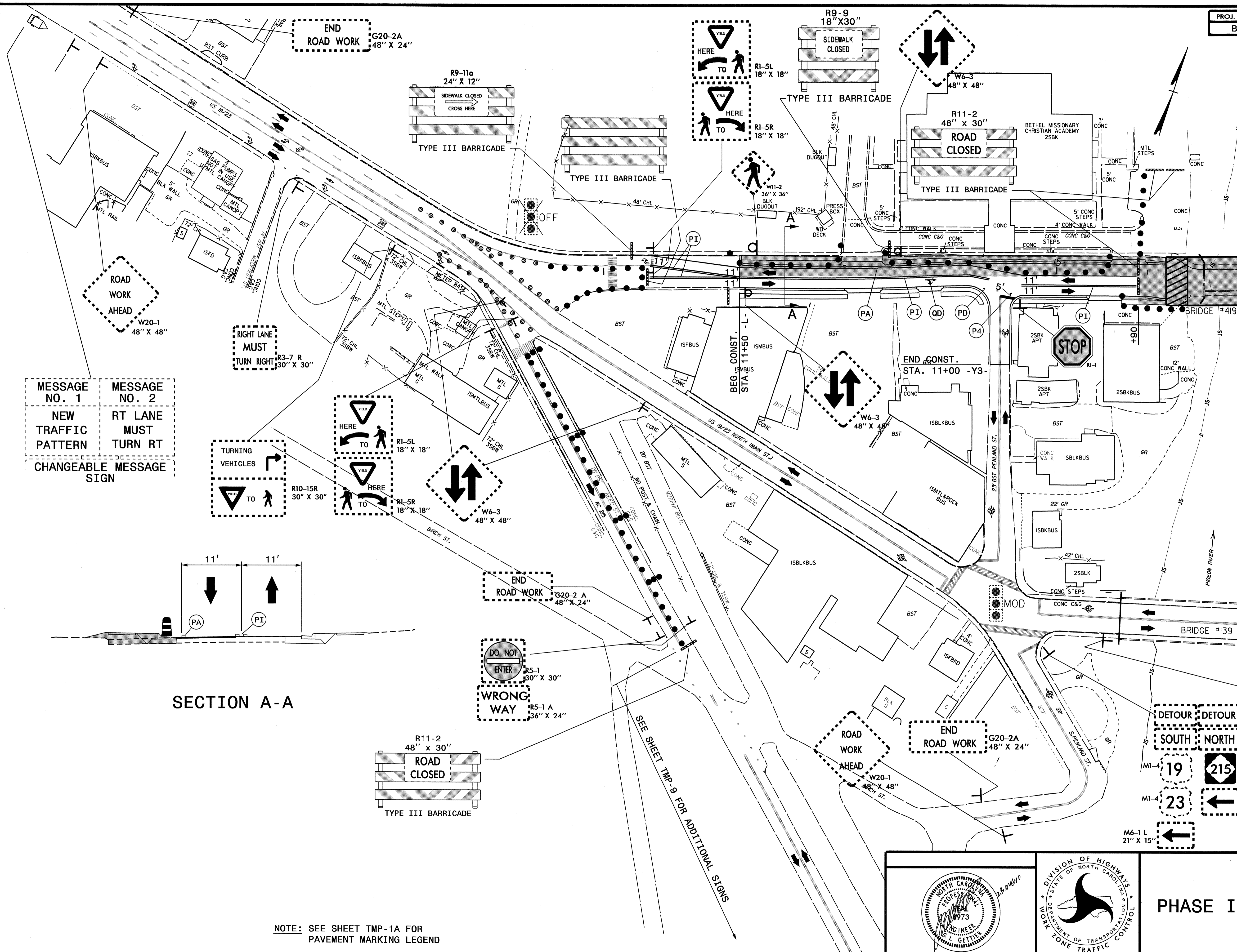

MESSAGE NO. 1
NEW TRAFFIC PATTERN
CHANGEABLE MESSAGE SIGN

MESSAGE NO. 2
RT LANE MUST TURN RT
CHANGEABLE MESSAGE SIGN

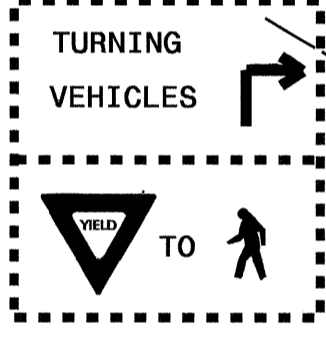

SECTION A-A

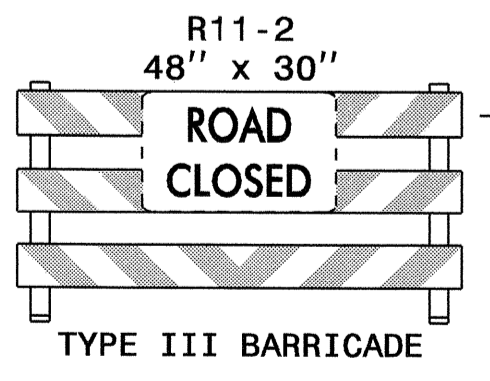
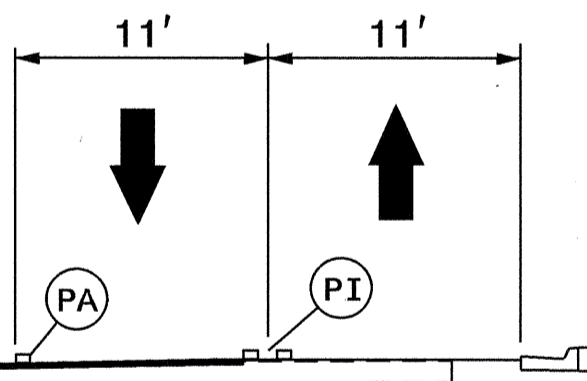

NOTE: SEE SHEET TMP-1A FOR PAVEMENT MARKING LEGEND

MATCH LINE STA. 17+00 - L-
SEE SHEET TMP-8

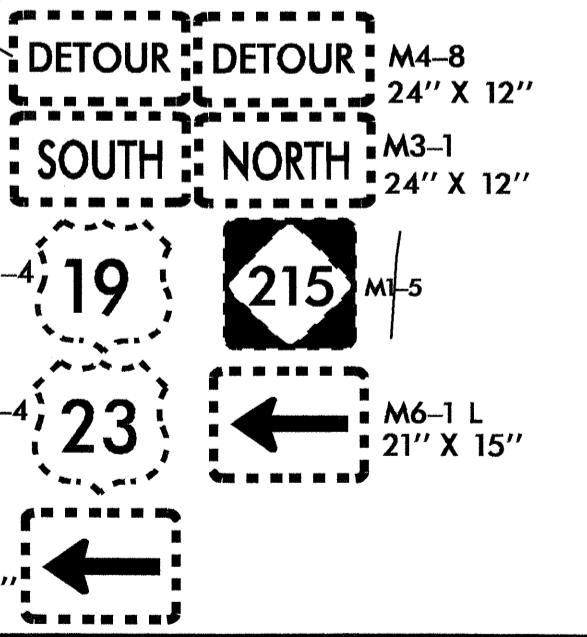

		<p>PHASE II DETAILS</p>
--	--	-------------------------

