

STATE	PROJECT NO.	SHEET NO.	TOTAL SHEETS
N.C.	7CR.10791.33, 7CR.20791.33	1	
F.A. PROJ. NO.			

# ROCKINGHAM COUNTY

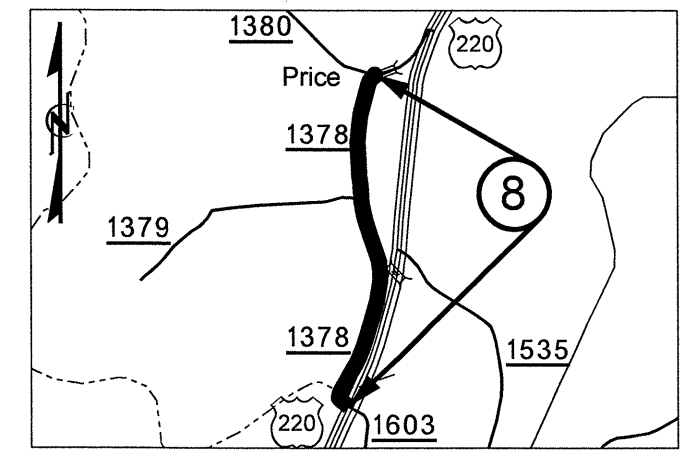

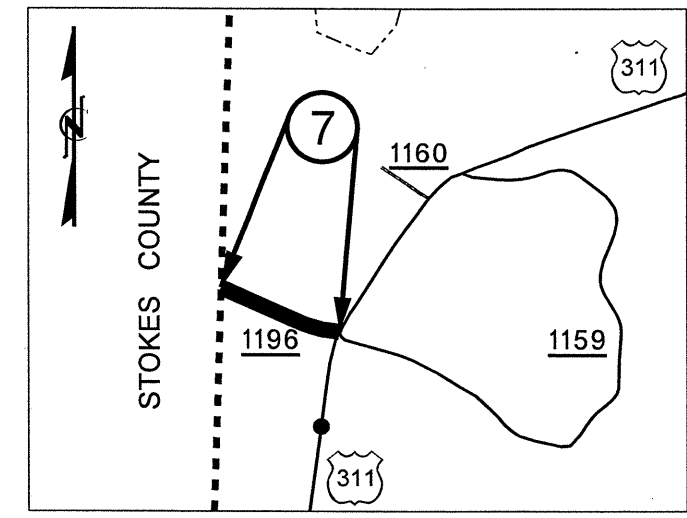
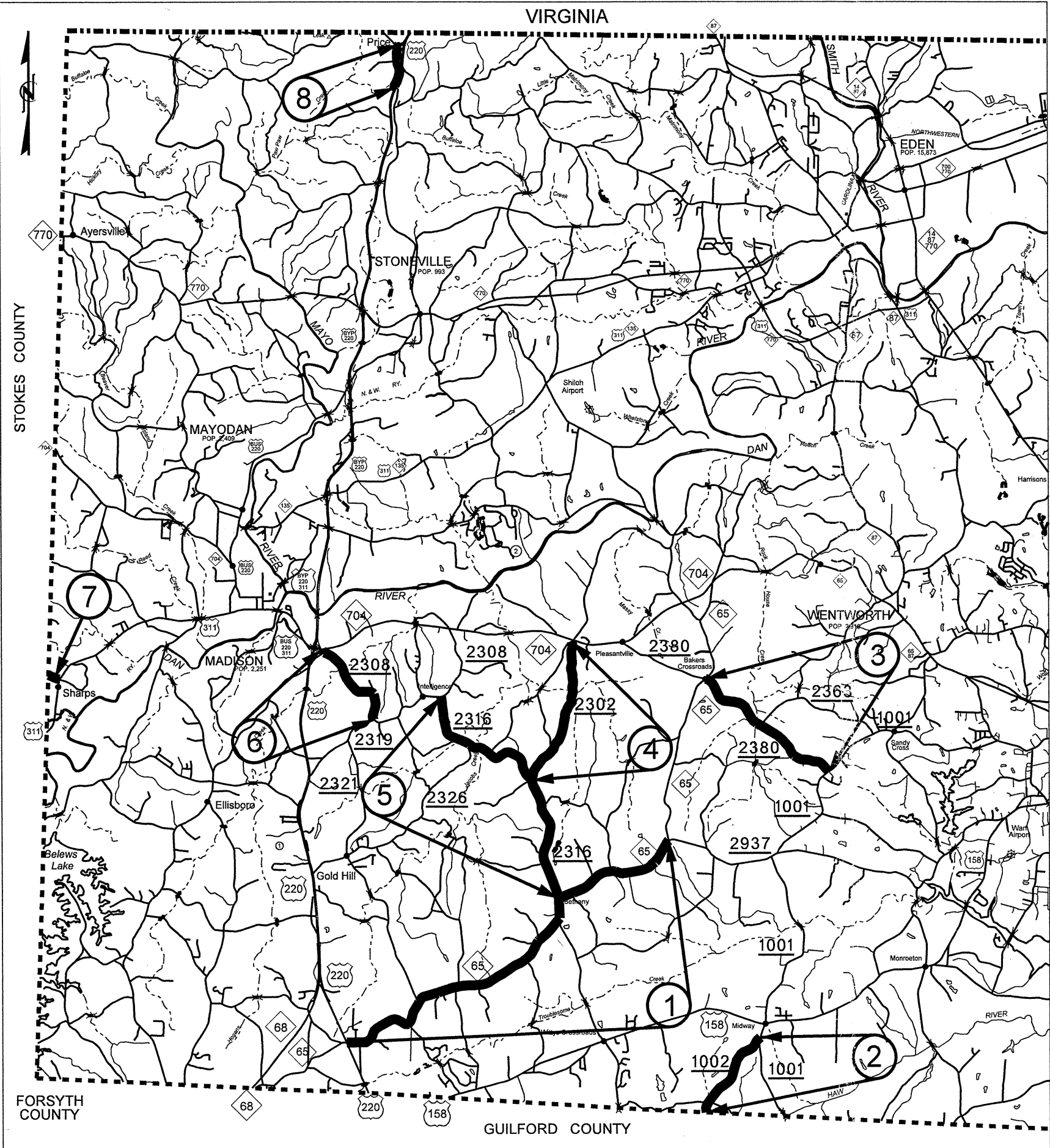

PROJECT NO.	SHEET NO.	TOTAL NO.
7CR.10791.33, 7CR.20791.33	3	

## SUMMARY OF QUANTITIES

PROJECT NO.	COUNTY	MAP NO.	ROUTE	DESCRIPTION	TYP	FINAL SURFACE TESTING REQUIRED	LENGTH MI	WIDTH FT	BORROW EXCAVATION CY	INCIDENTAL STONE BASE TONS	SHOULDER RECONSTRUCTION SMI	MILLING ASPHALT PAVEMENT, 1-1/4" DEPTH SY	INCIDENTAL MILLING SY	ASPHALT CONC BASE COURSE, TYPE B25.0B TONS	ASPHALT CONC SURFACE COURSE, TYPE SF9.5A TONS	ASPHALT BINDER FOR PLANT MIX, GRADE PG 64-22 TONS	ASPHALT SURFACE TREATMENT, MAT COAT, #78M STONE SY	SEEDING & MULCHING AC	GENERIC EROSION CONTROL ITEM - [RESIDENTIAL SEEDING] AC		
7CR.10791.33	Rockingham	1	NC 65	FROM NEW JOINT 500' SOUTH OF SR 2937 (IRON WORKS RD) TO US 220	1	NO	6.708	21	20	438	15.58			7,197	7,360	788	82,643	1.42	1.42		
					1	NO	0.035	21-31					38	43	4	534					
					1	NO	0.03	21-50					32	55	5	722					
					1	NO	0.049	50					53	167	13	1,437					
					1	NO	0.056	38					60	95	9	1,248					
					1	NO	0.068	21-38					73	94	9	1,197					
					1	NO	0.822	21					882	956	100	10,127					
					1	NO	0.018	21-30					19	22	2	275					
<b>TOTAL FOR MAP NO. 1</b>							<b>7.786</b>		<b>20</b>	<b>438</b>	<b>15.58</b>		<b>8,354</b>	<b>8,792</b>	<b>930</b>	<b>98,183</b>	<b>1.42</b>	<b>1.42</b>			
<b>TOTAL FOR PROJ NO. 7CR.10791.33</b>							<b>7.786</b>		<b>20</b>	<b>438</b>	<b>15.58</b>		<b>8,354</b>	<b>8,792</b>	<b>930</b>	<b>98,183</b>	<b>1.42</b>	<b>1.42</b>			
7CR.20791.33	Rockingham	2	SR 1002 (SCALESVILLE RD)	FROM SR 1001 (CHURCH ST) TO GUILFORD COUNTY LINE	2	NO	1.567	21		135			175		1,334	87	19,305				
				Bridge #18	2	NO	0.014	23				189		13	1						
					2	NO	0.231	21					175		197	13	2,846				
		<b>TOTAL FOR MAP NO. 2</b>							<b>1.812</b>		<b>135</b>		<b>189</b>	<b>350</b>	<b>1,544</b>	<b>101</b>	<b>22,151</b>				
		3	SR 2380 (BAKERS CROSSROAD)	FROM SR 1001 (SANDY CROSSROAD) TO NC 65	2	NO	0.019	20-30			338					19	1	279			
					2	NO	1.65	20					1,418	92	19,360						
					2	NO	0.018	20-29					18	1	264						
				Bridge #26	2	NO	0.023	29					27	2	391						
					2	NO	0.015	20-29					15	1	220						
		<b>TOTAL FOR MAP NO. 3</b>							<b>3.037</b>		<b>338</b>			<b>2,561</b>	<b>166</b>	<b>35,908</b>					
		4	SR 2302 (MCCOLLUM RD)	FROM NC 704 TO SR 2316 (BETHANY RD)	2	NO	0.034	18-34			337					116	8	519			
					2	NO	1.05	18					150		767	50	11,088				
				Bridge #37	2	NO	0.018	18													
					2	NO	1.913	18					150		1,477	96	20,201				
		<b>TOTAL FOR MAP NO. 4</b>							<b>3.015</b>		<b>337</b>		<b>300</b>	<b>2,360</b>	<b>154</b>	<b>31,808</b>					
		5	SR 2316 (BETHANY RD)	FROM SR 2308 (BALD HILL LOOP) TO NC 65	2	NO	0.935	21			551				175	816	53	11,519			
				Bridge #40	2	NO	0.008	22					103		7						
				Bridge #39	2	NO	0.483	21					350		471	31	5,951				
					2	NO	0.029	21								175	2,884	187	38,845		
					2	NO	0.061	31-32								67	4	966			
					2	NO	0.147	32								190	12	2,760			
					2	NO	0.059	21-32								64	4	935			
					2	NO	0.196	21								167	11	2,415			
		<b>TOTAL FOR MAP NO. 5</b>							<b>5.071</b>		<b>551</b>		<b>103</b>	<b>700</b>	<b>4,666</b>	<b>302</b>	<b>63,391</b>				
		6	SR 2308 (BALD HILL TOP)	FROM SR 2319 (BAGGAGE RD) TO NC 704	2	NO	0.058	20-22			210					49	3	715			
					2	NO	1.207	20							1,039	68	14,162				
				Bridge #197	2	NO	0.01	20							8	1	117				
		<b>TOTAL FOR MAP NO. 6</b>							<b>1.813</b>		<b>210</b>			<b>1,612</b>	<b>106</b>	<b>21,307</b>					
7	SR 1196 (MADISON DILLARD RD)	FROM US 311 TO STOKES COUNTY LINE	2	NO	0.209	22			41					186	12	2,698					
<b>TOTAL FOR MAP NO. 7</b>							<b>0.209</b>		<b>41</b>				<b>186</b>	<b>12</b>	<b>2,698</b>						
8	SR 1378 (MARTINSVILLE LOOP)	FROM US 220 TO SR 1280 (SPENCER RD)	2	NO	0.098	21-37			107					115	7	1,667					
			2	NO	0.522	21							464	30	6,431						
			2	NO	0.062	21-23							55	4	800						
			2	NO	0.092	21-26							89	6	1,295						
<b>TOTAL FOR MAP NO. 8</b>							<b>0.774</b>		<b>107</b>			<b>723</b>	<b>47</b>	<b>10,193</b>							
<b>TOTAL FOR PROJ NO. 7CR.20791.33</b>							<b>15.731</b>		<b>1,719</b>		<b>292</b>	<b>1,350</b>	<b>13,652</b>	<b>888</b>	<b>187,456</b>						
<b>GRAND TOTAL</b>							<b>23.517</b>		<b>20</b>	<b>2,157</b>	<b>15.58</b>	<b>292</b>	<b>1,350</b>	<b>8,354</b>	<b>22,444</b>	<b>1,818</b>	<b>285,639</b>	<b>1.42</b>	<b>1.42</b>		

PROJECT NO.	SHEET NO.	TOTAL NO.
7CR.10791.33, 7CR.20791.33	4	

### THERMOPLASTIC AND PAINT QUANTITIES

PROJECT NO	COUNTY	MAP NO	ROUTE	DESCRIPTION	LENGTH	WIDTH	4685000000-E	4686000000-E			4690000000-E	4695000000-E	4710000000-E	4721000000-E			4725000000-E	4810000000-E		4820000000-E	4900000000-N	4905000000-N	
							4" X 90 M WHITE THERMO LF	4" X 120 M WHITE THERMO LF	4" X 120 M YELLOW THERMO LF	6" X 120 M WHITE THERMO LF	8" X 90 M WHITE THERMO LF	24" X 120 M WHITE THERMO LF	THERMO MSG SCHOOL 120 M EA	THERMO MSG ONLY 120 M EA	THERMO LT ARROW 90 M EA	4" WHITE PAINT LF	4" YELLOW PAINT LF	8" YELLOW PAINT LF	YELLOW & YELLOW MARKERS EA	SNOWPLOWABLE PAVEMENT MARKERS EA			
7CR.10791.33	Rockingham	1	NC 65	FROM NEW JOINT 500' SOUTH OF SR 2937 (IRON WORKS RD) TO US 220	7.786	21	82,230	258	76,873	404	153	100	12		2							616	
		TOTAL FOR MAP NO. 1				7.786		82,230	258	76,873	404	153	100	12		2							616
		TOTAL FOR PROJ NO. 7CR.10791.33				7.786		82,230	258	76,873	404	153	100	12		2							
							77,131						12										
7CR.20791.33	Rockingham	2	SR 1002 (SCALESVILLE RD)	FROM SR 1001 (CHURCH ST) TO GUILFORD COUNTY LINE	1.812	21											38,280	33,528		144			
		TOTAL FOR MAP NO. 2				1.812												38,280	33,528		144		
		3	SR 2380 (BAKERS CROSSROAD)	FROM SR 1001 (SANDY CROSSROAD) TO NC 65	3.037	25	150			40								63,820	57,795		240		
		TOTAL FOR MAP NO. 3				3.037		150		40								63,820	57,795		240		
		4	SR 2302 (MCCOLLUM RD)	FROM NC 704 TO SR 2316 (BETHANY RD)	0.034	26	225			72								63,430	61,058		239		
		TOTAL FOR MAP NO. 4				2.981	18			72								63,430	61,058		239		
		5	SR 2316 (BETHANY RD)	FROM SR 2308 (BALD HILL LOOP) TO NC 65	5.071	21	975			206		100	12	4	2			105,562	97,918	344	402		
		TOTAL FOR MAP NO. 5				5.071		975		206		100	12	4	2			105,562	97,918	344	402		
		6	SR 2308 (BALD HILL TOP)	FROM SR 2319 (BAGGAGE RD) TO NC 704	1.813	21	225			72								37,850	38,300				
		TOTAL FOR MAP NO. 6				1.813		225		72								37,850	38,300				
		7	SR 1196 (MADISON DILLARD RD)	FROM US 311 TO STOKES COUNTY LINE	0.209	22												4,420	3,663				
		TOTAL FOR MAP NO. 7				0.209												4,420	3,663				
		8	SR 1378 (MARTINSVILLE LOOP)	FROM US 220 TO SR 1280 (SPENCER RD)	0.774	29	75			12								16,170	16,320				
		TOTAL FOR MAP NO. 8				0.774		75		12								16,170	16,320				
		TOTAL FOR PROJ NO. 7CR.20791.33				15.731		1,650		402		100	12	4	2			329,532	308,582	344	1,025		
										16			638,114										
GRAND TOTAL					23.517		83,880	258	76,873	806	153	200	24	4	4	329,532	308,582	344	1,025	616			
							77,131						28			638,114							

