

BY: HET
PASQUOTANK

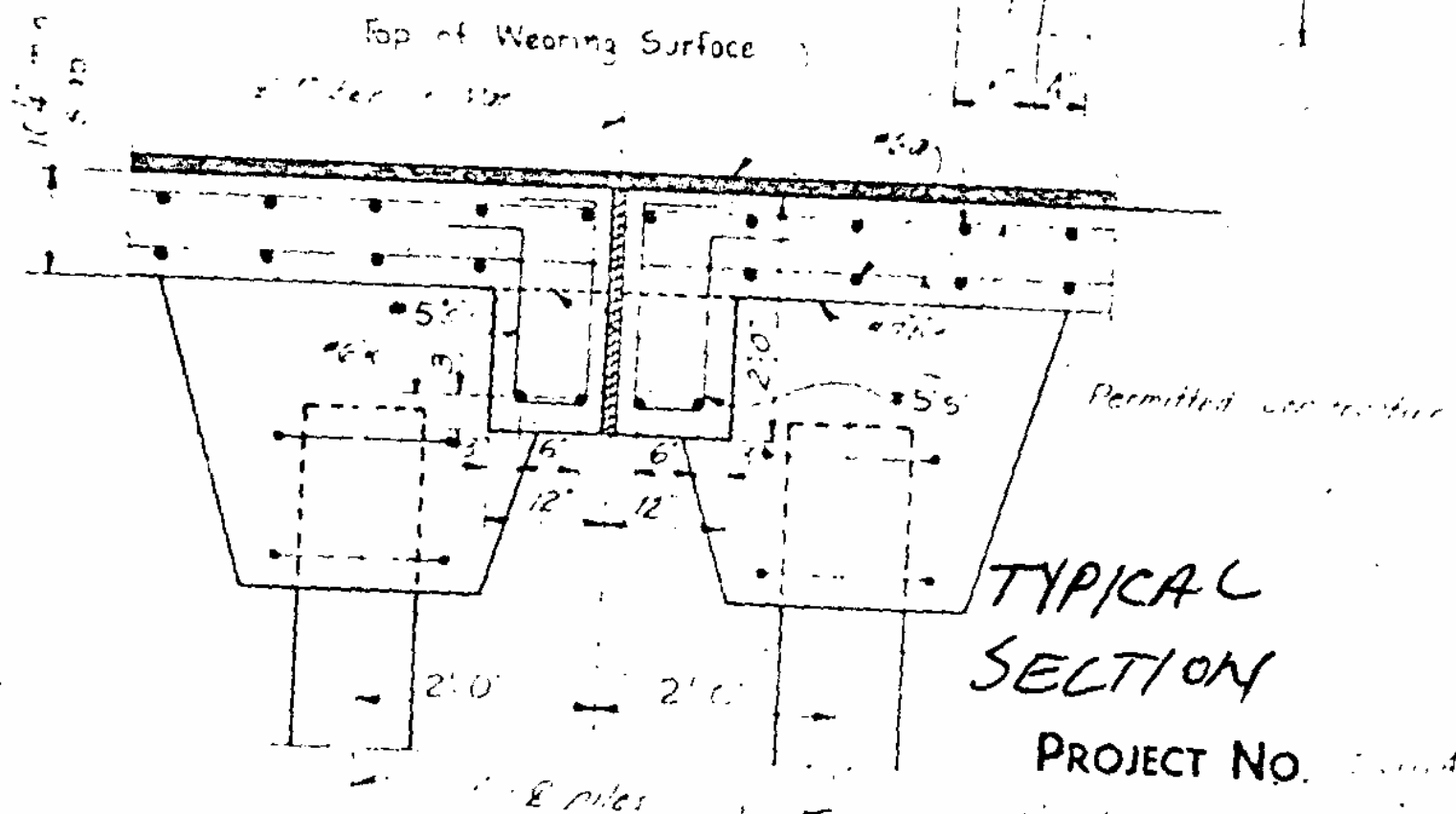
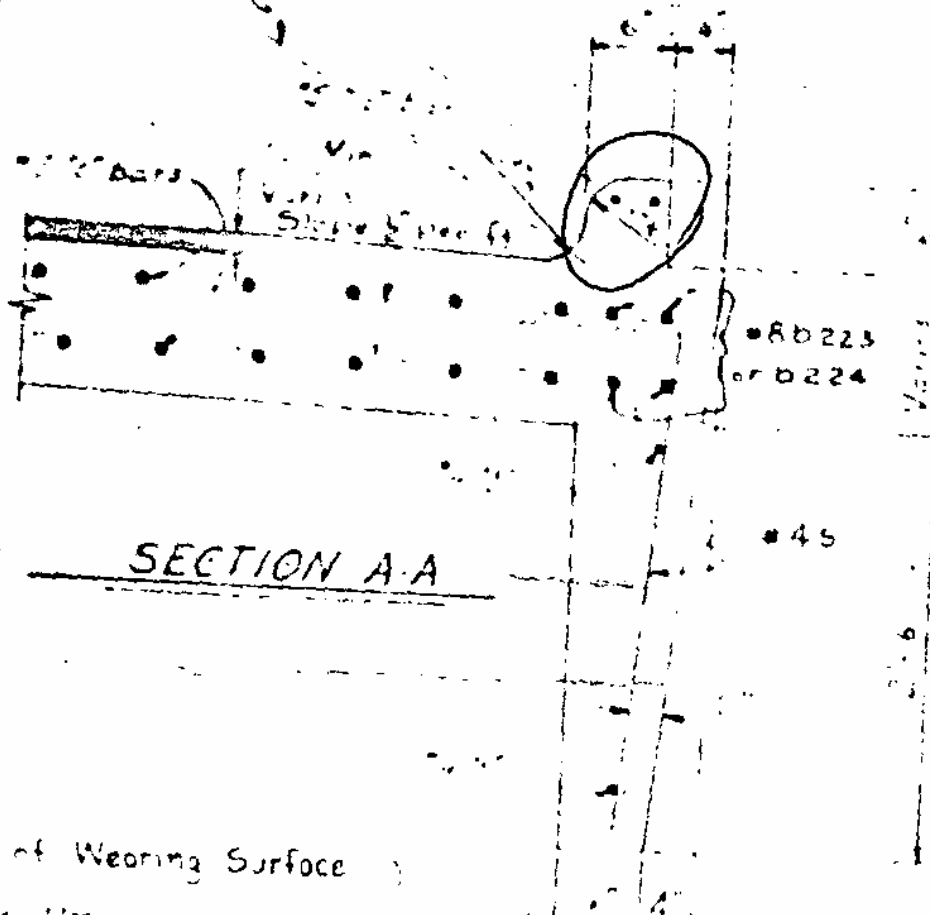

TYPICAL SECTION

PROJECT NO. _____

STATION: 99+76.3

Sheet 2 of 3 = 2+000

STATE OF NORTH CAROLINA
DEPARTMENT OF TRANSPORTATION

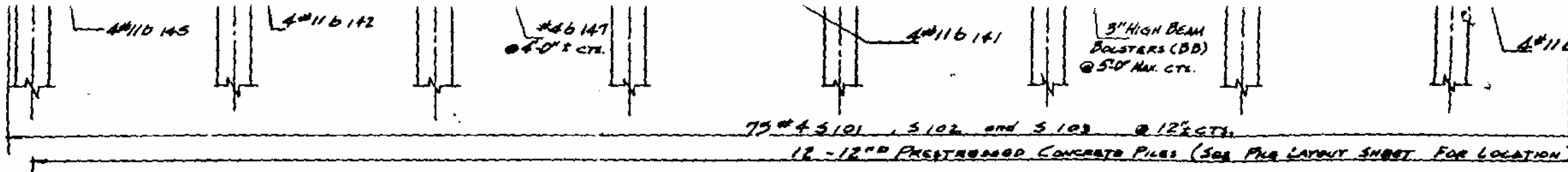

END ELEVATION
END BENT No. 1

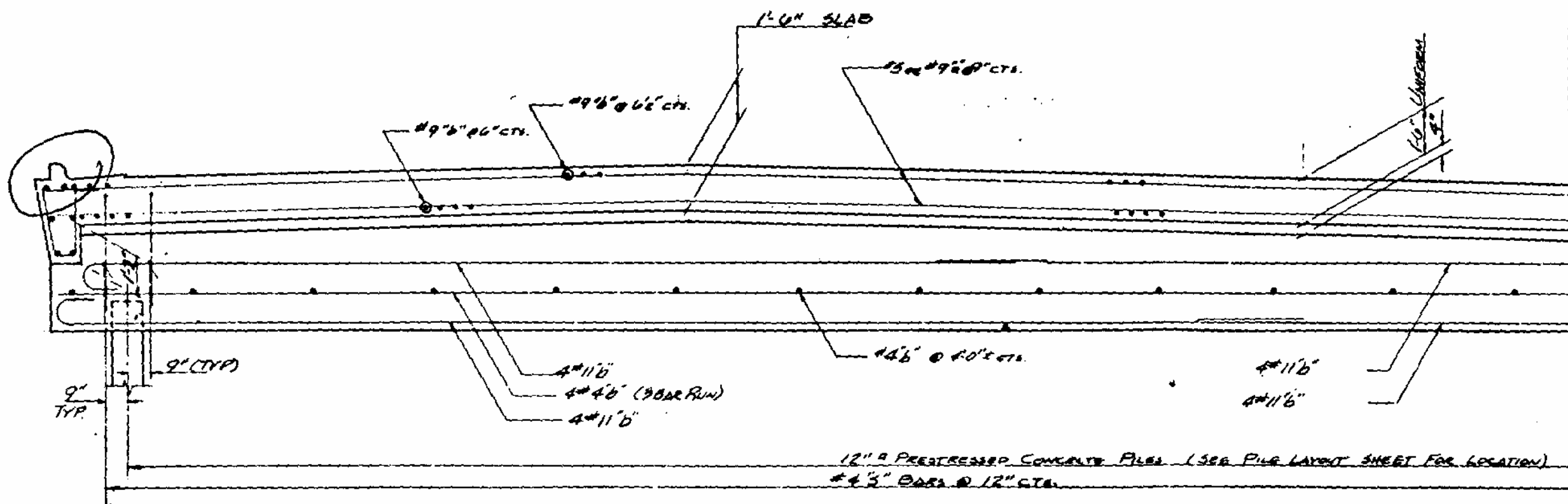

TYPICAL SECTION
FIXED BENT
SINGLE ROW PILES

*BR. # 20
PARQUOSANK*

DATE 7-1-91
DATE 11-1-91

Post-it® Fax Note 7671

Date	12-11-91	# of pages	1
From	FRED MAIN		
To	BOBBY BR. MAIN		
Co./Dept.	WILLIAMSON		
Phone #	R. P. [unclear]		
Fax #			

PLAN OF END POST
SHOWING REINFORCEMENT

PLAN OF POST
SHOWING REINFORCEMENT

GENERAL NOTE
No construction joints permitted, except as shown.
Piling under Abutment footing to be untreated.
Piling under approach slab shall be impregnated with at least 18 lbs. of preservative oil per cu. ft. See Specifications.
For further GENERAL NOTE see sheet N&Z.

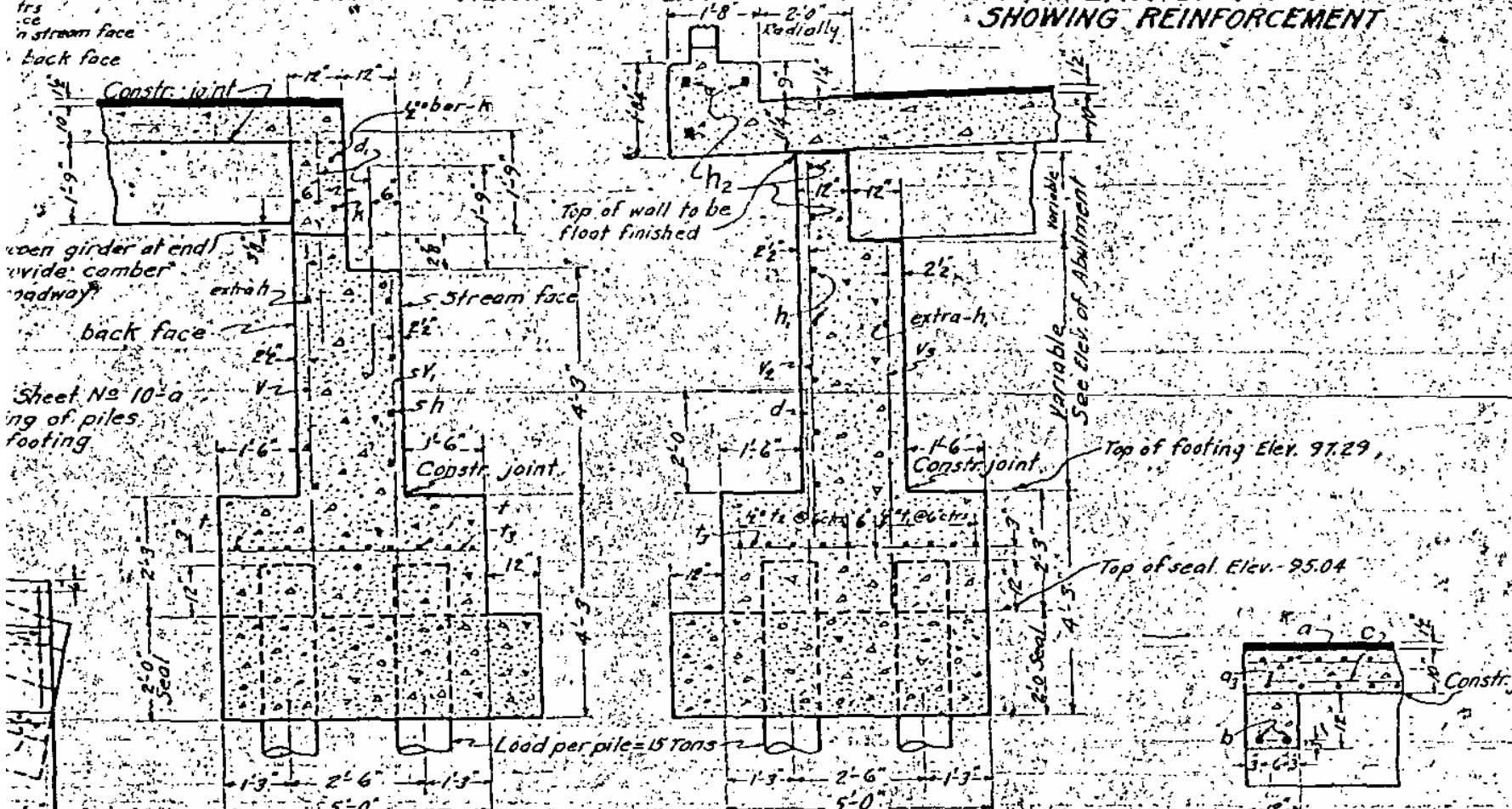

SECTION A-A

SECTION B-B

SECTION E-E

SECTION D-D

SECTION F-F

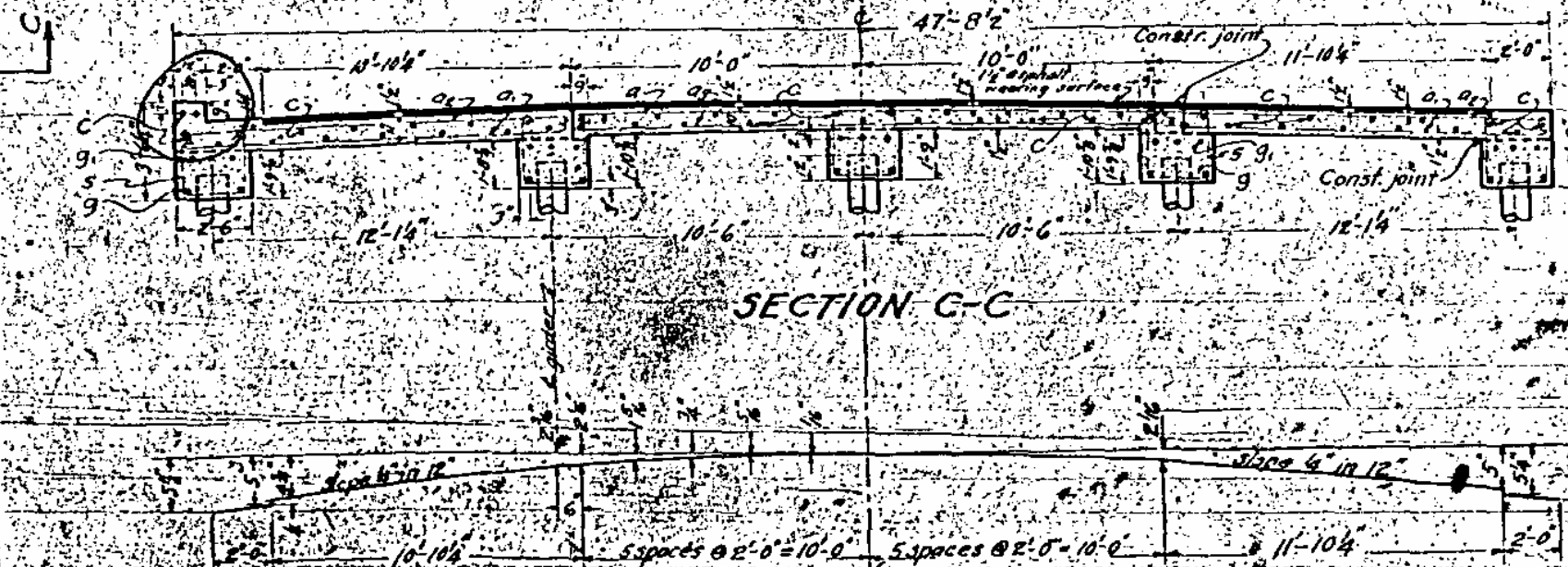

DETAIL OF CROWN
FOR SECT. C-C

Handwritten: P. 19
PASQUOTANK

PROJECT NO. 1720
PASQUOTANK COUNTY
STATION 18+10
ABUTMENT A & APPROACH SLAB
PROPOSITION No. 1

STATE OF NORTH CAROLINA
STATE HIGHWAY COMMISSION

SPECIAL DETAIL OF
ABUTMENT A & APPROACH SLAB
FOR
ELIZABETH CITY BRIDGE
OVER
PASQUOTANK RIVER
OCTOBER 1930

DESIGNED BY *W. L. Craven*
APPROVED BY *John H. Wells*

PLAN NO. 78-17-24
APR 12 1930

STANDARD NO.

of filling station West End of bridge Elev. 105.10
of handrail and detail of slab 11/31 A.J.C. by L.C.D.