

STATE OF NORTH CAROLINA  
DIVISION OF HIGHWAYS

**TRANSPORTATION MANAGEMENT PLAN**  
**MACON COUNTY**

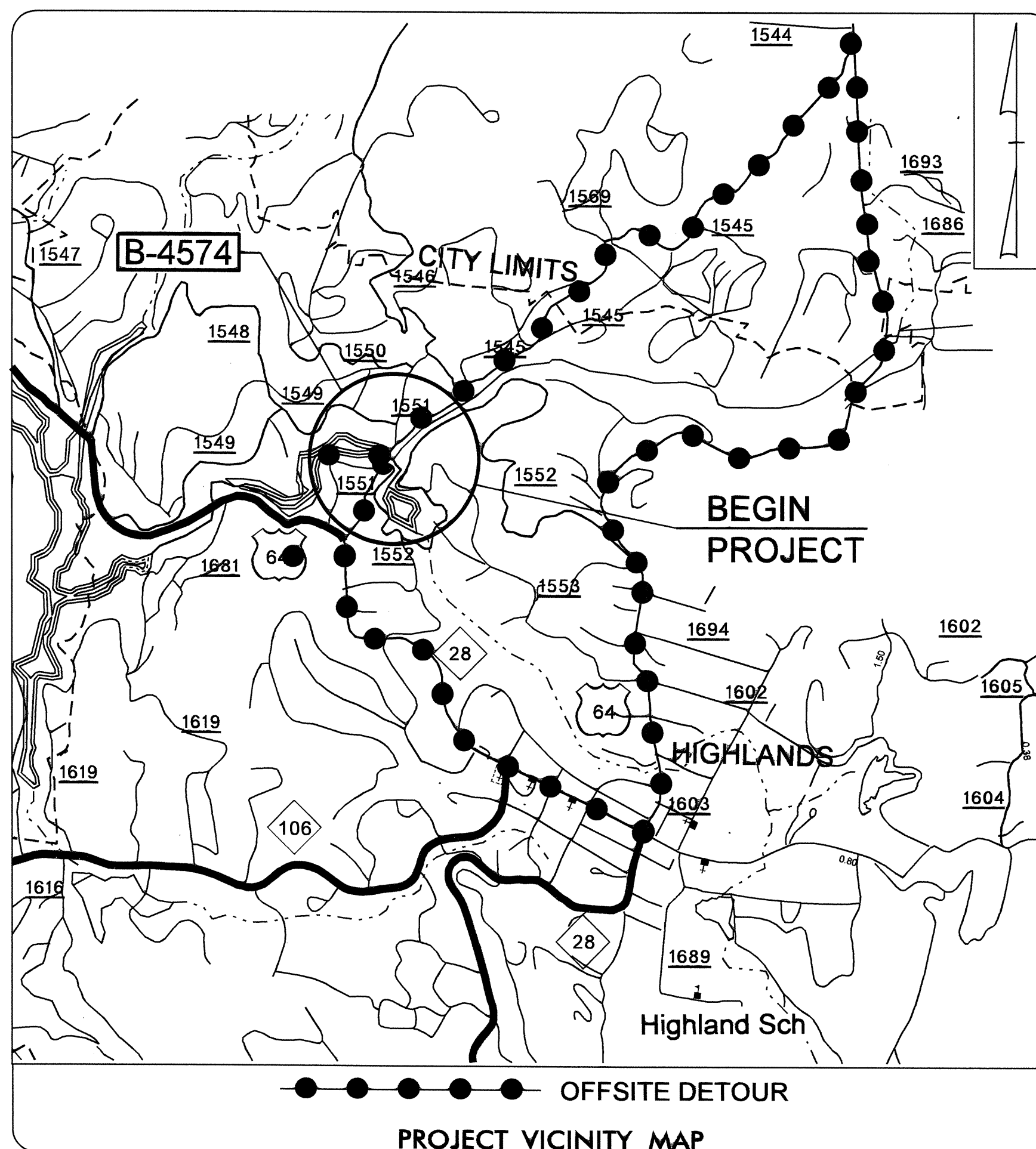

**INDEX OF SHEETS**

SHEET NO.	TITLE
TMP-1	TITLE SHEET, LEGEND AND INDEX OF SHEETS
TMP-1A	LIST OF APPLICABLE ROADWAY STANDARD DRAWINGS, TRANSPORTATION OPERATIONS PLAN (MANAGEMENT STRATEGIES AND GENERAL NOTES) AND PROJECT PHASING
TMP-2	DETOUR ROUTE AND SIGNING FOR SR 1551
SD-1	SPECIAL SIGN DESIGN

**LEGEND**

GENERAL

- NORTH ARROW
- WORK AREA

TRAFFIC CONTROL DEVICES

- BARRICADE (TYPE III)

TEMPORARY SIGNING

- STATIONARY SIGN

29-NOV-2010 11:56 \\dot\dfsroot\TIPProjects-B\B4574\TrafficControl\TCP\B4574.tc.tcp.0.dgn dougjoyner AT WZTC244749

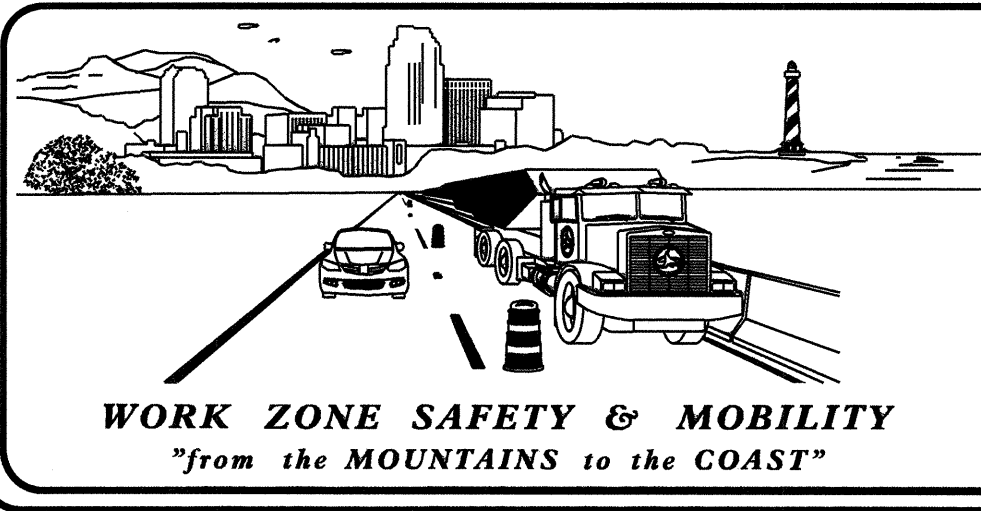

**N.C.D.O.T. WORK ZONE TRAFFIC CONTROL**  
1580 MAIL SERVICE CENTER (MSC) RALEIGH, NC 27699-1580  
1020 BIRCH RIDGE DRIVE, RALEIGH, NC 27610 (DELIVERY)  
PHONE: (919) 250-4094 FAX: (919) 250-4098

J. S. BOURNE, P.E. STATE TRAFFIC MANAGEMENT ENGINEER  
STEVE KITE, P.E. TRAFFIC CONTROL PROJECT ENGINEER  
DON PARKER TRAFFIC CONTROL PROJECT DESIGN ENGINEER  
DOUG JOYNER TRAFFIC CONTROL DESIGN ENGINEER /TECHNICIAN

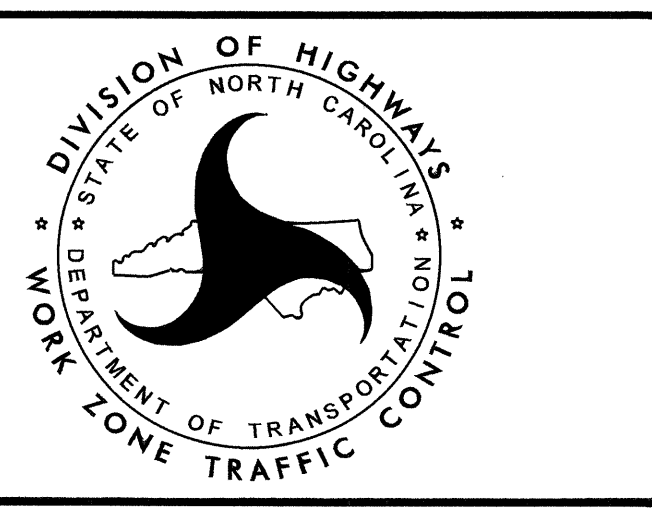

APPROVED:   
DATE: November 29, 2010

SEAL

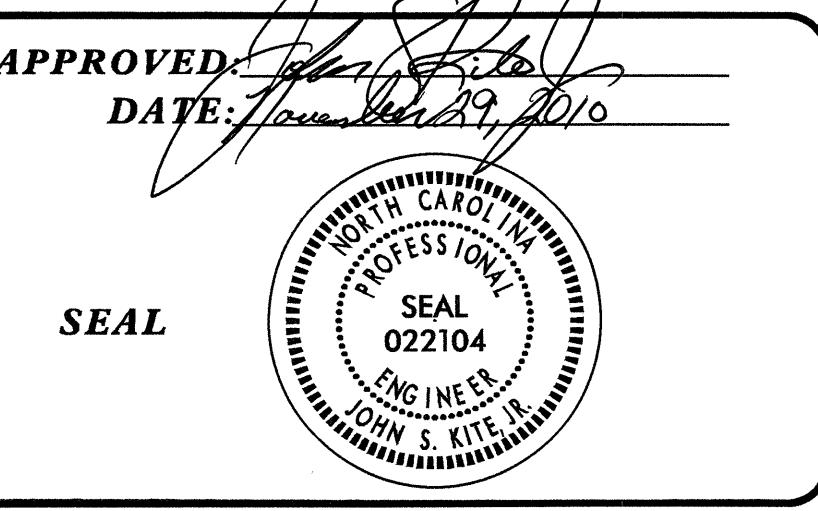

**B-4574**  
**TIP PROJECT:**

SHEET NO.  
TMP-1

## ROADWAY STANDARD DRAWINGS

THE FOLLOWING ROADWAY STANDARDS AS SHOWN IN "ROADWAY STANDARD DRAWINGS" - PROJECT SERVICES UNIT - N.C. DEPARTMENT OF TRANSPORTATION - RALEIGH, N.C., DATED JULY 2006 ARE APPLICABLE TO THIS PROJECT AND BY REFERENCE HEREBY ARE CONSIDERED A PART OF THESE PLANS:

<u>STD. NO.</u>	<u>TITLE</u>
1101.03	TEMPORARY ROAD CLOSURES
1110.01	STATIONARY WORK ZONE SIGNS
1145.01	BARRICADES
1261.01	GUARDRAIL & BARRIER DELINEATOR SPACING
1261.02	GUARDRAIL & BARRIER DELINEATOR TYPES
1262.01	GUARDRAIL END DELINEATION
1264.01	OBJECT MARKERS
1264.02	PLACEMENT OF OBJECT MARKERS

## GENERAL NOTES / LOCAL NOTES

CHANGES MAY BE REQUIRED WHEN PHYSICAL DIMENSIONS IN THE DETAIL DRAWINGS, STANDARD DETAILS, AND ROADWAY DETAILS ARE NOT ATTAINABLE TO MEET FIELD CONDITIONS OR RESULT IN DUPLICATE OR UNDESIRED OVERLAPPING OF DEVICES. MODIFICATION MAY INCLUDE: MOVING, SUPPLEMENTING, COVERING, OR REMOVAL OF DEVICES AS DIRECTED BY THE ENGINEER.

THE FOLLOWING GENERAL NOTES APPLY AT ALL TIMES FOR THE DURATION OF THE CONSTRUCTION PROJECT EXCEPT WHEN OTHERWISE NOTED IN THE PLAN OR DIRECTED BY THE ENGINEER.

### TRAFFIC PATTERN ALTERATIONS

- A) NOTIFY THE ENGINEER TWENTY ONE (21) CALENDAR DAYS PRIOR TO ANY TRAFFIC PATTERN ALTERATION.

### SIGNING

- B) CONTRACTOR WILL BE RESPONSIBLE FOR PROVIDING PERMANENT SIGNING.  
 C) PROVIDE SIGNING AND DEVICES REQUIRED TO CLOSE THE ROAD ACCORDING TO THE ROADWAY STANDARD DRAWINGS AND TRAFFIC CONTROL PLANS.

PROVIDE SIGNING REQUIRED FOR THE OFF-SITE DETOUR ROUTE AS SHOWN IN THE TRAFFIC CONTROL PLANS.

- D) COVER OR REMOVE ALL SIGNS AND DEVICES REQUIRED TO CLOSE THE ROAD WHEN ROAD CLOSURE IS NOT IN OPERATION.  
 COVER OR REMOVE ALL SIGNS REQUIRED FOR THE OFF-SITE DETOUR WHEN THE DETOUR IS NOT IN OPERATION.  
 E) ENSURE ALL NECESSARY SIGNING IS IN PLACE PRIOR TO ALTERING ANY TRAFFIC PATTERN.

### TRAFFIC CONTROL DEVICES

- F) PLACE TYPE III BARRICADES, WITH "ROAD CLOSED" SIGN R11-2 ATTACHED, OF SUFFICIENT LENGTH TO CLOSE ENTIRE ROADWAY.



### PAVEMENT MARKINGS AND MARKERS

- G) INSTALL PAVEMENT MARKINGS AND PAVEMENT MARKERS ON THE FINAL SURFACE AS SHOWN IN THE PAVEMENT MARKING PLAN.

## PROJECT PHASING

- 1) USING ROADWAY STANDARD DRAWING 1101.03, SHEET 1 OF 9 & TMP-2, INSTALL ALL OFF-SITE DETOUR SIGNS; CLOSE SR 1551 AND DETOUR TRAFFIC. INSTALL TYPE III BARRICADES ON CULLASAJA DRIVE ON THE EAST SIDE OF THE BRIDGE.
- 2) REMOVE EXISTING BRIDGE AND CONSTRUCT PROPOSED BRIDGE AND APPROACHES, UP TO AND INCLUDING THE FINAL LAYER OF SURFACE COURSE.
- 3) PLACE FINAL PAVEMENT MARKINGS/MARKERS AS PER FINAL PAVEMENT MARKING PLANS. REMOVE ALL TRAFFIC CONTROL DEVICES AND RE-OPEN SR 1551 TO TRAFFIC.

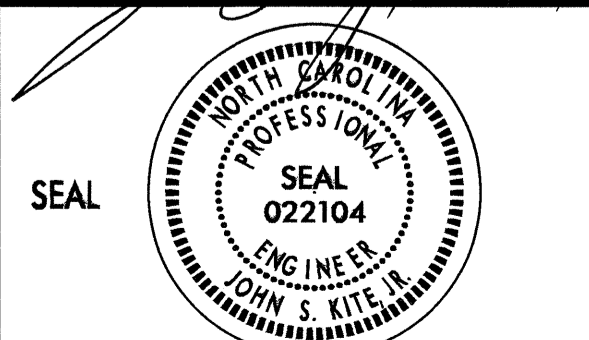
29-NOV-2010 11:56  
 \\dot.dfsr\001\p\Projects\B\4574\TrafficControl\TCP\B4574.tc\_top.01.dgn  
 AT WZTC244749  
 doug.j.yner

APPROVED:  DATE: 11/29/10 		<b>TRANSPORTATION          OPERATIONS PLAN,          ROADWAY STANDARD          DRAWINGS AND          PROJECT PHASING</b>
---	---	--

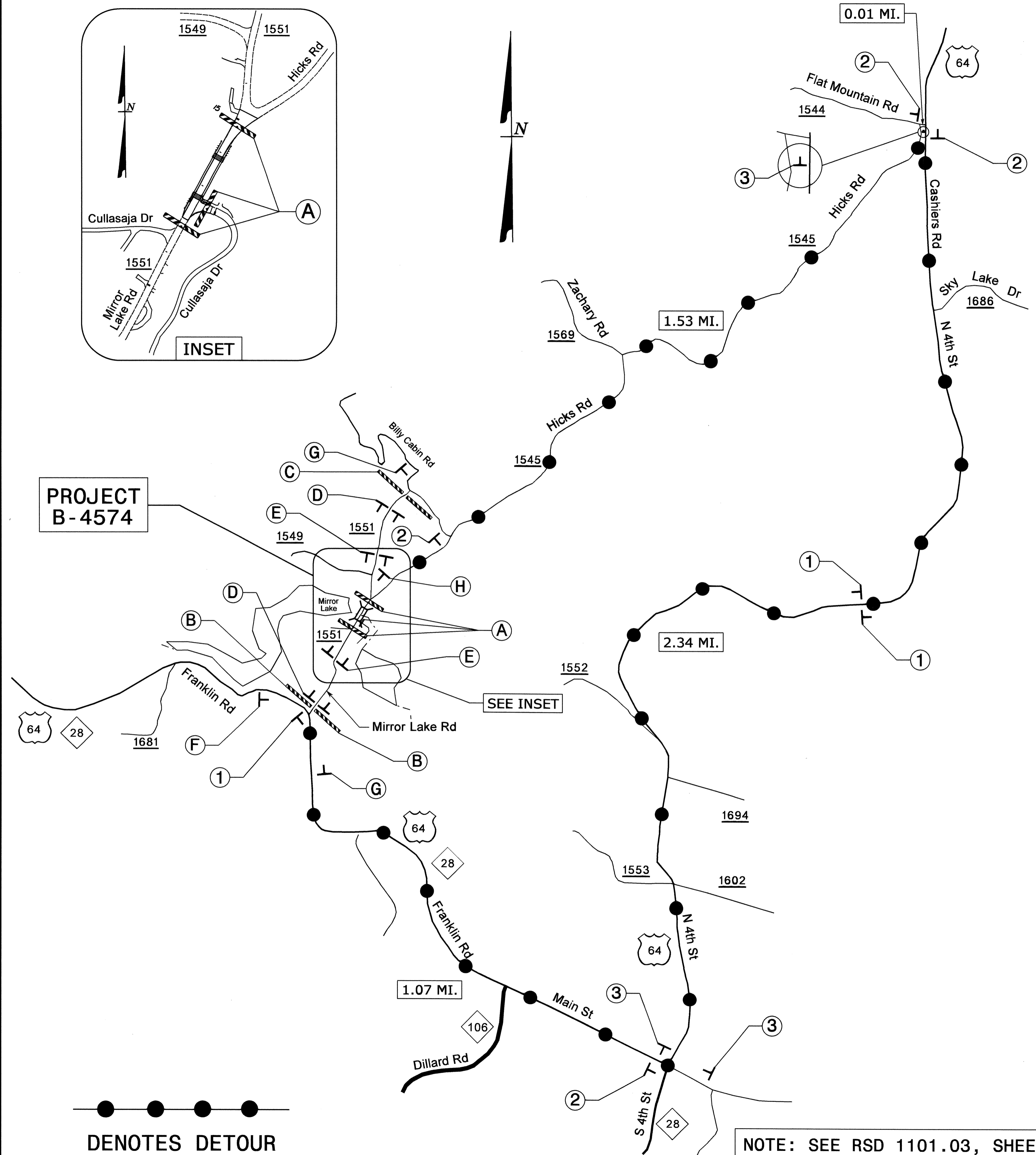
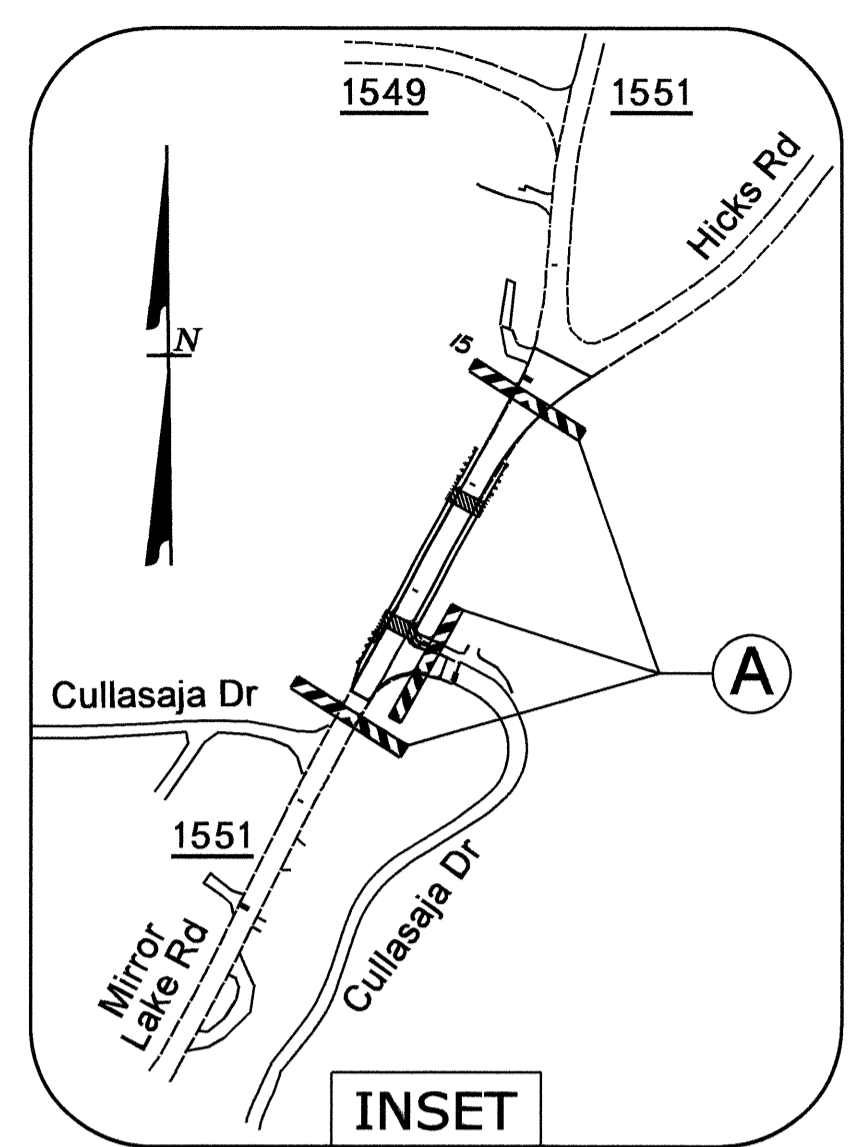

NOTE: SEE RSD 1101.03, SHEET 1 OF 9 FOR ADVANCE WARNING SIGNAGE AND BARRICADE PLACEMENT

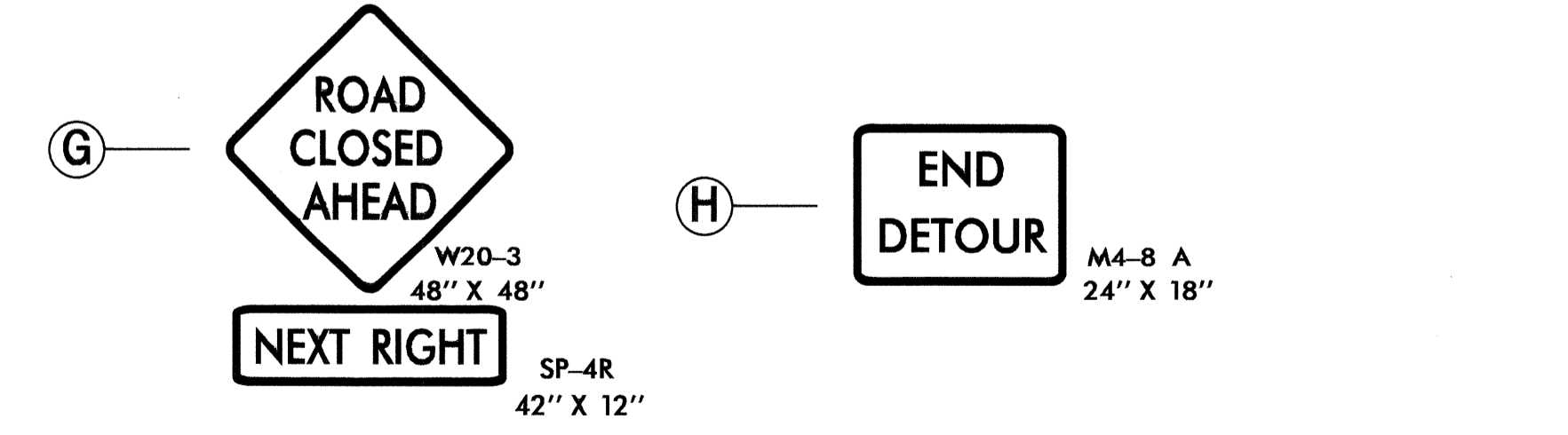
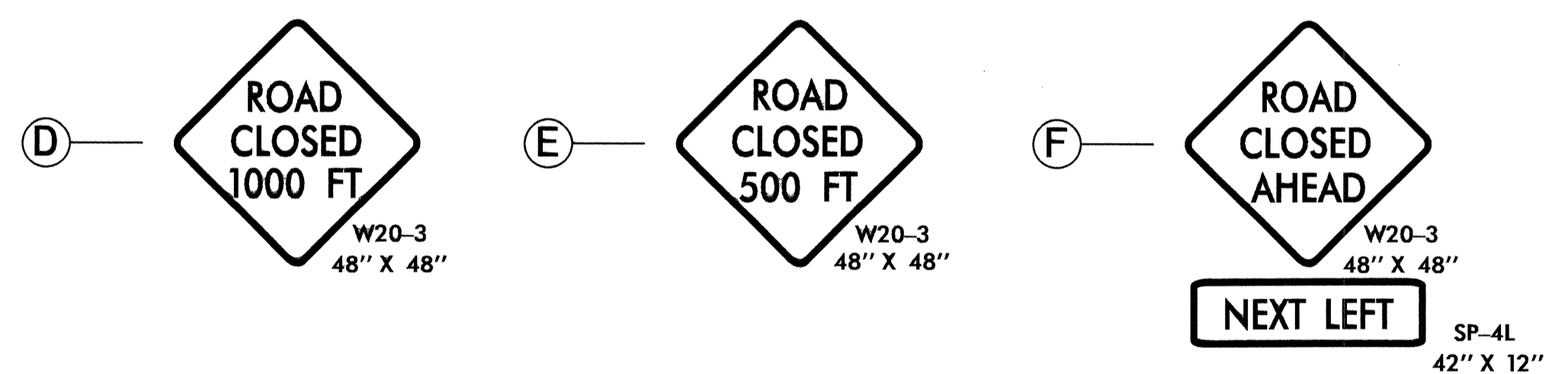
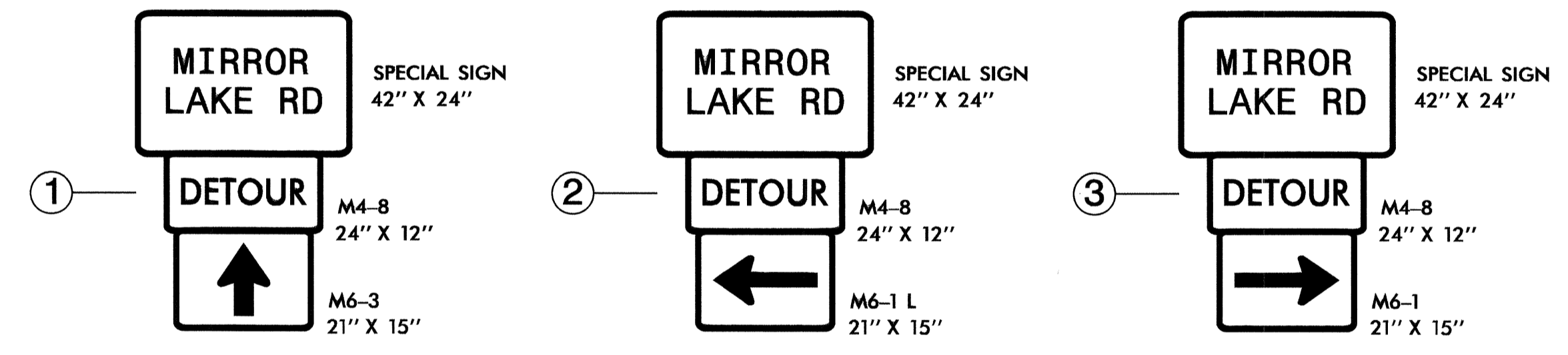
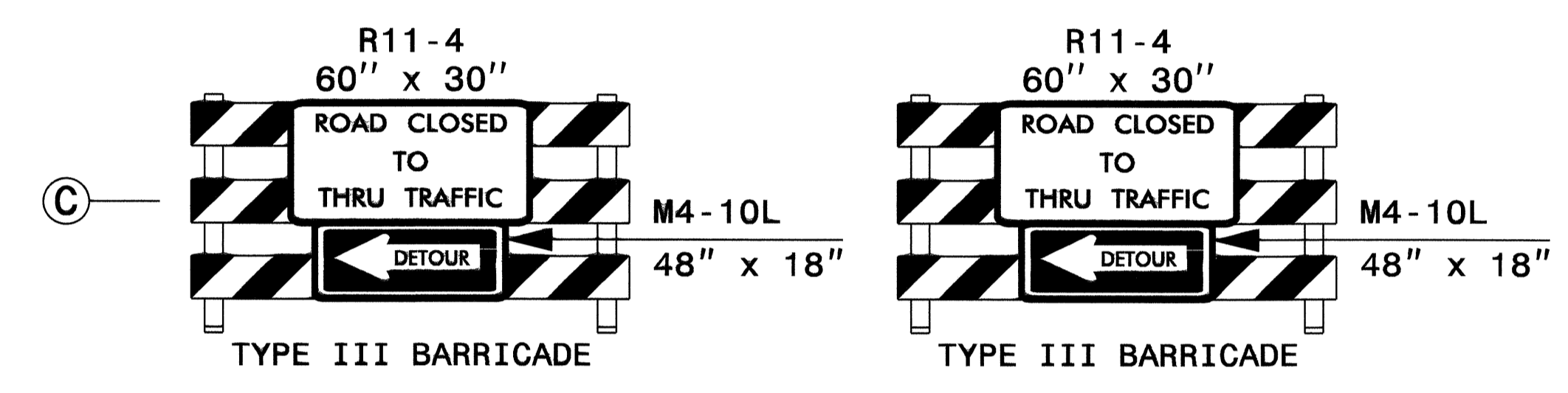
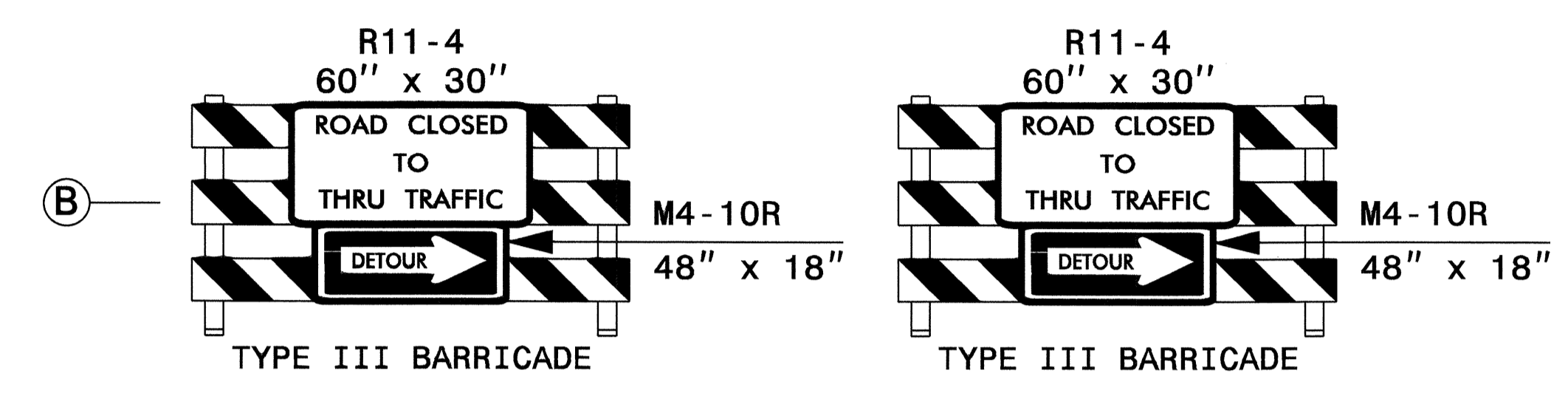
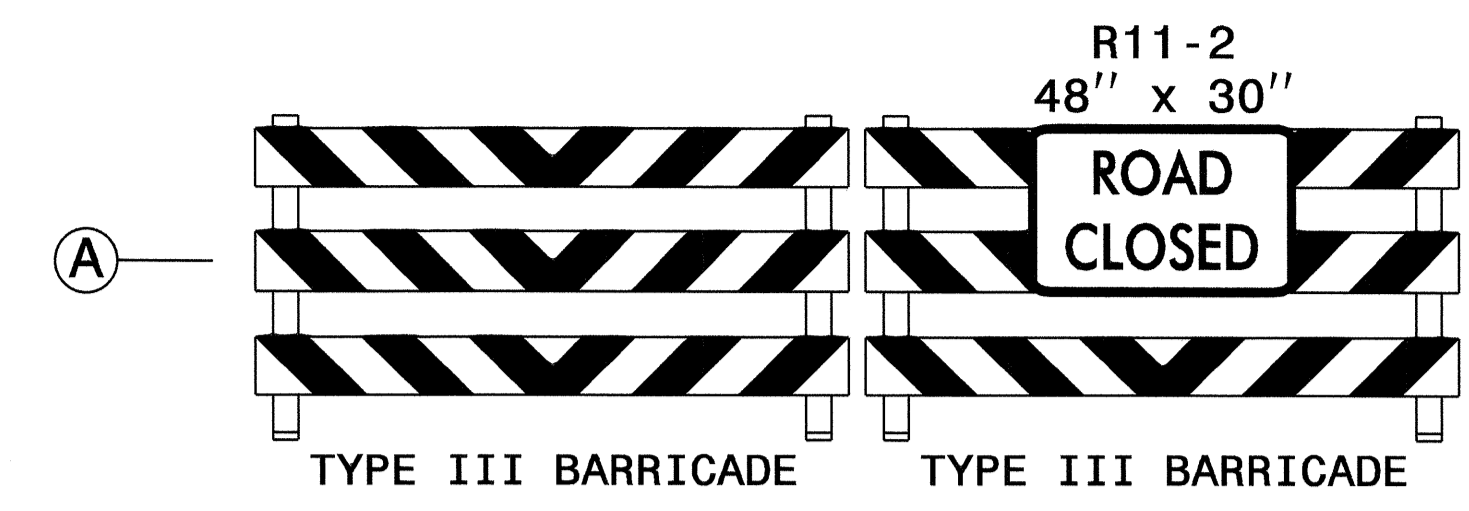

APPROVED: *[Signature]* DATE: 11/27/10  
 SEAL  
 NORTH CAROLINA PROFESSIONAL SEAL 022104  
 JOHN S. HITE, II  
 ENGINEER

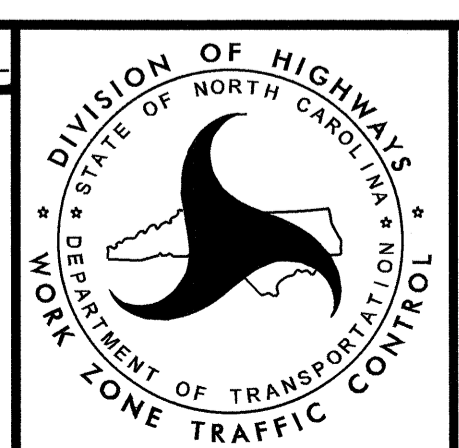

DETOUR ROUTE AND SIGNING

29-NOV-2010 12:26 \\dot\dfs\of01\p\proj\TIP\Projects-B\B4574\TrafficControl\TCP\B4574.tc.tcp.02.dgn doug.byner AT WZTC244749