

**STATE OF NORTH CAROLINA
DEPARTMENT OF TRANSPORTATION**

**PAVEMENT MARKING PLAN
MACON COUNTY**

**LOCATION: BRIDGE No. 58 OVER THE CULLASAJA RIVER
ON SR 1551 (MIRROR LAKE ROAD)**

TIP NO. B-4574	SHEET NO. PMP-1
APPROVED:	
DATE: 11-3-10	
SEAL 	

T.I.P.: B-4574

CONTRACT:

ROADWAY STANDARD DRAWING

THE FOLLOWING ROADWAY STANDARDS AS APPEAR IN "ROADWAY STANDARD DRAWINGS" - PROJECT SERVICES UNIT - N.C. DEPARTMENT OF TRANSPORTATION - RALEIGH, N.C., DATED JULY 2006 ARE APPLICABLE TO THIS PROJECT AND BY REFERENCE HEREBY ARE CONSIDERED A PART OF THESE PLANS:

STD. NO.	TITLE
1205.01	PAVEMENT MARKINGS - LINE TYPES AND OFFSETS
1205.02	PAVEMENT MARKINGS - 2 LANE AND MULTILANE ROADWAYS
1205.12	PAVEMENT MARKINGS - BRIDGES
1261.01	GUARDRAIL AND BARRIER DELINEATOR SPACING
1261.02	GUARDRAIL AND BARRIER DELINEATOR TYPES
1262.01	GUARDRAIL END DELINEATION

GENERAL NOTES

THE FOLLOWING GENERAL NOTES APPLY AT ALL TIMES FOR THE DURATION OF THE CONSTRUCTION PROJECT, EXCEPT WHEN OTHERWISE NOTED IN THE PLAN, OR DIRECTED BY THE ENGINEER.

- A) INSTALL PAVEMENT MARKINGS AND PAVEMENT MARKERS ON THE FINAL SURFACE AS FOLLOWS:
- | ROAD NAME | MARKING | MARKER |
|-------------------------|---------|--------|
| SR 1551 MIRROR LAKE RD. | PAINT | NONE |
- B) PLACE TWO APPLICATIONS OF PAINT PAVEMENT MARKINGS ON THE FINAL WEARING SURFACE. PLACE THE SECOND APPLICATION OF PAINT UPON SUFFICIENT DRYING TIME OF THE FIRST.
 - C) TIE PROPOSED PAVEMENT MARKING LINES TO EXISTING PAVEMENT MARKING LINES.
 - D) REMOVE/REPLACE ANY CONFLICTING/DAMAGED PAVEMENT MARKINGS AND MARKERS.
 - E) PASSING ZONES WILL BE DETERMINED IN THE FIELD AND MUST BE APPROVED BY THE ENGINEER.

INDEX

SHEET NO.	DESCRIPTION
PMP-1	PAVEMENT MARKING PLAN TITLE SHEET
PMP-2	PAVEMENT MARKING SCHEDULE AND PAVEMENT MARKING DETAIL

PLAN PREPARED BY: N.C.D.O.T. SIGNING AND DELINEATION UNIT

<u>AYMAN I. ALQUDWAH, P.E.</u>	SIGNING & DELINEATION REGIONAL ENGINEER
<u>DERRICK H. BEARD</u>	SIGNING & DELINEATION PROJECT DESIGN ENGINEER

TIP NO.	SHEET NO.
B-4574	PMP-2
APPROVED: <i>[Signature]</i>	
DATE: 11-3-10	
SEAL	

B-4574 FINAL PAVEMENT MARKING SCHEDULE

SYMBOL	DESCRIPTION
	FINAL PAVEMENT MARKINGS
	PAINT (4")
PA	WHITE EDGELINE
PD	2 FT. WHITE MINISKIP
PI	YELLOW DOUBLE CENTER

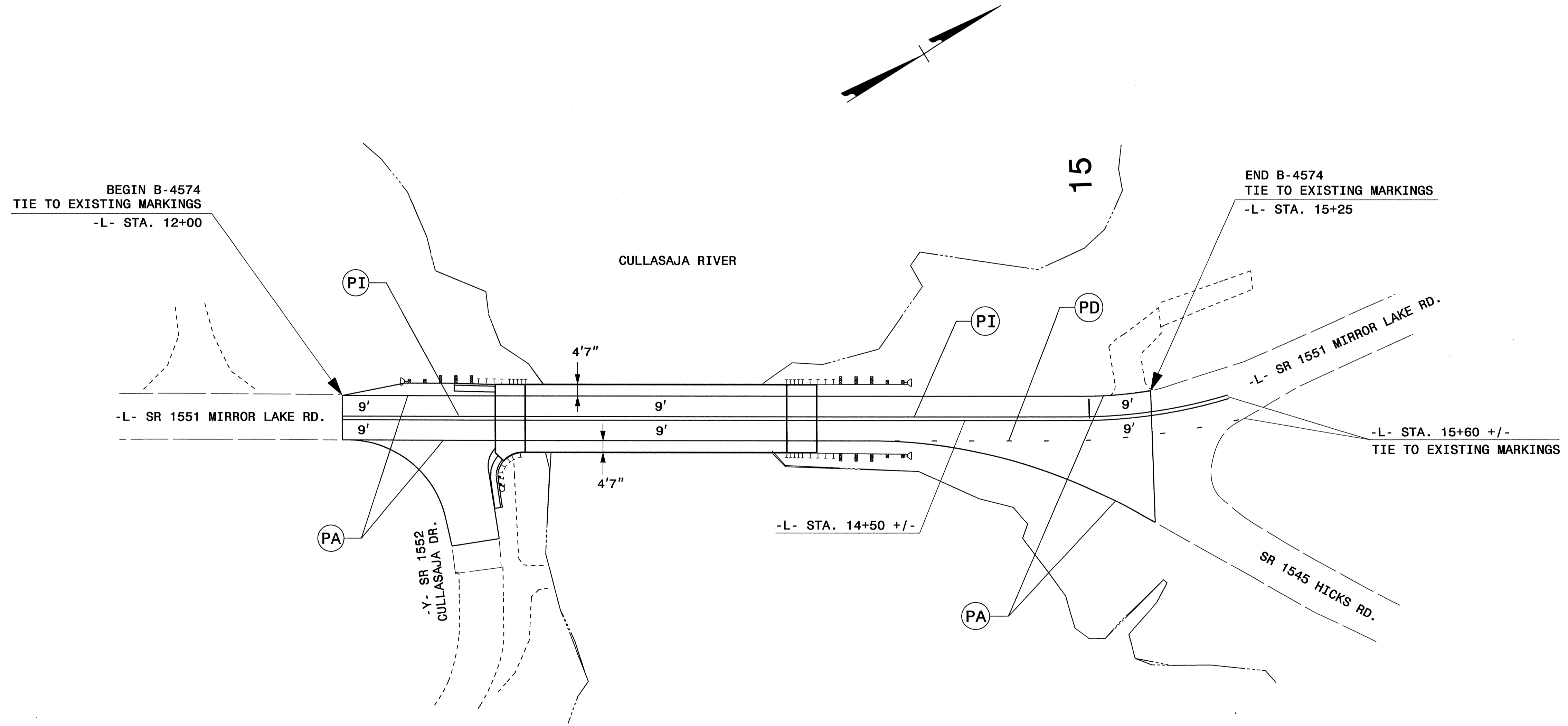

PAVEMENT MARKING SCHEDULE AND PAVEMENT MARKING DETAIL

03-NOV-2010 10:43
 R:\TranFic\Signing\CADD\PM\B-4574_Sgn_PMP_2.dgn
 AT WZ1244736
 dhbeard