

CONTRACT: 35196.1.2 T.I.P.: X-0002CA

3/23/2010 P:\TRAFFIC\Sub\Jobs\X-2ca\X-2ca\1007\X2ca_TC_pmp01.dgn Florence & Hutcheson, Inc.

**STATE OF NORTH CAROLINA
DEPARTMENT OF TRANSPORTATION**

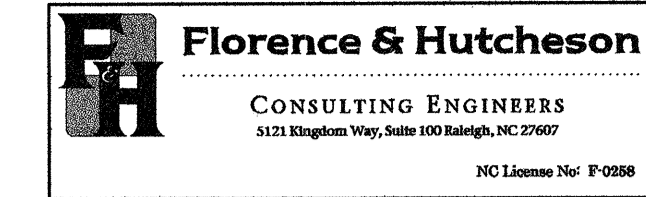

TIP NO. X-0002CA	SHEET NO. PMP-1
APPROVED: <i>Michael T. Korman</i>	
DATE: 3-29-10	
SEAL	

**PAVEMENT MARKING PLAN
CUMBERLAND COUNTY**

**LOCATION: NC 24 EXTENSION (FAYETTEVILLE OUTER LOOP)
FROM 1.3 MILES EAST OF NC 87-NC 210 (MURCHISON RD.)
TO EAST OF SR 1600 (McARTHUR RD.)**

GENERAL NOTES

THE FOLLOWING GENERAL NOTES APPLY AT ALL TIMES FOR THE DURATION OF THE CONSTRUCTION PROJECT, EXCEPT WHEN OTHERWISE NOTED IN THE PLAN, OR DIRECTED BY THE ENGINEER.

- A) INSTALL PAVEMENT MARKINGS AND PAVEMENT MARKERS ON THE FINAL SURFACE AS FOLLOWS:

ROAD NAME	MARKING	MARKER
McARTHUR RD. (-Y-) BRIDGE DECKS	THERMOPLASTIC COLD APPLIED (TYPE 3 - PERMANENT WET REFLECTIVE)	SNOWPLOWABLE PERMANENT RAISED
ALL OTHER ROADS	PAINT	NONE
- B) PLACE TWO APPLICATIONS OF PAINT PAVEMENT MARKINGS ON THE FINAL WEARING SURFACE. PLACE THE SECOND APPLICATION OF PAINT UPON SUFFICIENT DRYING TIME OF THE FIRST.
- C) TIE PROPOSED PAVEMENT MARKING LINES TO EXISTING PAVEMENT MARKING LINES.
- D) REMOVE/REPLACE ANY CONFLICTING/DAMAGED PAVEMENT MARKINGS AND MARKERS.
- E) STOPBAR LOCATION AT NON-SIGNALIZED INTERSECTIONS MAY BE ADJUSTED AS DIRECTED BY THE ENGINEER.
- F) REMOVE ALL RESIDUE AND SURFACE LAITANCE BY ACCEPTABLE METHODS ON THE BRIDGE DECK(S) PRIOR TO PLACING COLD APPLIED (TYPE 3 - PERMANENT WET REFLECTIVE TAPE) PAVEMENT MARKING.

ROADWAY STANDARD DRAWING

THE FOLLOWING ROADWAY STANDARDS AS APPEAR IN "ROADWAY STANDARD DRAWINGS" - PROJECT SERVICES UNIT - N.C. DEPARTMENT OF TRANSPORTATION - RALEIGH, N.C., DATED JULY 2006 ARE APPLICABLE TO THIS PROJECT AND BY REFERENCE HEREBY ARE CONSIDERED A PART OF THESE PLANS:

STD. NO.	TITLE
1205.01	PAVEMENT MARKINGS - LINE TYPES AND OFFSETS
1205.02	PAVEMENT MARKINGS - 2 LANE AND MULTILANE ROADWAYS
1205.04	PAVEMENT MARKINGS - INTERSECTIONS
1205.05	PAVEMENT MARKINGS - TURN LANES
1205.06	PAVEMENT MARKINGS - THRU LANE DROPS
1205.08	PAVEMENT MARKINGS - SYMBOL AND WORD MESSAGES
1205.09	PAVEMENT MARKINGS - PAINTED ISLANDS
1250.01	PAVEMENT MARKER SPACING
1251.01	RAISED PAVEMENT MARKERS - TEMPORARY AND PERMANENT
1253.01	SNOWPLOWABLE RAISED PAVEMENT MARKERS
1261.01	GUARDRAIL AND BARRIER DELINEATOR SPACING
1261.02	GUARDRAIL AND BARRIER DELINEATOR TYPES
1262.01	GUARDRAIL END DELINEATION
1264.01	OBJECT MARKERS
1264.02	PLACEMENT OF OBJECT MARKERS

INDEX

SHEET NO.	DESCRIPTION
PMP-1	PAVEMENT MARKING PLAN TITLE SHEET
PMP-2	PAVEMENT MARKING SCHEDULE
PMP-3 THRU PMP-7	PAVEMENT MARKING DETAIL

FINAL PAV'T MARKING SCHEDULE

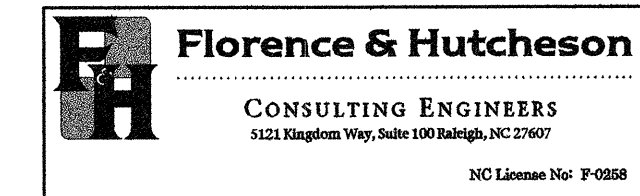

<small>TIP NO.</small> X-0002CA	<small>SHEET NO.</small> PMP-02
<small>APPROVED:</small> <i>Michael J. Replek</i>	
<small>DATE:</small> 3-29-10	
<small>SEAL</small>	

<u>SYMBOL</u>	<u>DESCRIPTION</u>	<u>PAY ITEM</u>
PAVEMENT MARKING LINES		
TA	WHITE EDGELINE	THERMOPLASTIC (100mm, 2.3mm)
TB	YELLOW EDGELINE	
TC	3m WHITE SKIP	THERMOPLASTIC (100mm, 3.1 mm)
TD	0.5m WHITE MINISKIP	
TE	WHITE SOLID LANE LINE	
TI	YELLOW DOUBLE CENTER LINE	
TP	WHITE GORELINE	THERMOPLASTIC (200mm, 2.3mm)
TT	YELLOW DIAGONAL	
T2	WHITE STOPBAR	THERMOPLASTIC (600mm, 3.1mm)
COLD APPLIED PLASTIC (100mm)TYPE3 - PERMANENT WET REFLECTIVE		
CA	WHITE EDGELINE	
CB	YELLOW EDGELINE	
CC	3m WHITE SKIP	
CD	0.5m WHITE MINISKIP	
PA	WHITE EDGELINE	PAINT (100mm)
PI	YELLOW DOUBLE CENTER LINE	
PAVEMENT MARKING SYMBOLS		
UA	LEFT TURN ARROW	THERMOPLASTIC SYMBOL
UB	RIGHT TURN ARROW	
UC	STRAIGHT ARROW	
UI	ALPHANUMERIC CHARACTER	THERMOPLASTIC CHARACTER
PAVEMENT MARKERS		
MB	CRYSTAL AND RED	PERMANENT RAISED
ME	YELLOW AND YELLOW	SNOWPLOWABLE RAISED
MF	CRYSTAL AND RED	

PAVEMENT MARKING DETAIL

3/23/2010
 P:\TRAFFIC\Sub-Jobs\X-2c\X-2ca\100\X2ca\TC_pmp02.dgn
 Florence & Hutcheson, Inc.



Florence & Hutcheson
 CONSULTING ENGINEERS
 5123 Kingston Way, Suite 100 Raleigh, NC 27607
 NC License No. P-0258

TIP NO. X-0002CA	SHEET NO. PMP-03
APPROVED: <i>M. J. Kelly</i>	
DATE: 3-29-10	
SEAL	
	

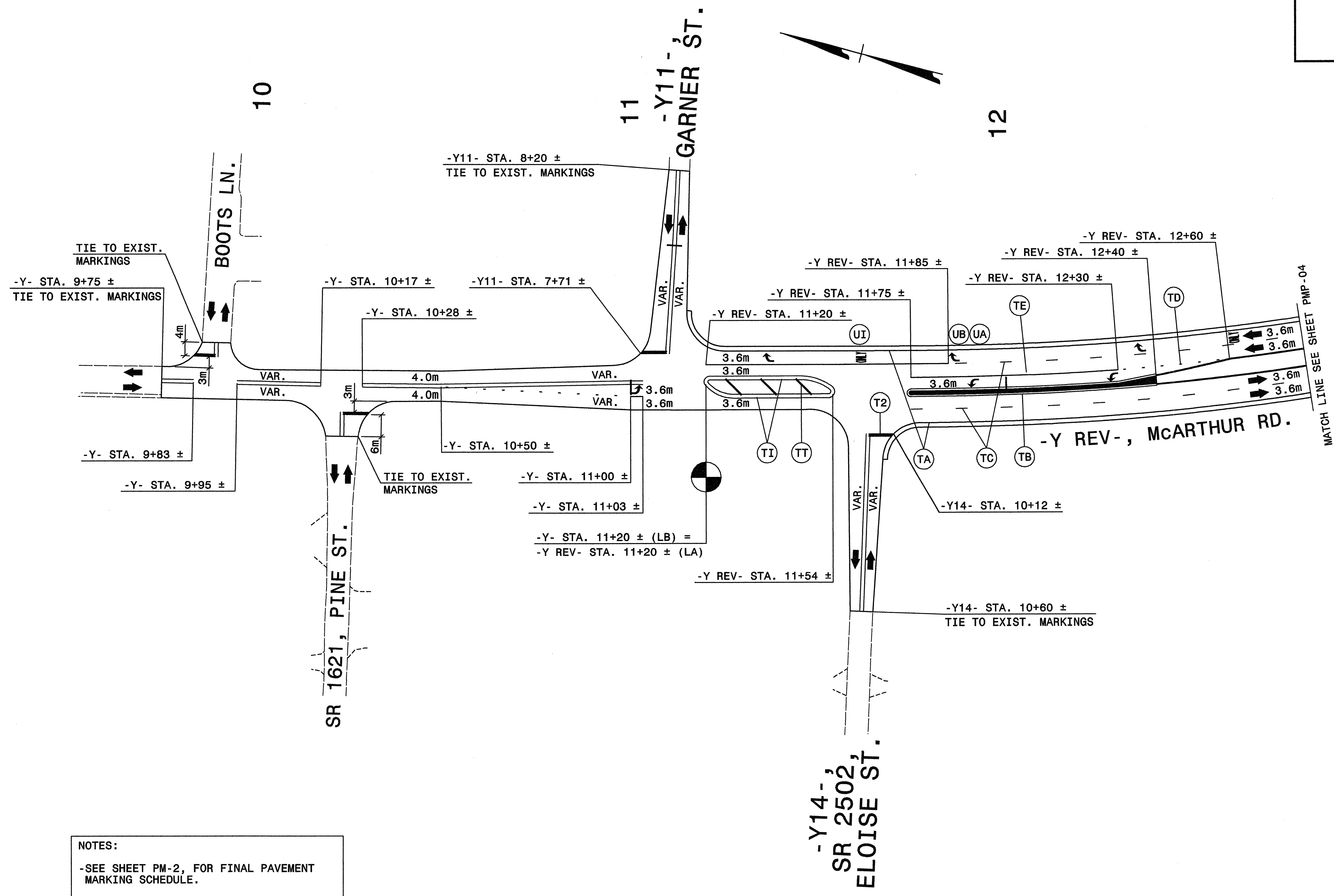

NOTES:

- SEE SHEET PM-2, FOR FINAL PAVEMENT MARKING SCHEDULE.
- PAVEMENT MARKINGS, SYMBOLS, AND CHARACTERS ARE TO BE MARKED ACCORDING TO ROADWAY STANDARD DRAWINGS UNLESS OTHERWISE NOTED IN THE PLANS.
- PAVEMENT MARKERS ARE TO BE SPACED ACCORDING TO THE ROADWAY STANDARD DRAWINGS.

PAVEMENT MARKING DETAIL

3/23/2010
 P:\TRAFFIC\Sub-Jobs\X-2e\X-2ca\100%\x2ca_TC_pmp03.dgn
 Florence & Hutcheson, Inc.



Florence & Hutcheson
 CONSULTING ENGINEERS
 1121 Flagstone Way, Suite 100 Raleigh, NC 27607
 NC License No: P-0258

TIP NO. X-0002CA	SHEET NO. PMP-04
APPROVED: <i>Michelle J. [Signature]</i>	
DATE: 3-29-10	
SEAL	

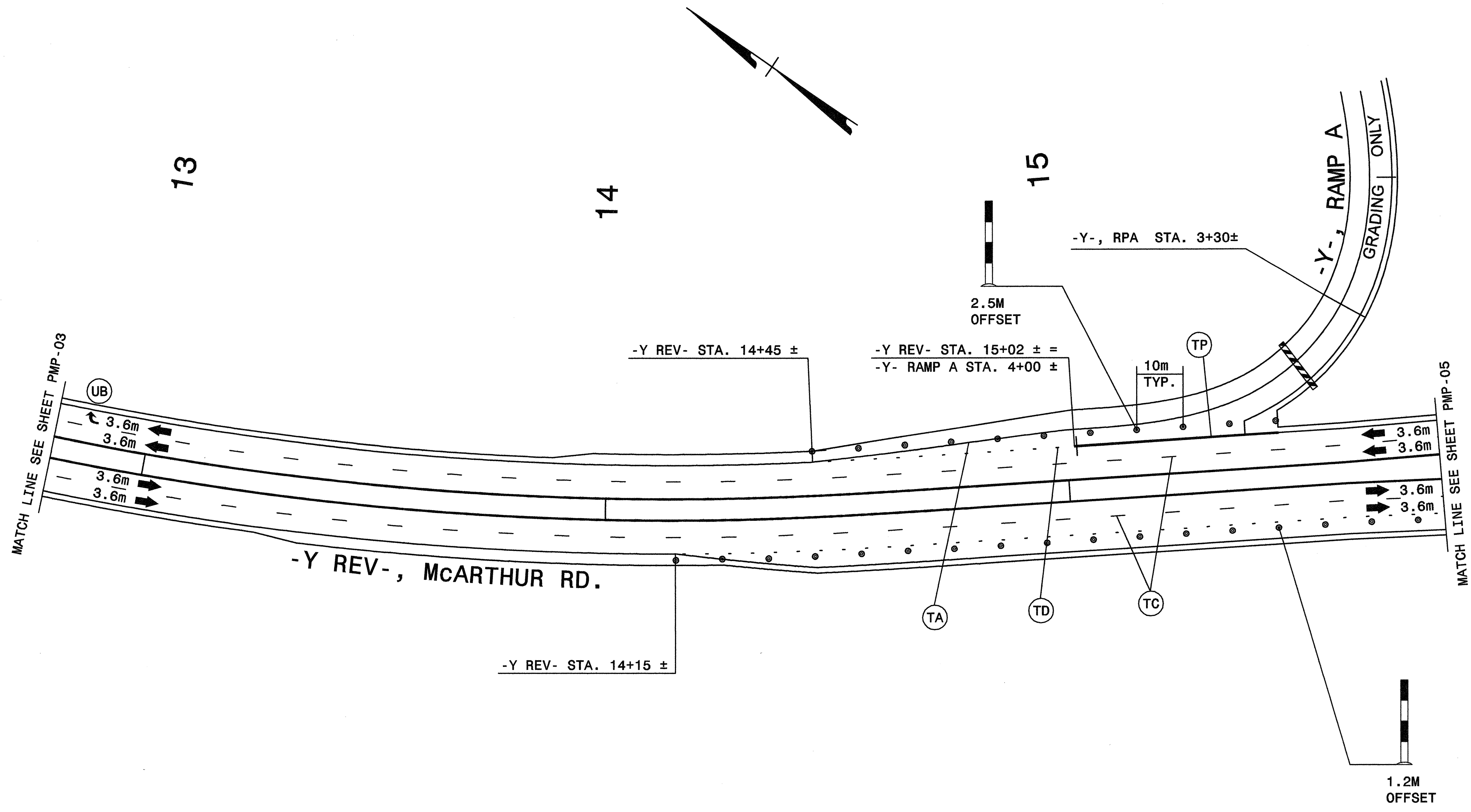

NOTES:

- SEE SHEET PM-2, FOR FINAL PAVEMENT MARKING SCHEDULE.
- PAVEMENT MARKINGS, SYMBOLS, AND CHARACTERS ARE TO BE MARKED ACCORDING TO ROADWAY STANDARD DRAWINGS UNLESS OTHERWISE NOTED IN THE PLANS.
- PAVEMENT MARKERS ARE TO BE SPACED ACCORDING TO THE ROADWAY STANDARD DRAWINGS.

PAVEMENT MARKING DETAIL

3/23/2010
 P:\TRAFFIC\Sub-Jobs\X-2ca\X-2ca\1007\X2ca-TC-pmp04.dgn
 Florence & Hutcheson, Inc.

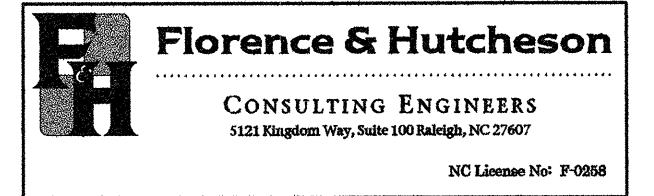

APPROVED: *Michael T. Rzepka*
 DATE: 3-29-10

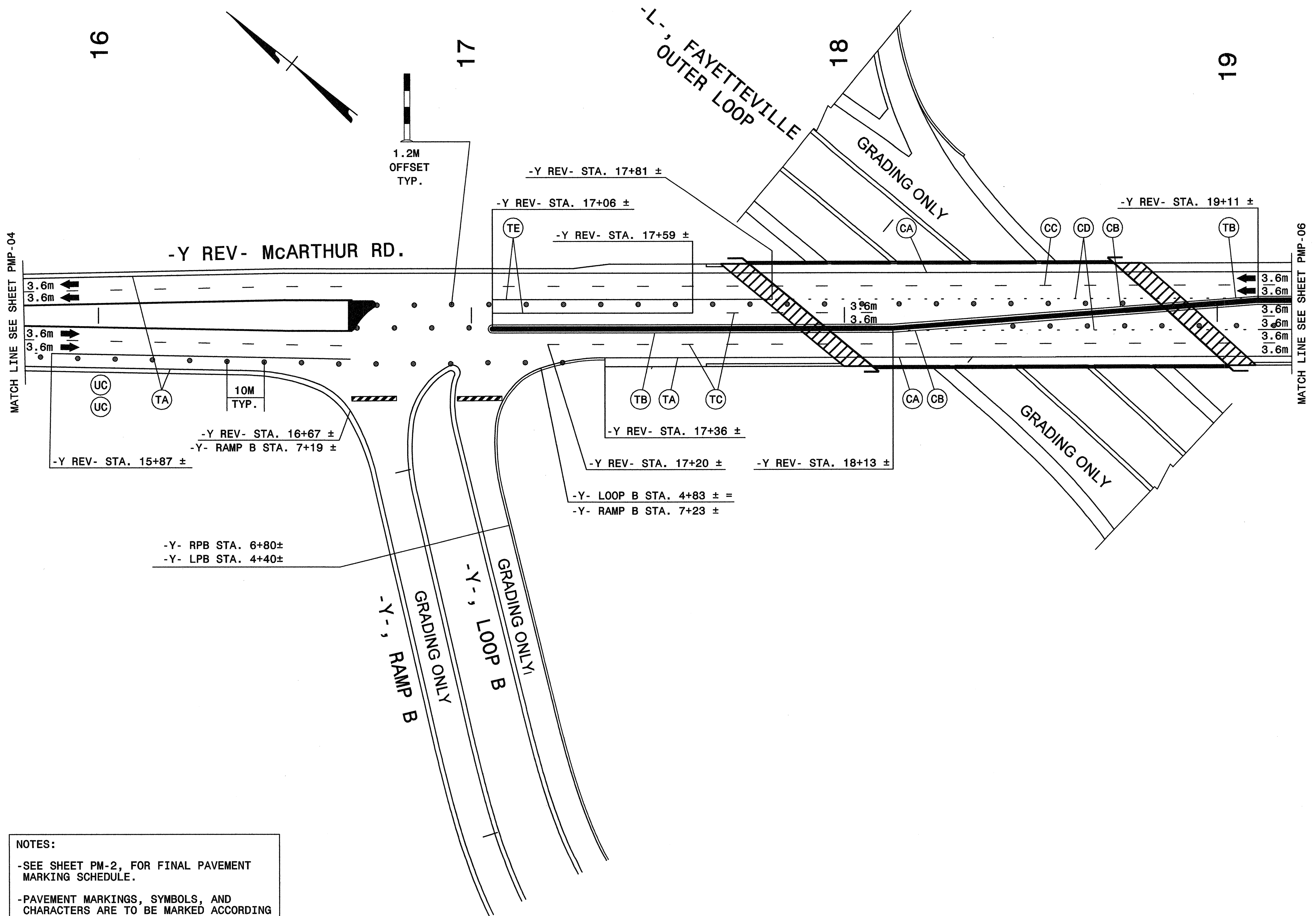
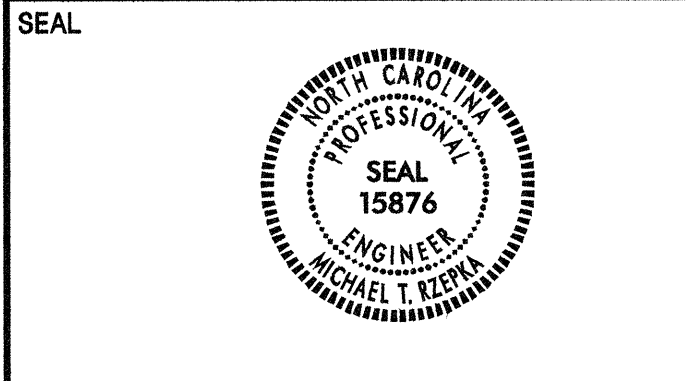

MATCH LINE SEE SHEET PMP-04

MATCH LINE SEE SHEET PMP-06

NOTES:
 -SEE SHEET PM-2, FOR FINAL PAVEMENT MARKING SCHEDULE.
 -PAVEMENT MARKINGS, SYMBOLS, AND CHARACTERS ARE TO BE MARKED ACCORDING TO ROADWAY STANDARD DRAWINGS UNLESS OTHERWISE NOTED IN THE PLANS.
 -PAVEMENT MARKERS ARE TO BE SPACED ACCORDING TO THE ROADWAY STANDARD DRAWINGS.

PAVEMENT MARKING DETAIL

3/23/2010
 P:\TRAFFIC\Sub-Jobs\X-2ca\X-2ca\1007\X2ca-TC-pmp05.dgn
 Florence & Hutcheson, Inc.

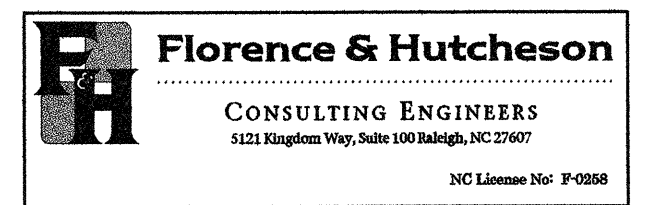

APPROVED: *Michael R. Kappeler*
 DATE: 3-29-10

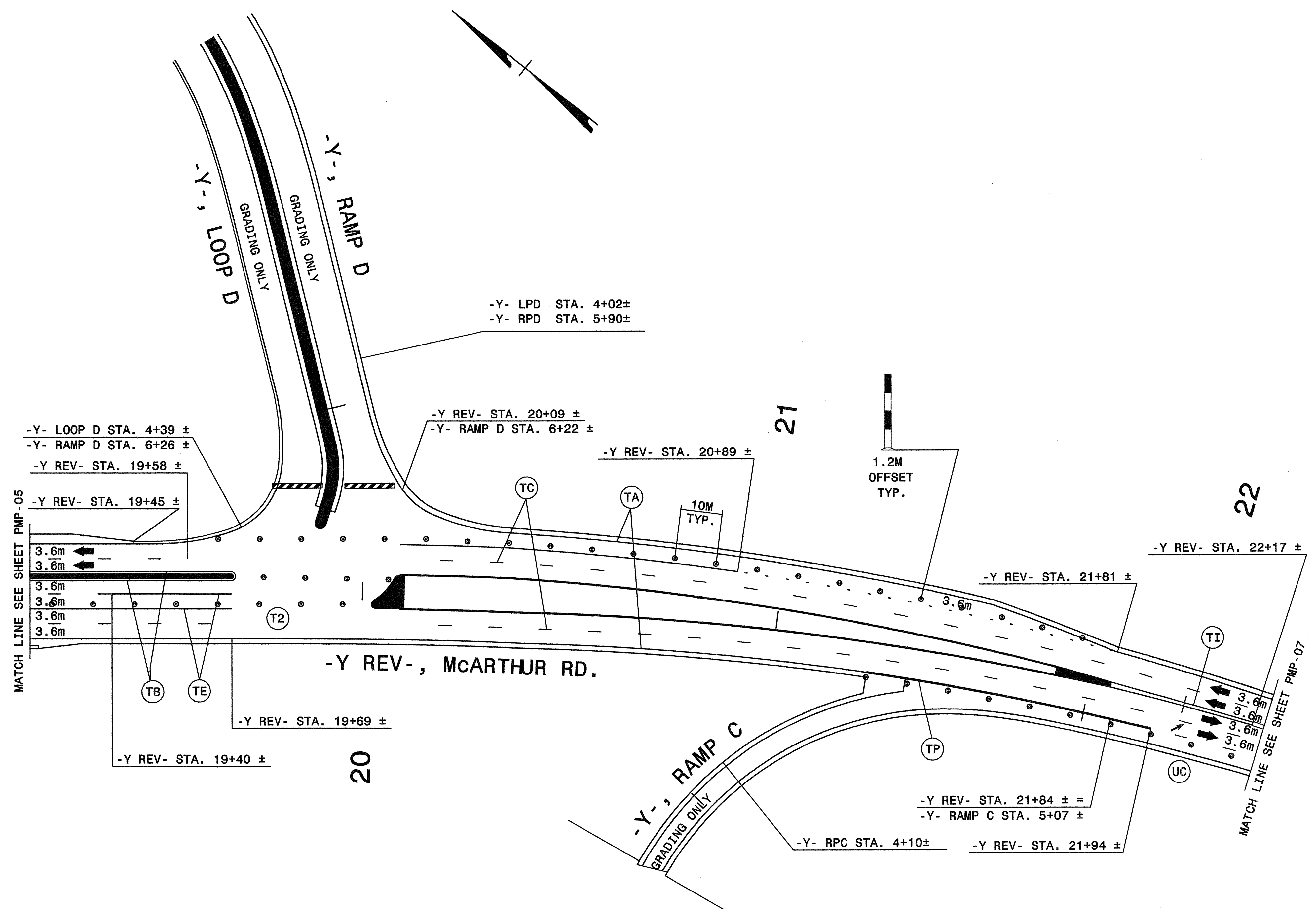
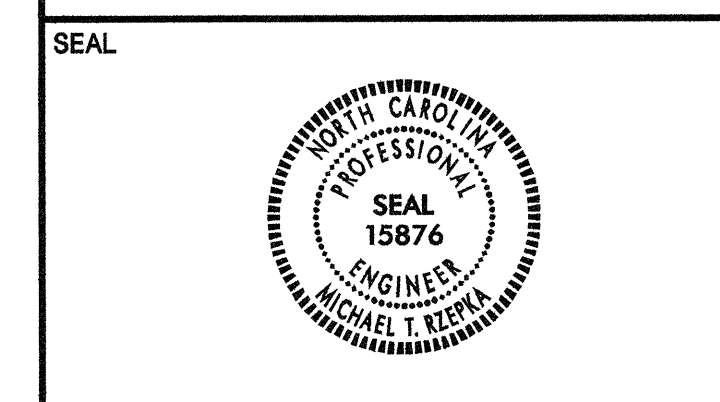

NOTES:

- SEE SHEET PM-2, FOR FINAL PAVEMENT MARKING SCHEDULE.
- PAVEMENT MARKINGS, SYMBOLS, AND CHARACTERS ARE TO BE MARKED ACCORDING TO ROADWAY STANDARD DRAWINGS UNLESS OTHERWISE NOTED IN THE PLANS.
- PAVEMENT MARKERS ARE TO BE SPACED ACCORDING TO THE ROADWAY STANDARD DRAWINGS.

PAVEMENT MARKING DETAIL

3/23/2010
 P:\TRAFFIC\Sub-Jobs\X-2ca\X-2ca\100\X2ca-TC-pmp06.dgn
 Florence & Hutcheson, Inc.



FH Florence & Hutcheson
 CONSULTING ENGINEERS
 5221 Raleigh Way, Suite 100 Raleigh, NC 27607
 NC License No. P-0088

TIP NO. X-0002CA	SHEET NO. PMP-07
APPROVED: <i>Michael T. Ryan</i>	
DATE: 3-29-10	
SEAL	

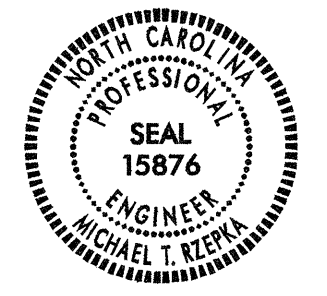

23

24

25

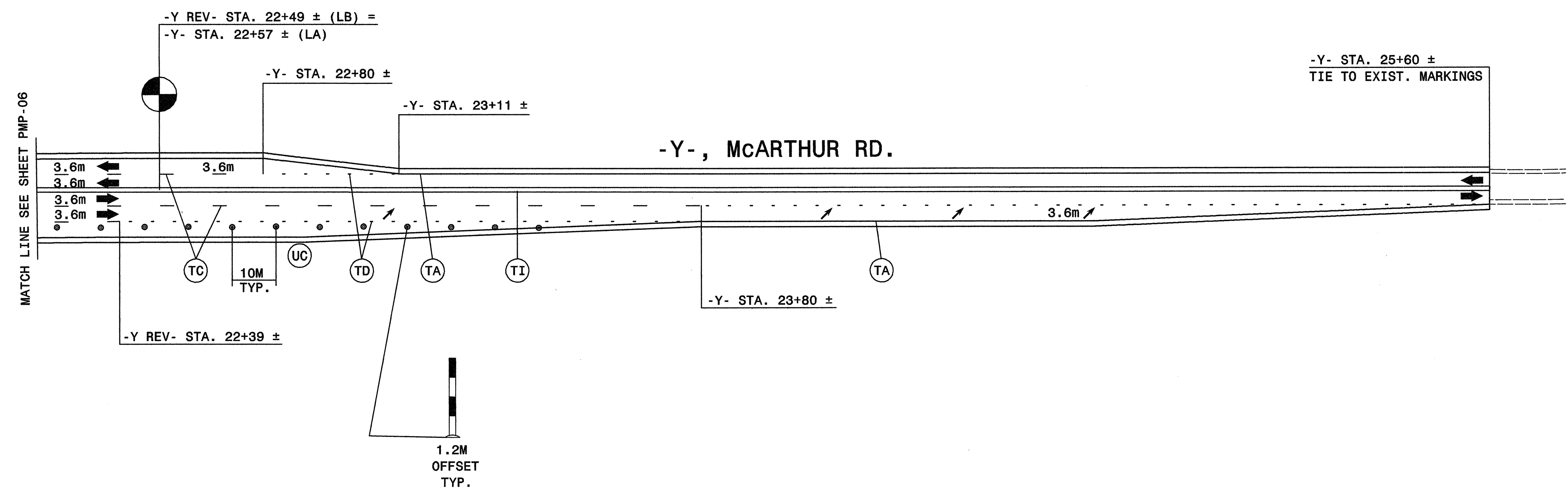
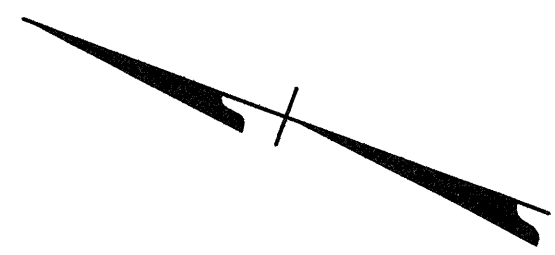

NOTES:

- SEE SHEET PM-2, FOR FINAL PAVEMENT MARKING SCHEDULE.
- PAVEMENT MARKINGS, SYMBOLS, AND CHARACTERS ARE TO BE MARKED ACCORDING TO ROADWAY STANDARD DRAWINGS UNLESS OTHERWISE NOTED IN THE PLANS.
- PAVEMENT MARKERS ARE TO BE SPACED ACCORDING TO THE ROADWAY STANDARD DRAWINGS.

PAVEMENT MARKING DETAIL

3/23/2010
 P:\PROJECTS\Sub-Jobs\X-2ca\X-2ca\1007\X2cd_Tc_pmp07.dgn
 Florence & Hutcheson, Inc.