

STATE OF NORTH CAROLINA
DIVISION OF HIGHWAYS

PROJ. REFERENCE NO.	SHEET NO.
B-4286	X- 1A

NOTE: EMBANKMENT COLUMN DOES NOT INCLUDE BACKFILL FOR UNDERCUT

CROSS-SECTION SUMMARY

Station	Uncl. Exc.	Embt	Station	Uncl. Exc.	Embt
L	(cu. yd.)	(cu. yd.)	Y1	(cu. yd.)	(cu. yd.)
13+00.00	0	0	11+75.00	0	119
13+50.00	20	10	12+00.00	0	136
14+00.00	31	18	12+25.00	0	119
14+50.00	23	59	Subtotal	85	546
15+00.00	12	102			
15+50.00	12	137			
Subtotal	98	326			
Station	Uncl. Exc.	Embt			
L	(cu. yd.)	(cu. yd.)			
17+50.00	0	0			
18+00.00	170	0			
18+50.00	164	0			
19+00.00	156	0			
19+50.00	133	0			
Subtotal	623	0			
Station	Uncl. Exc.	Embt			
DET	(cu. yd.)	(cu. yd.)			
11+50.00	0	0			
12+00.00	19	19			
12+50.00	25	67			
13+00.00	26	143			
13+50.00	20	216			
14+00.00	11	191			
14+50.00	2	105			
15+00.00	0	225			
15+50.00	0	430			
Subtotal	103	1396			
Station	Uncl. Exc.	Embt			
DET	(cu. yd.)	(cu. yd.)			
17+50.00	0	0			
18+00.00	2	118			
18+50.00	4	149			
19+00.00	3	169			
19+50.00	2	180			
20+00.00	0	230			
20+50.00	24	133			
21+00.00	29	45			
21+50.00	28	50			
22+00.00	36	5			
Subtotal	128	1079			
Station	Uncl. Exc.	Embt			
Y1	(cu. yd.)	(cu. yd.)			
10+00.00	0	0			
10+25.00	40	0			
10+50.00	31	0			
10+75.00	13	2			
11+00.00	1	21			
11+25.00	0	57			
11+50.00	0	92			

Approximate quantities only. Unclassified excavation, borrow excavation, fine grading, clearing and grubbing, and removal of existing pavement will be paid for at the lump sum price for "Grading".

8/23/99

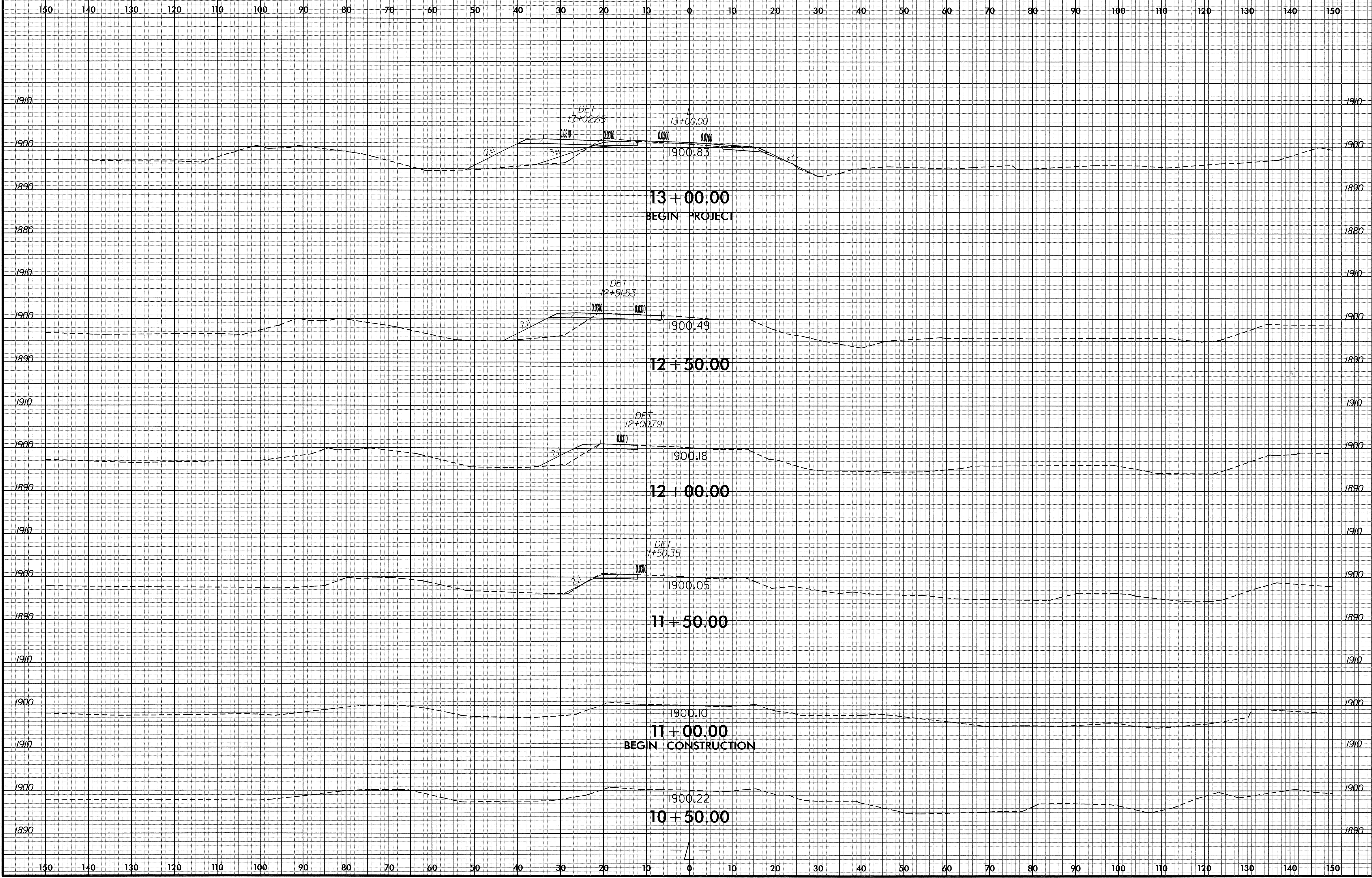

22-JUN-2010 08:32
C:\road\p1\work\p1\B-4286-x-1.dgn
\$\$\$\$USERAME\$\$\$\$

8/23/99

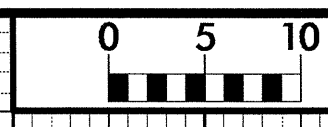

PROJ. REFERENCE NO. B-4286	SHEET NO. X-2
-------------------------------	------------------

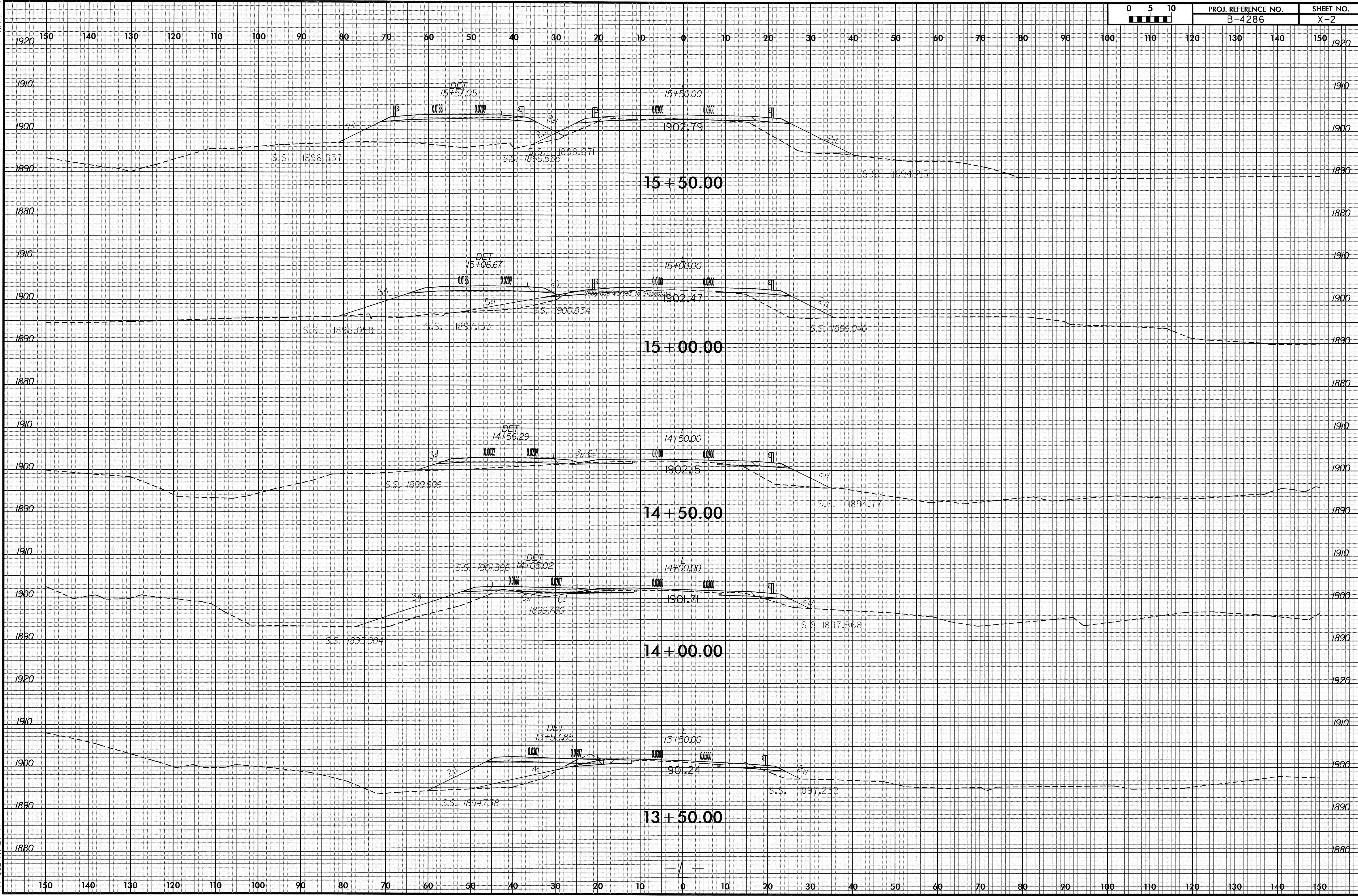

22-JUN-2010 08:32
C:\p000604\B4286\B4286-rdy-xpl-1.dgn

8/23/99

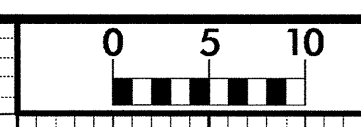

PROJ. REFERENCE NO. B-4286	SHEET NO. X-4
-------------------------------	------------------

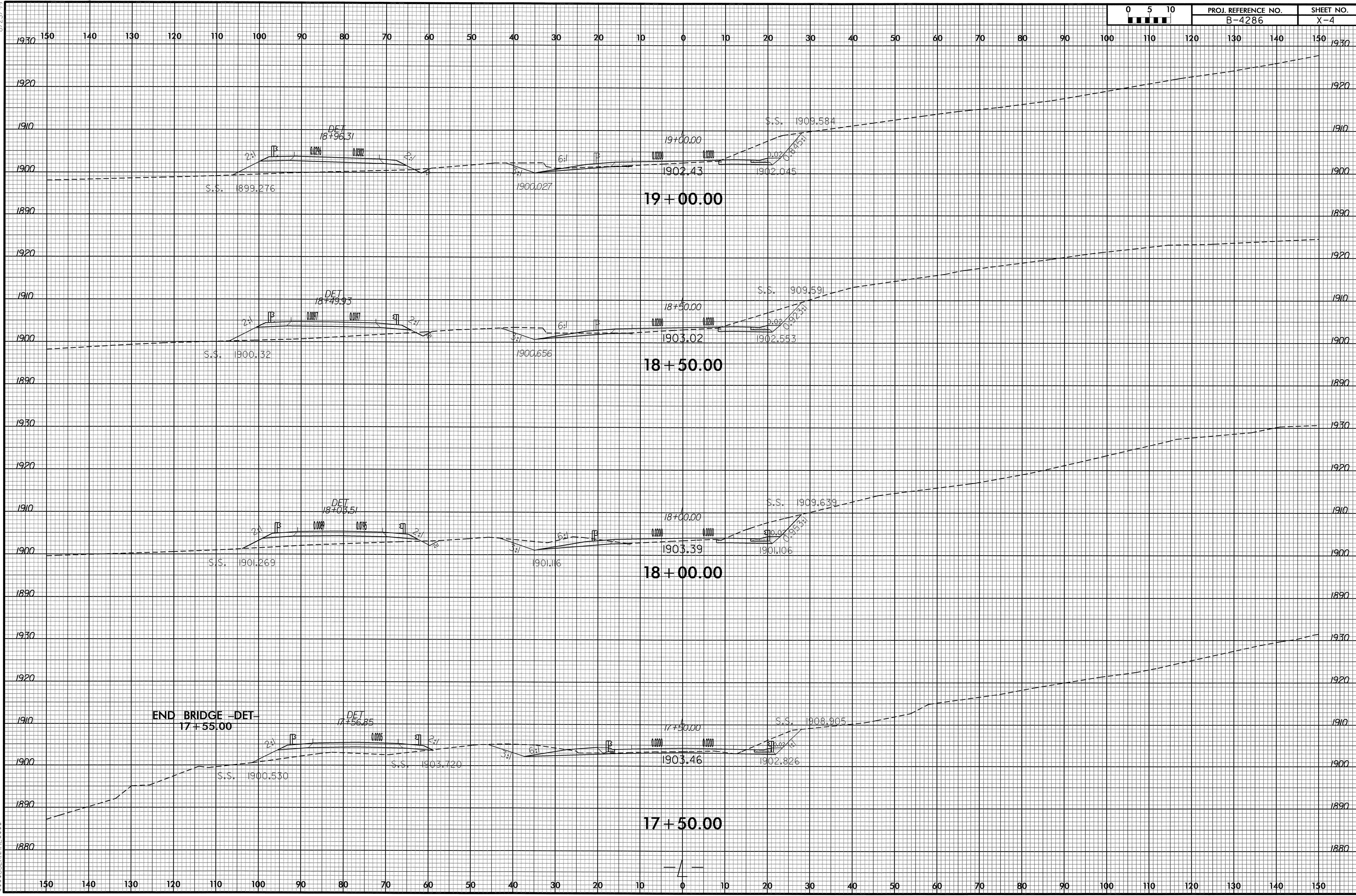

22-JUN-2010 08:32:01 \\b4286-rdy.xpl.1.dgn

8/23/99

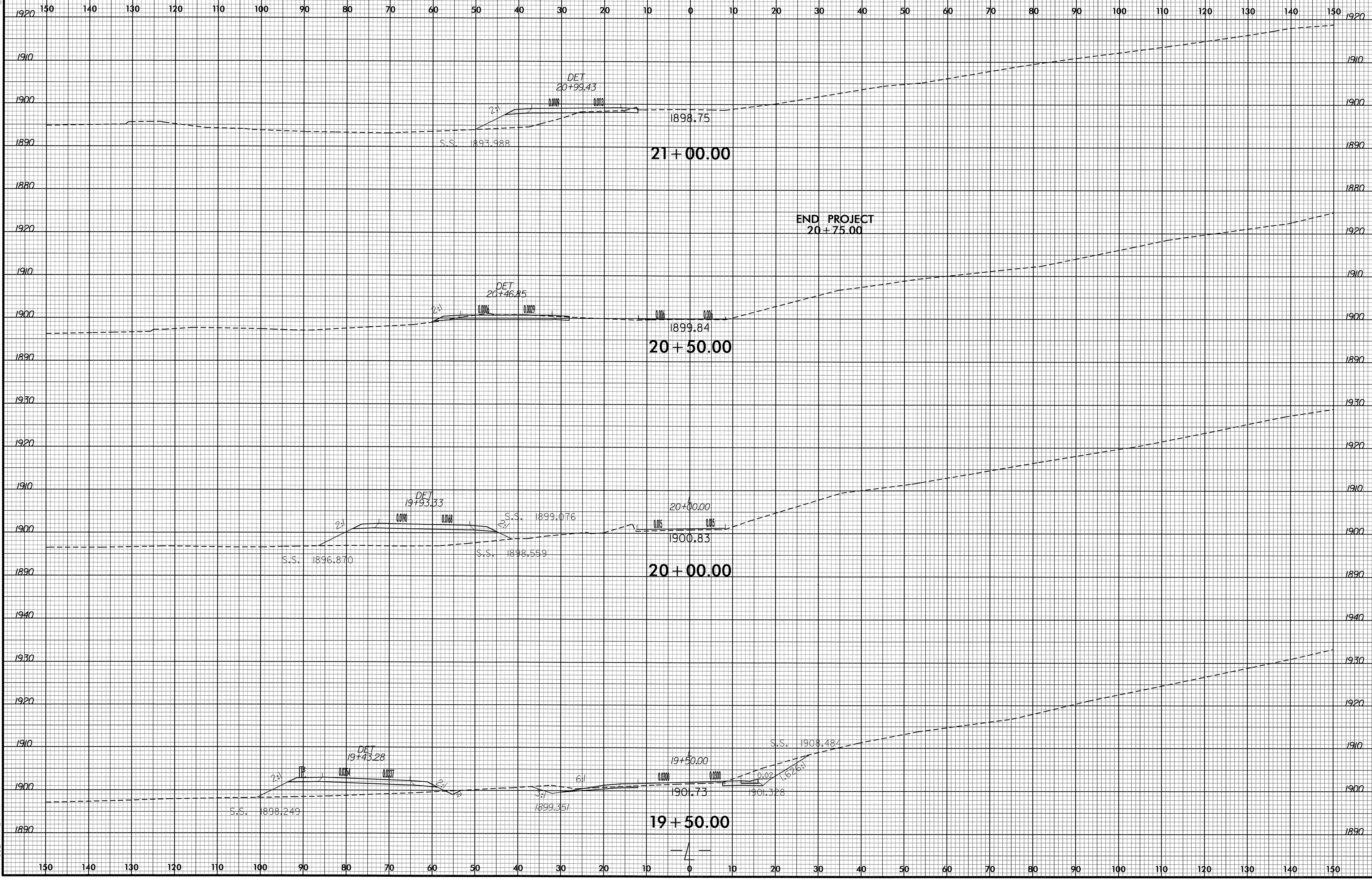

22-JUN-2010 08:32
 C:\roadwork\ss\vol\4286.rdy.rpl.dgn
 \$\$\$DSENAME\$\$\$

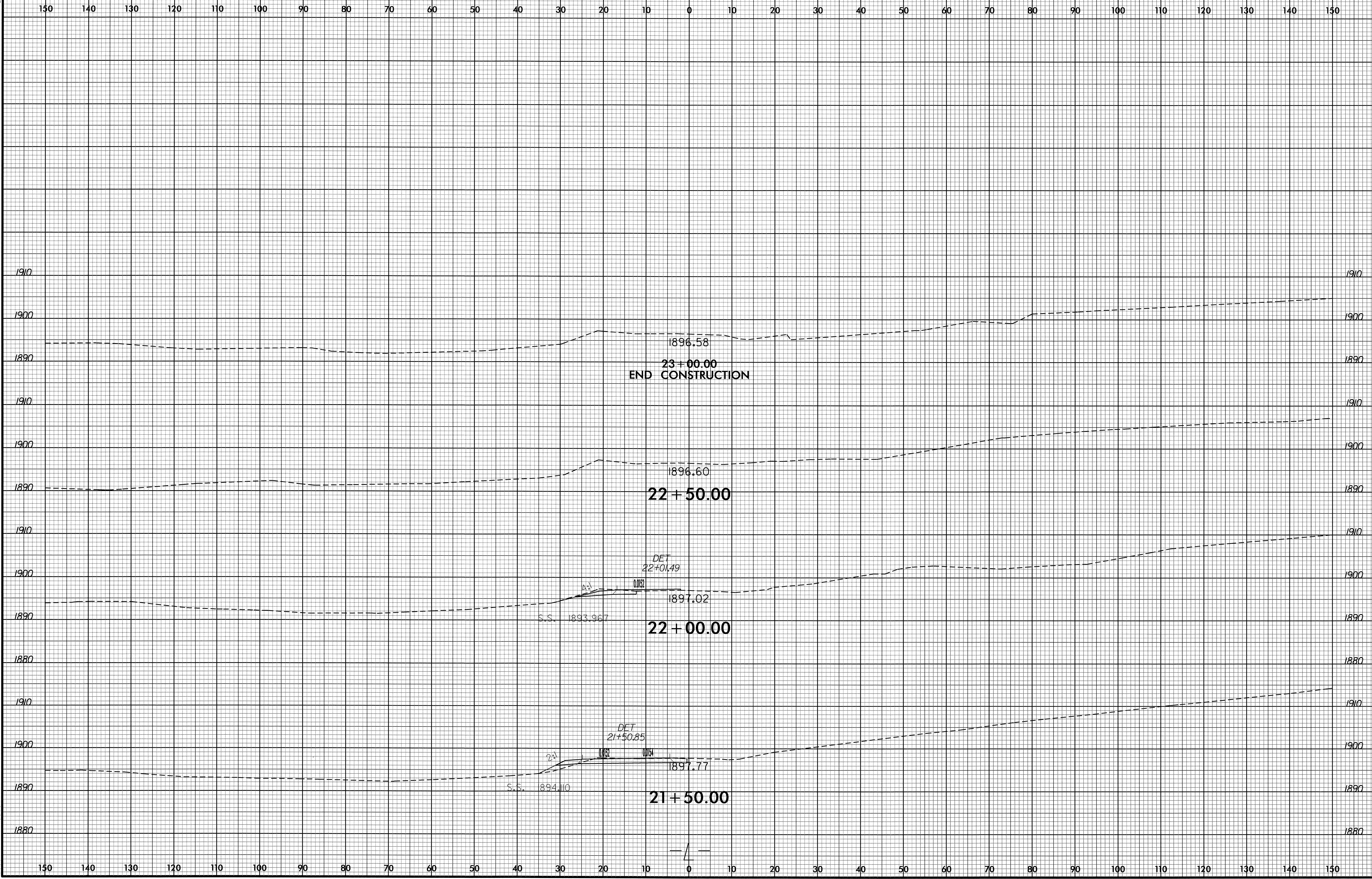

8/23/99

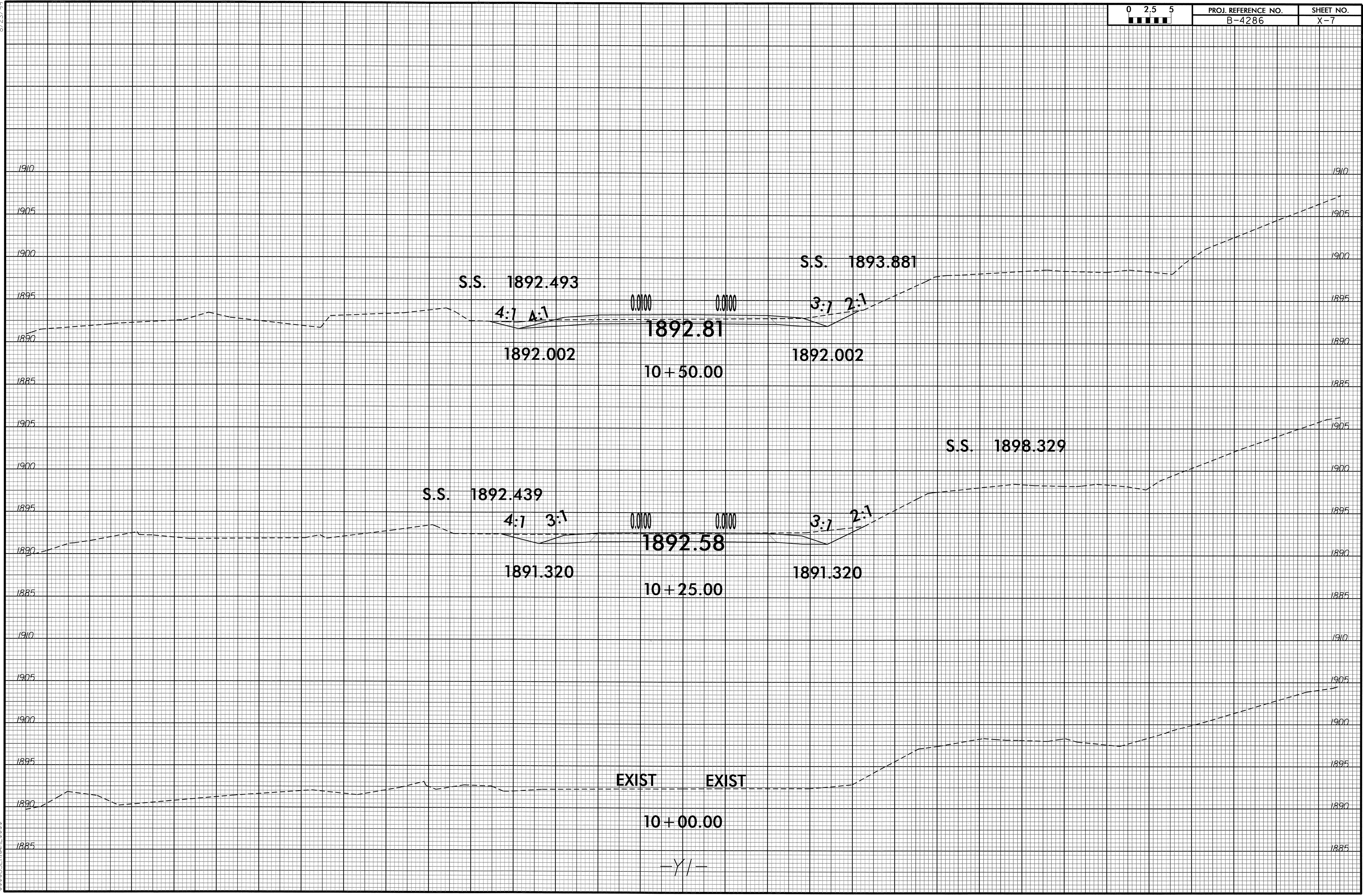

21 JUN 2000 15:23
3386175286.rdy -xp1.g1.dgn

8/23/99

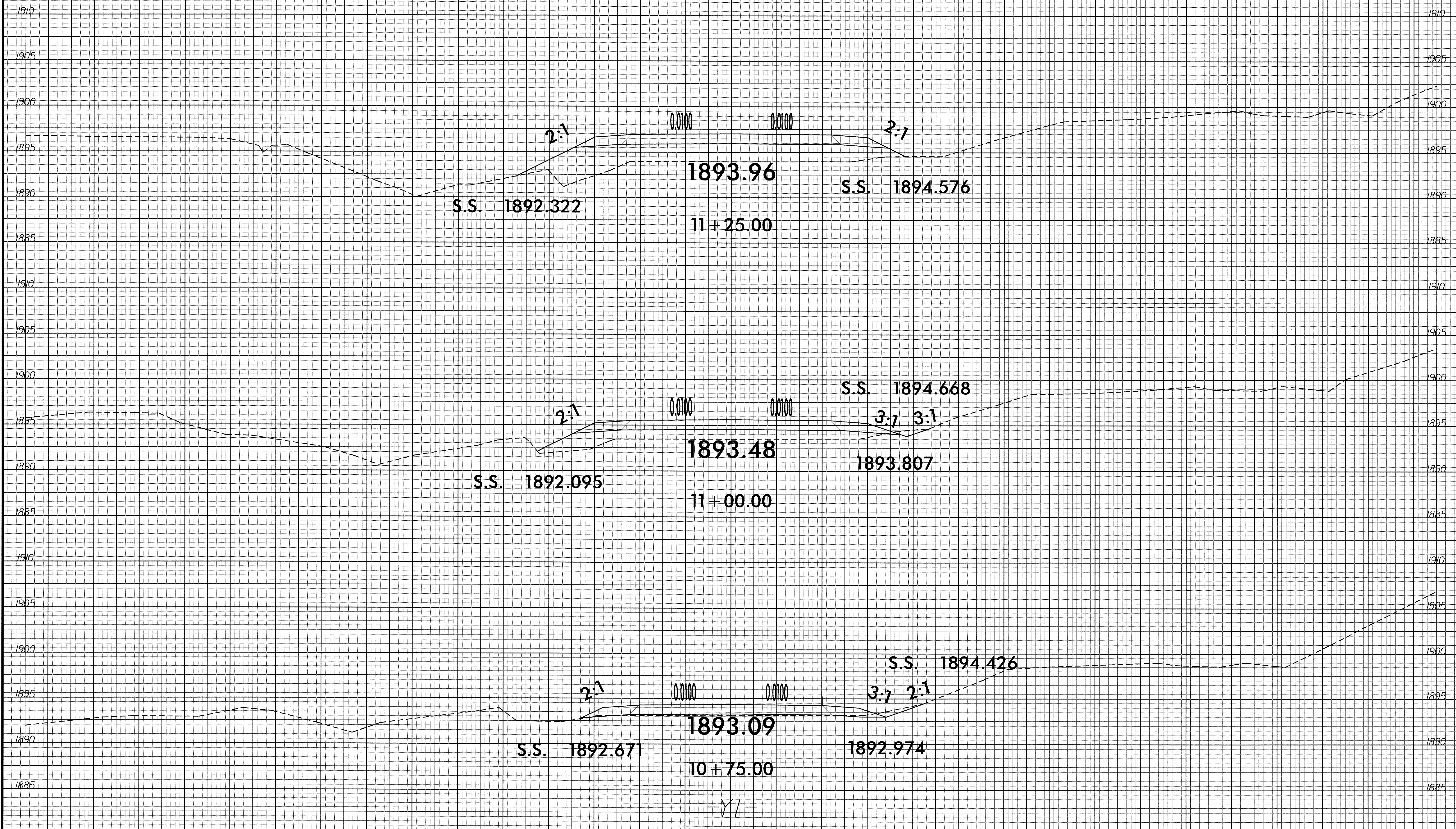

21-JUN-2010 15:24
R:\Roadwork\XSC\p1\B-4286_rdy_xpl.dgn
\$\$\$\$\$USERNAME\$\$\$

