

09/08/99

TIP PROJECT: B-4286

T.I.P. NO.	SHEET NO.
B-4286	UO-1

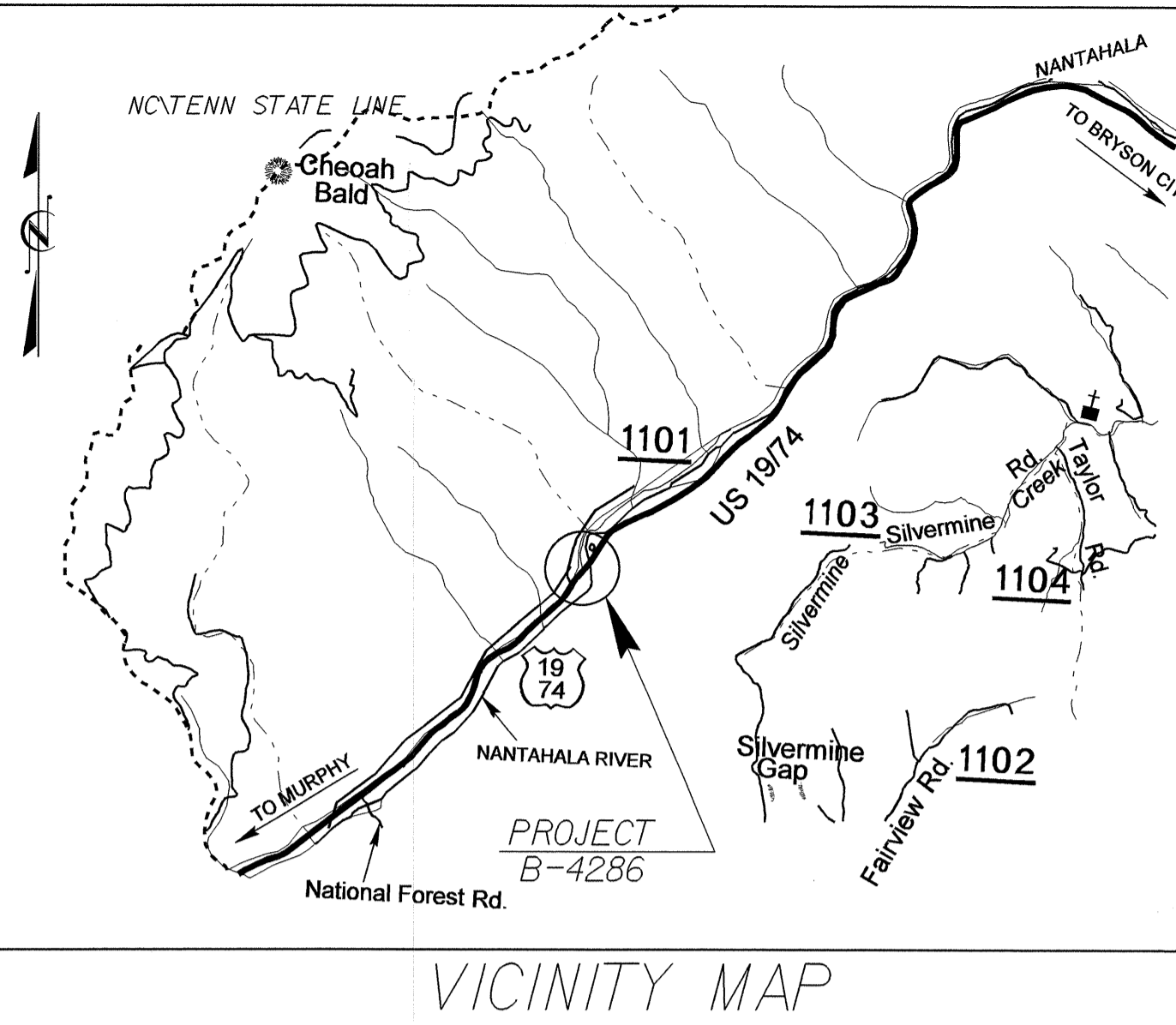

STATE OF NORTH CAROLINA
DIVISION OF HIGHWAYS

UTILITIES BY OTHERS PLANS SWAIN COUNTY

**LOCATION: BRIDGE NO. 3 ON US 1974 OVER THE
NANTAHALA RIVER**

TYPE OF WORK: POWER RELOCATION

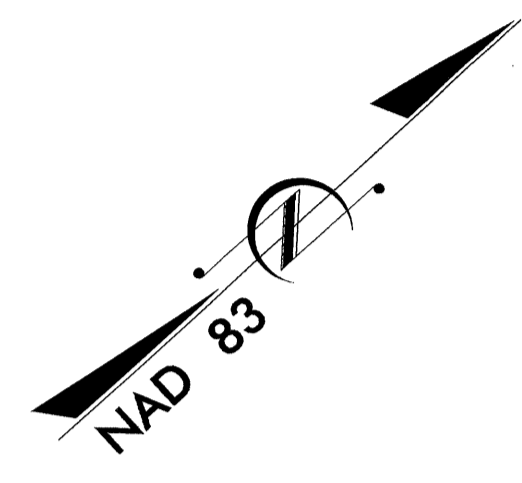

BEGIN CONSTRUCTION -L- STA. 11+00.00

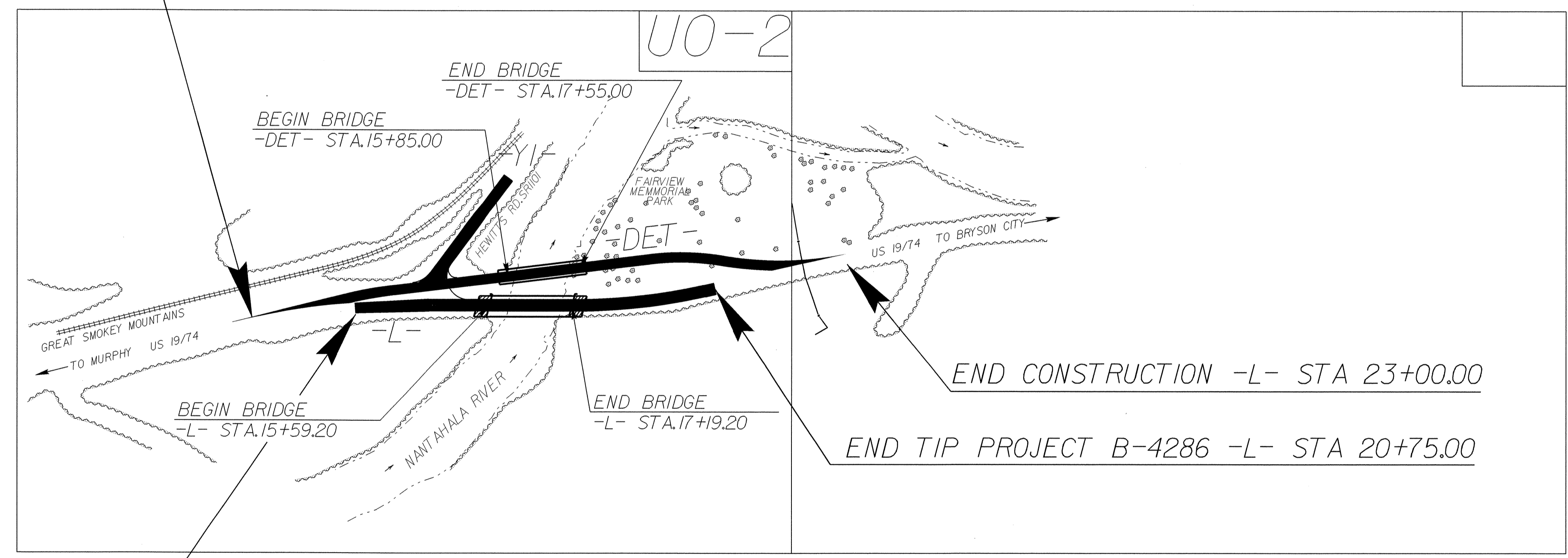

BEGIN TIP PROJECT B-4286 -L- STA 13+00.00

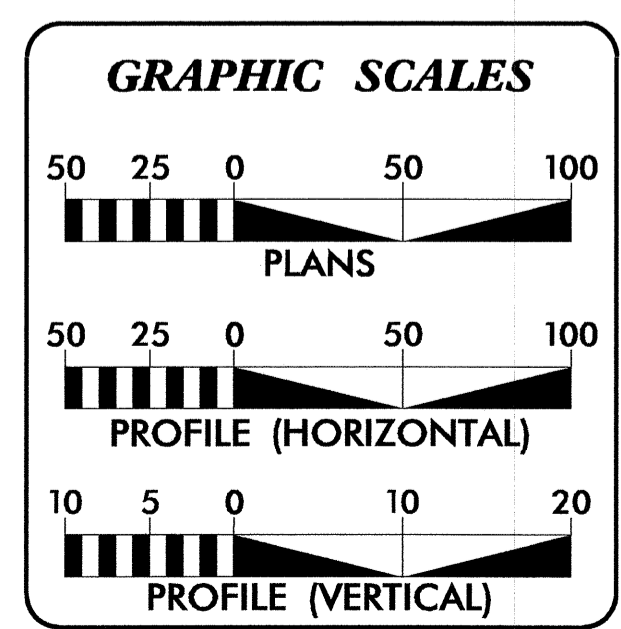

INDEX OF SHEETS	
SHEET NO.	DESCRIPTION
UO-1	TITLE SHEET
UO-2	UTILITY BY OTHERS PLAN SHEETS

UTILITY OWNERS ON PROJECT
(1) DUKE POWER

PREPARED IN THE OFFICE OF:
**DIVISION OF HIGHWAYS
UTILITIES ENGINEERING
SECTION**

1550 MAIL SERVICES CENTER
RALEIGH NC 27699-1591
PHONE (919) 250-4128
FAX (919) 250-4119

Roger Worthington, P.E. UTILITIES SECTION ENGINEER
Carl Barclay, P.E. UTILITIES SQUAD LEADER PROJECT ENGINEER
Ali Kouchehi, P.E. UTILITIES PROJECT DESIGNER

02-JUN-2010 12:17
R:\Utilities\rdy\ut\proj\b4286_rdy_tsh.dgn
\$\$\$\$\$USERNAME\$\$\$\$\$

UTILITIES BY OTHERS

NOTE:
ALL PROPOSED UTILITY WORK
SHOWN ON THIS SHEET WILL
BE DONE BY OTHERS

-DEL-	-L-	-YI-
PI Sta 13+34.65 Δ = 7° 50' 00.0" (RT) D = 7° 50' 55.5" L = 89.19' T = 446.5' R = 730.00'	PI Sta 12+37.05 Δ = 14° 02' 16.80" (RT) D = 3° 23' 39.48" L = 413.58' T = 207.83' R = 1688.00'	PI Sta 12+46.09 Δ = 36° 39' 56.0" (LT) D = 73° 27' 22.1" L = 49.91' T = 25.85' R = 78.00'

FOR PROFILES SEE SHEET 6 AND 7
FOR STRUCTURES SEE SHEETS S-1 THRU S-41

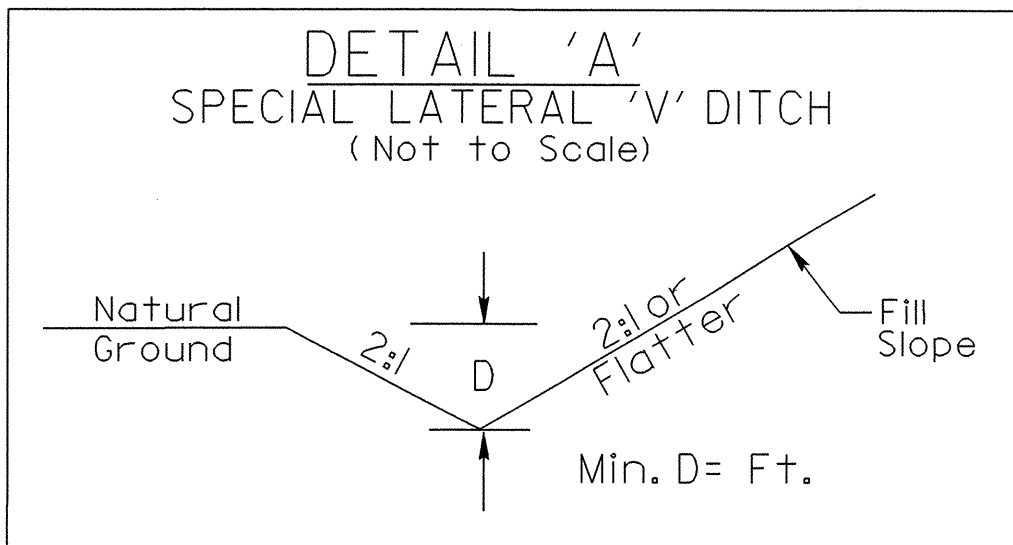

FROM -DET- STA. 17+57 TO STA. 19+92 RT.

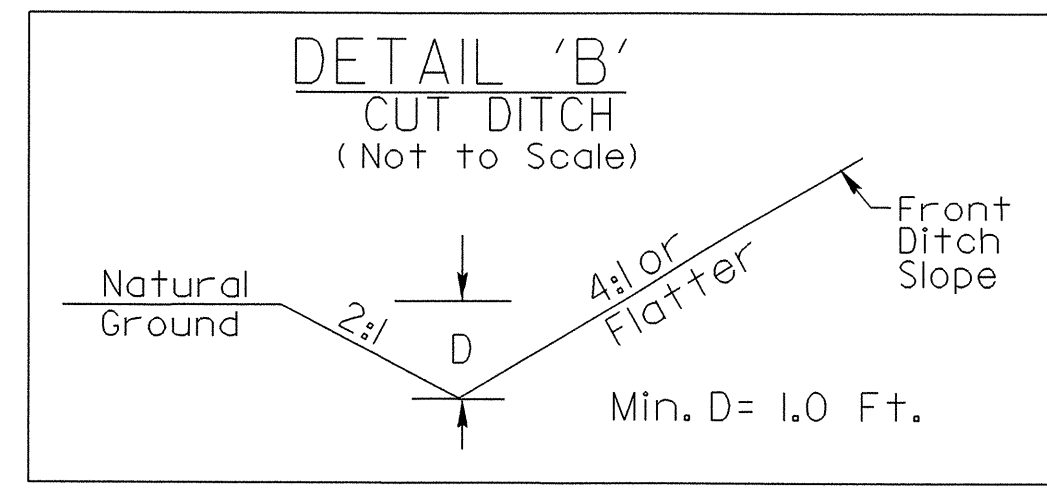

FROM -L- STA. 19+51 TO STA. 19+90 LT.

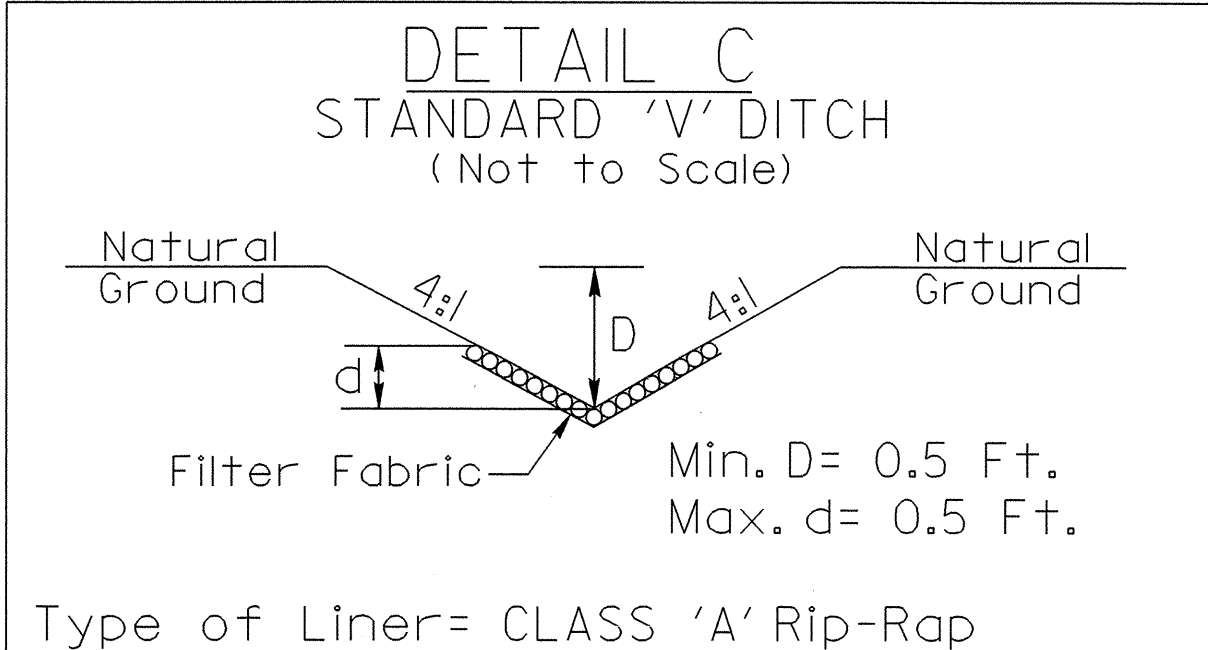

Type of Liner= CLASS 'A' Rip-Rap
TYPICAL AT OUTLET OF EACH
MODIFIED CONCRETE FLUME (MCF)
EST. 1.5 TONS EACH
EST. 5 SY FF EACH

-L-	-DET-
PI Sta 18+52.50 Δ = 12° 50' 31.2" (LT) D = 5° 03' 41.27" L = 253.72' T = 127.39' R = 1132.00'	PI Sta 19+70.03 Δ = 14° 11' 12.3" (RT) D = 7° 50' 55.5" L = 180.75' T = 90.84' R = 730.00'

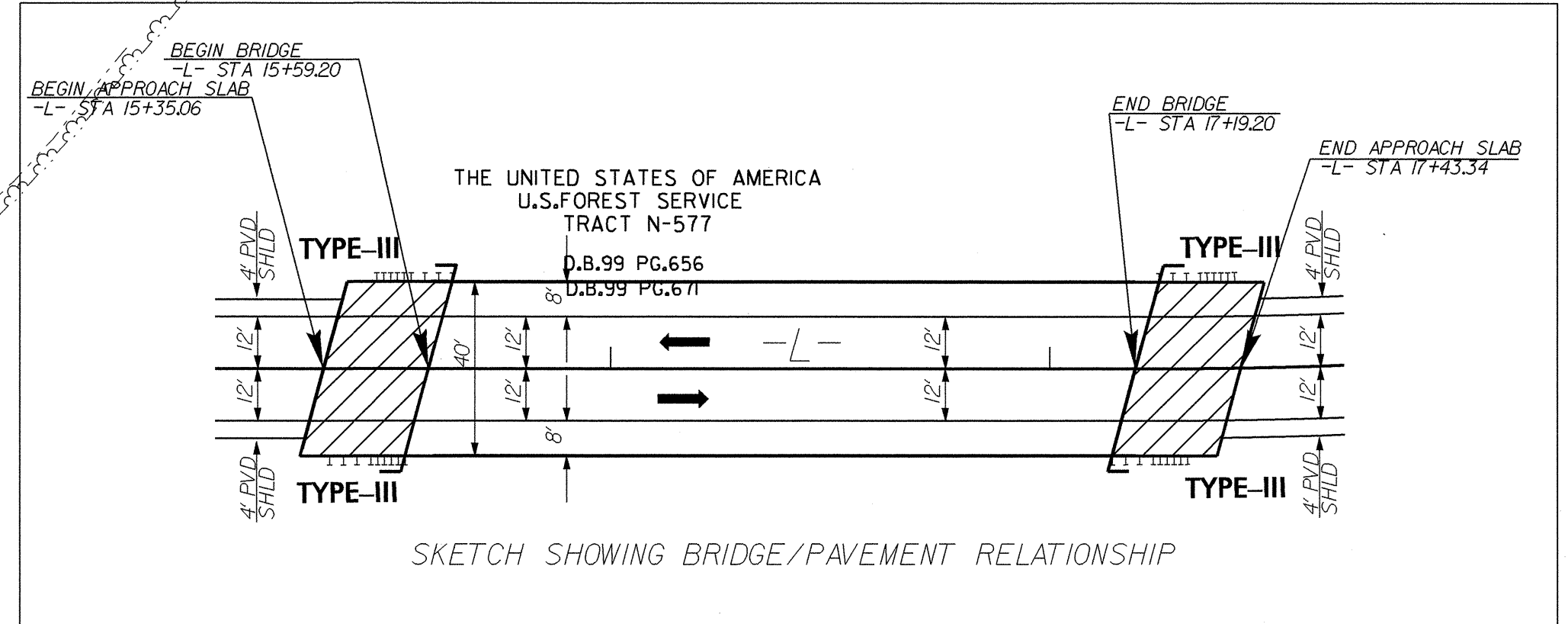
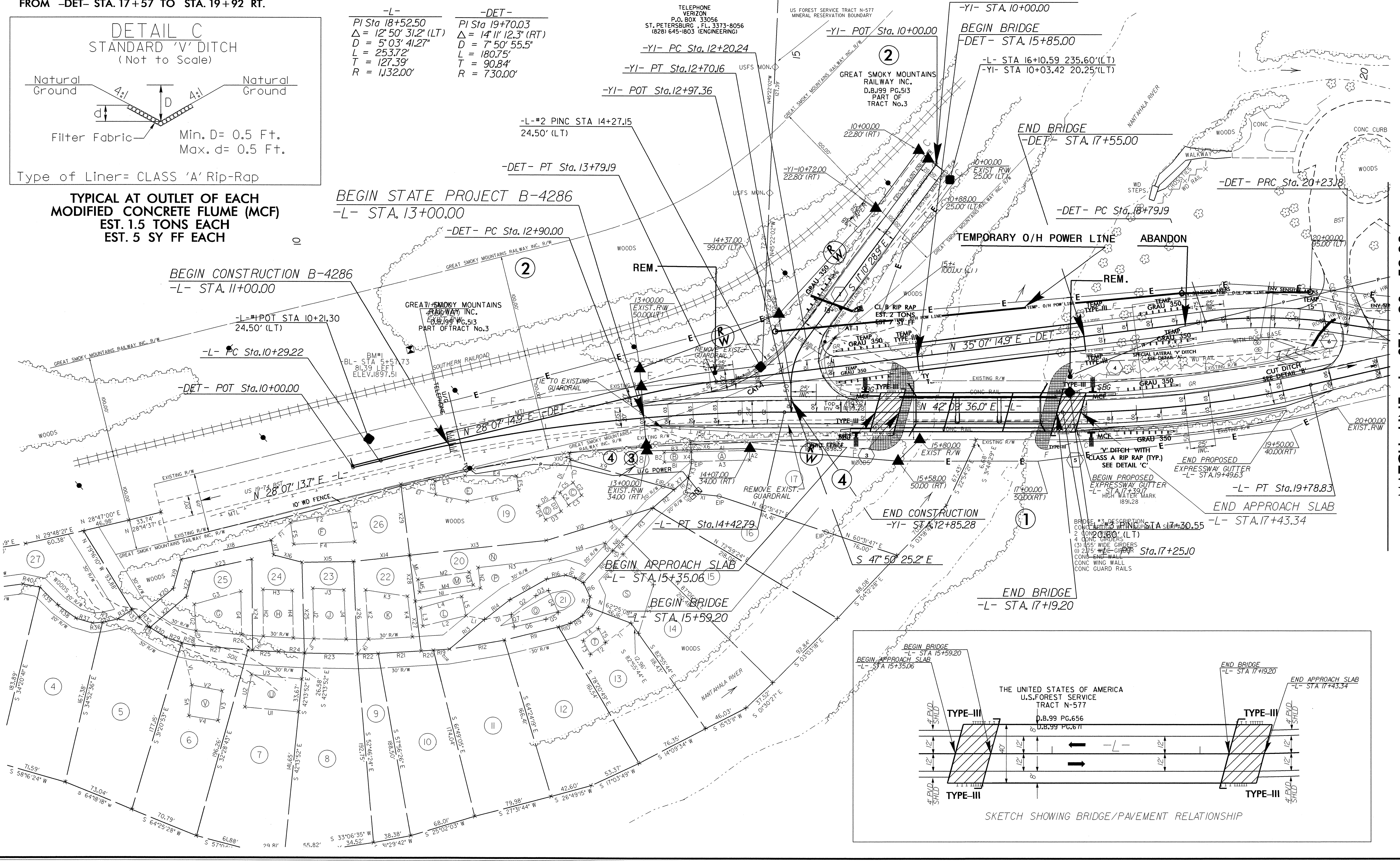

REVISIONS
 02 JUN-2010 12:19
 R:\util\B-4286\Draw\U0-2.dwg
 6/13/99
 02 JUN-2010 12:19
 R:\util\B-4286\Draw\U0-2.dwg
 6/13/99

MATCH LINE -L- STA. 20+59.23