

**TIP PROJECT: B-4682**

STATE OF NORTH CAROLINA  
 DIVISION OF HIGHWAYS  
 PLAN FOR PROPOSED  
 HIGHWAY EROSION CONTROL  
**WILSON COUNTY**

**LOCATION: BRIDGE NO. 2 ON SR 1628 (WOODBIDGE ROAD)  
 OVER CONTENTNEA CREEK**

**TYPE OF WORK: GRADING, DRAINAGE, PAVING, GUARDRAIL  
 AND STRUCTURE**

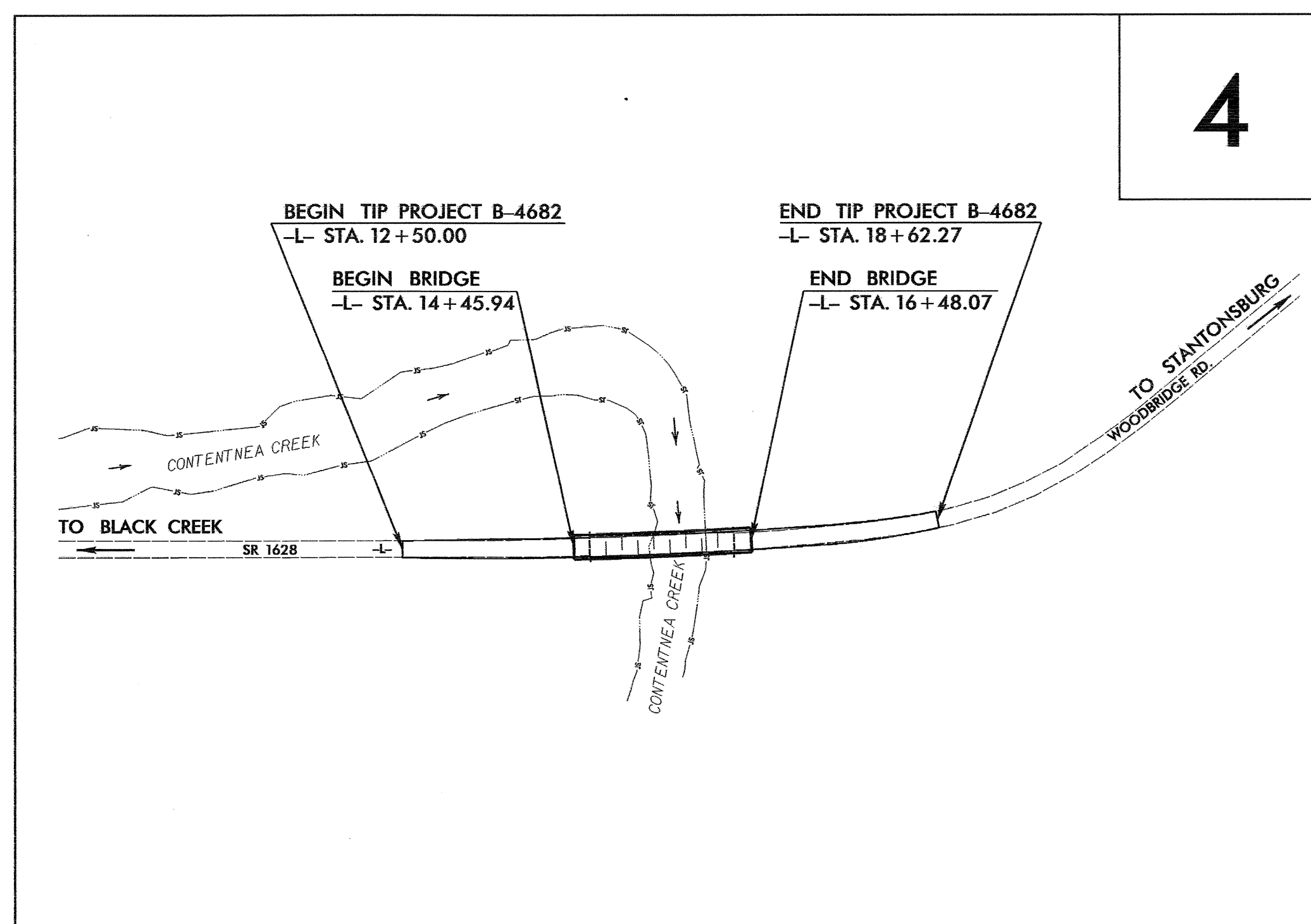

STATE	STATE PROJECT REFERENCE NO.	SHEET NO.	TOTAL SHEETS
N.C.	B-4682	EC-1	
STATE PROJ. NO.	F.A. PROJ. NO.	DESCRIPTION	

**EROSION AND SEDIMENT CONTROL MEASURES**

Std. #	Description	Symbol
1630.03	Temporary Silt Ditch	
1630.05	Temporary Diversion	
1605.01	Temporary Silt Fence	
1606.01	Special Sediment Control Fence	
1622.01	Temporary Berms and Slope Drains	
	Silt Basin Type B	
1633.01	Temporary Rock Silt Check Type-A	
	Temporary Rock Silt Check Type-A with Matting and Polyacrylamide (PAM)	
	Temporary Rock Silt Check Type-B	
	Wattle / Coir Fiber Wattle	
	Wattle / Coir Fiber Wattle with Polyacrylamide (PAM)	
1634.01	Temporary Rock Sediment Dam Type-A	
1634.02	Temporary Rock Sediment Dam Type-B	
1635.01	Rock Pipe Inlet Sediment Trap Type-A	
1635.02	Rock Pipe Inlet Sediment Trap Type-B	
1630.04	Stilling Basin	
1630.06	Special Stilling Basin	
	Rock Inlet Sediment Trap:	
1632.01	Type A	
1632.02	Type B	
1632.03	Type C	
	Skimmer Basin	
	Tiered Skimmer Basin	
	Infiltration Basin	

**THIS PROJECT CONTAINS  
 EROSION CONTROL PLANS  
 FOR CLEARING AND  
 GRUBBING PHASE OF  
 CONSTRUCTION.**

**ENVIRONMENTALLY  
 SENSITIVE AREA(S) EXIST  
 ON THIS PROJECT**  
*Refer To E. C. Special Provisions  
 for Special Considerations.*

**THIS PROJECT HAS  
 BEEN DESIGNED TO  
 SENSITIVE WATERSHED  
 STANDARDS.**

**GRAPHIC SCALE**

0

PLANS

0

PROFILE (HORIZONTAL)

0

PROFILE (VERTICAL)

ROADSIDE ENVIRONMENTAL UNIT  
 DIVISION OF HIGHWAYS  
 STATE OF NORTH CAROLINA

Prepared in the Office of:  
**ROADSIDE ENVIRONMENTAL UNIT**  
 1 South Wilmington St.  
 Raleigh, NC 27611  
**2006 STANDARD SPECIFICATIONS**

Roadway Standard Drawings

The following roadway english standards as appear in "Roadway Standard Drawings"- Roadway Design Unit - N. C. Department of Transportation - Raleigh, N. C., dated July 18, 2006 and the latest revision thereto are applicable to this project and by reference hereby are considered a part of these plans.

1605.01 Temporary Silt Fence  
 1606.01 Special Sediment Control Fence  
 1607.01 Gravel Construction Entrance  
 1622.01 Temporary Berms and Slope Drains  
 1630.05 Temporary Diversion  
 1632.03 Rock Inlet Sediment Trap Type C  
 1633.01 Temporary Rock Silt Check Type A

30-DEC-2009 15:37  
 EN-PR-ARCH  
 AT-FR-12538  
 1630-4682-EC-1-sh.dgn



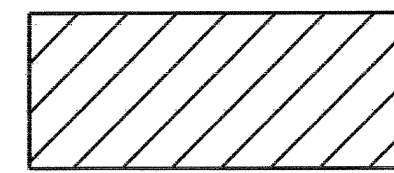

ENVIRONMENTALLY SENSITIVE AREA  
SEE PROJECT SPECIAL PROVISIONS

NOTE:  
PLACE TEMPORARY ROCK SEDIMENT DAMS TYPE - B  
AND TEMPORARY ROCK SILT CHECKS TYPE - A AT  
DRAINAGE OUTLETS.

CLEARING AND GRUBBING  
EROSION CONTROL FOR  
CONSTRUCTION SHEET 4

NOTE:  
UTILIZE TEMPORARY ROCK SILT CHECK TYPE - A  
AS STILLING BASIN WHERE APPLICABLE.

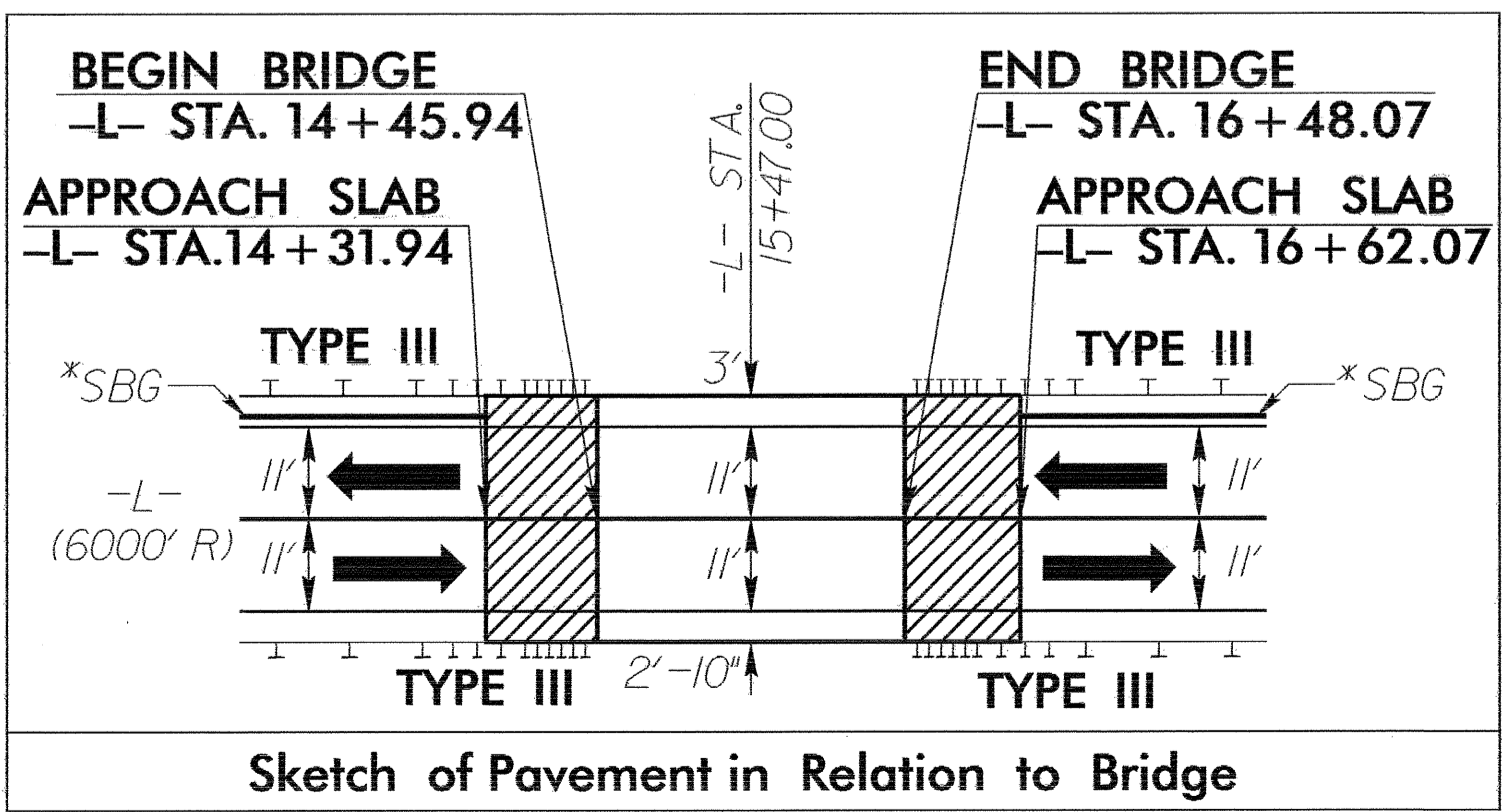
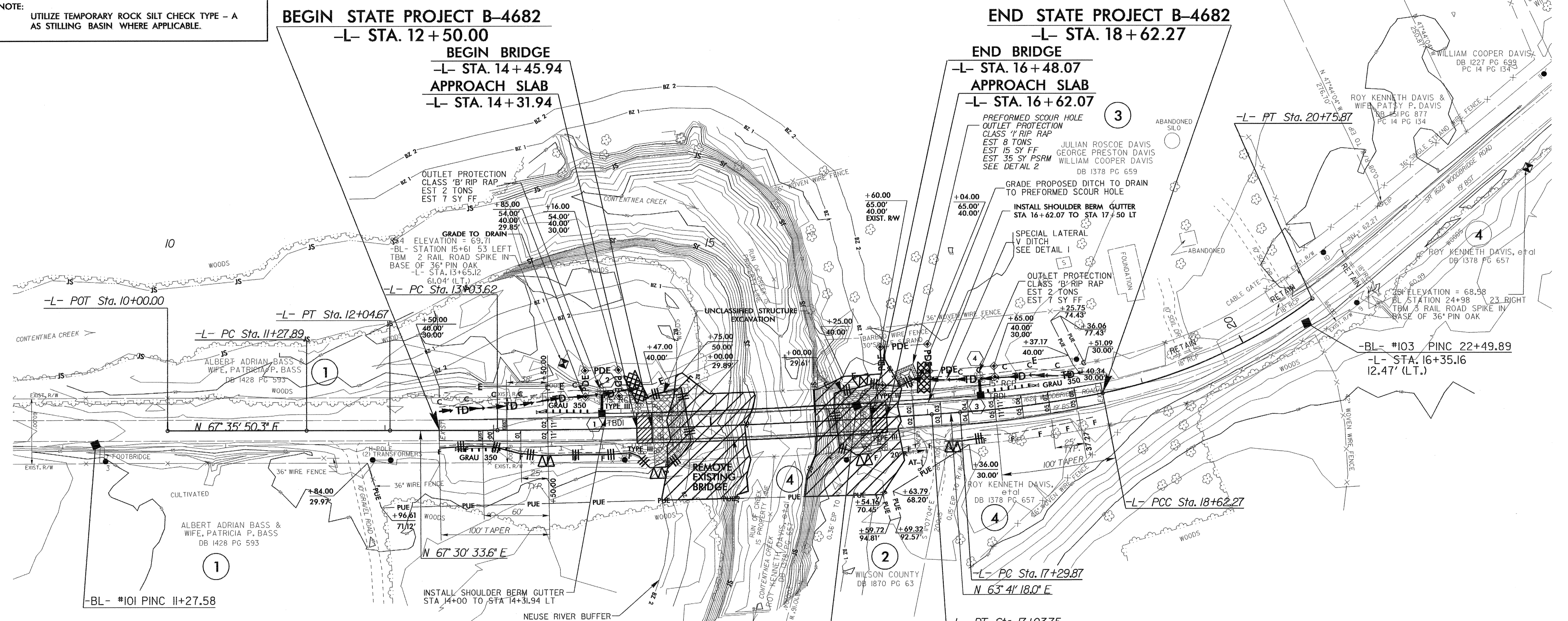
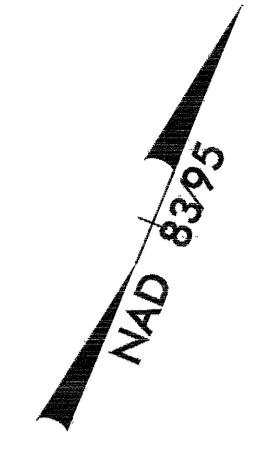

\* SBG DENOTES "SHOULDER BERM GUTTER"

-L-			
PI Sta 11+66.28 Δ = 0° 05' 16.7" (LT) D = 0° 06' 52.5" L = 76.78' T = 38.39' R = 50,000.00'	PI Sta 15+03.76 Δ = 3° 49' 15.6" (LT) D = 0° 57' 17.7" L = 400.13' T = 200.14' R = 6,000.00' SE = 02 RO = SEE PLANS	PI Sta 17+96.16 Δ = 7° 24' 28.5" (LT) D = 5° 35' 43.0" L = 132.40' T = 66.29' R = 1,024.00' SE = SEE PLANS RO = SEE PLANS	PI Sta 19+70.93 Δ = 25° 56' 55.1" (LT) D = 12° 08' 53.0" L = 213.60' T = 108.67' R = 471.65'

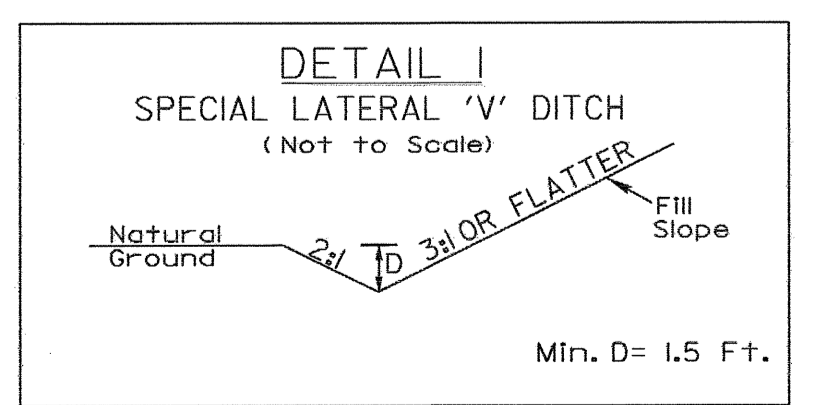

-L- STA 12+50 TO STA 14+35 (LT)  
-L- STA 16+80 TO STA 18+50 (LT)

NOTE: SEE SHEET NO. 5 FOR -L- PROFILE  
SEE SHEET S-1 THRU S- FOR STRUCTURE PLANS  
TRAFFIC IS TO BE MAINTAINED WITH AN OFF SITE DETOUR

30-DEC-2009 15:33  
R:\Environmental\Design\B4682\_EC\_PSH.dgn  
REVISED AT 2/14/08

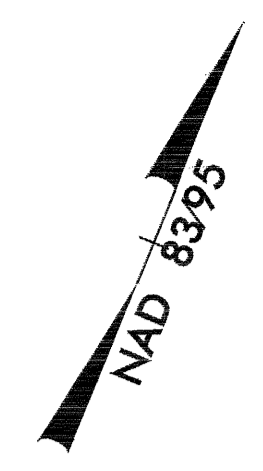

NOTE:  
UTILIZE TEMPORARY ROCK SILT CHECK TYPE - A AS STILLING BASIN WHERE APPLICABLE.

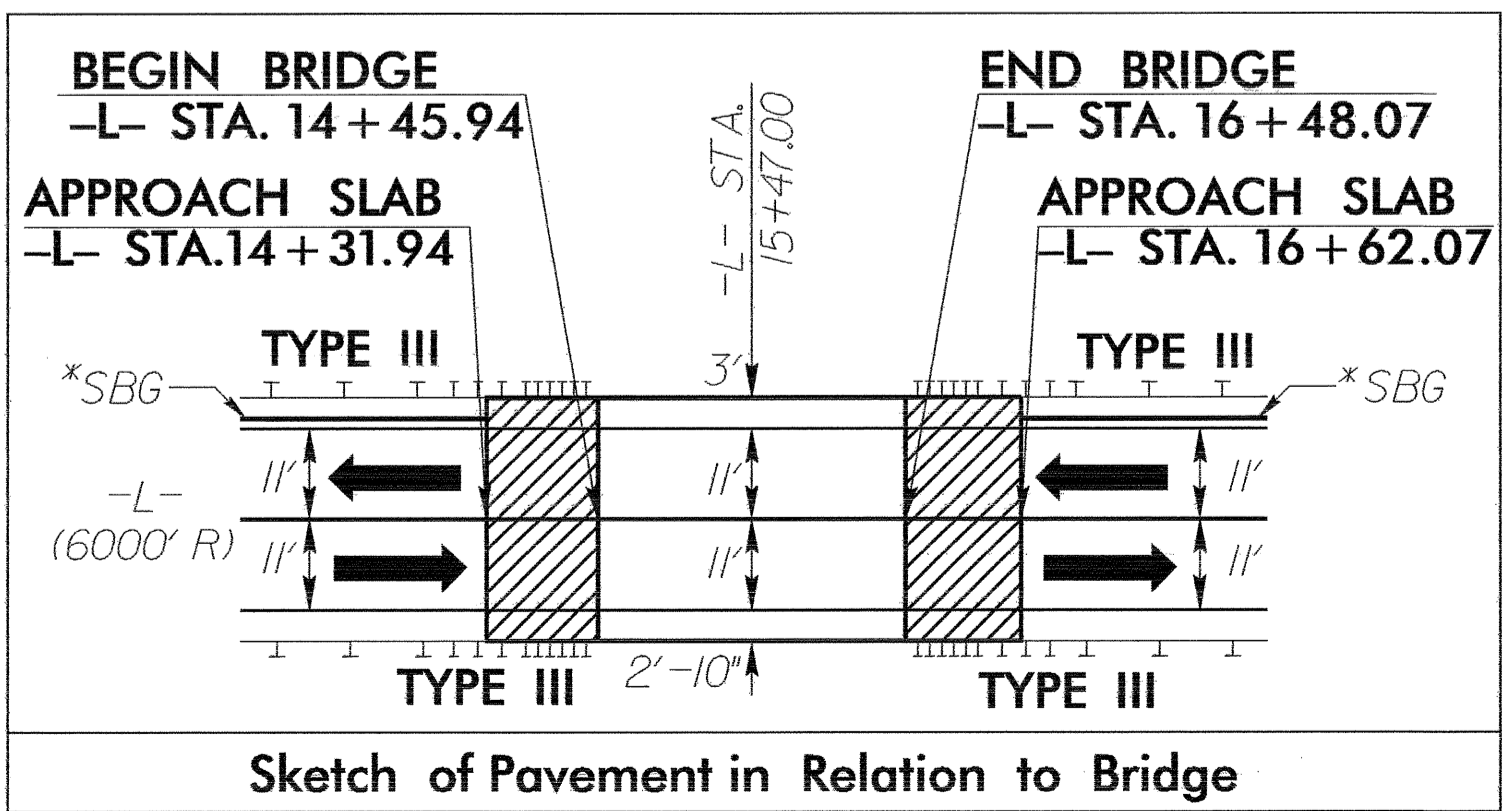
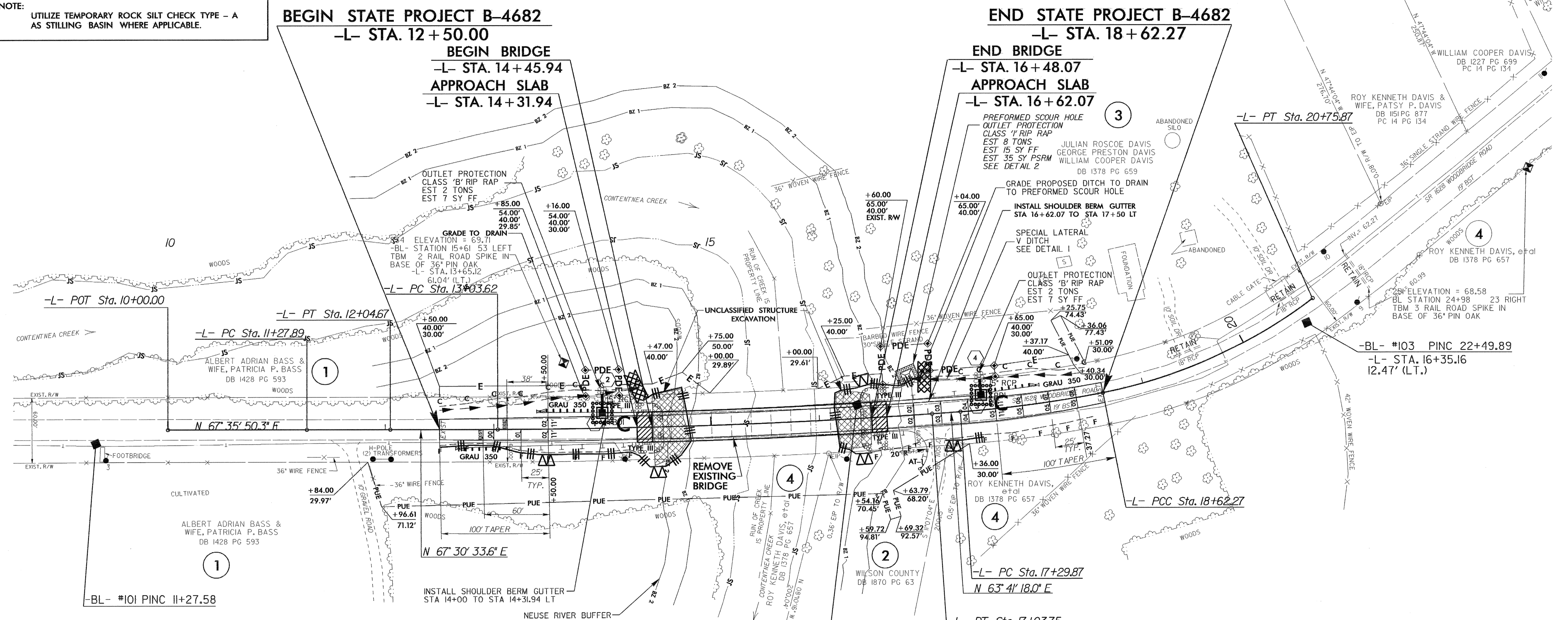

\* SBG DENOTES "SHOULDER BERM GUTTER"

-L-			
PI Sta 11+66.28 Δ = 0° 05' 16.7" (LT) D = 0° 06' 52.5" L = 76.78' T = 38.39' R = 50,000.00'	PI Sta 15+03.76 Δ = 3° 49' 15.6" (LT) D = 0° 57' 17.7" L = 400.13' T = 200.14' R = 6,000.00' SE = 02 RO = SEE PLANS	PI Sta 17+96.16 Δ = 7° 24' 28.5" (LT) D = 5° 35' 43.0" L = 132.40' T = 66.29' R = 1,024.00' SE = SEE PLANS RO = SEE PLANS	PI Sta 19+70.93 Δ = 25° 56' 55.1" (LT) D = 12° 08' 53.0" L = 213.60' T = 108.67' R = 471.65'

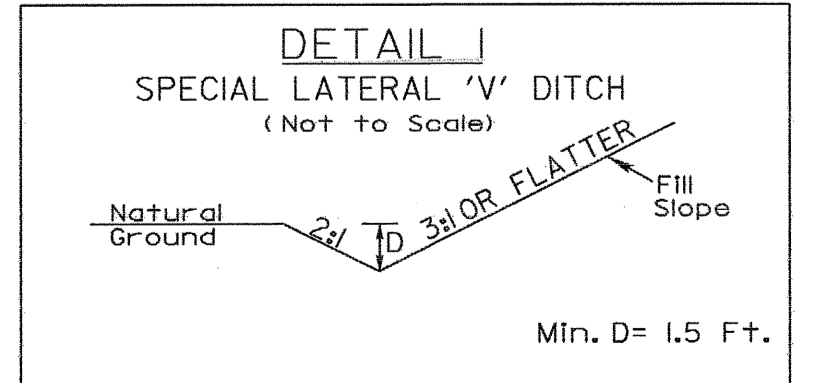

-L- STA 12+50 TO STA 14+35 (LT)  
-L- STA 16+80 TO STA 18+50 (LT)

NOTE: SEE SHEET NO. 5 FOR -L- PROFILE  
SEE SHEET S-1 THRU S- FOR STRUCTURE PLANS  
TRAFFIC IS TO BE MAINTAINED WITH AN OFF SITE DETOUR

30-DEC-2009 15:33 R:\enviro\comentia\Design\B-4682-EC\_PSH.dgn s:\branch\AT\REV227438