

T.I.P.: R-2233AA

**STATE OF NORTH CAROLINA  
DEPARTMENT OF TRANSPORTATION**

**PAVEMENT MARKING PLAN**

**RUTHERFORD COUNTY**

LOCATION: US 221 FROM SC STATE LINE  
TO JUST NORTH OF SR 2125

TIP NO. R-2233AA	SHEET NO. PMP-1
APPROVED:	
DATE: 12/1/19	
SEAL 	

**ROADWAY STANDARD DRAWING**

THE FOLLOWING ROADWAY STANDARDS AS APPEAR IN "ROADWAY STANDARD DRAWINGS" - PROJECT SERVICES UNIT - N.C. DEPARTMENT OF TRANSPORTATION - RALEIGH, N.C., DATED JULY 2006 ARE APPLICABLE TO THIS PROJECT AND BY REFERENCE HEREBY ARE CONSIDERED A PART OF THESE PLANS:

STD. NO.	TITLE
1205.01	PAVEMENT MARKINGS - LINE TYPES AND OFFSETS
1205.02	PAVEMENT MARKINGS - 2 LANE AND MULTILANE ROADWAYS
1205.04	PAVEMENT MARKINGS - INTERSECTIONS
1205.05	PAVEMENT MARKINGS - TURN LANES
1205.06	PAVEMENT MARKINGS - THRU LANE DROPS
1205.08	PAVEMENT MARKINGS - SYMBOL AND WORD MESSAGES
1205.09	PAVEMENT MARKINGS - PAINTED ISLANDS
1205.12	PAVEMENT MARKINGS - BRIDGES
1250.01	PAVEMENT MARKER SPACING
1253.01	SNOWPLOWABLE RAISED PAVEMENT MARKERS
1261.01	GUARDRAIL AND BARRIER DELINEATOR SPACING
1261.02	GUARDRAIL AND BARRIER DELINEATOR TYPES
1262.01	GUARDRAIL END DELINEATION
1264.01	OBJECT MARKERS
1264.02	PLACEMENT OF OBJECT MARKERS

**INDEX**

SHEET NO.	DESCRIPTION
PMP-1	PAVEMENT MARKING PLAN COVER SHEET
PMP-2	PAVEMENT MARKING SCHEDULE
PMP-3-22	PAVEMENT MARKING DETAIL

**GENERAL NOTES**

- THE FOLLOWING GENERAL NOTES APPLY AT ALL TIMES FOR THE DURATION OF THE CONSTRUCTION PROJECT, EXCEPT WHEN OTHERWISE NOTED IN THE PLAN, OR DIRECTED BY THE ENGINEER.
- A) INSTALL PAVEMENT MARKINGS AND PAVEMENT MARKERS ON THE FINAL SURFACE AS FOLLOWS:

ROAD NAME	MARKING	MARKER
ALL	THERMOPLASTIC	SNOWPLOWABLE RAISED
-L- BRIDGES	COLD APPLIED PLASTIC-TYPE 2	
  - B) TIE PROPOSED PAVEMENT MARKING LINES TO EXISTING PAVEMENT MARKING LINES.
  - C) REMOVE/REPLACE ANY CONFLICTING/DAMAGED PAVEMENT MARKINGS AND MARKERS.
  - D) STOPBAR LOCATION AT NON-SIGNALIZED INTERSECTIONS MAY BE ADJUSTED AS DIRECTED BY THE ENGINEER.
  - E) REMOVE ALL RESIDUE AND SURFACE LAITANCE BY ACCEPTABLE METHODS ON THE BRIDGE DECKS PRIOR TO PLACING COLD APPLIED PLASTIC PAVEMENT MARKING.
  - F) SNOWPLOWABLE MARKERS ARE TO BE PLACED ACCORDING TO THE ROADWAY STANDARD DRAWINGS.

**PLAN REVIEWED BY: N.C.D.O.T. SIGNING AND DELINEATION UNIT**

---

CHRIS HOWARD SIGNING & DELINEATION STANDARDS ENGINEER  
MARK MANRIQUEZ SIGNING & DELINEATION PROJECT DESIGN ENGINEER

**PLAN PREPARED BY: PROGRESSIVE DESIGN GROUP, INC.**

---

TIM AREY, P.E. PROJECT MANAGER  
LARRY ASHLEY ENGINEER

PLAN PREPARED IN THE OFFICE OF  
**PROGRESSIVE  
DESIGN GROUP, INC.**  
  
ENGINEERS • CONSULTANTS  
CHARLOTTE, NC 704.573.3003

TIP NO. R-2233AA	SHEET NO. PMP-2
APPROVED: <i>J. Auf</i>	
DATE: 12/1/19	
SEAL	
	

SYMB	DESCRIPTION	PAY ITEM	QUANTITY	TOTAL
		THERMOPLASTIC(24", 120 MILS)		
T2	WHITE STOPBAR		256 LF	
		TOTAL		256 LF
		COLD APPLIED PLASTIC (4") Type 2- Permanent High Performance		
CA	WHITE EDGELINE		1165 LF	
CB	YELLOW EDGELINE		1165 LF	
CC	10 FT. WHITE SKIP		291 LF	
		TOTAL		2621 LF
		THERMOPLASTIC(4", 120 MILS)		
TC	10 FT. WHITE SKIP		13250 LF	
TD	2 FT. WHITE MINISKIP		1144 LF	
TE	WHITE SOLID LANE LINE		570 LF	
TI	YELLOW DOUBLE CENTER		13400 LF	
		TOTAL		28364 LF
		THERMOPLASTIC(4", 90 MILS)		
TA	WHITE EDGELINE		67100 LF	
TB	YELLOW EDGELINE		59700 LF	
		TOTAL		126800 LF
		THERMOPLASTIC(6", 120 MILS)		
TN	2 FT. YELLOW MINISKIP		133 LF	
		TOTAL		133 LF
		THERMOPLASTIC(8", 90 MILS)		
TP	WHITE GORELINE		24470 LF	
TQ	WHITE DIAGONAL		4430 LF	
TT	YELLOW DIAGONAL		1750 LF	
		TOTAL		30650 LF
		THERMOPLASTICPAVEMENT MARKING CHARACTER (120 MILS)		
UI	ALPHANUMERIC CHAR.		36 EA	
		TOTAL		36 EA
		THERMOPLASTICPAVEMENT MARKING SYMBOLS (90 MILS)		
UA	LEFT TURN ARROW		30 EA	
UB	RIGHT TURN ARROW		56 EA	
UC	STRAIGHT ARROW		5 EA	
UK	U-TURN ARROW		47 EA	
		TOTAL		138 EA
		MARKERS		
		SNOWPLOWABLE RAISED PAVEMENT MARKERS		
ME	YELLOW & YELLOW		201 EA	
MF	CRYSTAL & RED		1910 EA	
		TOTAL		2111 EA

TIP NO. R-2233AA	SHEET NO. PMP-3
APPROVED: <i>[Signature]</i>	
DATE: 12/19	
SEAL	
	

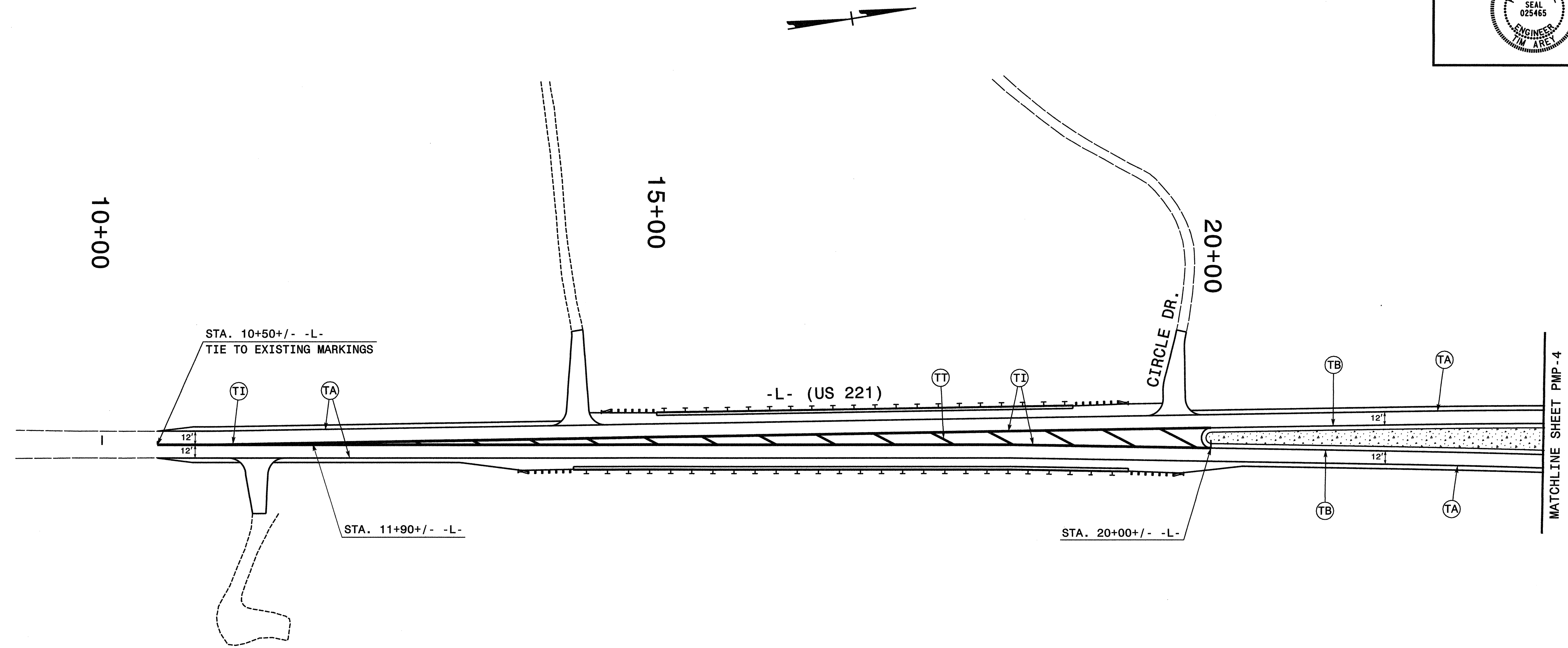

TIP NO. R-2233AA	SHEET NO. PMP-4
APPROVED: <i>[Signature]</i>	
DATE: 12/1/19	
SEAL	
	

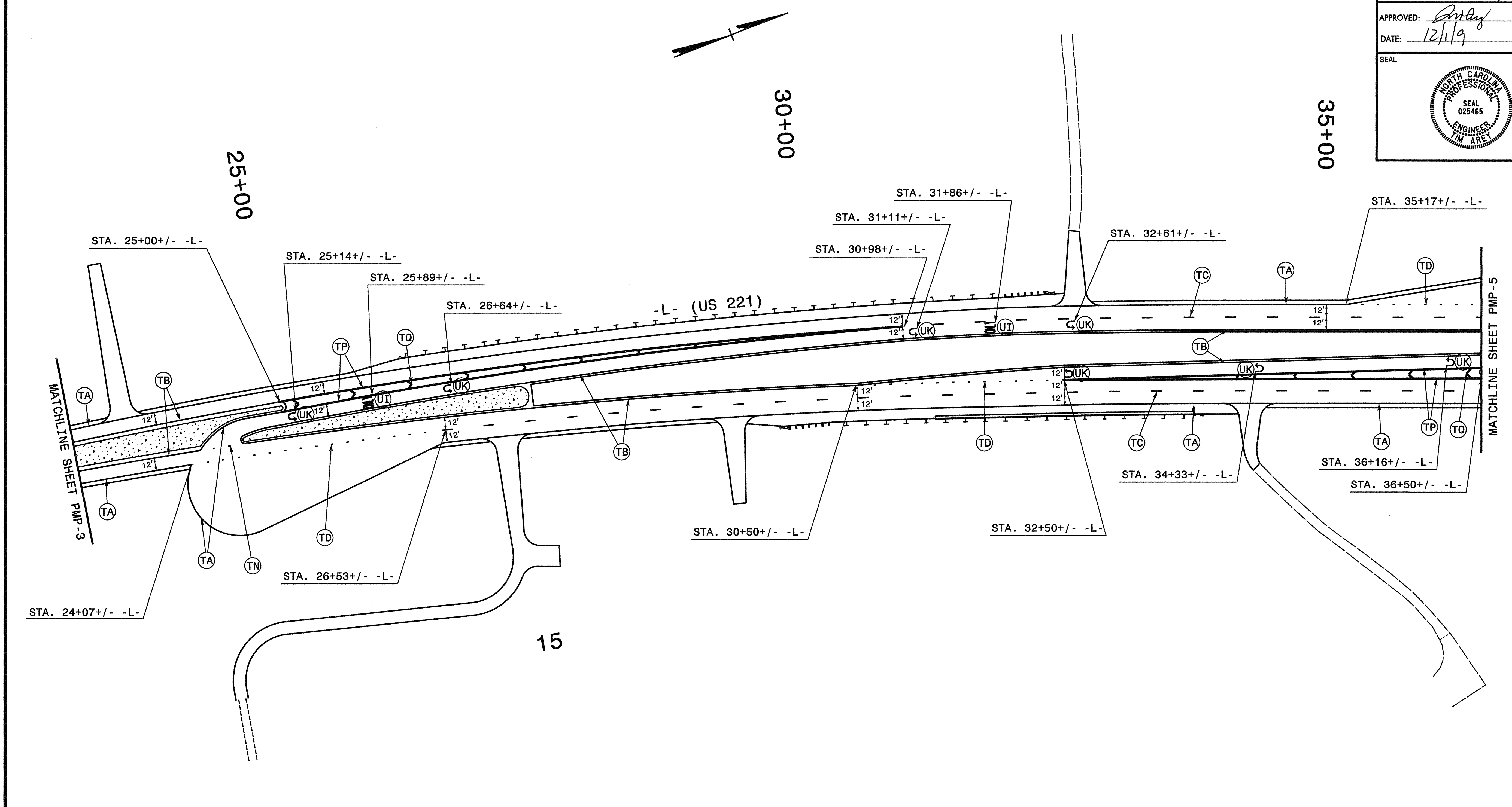

**NOTE:**  
SEE ROADWAY STANDARD FOR PLACEMENT OF SYMBOLS AND  
CHARACTERS UNLESS OTHERWISE SPECIFIED ON THE PLAN.



TIP NO. R-2233AA	SHEET NO. PMP-5
APPROVED: <i>[Signature]</i>	
DATE: 12/19	
SEAL	
	

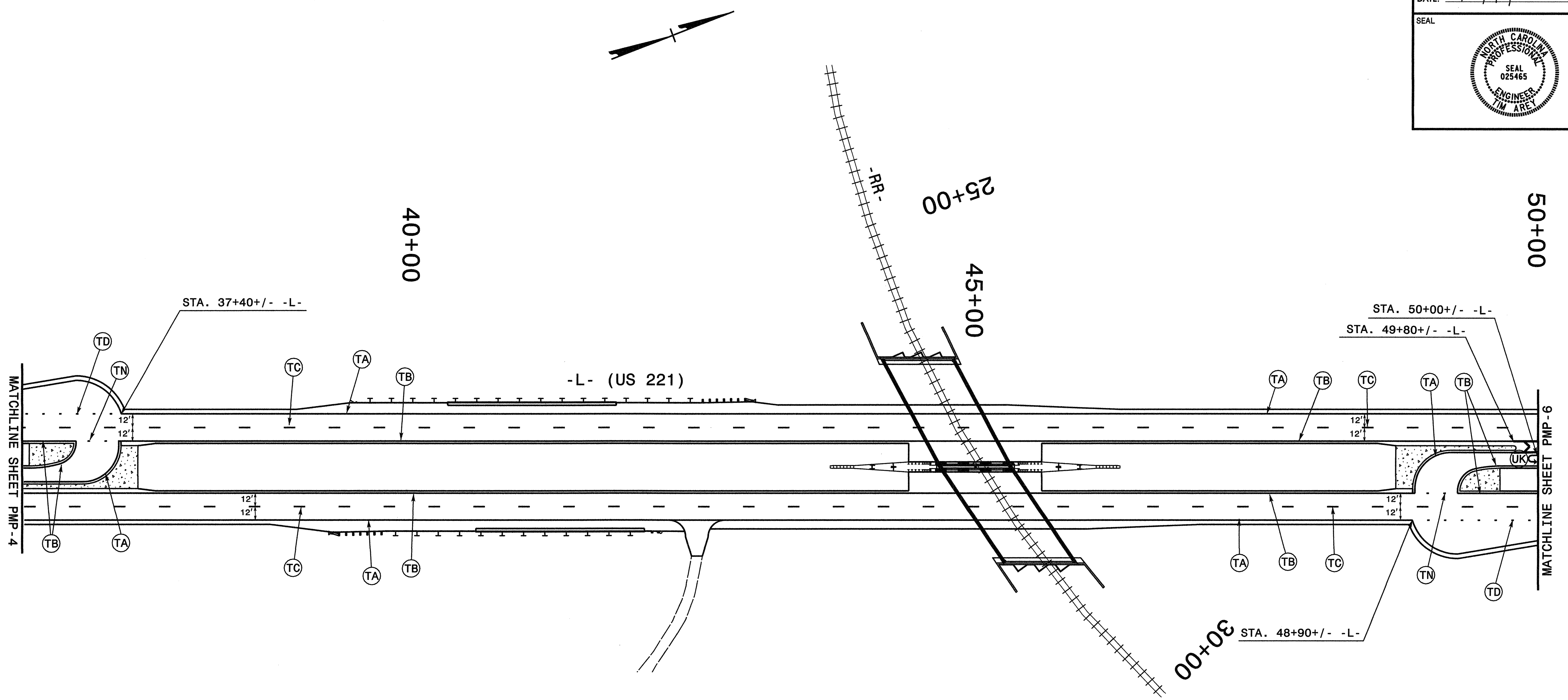

**NOTE:**  
SEE ROADWAY STANDARD FOR PLACEMENT OF SYMBOLS AND CHARACTERS UNLESS OTHERWISE SPECIFIED ON THE PLAN.

**PAVEMENT MARKING DETAIL**

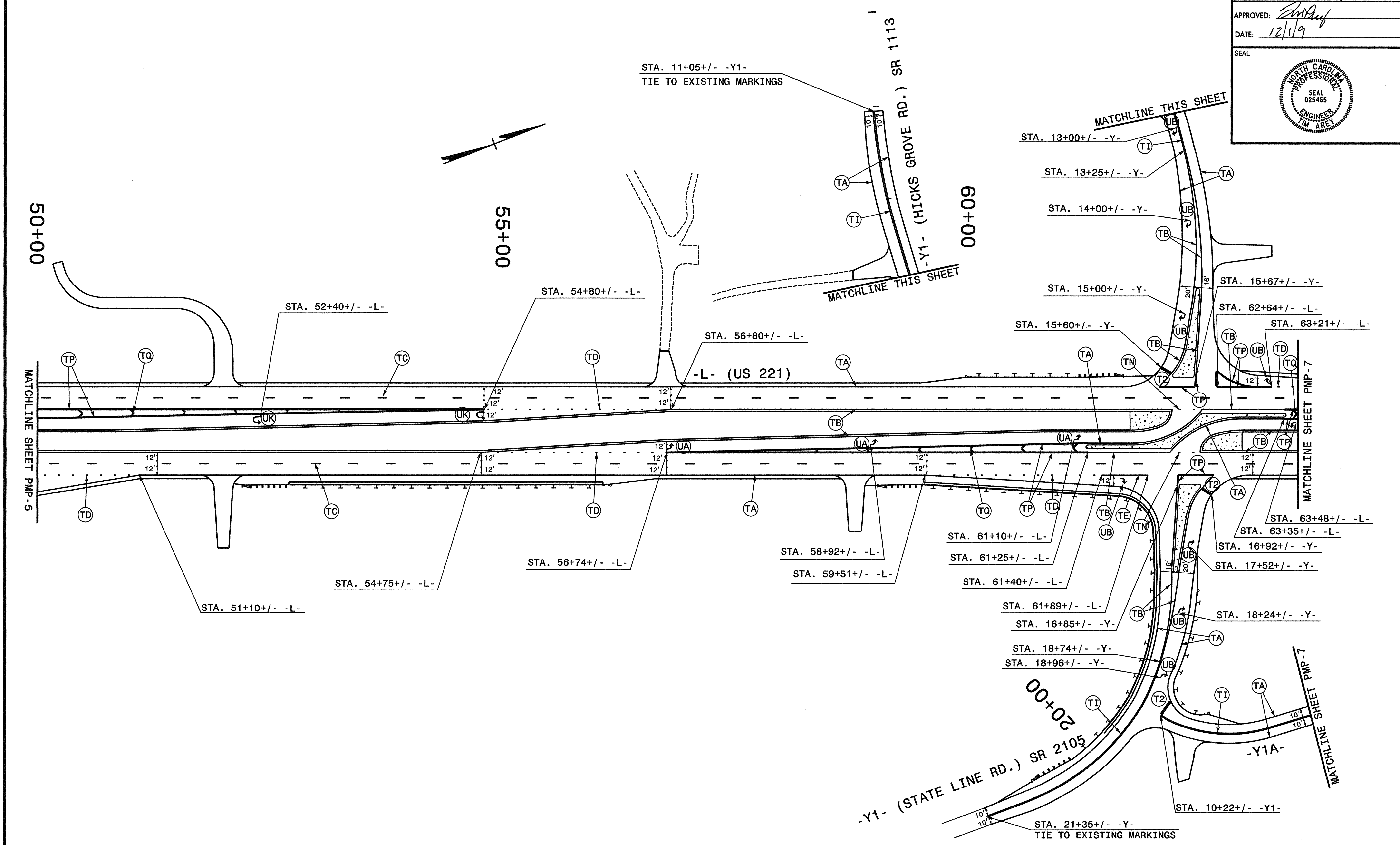

NOTE:  
SEE ROADWAY STANDARD FOR PLACEMENT OF SYMBOLS AND CHARACTERS UNLESS OTHERWISE SPECIFIED ON THE PLAN.

**PAVEMENT MARKING DETAIL**

TIP NO. R-2233AA	SHEET NO. PMP-7
APPROVED: <i>[Signature]</i>	
DATE: 12/1/19	
SEAL	
	

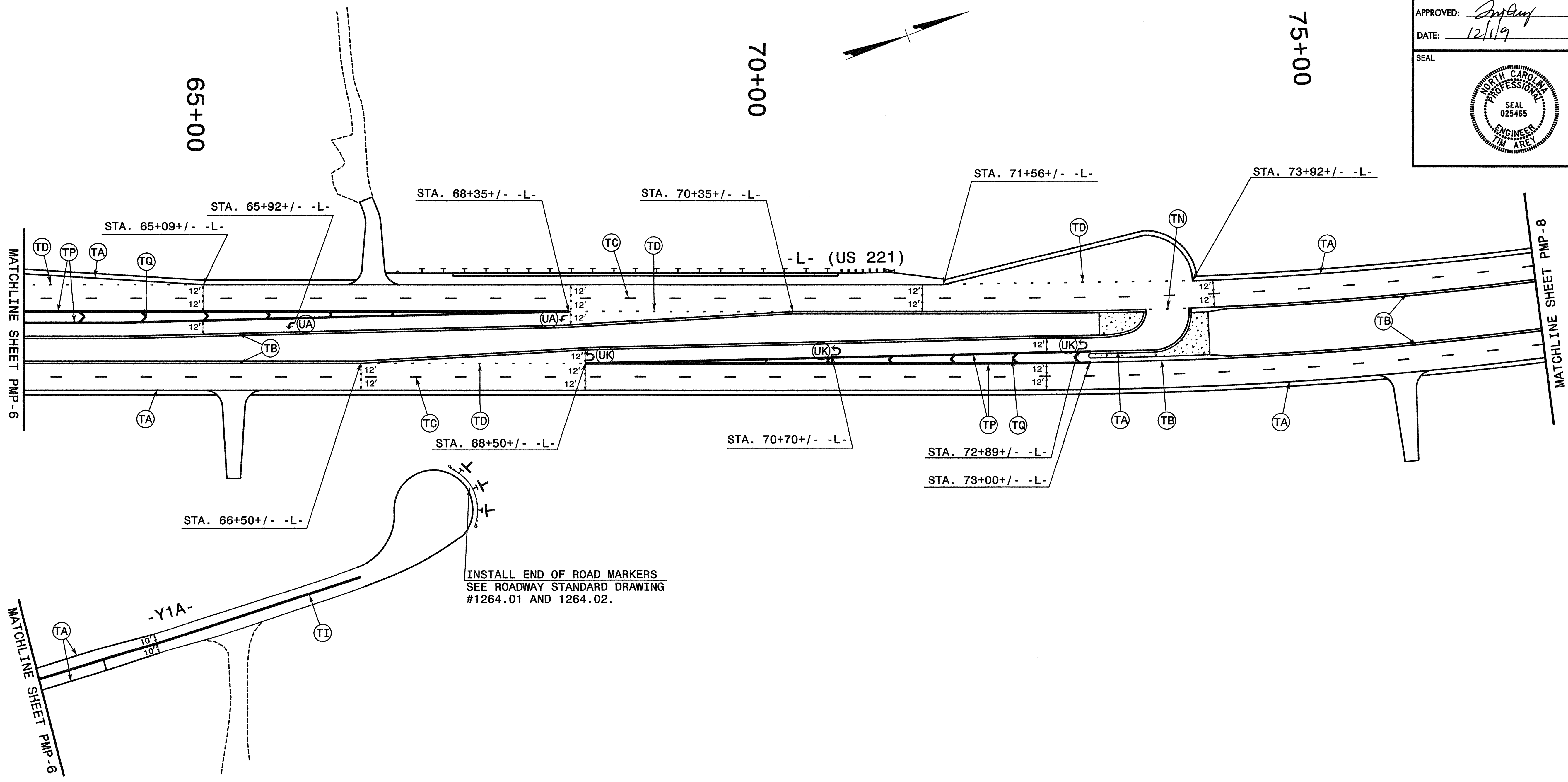

**NOTE:**  
SEE ROADWAY STANDARD FOR PLACEMENT OF SYMBOLS AND CHARACTERS UNLESS OTHERWISE SPECIFIED ON THE PLAN.



TIP NO. R-2233AA	SHEET NO. PMP-8
APPROVED: <i>Tim Arey</i>	
DATE: 12/19	
SEAL	
	

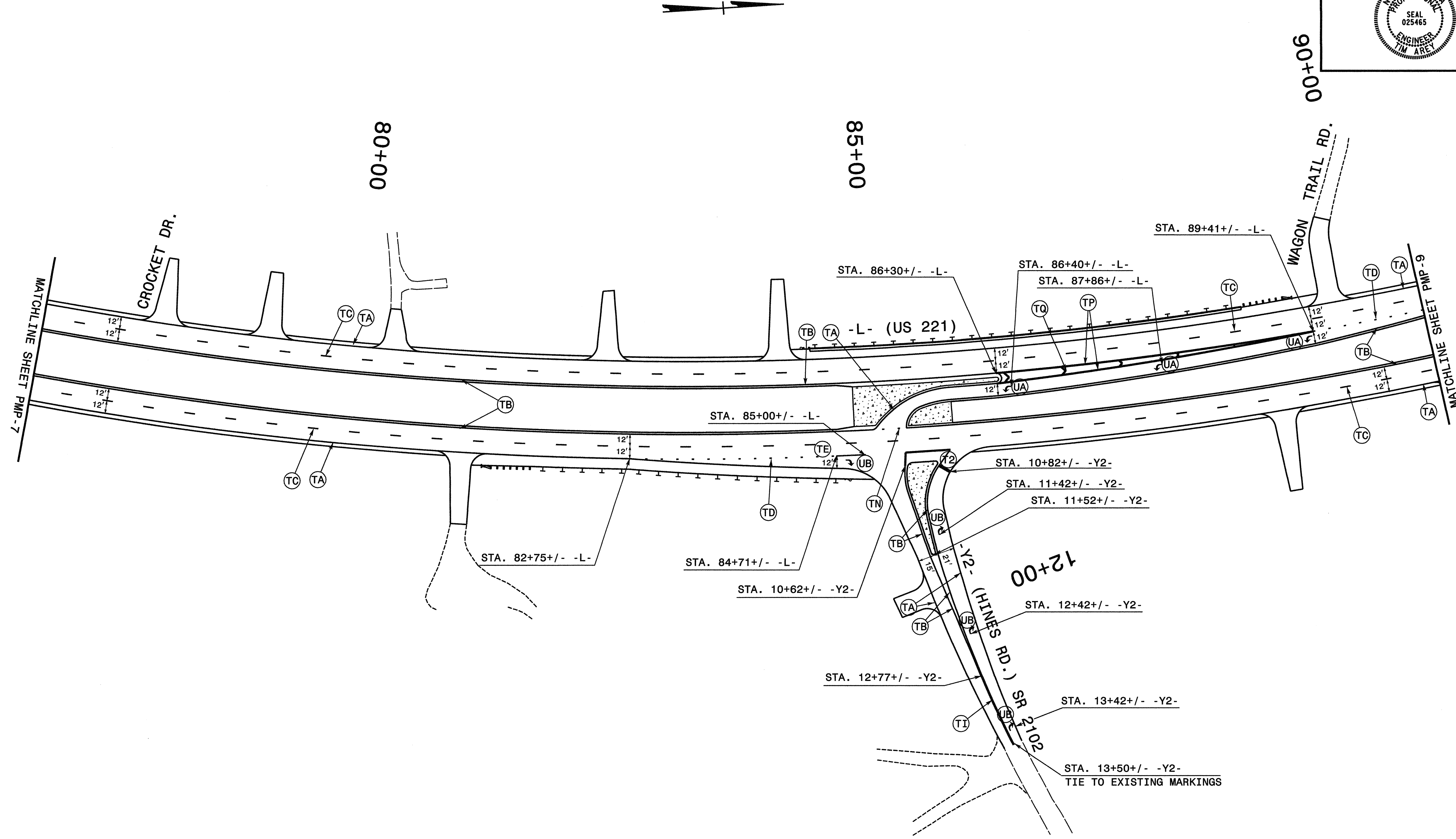

**NOTE:**  
SEE ROADWAY STANDARD FOR PLACEMENT OF SYMBOLS AND CHARACTERS UNLESS OTHERWISE SPECIFIED ON THE PLAN.

**PAVEMENT MARKING DETAIL**



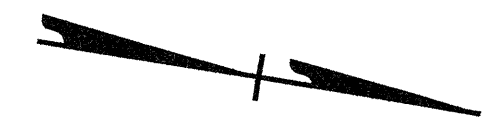

TIP NO. R-2233AA	SHEET NO. PMP-9
APPROVED: <i>[Signature]</i>	
DATE: 12/19	
SEAL	
	

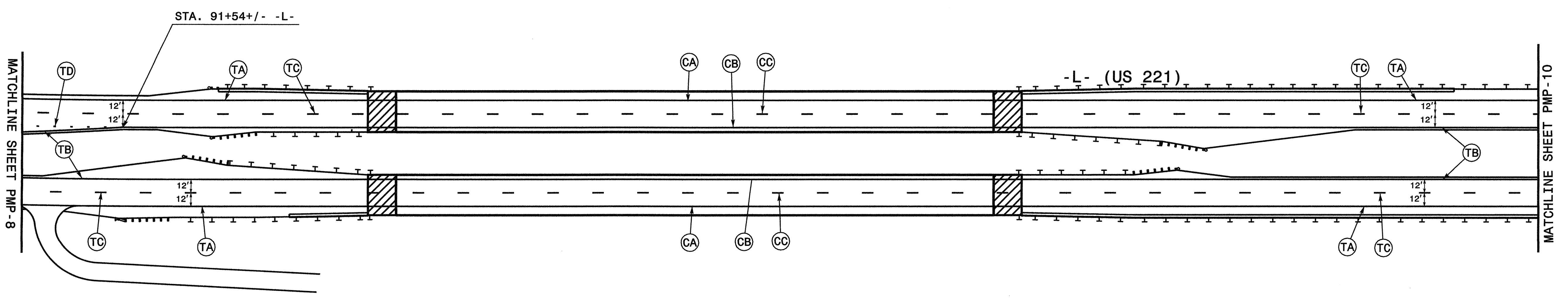

95+00

100+00



TIP NO. R-2233AA	SHEET NO. PMP-10
APPROVED: <i>[Signature]</i>	
DATE: 12/1/9	
SEAL	
	

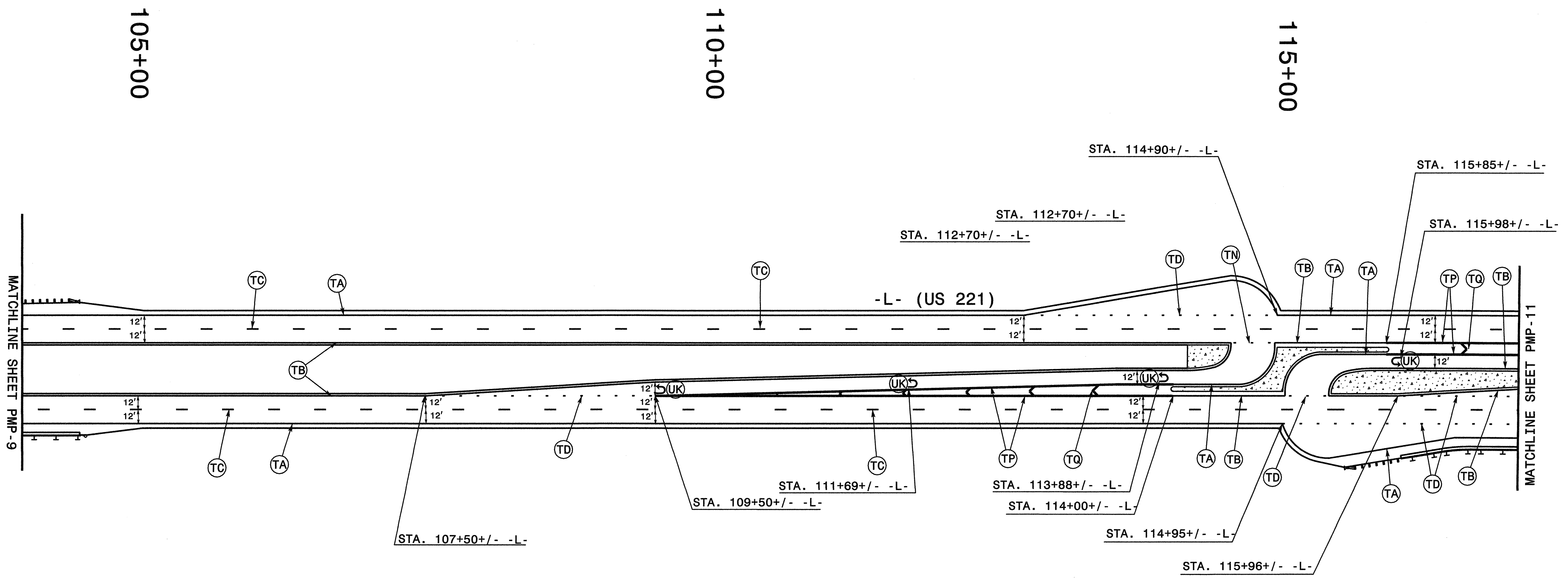

**NOTE:**  
SEE ROADWAY STANDARD FOR PLACEMENT OF SYMBOLS AND CHARACTERS UNLESS OTHERWISE SPECIFIED ON THE PLAN.

**PAVEMENT MARKING DETAIL**

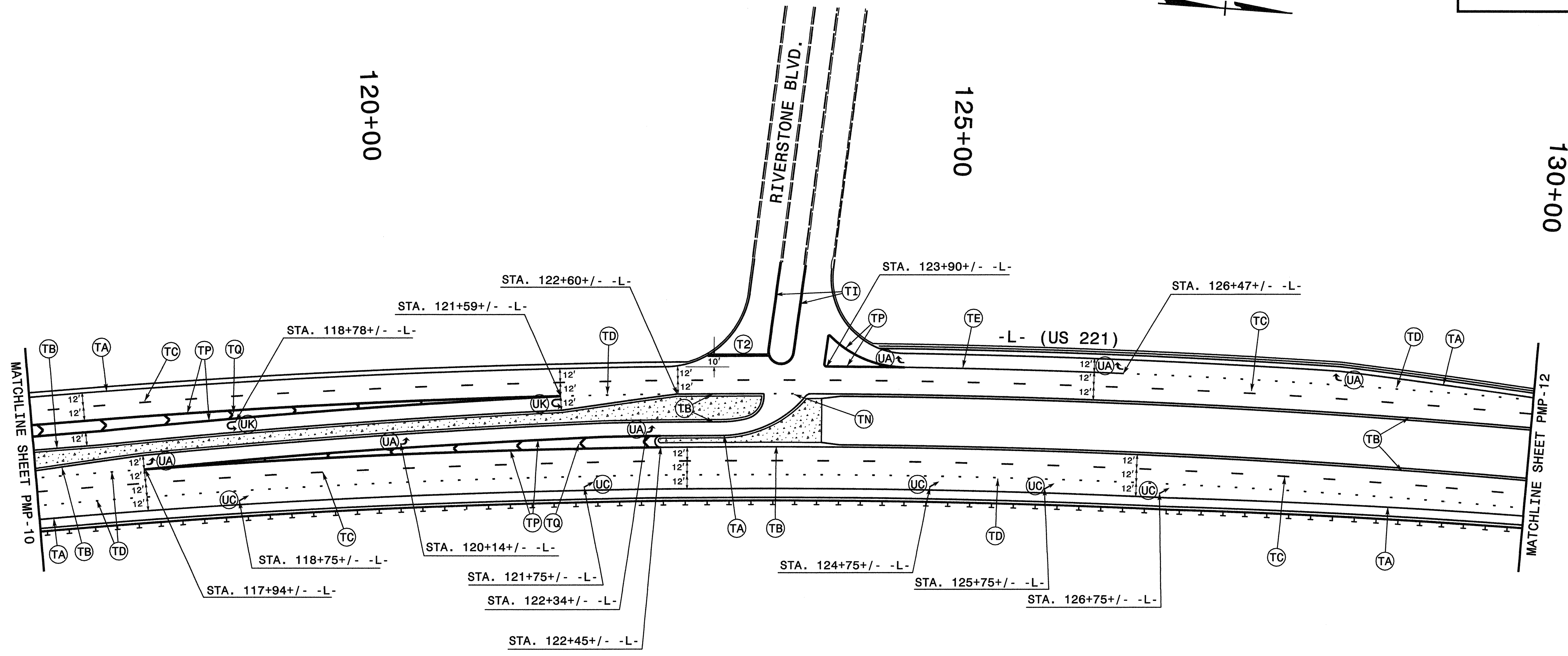

**NOTE:**  
SEE ROADWAY STANDARD FOR PLACEMENT OF SYMBOLS AND CHARACTERS UNLESS OTHERWISE SPECIFIED ON THE PLAN.



TIP NO. R-2233AA	SHEET NO. PMP-12
APPROVED: <i>[Signature]</i>	
DATE: 12/1/19	
SEAL	
	

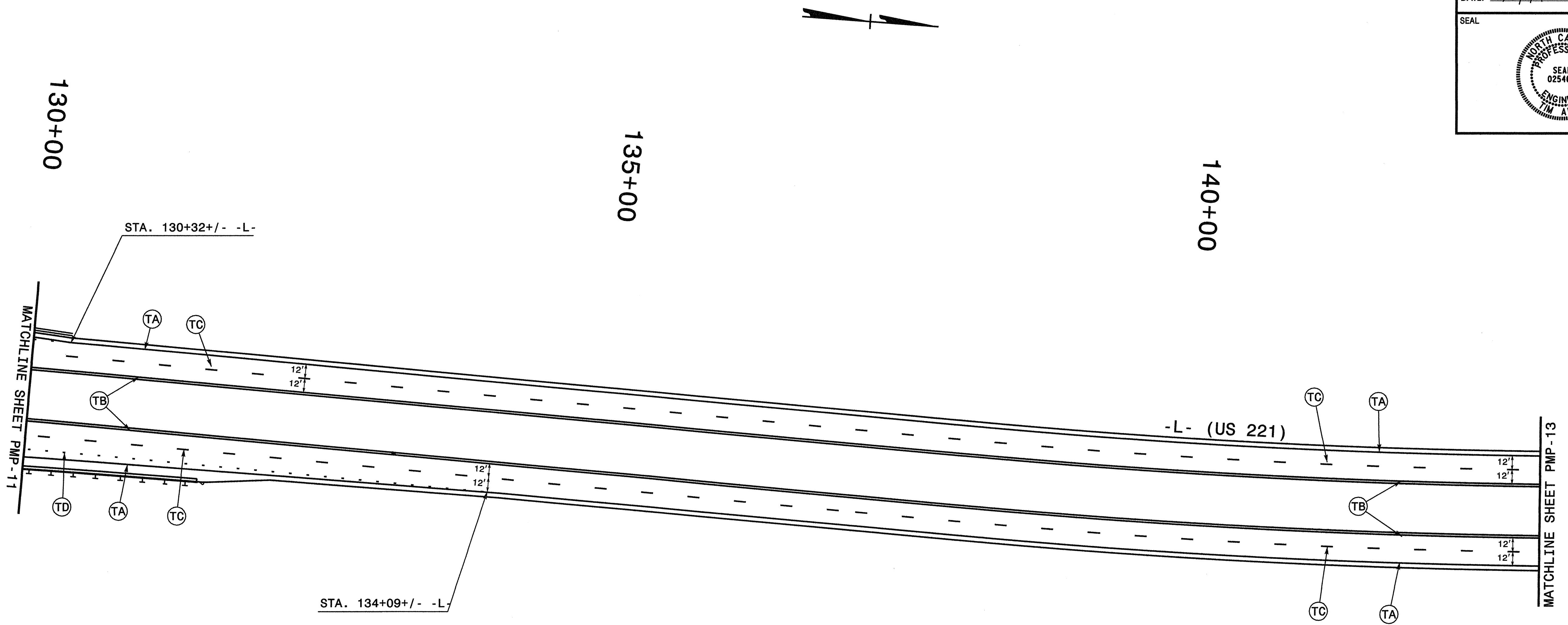

TIP NO. R-2233AA	SHEET NO. PMP-13
APPROVED: <i>[Signature]</i>	
DATE: 12/19	
SEAL	
	

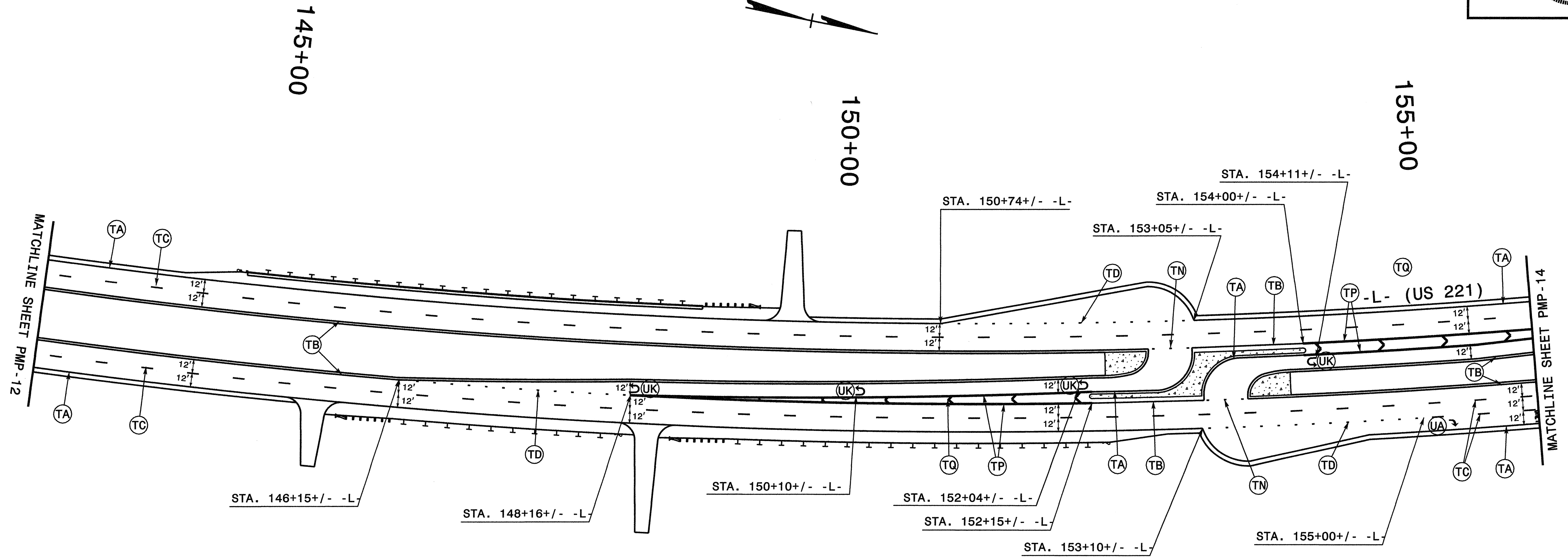

**NOTE:**  
SEE ROADWAY STANDARD FOR PLACEMENT OF SYMBOLS AND CHARACTERS UNLESS OTHERWISE SPECIFIED ON THE PLAN.

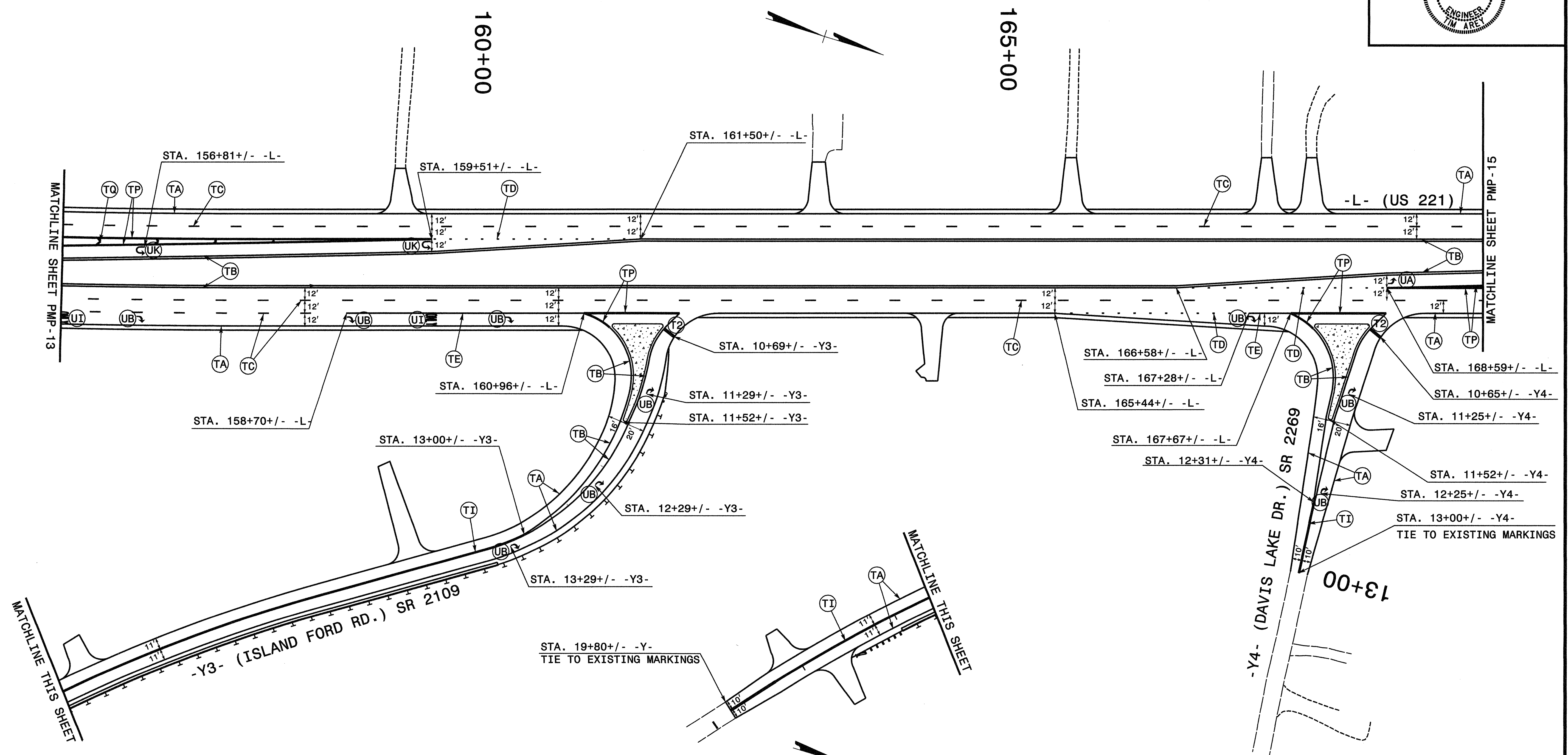

NOTE:  
SEE ROADWAY STANDARD FOR PLACEMENT OF SYMBOLS AND CHARACTERS UNLESS OTHERWISE SPECIFIED ON THE PLAN.



TIP NO. R-2233AA	SHEET NO. PMP-15
APPROVED: <i>[Signature]</i>	
DATE: 12/19	
SEAL	
	

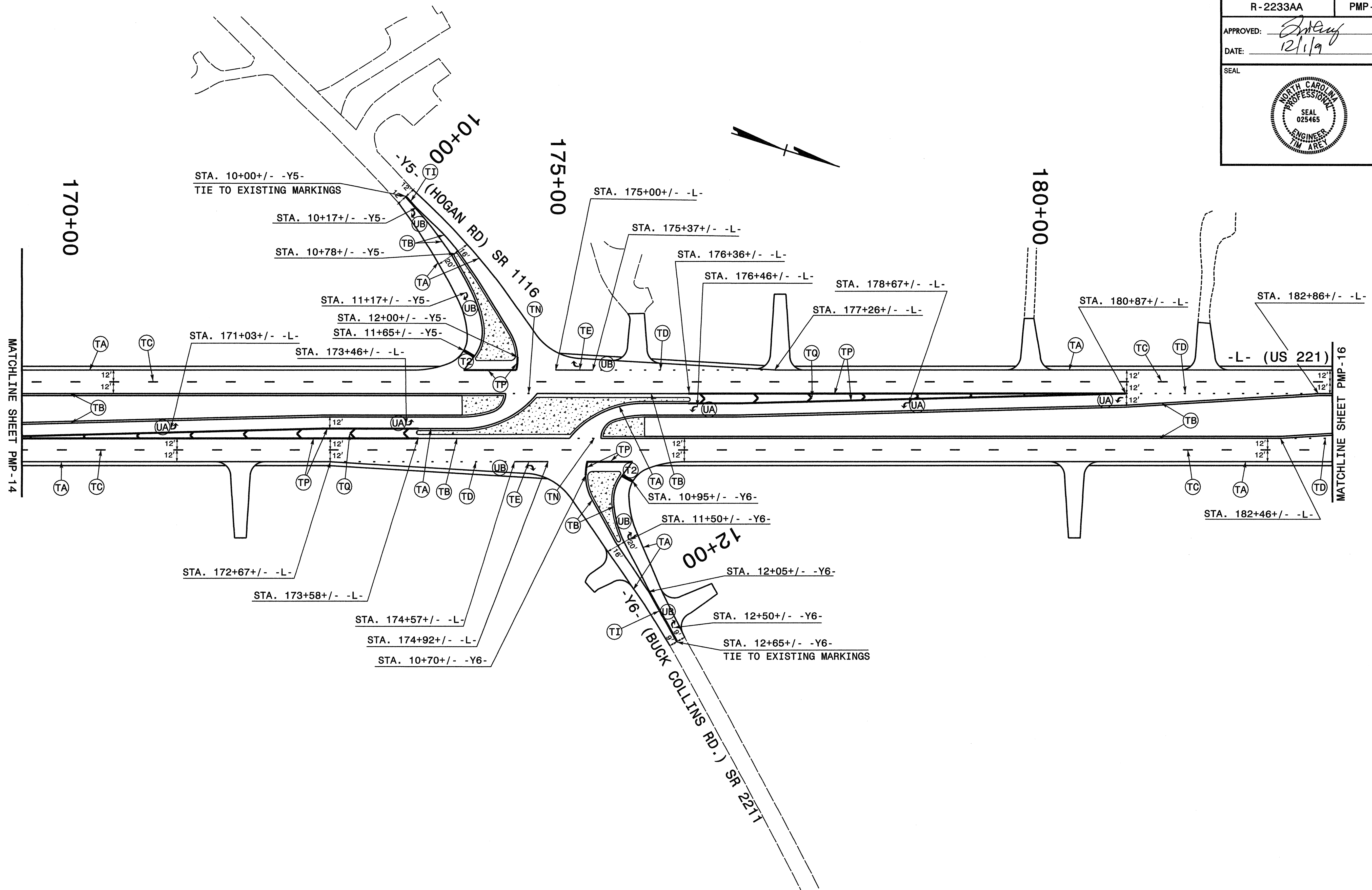

**NOTE:**  
SEE ROADWAY STANDARD FOR PLACEMENT OF SYMBOLS AND CHARACTERS UNLESS OTHERWISE SPECIFIED ON THE PLAN.

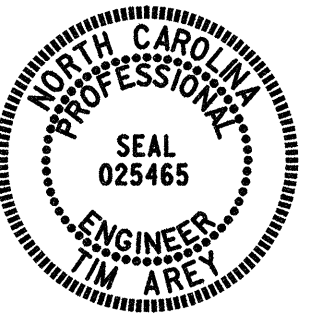
TIP NO. R-2233AA	SHEET NO. PMP-16
APPROVED: <i>[Signature]</i>	
DATE: 12/1/19	
SEAL	
	

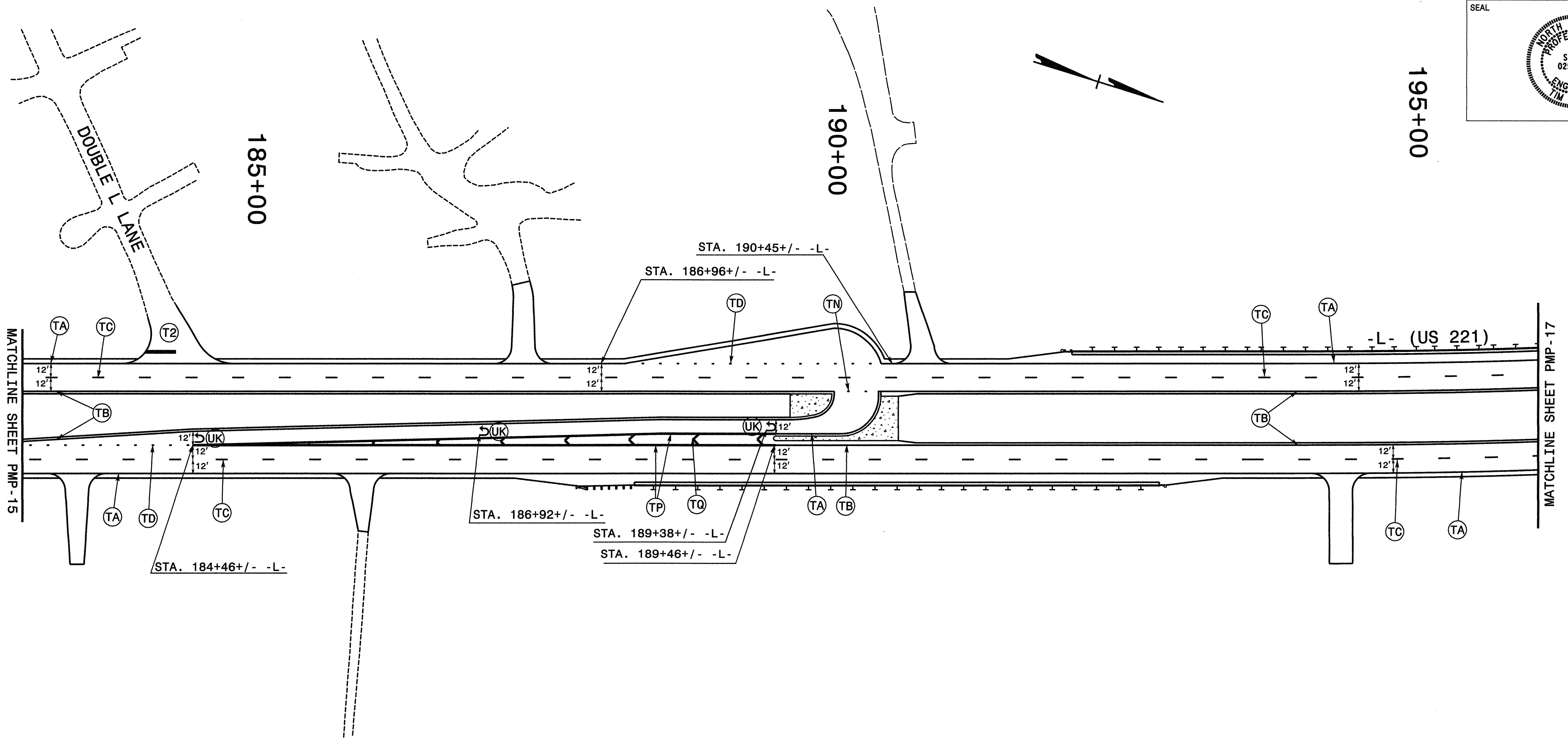

NOTE:  
SEE ROADWAY STANDARD FOR PLACEMENT OF SYMBOLS AND CHARACTERS UNLESS OTHERWISE SPECIFIED ON THE PLAN.

**PAVEMENT MARKING DETAIL**

TIP NO. R-2233AA	SHEET NO. PMP-17
APPROVED: <i>[Signature]</i>	
DATE: 12/1/9	
SEAL	
	

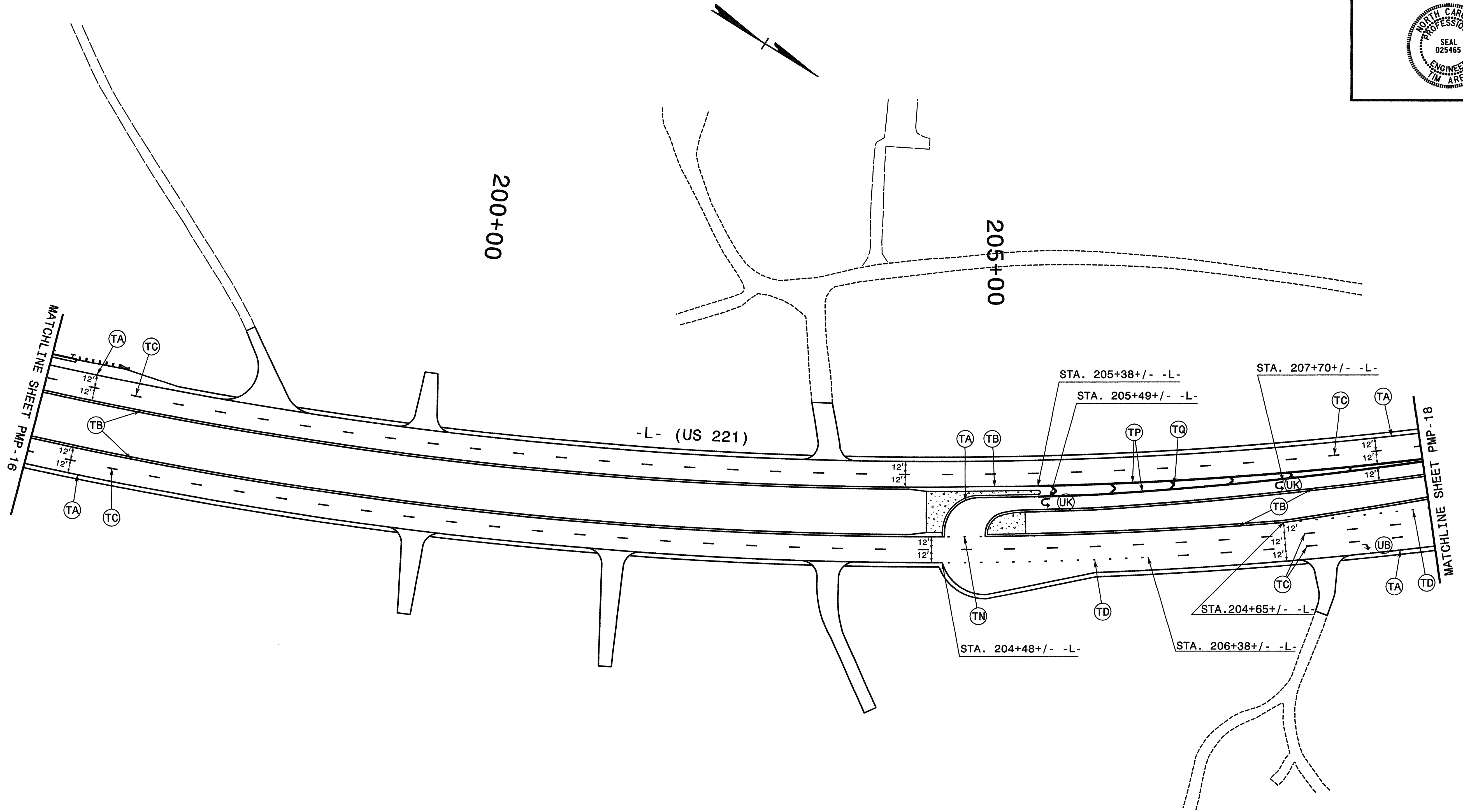

NOTE:  
SEE ROADWAY STANDARD FOR PLACEMENT OF SYMBOLS AND CHARACTERS UNLESS OTHERWISE SPECIFIED ON THE PLAN.

**PAVEMENT MARKING DETAIL**



TIP NO. R-2233AA	SHEET NO. PMP-18
APPROVED: <i>[Signature]</i>	
DATE: 12/19	
SEAL	
	

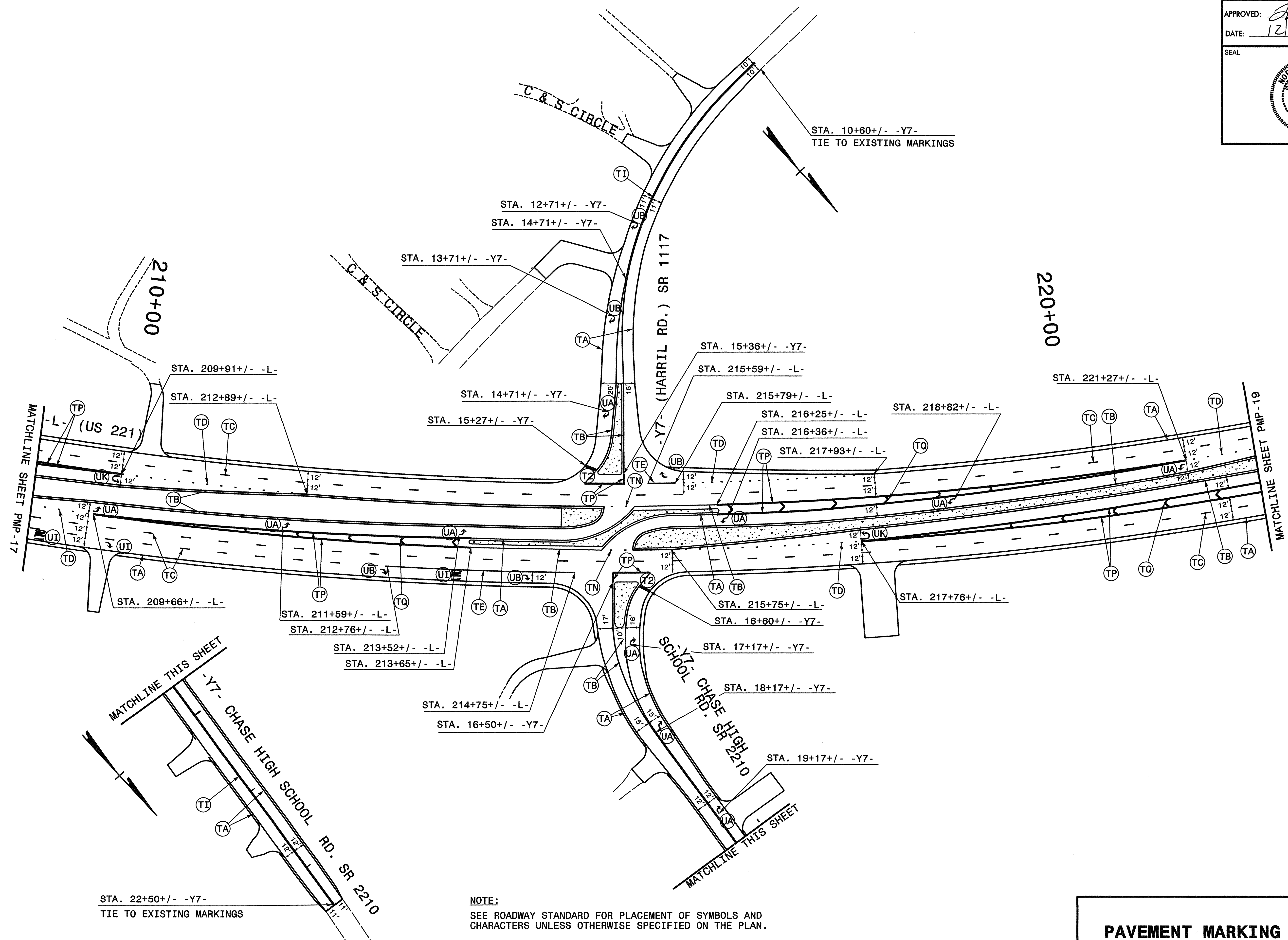

STA. 22+50+/- -Y7-  
TIE TO EXISTING MARKINGS

NOTE:  
SEE ROADWAY STANDARD FOR PLACEMENT OF SYMBOLS AND  
CHARACTERS UNLESS OTHERWISE SPECIFIED ON THE PLAN.

**PAVEMENT MARKING DETAIL**

TIP NO. R-2233AA	SHEET NO. PMP-19
APPROVED: <i>[Signature]</i>	
DATE: 12/19	
SEAL	

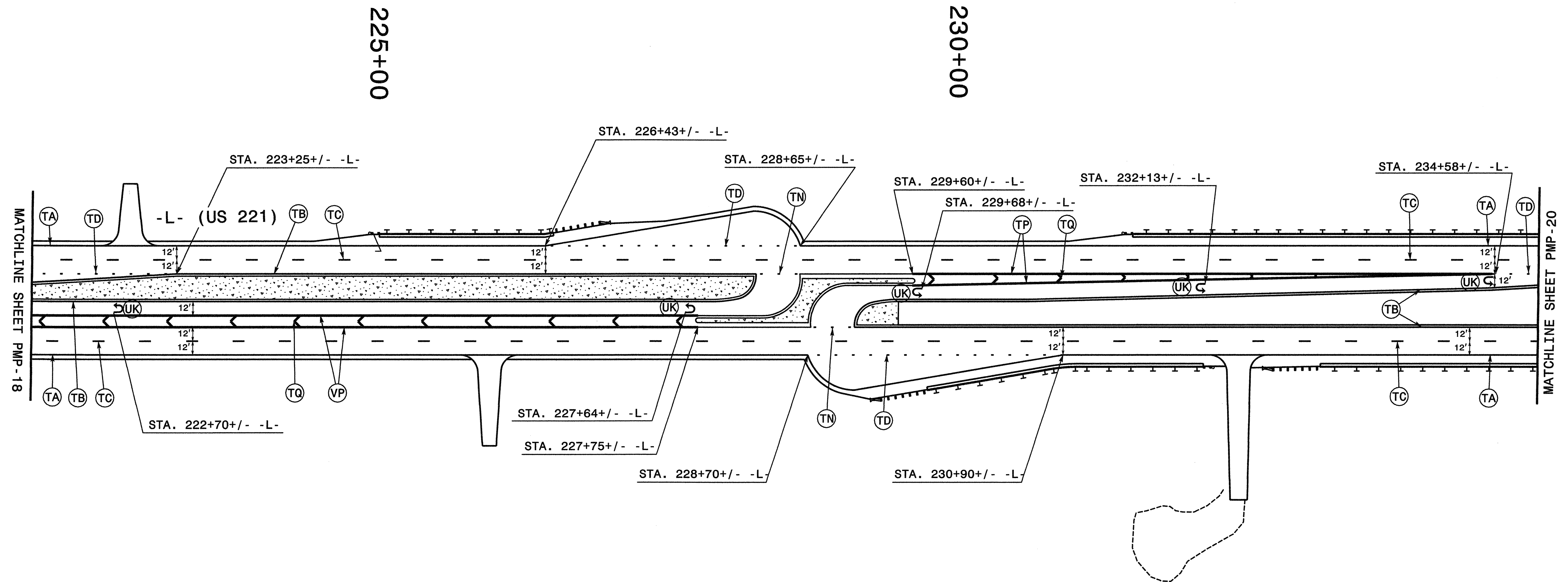

**NOTE:**  
SEE ROADWAY STANDARD FOR PLACEMENT OF SYMBOLS AND CHARACTERS UNLESS OTHERWISE SPECIFIED ON THE PLAN.

**PAVEMENT MARKING DETAIL**





TIP NO. R - 2233AA	SHEET NO. PMP - 21
APPROVED: <i>[Signature]</i>	
DATE: 12/19	
SEAL	
	

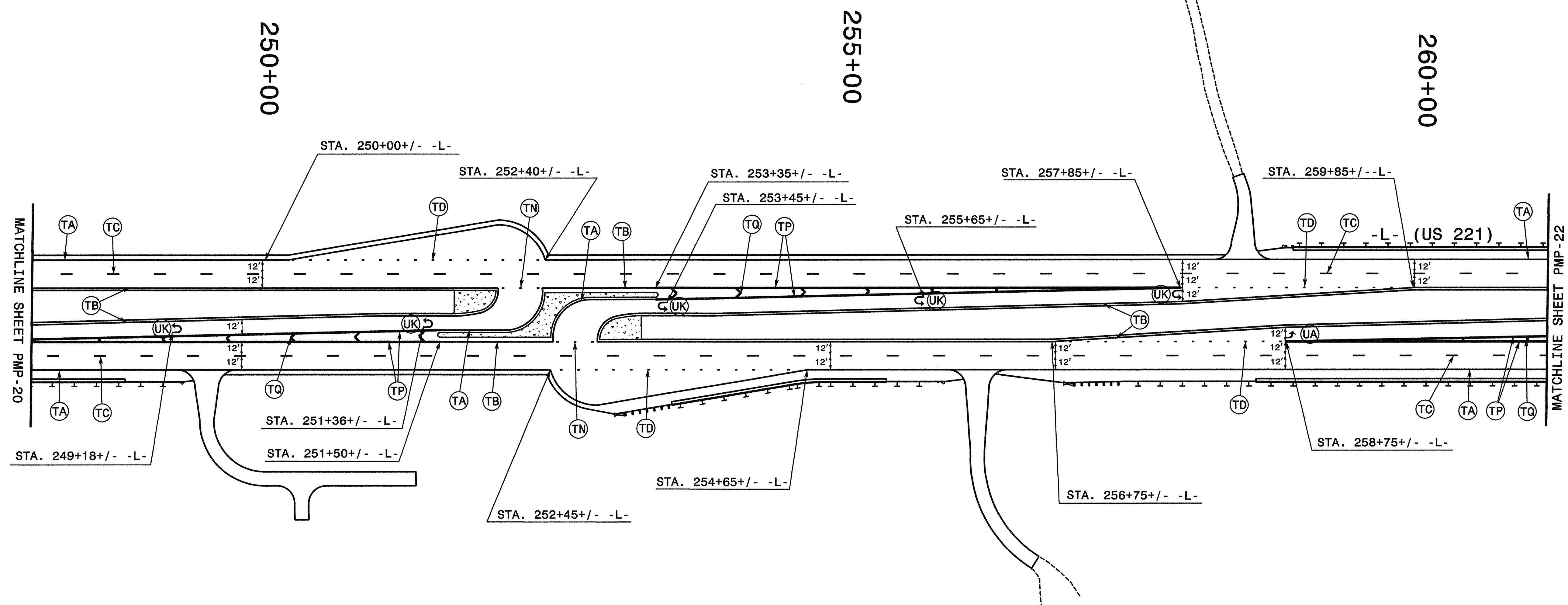

NOTE:  
SEE ROADWAY STANDARD FOR PLACEMENT OF SYMBOLS AND  
CHARACTERS UNLESS OTHERWISE SPECIFIED ON THE PLAN.

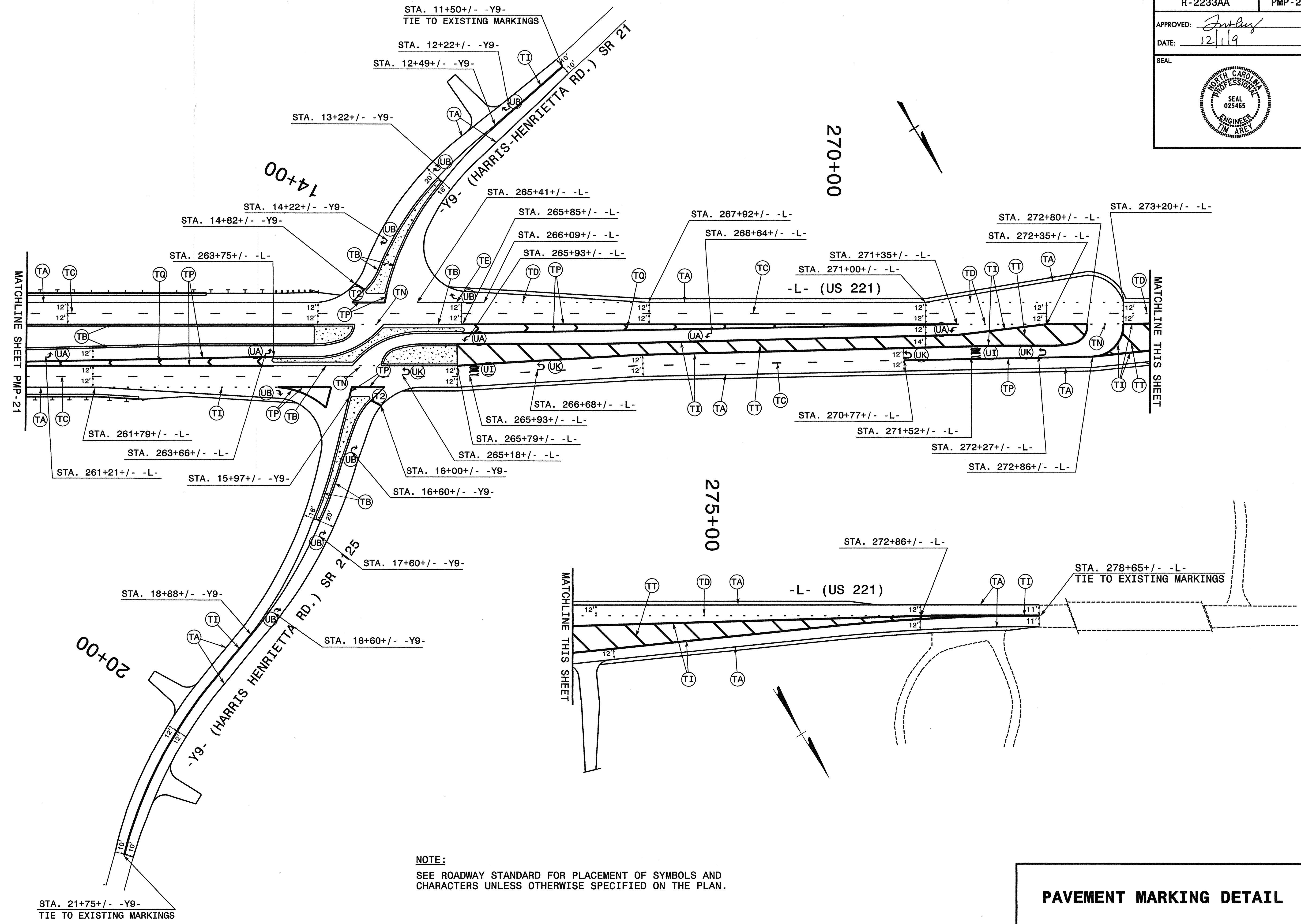

**PAVEMENT MARKING DETAIL**