

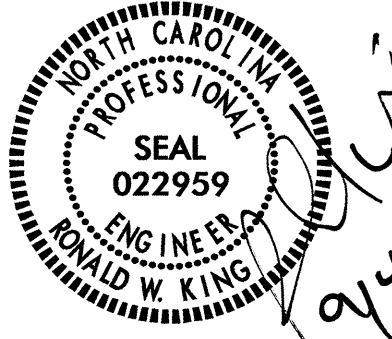

TIP NO. R-2814A	SHEET NO. SIGN-1
APPROVED: _____	
DATE: _____	
SEAL	
	

**STATE OF NORTH CAROLINA
DEPARTMENT OF TRANSPORTATION**

**SIGNING PLANS
WAKE COUNTY**

**LOCATION: US 401 FROM SR 2044 (LIGON MILL ROAD)
TO SOUTH OF SR 2226 (JONESVILLE ROAD)**

T.I.P.: R-2814A

CONTRACT: C202228

ROADWAY STANDARD DRAWING

THE FOLLOWING ROADWAY STANDARDS AS APPEAR IN "ROADWAY STANDARD DRAWINGS" - PROJECT SERVICES UNIT - N.C. DEPARTMENT OF TRANSPORTATION - RALEIGH, N.C., DATED JULY 2006 ARE APPLICABLE TO THIS PROJECT AND BY REFERENCE HEREBY ARE CONSIDERED A PART OF THESE PLANS:

STD. NO.	TITLE
901.50	ARROWS AND SHIELDS
901.70	SIGN STRINGERS AND SUPPORT SPACING
901.80	SIGN MOUNTING DETAILS - FOR TYPE A AND TYPE B SIGNS
904.10	ORIENTATION OF GROUND MOUNTED SIGNS
904.50	MOUNTING OF TYPE 'D', 'E' AND 'F' SIGNS ON 'U' CHANNEL POSTS

GENERAL NOTES

- . SIGNS FURNISHED BY STATE
- . ALL TYPE 'D' SIGNS SHALL BE MOUNTED ON TWO U-CHANNEL POSTS UNLESS OTHERWISE INDICATED ON THE PLANS.
- . IF REMOVAL OR RELOCATION OF SIGNS ON PRIVATE STREET (NON-STATE MAINTAINED) IS REQUIRED DUE TO CONSTRUCTION, THE CONTRACTOR SHALL INFORM THE ENGINEER. THE WORK WILL BE COMPLETED BY OTHERS.
- . SIGNING PLANS DO NOT INCLUDE TEMPORARY CONSTRUCTION SIGNING OR PAVEMENT MARKINGS. SEE TRAFFIC CONTROL PLANS.
- . WHEN NOT STATIONED OR DIMENSIONED ON PLANS, ALL 'E' AND 'F' SIGNS SHALL BE FIELD LOCATED BY THE ENGINEER
- . ALL EXISTING SIGNS ON "U" CHANNEL POST WITHIN THE PROJECT LIMITS SHALL BE REMOVED AND DISPOSED OF UNLESS OTHERWISE NOTED ON PLANS.
- . WHEN EXISTING SIGNS ARE REMOVED AND INSTALLED ON NEW SUPPORTS, THE RE-ERECTION SHALL IMMEDIATELY FOLLOW THE REMOVAL.
- . THE BACKGROUND FOR TYPE E & F SIGNS SHALL BE TYPE C REFLECTIVE SHEETING.
- . SEE ROADWAY PLANS FOR GUARD/GUIDE RAIL DETAILS.

SUMMARY OF QUANTITIES

ITEM NO.	DESC. NO.	SECT. NO.	ITEM DESCRIPTION	QUANTITY	UNIT
4072000000	903		SUPPORTS, 4.5 kg STEEL U-CHANNEL	717	M.
4096000000	904		SIGN ERECTION, TYPE D	4	EA.
4102000000	904		SIGN ERECTION, TYPE E	126	EA.
4108000000	904		SIGN ERECTION, TYPE F	11	EA.
4116100000	904		SIGN ERECTION, RELOCATE SIGN TYPE E	3	EA.
4155000000	907		DISPOSAL OF SIGN SYSTEM, U-CHANNEL	32	EA.
4192000000	907		DISPOSAL OF SUPPORT, U-CHANNEL	3	EA.

INDEX

SHEET NO.	DESCRIPTION
SIGN - 1	SIGNING PLAN - SUMMARY OF QUANTITIES, ROADWAY STANDARD DRAWINGS, INDEX, & NOTES
SIGN - 2	SIGN DESIGN SHEET
SIGN - 3	"E" AND "F" SHEET
SIGN - 4 - 15	SIGN ROADWAY SHEETS

PLAN PREPARED BY: N.C.D.O.T. SIGNING AND DELINEATION UNIT

R. KING, P.E. STATE SIGNING & DELINEATION ENGINEER
S. JOHNS SIGNING & DELINEATION DESIGN ENGINEER



TIP NO. R-2814A SHEET NO. SIGN-2

APPROVED: _____
DATE: _____

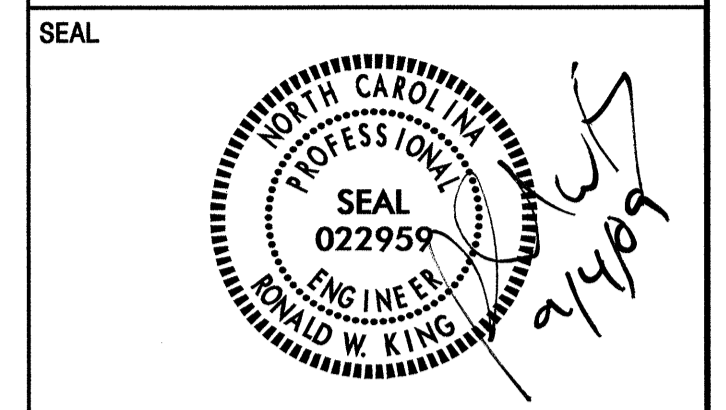

SIGN NUMBER: 301
TYPE: D
QUANTITY: 1
SIGN WIDTH: 2200mm
HEIGHT: 500mm
TOTAL AREA: 1.1 Sq.m

BACKG COLOR: Green
COPY COLOR: White

DESIGN BY: SJ
PROJECT ID: R-2814A
CHECKED BY: DIV: 5
DATE: Aug 11, 2009

SYMBOL	X	Y	WID	HT
ARUP	152	569	200	300
ARUP	1628	131	200	300

BORDER TYPE: FLUSH
RECESS: 0mm
WIDTH: 25mm
RADII: 65mm
NO. Z BARS: _____
LENGTH: _____

MAT'L: 0.125" (3.2 mm) ALUMINUM

USE NOTES: 1,2
1. Legend and border shall be direct applied Grade C sheeting.
2. Background shall be Grade C reflective sheeting.

LETTER POSITIONS

Letter spacings are to start of next letter													Series/Size	
													Text Length	
R	O	L	E	S	V	I	L	L	E				D 2000	
184	166	186	154	144	152	182	80	154	154	124	200	136	184	1832

Spacing Factor is 1 unless specified otherwise

FILENAME: signdesign01-2814A NORTH CAROLINA D.O.T. SIGN DETAIL

SIGN NUMBER: 303
TYPE: D
QUANTITY: 1
SIGN WIDTH: 2300mm
HEIGHT: 900mm
TOTAL AREA: 2.1 Sq.m

BACKG COLOR: Green/Green
COPY COLOR: White

DESIGN BY: SJ
PROJECT ID: R-2814A
CHECKED BY: DIV: 5
DATE: Aug 11, 2009

SYMBOL	X	Y	WID	HT
ARUP	152	569	200	300
ARUP	1628	131	200	300

BORDER TYPE: FLUSH
RECESS: 0mm
WIDTH: 25mm
RADII: 76mm
NO. Z BARS: _____
LENGTH: _____

MAT'L: 0.125" (3.2 mm) ALUMINUM

USE NOTES: 1,2
1. Legend and border shall be direct applied Grade C sheeting.
2. Background shall be Grade C reflective sheeting.

LETTER POSITIONS

Letter spacings are to start of next letter													Series/Size
													Text Length
R	O	L	E	S	V	I	L	L	E				D 2000
652	166	186	154	144	152	182	80	154	154	124	152		1496
R	A	L	E	I	G	H							D 2000
372	152	200	154	158	76	180	136	872					1056

Spacing Factor is 1 unless specified otherwise

SIGN NUMBER: 302
TYPE: D
QUANTITY: 1
SIGN WIDTH: 2500mm
HEIGHT: 900mm
TOTAL AREA: 2.3 Sq.m

BACKG COLOR: Green
COPY COLOR: White

DESIGN BY: SWJ
PROJECT ID: R-2814A
CHECKED BY: DIV: 5
DATE: Aug 13, 2009

SYMBOL	X	Y	WID	HT
ARUP	372	569	200	300
ARUP	1848	131	200	300

BORDER TYPE: FLUSH
RECESS: 0mm
WIDTH: 25mm
RADII: 76mm
NO. Z BARS: _____
LENGTH: _____

MAT'L: 0.125" (3.2 mm) ALUMINUM

USE NOTES: 1,2
1. Legend and border shall be direct applied Grade C sheeting.
2. Background shall be Grade C reflective sheeting.

LETTER POSITIONS

Letter spacings are to start of next letter													Series/Size	
													Text Length	
R	A	L	E	I	G	H							D 2000	
148	147	191	145	148	63	167	136	1356					997	
1	1												D 2000	
2221	81	50	148										131	
F	A	Y	E	T	T	E	V	I	L	L	E		D 2000	
148	132	178	193	135	132	145	135	173	66	145	145	124	648	1704
6	9													D 2000
2052	164	136	148											300

Spacing Factor is 1 unless specified otherwise

SIGN NUMBER: 304
TYPE: D
QUANTITY: 1
SIGN WIDTH: 2300mm
HEIGHT: 900mm
TOTAL AREA: 2.1 Sq.m

BACKG COLOR: Green/Green
COPY COLOR: White

DESIGN BY: SJ
PROJECT ID: R-2814A
CHECKED BY: DIV: 5
DATE: Aug 11, 2009

SYMBOL	X	Y	WID	HT
ARUP	372	569	200	300
ARUP	1848	131	200	300

BORDER TYPE: FLUSH
RECESS: 0mm
WIDTH: 25mm
RADII: 76mm
NO. Z BARS: _____
LENGTH: _____

MAT'L: 0.125" (3.2 mm) ALUMINUM

USE NOTES: 1,2
1. Legend and border shall be direct applied Grade C sheeting.
2. Background shall be Grade C reflective sheeting.

LETTER POSITIONS

Letter spacings are to start of next letter													Series/Size
													Text Length
R	A	L	E	I	G	H							D 2000
872	152	200	154	158	76	180	136	372					1056
R	O	L	E	S	V	I	L	L	E				D 2000
152	166	186	154	144	152	182	80	154	154	124	652		1496

Spacing Factor is 1 unless specified otherwise

SIGN DESIGNS

04-SEP-2009 08:36
n:\projects\sign\cadd\sign_designs\signdesign01-2814A.dgn
sjohns AT TECC221644



TIP NO. R-2814A	SHEET NO. SIGN-3
APPROVED: _____	
DATE: _____	
SEAL	

401 QUANTITY REQ'D 6

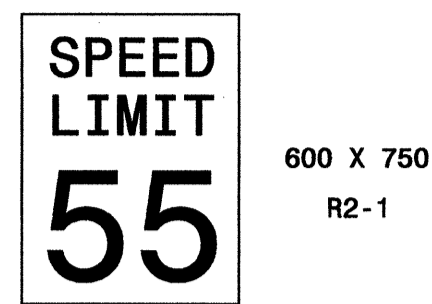

600 X 750
R2-1

ONE "U" POST PER SIGN

414 QUANTITY REQ'D 11



1350 X 450
R6-1 (L)

TWO "U" POSTS PER SIGN

462 QUANTITY REQ'D 3

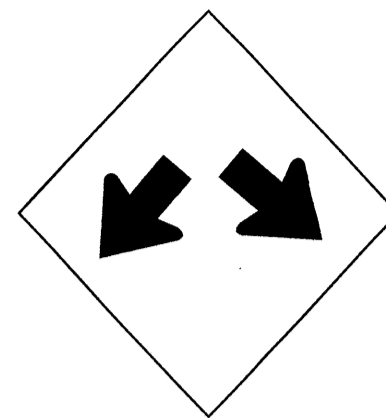

900 X 900
W12-1

ONE "U" POST PER SIGN

501
504
509
510



600 X 300
750 X 600

ONE "U" POST PER SIGN

408 QUANTITY REQ'D 10

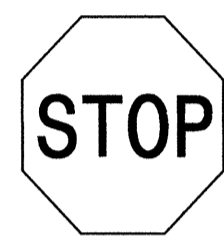

750 X 750
R1-1

ONE "U" POST PER SIGN

416 QUANTITY REQ'D 16

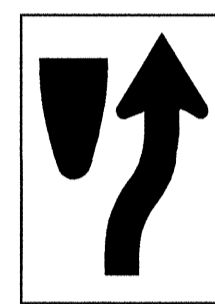

600 X 750
R4-7

ONE "U" POST PER SIGN

468 QUANTITY REQ'D 3

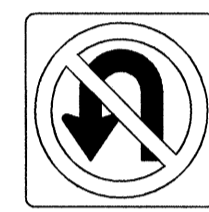

600 X 600
R3-4

ONE "U" POST PER SIGN

502
503
506



600 X 300
750 X 600

ONE "U" POST PER SIGN

410 QUANTITY REQ'D 22

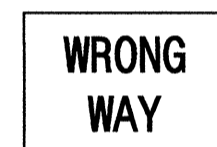

900 X 600
R5-1a

ONE "U" POST PER SIGN

417 QUANTITY REQ'D 16

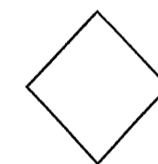

450 X 450
W23-15

MOUNT BELOW SIGN 416...
IN 14 INSTALLATIONS

469 QUANTITY REQ'D 3



600 X 450

MOUNT BELOW SIGN 468
IN 3 INSTALLATIONS

505

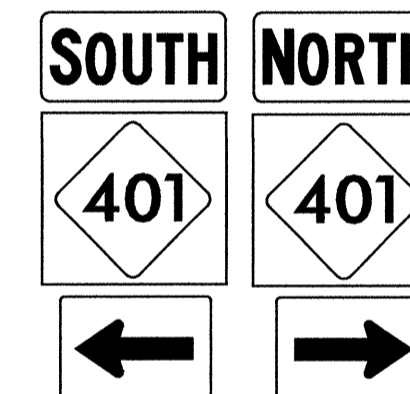

2 - 600 X 300
2 - 750 X 600
2 - 530 X 380

TWO "U" POSTS PER SIGN

411 QUANTITY REQ'D 14



750 X 750
R5-1

ONE "U" POST PER SIGN

455 QUANTITY REQ'D 4

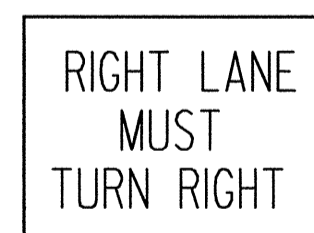

750 X 750
R3-7

ONE "U" POST PER SIGN

460 QUANTITY REQ'D 1

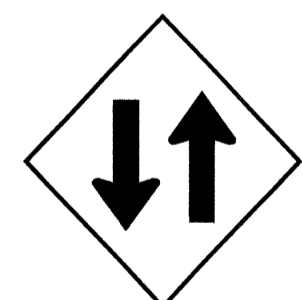

900 X 900
W6-3

ONE "U" POST PER SIGN

507
511

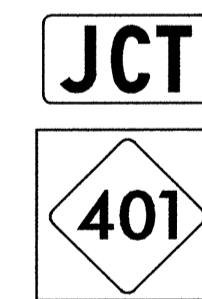

600 X 300
750 X 600

ONE "U" POST PER SIGN

413 QUANTITY REQ'D 15



1350 X 450
R6-1 (R)

TWO "U" POSTS PER SIGN

458 QUANTITY REQ'D 2



750 X 750
W14-2

ONE "U" POST PER SIGN

508

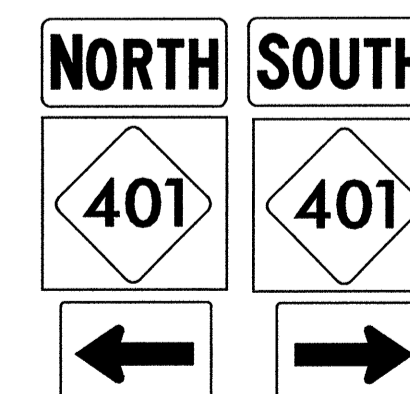

2 - 600 X 300
2 - 750 X 600
2 - 530 X 380

TWO "U" POSTS PER SIGN

NOTE: THIS DRAWING IS DIMENSIONED
IN MILIMETERS UNLESS OTHERWISE
DEPICTED WITHIN THE DRAWING.

TYPE "E" & "F" SIGNS



TIP NO. R-2814A	SHEET NO. SIGN-4
APPROVED: _____	
DATE: _____	
SEAL	



BEGIN STATE SIGNING PROJECT
R-2814A - STA. 9+60.00 -L-

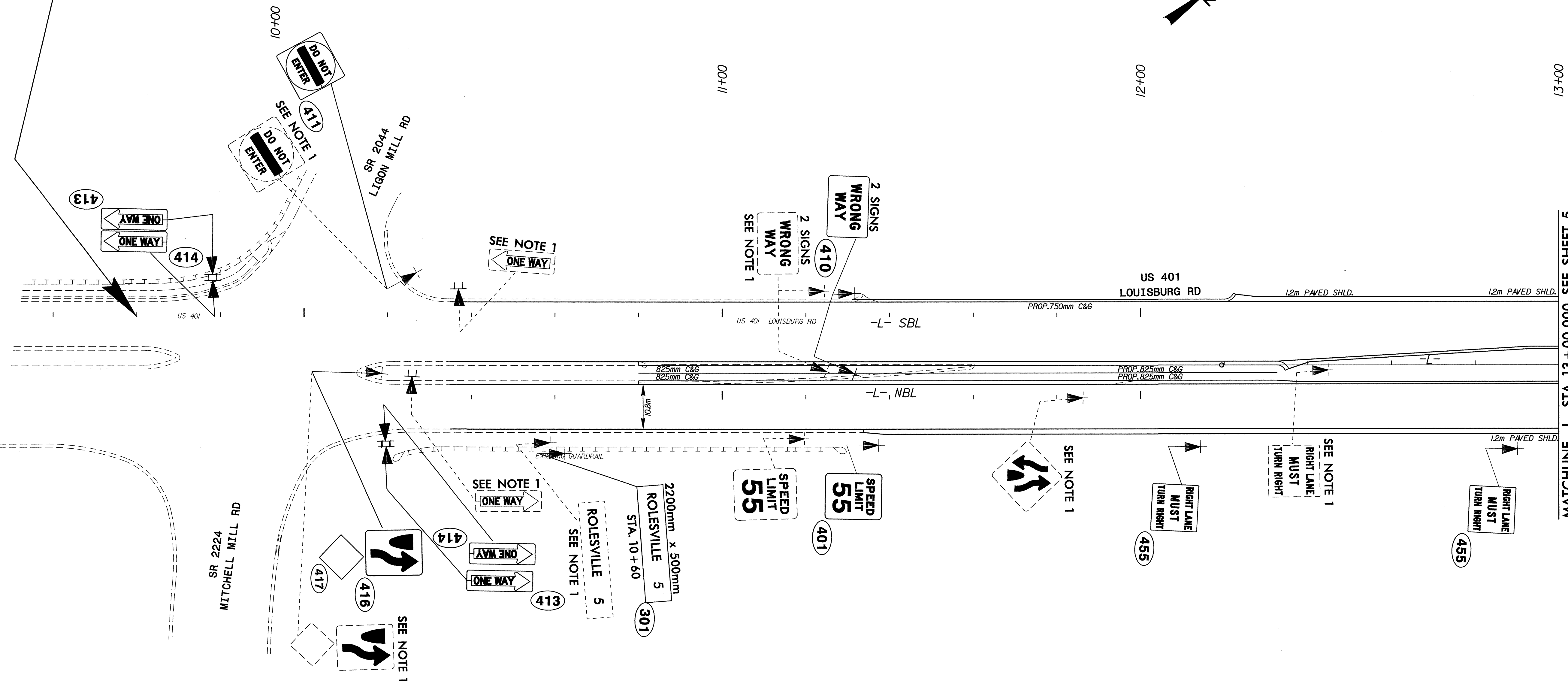

MATCHLINE -L- STA. 13+00.000 SEE SHEET 5

PAY ITEM NOTES	
1	DISPOSAL OF SIGN SYSTEM, U-CHANNEL

PROPOSED & EXISTING SIGNS
STA. 9+60 TO STA. 13+00
US 401-L- (LOUISBURG RD)

04-SEP-2009 08:37
n:\projects\2814a\traffic\signing\code\signing\Layout\Plans\Signing\R-2814as04.psh
s\signing - H:\TECC221642



TIP NO. R-2814A	SHEET NO. SIGN-5
--------------------	---------------------

APPROVED: _____
DATE: _____

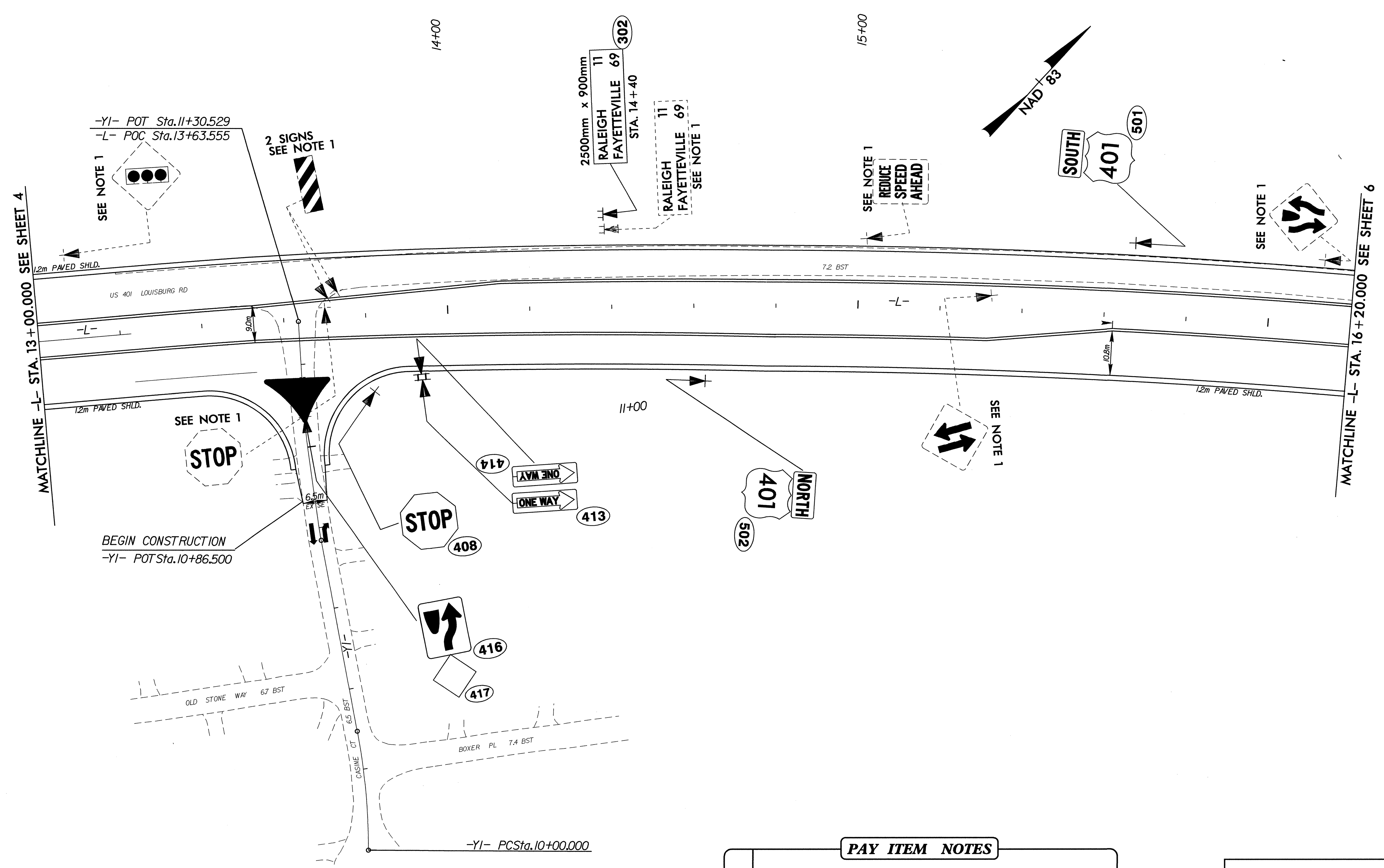
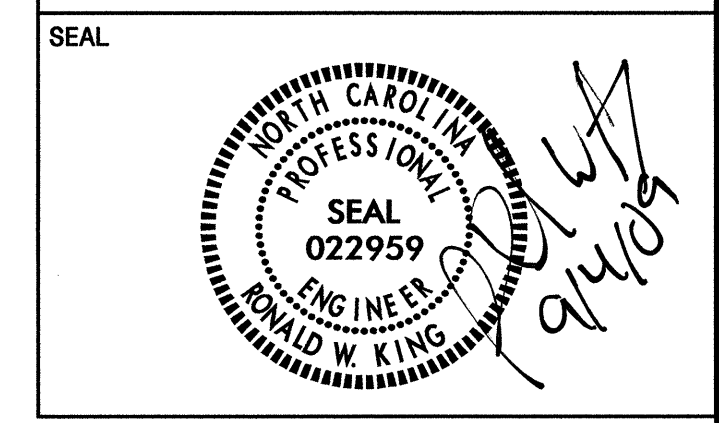

PAY ITEM NOTES	
1	DISPOSAL OF SIGN SYSTEM, U-CHANNEL

**PROPOSED & EXISTING SIGNS
STA. 13+00 TO STA. 16+20
US 401-L- (LOUISBURG RD)**

04-SEP-2009 08:39
 C:\Users\m\Documents\Projects\2814A\Signing\Layout\Plan\Signing\2814A\05\psh
 11:10:28 AM
 11:10:28 AM



TIP NO.	SHEET NO.
R-2814A	SIGN-6

APPROVED: _____
 DATE: _____

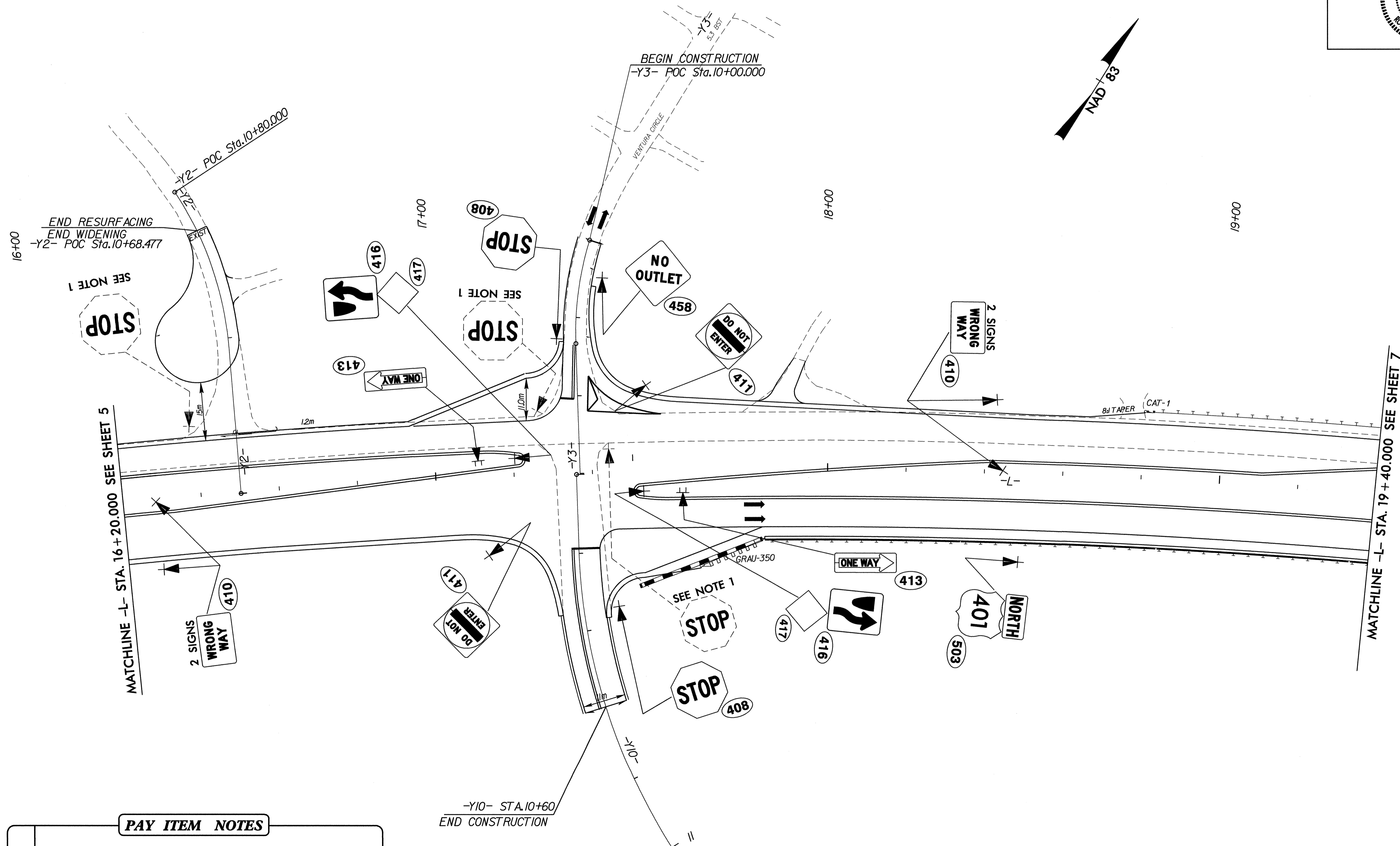
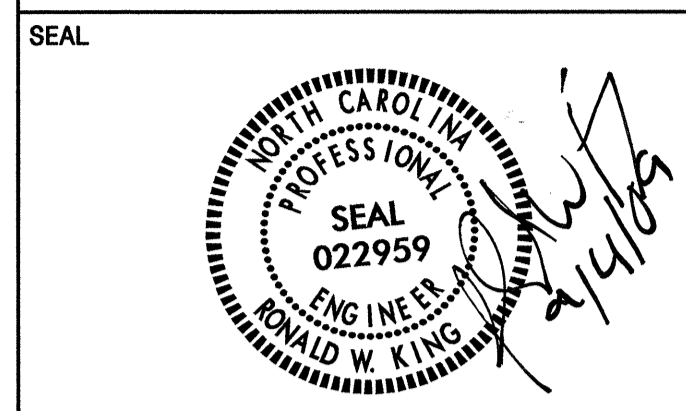

PAY ITEM NOTES

- 1 DISPOSAL OF SIGN SYSTEM, U-CHANNEL

**PROPOSED & EXISTING SIGNS
 STA. 16+20 TO STA. 19+40
 US 401-L- (LOUISBURG RD)**

04-SEP-2009 08:39
 n:\sfp\c\04\2814a\signing\layout\plans\signing\2814a\06.psh
 Jobname: 2814A_SIGNING_LAYOUT

04-SEP-2009 08:55 C:\2814\Traffic\signing\cadd\signing\Layout\Plans\Signing\vr2814as07.psh
3: John King - 817-765-2164

MATCHLINE -L- STA. 19 + 40.000 SEE SHEET 6

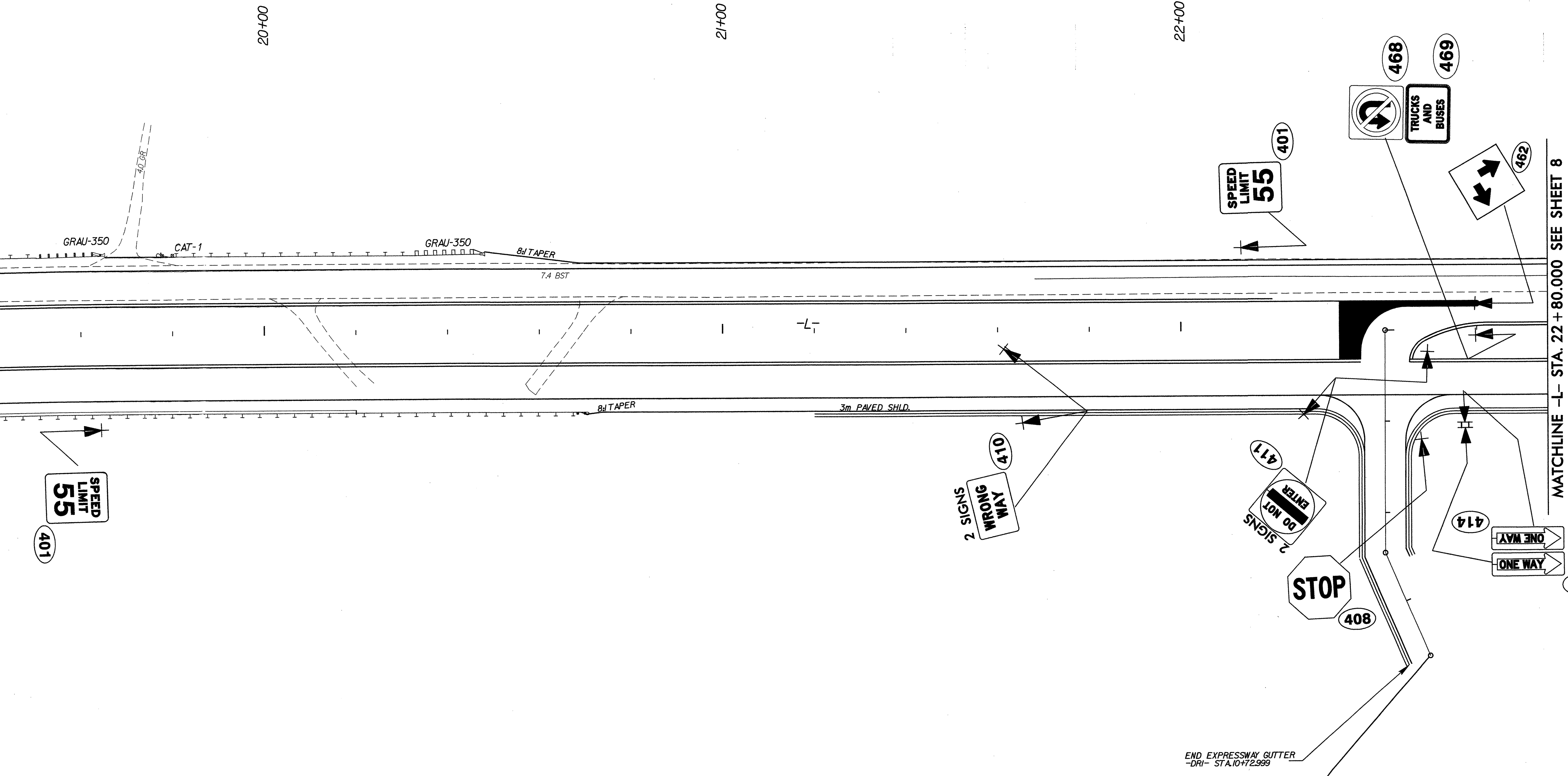

END CONSTRUCTION
-DRI- POT Sta. 10+72.999

END EXPRESSWAY GUTTER
-DRI- STA. 10+72.999

PROPOSED & EXISTING SIGNS
STA. 19+40 TO STA. 22+80
US 401-L- (LOUISBURG RD)



TIP NO. R-2814A	SHEET NO. SIGN-7
APPROVED: _____	
DATE: _____	
SEAL	

13-OCT-2009 16:46
C:\Users\peter\Documents\28144\Signing\CADD\Signing_Layout_Plans\Signing\28144a05.psh
Drawing At EC28144

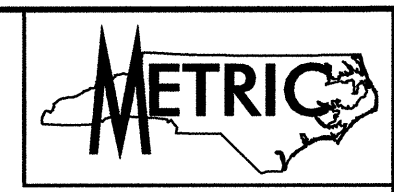

TIP NO. R-2814A	SHEET NO. SIGN-8
APPROVED: _____	
DATE: _____	
SEAL	

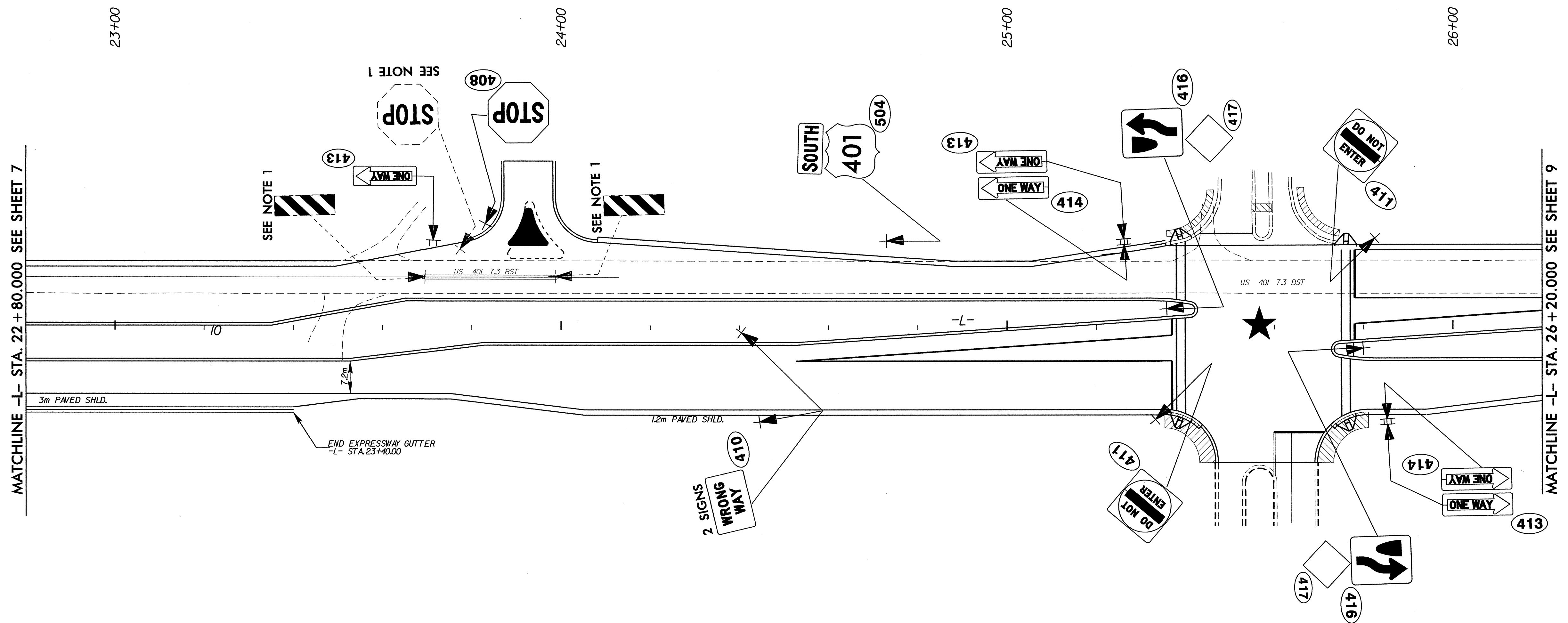

PAY ITEM NOTES	
1	DISPOSAL OF SIGN SYSTEM, U-CHANNEL

**PROPOSED & EXISTING SIGNS
STA. 22+80 TO STA. 26+20
US 401-L- (LOUISBURG RD)**



TIP NO. R-2814A	SHEET NO. SIGN-9
--------------------	---------------------

APPROVED: _____

DATE: _____

SEAL

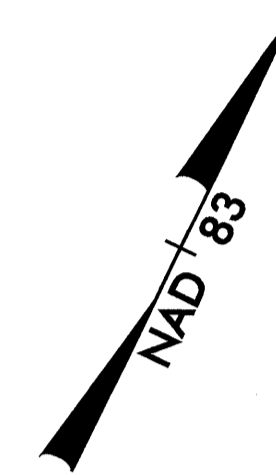

MATCHLINE -L- STA. 26 + 20.000 SEE SHEET 8

REVISIONS

2 SIGNS
WRONG
WAY
410

27+00

28+00

29+00

SPEED
LIMIT
55
401

ONE WAY

413

MATCHLINE -L- STA. 29 + 40.000 SEE SHEET 10

PROPOSED & EXISTING SIGNS
STA. 28+20 TO STA. 29+40
US 401-L- (LOUISBURG RD)



TIP NO. R-2814A	SHEET NO. SIGN-10
--------------------	----------------------

APPROVED: _____
DATE: _____

SEAL

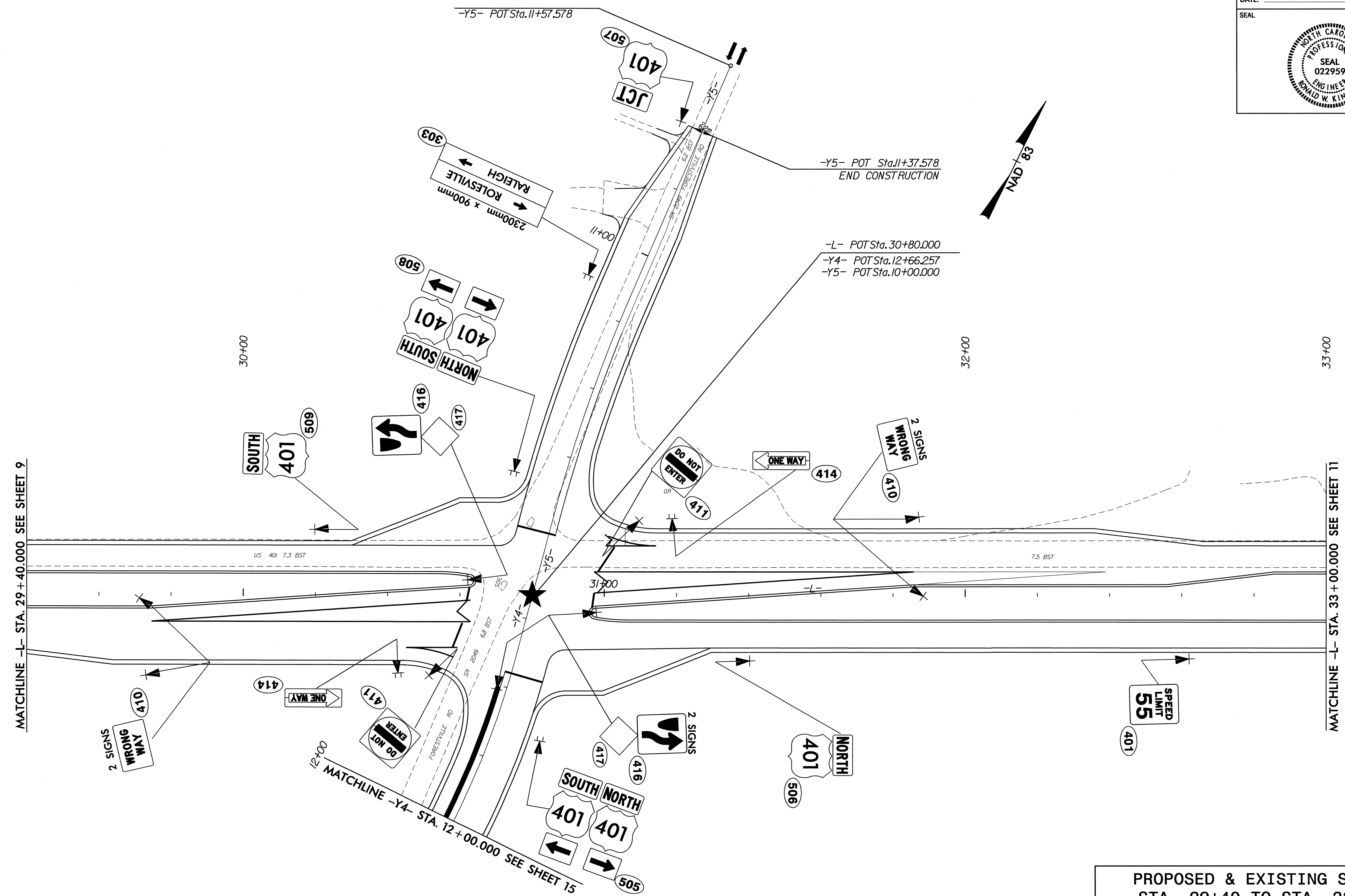
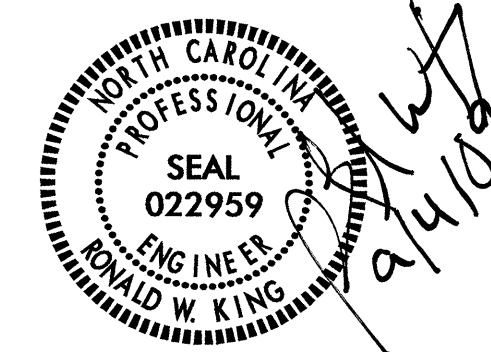

MATCHLINE -L- STA. 29+40.000 SEE SHEET 9

MATCHLINE -L- STA. 33+00.000 SEE SHEET 11

MATCHLINE -Y4- STA. 12+00.000 SEE SHEET 15

-Y5- POT Sta. 11+57.578
-Y5- POT Sta. 11+37.578
END CONSTRUCTION
-L- POT Sta. 30+80.000
-Y4- POT Sta. 12+66.257
-Y5- POT Sta. 10+00.000

PROPOSED & EXISTING SIGNS
STA. 29+40 TO STA. 33+00
US 401-L- (LOUISBURG RD)

04-SEP-2009 08:42
c:\piper\projects\2814a\trf\fr\signing\ceod\signing\Layout\Plans\Signing\2814a\10.dwg
John A. King



TIP NO. R-2814A	SHEET NO. SIGN-11
--------------------	----------------------

APPROVED: _____

DATE: _____

SEAL

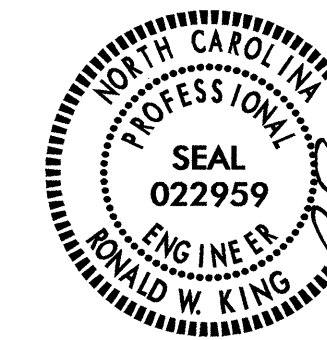

RW King
9/4/09

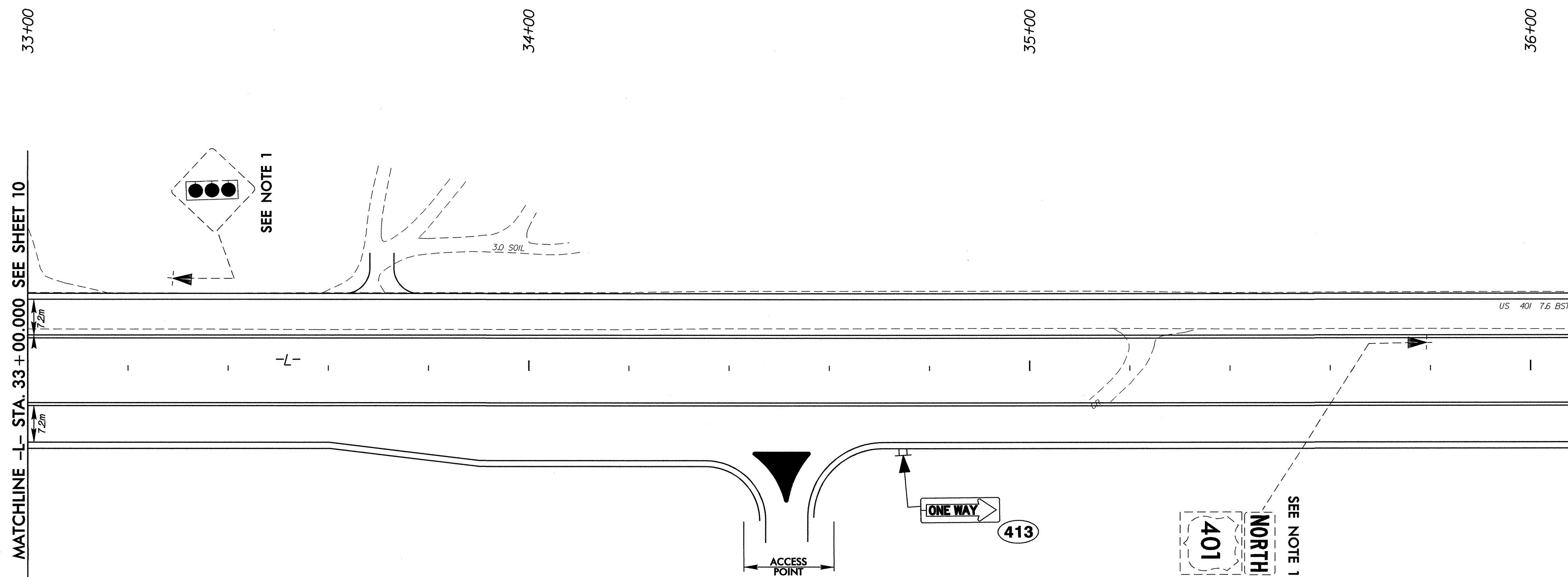
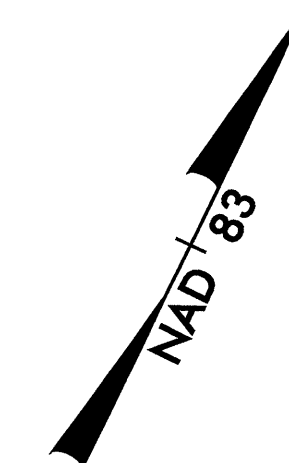

PAY ITEM NOTES

- | | |
|---|------------------------------------|
| 1 | DISPOSAL OF SIGN SYSTEM, U-CHANNEL |
|---|------------------------------------|

**PROPOSED & EXISTING SIGNS
STA. 33+00 TO STA. 36+40
US 401-L- (LOUISBURG RD)**

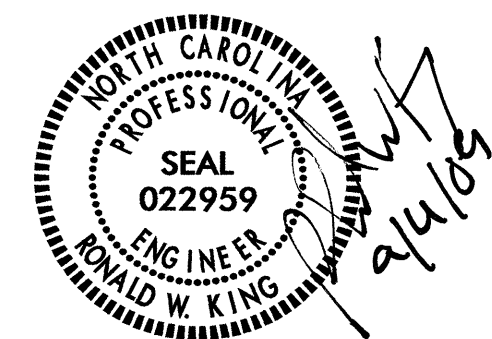

TIP NO. R-2814A	SHEET NO. SIGN-12
APPROVED: _____	
DATE: _____	
SEAL	
	

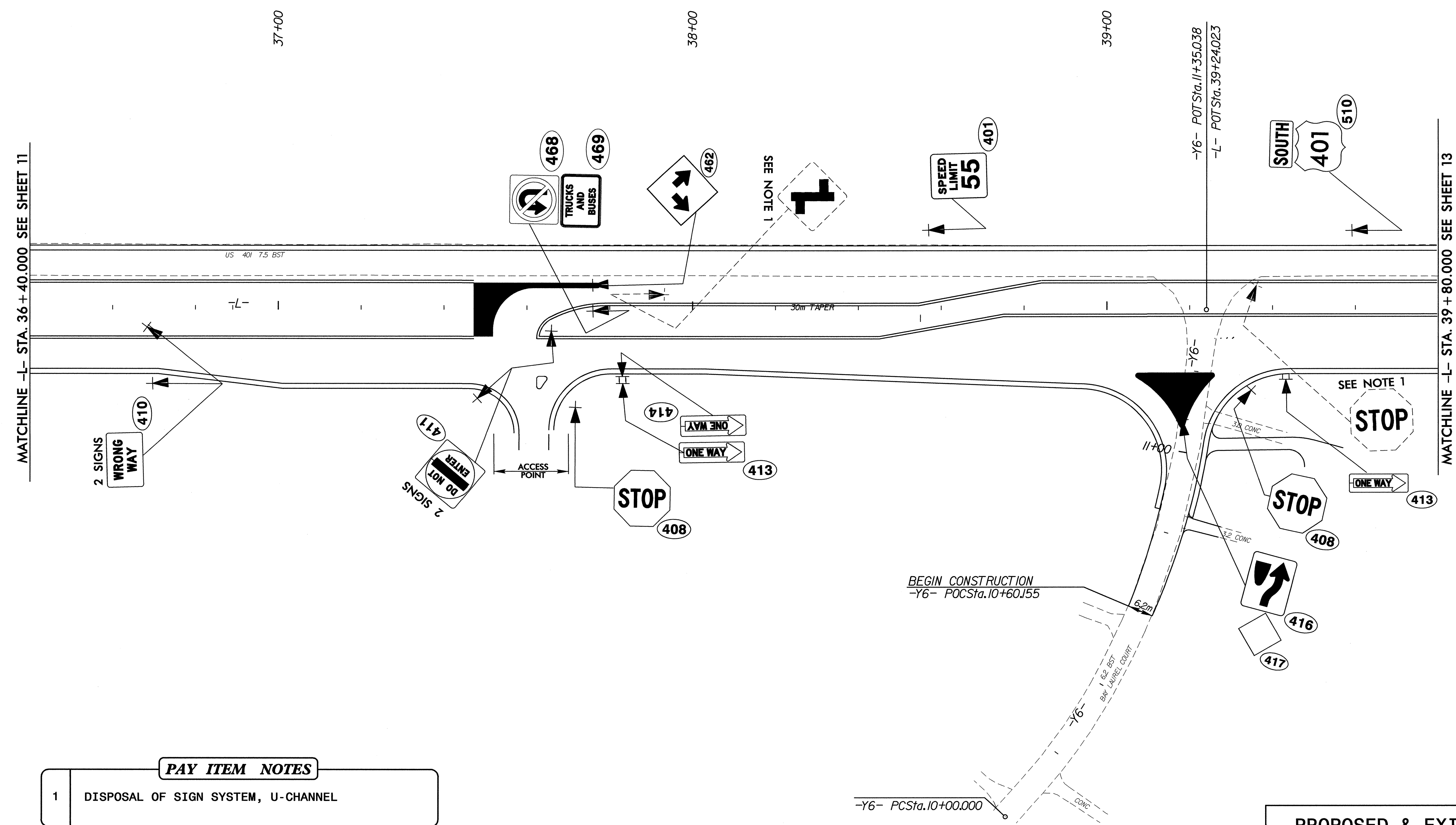

PAY ITEM NOTES	
1	DISPOSAL OF SIGN SYSTEM, U-CHANNEL

PROPOSED & EXISTING SIGNS
 STA. 36+40 TO STA. 39+80
 US 401-L- (LOUISBURG RD)

04-SEP-2009 08:53
 n:\projects\09082812\tr-ef\ca\signing\layout\Plans\Signing_V-2814esi2.psh
 Johns AT 10/22/09



TIP NO. R-2814A	SHEET NO. SIGN-13
--------------------	----------------------

APPROVED: _____
DATE: _____

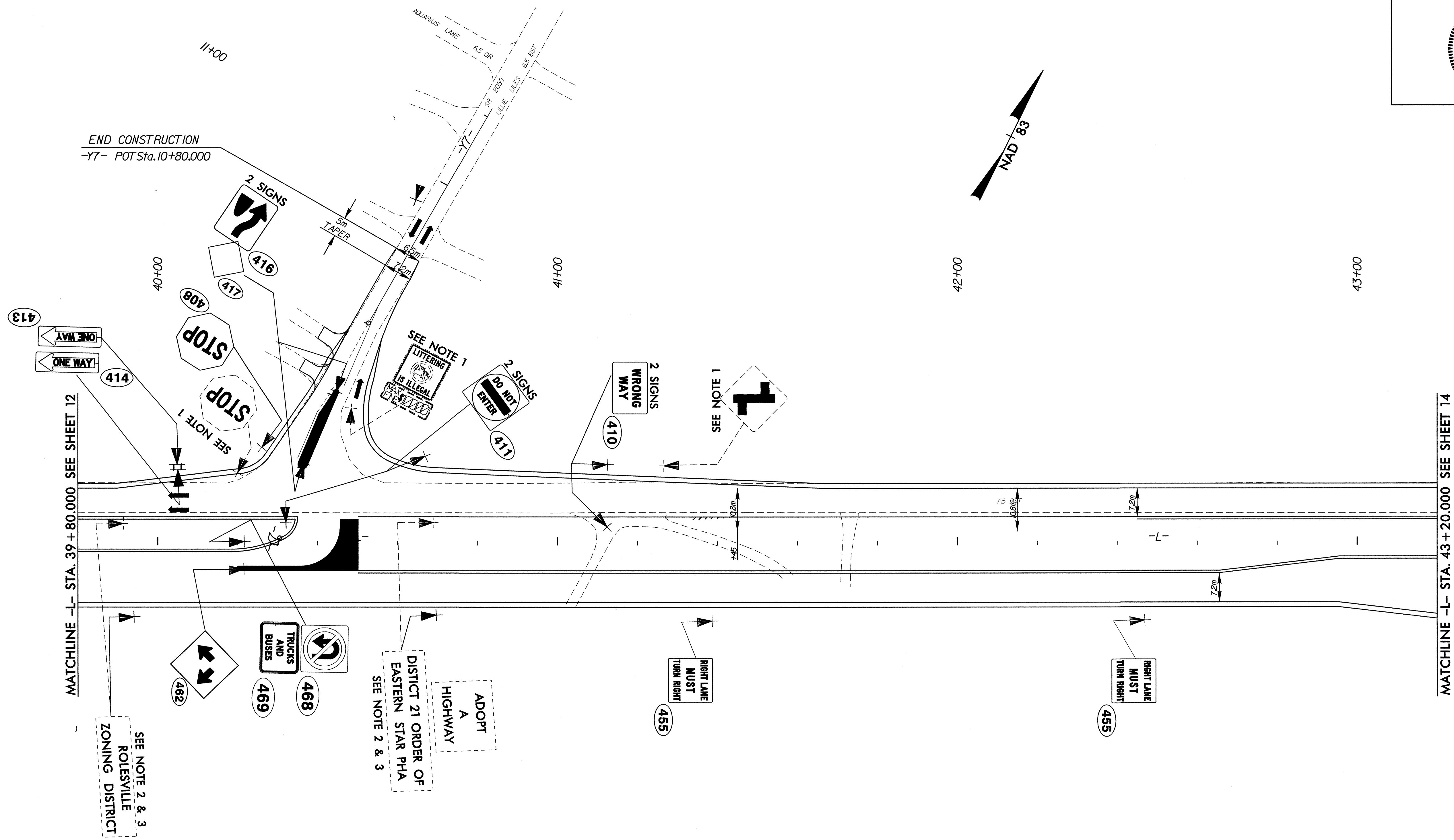
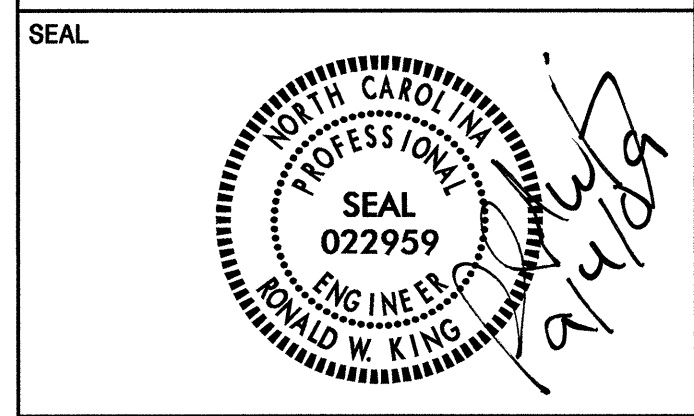

PAY ITEM NOTES	
1	DISPOSAL OF SIGN SYSTEM, U-CHANNEL
1	SIGN ERECTION, RELOCATE SIGN TYPE E
1	DISPOSAL OF SUPPORT, U-CHANNEL

**PROPOSED & EXISTING SIGNS
STA. 39+80 TO STA. 43+20
US 401-L- (LOUISBURG RD)**

04-SEP-2009 08:44
 n:\sppr\c\p\2814a\signing\cead\signing\Layout\Plans\Signing\cead\2814a13.psh
 Jobname: 2814a13



TIP NO. R-2814A	SHEET NO. SIGN-14
--------------------	----------------------

APPROVED: _____
DATE: _____

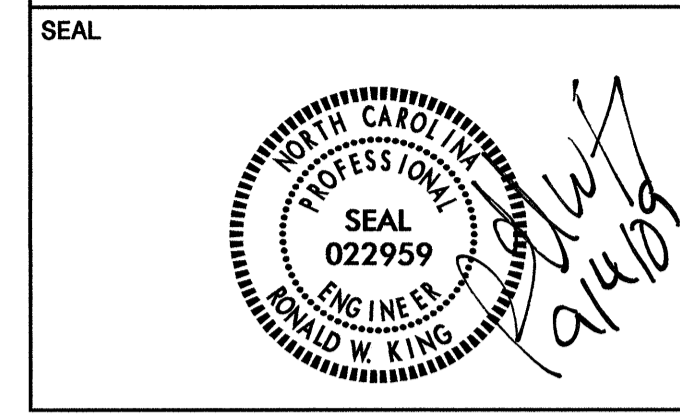

MATCHLINE -L- STA. 43+20.000 SEE SHEET 13

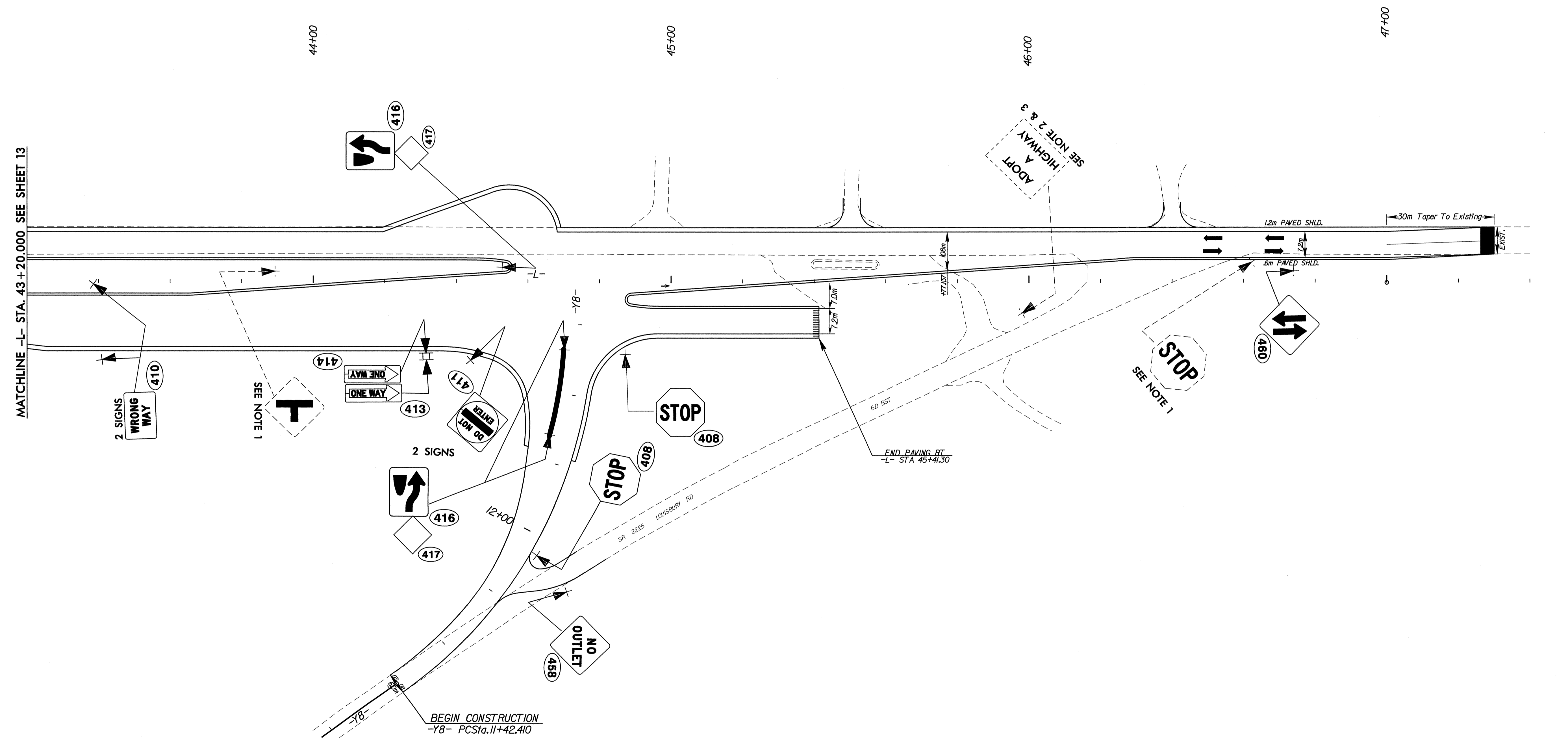

PAY ITEM NOTES	
1	DISPOSAL OF SIGN SYSTEM, U-CHANNEL
1	SIGN ERECTION, RELOCATE SIGN TYPE E
1	DISPOSAL OF SUPPORT, U-CHANNEL

**PROPOSED & EXISTING SIGNS
STA. 43+20 TO STA. 46+60
US 401-L- (LOUISBURG RD)**

04-SEP-2009 08:44
 n:\piper\085111\14\tr\office\signing\cead\signing\Layout\Plena\Signing\281\ast14.psh
 plena AT 10:22:28.42



TIP NO. R-2814A	SHEET NO. SIGN-15
--------------------	----------------------

APPROVED: _____
DATE: _____

SEAL

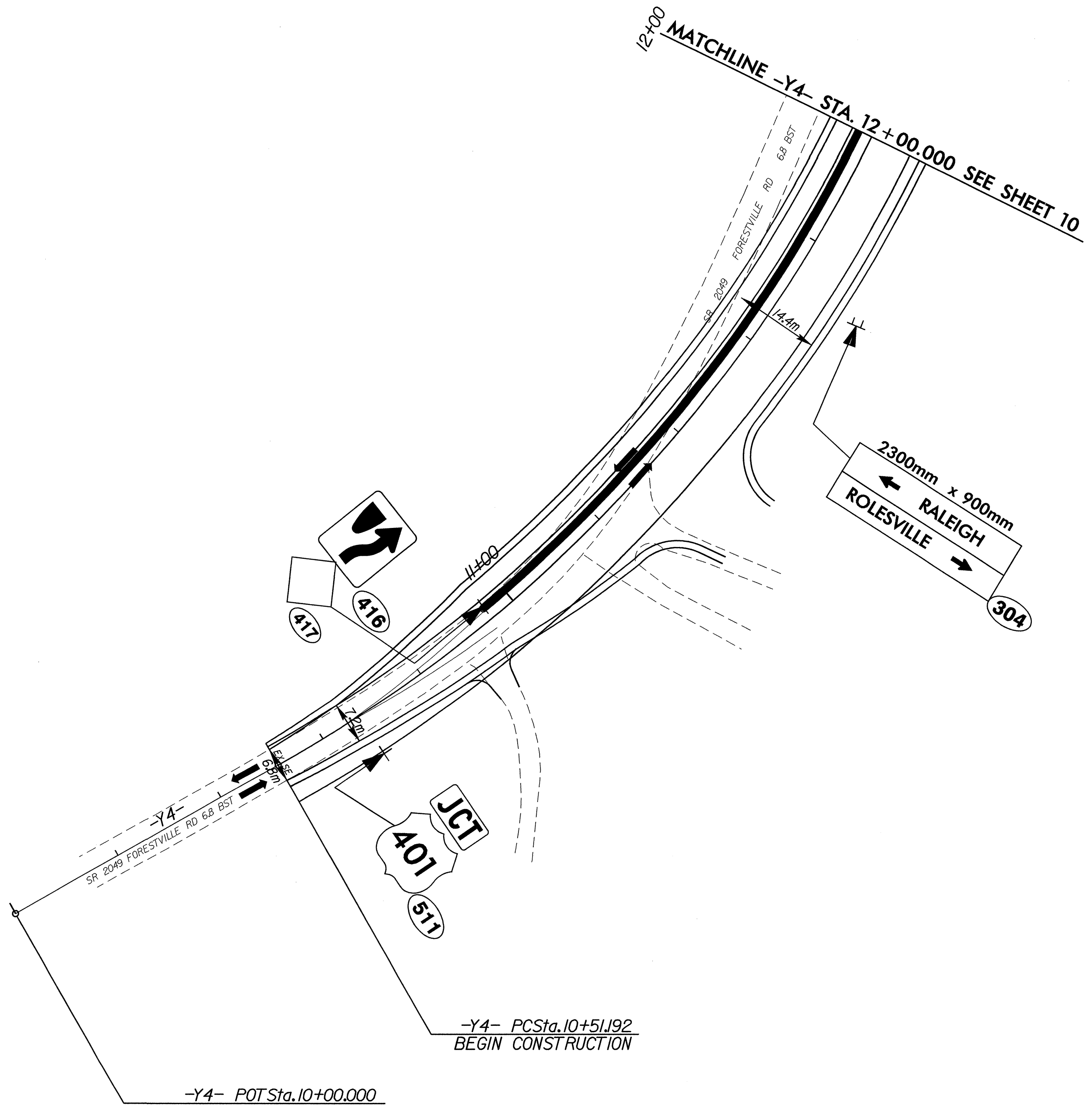
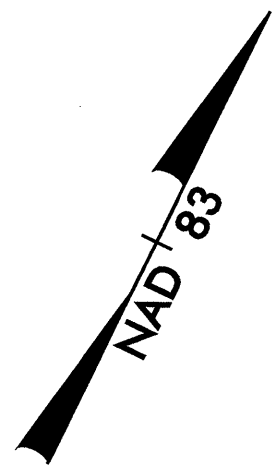

04-SEP-2009 08:45
 n:\projects\09\0912\tr\eff\signing\cadd\signing_layout\plane\signing_vr2814as16.psh
 10:22:18

PROPOSED & EXISTING SIGNS
STA. 10+00 TO STA. 12+00
Sr 2049 -Y4- (FORESTVILLE RD)