

STATE	STATE PROJECT REFERENCE NO.	SHEET NO.	TOTAL SHEETS
N.C.	41797	UC-1	
STATE PROJ. NO.	F. A. PROJ. NO.	DESCRIPTION	
41797		PE, CONST.	

STATE OF NORTH CAROLINA
 DIVISION OF HIGHWAYS
WAKE COUNTY

**LOCATION: EXTENSION OF SR 1774 (DISTRICT DR) TO SR 1775 (REEDY CREEK RD)
 FOR ACCESS TO STOC/NCNG**

TYPE OF WORK: SANITARY SEWER RELOCATION

See Sheet 1-A For Index of Sheets
 See Sheet 1-B For Conventional Symbols

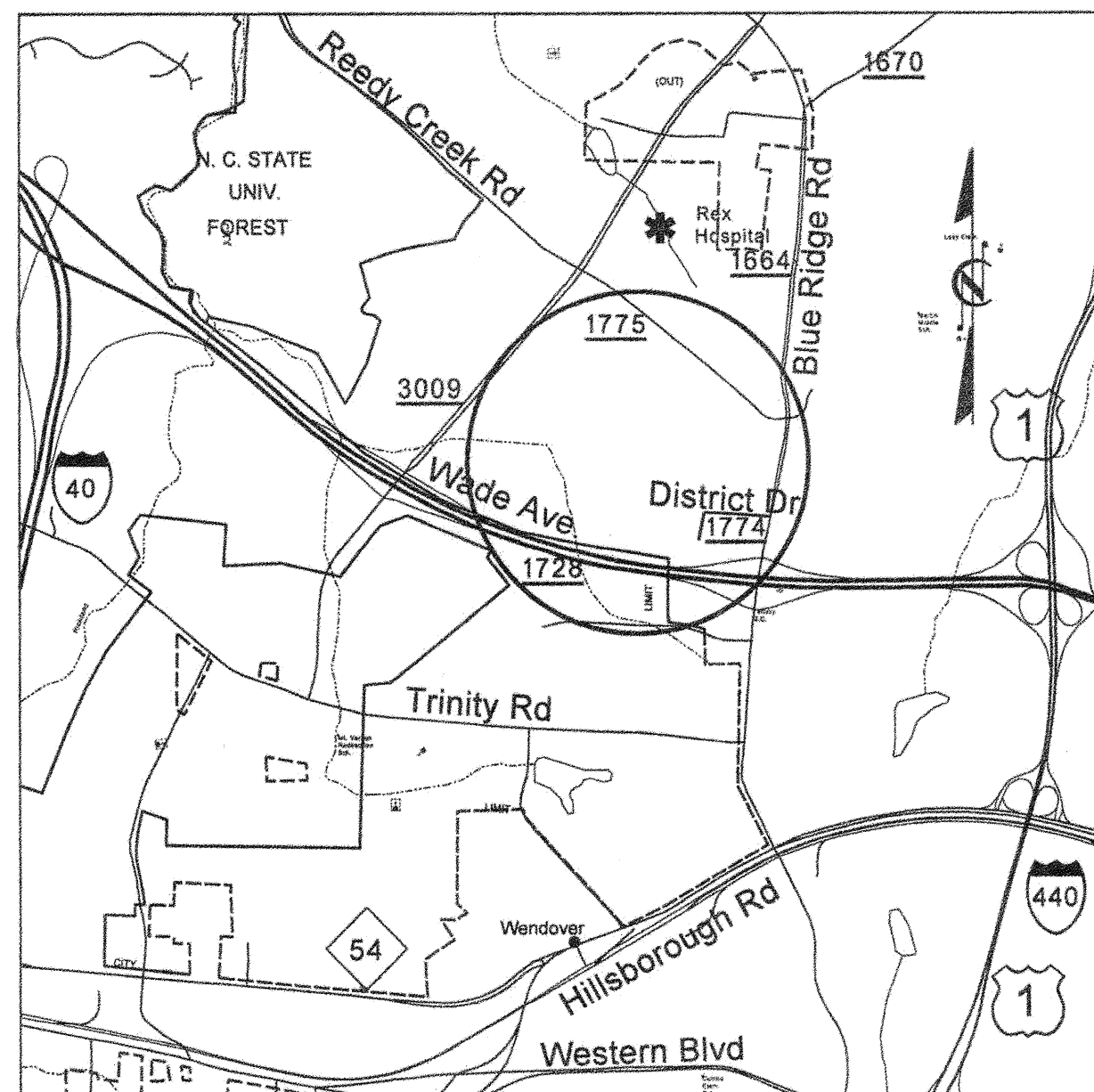

**VICINITY MAP SHOWING
 LOCATION OF PROJECT 41797**

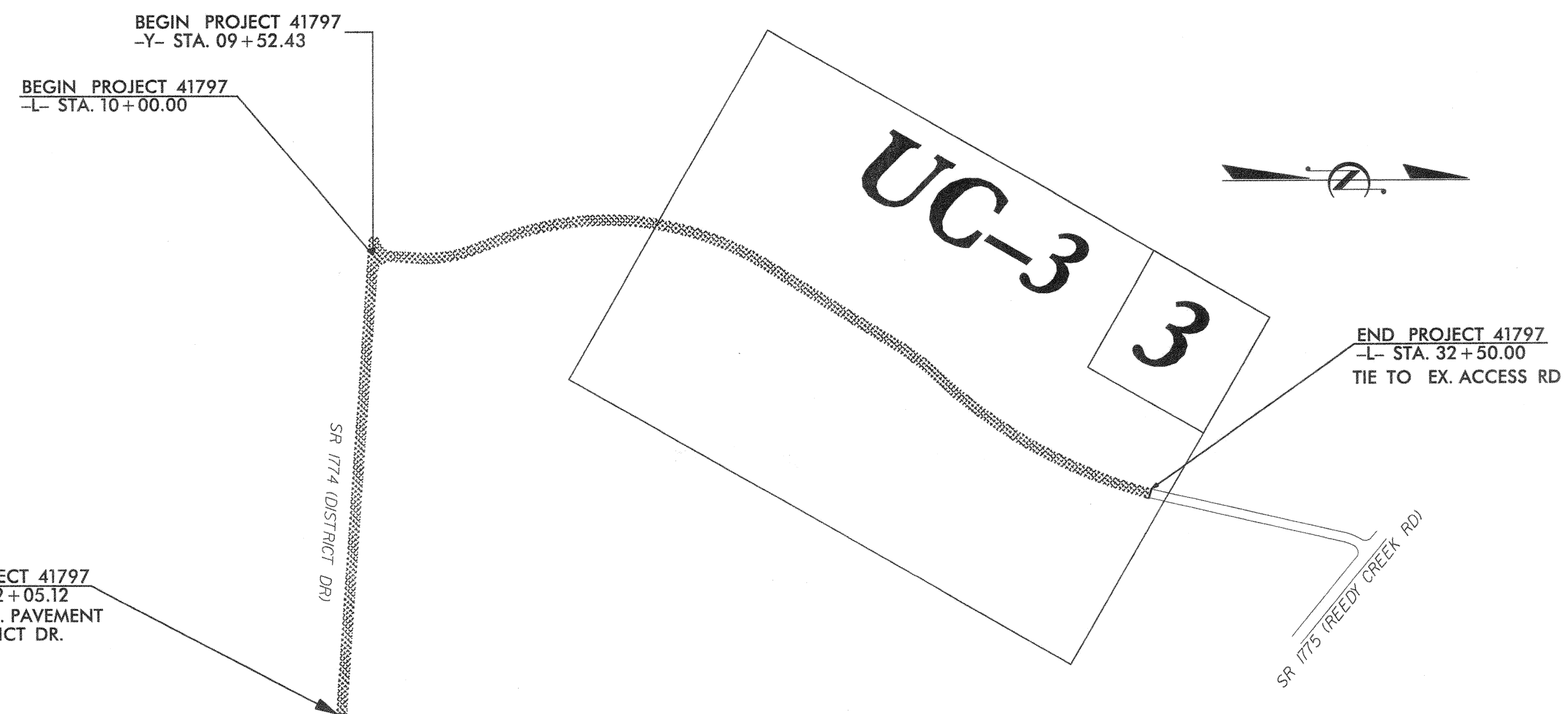

PROJECT: 41797

PROJECT: 41797

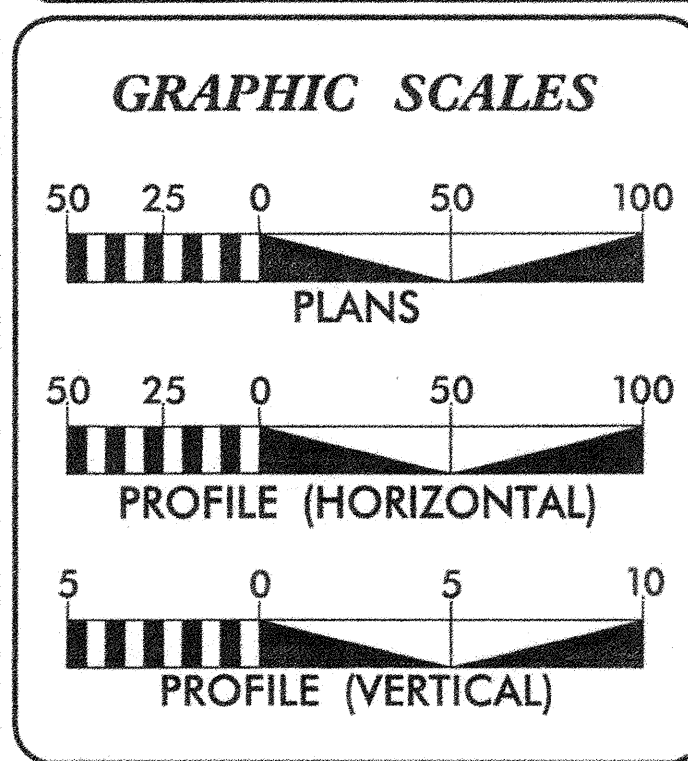

DESIGN DATA

ADT 2008 =	3500
ADT 2028 =	7000
D =	3 %
T =	2 %
V =	35 MPH

PROJECT LENGTH

Length Roadway Project 41797 = 0.663 Miles

PLANS PREPARED BY :

RK&K

RUMMEL, KLEPPER & KAHL, LLP
 900 RIDGEFIELD DRIVE, SUITE 350
 RALEIGH, NORTH CAROLINA 27609
 NC LICENSE NO. F-0112

FOR
DIVISION OF HIGHWAYS

UTILITY DESIGN ENGINEER

SIGNATURE: *Howard T. Woodall, III* P.E.
 8/21/09

**DIVISION OF HIGHWAYS
 STATE OF NORTH CAROLINA**

**FIFTH DIVISION
 J. WALLY BOWMAN, P.E.
 DIVISION ENGINEER**

08/27/09 11:26:56
 I:\Utilities\Projects\41797\Reedy_Creek_w.t.tsh.dgn
 ktk:bjh

UTILITY ENGINEER
 NORTH CAROLINA PROFESSIONAL SEAL 25881
 HOWARD T. WOODALL III
 8/27/09

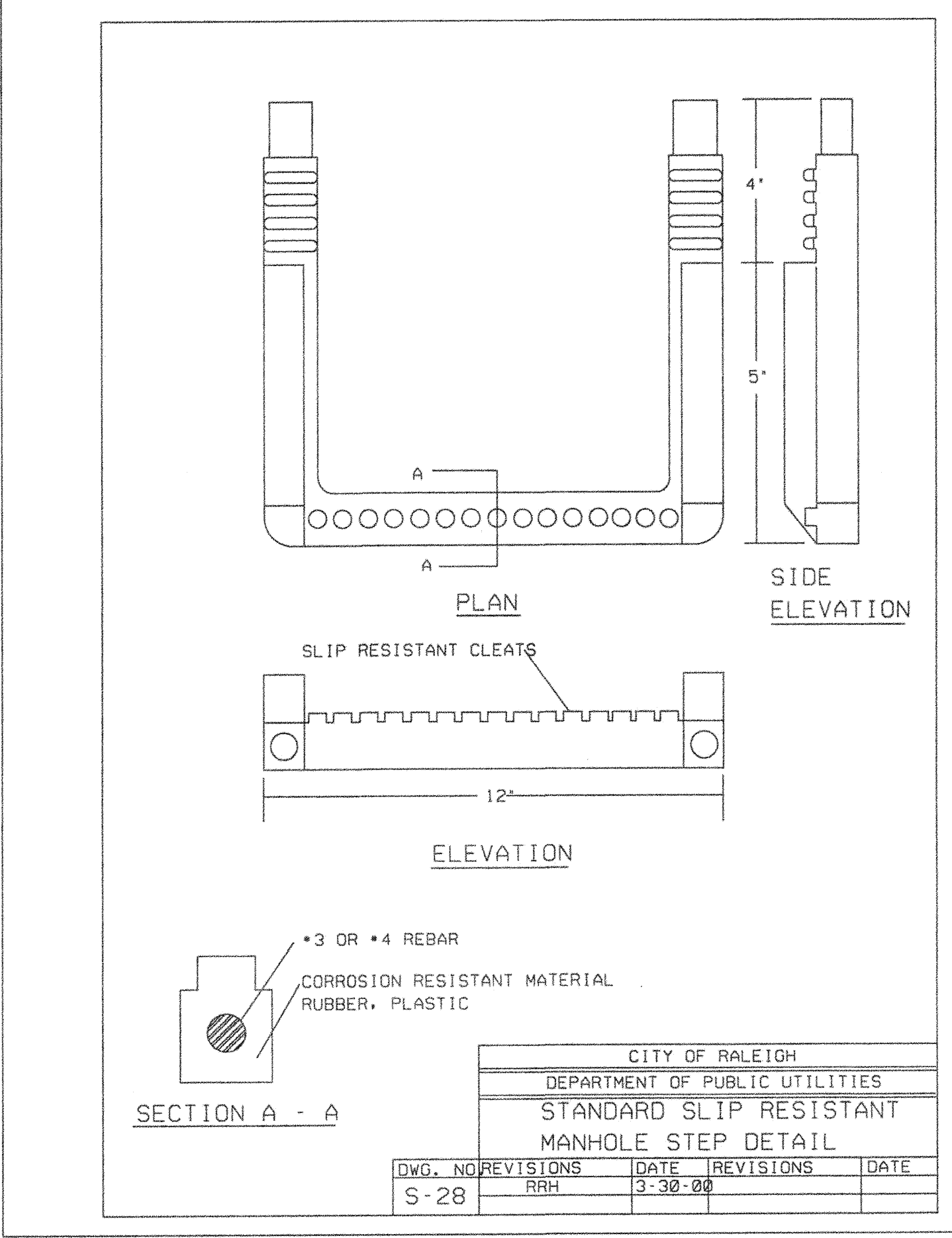
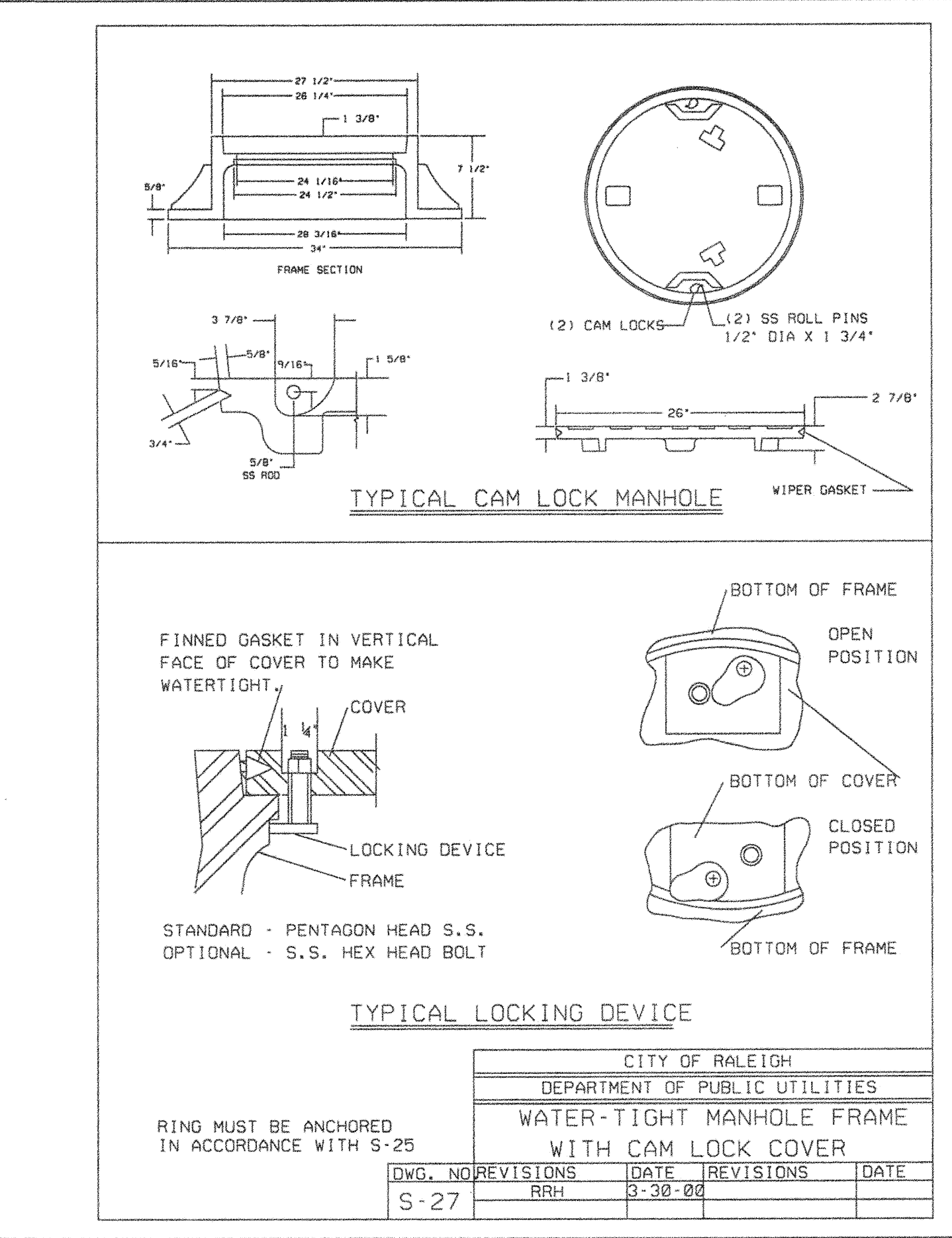
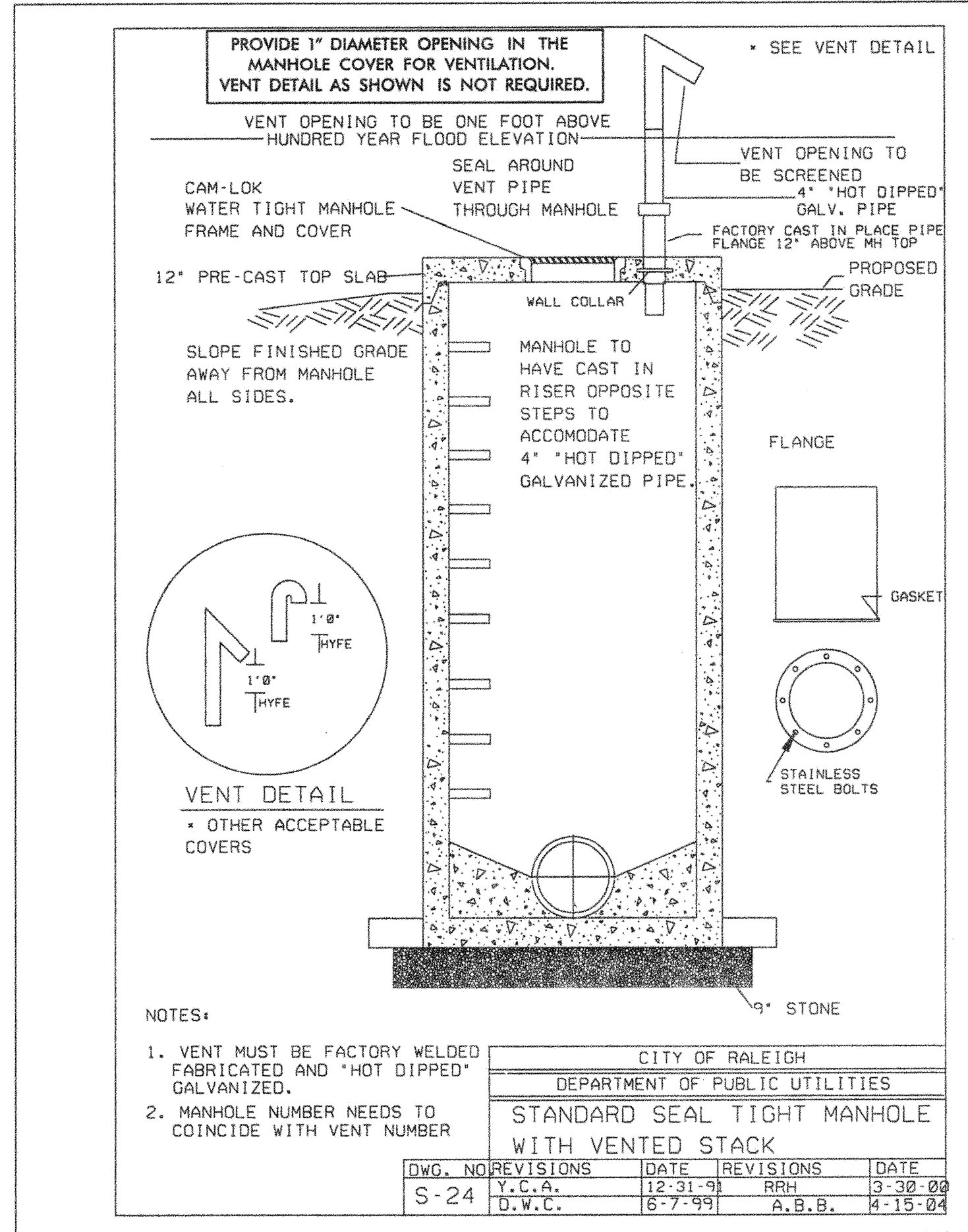
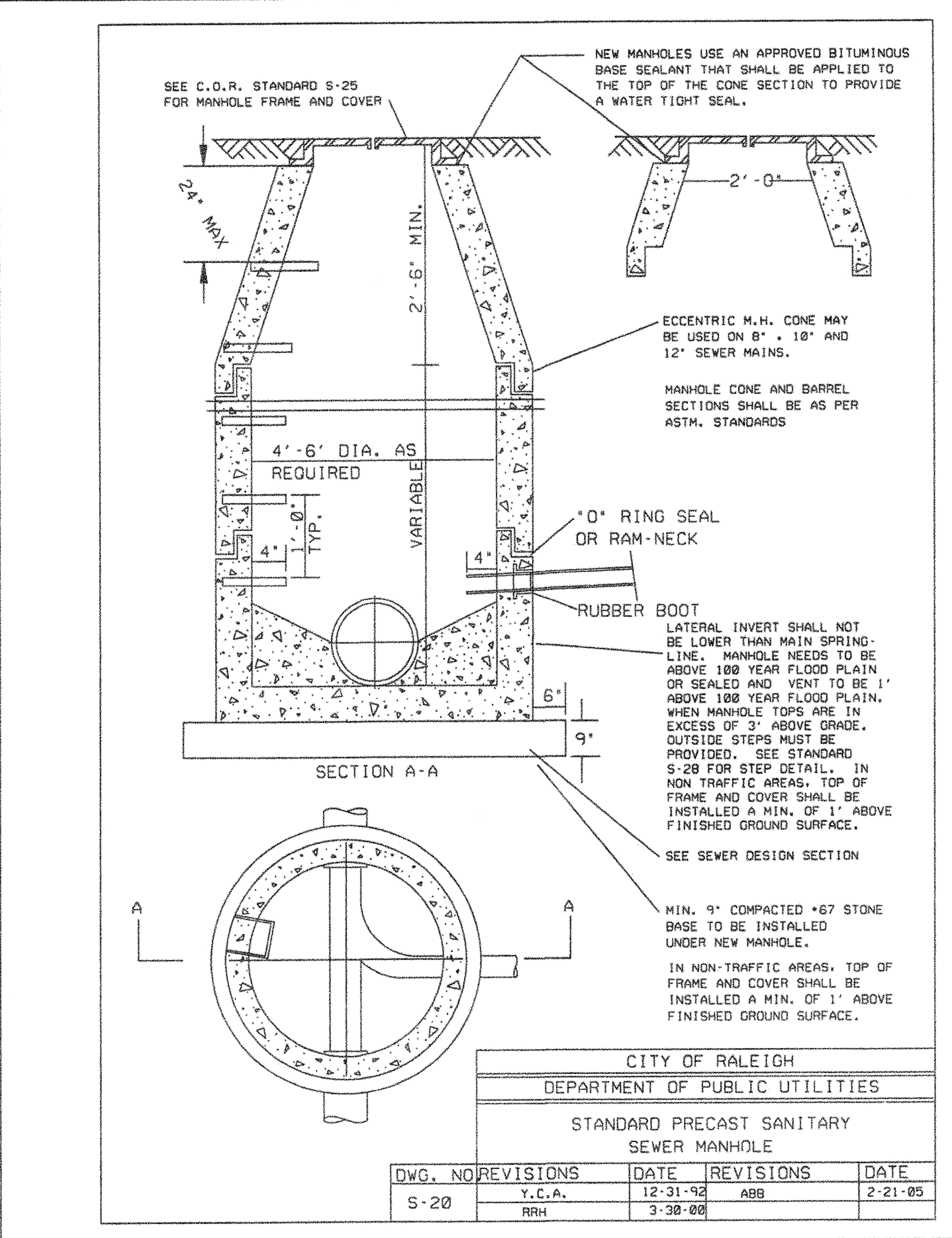
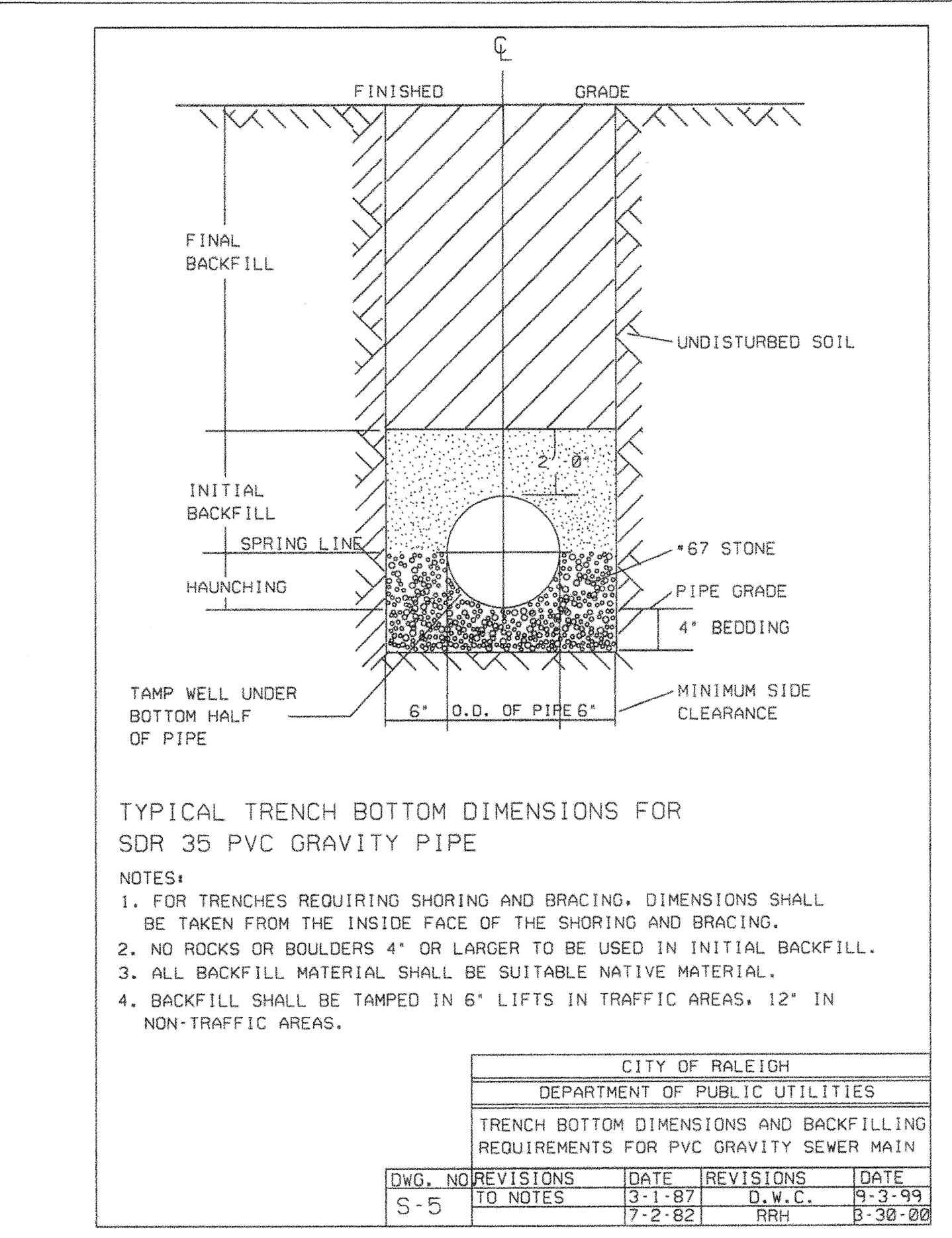
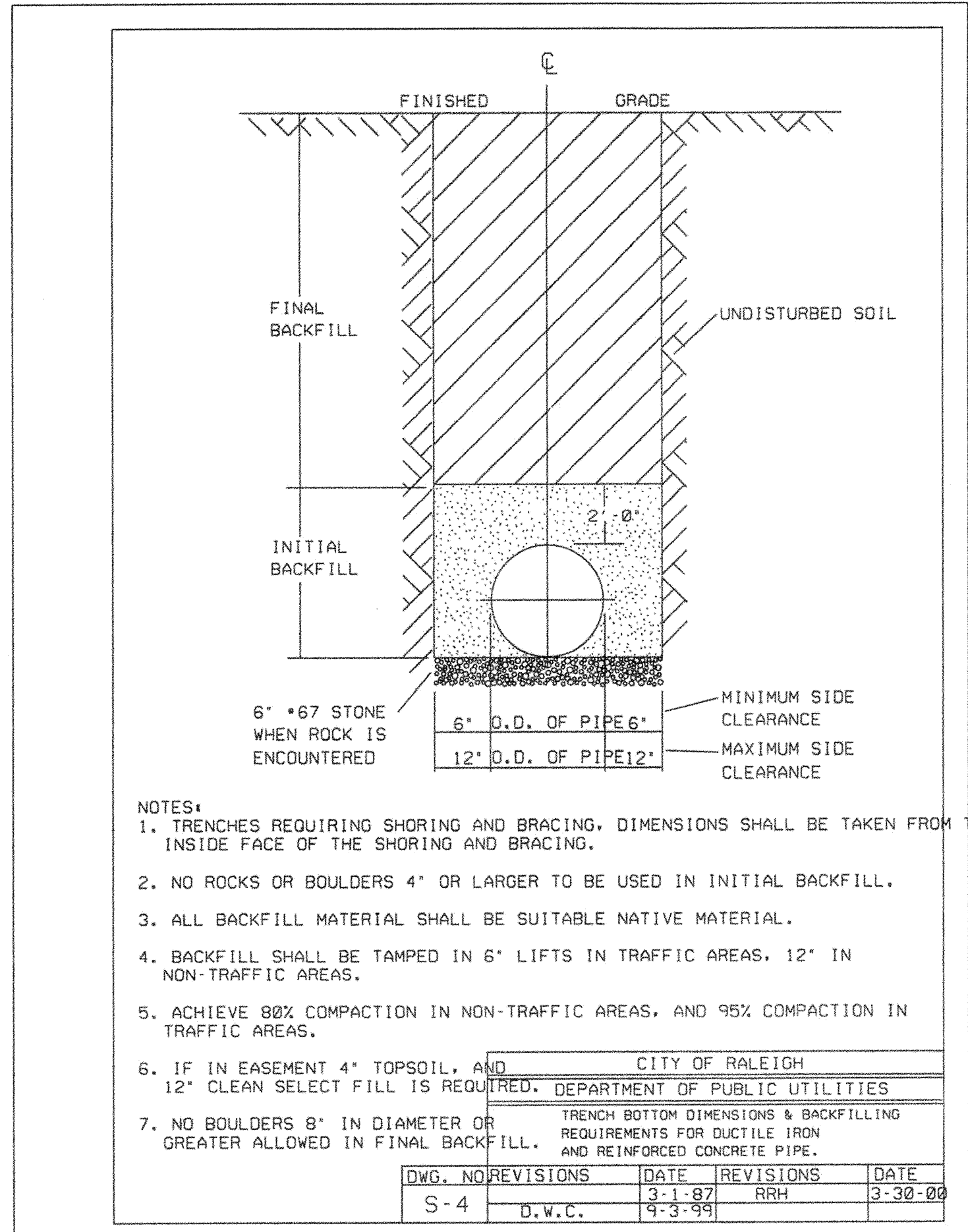

8/17/99
 REVISIONS
 08/27/09 08:53:32
 C:\Users\Wdj\Documents\Projects\ready_creek_util_tup.dwg
 Kitching

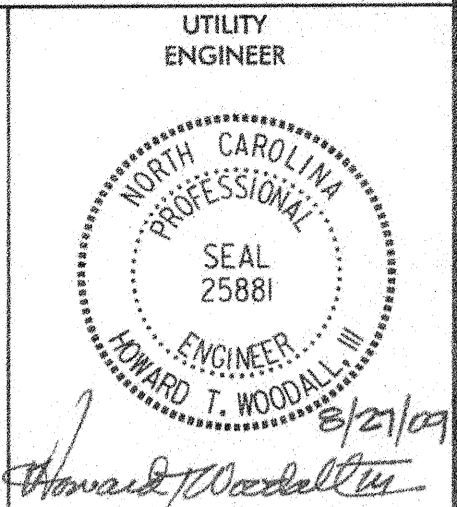

EXISTING SSMH
RIM = 388.84'
INV. IN = 378.22'
INV. OUT = 378.04'

PROPOSED MH #1
STA. 23+74.28 OFFSET = 47.7'
4" DIAMETER - FLAT TOP
DEPTH = 7.57'
ANGLE OF DEFLECTION = 3' 47" 12"

INSTALL FLAT TOP MANHOLE IN ACCORDANCE WITH CITY OF RALEIGH STD. DETAIL S-24. VENT STACK IS NOT REQUIRED.

PROP. 250' - REMOVE 12" TC SAN. SEWER
PROP. 250' - 12" SAN. GRAVITY SEWER
REPLACE EXISTING 12" TC SAN. SEWER WITH 12" D.J.P. MATCH LINE & GRADE

PROP. 135.2' - 12" SAN. GRAVITY SEWER

PROP. 100' - ABANDON EXIST. 12" TC SAN. SEWER PIPE

PROP. 1' - ABANDON EXIST. SAN. SEWER MANHOLE

PROP. 37' - ABANDON EXIST. 12" TC SAN. SEWER PIPE

PROPOSED MH #2
STA. 24+64.30 OFFSET = 53.24'
4" DIAMETER - FLAT TOP
DEPTH = 9.09'
ANGLE OF DEFLECTION = 12' 58" 16"

INSTALL FLAT TOP MANHOLE IN ACCORDANCE WITH CITY OF RALEIGH STD. DETAIL S-24. VENT STACK IS NOT REQUIRED.

PROP. 169' - REMOVE 12" TC SAN. SEWER
PROP. 169' - 12" SAN. GRAVITY SEWER
REPLACE EXISTING 12" TC SAN. SEWER WITH 12" D.J.P. MATCH LINE & GRADE

EXISTING SSMH
RIM = 397.73'
INV. IN = 386.61'
INV. OUT = 386.42'

CITY OF RALEIGH OWNS & MAINTAINS THE EXISTING SANITARY SEWER.

NOTES:

1. A BYPASS PLAN SEALED BY A NC PROFESSIONAL ENGINEER MUST BE SUBMITTED TO PUBLIC UTILITIES PRIOR TO PUMPING OPERATIONS TO COORDINATE WITH ADMINISTRATION ENGINEERING STAFF. PUMPS SHOULD BE SIZED TO HANDLE THE PEAK DAILY FLOW (2.5 TIMES THE AVERAGE DAILY FLOW) FOR THE LINE OR AREA OF WORK. THE CONTRACTOR SHALL SECURE PUMPS FROM A PUMP SUPPLIER ACCORDING TO THE PROVIDED FLOW INFORMATION. PUMPING OPERATIONS MUST BE MONITORED 24 HOURS A DAY FOR EACH DAY OF THE PUMPING OPERATION BY A QUALIFIED PERSONNEL IN ORDER TO RESPOND TO PROBLEMS OR FAILURES. 100% REDUNDANCY IS REQUIRED FOR PUMPING OPERATIONS. IN ADDITION, BACK UP PUMPS ARE TO BE CONNECTED TO THE BYPASS FORCE MAIN TO FACILITATE IMMEDIATE USE UPON FAILURE OF THE PRIMARY PUMPS.

2. ALL CONSTRUCTION SHALL BE IN ACCORDANCE WITH CITY OF RALEIGH STANDARDS AND SPECIFICATIONS AND/OR NCDOT STANDARDS AND SPECIFICATIONS (LATEST EDITIONS).

ATTENTION CONTRACTORS

The **Construction Contractor** responsible for the extension of water, sewer, and/or reuse, as approved in these plans, is responsible for **contacting the Public Works Department at (919) 996-6810** and the **Public Utilities Department at (919) 857-4540** at least **twenty four hours** prior to beginning any of their construction.

Failure to notify both **City Departments** in advance of beginning construction, will result in the issuance of **monetary fines**, and require reinstallation of any water or sewer facilities not inspected as a result of this notification failure.

Failure to call for **inspection, install a Downstream Plug, have Permitted Plans** on the **Jobsite**, or any other **Violation of City of Raleigh Standards** will result in a **Fine and Possible Exclusion** from future work in the **City of Raleigh**.

Public Sewer Collection / Extension System

The City of Raleigh consents to the connection and extension of the City's public sewer system as shown on this plan. The material and construction methods used for this project shall conform to the standards and specifications of the City's Public Utilities Handbook.

City of Raleigh
Public Utilities Department Permit # _____
Authorization to Construct _____
Date _____

386' (100 YEAR FLOODPLAIN)
PER CULVERT SURVEY & HYDRAULIC DESIGN REPORT PREPARED BY BRIAN S. LIPSCOMB, PE AND DATED 03/06/08

EXISTING 12" TC, S = 0.49%
TO BE REPLACED WITH D.J.P.

EXISTING 12" TC, S = 2.15%
TO BE REPLACED WITH D.J.P.

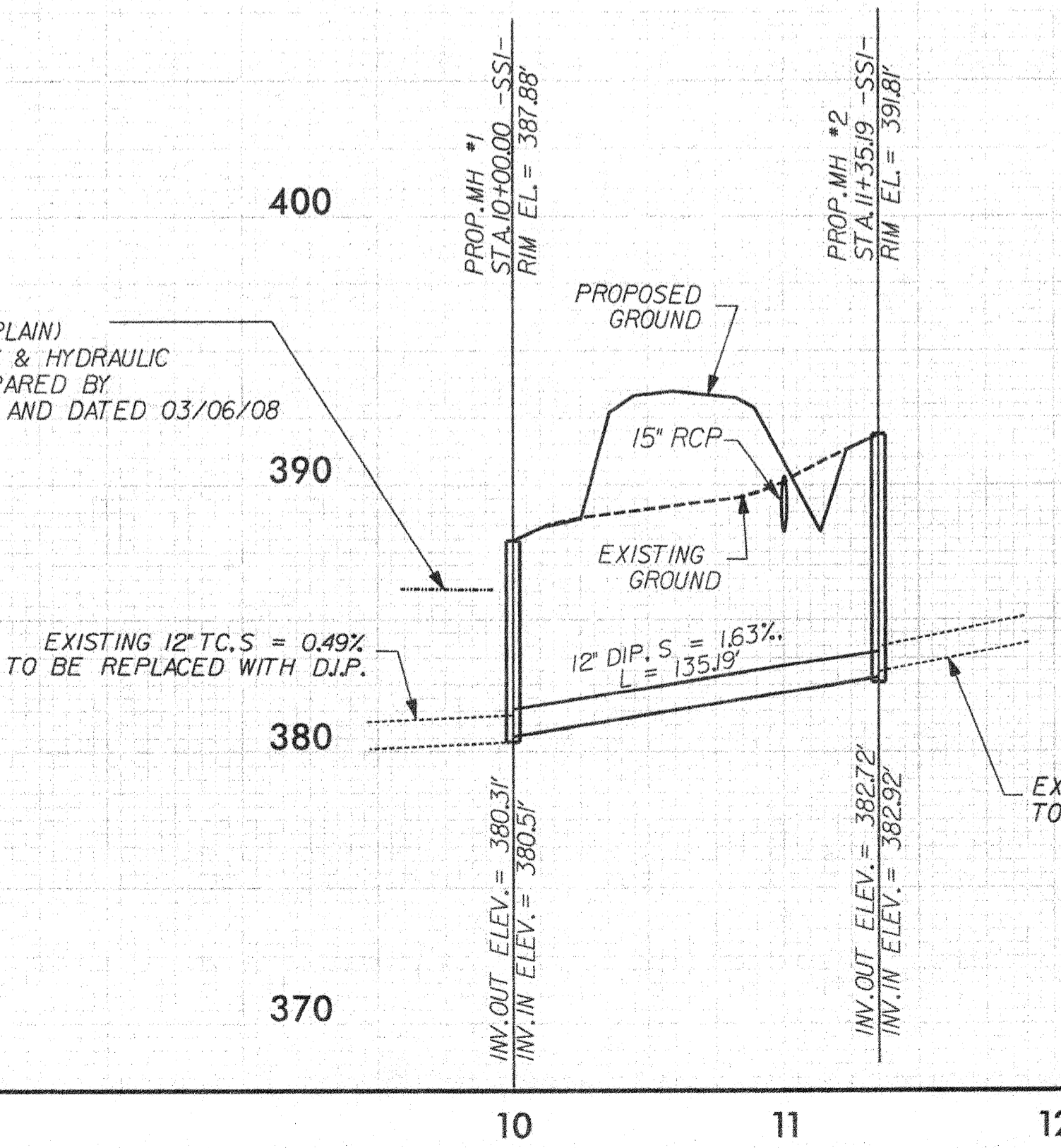

GRAPHIC SCALES

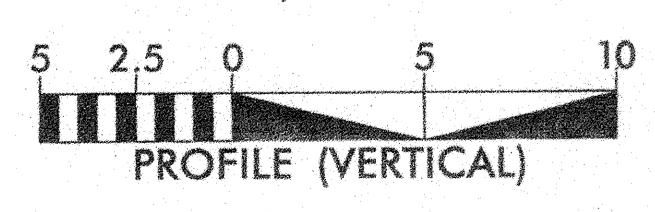
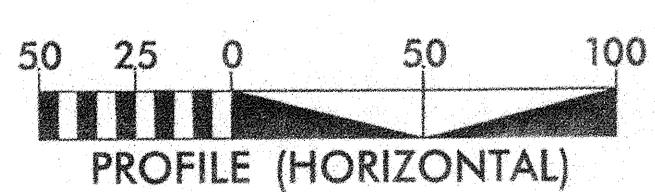

REVISIONS

8/17/09

08_27_09 08:29:59
P:\Utilities\Wfry_Ut_P\p\reedey_creek_ut.psh.dgn