

5/14/99

PROJECT REFERENCE NO.	SHEET NO.
B-3919	X-1
RW SHEET NO.	
ROADWAY DESIGN ENGINEER	HYDRAULICS ENGINEER

X-SECTION INDEX

X-2 THROUGH X-4 -L- (BRIDGE NO. 448)

X-5 THROUGH X-10 -L- (BRIDGE NO. 140)

X-11 -Y1-

X-12 -DR-

STATE OF NORTH CAROLINA
DIVISION OF HIGHWAYS

PROJ. REFERENCE NO.	SHEET NO.
B-3919	X-1A

NOTE: EMBANKMENT COLUMN DOES NOT INCLUDE BACKFILL FOR UNDERCUT

CROSS-SECTION SUMMARY

Station	Uncl. Exc. (cu. yd.)	Embt (cu. yd.)																			
L																					
15+42.50	0	0																			
15+50.00	1	2																			
16+00.00	4	71																			
16+50.00	7	233																			
17+00.00	23	369																			
17+12.70	9	98																			
L																					
32+50.00	0	0																			
33+00.00	4	53																			
33+50.00	4	271																			
34+00.00	0	493																			
34+50.00	0	671																			
35+00.00	0	857																			
35+50.00	0	915																			
36+00.00	0	911																			
36+50.00	0	838																			
37+00.00	0	722																			
37+50.00	0	744																			
37+62.60	0	203																			
Y1																					
11+90.00	0	0																			
12+00.00	1	0																			
12+50.00	80	3																			
12+68.26	65	2																			
Dr																					
10+12.00	0	0																			
10+50.00	0	17																			
10+66.00	3	4																			

NOTE: Approximate quantities only. Unclassified excavation, fine grading, clearing and grubbing, breaking of existing pavement and removal of existing pavement will be paid for at the lump sum price for "Grading".

8/23/99

0 2.5 5	PROJ. REFERENCE NO. B-3919	SHEET NO. X-2
---------	-------------------------------	------------------

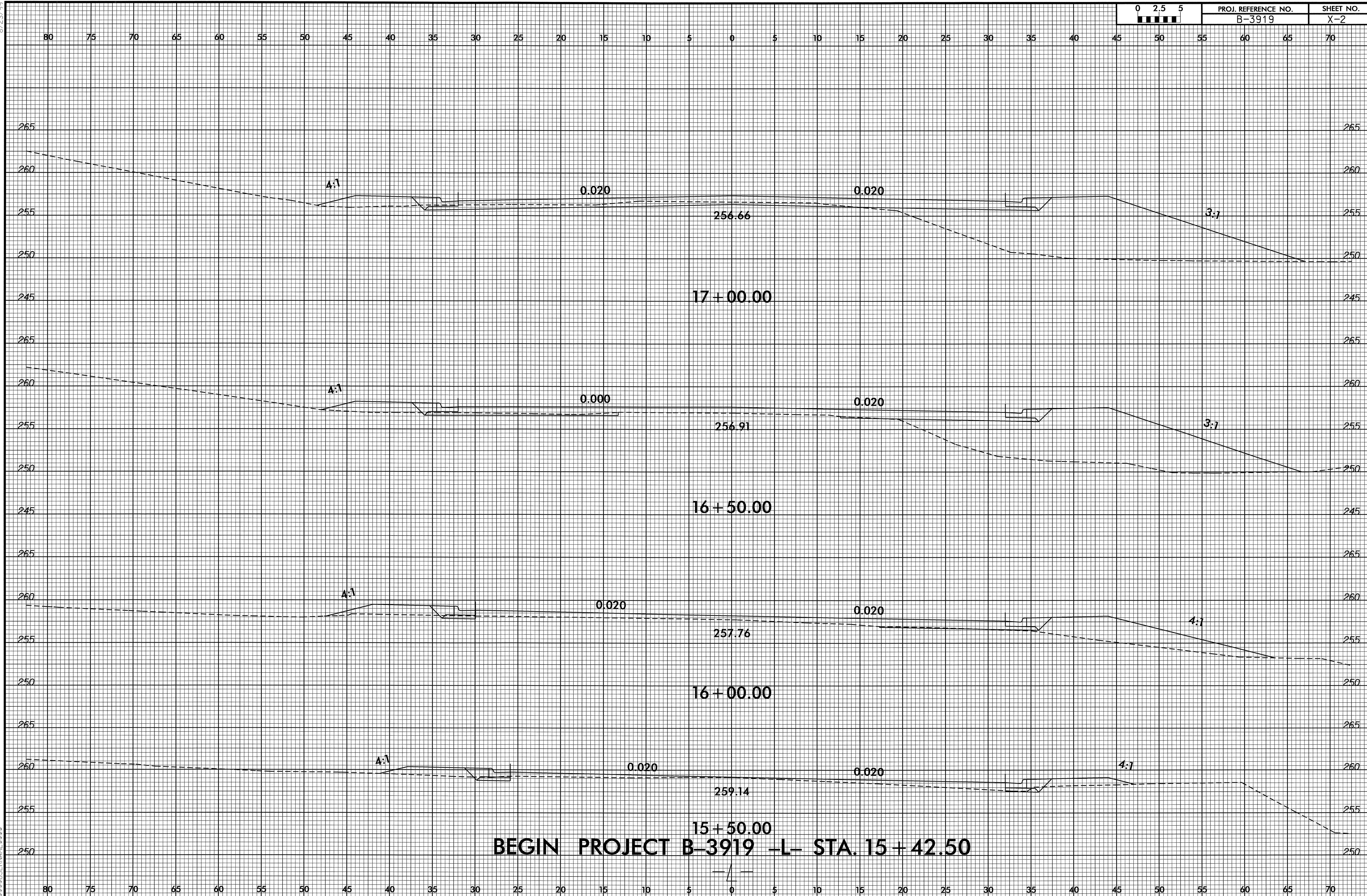

BEGIN PROJECT B-3919 -L- STA. 15+42.50

01-SEP-2009 09:48
 P:\D\F\2009\09-18-09\19_r.dwg-xpl.11.dgn
 \$\$\$SHEETNAME\$\$\$

8/23/99

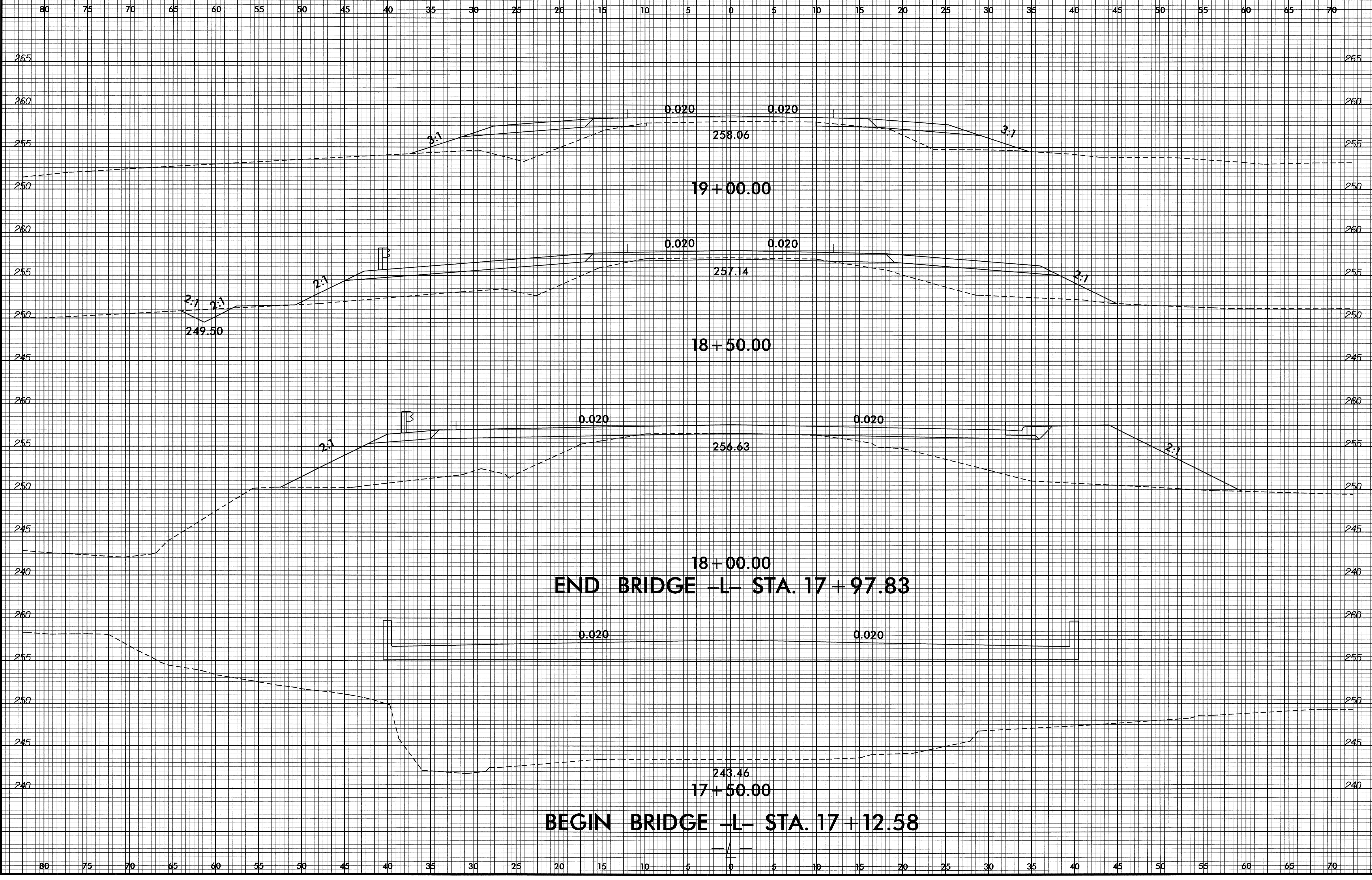

02-SEP-2009 17:00
R:\Roadway\XSC\63919_rdu_xpl1.dgn
\$\$\$\$USERNAME\$\$\$\$

8/23/99

80 75 70 65 60 55 50 45 40 35 30 25 20 15 10 5 0 5 10 15 20 25 30 35 40 45 50 55 60 65 70

END CONSTRUCTION -L- STA. 21+25.00

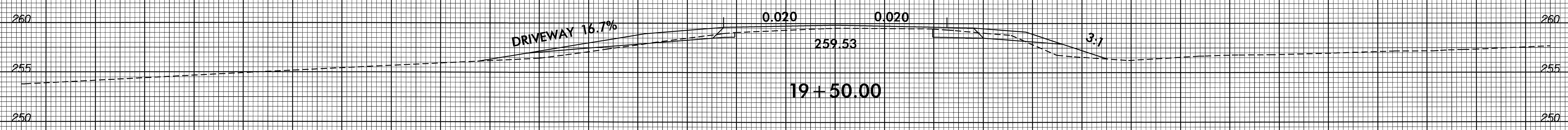
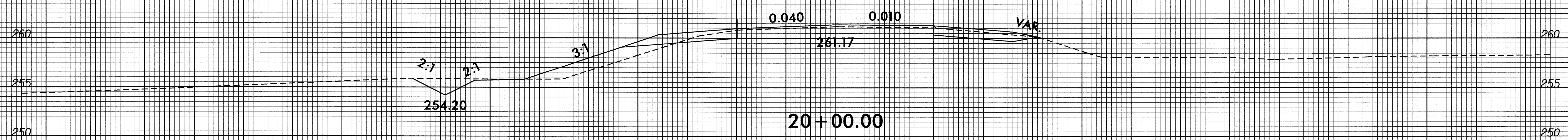
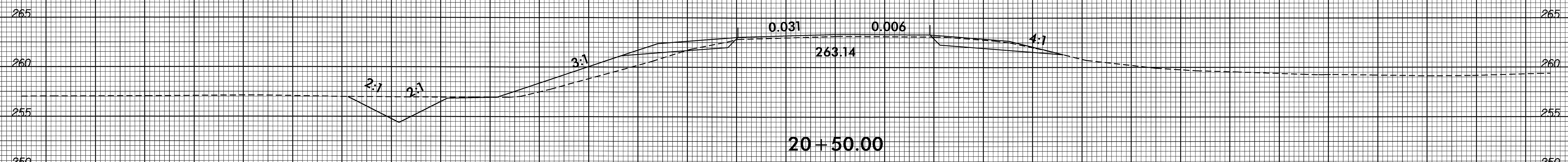
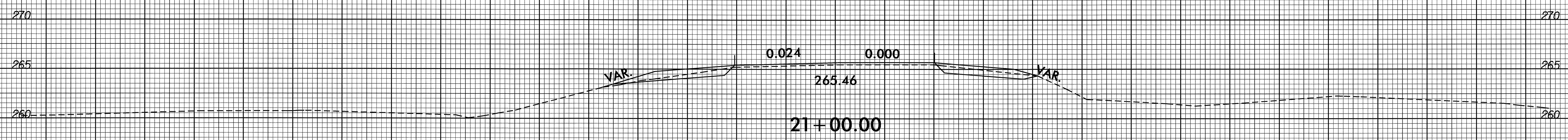
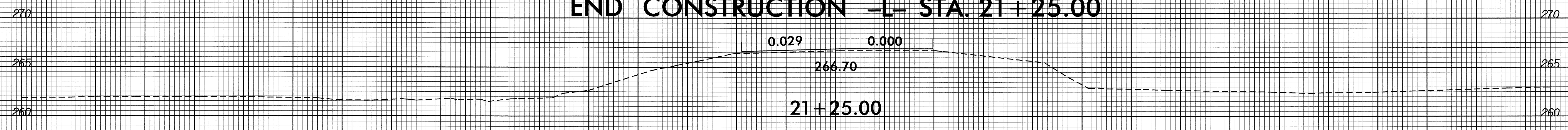

01-SEP-2009 09:48
 C:\P\03\19\B-3919_rdy_xpl.dgn
 USER:ME

80 75 70 65 60 55 50 45 40 35 30 25 20 15 10 5 0 5 10 15 20 25 30 35 40 45 50 55 60 65 70

B/23/99

0 2.5 5	PROJ. REFERENCE NO. B-3919	SHEET NO. X-5
---------	-------------------------------	------------------

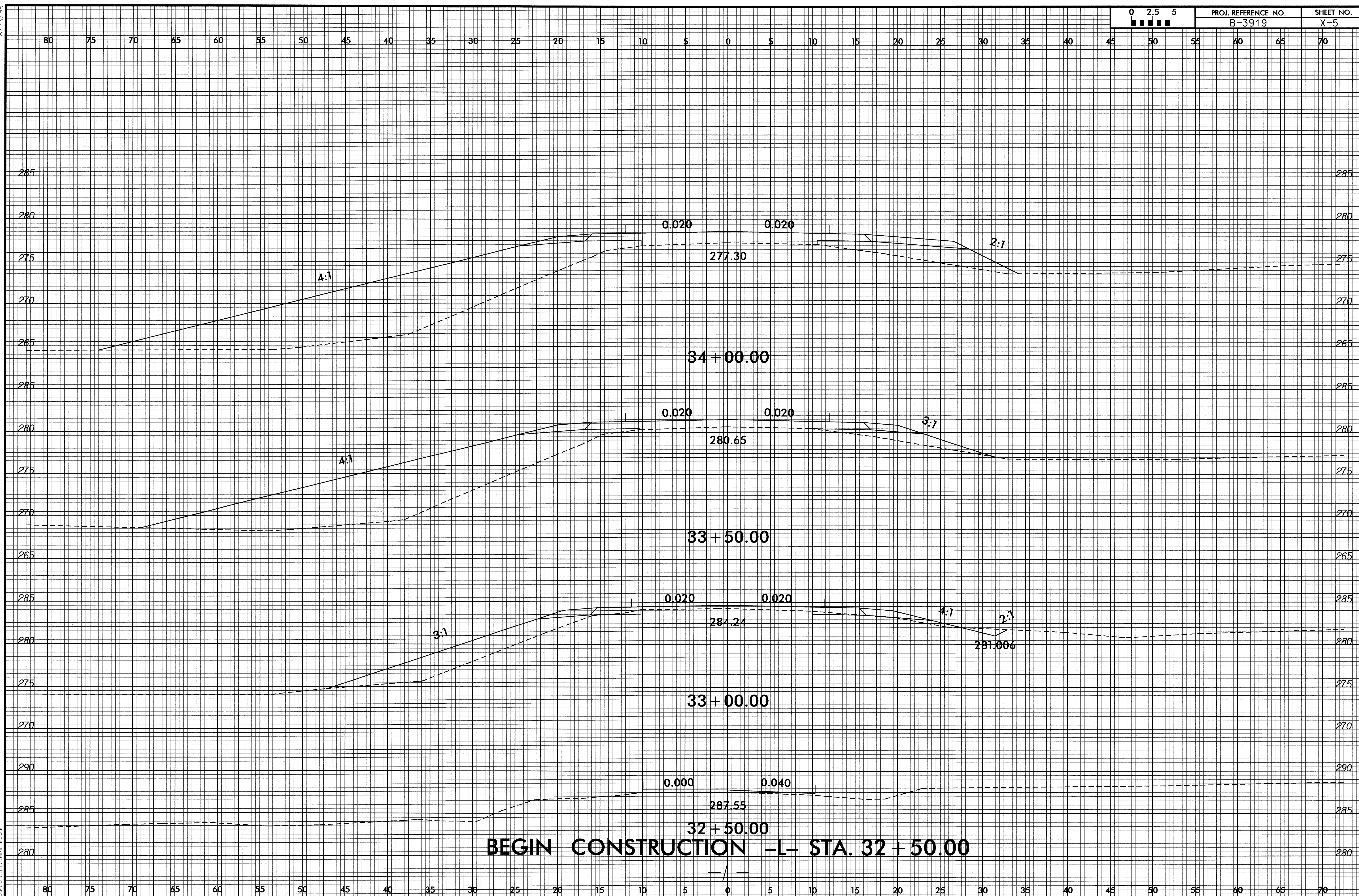

BEGIN CONSTRUCTION -L- STA. 32 + 50.00

01-SEP-2009 09:48
D:\SEP-2009\09-18-09\3919_r.dwg -xp1.12.dgn
\$\$\$\$\$BETWEEN\$\$\$\$\$

8/23/99

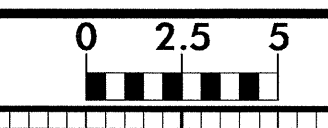

PROJ. REFERENCE NO.	SHEET NO.
B-3919	X-6

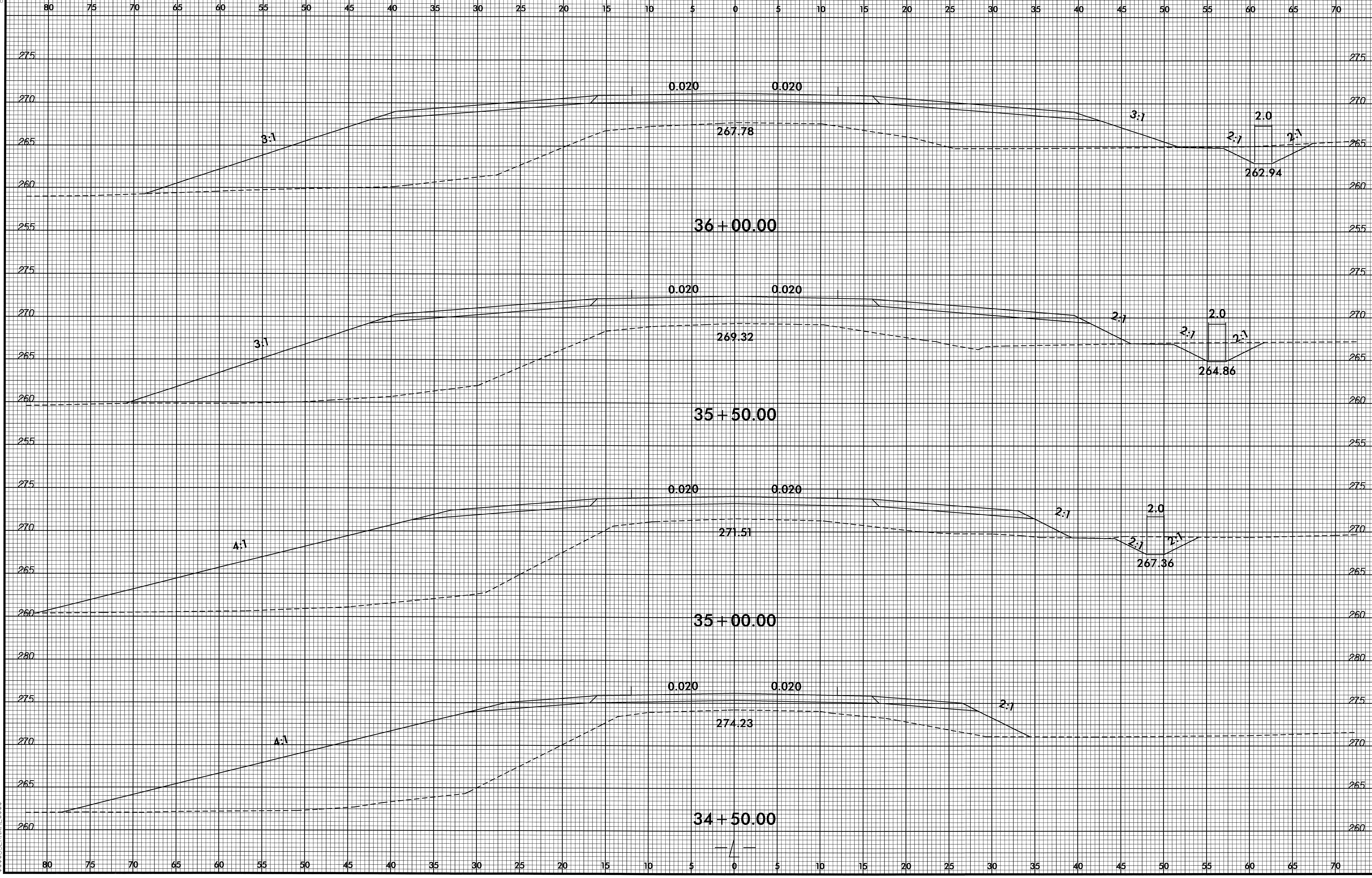

01-SEP-2009 09:46
D:\SEP\2009\0946
B-3919_rdy_xpl_12.dgn
\$\$\$\$\$USERRAME\$\$\$\$\$

8/22/99

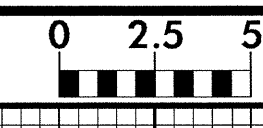

PROJ. REFERENCE NO.	SHEET NO.
B-3919	X-7

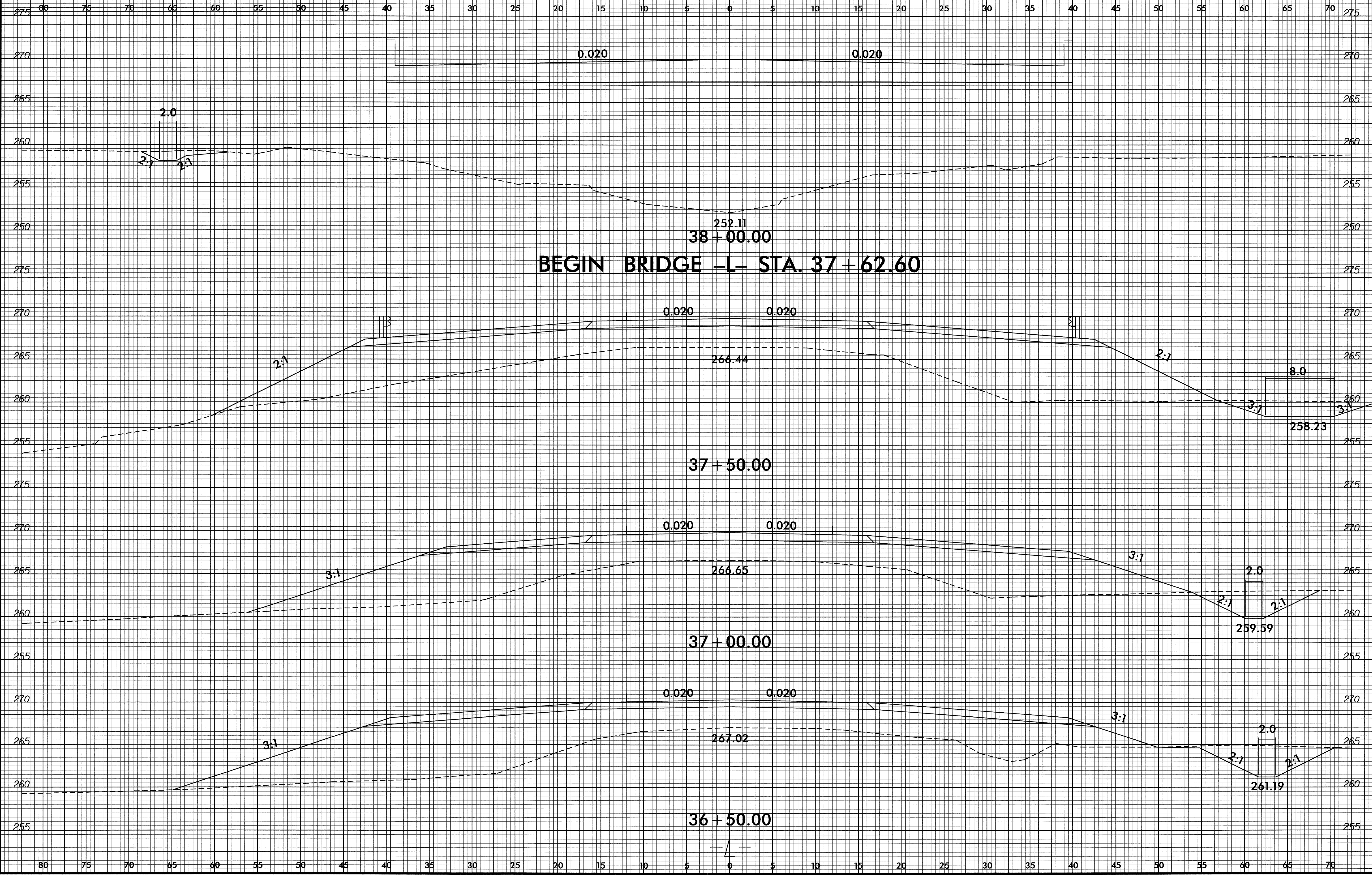

01-SEP-2009 15:20
 P:\REGISTRATION\3919\3919_rdy_xpl_12.dgn
 \$\$\$USERNAME\$\$\$

8/23/99

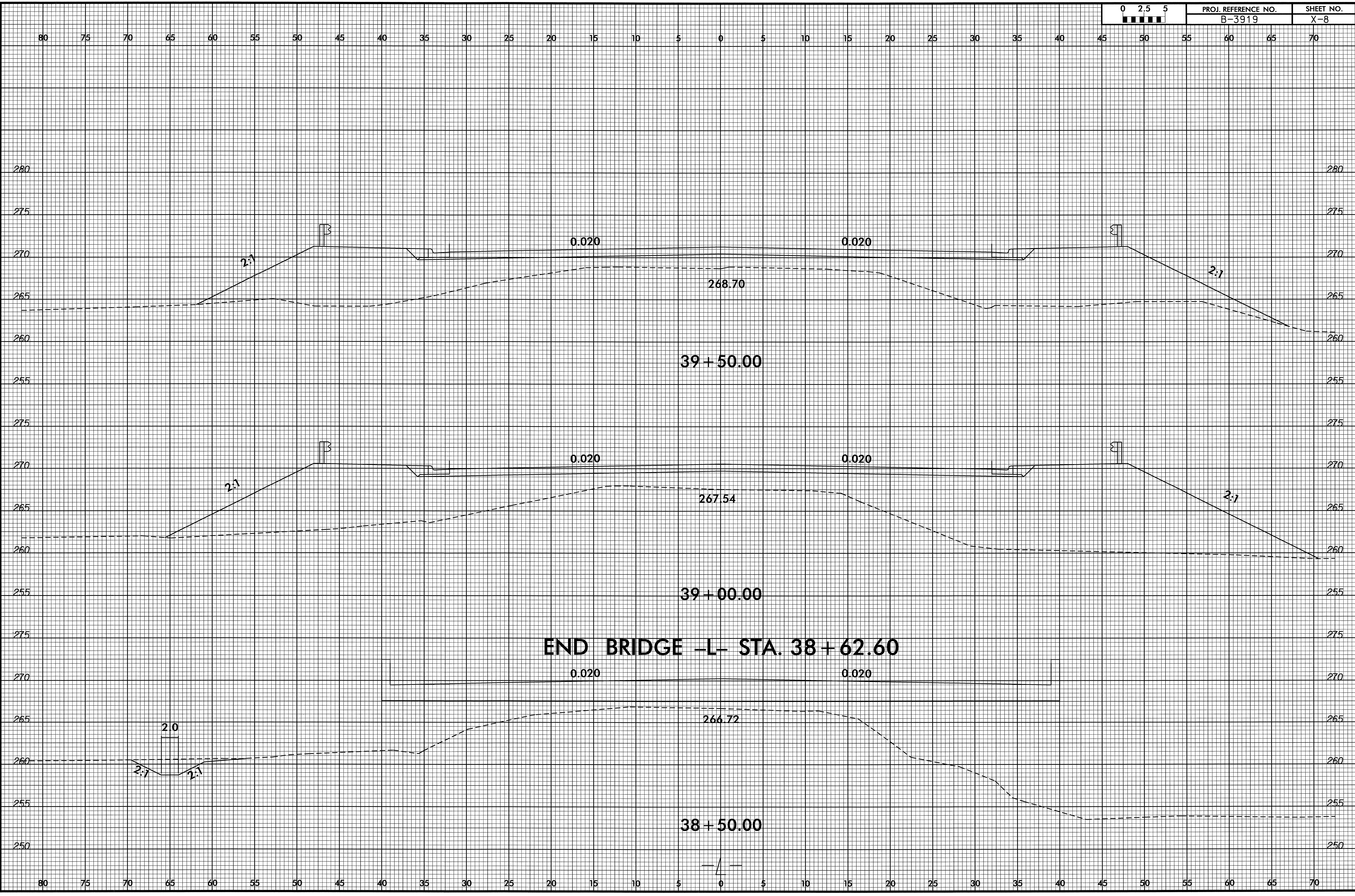

01-SEP-2009 15:20
P:\Projects\BMA_XSC\3919_rdy_xp1_12.dgn
\$\$\$\$\$USERNAME\$\$\$\$\$

8/23/99

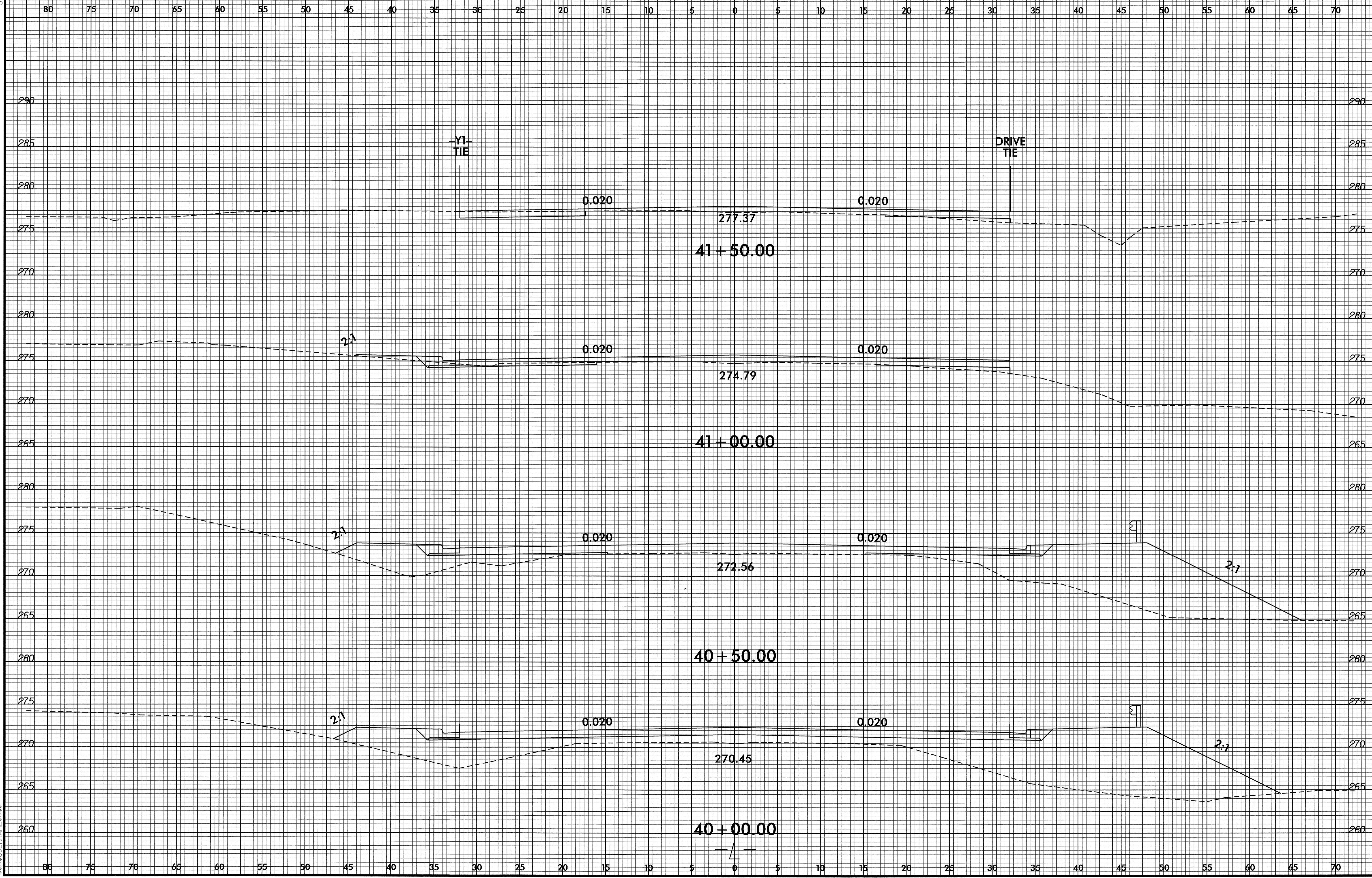

0:\SEP-2009\09148\3919_rdy_xp1.12.dgn

8/23/99

0 2.5 5	PROJ. REFERENCE NO.	SHEET NO.
	B-3919	X-10

80 75 70 65 60 55 50 45 40 35 30 25 20 15 10 5 0 5 10 15 20 25 30 35 40 45 50 55 60 65 70

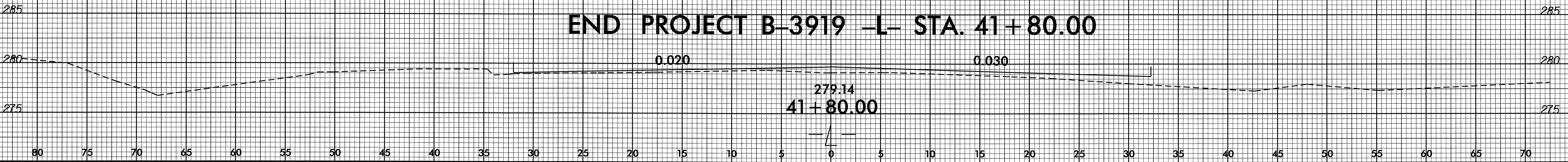

END PROJECT B-3919 -L- STA. 41+80.00

01_SFP_2009_09A48
01_SFP_2009_09A48
01_SFP_2009_09A48
01_SFP_2009_09A48
01_SFP_2009_09A48

8/23/99

75 70 65 60 55 50 45 40 35 30 25 20 15 10 5 0 5 10 15 20 25 30 35 40 45 50 55 60 65 70 75

END CONSTRUCTION -Y1- STA. 12+68.26

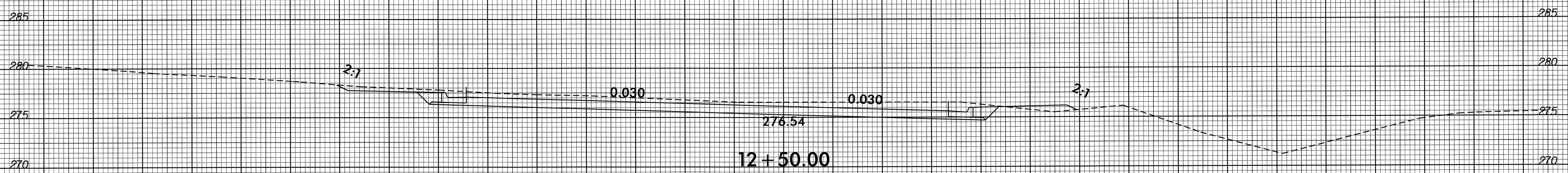

12+50.00

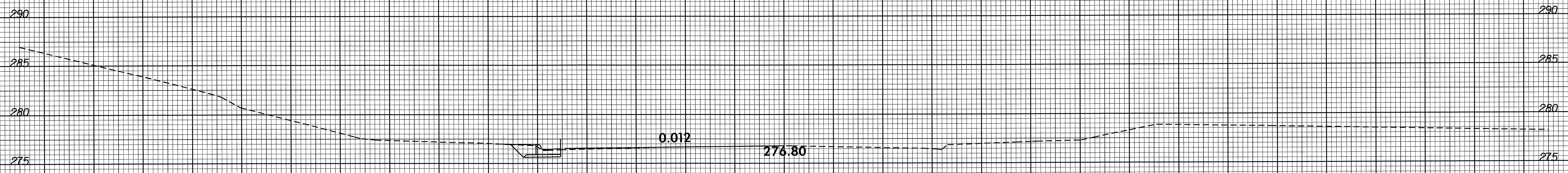

12+00.00

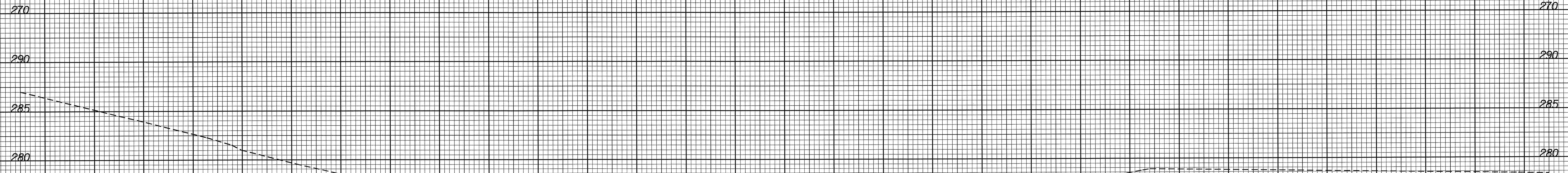

11+90.00

BEGIN CONSTRUCTION -Y1- STA. 11+90.00

-Y1-

75 70 65 60 55 50 45 40 35 30 25 20 15 10 5 0 5 10 15 20 25 30 35 40 45 50 55 60 65 70 75

I:\SEP-2009\1147
 \$\$\$DOSEANME\$\$\$
 \XFC\h3919_rdy_xpl.ul.dgn

8/23/99

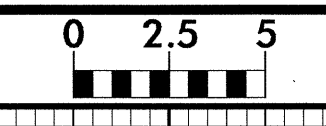

PROJ. REFERENCE NO.
B-3919

SHEET NO.
X-12

75 70 65 60 55 50 45 40 35 30 25 20 15 10 5 0 5 10 15 20 25 30 35 40 45 50 55 60 65 70 75

END CONSTRUCTION -DR- STA. 10+66.00

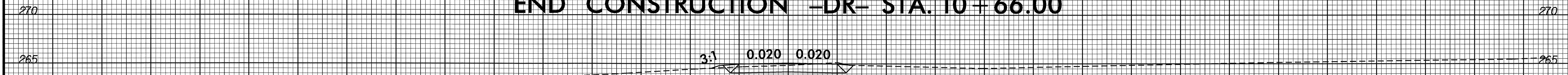

264.85
10+66.00

BEGIN CONSTRUCTION -DR- STA. 10+12.00

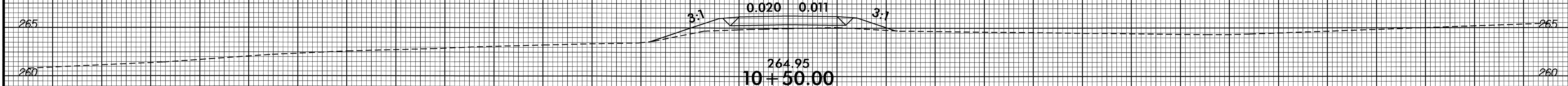

264.95
10+50.00

-DR-

75 70 65 60 55 50 45 40 35 30 25 20 15 10 5 0 5 10 15 20 25 30 35 40 45 50 55 60 65 70 75

01-SEP-2009 09:48
R:\Roadway\XSC\3919_rdg_xpl_dr.dgn
\$\$\$\$USERNAME\$\$\$\$