

STATE	PROJECT WBS	SHEET NUMBER
NC	12CR10661.7	1

1

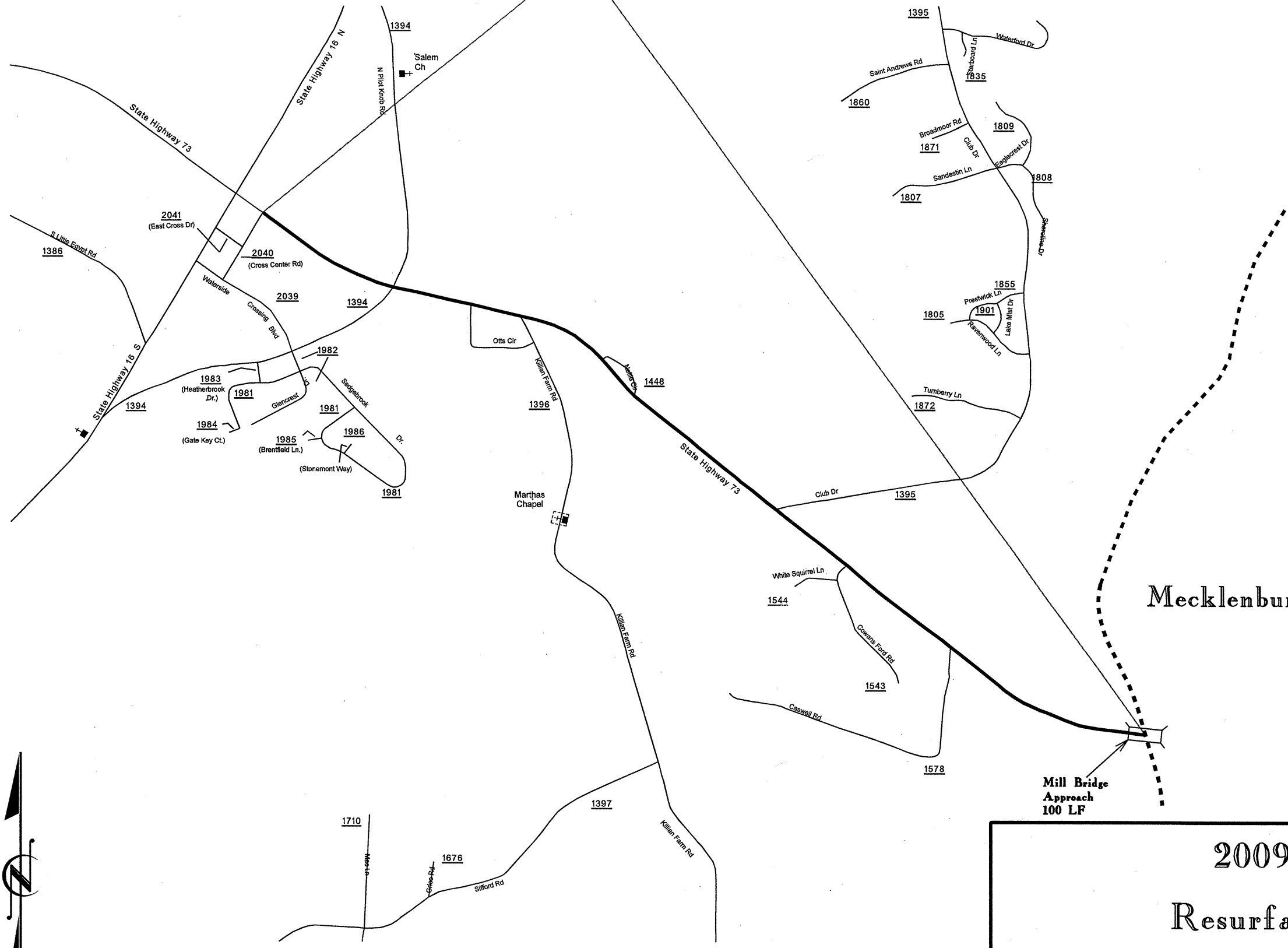

Mecklenburg Co.

Mill Bridge Approach
100 LF

2009 - 2010
Resurfacing Map
LINCOLN COUNTY NC

No Scale



G. BRITTAIN
Drawn by:

STATE	PROJECT WBS	SHEET NUMBER
NC	DCR100417	2

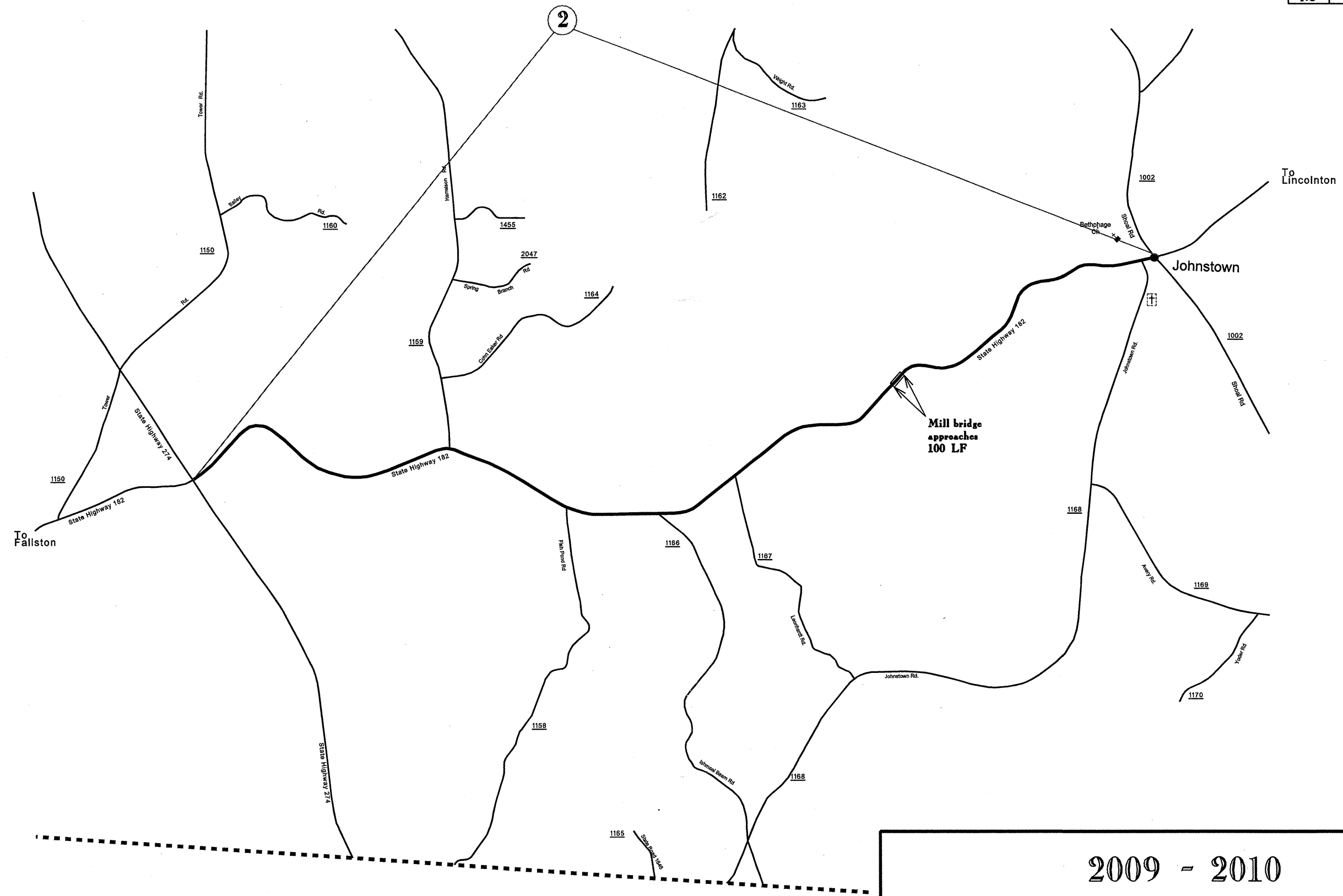

Gaston Co.

2009 - 2010
 Resurfacing Map
 LINCOLN COUNTY NC

G. BRITTAIN
 Drawn by:

STATE	PROJECT WBS	SHEET NUMBER
NC	19CR1044L7	3

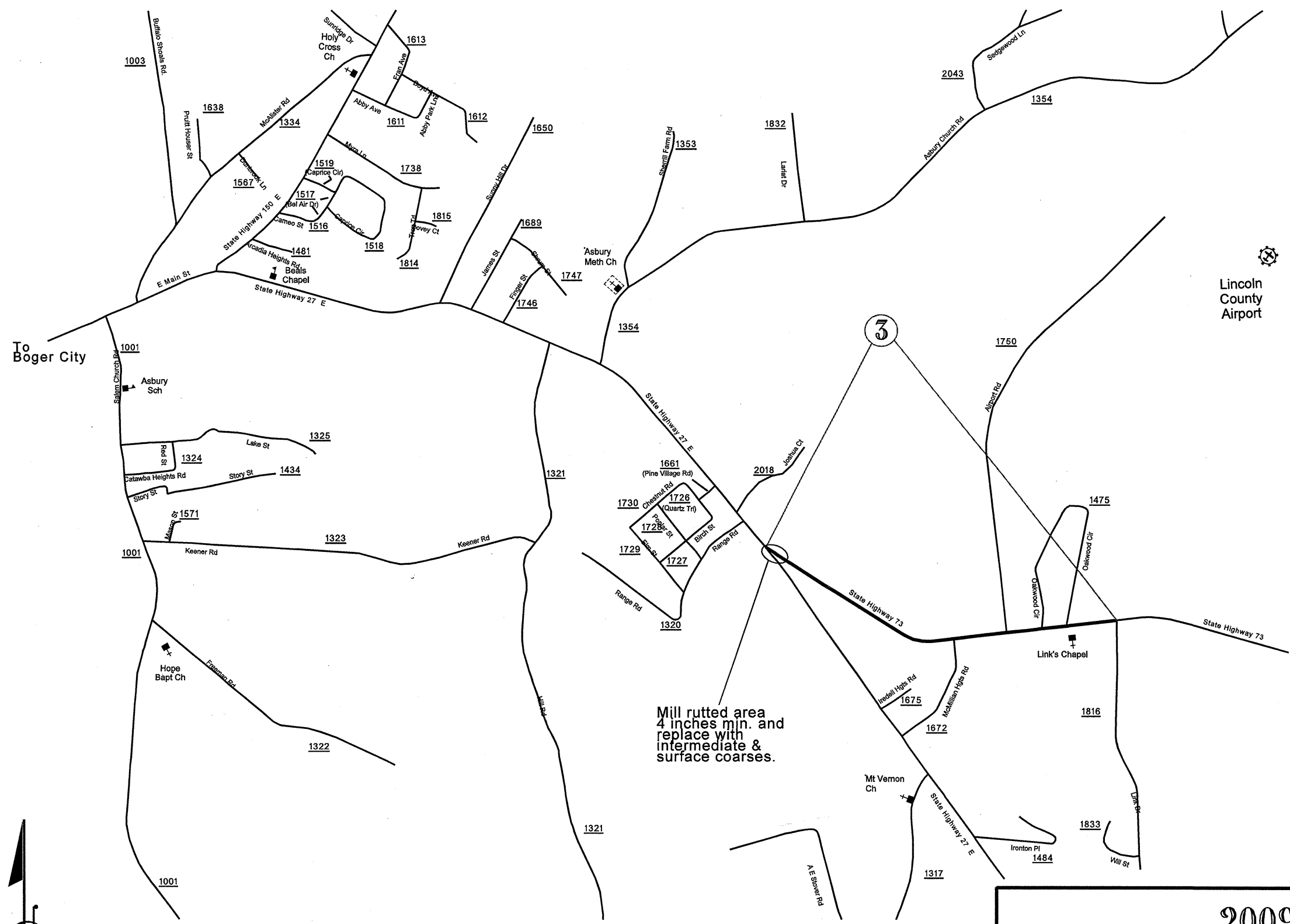

G. BRITTAIN



No Scale

2009 - 2010
 Resurfacing Map
 LINCOLN COUNTY NC

STATE	PROJECT WBS	SHEET NUMBER
NC	EXPL-AM17	4

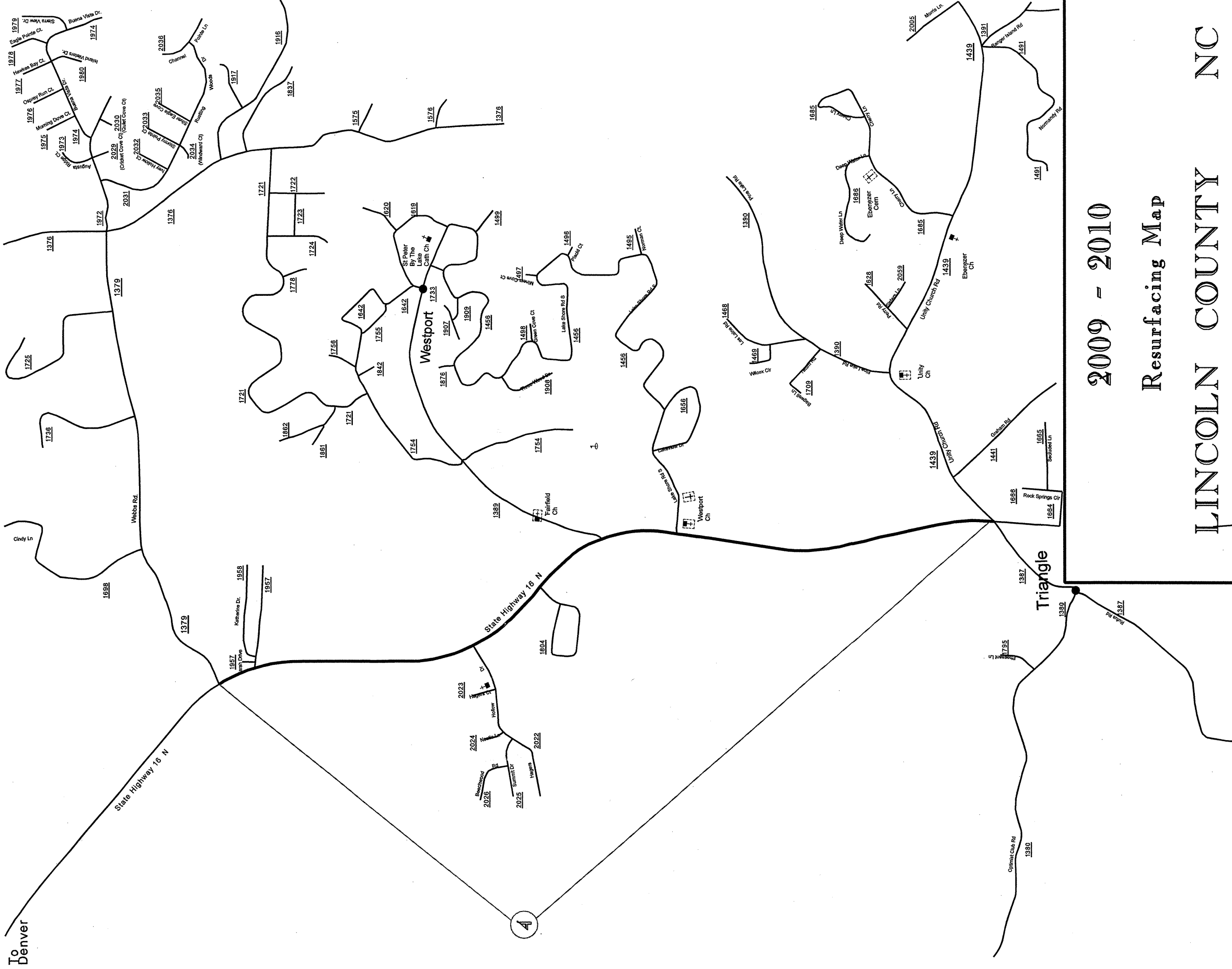

2009 - 2010

Resurfacing Map

LINCOLN COUNTY NC

STATE	PROJECT	SHEET
NC	WBS INCR. 0000149	NUMBER 5

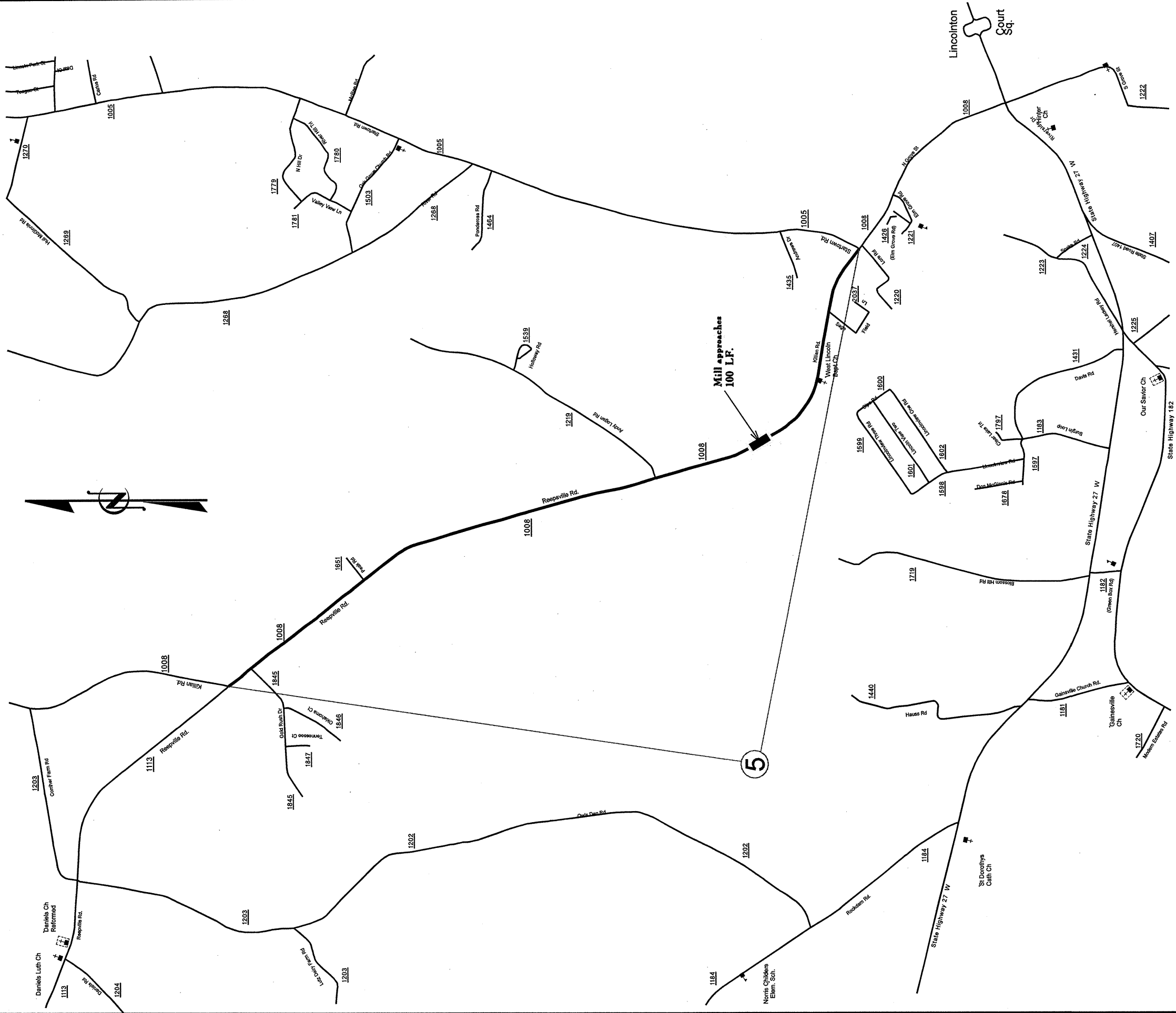

2009 - 2010

Resurfacing Map

LINCOLN COUNTY NC

STATE	PROJECT WBS	SHEET NUMBER
NC	13CR300419	6

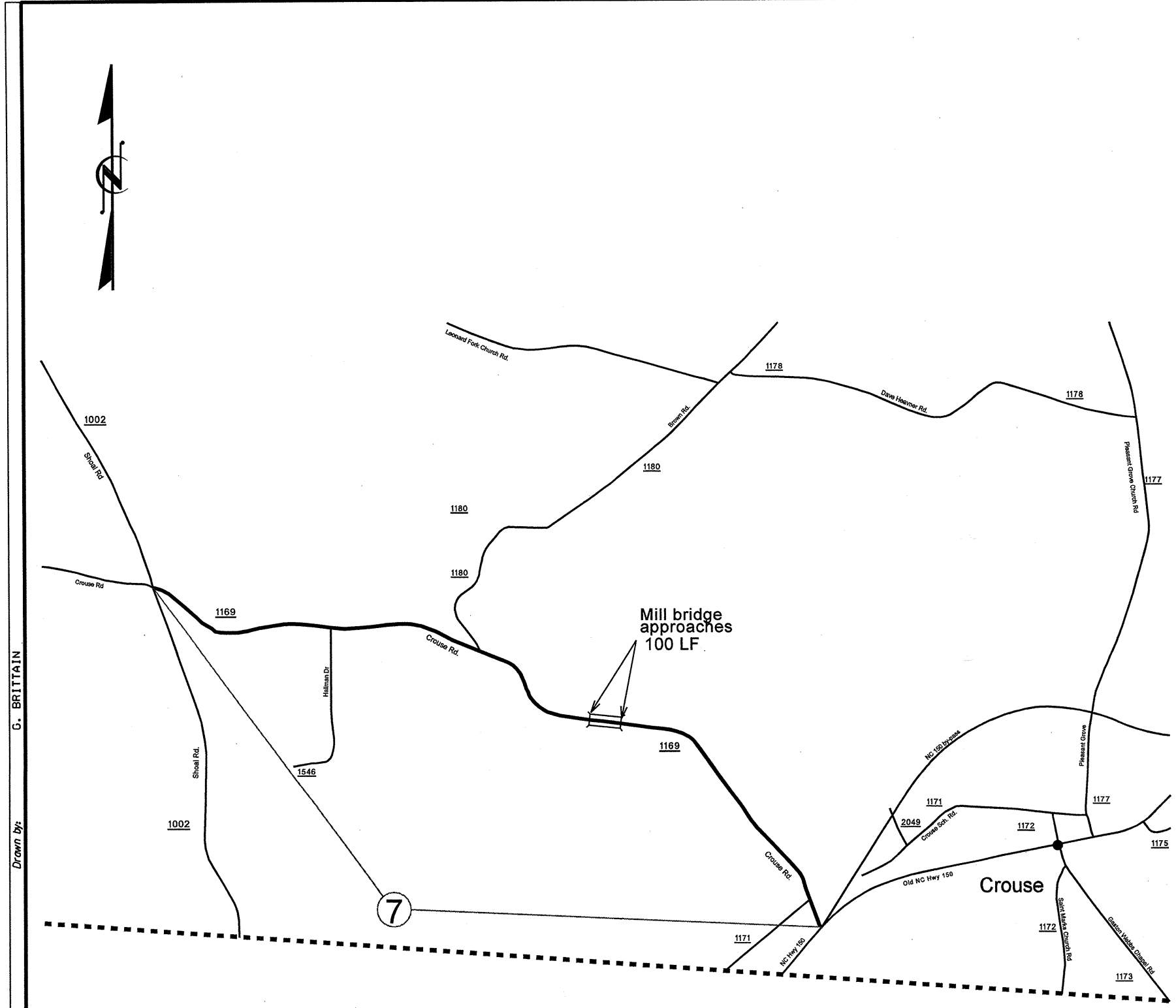

Gaston County

No Scale

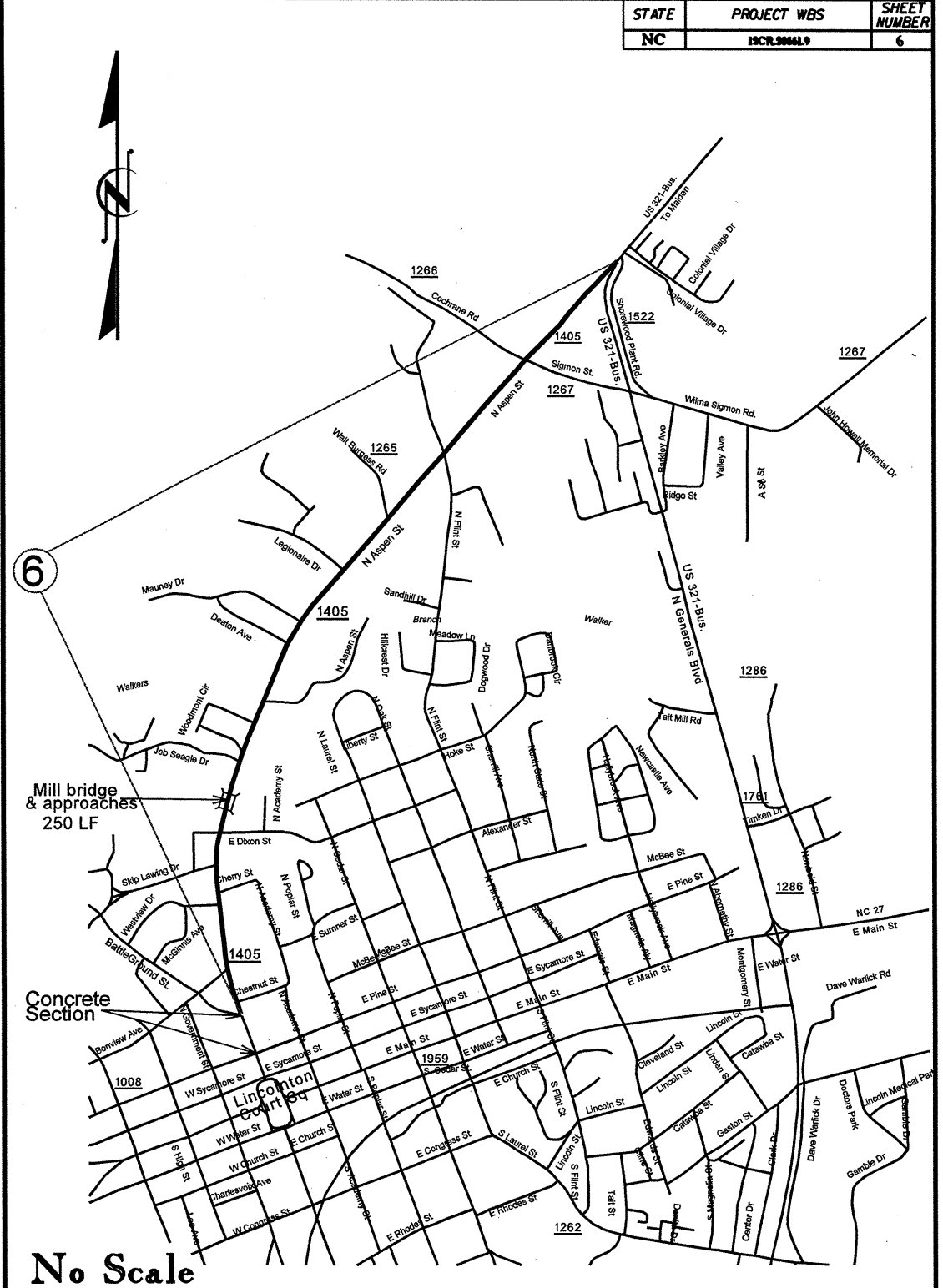

No Scale

2009 - 2010
Resurfacing Map
LINCOLN COUNTY NC

Drawn by: C. BRITAIN

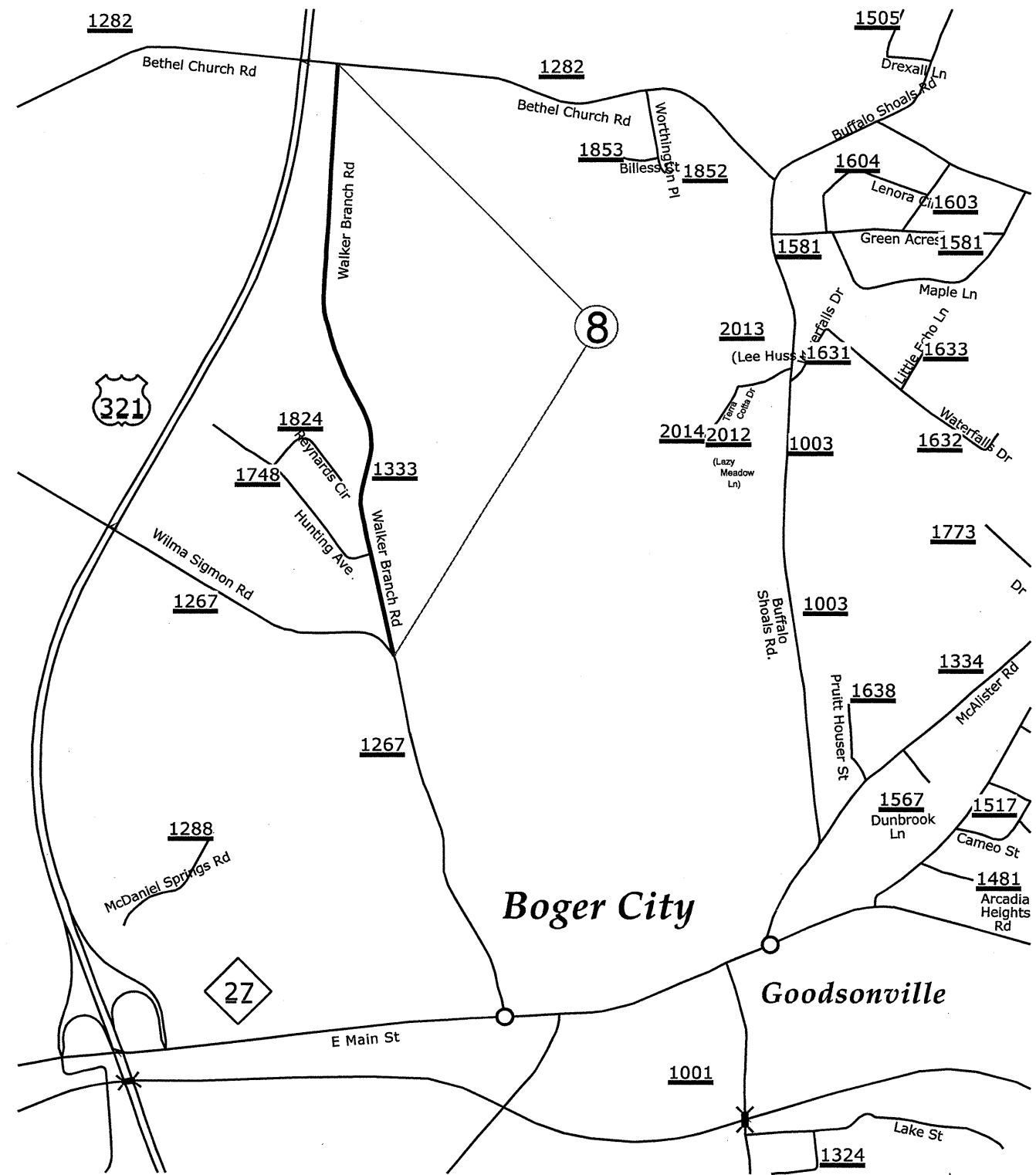

No Scale

2009 - 2010
Resurfacing Map
LINCOLN COUNTY NC

G. BRITTAIN
Drawn by:

STATE	PROJECT WBS	SHEET NUMBER
NC	13CR.20461.9	8

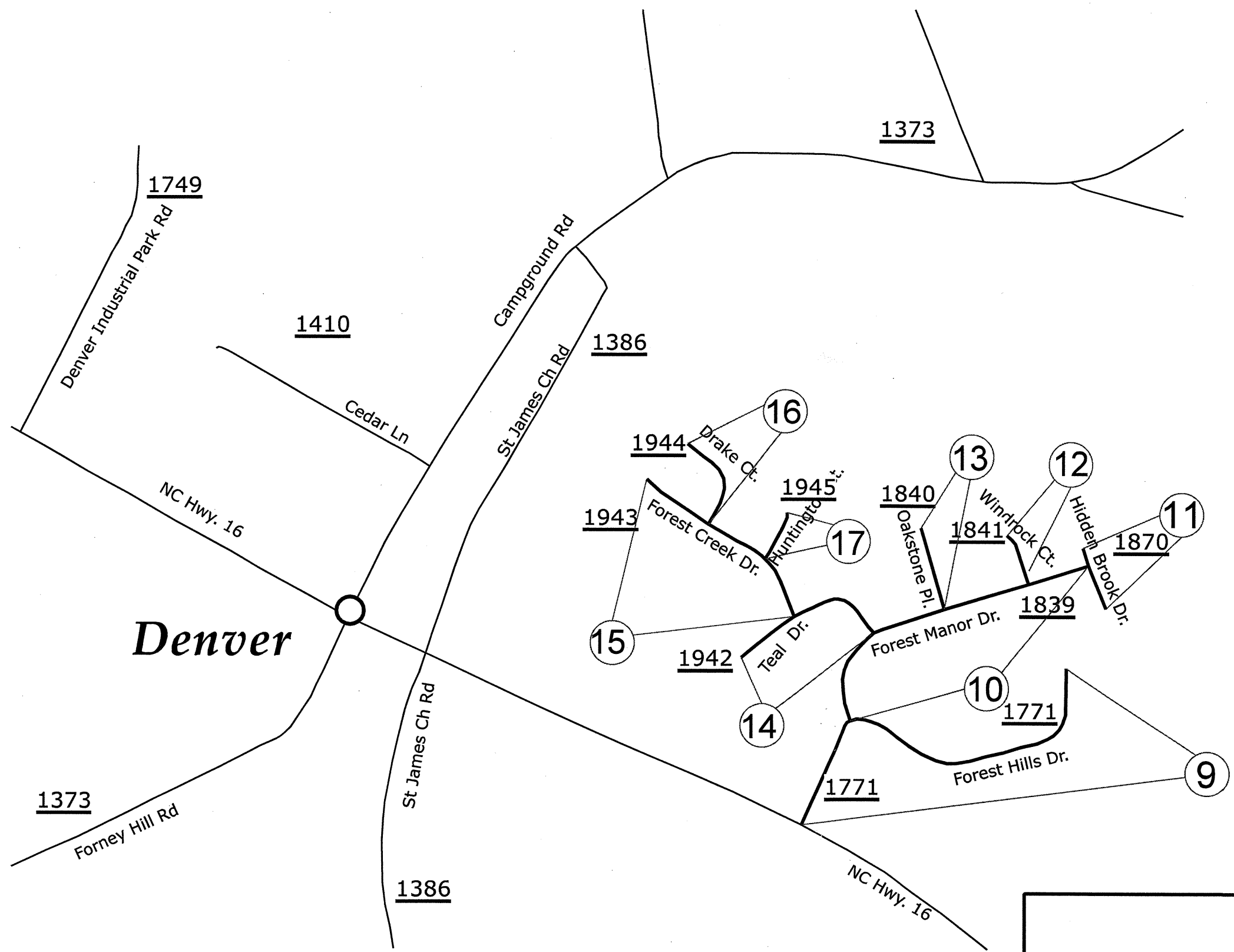

Denver

No Scale

2009 - 2010
 Resurfacing Map
 LINCOLN COUNTY NC

G. BRITAIN
 Drawn by:

STATE	PROJECT WBS	SHEET NUMBER
NC	10CR.0001.9	9

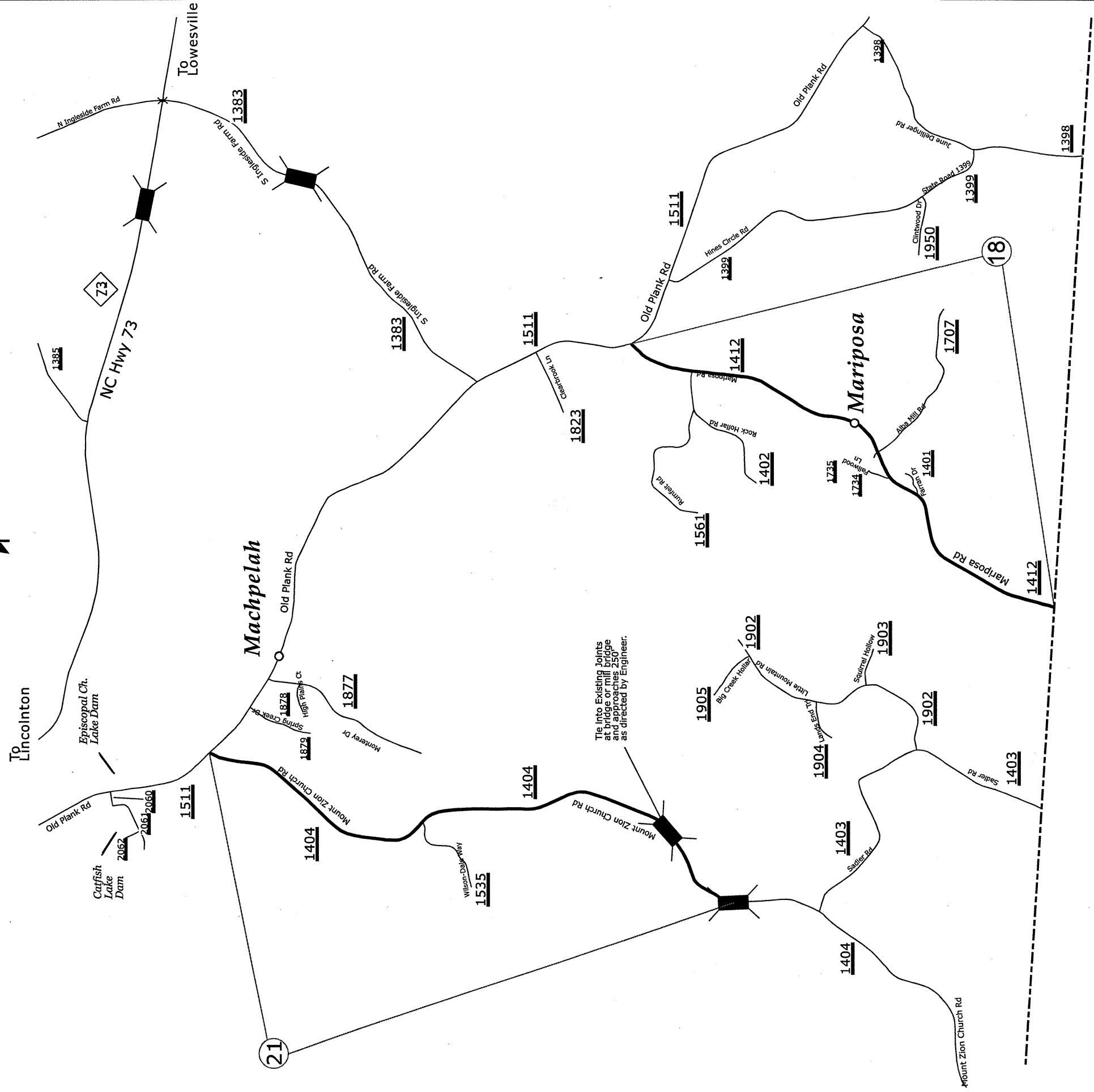

Gaston County

2009 - 2010

Resurfacing Map

LINCOLN COUNTY NC

STATE	PROJECT WBS	SHEET NUMBER
NC	13CR.2008L9	10

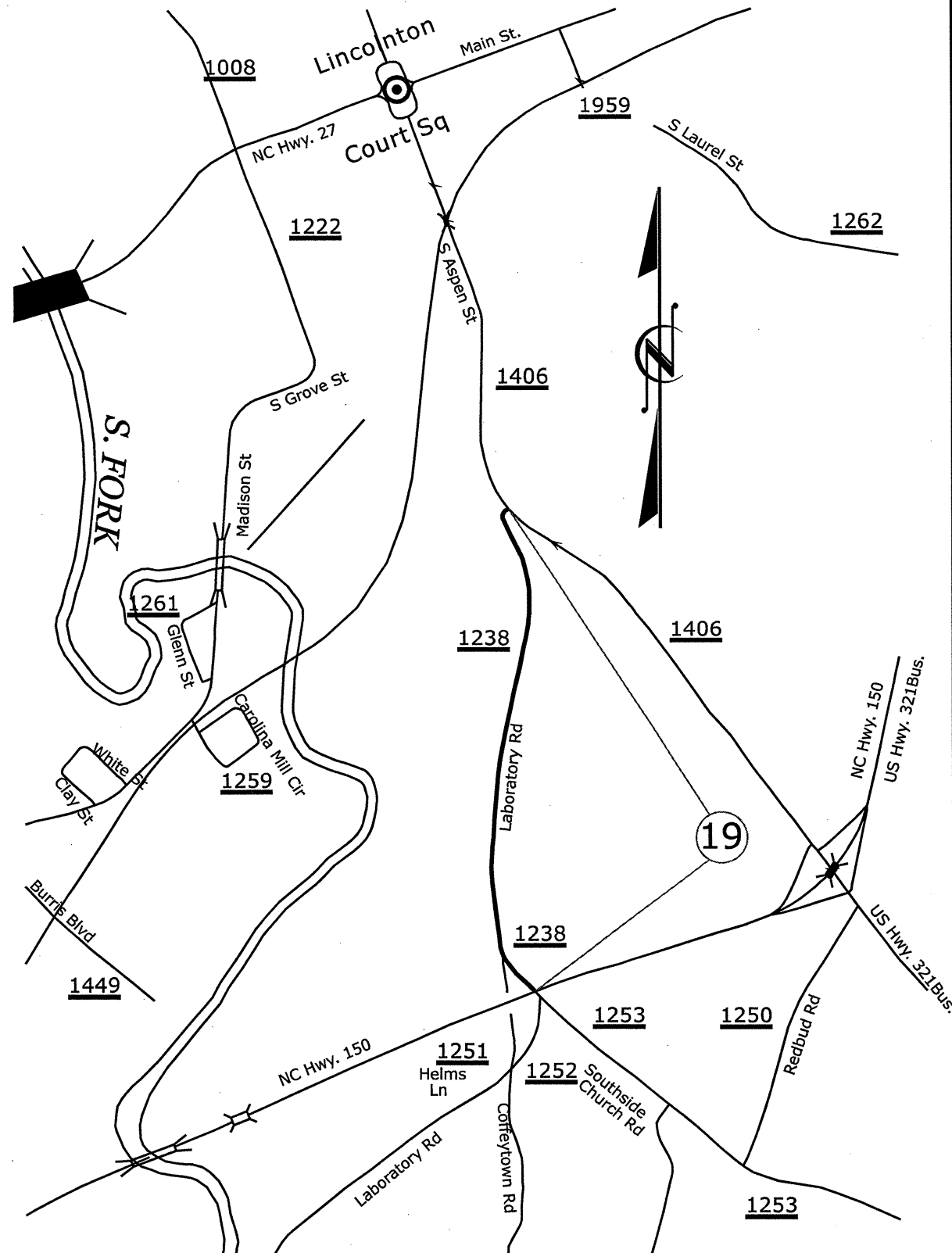

No Scale

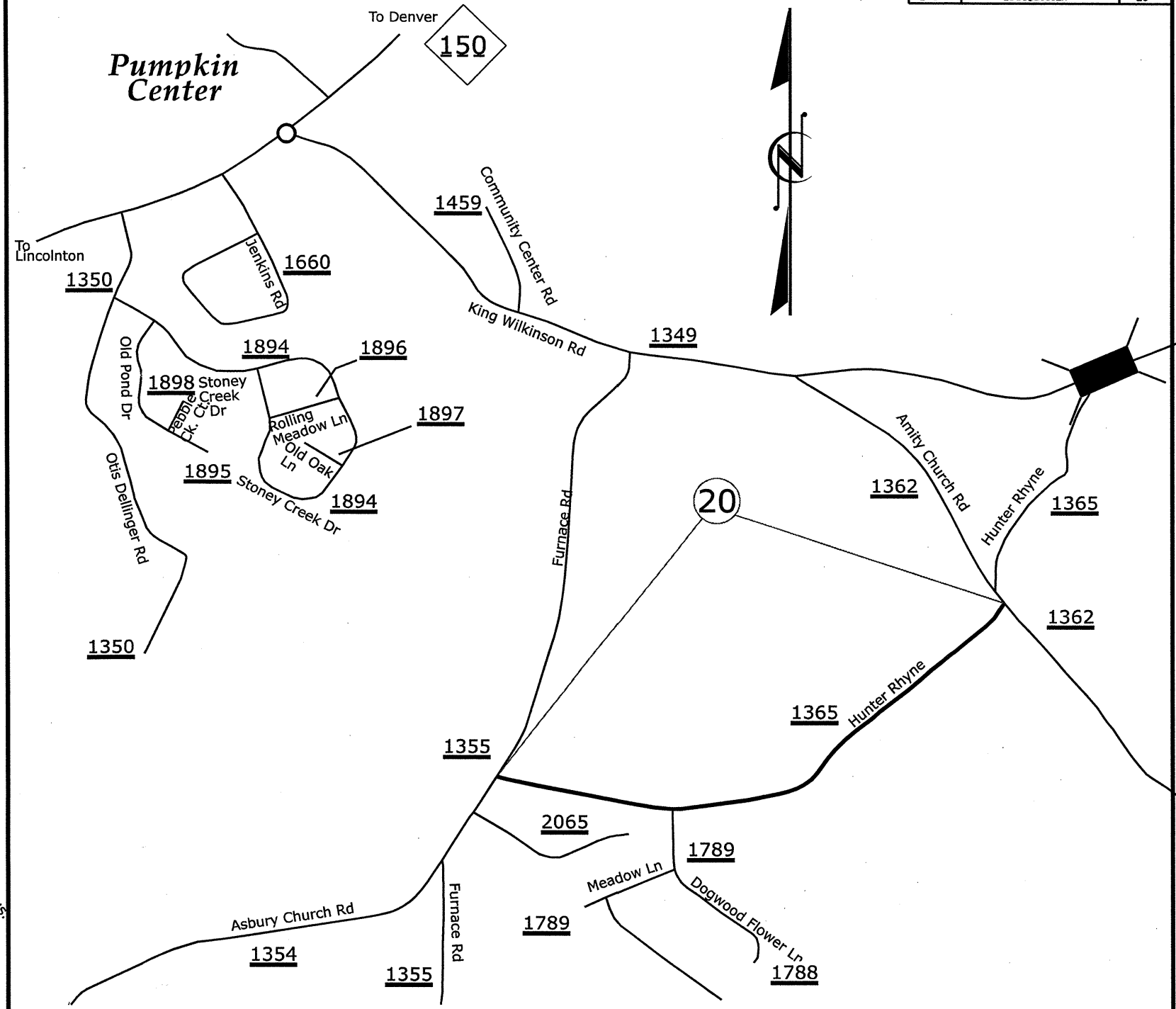

No Scale

2009 - 2010
Resurfacing Map
LINCOLN COUNTY NC

G. BRITTAIN
Drawn by:

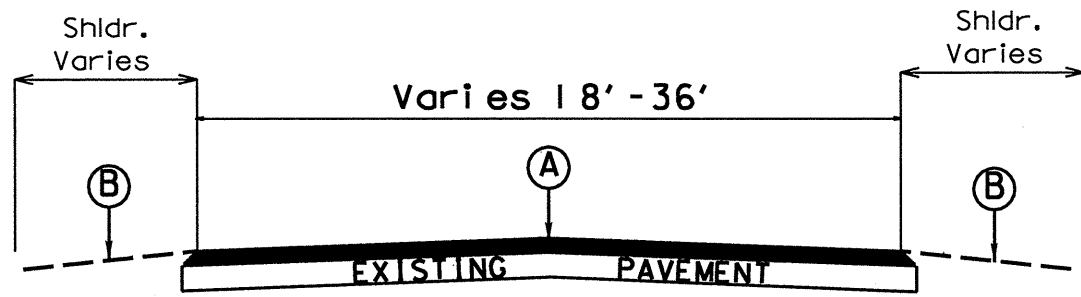

TYPICAL SECTION NO. 1

- MAP # 1 - # 3 (entire maps)
- MAP # 4 - STA 0+00 TO 45+00
STA 48+00 TO 154+00
- MAP # 5 (entire map)
- MAP # 6 - STA. 30+50 TO 41+50
STA. 75+00 TO 80+00
- MAP # 7 - MAP # 21 (entire maps)

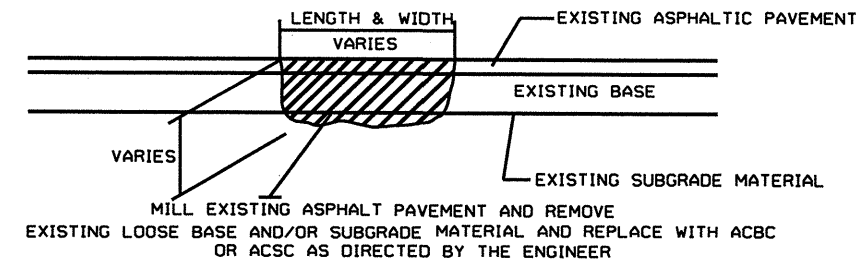

PATCHING EXISTING PAVEMENT

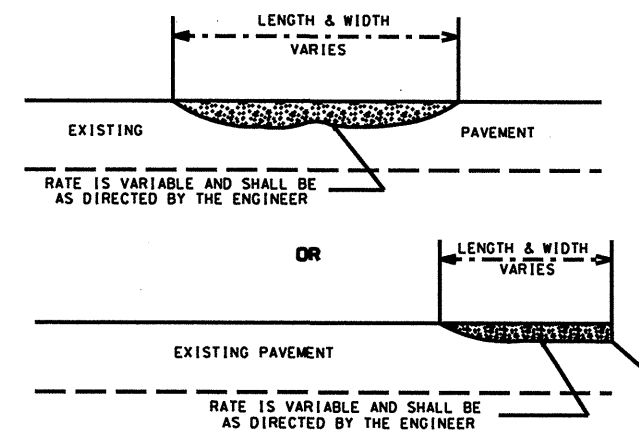

**ASPHALT CONCRETE SURFACE COURSE
TYPE S9.5B. (LEVELING COURSE)**

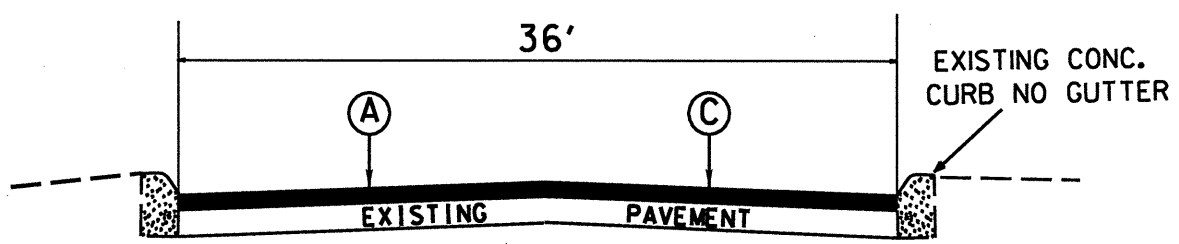

TYPICAL SECTION NO. 2

MAP # 6 STA. 0+00 TO STA 19+00

PAVEMENT SCHEDULE	
A	PROP. APPROX. 1½" ASPHALT CONCRETE SURFACE COURSE, TYPE S9.5B, AT AN AVERAGE RATE OF 168 LBS. PER SQ. YD.
B	EARTH MATERIAL (SHOULDER RECONSTRUCTION)
C	MILL ASPHALT PAVEMENT APPROX. 1.5" TO 3.0" AS DIRECTED BY THE ENGINEER

General Notes:

- * Pavement edge slopes are 1:1 unless specified otherwise.
- * Mill bridge approaches 100' to provide a smooth transition or as directed by the Engineer.

**2009 - 2010
Resurfacing Program
Typical Sections
Lincoln County NC**

**Stations increase to the N & E

Checked by: Drawn by: G. Brittain

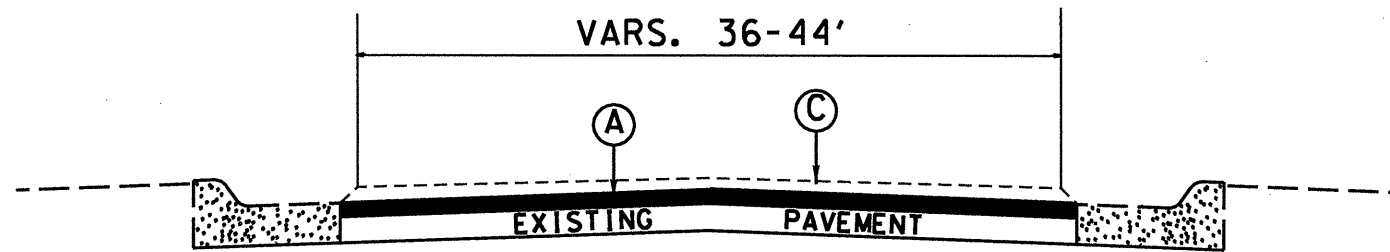

TYPICAL SECTION NO. 3

MAP # 6 STA. 19+00 TO STA 30+50

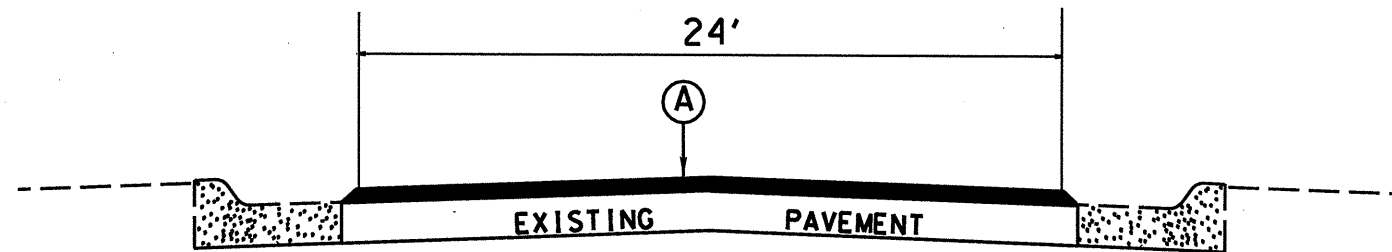

TYPICAL SECTION NO. 4

MAP # 6 STA. 63+50 TO STA 70+00

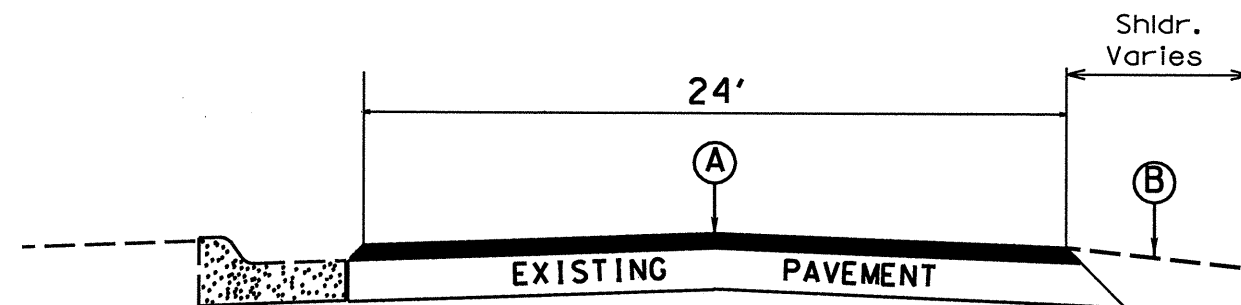

TYPICAL SECTION NO. 5

MAP # 6 STA. 41+50 TO 63+50
 STA. 70+00 TO 75+00
 STA. 80+00 TO 87+50

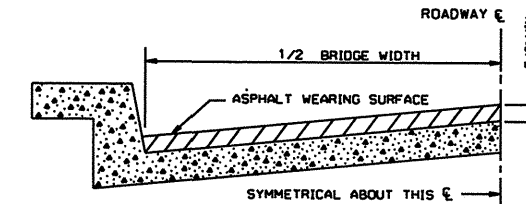

BRIDGE HALF TYPICAL SECTION

FOR BRIDGES WITH FLOOR DRAINS, CARE SHALL BE EXERCISED IN PLACING THE WEARING SURFACE AROUND FLOOR DRAINS SO AS NOT TO HINDER EFFECTIVE DRAINAGE. ALL DRAINS SHALL BE LEFT OPEN.

THE PROPOSED WEARING SURFACE SHALL VARY IN THICKNESS AS NECESSARY TO PROVIDE A SMOOTH RIDING SURFACE. A THICKNESS OF NOT LESS THAN 5/8\"/>

NOTES

ALL UNPAVED S.R. ROADS TO BE SURFACED 50' FROM EDGE OF PAVEMENT OF MAIN PROJECT.
 ALL PAVED S.R. ROADS TO BE RESURFACED TO THE ENDS OF THE RADII, OR AS DIRECTED BY THE ENGINEER.
 EDGES, PAVEMENT WIDENING, INTERSECTIONS AND BRIDGE FLARES ARE INCLUDED IN THE TABLE OF QUANTITIES.
 SHOULDERS AND DITCHES ARE TO BE CONSTRUCTED BY OTHERS UNLESS OTHERWISE NOTED.
 BRIDGES TO BE RESURFACED AT LOCATIONS AND TO DEPTH AS DIRECTED BY THE ENGINEER.

PAVEMENT SCHEDULE	
A	PROP. APPROX. 1 1/2" ASPHALT CONCRETE SURFACE COURSE, TYPE S9.5B, AT AN AVERAGE RATE OF 168 LBS. PER SQ. YD.
B	EARTH MATERIAL (SHOULDER RECONSTRUCTION)
C	MILL ASPHALT PAVEMENT APPROX. 1.5" TO 3.0" AS DIRECTED BY THE ENGINEER

General Notes:

- * Pavement edge slopes are 1:1 unless specified otherwise.
- * Mill bridge approaches 100' to provide a smooth transition or as directed by the Engineer.

2009 - 2010
 Resurfacing Program
 Typical Sections
 Lincoln County NC

**Stations increase to the N & E

Checked by:

Drawn by: G. Brittain

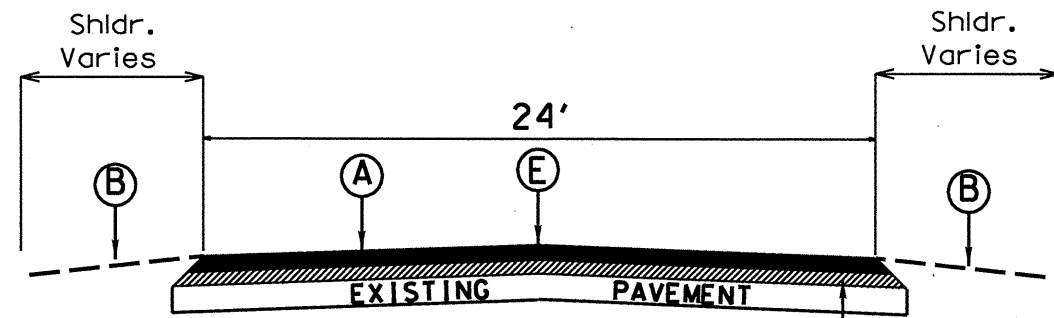

TYPICAL SECTION NO. 6
 MAP # 3 STA. 0+00 TO 2+50
 OR AS DIRECTED BY ENGINEER



DETAIL A
 MILLING BRIDGE APPROACHES

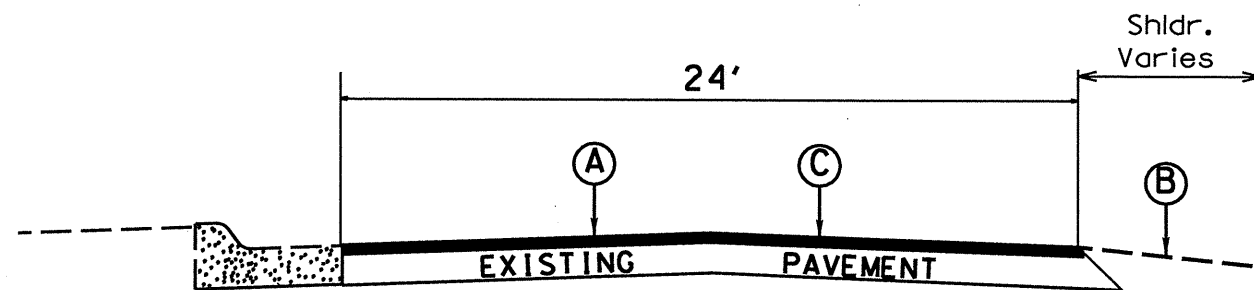

TYPICAL SECTION NO. 7
 MAP # 4 STA. 45+00 TO 48+00

PAVEMENT SCHEDULE	
A	PROP. APPROX. 1½" ASPHALT CONCRETE SURFACE COURSE, TYPE S9.5B, AT AN AVERAGE RATE OF 168 LBS. PER SQ. YD.
B	EARTH MATERIAL (SHOULDER RECONSTRUCTION)
C	MILL ASPHALT PVMT. APPROX. 1.5" TO 3.0" AS DIRECTED BY THE ENGINEER
D	PROP. APPROX. 2½" ASPHALT CONCRETE INTERMEDIATE COURSE, TYPE I 19.0B, AT AN AVERAGE RATE OF 285 LBS. PER SQ. YD.
E	MILL ASPHALT PAVEMENT APPROX. 4.0"
Y1	PROP. APPROX. 0 - 1.5" OF INCIDENTAL MILLING

General Notes:

- * Pavement edge slopes are 1:1 unless specified otherwise.
- * Mill bridge approaches 100' to provide a smooth transition or as directed by the Engineer.

2009 - 2010
 Resurfacing Program
 Typical Sections
 Lincoln County NC

**Stations increase to the N & E

Checked by:

Drawn by G. Brittain

PROJECT NO. 12CR.10551.7 & 12CR.20551.9	SHEET NO. 14	TOTAL NO. 15
---	-----------------	-----------------

SUMMARY OF QUANTITIES

PROJECT NO	COUNTY	MAP NO	ROUTE	DESCRIPTION	TYP NO	FINAL SURFACE TESTING REQUIRED	LENGTH MI	WIDTH FT	INCIDENTAL STONE BASE TONS	SHOULDER RECONSTRUCTION SMI	4" MILLING SY	1.5" TO 3" MILLING SY	INCIDENTAL MILLING SY	INTER-MEDIATE COURSE, 119.0B TONS	SURFACE COURSE, S9.5B TONS	LEVELING COURSE, S9.5B TONS	PG 64-22 PLANT MIX TONS	PATCHING EXISTING PAVEMENT TONS	ADJUST CATCH BASIN EA	ADJUST MANHOLES EA	ADJUST METER OR VALVE BOX EA	PORTABLE LIGHTING LS
12CR.10551.7	Lincoln	1	NC 73	FROM SR 2040 TO MECKLENBURG CO. LINE	1	NO	2.54	VAR.S.24-36	60	5.08			300		3,784	350	250	350		2	7	
12CR.10551.7	Lincoln	2	NC 182	FROM NC 274 TO SR 1002	1	NO	3.60	24	50	7.2			533		4,708	600	321	470				
12CR.10551.7	Lincoln	3	NC 73	FROM NC 27 TO SR 1816	1,6	NO	1.00	24	20	2	1,350			275	1,314	120	100	120				
12CR.10551.7	Lincoln	4	NC 16	FROM SR 1439 N. TO SR 1379	1,7	NO	2.92	VAR.S.24-36	60	5.84		1,100			4,545	450	302	450	1	4	14	1
TOTAL FOR PROJ NO. 12CR.10551.7							10.06		190	20.12	1,350	1,100	833	275	14,351	1,520	973	1,390	1	6	21	1
12CR.20551.9	Lincoln	5	SR 1008 (REEPSVILLE RD.)	FROM SR 1005 TO SR 1113	1	NO	2.86	20	50	5.72			450		3,120	400	213	300				
12CR.20551.9	Lincoln	6	SR 1405 (N. ASPEN ST.)	FROM BATTLE GROUND ST. N. TO US-321 Bus.	1,2,3,4,5	NO	1.20	VAR.S. 20-44	20	1.26		14,900	650		3,028	300	201	400		14	14	
12CR.20551.9	Lincoln	7	SR 1169 (CROUSE RD)	FROM NC 150 TO SR 1002	1	NO	2.13	20	40	4.26			450		2,324	300	159	250				
12CR.20551.9	Lincoln	8	SR 1333 (WALKER BRANCH RD)	FROM SR 1282 FROM SR 1267	1	NO	1.12	18	40	2.24					1,100	160	76	200		1	2	
12CR.20551.9	Lincoln	9	SR 1771 (FOREST HILLS DR)	FROM NC 16 TO CUL-DE-SAC	1	NO	0.45	20	20	0.9					532	50	35	80				
12CR.20551.9	Lincoln	10	SR 1839 (FOREST MANOR DR)	FROM SR 1771 TO SR 1870	1	NO	0.38	18	20	0.76					373	20	24	40				
12CR.20551.9	Lincoln	11	SR 1870 (HIDDENBROOK DR)	FROM CUL-DE-SAC TO CUL-DE-SAC	1	NO	0.07	18		0.14					69	10	5	10				
12CR.20551.9	Lincoln	12	SR 1841 (WINDROCK DR)	FROM SR 1839 TO CUL-DE-SAC	1	NO	0.55	18		1.1					540	40	35	60				
12CR.20551.9	Lincoln	13	SR 1840 (OAKSTONE DR)	FROM SR 1839 TO CUL-DE-SAC	1	NO	0.09	18		0.18					88	10	6	10				
12CR.20551.9	Lincoln	14	SR 1942 (TEAL DR)	FROM SR 1839 TO CUL-DE-SAC	1	NO	0.18	18		0.36					177	10	11	20				
12CR.20551.9	Lincoln	15	SR1943 (FOREST CRK DR)	FROM SR 1942 TO CUL-DE-SAC	1	NO	0.25	18		0.5					246	10	15	20				
12CR.20551.9	Lincoln	16	SR 1944 (DRAKE CT)	FROM SR 1943 TO CUL-DE-SAC	1	NO	0.11	18		0.22					108	10	7	20				
12CR.20551.9	Lincoln	17	SR 1945 (HUNTINGTON CT)	FROM SR 1943 TO CUL-DE-SAC	1	NO	0.06	18		0.12					59	10	4	10				
12CR.20551.9	Lincoln	18	SR 1412 (MARIPOSA RD)	FROM SR 1511 TO GASTON CO. LINE	1	NO	2.02	20	40	4.04			450		2,204	220	147	300				
12CR.20551.9	Lincoln	19	SR1238 (LABORATORY RD)	FROM NC 150 TO SR 1406	1	NO	0.83	19	20	1.66					878	120	61	150				
12CR.20551.9	Lincoln	20	SR 1365 (HUNTER RHYNE RD)	FROM SR 1355 TO SR 1362	1	NO	1.12	20	20	2.24					1,166	120	78	180				
12CR.20551.9	Lincoln	21	SR 1404 (MT ZION CH RD)	FROM SR 1511 TO BRDG. # 156 OVER LEEPERS CRK.	1	NO	2.28	18	40	4.56			500		2,240	220	149	300				
TOTAL FOR PROJ NO. 12CR.20551.9							15.7		310	30.26	0	14,900	2,500	0	18,252	2,010	1,226	2,350		15	16	
GRAND TOTAL							25.76		500	50.38	1,350	16,000	3,333	275	32,603	3,530	2,199	3,740	1	21	37	1

PROJECT NO.	SHEET NO.	TOTAL NO.
12CR10551.7 & 12CR.20551.9	15	15

THERMOPLASTIC AND PAINT QUANTITIES

PROJECT NO	COUNTY	MAP NO	ROUTE	DESCRIPTION	4685000000-E	4686000000-E			4697000000-E	4705000000-E	4710000000-E	4721000000-E		4725000000-E				4810000000-E		4905000000-N
					4" X 90 M WHITE THERMO LF	4" X 120 M YELLOW THERMO LF	4" X 120 M WHITE THERMO LF	8" X 120 M WHITE THERMO LF	16" X 120 M WHITE THERMO LF	24" X 120 M WHITE THERMO LF	THERMO RXR 120 M EA	THERMO MSG SCHOOL 120 M EA	THERMO LT ARROW 90 M EA	THERMO RT ARROW 90 M EA	THERMO STR & RT ARROW 90 M EA	THERMO STR & LT ARROW 90 M EA	4" WHITE PAINT LF	4" YELLOW PAINT LF	SNOW PLOWABLE MARKERS EA	
12CR.10551.7	Lincoln	1	NC 73	FROM SR 2040 TO MECKLENBURG CO. LINE	26,800	29,600	1,500		100	200	4		25	6					250	
12CR.10551.7	Lincoln	2	NC 182	FROM NC 274 TO SR 1002														75,500	75,500	250
12CR.10551.7	Lincoln	3	NC 73	FROM NC 27 TO SR 1816	10,560	10,560														70
12CR.10551.7	Lincoln	4	NC 16	FROM SR 1439 N. TO SR 1379	30,750	35,150	4,000			350		12	40	10	5	2				440
TOTAL FOR PROJ NO. 12CR.10551.7					68,110	75,310	5,500		100	550	4	12	65	16	5	2		75,500	75,500	1,010
						80,810						16		88				151,000		
12CR.20551.9	Lincoln	5	SR 1008 (REEPSVILLE RD.)	FROM SR 1005 TO SR 1113														60,250	60,250	
12CR.20551.9	Lincoln	6	SR 1405 (N. ASPEN ST.)	FROM BATTLE GROUND ST. N. to US-321 Bus.				200		200		12	22					13,500	36,500	200
12CR.20551.9	Lincoln	7	SR 1169 (CROUSE RD)	FROM NC 150 TO SR 1002														45,100	45,100	
12CR.20551.9	Lincoln	8	SR 1333 (WALKER BRANCH RD)	FROM SR 1282 FROM SR 1267														23,250	23,250	
12CR.20551.9	Lincoln	9	SR 1771 (FOREST HILLS DR)	FROM NC 16 TO CUL-DE-SAC																
12CR.20551.9	Lincoln	10	SR 1839 (FOREST MANOR DR)	FROM SR 1771 TO SR 1870																
12CR.20551.9	Lincoln	11	SR 1870 (HIDDENBROOK DR)	FROM CUL-DE-SAC TO CUL-DE-SAC																
12CR.20551.9	Lincoln	12	SR 1841 (WINDROCK DR)	FROM SR 1839 TO CUL-DE-SAC																
12CR.20551.9	Lincoln	13	SR 1840 (OAKSTONE DR)	FROM SR 1839 TO CUL-DE-SAC																
12CR.20551.9	Lincoln	14	SR 1942 (TEAL DR)	FROM SR 1839 TO CUL-DE-SAC																
12CR.20551.9	Lincoln	15	SR1943 (FOREST CRK DR)	FROM SR 1942 TO CUL-DE-SAC																
12CR.20551.9	Lincoln	16	SR 1944 (DRAKE CT)	FROM SR 1943 TO CUL-DE-SAC																
12CR.20551.9	Lincoln	17	SR 1945 (HUNTINGTON CT)	FROM SR 1943 TO CUL-DE-SAC																
12CR.20551.9	Lincoln	18	SR 1412 (MARIPOSA RD)	FROM SR 1511 TO GASTON CO. LINE														42,600	42,600	
12CR.20551.9	Lincoln	19	SR1238 (LABORATORY RD)	FROM NC 150 TO SR 1406														17,750	17,750	
12CR.20551.9	Lincoln	20	SR 1365 (HUNTER RHYNE RD)	FROM SR 1355 TO SR 1362						50		6						23,650	23,650	
12CR.20551.9	Lincoln	21	SR 1404 (MT ZION CH RD)	FROM SR 1511 TO BRDG. # 156 OVER LEEPERS CRK.														48,250	48,250	
TOTAL FOR PROJ NO. 12CR.20551.9								200		250		18	22					274,350	297,350	200
											18		22				571,700			
GRAND TOTAL					68,110	75,310	5,500	200	100	800	4	30	87	16	5	2		349,850	372,850	1,210
						80,810						34		110				722,700		

TWO-WAY UNDIVIDED ** (L-LINES)

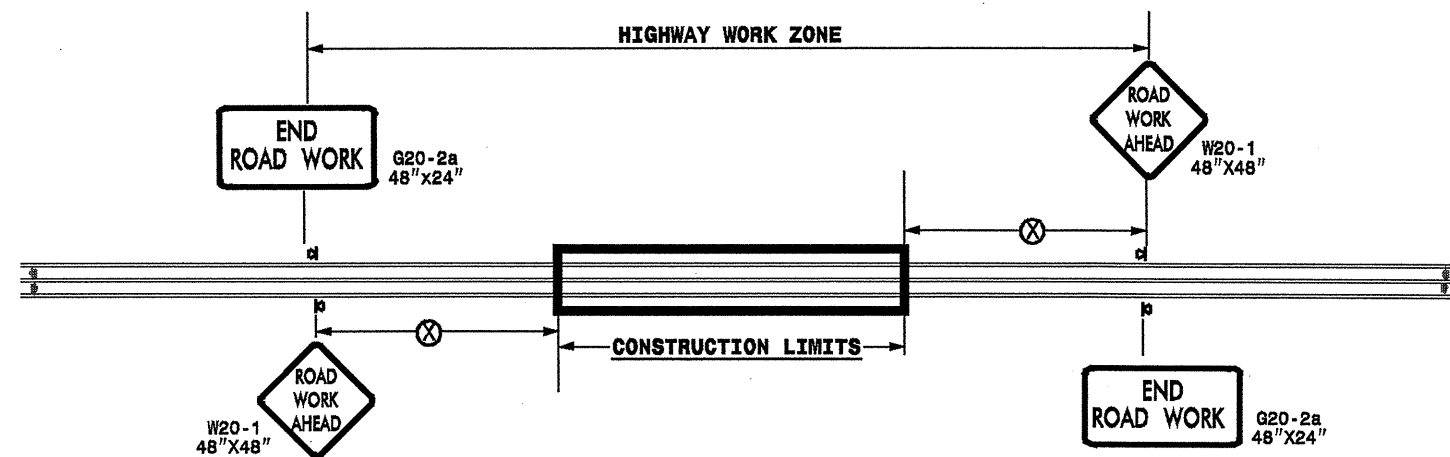

POSTED SPEED LIMIT (M.P.H.)	RECOMMENDED MINIMUM SIGN SPACING
≤ 50	500'
≥ 55	1000'

STATE OF NORTH CAROLINA
DEPT. OF TRANSPORTATION
DIVISION OF HIGHWAYS
RALEIGH, N.C.

ROADWAYS INTERSECTING ALONG 2 WAY UNDIVIDED WORK ZONE (Y-LINES)

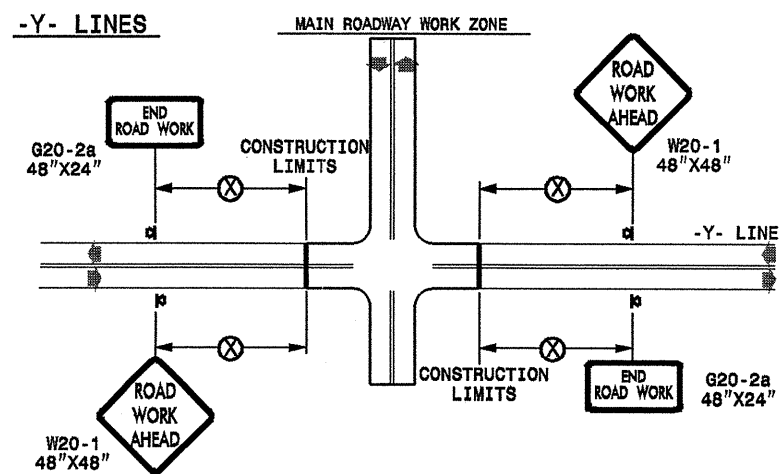

GENERAL NOTES

- USE FLUORESCENT ORANGE SHEETING (TYPE VII OR HIGHER) ON ALL ADVANCE WORK ZONE SIGNS.
- DO NOT INSTALL ADVANCE WARNING SIGNS MORE THAN 3 DAYS PRIOR TO BEGINNING OF WORK.
- ALL SIGN SPACING DIMENSIONS ARE APPROXIMATE, FIELD ADJUST AS NECESSARY OR AS DIRECTED.
- USE PORTABLE WORK ZONE SIGNS ONLY WITH PORTABLE WORK ZONE SIGN STANDS SPECIFICALLY DESIGNED FOR ONE ANOTHER. PORTABLE WORK ZONE SIGNS MAY BE ROLL UP OR APPROVED COMPOSITE.
- PROVIDE PORTABLE WORK ZONE SIGN STANDS, PORTABLE SIGNS AND SIGN SHEETING WHICH ARE LISTED ON THE NORTH CAROLINA DEPARTMENT OF TRANSPORTATION'S APPROVED PRODUCT LIST OR ACCEPTED AS TRAFFIC QUALIFIED BY THE TRAFFIC CONTROL UNIT.
- ** TWO-WAY UNDIVIDED ADVANCE WARNING SIGN CONFIGURATION MAY BE USED ON URBAN MULTI-LANE FACILITIES WHERE CONDITIONS LIMIT THE USE OF DUAL MOUNTED SIGNS AS DETERMINED BY THE ENGINEER.

LEGEND

◀ PORTABLE SIGN

➡ DIRECTION OF TRAFFIC FLOW

DETAIL DRAWING
FOR TWO-WAY UNDIVIDED
WORK ZONE WARNING SIGNS

SHEET 1 OF 1

APPROVED: _____ DATE: _____	DETAIL DRAWING FOR TWO-WAY UNDIVIDED ADVANCED WORK ZONE WARNING SIGNS	
SEAL		
SCALE: NONE		REVISIONS
DATE: _____		7-98 10/01
DWG. BY: _____		10-98 03/04
DESIGN BY: _____		01/01 11/04
REVIEWED BY: _____	CHD RLE	

23-OCT-2009 15:23
 499f90_030509\resur facing2009\div2\c202497a-b\2cr10551x2.lincoln.nc73m2\c202497a-b\2cr10551x2.2woyundivurbfrwysjuly2006.portable.dgn
 pssymors AT WZUC21602