

09/08/99

T.I.P. NO.	SHEET NO.
U-3309A	UC-1

TIP PROJECT: U-3309A

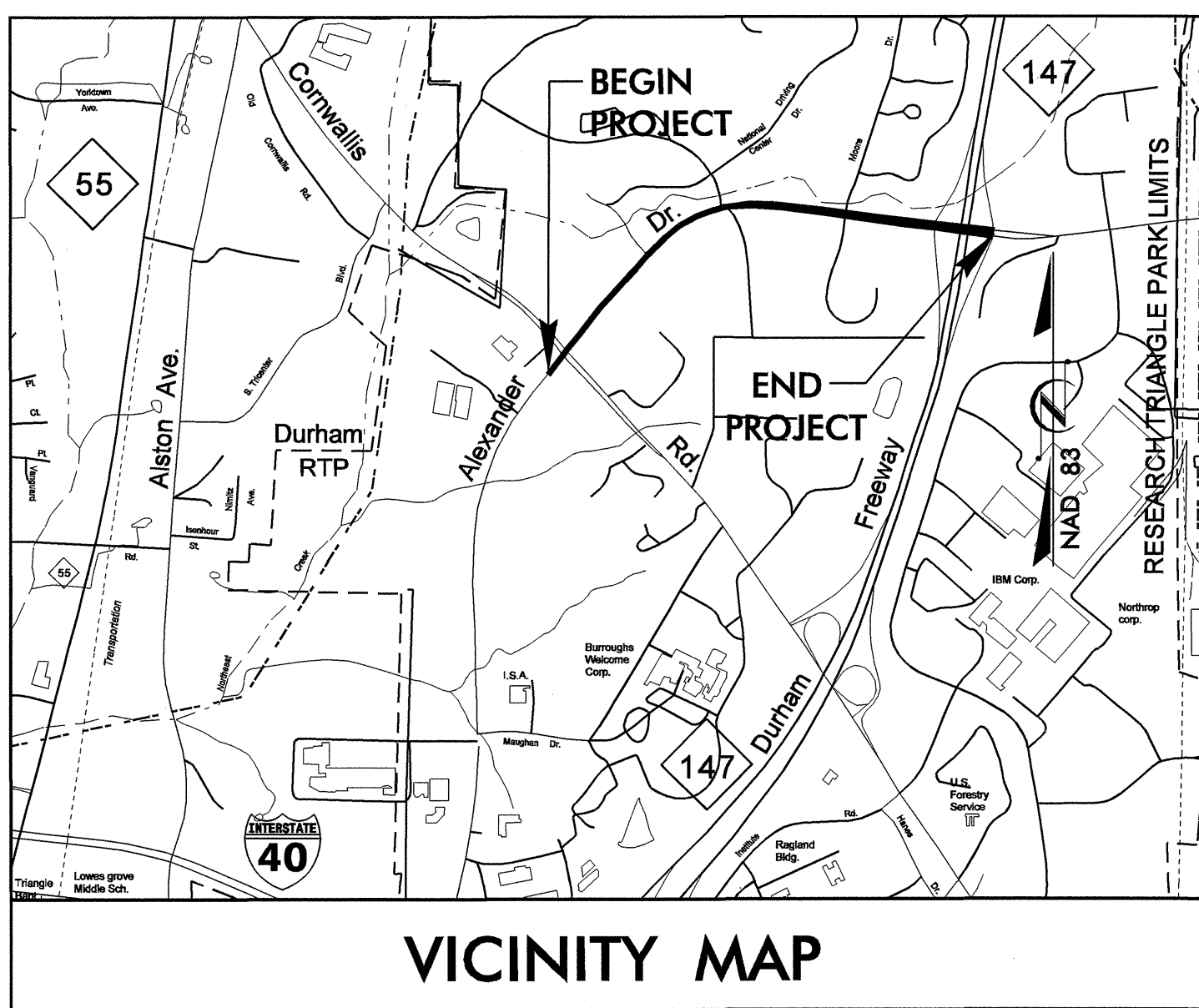

STATE OF NORTH CAROLINA  
DIVISION OF HIGHWAYS

UTILITY CONSTRUCTION PLANS  
DURHAM COUNTY

LOCATION: SR 2080 (T.W. ALEXANDER DRIVE)

TYPE OF WORK: WATER AND SEWER LINES  
RELOCATION

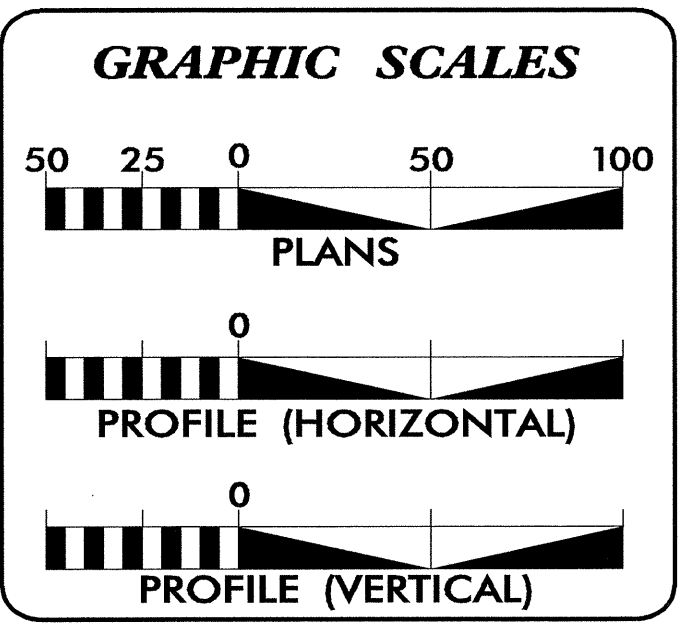
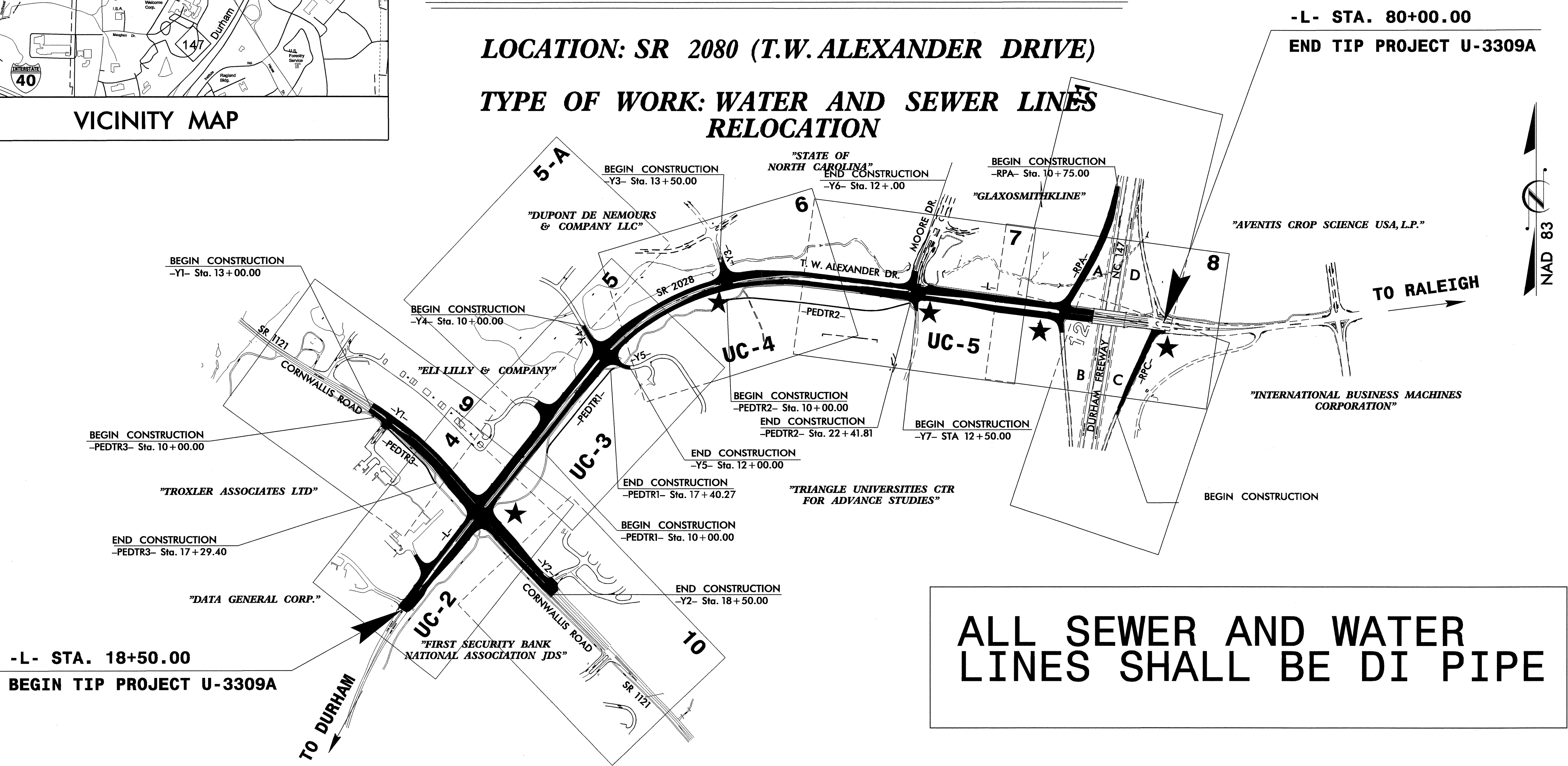

INDEX OF SHEETS

SHEET NO.	DESCRIPTION
UC-1	TITLE SHEET
UC-2 THRU UC-5	UTILITY CONSTRUCTION PLAN SHEETS
UC-6	DETAILS SHEET

WATER AND SEWER OWNERS ON PROJECT

(1) WATER: CITY OF DURHAM
(2) SANITARY SEWER: DURHAM COUNTY

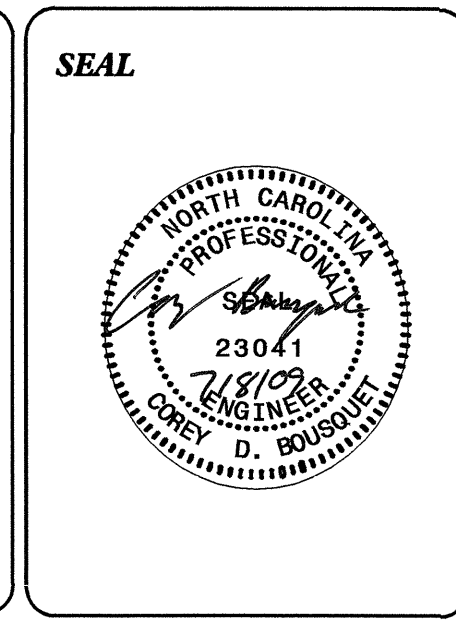

PREPARED IN THE OFFICE OF:  
DIVISION OF HIGHWAYS  
UTILITIES ENGINEERING SECTION

1591 MAIL SERVICES CENTER  
RALEIGH NC 27699-1591  
PHONE (919) 250-4128  
FAX (919) 250-4119

Roger Worthington, P.E. UTILITIES SECTION ENGINEER  
Corey Bousquet, P.E. UTILITIES SQUAD LEADER PROJECT ENGINEER  
Kifah Kamil UTILITIES PROJECT DESIGNER

06-JUL-2009 16:05 C:\UTILITIES\proj\U3309a\_ut\_ucl.tsh.dgn

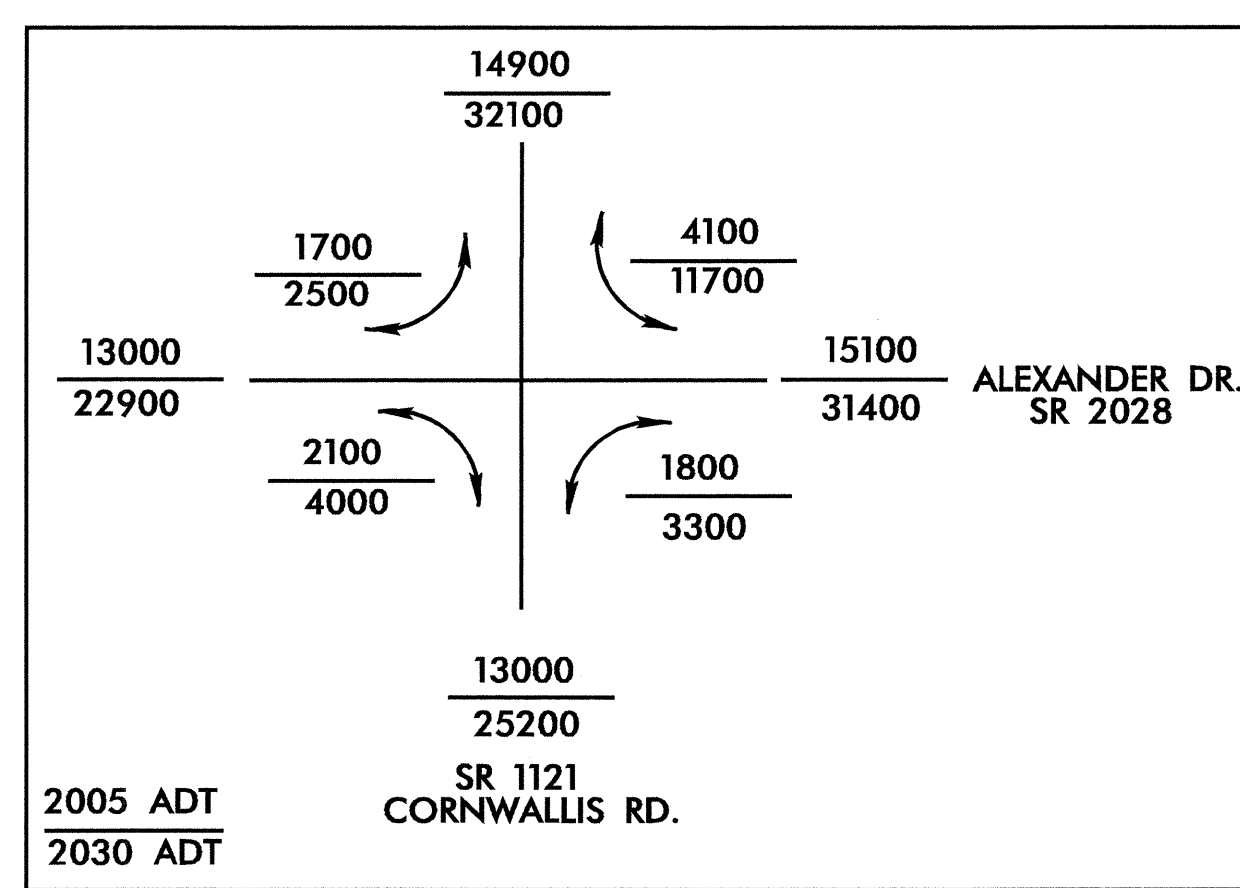
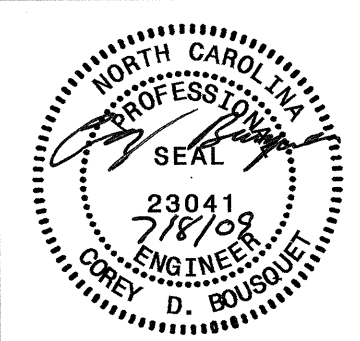

**UTILITY CONSTRUCTION**

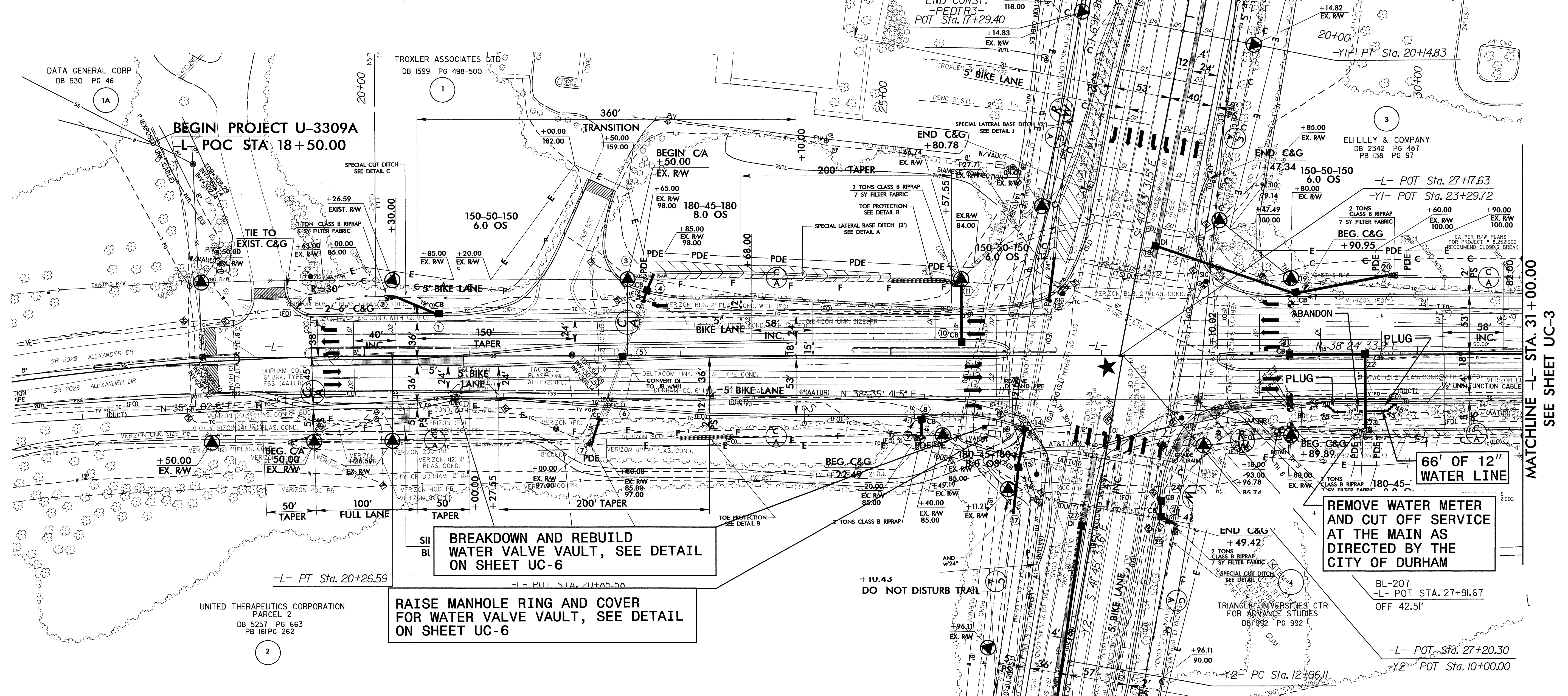

-L-	-Y1-	-Y2-	-PEDTR3-
PI Sta 15+19.71	PI Sta 14+92.16	PI Sta 16+27.28	PI Sta 14+68.20
$\Delta = 22^\circ 01' 47.0''$ (RT)	$\Delta = 1^\circ 52' 19.2''$ (LT)	$\Delta = 17^\circ 33' 15.3''$ (RT)	$\Delta = 16^\circ 12' 45.4''$ (LT)
$D = 2^\circ 08' 45.3''$	$D = 0^\circ 28' 38.9''$	$D = 2^\circ 14' 48.8''$	$D = 38^\circ 11' 49.9''$
$L = 1,026.59'$	$L = 392.07'$	$L = 781.27'$	$L = 42.44'$
$T = 519.71'$	$T = 196.05'$	$T = 393.72'$	$T = 21.37'$
$R = 2,670.00'$	$R = 12,000.00'$	$R = 2,550.00'$	$R = 150.00'$
SE = Exlst.	SE = 06	SE = Exlst.	
	$V_0 = 60$ MPH		

NOTE: RECONNECT ALL PEDESTRIAN TRAILS AND SIDEWALKS BACK TO INTERSECTIONS.  
 ★ UPGRADE EXISTING TRAFFIC SIGNAL  
 PROP. 5" MONOLITHIC CONCRETE ISLAND  
 FOR -L- PROFILE, SEE SHEET NO. 13  
 FOR -Y1- PROFILE, SEE SHEET NO. 16  
 FOR -Y2- PROFILE, SEE SHEET NO. 17

REVISIONS

MATCHLINE -L- STA. 31+00.00  
 SEE SHEET UC-3

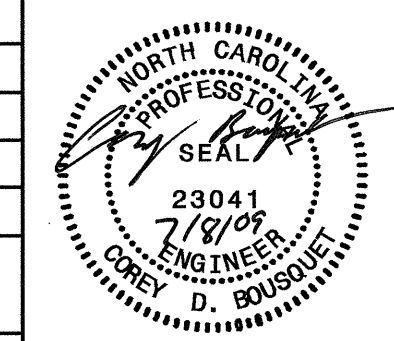

**UTILITY CONSTRUCTION**

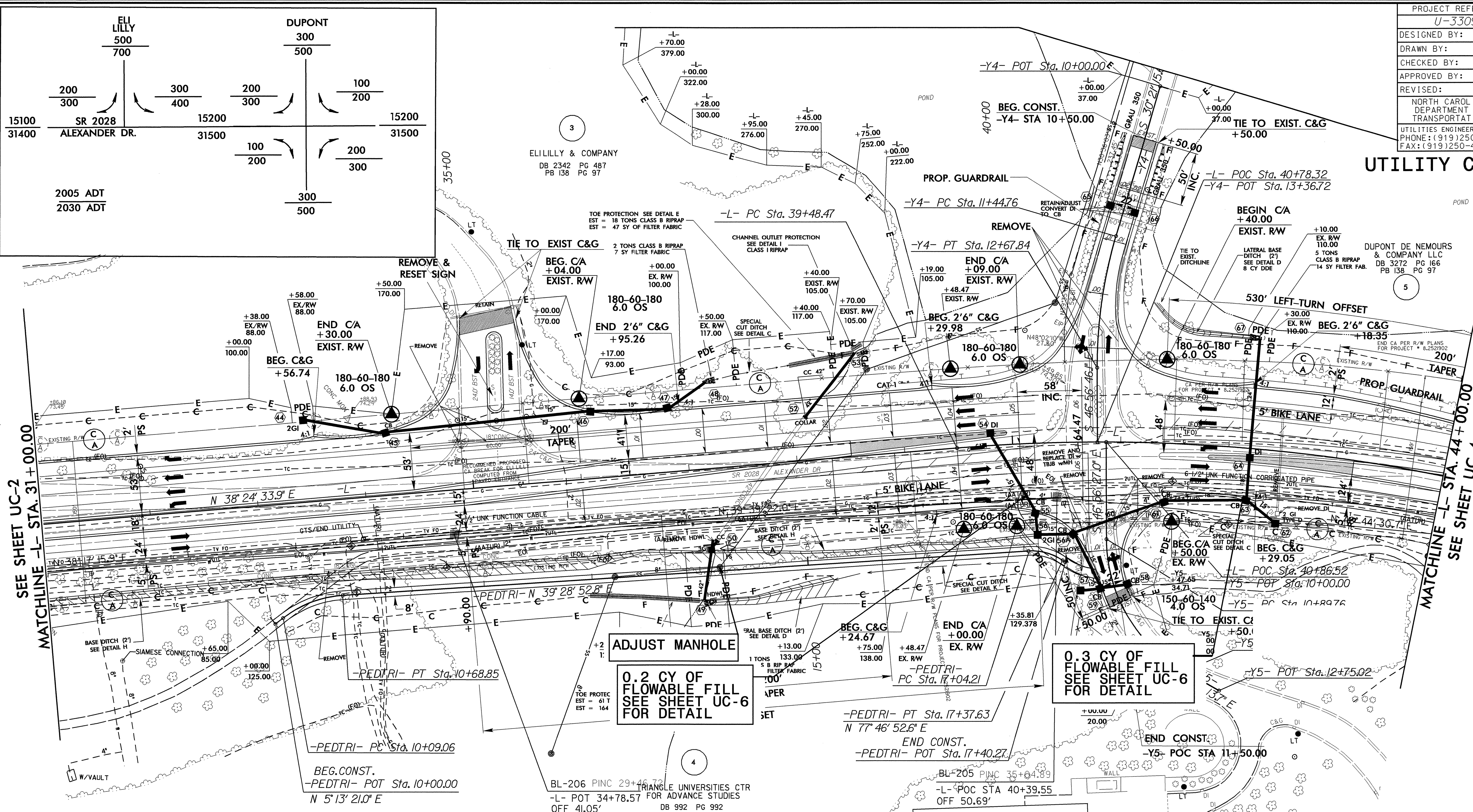

SEE SHEET UC-2  
MATCHLINE -L- STA. 31+00.00

MATCHLINE -L- STA. 44+00.00  
SEE SHEET UC-4

ADJUST MANHOLE  
0.2 CY OF FLOWABLE FILL  
SEE SHEET UC-6  
FOR DETAIL

0.3 CY OF FLOWABLE FILL  
SEE SHEET UC-6  
FOR DETAIL

MANHOLES SHOWN ON THE PLANS  
TO BE ADJUSTED WILL BE PAID  
FOR AS MASONRY DRAINAGE  
STRUCTURES

-L-	-PEDTRI-		-Y4-	-Y5-
PI Sta 48+52.84	PI Sta 10+39.88	PI Sta 17+21.57	PI Sta 12+06.73	PI Sta 11+72.12
$\Delta = 58^{\circ} 57' 11.0''$ (RT)	$\Delta = 34^{\circ} 15' 31.9''$ (RT)	$\Delta = 38^{\circ} 17' 59.8''$ (RT)	$\Delta = 16^{\circ} 35' 34.3''$ (LT)	$\Delta = 60^{\circ} 56' 19.3''$ (LT)
D = 3' 34' 51.6"	D = 57' 17' 44.8"	D = 114' 35' 29.6"	D = 13' 28' 52.9"	D = 40' 55' 32.0"
L = 1,646.28'	L = 59.79'	L = 33.42'	L = 123.08'	L = 148.90'
T = 904.37'	T = 30.82'	T = 17.36'	T = 61.97'	T = 82.37'
R = 1,600.00'	R = 100.00'	R = 50.00'	R = 425.00'	R = 140.00'
SE = 06			SE = EXIST.	SE = EXIST.
V <sub>6</sub> = 60 MPH				

NOTE: RECONNECT ALL PEDESTRIAN TRAILS AND SIDEWALKS BACK TO INTERSECTIONS.

PROP. 5" MONOLITHIC CONCRETE ISLAND  
 FOR -L- PROFILE, SEE SHEET NO. 13  
 FOR -Y4- PROFILE, SEE SHEET NO. 18  
 FOR -Y5- PROFILE, SEE SHEET NO. 18

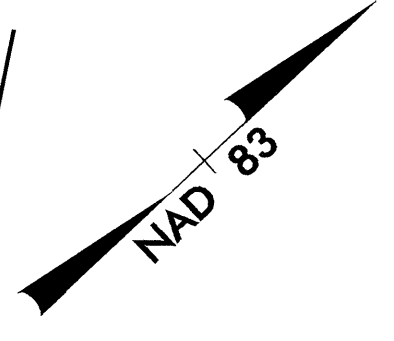

REVISIONS

06/24/11/2009 09:46:06 \\u3309a\_ut\_uc3\_psh05.dgn



06-JUL-2009 16:08 \\u33309a\_ut\_uc5\_psh07.dgn

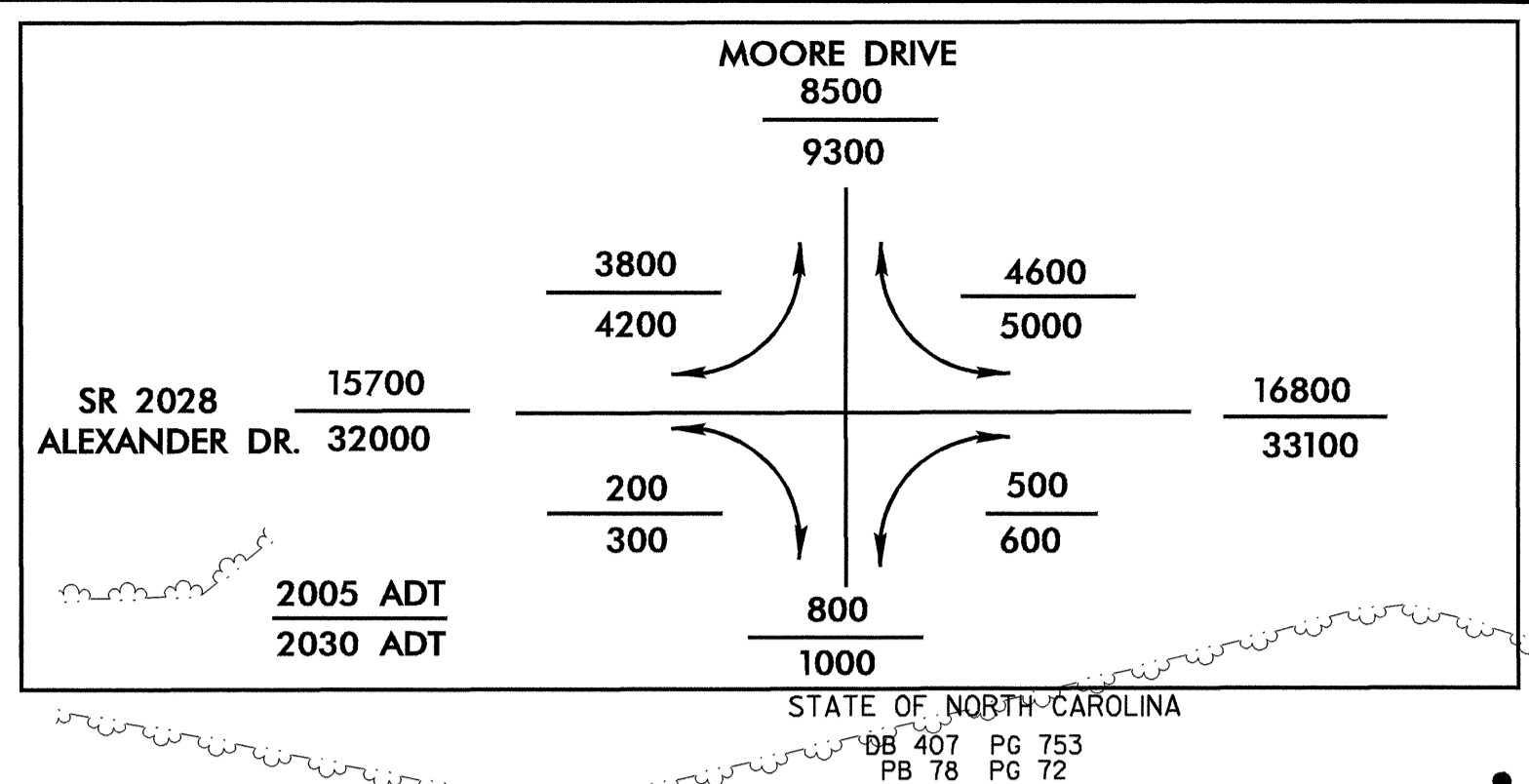

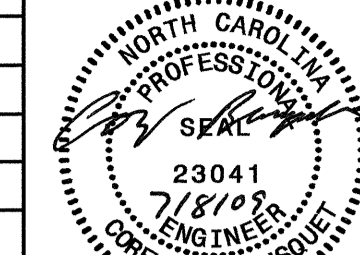
PROJECT REFERENCE NO. U-3309A	SHEET NO. UC-5
DESIGNED BY: KAK	
DRAWN BY: KAK	
CHECKED BY: CDB	
APPROVED BY: CDB	
NORTH CAROLINA DEPARTMENT OF TRANSPORTATION UTILITIES ENGINEERING SEC. PHONE: (919)250-4128 FAX: (919)250-4119	
UTILITY CONSTRUCTION PLANS ONLY	

**UTILITY CONSTRUCTION**

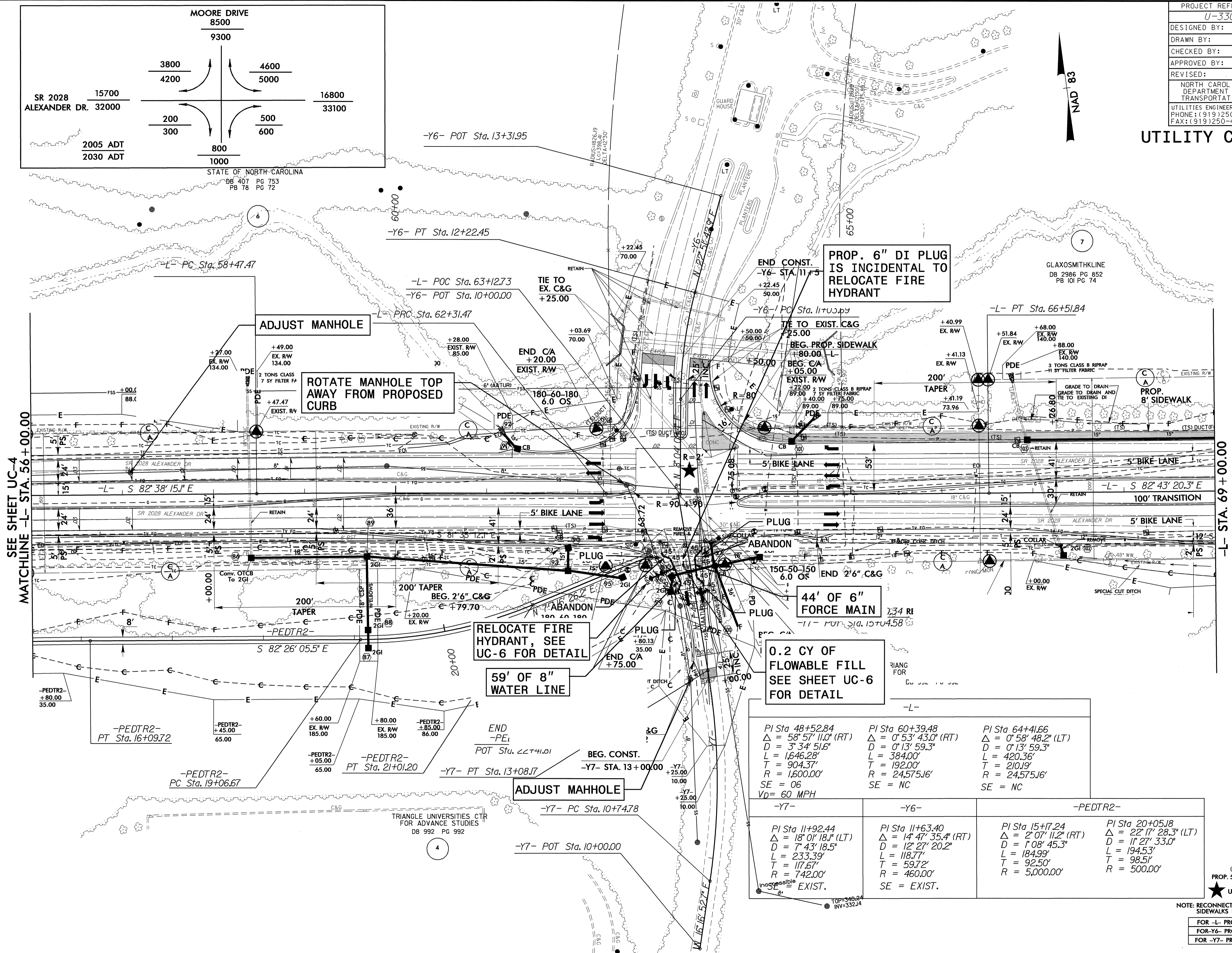

SEE SHEET UC-4  
MATCHLINE -L- STA. 56+00.00

-L- STA. 69+00.00

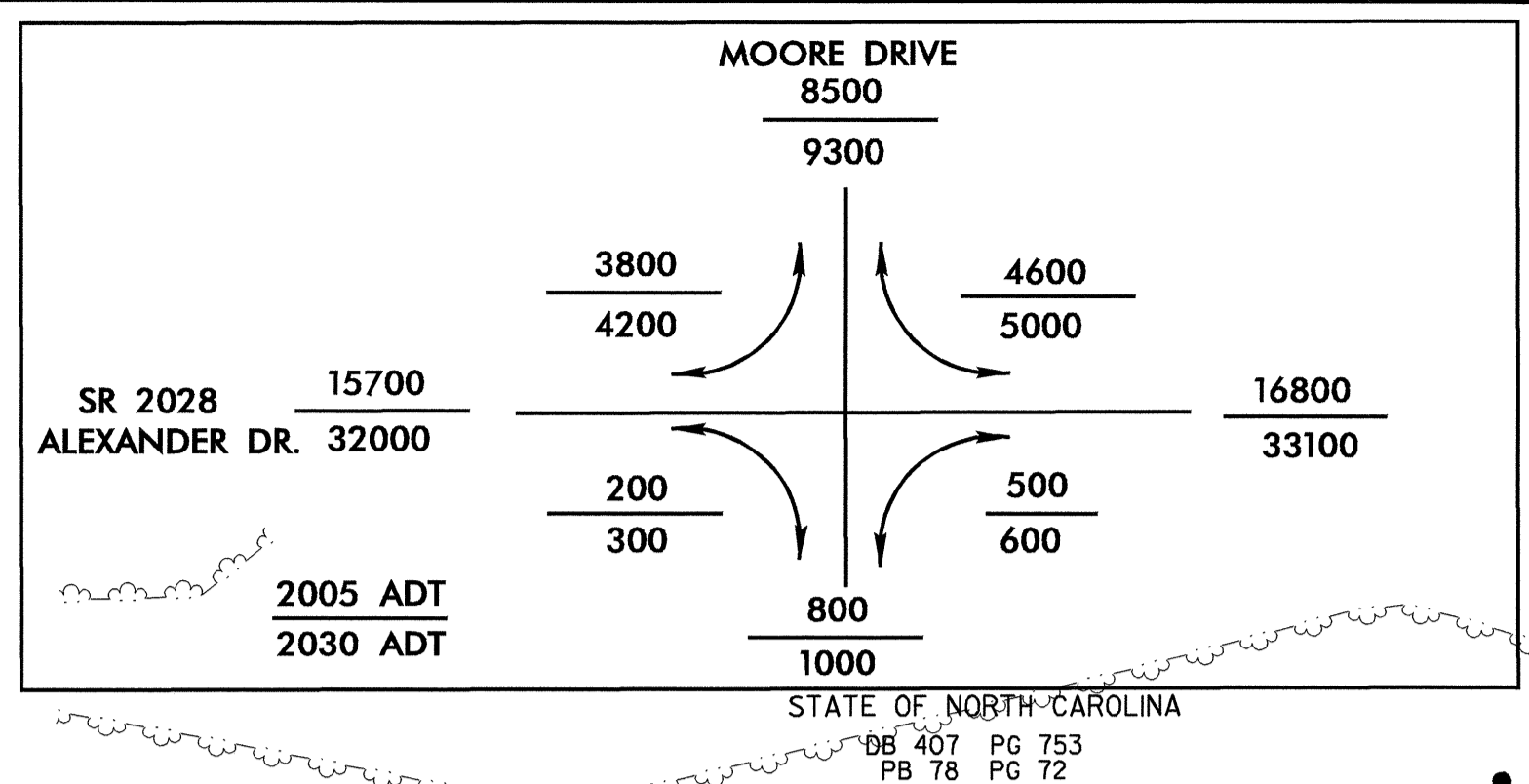

STATE OF NORTH CAROLINA  
DB 407 PG 753  
PB 78 PG 72



**PROP. 6" DI PLUG IS INCIDENTAL TO RELOCATE FIRE HYDRANT**

**ROTATE MANHOLE TOP AWAY FROM PROPOSED CURB**

**RELOCATE FIRE HYDRANT, SEE UC-6 FOR DETAIL**

**59' OF 8" WATER LINE**

**44' OF 6" FORCE MAIN**

**0.2 CY OF FLOWABLE FILL SEE SHEET UC-6 FOR DETAIL**

PI Sta 48+52.84 $\Delta = 58^{\circ}57'11.0"$ (RT) $D = 3^{\circ}34'51.6"$ $L = 1646.28'$ $T = 904.37'$ $R = 1600.00'$ $SE = 06$ $VD = 60$ MPH	PI Sta 60+39.48 $\Delta = 0^{\circ}53'43.0"$ (RT) $D = 0^{\circ}13'59.3"$ $L = 384.00'$ $T = 192.00'$ $R = 24575.16'$ $SE = NC$	PI Sta 64+41.66 $\Delta = 0^{\circ}58'48.2"$ (LT) $D = 0^{\circ}13'59.3"$ $L = 420.36'$ $T = 210.19'$ $R = 24575.16'$ $SE = NC$
---	---	---

-Y7-	-Y6-	-PEDTR2-	
PI Sta 11+92.44 $\Delta = 18^{\circ}01'18.1"$ (LT) $D = 7^{\circ}43'18.5"$ $L = 233.39'$ $T = 117.67'$ $R = 742.00'$ INACCESSIBLE EXIST.	PI Sta 11+63.40 $\Delta = 14^{\circ}47'35.4"$ (RT) $D = 12^{\circ}27'20.2"$ $L = 118.77'$ $T = 59.72'$ $R = 460.00'$ $SE = EXIST.$	PI Sta 15+7.24 $\Delta = 2^{\circ}07'11.2"$ (RT) $D = 1^{\circ}08'45.3"$ $L = 184.99'$ $T = 92.50'$ $R = 5000.00'$	PI Sta 20+05.18 $\Delta = 22^{\circ}17'28.3"$ (LT) $D = 11^{\circ}27'33.0"$ $L = 194.53'$ $T = 98.50'$ $R = 5000.00'$

PROP. 5" MONOLITHIC CONCRETE ISLAND  
★ UPGRADE EXISTING TRAFFIC SIGNAL

NOTE: RECONNECT ALL PEDESTRIAN TRAILS AND SIDEWALKS BACK TO INTERSECTIONS.

FOR -L- PROFILE, SEE SHEET NO. 14
FOR -Y6- PROFILE, SEE SHEET NO. 19
FOR -Y7- PROFILE, SEE SHEET NO. 19

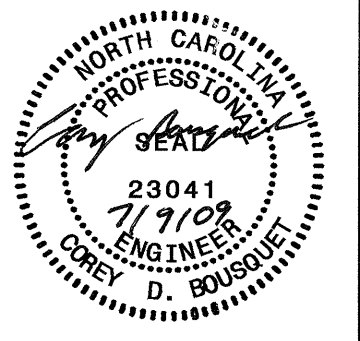

**UTILITY CONSTRUCTION**

- GENERAL NOTES:**
- PUMPER NOZZLE SHALL BE PERPENDICULAR TO ROADWAY.
  - SWIVEL (LOCKED JOINTS) FITTINGS MAY BE USED IN LIEU OF 3/4" RESTRAINING RODS.
  - ALL CONCRETE SHALL BE CLASS "B".
  - HYDRANT BRANCH LINE SHALL HAVE THE SAME COVER AS THE MAIN (36" BRANCH).

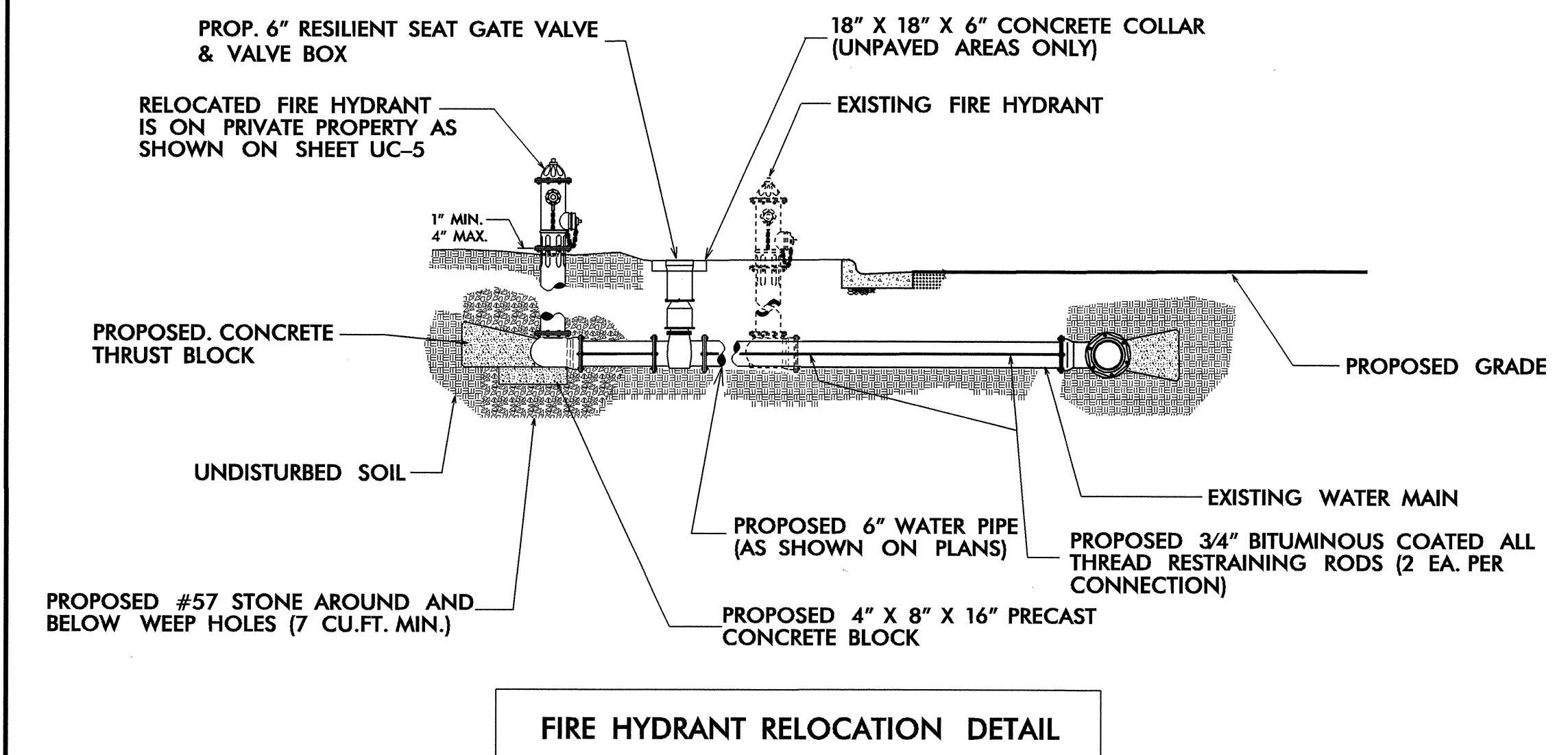

**FIRE HYDRANT RELOCATION DETAIL**

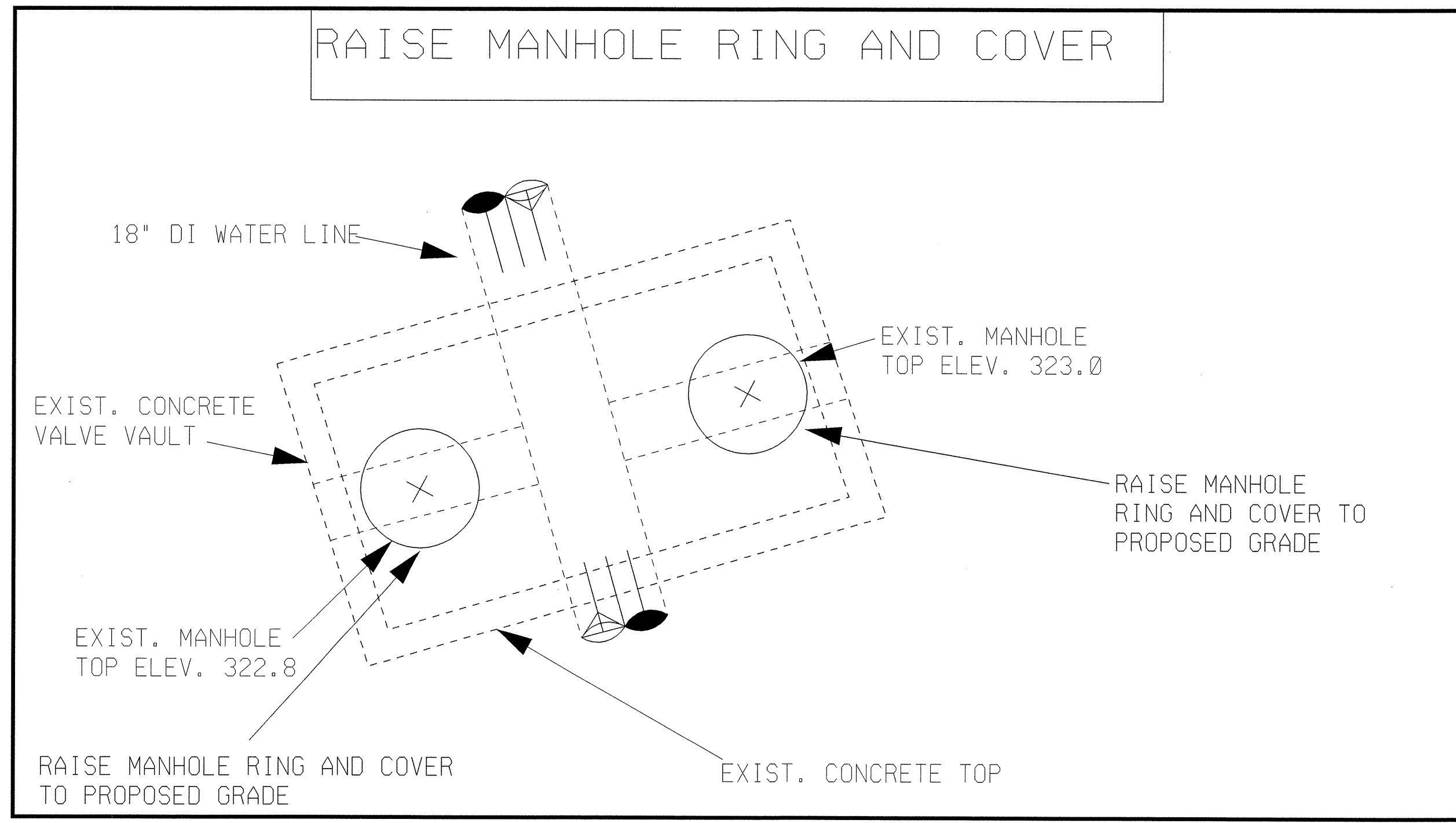
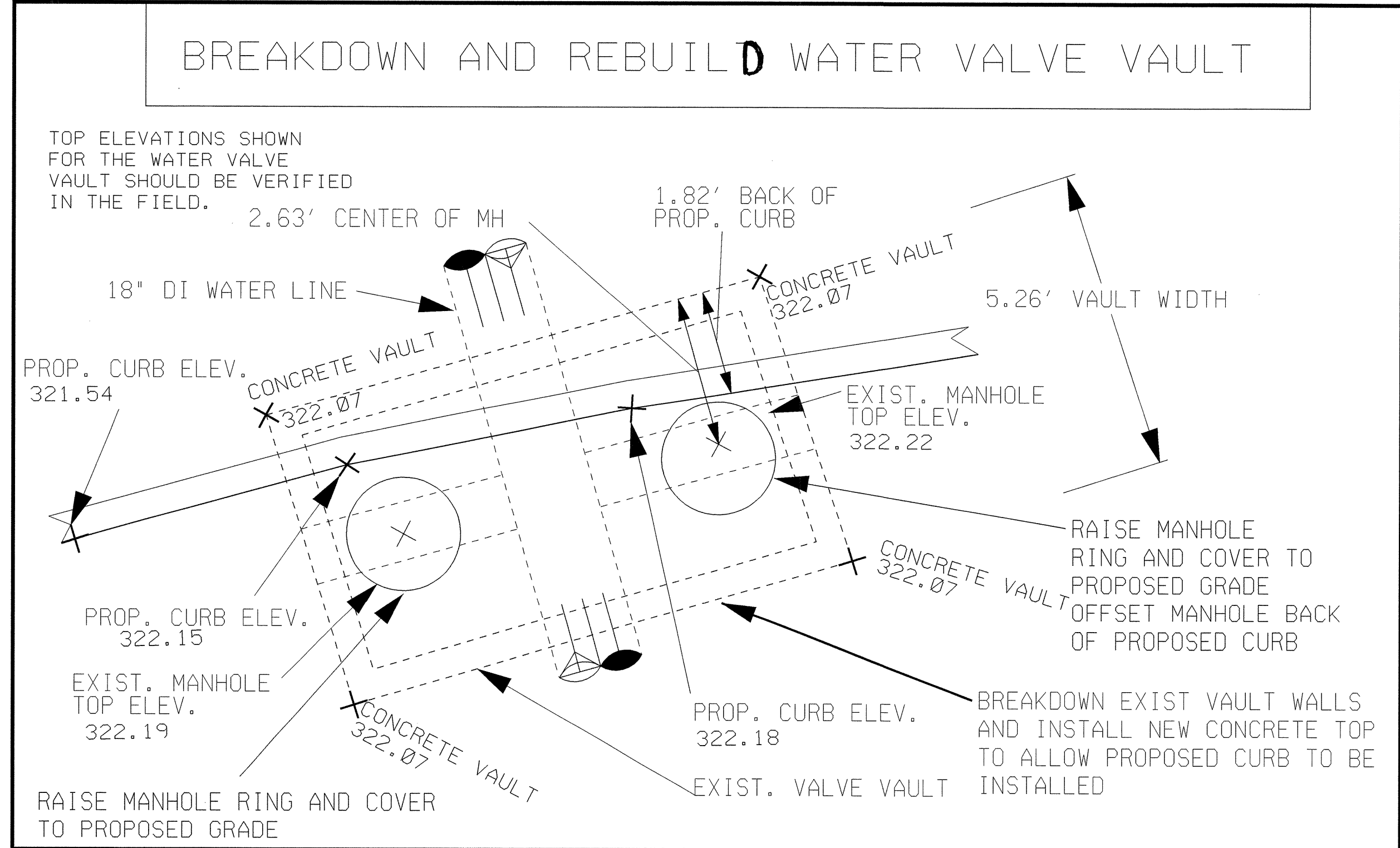
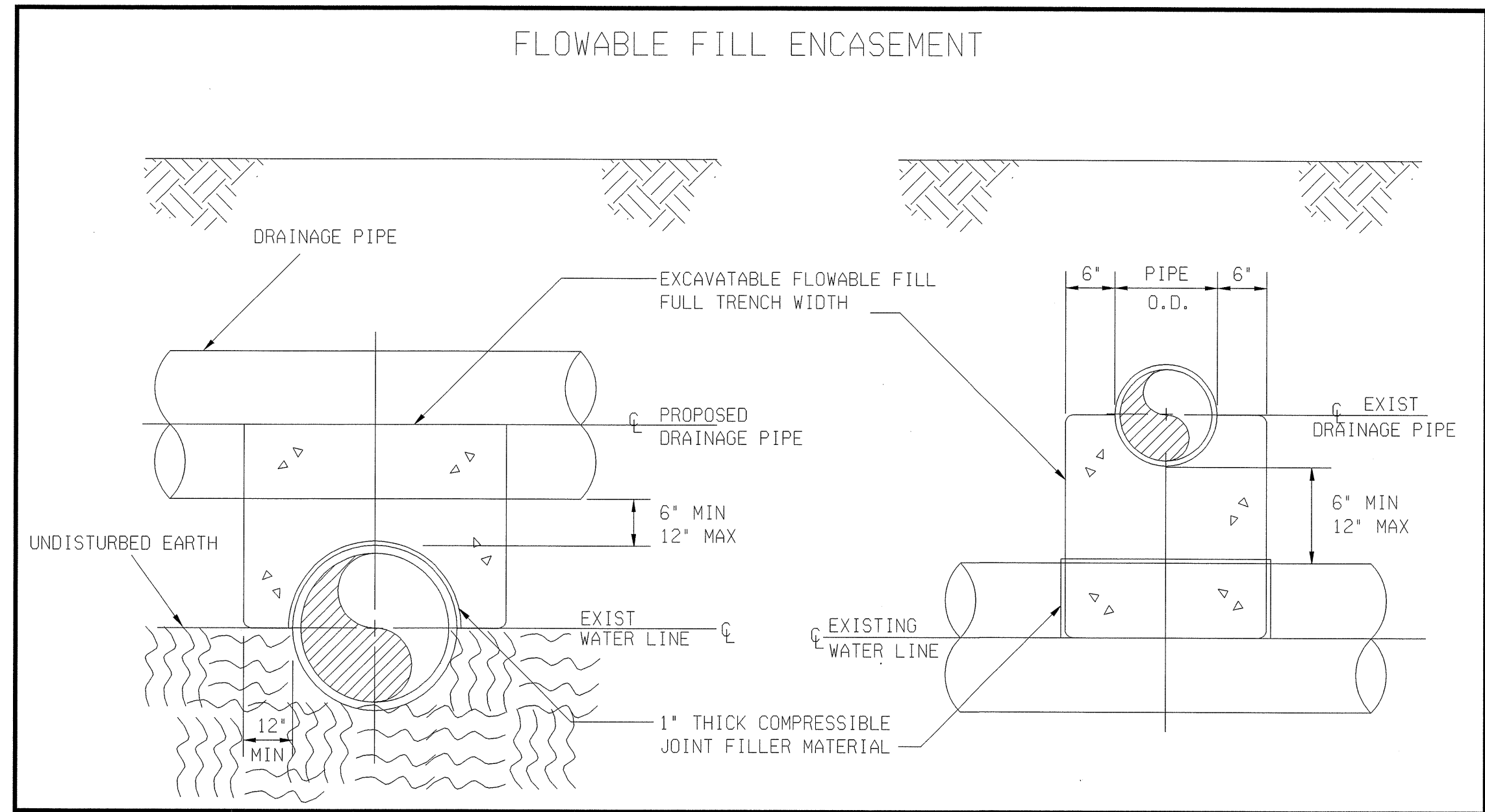

**MAXIMUM TRENCH WIDTH AT TOP OF PIPE**

NOMINAL PIPE SIZE (INCHES)	TRENCH WIDTH (INCHES)	NOMINAL PIPE SIZE (INCHES)	TRENCH WIDTH (INCHES)
4	28	20	44
6	30	24	48
8	32	30	54
10	34	36	60
12	36	42	66
14	38	48	72
16	40	54	78
18	42		

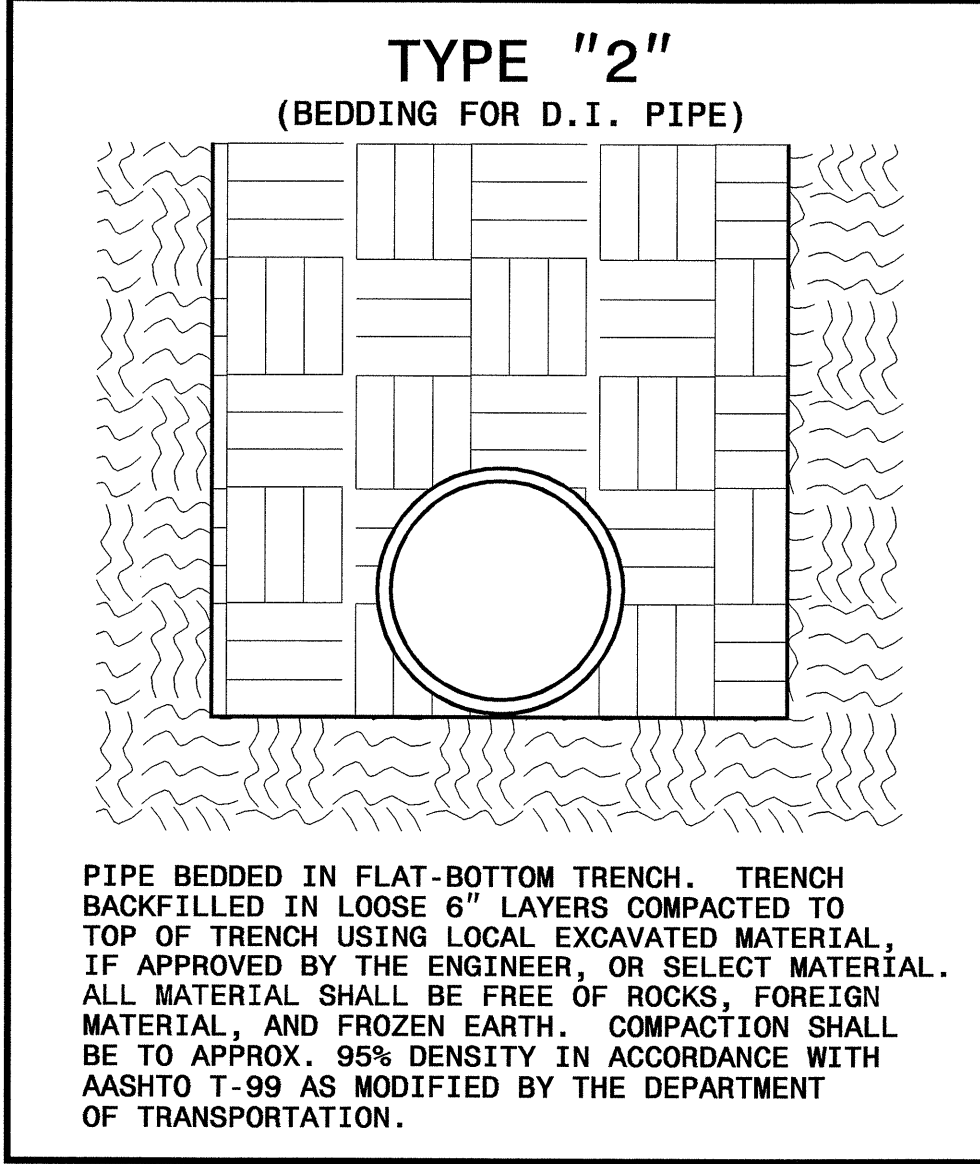

16-JUN-2009 10:26  
 \\h1t16a\cy\ut\proj\U3309a\_ut\_uo1\_tsh.dgn  
 \$\$\$USERNAME\$\$\$

T.I.P. NO.	SHEET NO.
U-3309A	UO-1

STATE OF NORTH CAROLINA  
 DIVISION OF HIGHWAYS

**UTILITIES BY OTHERS PLANS  
 DURHAM COUNTY**

LOCATION: SR 2028 (T.W. ALEXANDER DRIVE)  
 FROM SR 1121 TO EAST OF NC 17  
 TYPE OF WORK: RELOCATE UTILITY LINES

TIP PROJECT: U-3309A

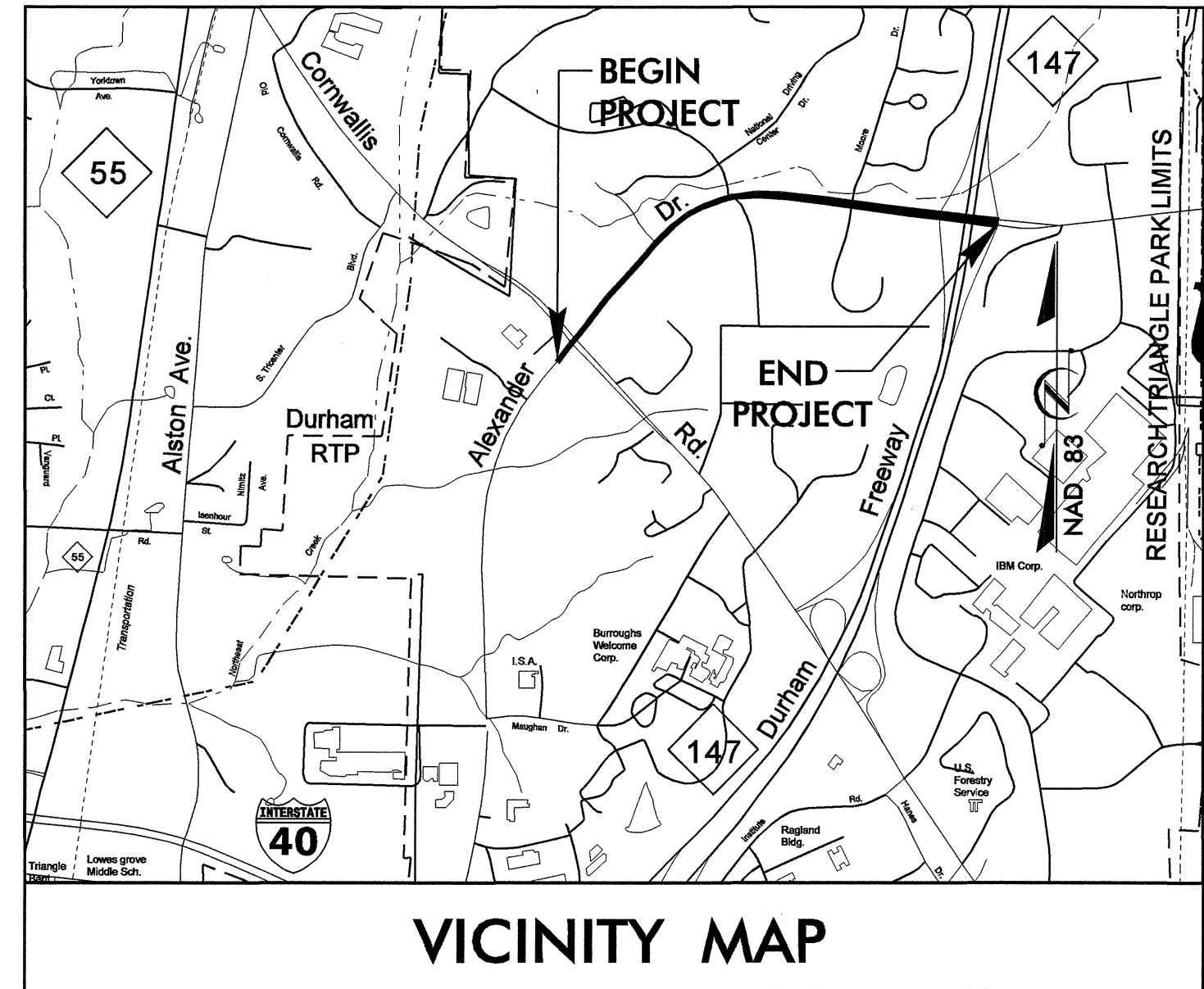

VICINITY MAP

SR 2028 (T.W. ALEXANDER DRIVE)  
 FROM SR 1121 (CORNWALLIS ROAD)  
 TO EAST OF NC 147

-L- STA. 18+50.00  
 BEGIN TIP PROJECT U-3309A

-L- STA. 80+00.00  
 END TIP PROJECT U-3309A

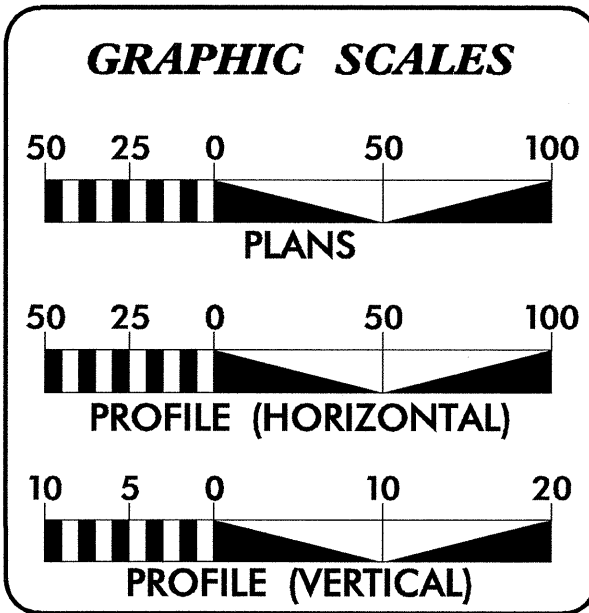
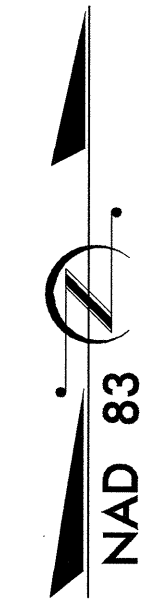
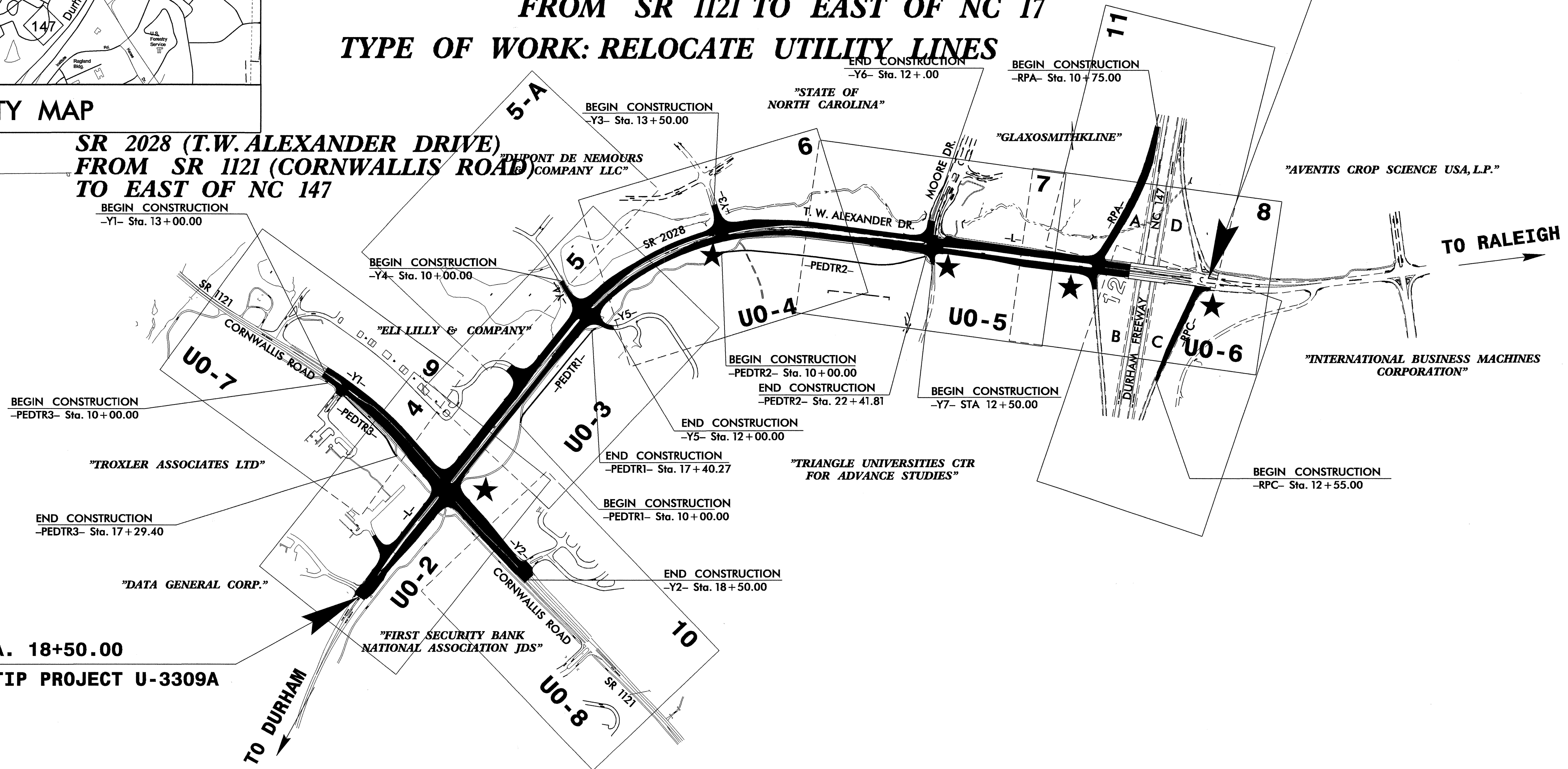

**INDEX OF SHEETS**

SHEET NO.	DESCRIPTION
UO-1	TITLE SHEET
UO-2 THRU UO-8	UTILITY BY OTHERS PLAN SHEETS

- UTILITY OWNERS ON PROJECT**
- (1) PSNC
  - (2) DUKE ENERGY
  - (3) TIME WARNER
  - (4) VERIZON COMMUNICATIONS
  - (5) VERIZON BUSINESS
  - (6) DUKENET
  - (7) LEVEL 3 COMMUNICATIONS
  - (8) BT/DELTA COM
  - (9) AT&T METRO
  - (10) GLAXO SMITH KLINE
  - (11) MCNC/UNC-TV

PREPARED IN THE OFFICE OF:  
**DIVISION OF HIGHWAYS  
 UTILITIES ENGINEERING  
 SECTION**

1591 MAIL SERVICES CENTER  
 RALEIGH NC 27699-1591  
 PHONE (919) 250-4128  
 FAX (919) 250-4119

**Roger Worthington, P.E.** UTILITIES SECTION ENGINEER  
**Corey Bousquet, P.E.** UTILITIES SQUAD LEADER PROJECT ENGINEER  
**Kifah Kamil** UTILITIES PROJECT DESIGNER

UTILITIES BY OTHERS

NOTE:  
ALL PROPOSED UTILITY WORK  
SHOWN ON THIS SHEET WILL  
BE DONE BY OTHERS

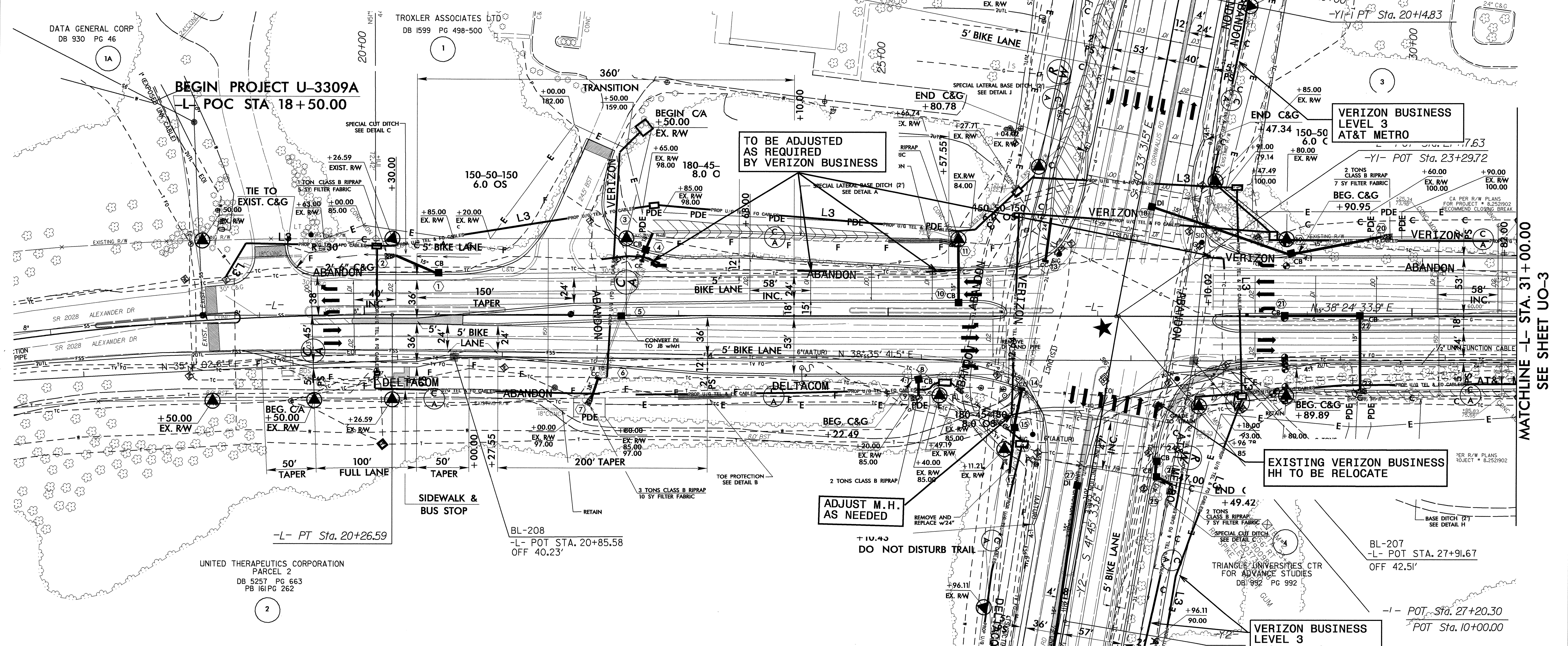
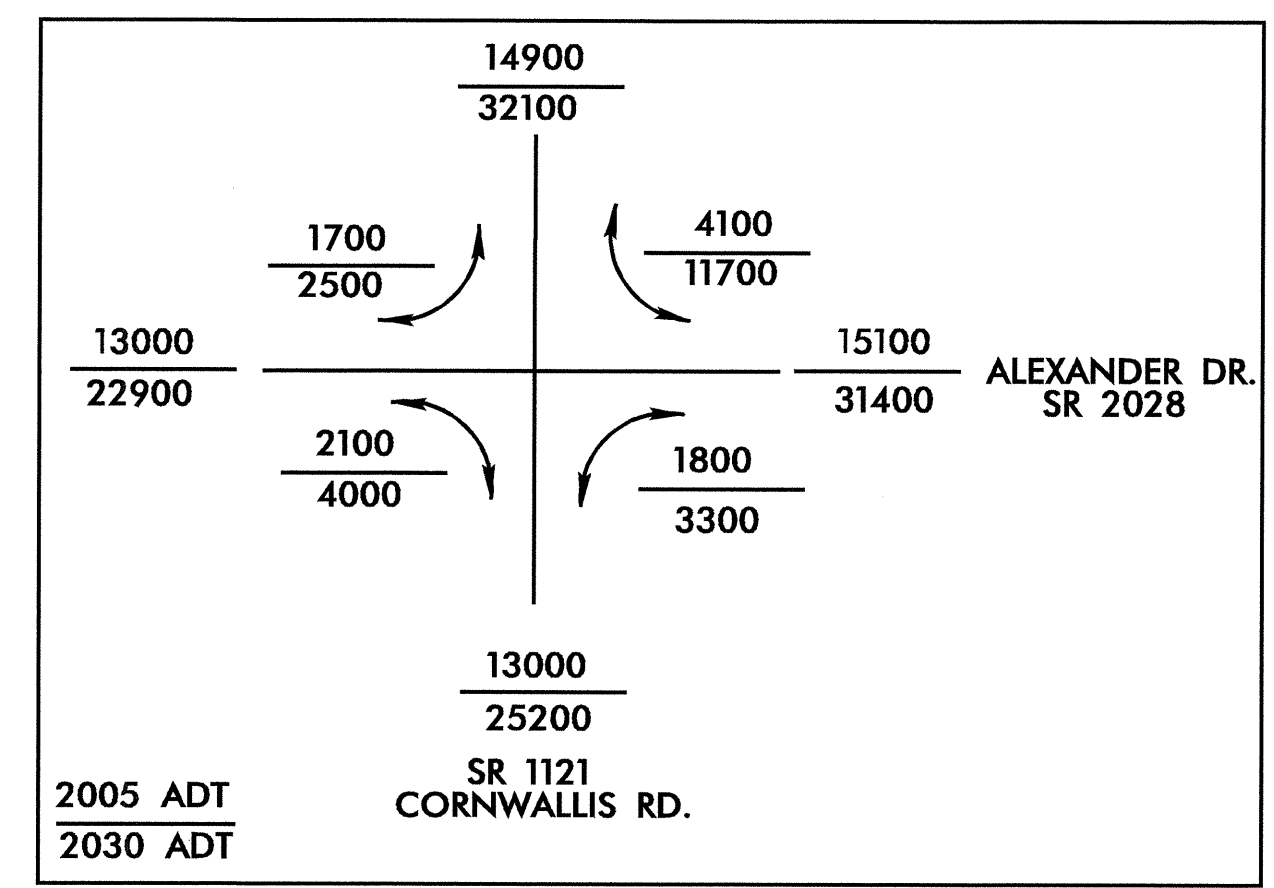

-L-	-Y1-	-Y2-	-PEDTR3-
PI Sta 15+19.71	PI Sta 14+92.16	PI Sta 16+27.28	PI Sta 14+68.20
$\Delta = 22^{\circ}01'47.0''$ (RT)	$\Delta = 1^{\circ}52'19.2''$ (LT)	$\Delta = 17^{\circ}33'15.3''$ (RT)	$\Delta = 16^{\circ}12'45.4''$ (LT)
D = 2'08'45.3"	D = 0'28'38.9"	D = 2'14'48.8"	D = 38'11'49.3"
L = 1,026.59'	L = 392.07'	L = 781.27'	L = 42.44'
T = 519.71'	T = 196.05'	T = 393.72'	T = 21.37'
R = 2,670.00'	R = 12,000.00'	R = 2,550.00'	R = 150.00'
SE = Exl.st.	SE = 06	SE = Exl.st.	
	$V_0 = 60$ MPH		

NOTE: RECONNECT ALL PEDESTRIAN TRAILS AND SIDEWALKS BACK TO INTERSECTIONS.  
 \* UPGRADE EXISTING TRAFFIC SIGNAL  
 PROP. 5' MONOLITHIC CONCRETE ISLAND  
 FOR -L- PROFILE, SEE SHEET NO. 13  
 FOR -Y1- PROFILE, SEE SHEET NO. 16  
 FOR -Y2- PROFILE, SEE SHEET NO. 17



UTILITIES BY OTHERS

NOTE:  
ALL PROPOSED UTILITY WORK  
SHOWN ON THIS SHEET WILL  
BE DONE BY OTHERS

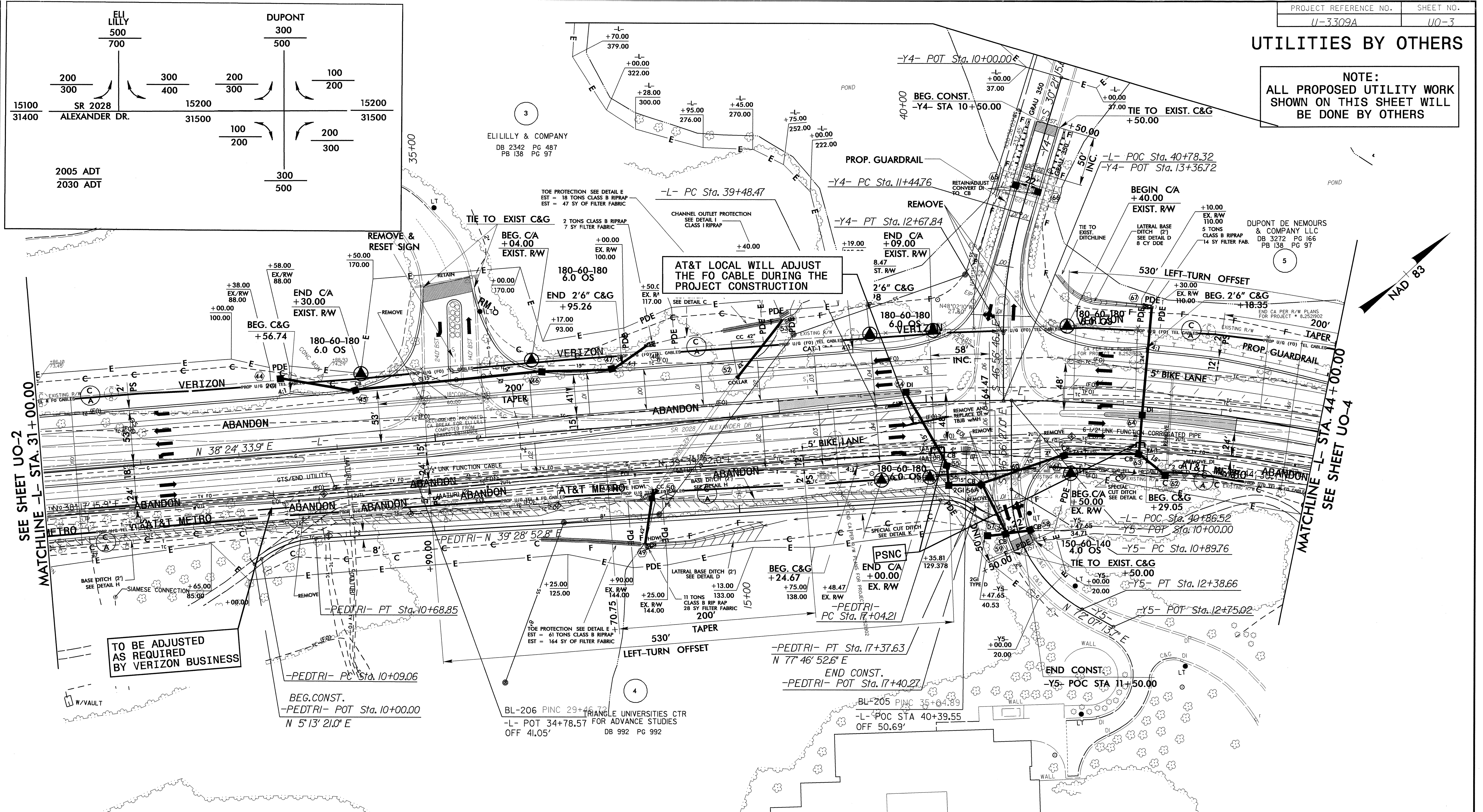

REVISIONS

SEE SHEET UO-2  
MATCHLINE -L- STA. 31+00.00

MATCHLINE -L- STA. 44+00.00  
SEE SHEET UO-4

-L-	-PEDTRI-		-Y4-	-Y5-
PI Sta 48+52.84	PI Sta 10+39.88	PI Sta 17+21.57	PI Sta 12+06.73	PI Sta 11+72.12
$\Delta = 58^{\circ} 57' 11.0"$ (RT)	$\Delta = 34^{\circ} 15' 31.9"$ (RT)	$\Delta = 38^{\circ} 17' 59.8"$ (RT)	$\Delta = 16^{\circ} 35' 34.3"$ (LT)	$\Delta = 60^{\circ} 56' 19.3"$ (LT)
D = 3' 34' 51.6"	D = 57' 17' 44.8"	D = 114' 35' 29.6"	D = 13' 28' 52.9"	D = 40' 55' 32.0"
L = 1646.28'	L = 59.79'	L = 33.42'	L = 123.08'	L = 148.90'
T = 904.37'	T = 30.82'	T = 17.36'	T = 61.97'	T = 82.37'
R = 1,600.00'	R = 100.00'	R = 50.00'	R = 425.00'	R = 140.00'
SE = 06			SE = EXIST.	SE = EXIST.
V <sub>D</sub> = 60 MPH				

NOTE: RECONNECT ALL PEDESTRIAN TRAILS AND SIDEWALKS BACK TO INTERSECTIONS.

PROP. 5' MONOLITHIC CONCRETE ISLAND  
FOR -L- PROFILE, SEE SHEET NO. 13  
FOR -Y4- PROFILE, SEE SHEET NO. 18  
FOR -Y5- PROFILE, SEE SHEET NO. 18

I:\c\11148000\10\_0929...  
 I:\c\11148000\10\_0929...  
 I:\c\11148000\10\_0929...

UTILITIES BY OTHERS

NOTE:  
ALL PROPOSED UTILITY WORK  
SHOWN ON THIS SHEET WILL  
BE DONE BY OTHERS

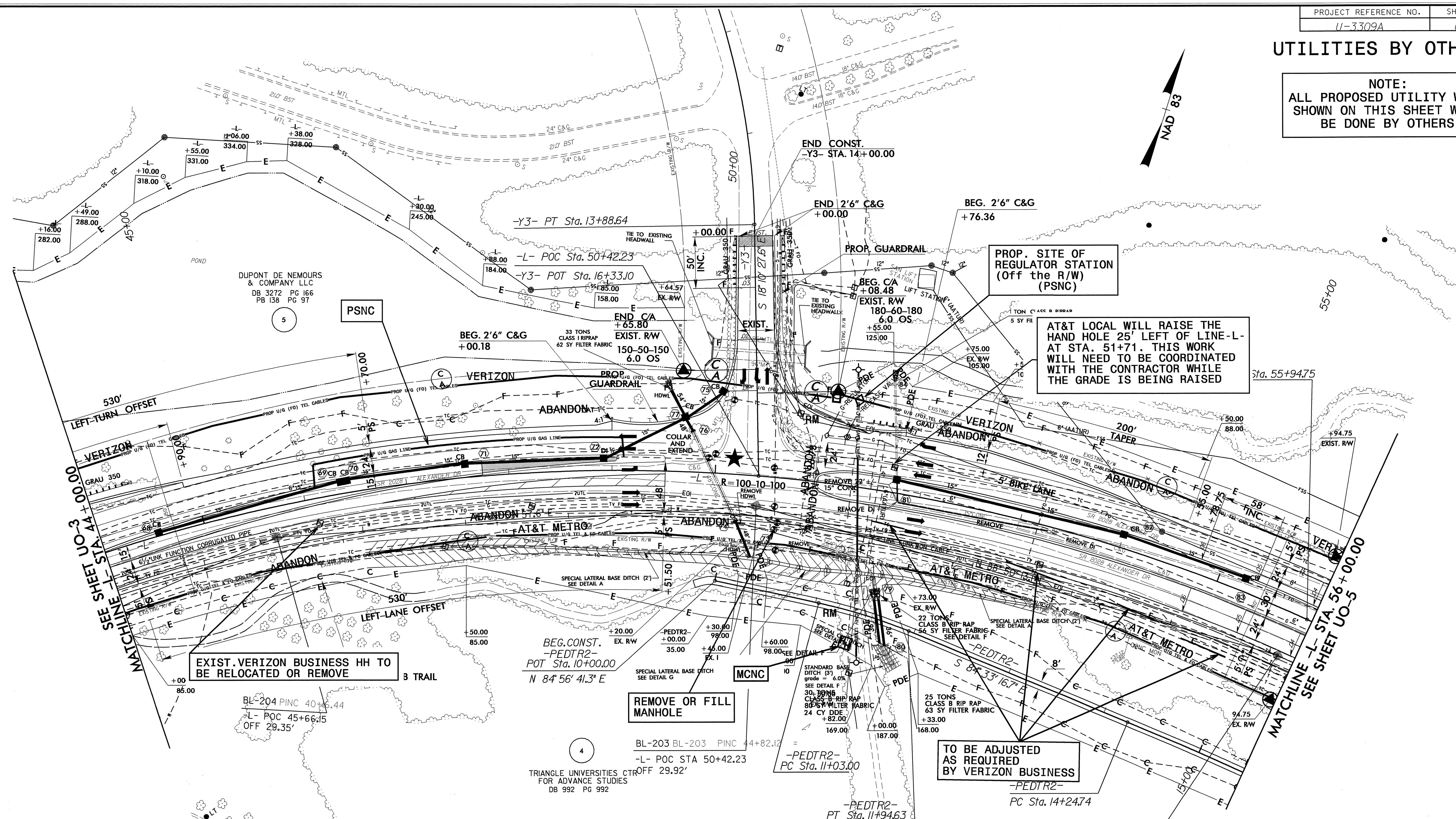

REVISIONS

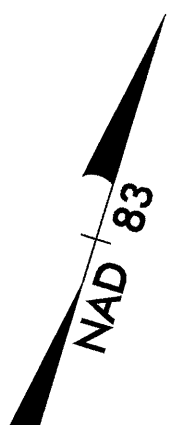

SEE SHEET UO-3  
MATCHLINE -L- STA 44 + 00.00

SEE SHEET UO-5  
MATCHLINE -L- STA 56 + 00.00

EXIST. VERIZON BUSINESS HH TO BE RELOCATED OR REMOVE

REMOVE OR FILL MANHOLE

TO BE ADJUSTED AS REQUIRED BY VERIZON BUSINESS

-L-	-PEDTR2-	-Y3-
PI Sta 48+52.84	PI Sta 11+48.95	PI Sta 15+17.24
Δ = 58° 57' 11.0" (RT)	Δ = 10° 30' 02.0" (RT)	Δ = 2° 07' 11.2" (RT)
D = 3° 34' 51.6"	D = 11° 27' 33.0"	D = 1° 08' 45.3"
L = 1846.28'	L = 91.63'	L = 184.99'
T = 904.37'	T = 45.95'	T = 92.50'
R = 1600.00'	R = 500.00'	R = 5000.00'
SE = 06°		
V <sub>D</sub> = 60 MPH		

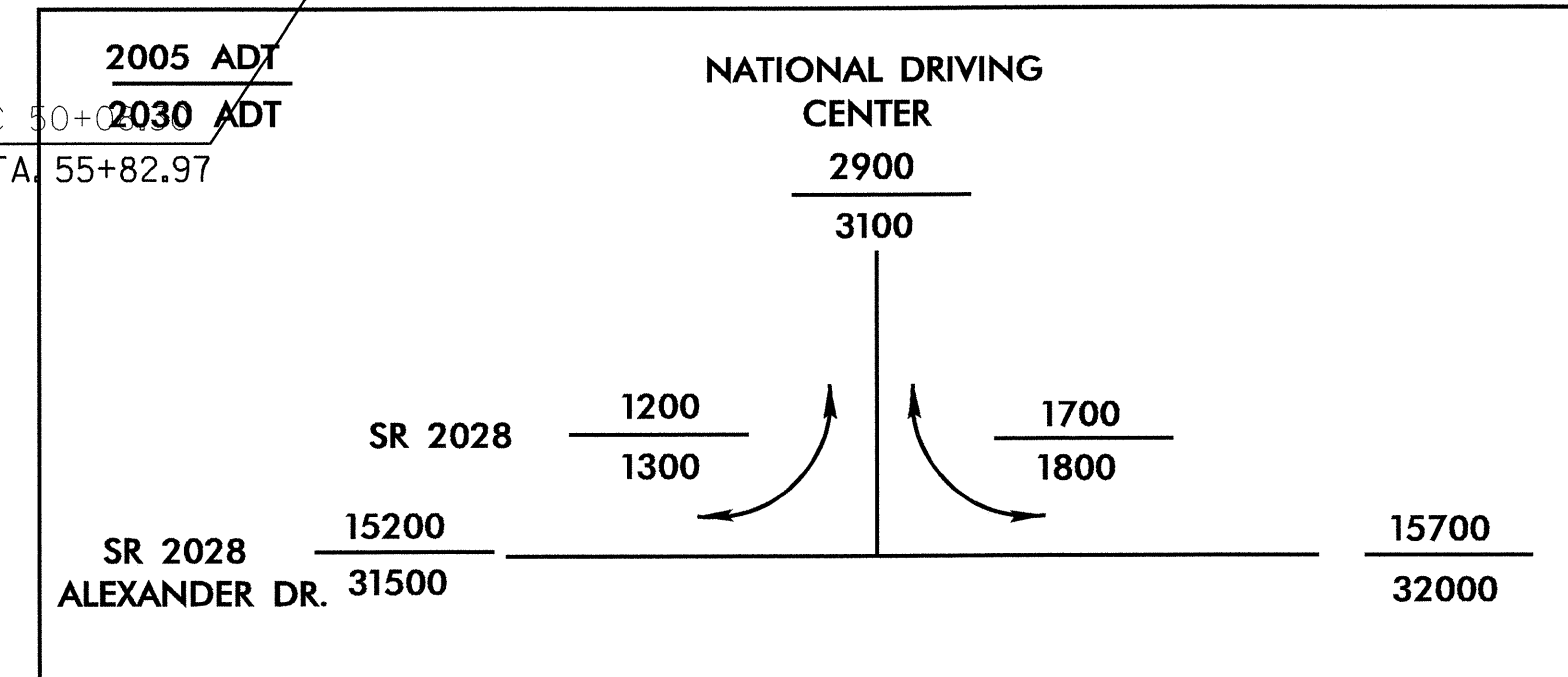

PROP. 5" MONOLITHIC CONCRETE ISLAND  
FOR -L- PROFILE, SEE SHEET NO. 14  
FOR -Y3- PROFILE, SEE SHEET NO. 17

88/11/2/999  
 I:\clients\10020\10020.dwg  
 r:\1\10020\10020.dwg

# UTILITIES BY OTHERS

**NOTE:**  
ALL PROPOSED UTILITY WORK SHOWN ON THIS SHEET WILL BE DONE BY OTHERS

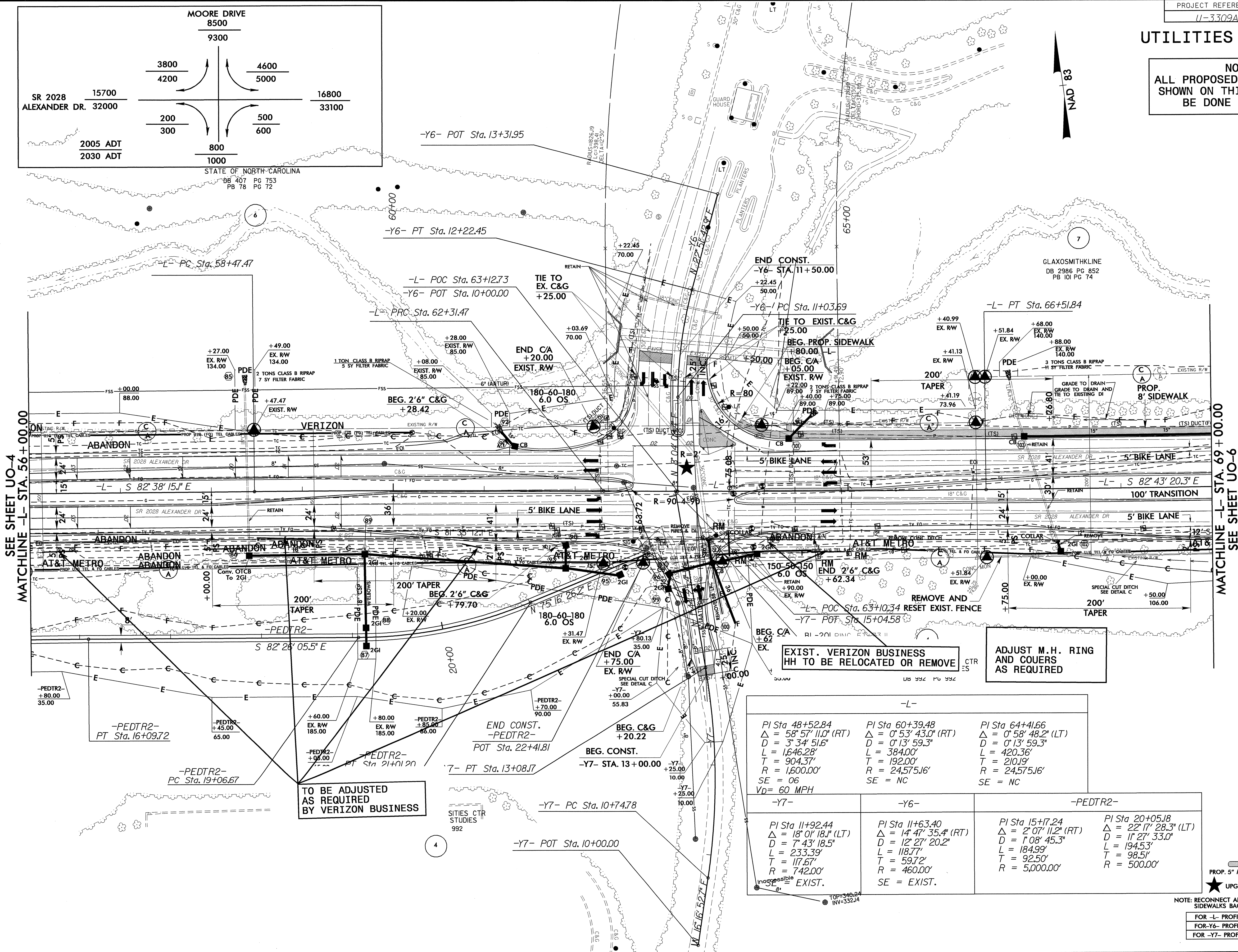
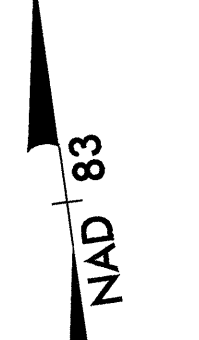
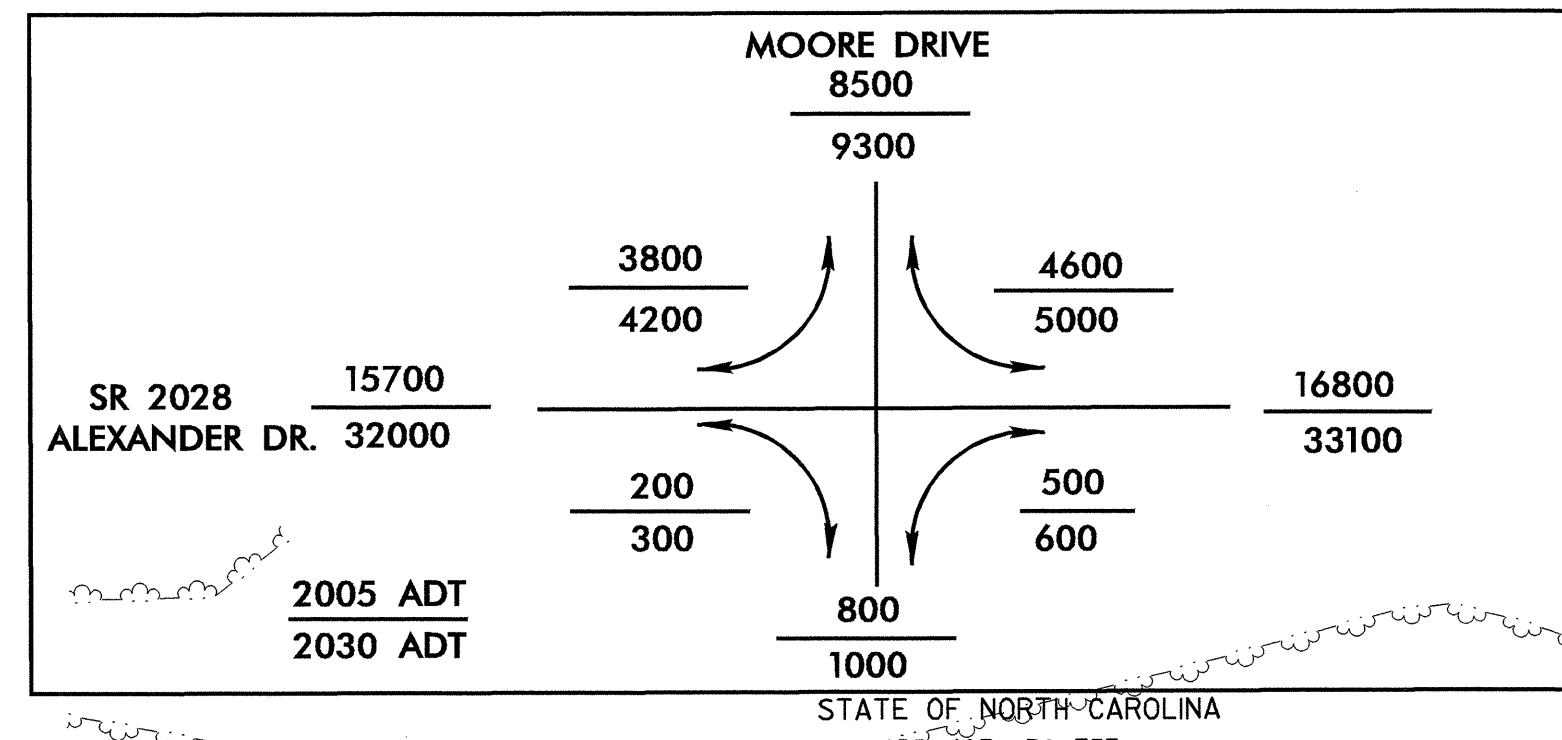

SEE SHEET UO-4  
MATCHLINE -L- STA. 56+00.00

MATCHLINE -L- STA. 69+00.00  
SEE SHEET UO-6

-L-		
PI Sta 48+52.84 $\Delta = 58^{\circ} 57' 11.0" (RT)$ $D = 3^{\circ} 34' 51.6"$ $L = 1646.28'$ $T = 904.37'$ $R = 1600.00'$ SE = 06 $V_d = 60 \text{ MPH}$	PI Sta 60+39.48 $\Delta = 0^{\circ} 53' 43.0" (RT)$ $D = 0^{\circ} 13' 59.3"$ $L = 384.00'$ $T = 192.00'$ $R = 24575.16'$ SE = NC	PI Sta 64+41.66 $\Delta = 0^{\circ} 58' 48.2" (LT)$ $D = 0^{\circ} 13' 59.3"$ $L = 420.36'$ $T = 210.19'$ $R = 24575.16'$ SE = NC
-PEDTR2-		
PI Sta 11+92.44 $\Delta = 18^{\circ} 01' 18.1" (LT)$ $D = 7^{\circ} 43' 18.5"$ $L = 233.39'$ $T = 117.67'$ $R = 742.00'$ SE = EXIST.	PI Sta 11+63.40 $\Delta = 14^{\circ} 47' 35.4" (RT)$ $D = 12^{\circ} 27' 20.2"$ $L = 118.77'$ $T = 59.72'$ $R = 460.00'$ SE = EXIST.	PI Sta 15+17.24 $\Delta = 2^{\circ} 07' 11.2" (RT)$ $D = 1^{\circ} 08' 45.3"$ $L = 184.99'$ $T = 92.50'$ $R = 5000.00'$
PI Sta 20+05.18 $\Delta = 22^{\circ} 17' 28.3" (LT)$ $D = 11^{\circ} 27' 33.0"$ $L = 194.53'$ $T = 98.51'$ $R = 500.00'$		

★ PROP. 5' MONOLITHIC CONCRETE ISLAND  
★ UPGRADE EXISTING TRAFFIC SIGNAL

NOTE: RECONNECT ALL PEDESTRIAN TRAILS AND SIDEWALKS BACK TO INTERSECTIONS.

FOR -L- PROFILE, SEE SHEET NO. 14  
FOR -Y6- PROFILE, SEE SHEET NO. 19  
FOR -Y7- PROFILE, SEE SHEET NO. 19

REVISIONS

## UTILITIES BY OTHERS

**NOTE:**  
ALL PROPOSED UTILITY WORK  
SHOWN ON THIS SHEET WILL  
BE DONE BY OTHERS

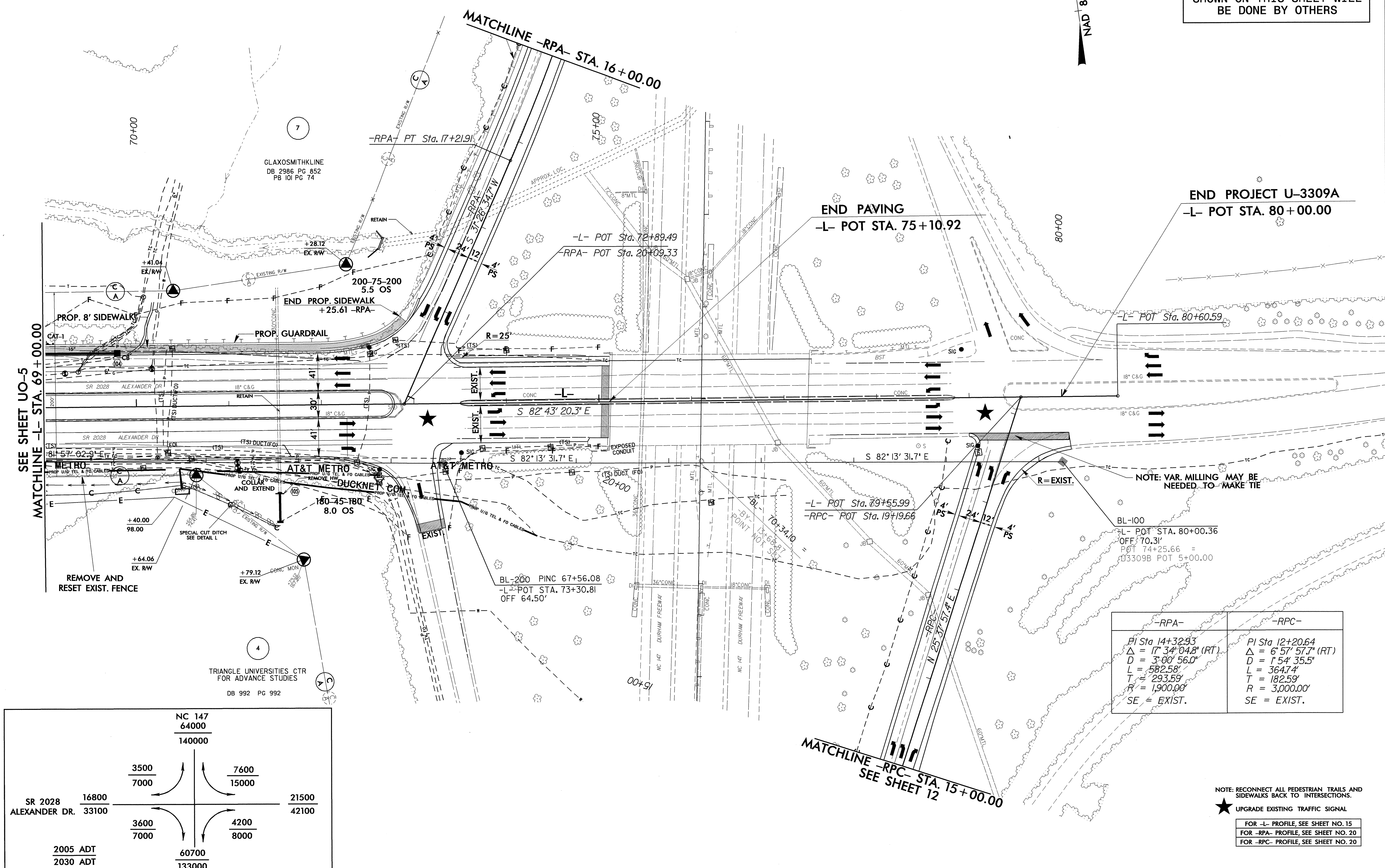
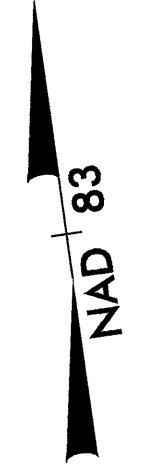

**END PROJECT U-3309A**  
-L- POT STA. 80+00.00

**END PAVING**  
-L- POT STA. 75+10.92

**NOTE: VAR. MILLING MAY BE  
NEEDED TO MAKE TIE**

-RPA-	-RPC-
PI Sta 14+32.93	PI Sta 12+20.64
$\Delta = 17^\circ 34' 04.8" (RT)$	$\Delta = 6^\circ 57' 57.7" (RT)$
D = 3' 00' 56.0"	D = 1' 54' 35.5"
L = 582.58'	L = 364.74'
T = 293.59'	T = 182.59'
R = 1900.00'	R = 3,000.00'
SE = EXIST.	SE = EXIST.

SEE SHEET UO-5  
MATCHLINE -L- STA. 69+00.00

MATCHLINE -RPC- STA. 15+00.00  
SEE SHEET 12

REVISIONS

SR 2028 ALEXANDER DR.	16800 33100	21500 42100
2005 ADT	3600 7000	4200 8000
2030 ADT	60700 133000	

**NOTE: RECONNECT ALL PEDESTRIAN TRAILS AND  
SIDEWALKS BACK TO INTERSECTIONS.**

★ UPGRADE EXISTING TRAFFIC SIGNAL

FOR -L- PROFILE, SEE SHEET NO. 15
FOR -RPA- PROFILE, SEE SHEET NO. 20
FOR -RPC- PROFILE, SEE SHEET NO. 20

UTILITIES BY OTHERS

NOTE:  
ALL PROPOSED UTILITY WORK SHOWN ON THIS SHEET WILL BE DONE BY OTHERS

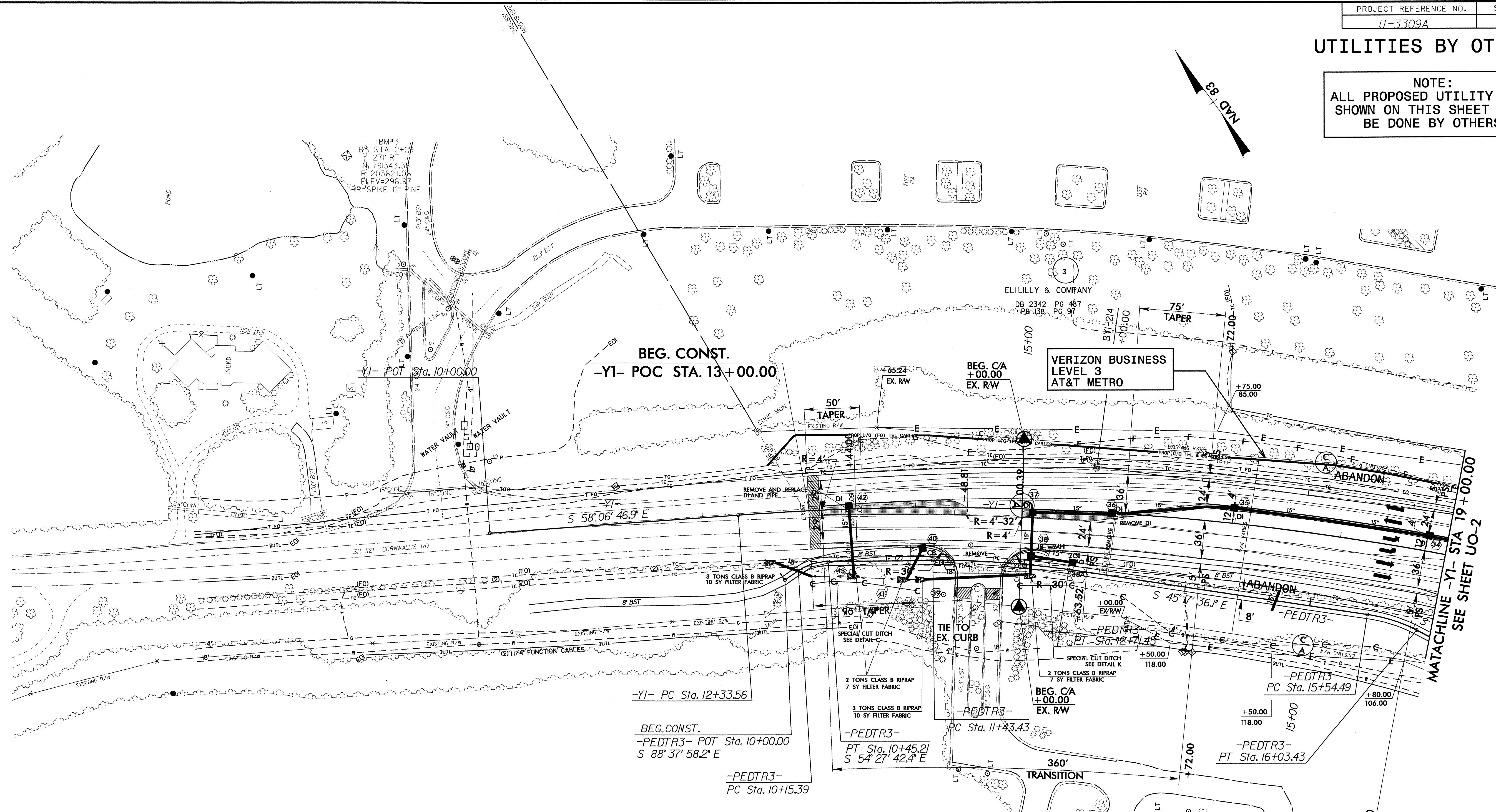

<p>-YILT-</p> <p>PI Sta 14+91.81      PI Sta 18+46.36  <math>\Delta = 8^{\circ} 43' 48.2''</math> (RT)      <math>\Delta = 7^{\circ} 42' 10.9''</math> (RT)  D = 2' 25' 56.4"      D = 2' 13' 58.4"  L = 358.92'      L = 344.98'  T = 179.81'      T = 172.75'  R = 2,355.59'      R = 2,566.00'</p>			
<p>-YIRT-</p> <p>PI Sta 14+93.11      PI Sta 18+41.78  <math>\Delta = 8^{\circ} 05' 51.8''</math> (RT)      <math>\Delta = 7^{\circ} 42' 10.9''</math> (RT)  D = 2' 14' 21.6"      D = 2' 15' 27.1"  L = 361.61'      L = 341.22'  T = 181.11'      T = 170.87'  R = 2,558.60'      R = 2,538.00'</p>		<p>-YI-</p> <p>PI Sta 16+27.28  <math>\Delta = 17^{\circ} 33' 15.3''</math> (RT)  D = 2' 14' 48.8"  L = 781.27'  T = 393.72'  R = 2,550.00'  SE = EXIST.</p>	<p>-PEDTR3-</p> <p>PI Sta 10+30.76      PI Sta 12+07.58      PI Sta 15+79.18      PI Sta 16+84.10  <math>\Delta = 34^{\circ} 10' 15.7''</math> (RT)      <math>\Delta = 9^{\circ} 10' 06.3''</math> (RT)      <math>\Delta = 18^{\circ} 41' 34.6''</math> (RT)      <math>\Delta = 16^{\circ} 12' 45.4''</math> (LT)  D = 114' 35' 29.6"      D = 7' 09' 43.1"      D = 38' 11' 49.9"      D = 38' 11' 49.9"  L = 781.27'      L = 29.82'      L = 48.94'      L = 42.44'  T = 15.37'      T = 64.14'      T = 24.69'      T = 21.37'  R = 50.00'      R = 800.00'      R = 150.00'      R = 150.00'</p>

TROXLER ASSOCIATES LTD  
DB 1599 PG 498-500

PROP. 5" MONOLITHIC CONCRETE ISLAND  
FOR -YI- LT PROFILE, SEE SHEET NO. 16  
FOR -YI- RT PROFILE, SEE SHEET NO. 16

# UTILITIES BY OTHERS

NOTE:  
ALL PROPOSED UTILITY WORK  
SHOWN ON THIS SHEET WILL  
BE DONE BY OTHERS

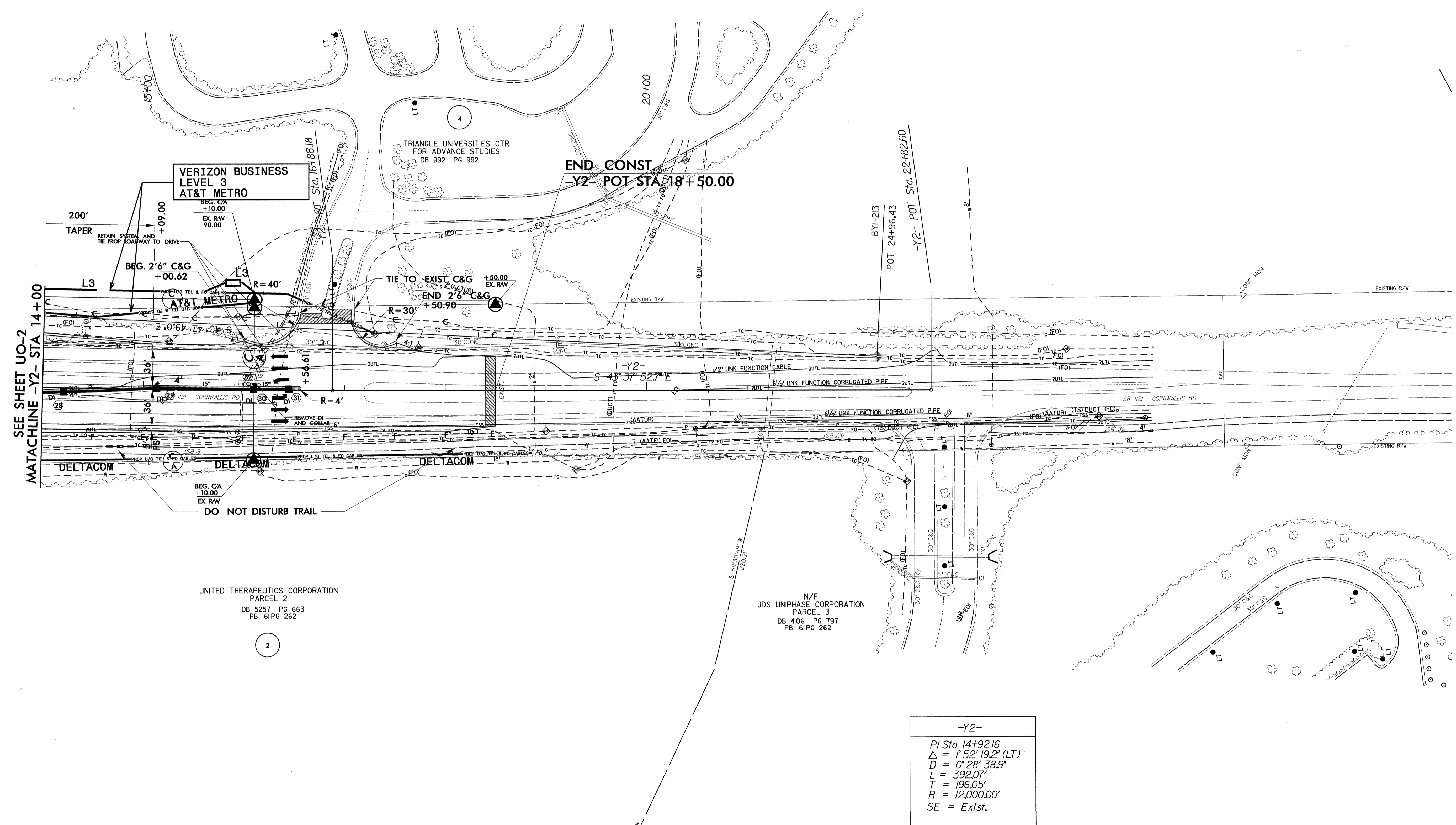
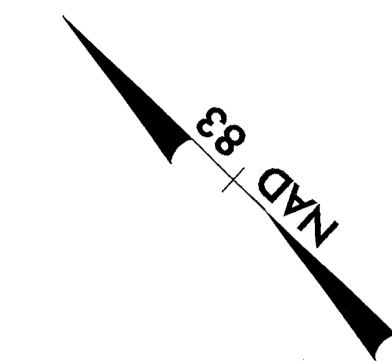

REVISIONS

SEE SHEET UO-2  
MATACHLINE -Y2- STA 14+00

UNITED THERAPEUTICS CORPORATION  
PARCEL 2  
DB 5257 PG 663  
PB 161 PG 262

N/F  
JDS UNIPHASE CORPORATION  
PARCEL 3  
DB 4106 PG 797  
PB 161 PG 262

-Y2-  
PI Sta 14+92.16  
 $\Delta = 1' 52' 19.2''$  (LT)  
 $D = 0' 28' 38.9''$   
 $L = 392.07'$   
 $T = 196.05'$   
 $R = 12,000.00'$   
SE = Exlst.

16-JUN-2009 10:32  
I:\utilities\psh10\dwg\proj\3309a\ut\_uo8\_psh10.dgn