

PROJ. REFERENCE NO.	SHEET NO.
B-4307	X-A

**STATE OF NORTH CAROLINA
DIVISION OF HIGHWAYS**

NOTE: EMBANKMENT COLUMN DOES NOT INCLUDE BACKFILL FOR UNDERCUT

CROSS-SECTION SUMMARY

Station	Uncl. Exc.	Embt																		
L	(cu. yd.)	(cu. yd.)																		
10+00.00	0	0																		
10+50.00	180	9																		
11+00.00	340	26																		
11+50.00	253	56																		
12+00.00	123	114																		
12+50.00	30	189																		
13+00.00	0	318																		
13+50.00	0	598																		
14+00.00	0	915																		
14+50.00	0	1079																		
15+00.00	0	1103																		
15+50.00	0	1046																		
16+00.00	0	1062																		
16+10.00	0	224																		
17+45.00	0	0																		
17+50.00	0	94																		
18+00.00	0	902																		
18+50.00	0	840																		
19+00.00	0	797																		
19+50.00	0	679																		
20+00.00	0	443																		
20+50.00	24	207																		
21+00.00	193	67																		
21+50.00	391	17																		
22+00.00	357	9																		
22+25.00	96	2																		

Earthwork quantities are calculated by the Roadway Design Unit. These earthwork quantities are based in part on the subsurface data provided by the Geotechnical Engineering Unit.

Approximate quantities only. Unclassified excavation, fine grading, clearing and grubbing, breaking of existing pavement and removal of existing pavement will be paid for at the lump sum price for "Grading". Note: Borrow Excavation will be paid for as a separate pay item.

8/23/99

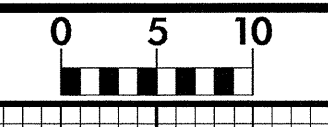

PROJ. REFERENCE NO. <i>B-4307</i>	SHEET NO. <i>X-1</i>
--------------------------------------	-------------------------

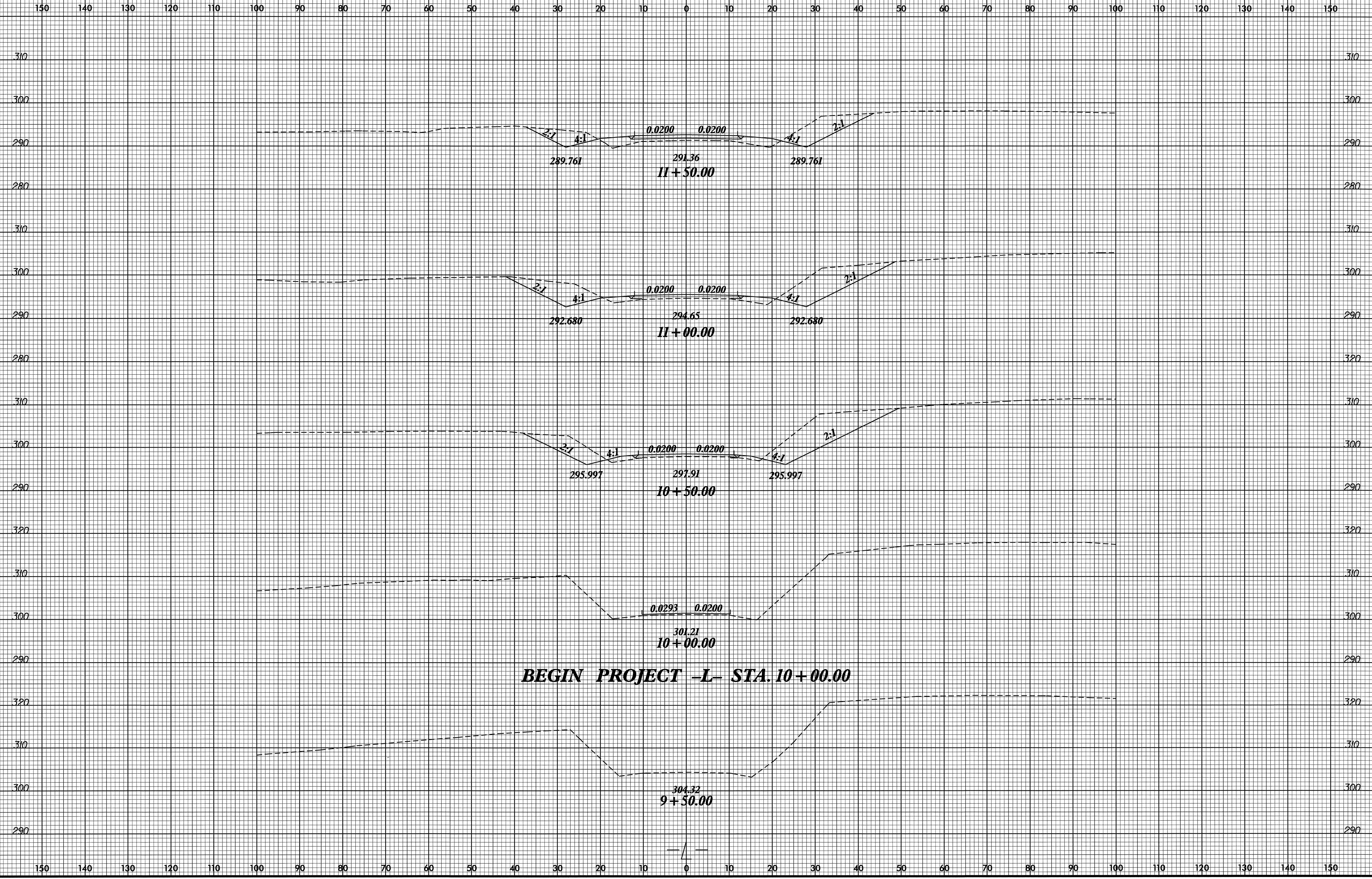

BEGIN PROJECT -L- STA. 10+00.00

17-FEB-2009 09:48
 R:\PROJECTS\17-FEB-2009\17-FEB-2009.dgn
 \$\$\$\$

8/23/99

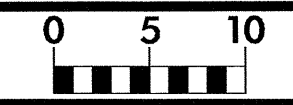

PROJ. REFERENCE NO. B-4307	SHEET NO. X-2
--------------------------------------	-------------------------

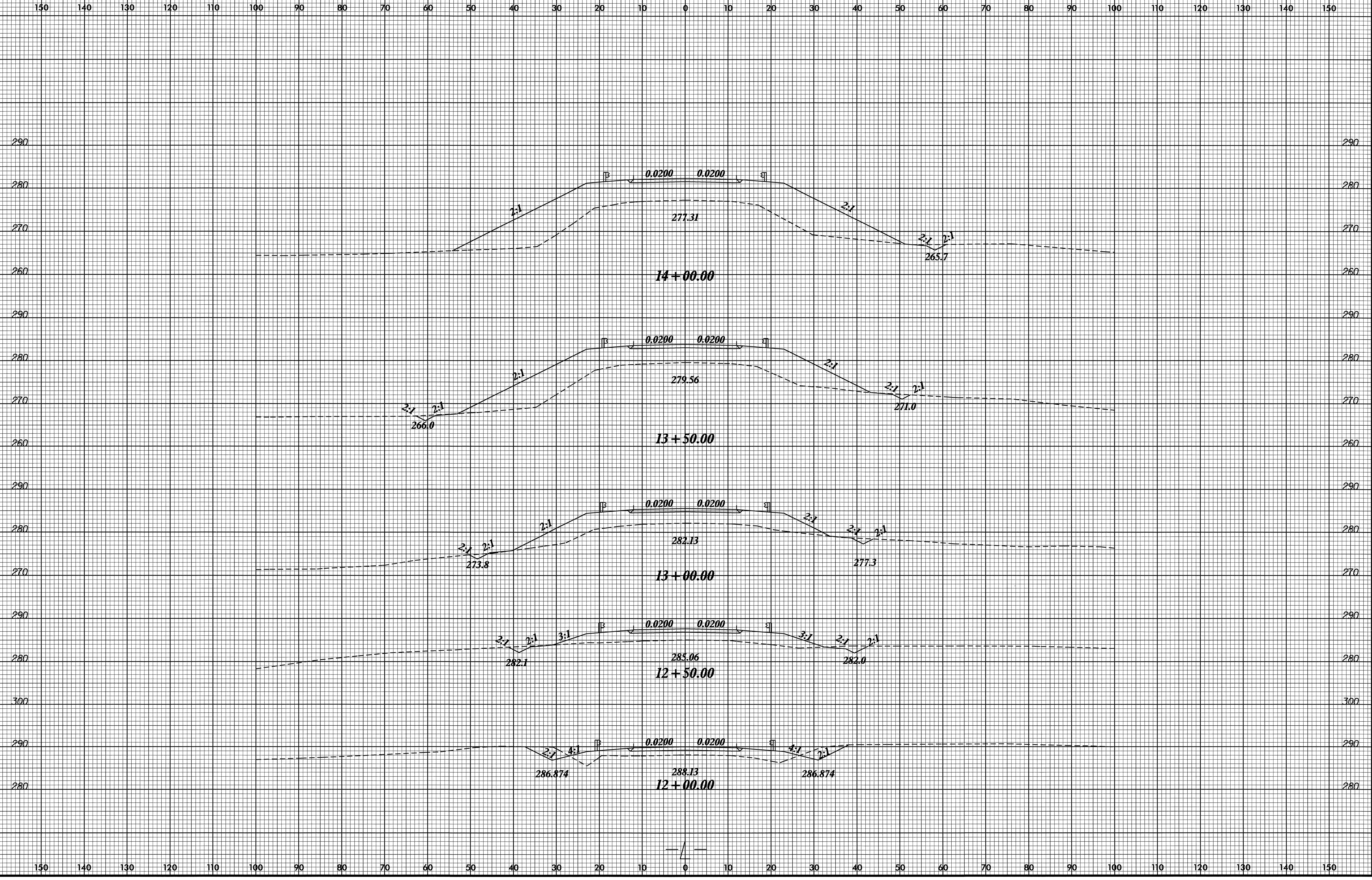

2-FEB-2009 16:32:43 B-4307_rdu_xpl.dgn

8/23/99

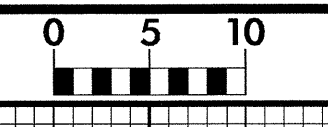

PROJ. REFERENCE NO. <i>B-4307</i>	SHEET NO. <i>X-3</i>
--------------------------------------	-------------------------

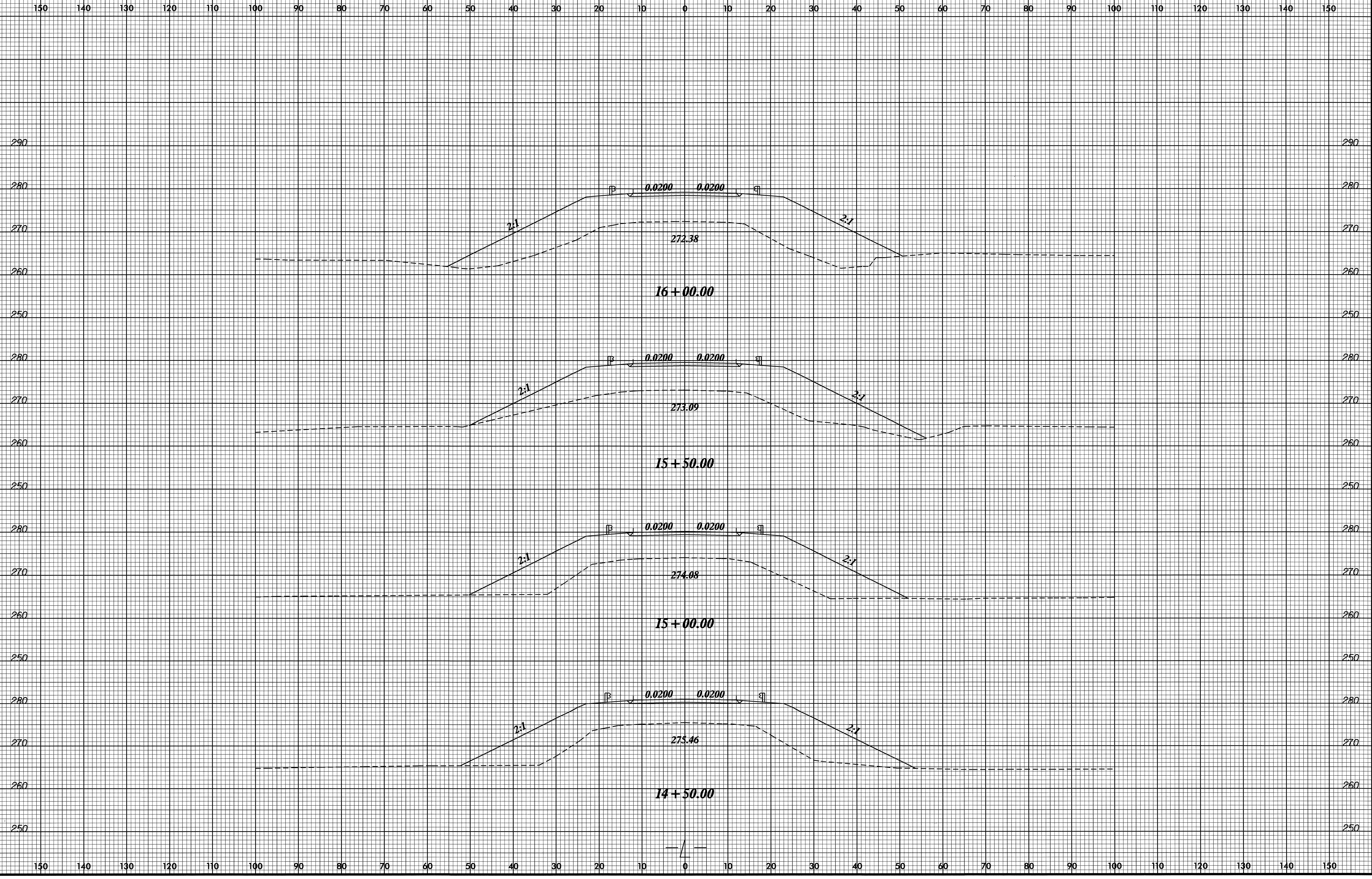

2-FEB-2009 16:32
 44361030304307_rdy_xpl.dgn
 44361030304307

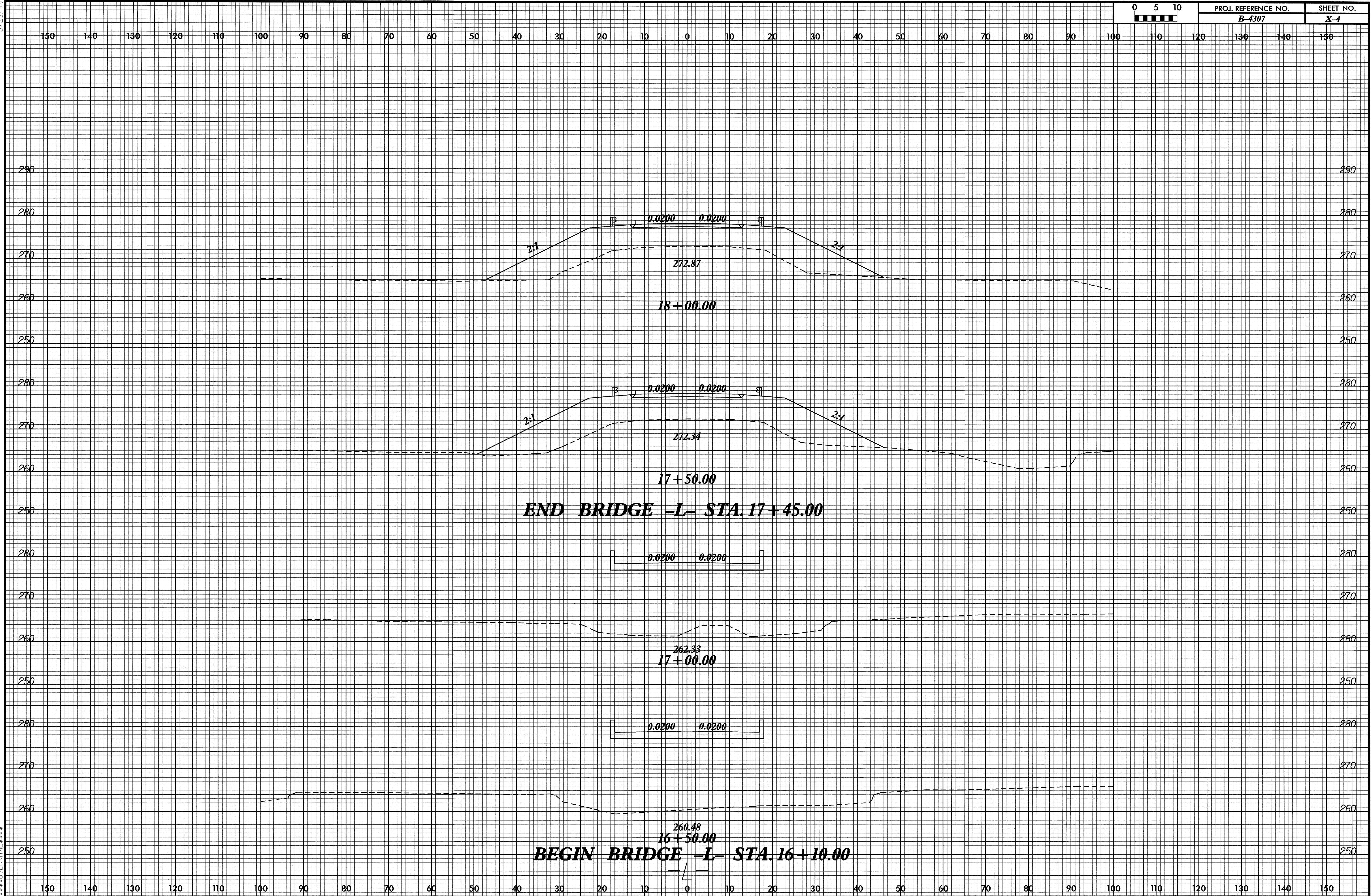

8/23/99

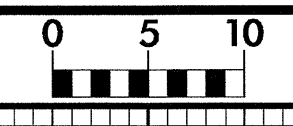

PROJ. REFERENCE NO.	SHEET NO.
B-4307	X-5

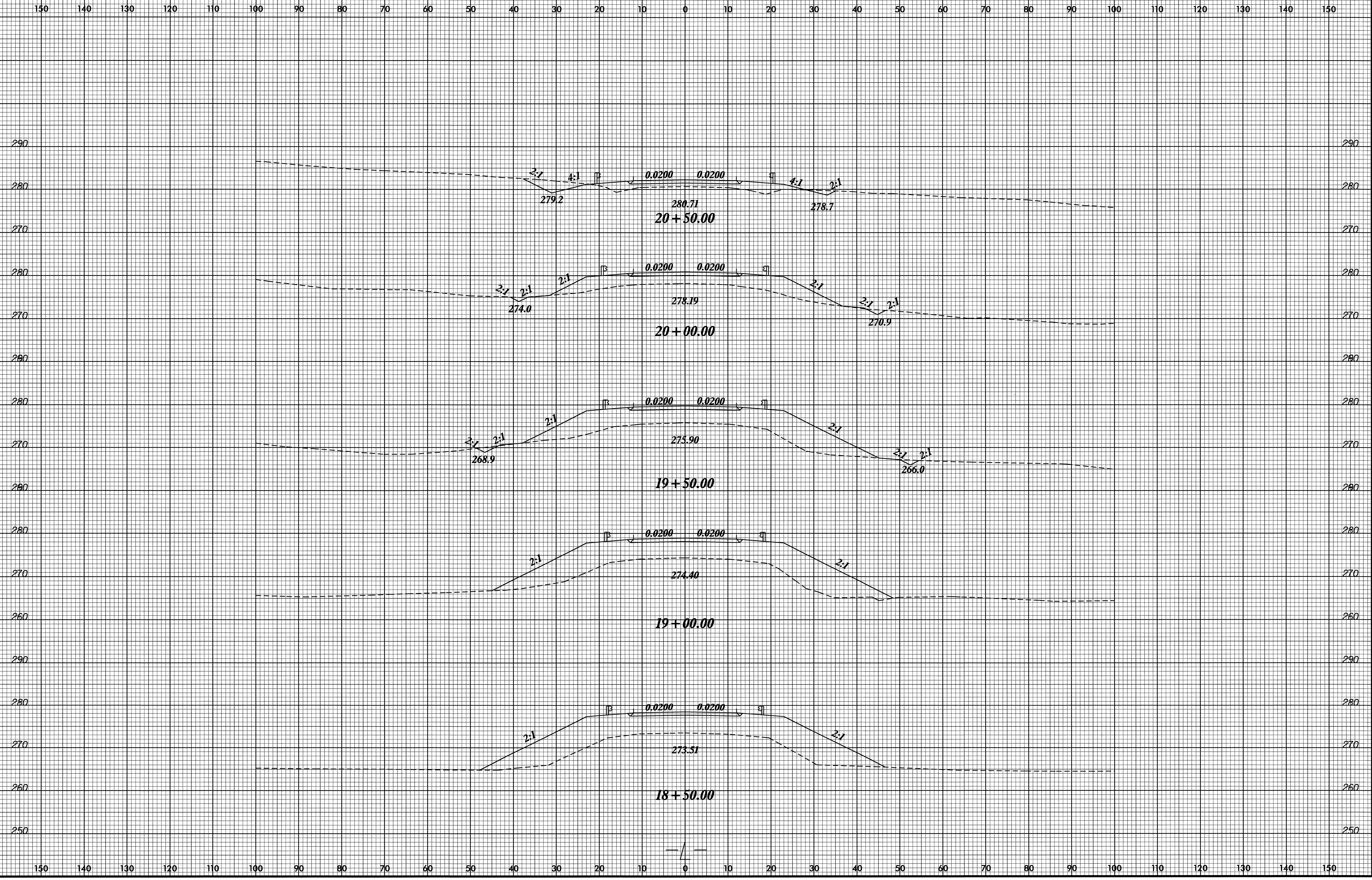

2-FEB-2009 16:52
4307.dwg

8/23/99

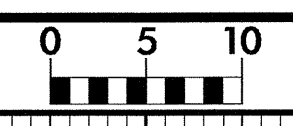

PROJ. REFERENCE NO.	SHEET NO.
B-4307	X-6

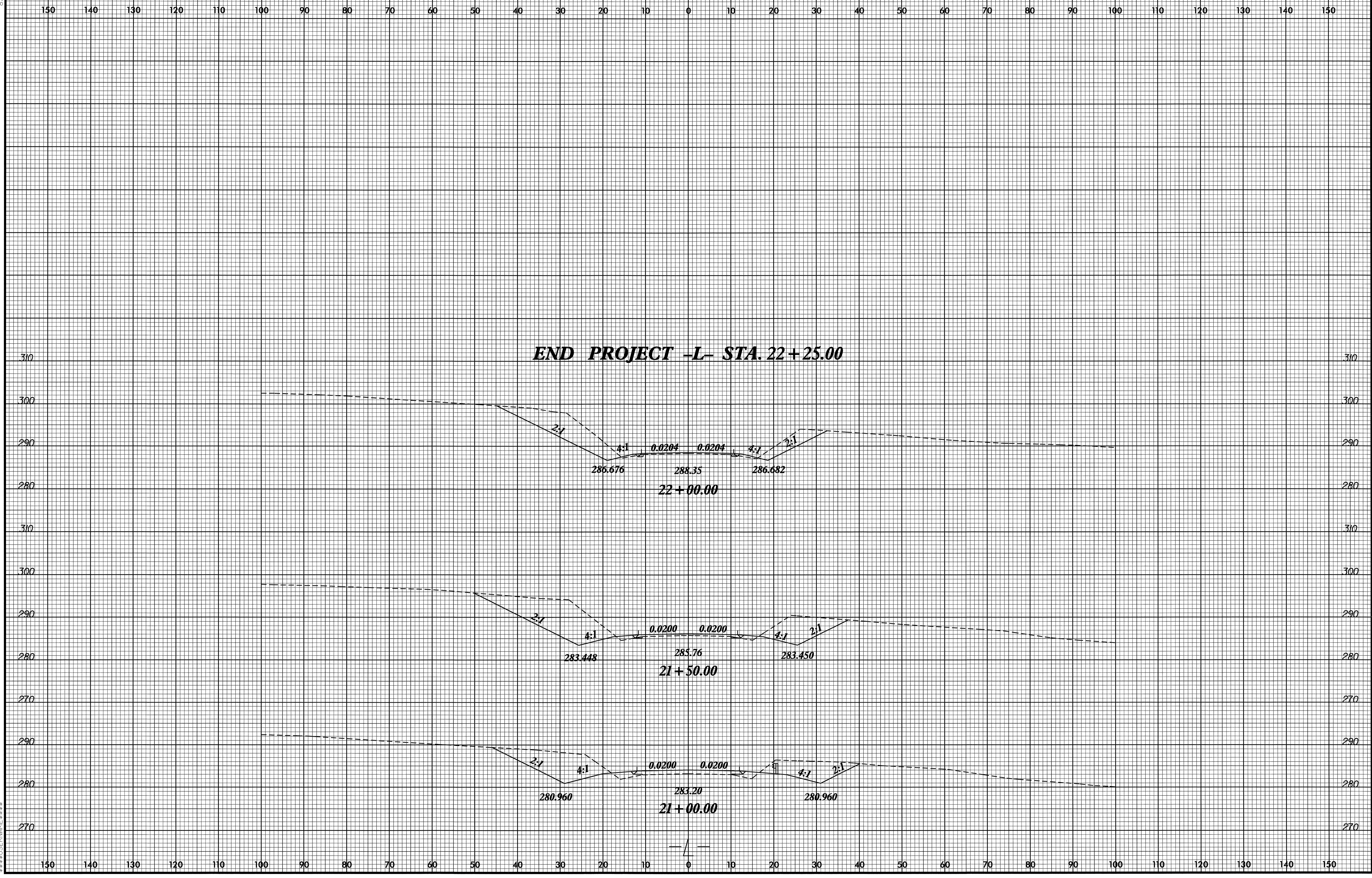

2-LEB-2003 16:32 b4307.rdu.xpl.dgn