

T.I.P.: B-4523

CONTRACT: C202126

**STATE OF NORTH CAROLINA
DEPARTMENT OF TRANSPORTATION**

**SIGNING PLANS
GRANVILLE COUNTY**

LOCATION: BRIDGE NO. 164 ON SR 1307 OVER FOX CREEK

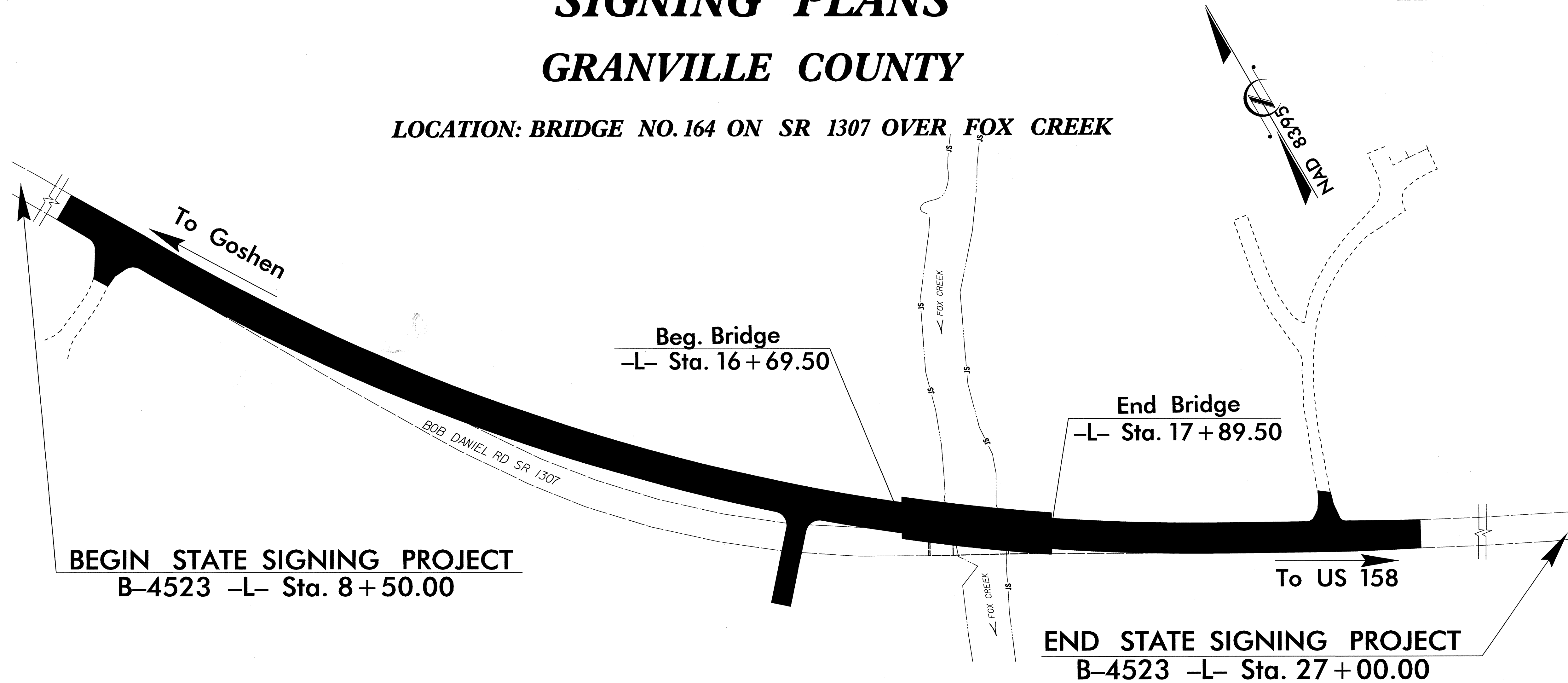

TIP NO. B-4523	SHEET NO. SIGN-1
APPROVED: <i>Aman Alquodwah</i>	
DATE: 1/14/09	

SUMMARY OF QUANTITIES

ITEM NO.		ITEM DESCRIPTION	QUANTITY	UNIT
DESC. NO.	SECT. NO.			
4072000000	903	SUPPORTS, 3 LB STEEL U-CHANNEL	28	L.F.
4102000000	904	SIGN ERECTION, TYPE E	2	EA.
4155000000	907	DISPOSAL OF SIGN SYSTEM, U-CHANNEL	10	EA.

INDEX

SHEET NO.	DESCRIPTION
1	TITLE SHEET
2	TYPE "E" SIGNS
3	EXISTING/PROPOSED ROADWAY

PLAN PREPARED BY: N.C.D.O.T. SIGNING SECTION	
R. W. KING, PE	SIGNING ENGINEER
A. I. ALQUODWAH, PE	SIGNING PROJECT ENGINEER
D. M. EATON	SIGNING PROJECT DESIGN ENGINEER
R. R. HENNEIN	SIGNING DESIGNER

ROADWAY STANDARD DRAWINGS
APPLICABLE TO THESE SIGNING PLANS
904.10 904.50

443 QUANTITY REQ'D 1



30 X 30
W1-2L

ONE "U" POST PER SIGN

444 QUANTITY REQ'D 1



30 X 30
W1-2R

ONE "U" POST PER SIGN

TIP NO. B-4523 SHEET NO. SIGN-2

APPROVED: *[Signature]*
DATE: 1/14/09

SEAL



TYPE "E" SIGNS

TIP NO. B-4523	SHEET NO. SIGN-3
APPROVED: <i>Ayman Alghodh</i>	
DATE: 1/14/09	
SEAL	

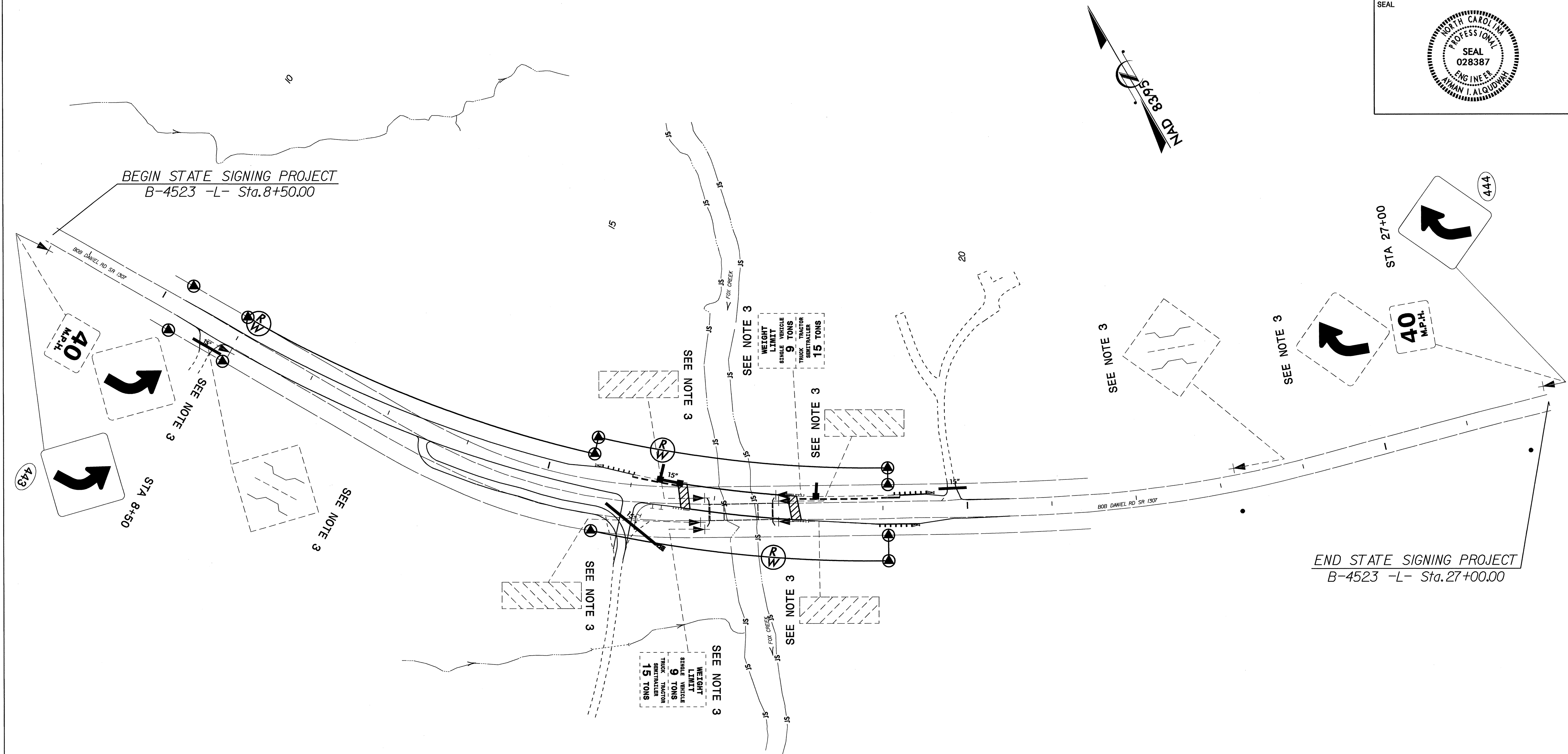

1. SEE ROADWAY STANDARD NO. 904.50 FOR MOUNTING OF TYPE 'D', 'E', AND 'F' SIGNS ON 'U' CHANNEL POSTS.
2. SIGNS FURNISHED BY STATE. BACKGROUND SHEETING SHALL BE GRADE C REFLECTIVE SHEETING.
3. DISPOSAL OF SIGN SYSTEM, U-CHANNEL.
4. SIGN ERECTION, RELOCATE SIGN TYPE D, E, OR F.
5. DISPOSAL OF SIGN SYSTEM, WOOD.
6. DISPOSAL OF SIGN, D, E, OR F.
7. DISPOSAL OF SUPPORT, U-CHANNEL.

STA 8+50 TO 27+00
SR 1307/BOB DANIEL RD
EXISTING/PROPOSED ROADWAY