

09/08/99
08-OCT-2008 14:20
C:\UTILITIES\vdv\ut\proj\B3377_ufl\uo_tsh.dgn
\$\$\$\$\$USERNAME\$\$\$\$\$

TIP PROJECT: B-3377

T.I.P. NO.	SHEET NO.
B-3377	UO-1

STATE OF NORTH CAROLINA
DIVISION OF HIGHWAYS

UTILITY BY OTHERS PLANS
WATAGUA COUNTY

LOCATION: BRIDGE NO. 302 ON SR 1233 OVER COVE CREEK

TYPE OF WORK: UTILITY RELOCATION

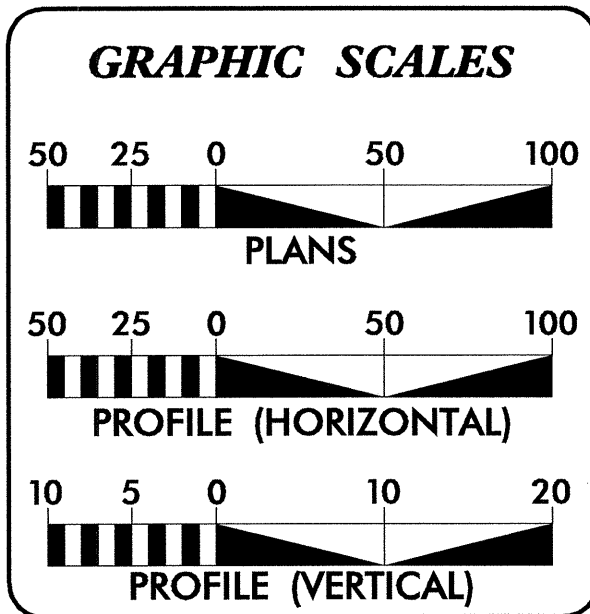
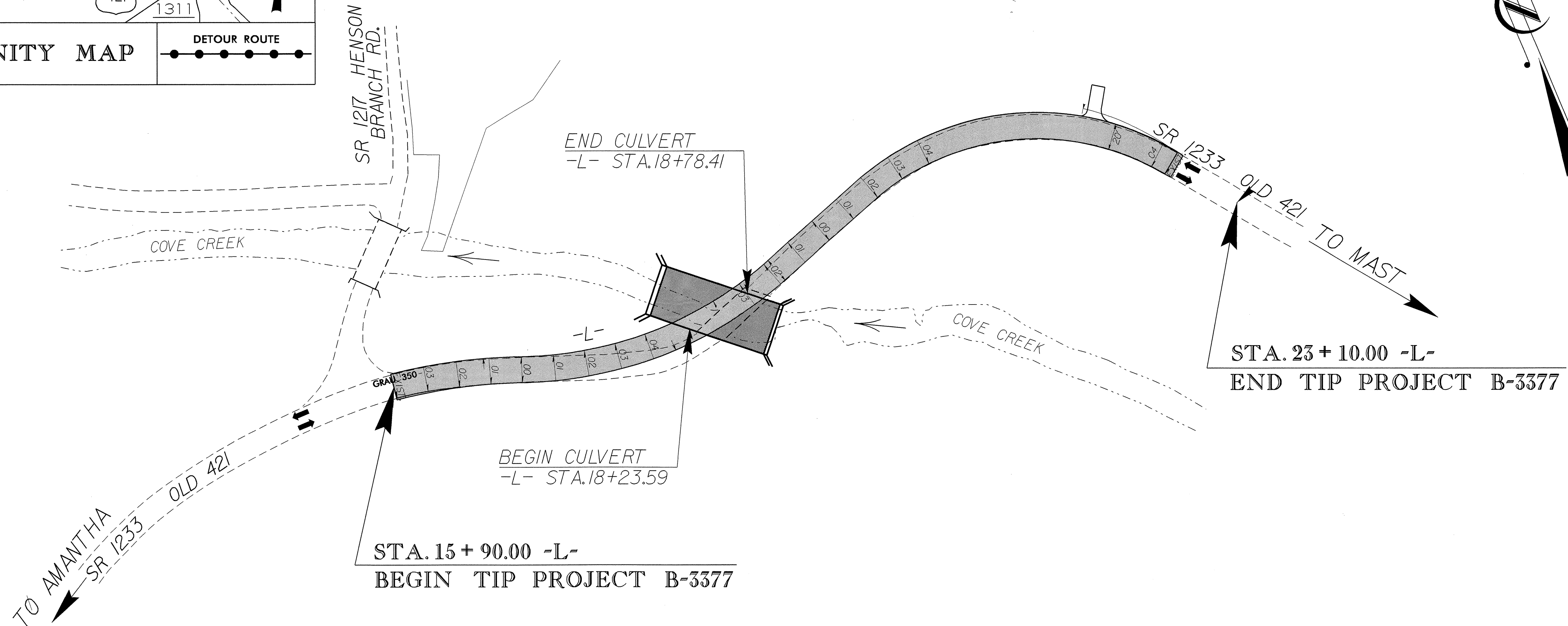
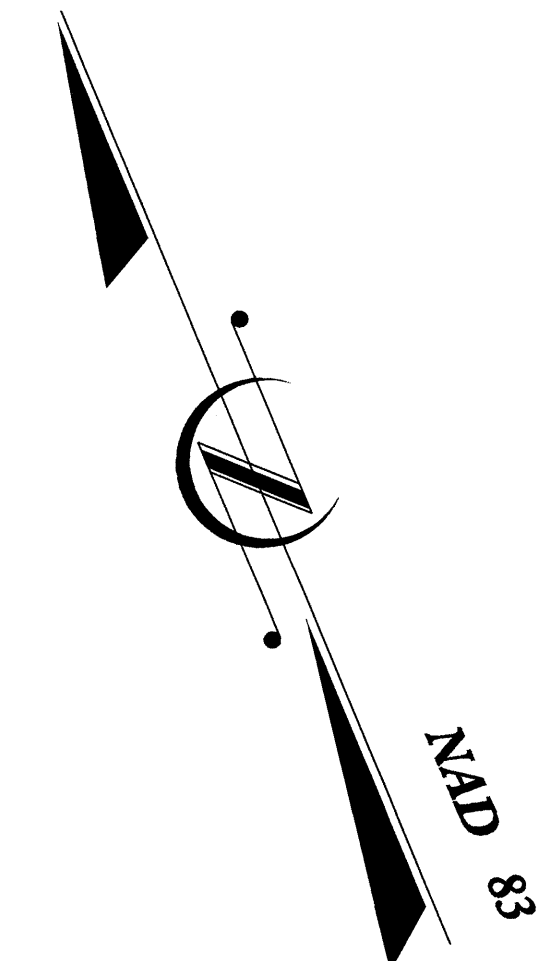
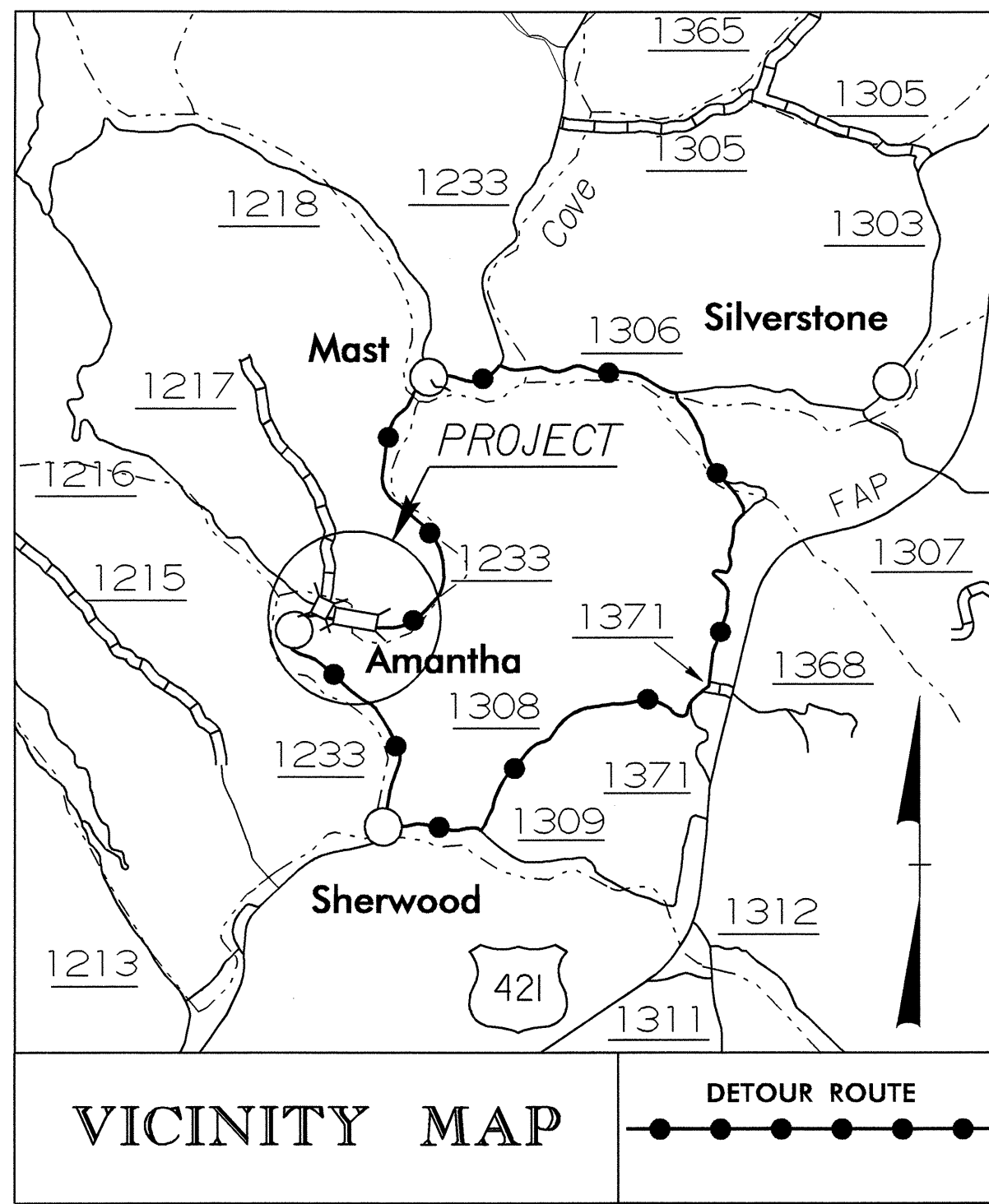

INDEX OF SHEETS	
SHEET NO.	DESCRIPTION
UO-1	TITLE SHEET
UO-2	UTILITY BY OTHERS PLAN SHEETS

UTILITY OWNERS ON PROJECT
(1) AT&T OF NC (Telephone)
(2) BLUE RIDGE EMC POWER (Power)
(3) CHARTER COMMUNICATIONS (Cable TV)

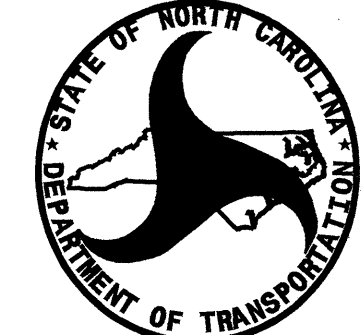

PREPARED IN THE OFFICE OF:
DIVISION OF HIGHWAYS
DESIGN SERVICES
UTILITY SECTION

1591 MAIL SERVICES CENTER
RALEIGH, NC 27699-1591
PHONE (919) 250-4128
FAX (919) 250-4119

Roger Worthington, P.E. UTILITIES SECTION ENGINEER
Corey Bousquet, P.E. UTILITIES SQUAD LEADER PROJECT ENGINEER
Brad Jackson UTILITIES PROJECT DESIGNER

UTILITIES BY OTHERS

NOTE:
ALL PROPOSED UTILITY WORK
SHOWN ON THIS SHEET WILL
BE DONE BY OTHERS

DESIGN EXCEPTION FOR DESIGN SPEED

END PROJECT B-3377
-L- STA. 23+10.00

R/W REV. - PARCEL 1 - REDUCE R/W TO AVOID SEPTIC TANK TAIL LINES
PARCEL 2 - NAME CHANGED TO TRAVIS TRIPLETT
MNL 5 - 22 - 08

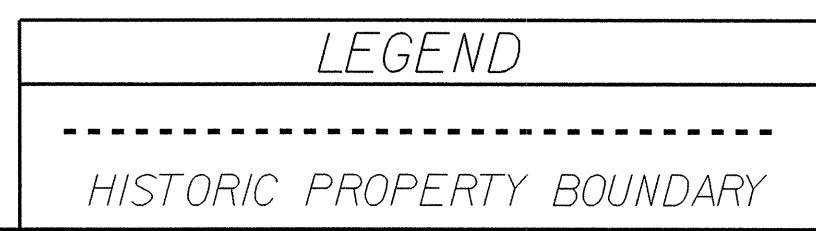
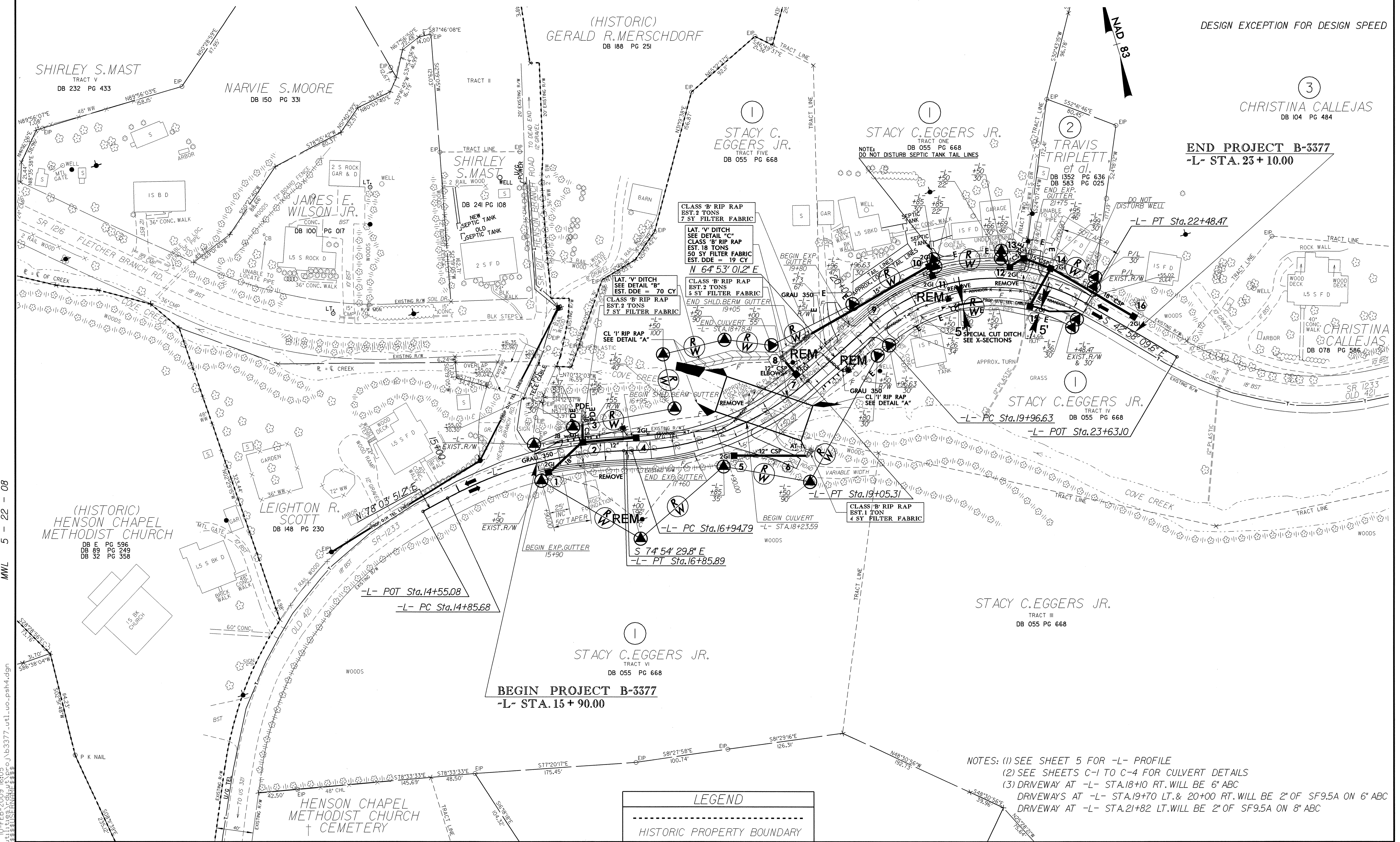

NOTES: (1) SEE SHEET 5 FOR -L- PROFILE
(2) SEE SHEETS C-1 TO C-4 FOR CULVERT DETAILS
(3) DRIVEWAY AT -L- STA.18+10 RT. WILL BE 6" ABC
DRIVEWAYS AT -L- STA.19+70 LT. & 20+00 RT. WILL BE 2" OF SF9.5A ON 6" ABC
DRIVEWAY AT -L- STA.21+82 LT. WILL BE 2" OF SF9.5A ON 8" ABC

5/14/99
10-FEB-2009 16:05
r:\utilities\cadd\psh4\psh4.dgn
B-3377-UO-2