

T.I.P.: B-4402

CONTRACT: C202048

**STATE OF NORTH CAROLINA
DEPARTMENT OF TRANSPORTATION**

**SIGNING PLANS
ALAMANCE COUNTY**

LOCATION: BRIDGE #7 OVER TICKLE CREEK ON SR 1504

TIP NO. B-4402	SHEET NO. SIGN-1
APPROVED:	
DATE: 8/11/07	
SEAL	

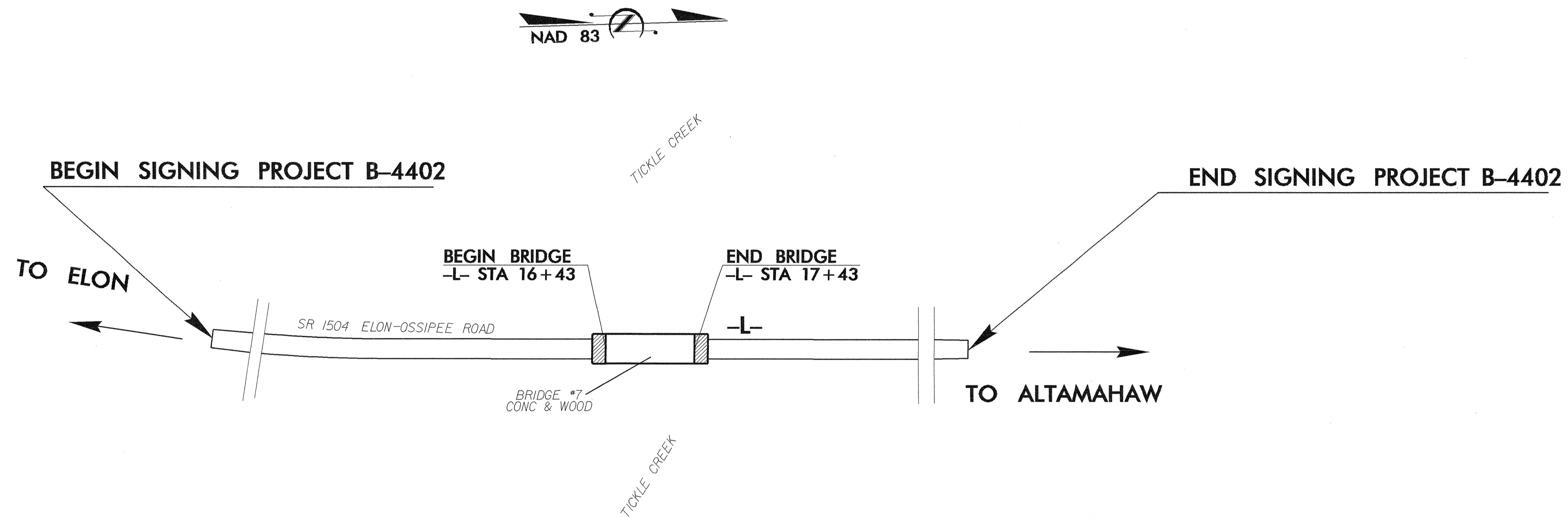

SUMMARY OF QUANTITIES

ITEM NO.		ITEM DESCRIPTION	QUANTITY	UNIT
DESC. NO.	SECT. NO.			
4072000000	903	SUPPORTS, 3 LB STEEL U-CHANNEL	13	L.F.
4102000000	904	SIGN ERECTION, TYPE E	1	EA.
4155000000	907	DISPOSAL OF SIGN SYSTEM, U-CHANNEL	9	EA.

**ROADWAY STANDARD DRAWINGS
APPLICABLE TO THESE SIGNING PLANS
904.10 904.50**

INDEX

SHEET NO.	DESCRIPTION
1	TITLE SHEET
2	TYPE "E" SIGNS
3	EXISTING & PROPOSED SIGNING

PLAN PREPARED BY: N.C.D.O.T. SIGNING SECTION	
R. W. KING, PE	STATE SIGNING ENGINEER
A. I. ALQUDWAH, PE	SIGNING CONTRACTS ENGINEER
SAMUEL COLEMAN	SIGNING CONT. PROJ. DESIGN ENGINEER
GEORGE TERLIZZI	SIGNING CONTRACTS DESIGNER ENGINEER

401 QUANTITY REQ'D 1

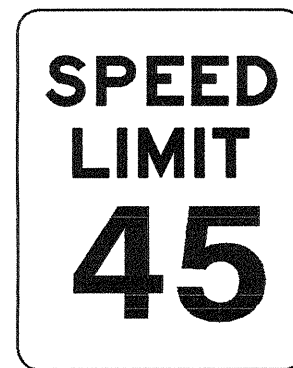

24 X 30
R2-1

ONE "U" POST PER SIGN

TIP NO. SHEET NO.

B-4402 SIGN-2

APPROVED: *[Signature]*

DATE: 8/11/08

SEAL



TYPE "E" SIGNS

TIP NO. B-4402	SHEET NO. SIGN-3
APPROVED: <i>Aman Alquodhi</i>	
DATE: 8/11/08	
SEAL	

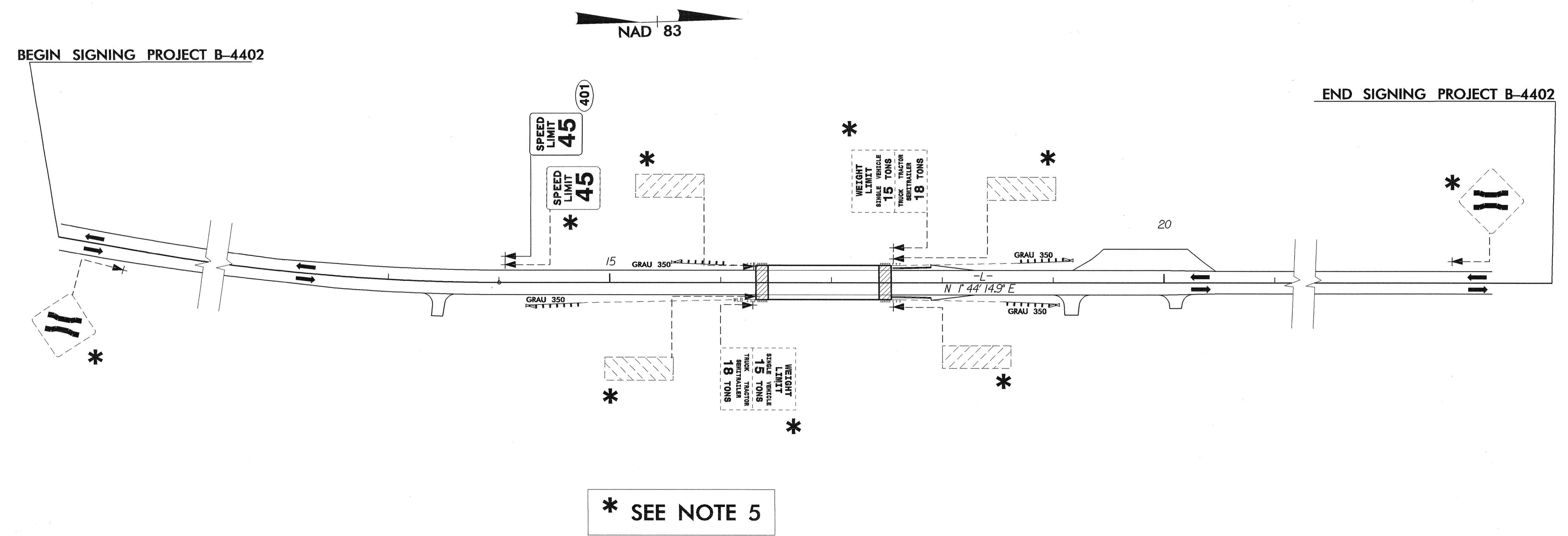

WARNING SIGNS PLACEMENT CHART

POSTED OR 85TH PERCENTILE SPEED MPH (KMH)	MUTCD DISTANCE FT (M)	SUGGESTED LOCATION FT (M)	SUGGESTED MAXIMUM FT (M)
30 (50)	450 (140)	475 (145)	575 (175)
35 (55)	550 (170)	575 (175)	675 (205)
40 (65)	650 (200)	675 (205)	775 (235)
45 (70)	750 (230)	775 (235)	875 (270)
50 (80)	850 (260)	875 (270)	975 (300)
55 (90)	950 (290)	975 (300)	1075 (330)
60 (95)	1100 (335)	1125 (345)	1225 (375)
65 (105)	1200 (365)	1225 (375)	1325 (405)
70 (115)	1250 (380)	1275 (390)	1375 (420)

1. SEE ROADWAY STANDARD NO. 904.50 FOR MOUNTING OF TYPE 'D', 'E', AND 'F' SIGNS ON 'U' CHANNEL POSTS.
2. SEE CHART FOR PLACEMENT OF WARNING SIGNS. DISTANCES SHOWN IN MINIMUM ROAD COLUMNS ARE FOR LEVEL ROADWAYS. MAKE CORRECTIONS FOR GRADES. IF 48-INCH (1219 MM) SIGNS ARE USED, THE LEGIBILITY DISTANCE MAY BE INCREASED TO 200 FEET (61 M). THIS WOULD ALLOW REDUCING THE CHART SPECIFIED DISTANCE BY 75 FEET (23 M).
3. IF THE BRIDGE IS OVER A MAJOR STREAM OR RIVER, A SIGN FOR THE NAME OF THE STREAM OR RIVER SHOULD BE INSTALLED AT EACH APPROACH. THESE DESIGNS WILL BE COMPLETED BY THE SIGNING SECTION UPON REQUEST.
4. SIGNS FURNISHED BY STATE. BACKGROUND SHEETING SHALL BE GRADE C REFLECTIVE SHEETING.
5. DISPOSAL OF SIGN SYSTEM, U-CHANNEL.
6. SIGN ERECTION, RELOCATE SIGN TYPE D, E, OR F.
7. DISPOSAL OF SIGN SYSTEM, WOOD.
8. DISPOSAL OF SIGN, D, E, OR F.
9. DISPOSAL OF SUPPORT, U-CHANNEL.

EXISTING & PROPOSED SIGNING
SR 1504
ELON-OSSIPEE ROAD