

STATE OF NORTH CAROLINA
DIVISION OF HIGHWAYS

PLAN FOR PROPOSED
TRAFFIC CONTROL, MARKING & DELINEATION

ASHE COUNTY

STATE PROJECT REFERENCE NO.	SHEET NO.
B-4011	TCP-1

B-4011

GENERAL NOTES

CHANGES MAY BE REQUIRED WHEN PHYSICAL DIMENSIONS IN THE DETAIL DRAWINGS, STANDARD DETAILS AND ROADWAY DETAILS ARE NOT ATTAINABLE TO MEET FIELD CONDITIONS, OR RESULT IN DUPLICATE, OR UNDESIRABLE OVERLAPPING OF DEVICES. MODIFICATION MAY INCLUDE: MOVING, SUPPLEMENTING, COVERING OR REMOVAL OF DEVICES, AS DIRECTED BY THE ENGINEER.

THE FOLLOWING GENERAL NOTES APPLY AT ALL TIMES FOR THE DURATION OF THE CONSTRUCTION PROJECT, EXCEPT WHEN OTHERWISE NOTED IN THE PLAN, OR DIRECTED BY THE ENGINEER.

TRAFFIC PATTERN ALTERATIONS

- A) NOTIFY THE ENGINEER TWENTY ONE (21) CALENDAR DAYS PRIOR TO ANY TRAFFIC PATTERN ALTERATION.

SIGNING

- B) PROVIDE PERMANENT SIGNING.
- C) PROVIDE DETOUR SIGNING WITHIN AND OFF THE PROJECT LIMITS.
- D) COVER OR REMOVE ALL DETOUR SIGNS WITHIN AND OFF THE PROJECT LIMITS WHEN A DETOUR IS NOT IN OPERATION.
- E) ENSURE ALL NECESSARY SIGNING IS IN PLACE PRIOR TO ALTERING ANY TRAFFIC PATTERN.

TRAFFIC CONTROL DEVICES

- F) PLACE TYPE III BARRICADES, WITH "ROAD CLOSED" SIGN R11-2 ATTACHED, OF SUFFICIENT LENGTH TO CLOSE ENTIRE ROADWAY.

PAVEMENT MARKINGS AND MARKERS

- G) INSTALL PAVEMENT MARKINGS AND PAVEMENT MARKERS ON THE FINAL SURFACE AS FOLLOWS:

ROAD NAME	MARKING	MARKER
RAILROAD GRADE ROAD (SR 1106)	PAINT	NONE

- H) PLACE TWO APPLICATIONS OF PAINT PAVEMENT MARKINGS ON THE FINAL WEARING SURFACE. PLACE THE SECOND APPLICATION OF PAINT UPON SUFFICIENT DRYING TIME OF THE FIRST.

- I) TIE PROPOSED PAVEMENT MARKING LINES TO EXISTING PAVEMENT MARKING LINES.

INDEX OF SHEETS

SHEET NO.	TITLE
TCP-1	LIST OF APPLICABLE ROADWAY STANDARD DRAWINGS, LEGEND, INDEX OF SHEETS AND GENERAL NOTES
TCP-2	PHASING, DETOUR SIGNING AND FINAL PAVEMENT MARKING SCHEDULE
SD-1	SPECIAL SIGN DESIGN

ROADWAY STANDARD DRAWINGS

THE FOLLOWING ROADWAY STANDARDS AS APPEAR IN "ROADWAY STANDARD DRAWINGS"- PROJECT SERVICES UNIT-N.C. DEPARTMENT OF TRANSPORTATION-RALEIGH, N.C., DATED JULY 2006 ARE APPLICABLE TO THIS PROJECT AND BY REFERENCE HEREBY ARE CONSIDERED A PART OF THESE PLANS:

STD. NO.	TITLE
1101.03	TEMPORARY ROAD CLOSURES
1101.05	WORK ZONE VEHICLE ACCESSES
1110.01	STATIONARY WORK ZONE SIGNS
1145.01	BARRICADES
1205.01	PAVEMENT MARKINGS - LINE TYPES & OFFSETS
1205.02	PAVEMENT MARKINGS - 2 LANE & MULTILANE ROADWAYS
1205.12	PAVEMENT MARKINGS - BRIDGES
1261.01	GUARDRAIL & BARRIER DELINEATOR SPACING
1261.02	GUARDRAIL & BARRIER DELINEATOR TYPES
1262.01	GUARDRAIL END DELINEATION

LEGEND

- GENERAL
- DIRECTION OF TRAFFIC FLOW
 - NORTH ARROW
 - PROPOSED PVMT. EXIST. PVMT.
 - WORK AREA
 - REMOVAL OF EXISTING PAVEMENT

TRAFFIC CONTROL DEVICES

- TYPE I BARRICADE
- TYPE II BARRICADE
- TYPE III BARRICADE
- CONE
- DRUM SKINNY DRUM
- FLASHING ARROW PANEL (TYPE C)
- STATIONARY SIGN
- PORTABLE SIGN
- STATIONARY OR PORTABLE SIGN
- CRASH CUSHION
- CHANGEABLE MESSAGE SIGN
- TRUCK MOUNTED IMPACT ATTENUATOR (TMIA)
- POLICE
- FLAGGER

PAVEMENT MARKINGS

- CRYSTAL/CRYSTAL PAVEMENT MARKER
- YELLOW/YELLOW PAVEMENT MARKER
- CRYSTAL/RED PAVEMENT MARKER
- PAVEMENT MARKING SYMBOLS

APPROVED: DATE:	PLAN PREPARED BY: N.C.D.O.T. WORK ZONE TRAFFIC CONTROL UNIT
	STUART BOURNE, P.E. TRAFFIC CONTROL ENGINEER
	JOSEPH ISHAK, P.E. TRAFFIC CONTROL PROJECT ENGINEER
	HABIB LAWANDOS TRAFFIC CONTROL PROJECT DESIGN ENGINEER
	JOE FUTRELL TRAFFIC CONTROL DESIGN ENGINEER

TIP PROJECT:

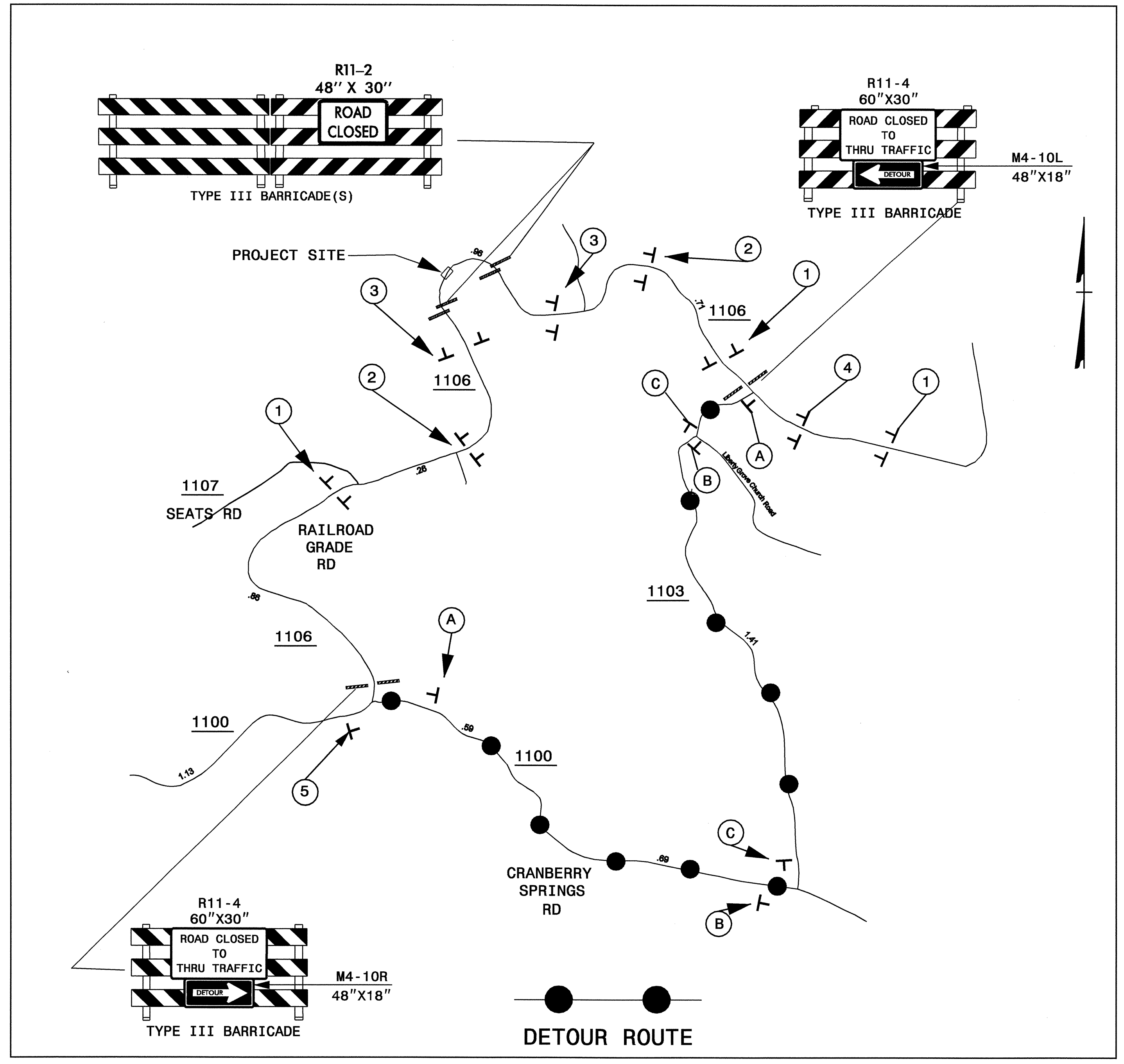

PHASING

- STEP 1.** USING SHEET TCP-2, INSTALL DETOUR SIGNS AND PLACE TYPE III BARRICADES TO CLOSE SR 1106 (RAILROAD GRADE ROAD) TO THRU TRAFFIC AND DETOUR TRAFFIC ONTO PROPOSED DETOUR.
- MAINTAIN ACCESS TO ALL DRIVEWAYS WITHIN THE PROJECT LIMITS.
- STEP 2.** AWAY FROM TRAFFIC, PERFORM THE FOLLOWING:
- REMOVE EXISTING STRUCTURE NO. 85 AND CONSTRUCT PROPOSED STRUCTURE FROM -L- STA. 17+02 +/- TO -L- STA. 18+02 +/-.
 - CONSTRUCT PROPOSED ROADWAY FROM -L- STA. 15+17 +/- TO -L- STA. 20+60 +/- UP TO AND INCLUDING THE FINAL SURFACE LAYER.
 - COMPLETE ALL DRAINAGE WORK WITHIN THE PROJECT LIMITS.
 - PLACE FINAL PAVEMENT MARKINGS (PAINT) ON -L- AND TIE IN WITH EXISTING PAVEMENT MARKINGS FROM -L- STA. 15+17 +/- TO -L- STA. 20+60 +/-.
- STEP 3.** REMOVE ALL TRAFFIC CONTROL DEVICES AND DETOUR SIGNS. OPEN SR 1106 (RAILROAD GRADE ROAD) TO ALL TRAFFIC.

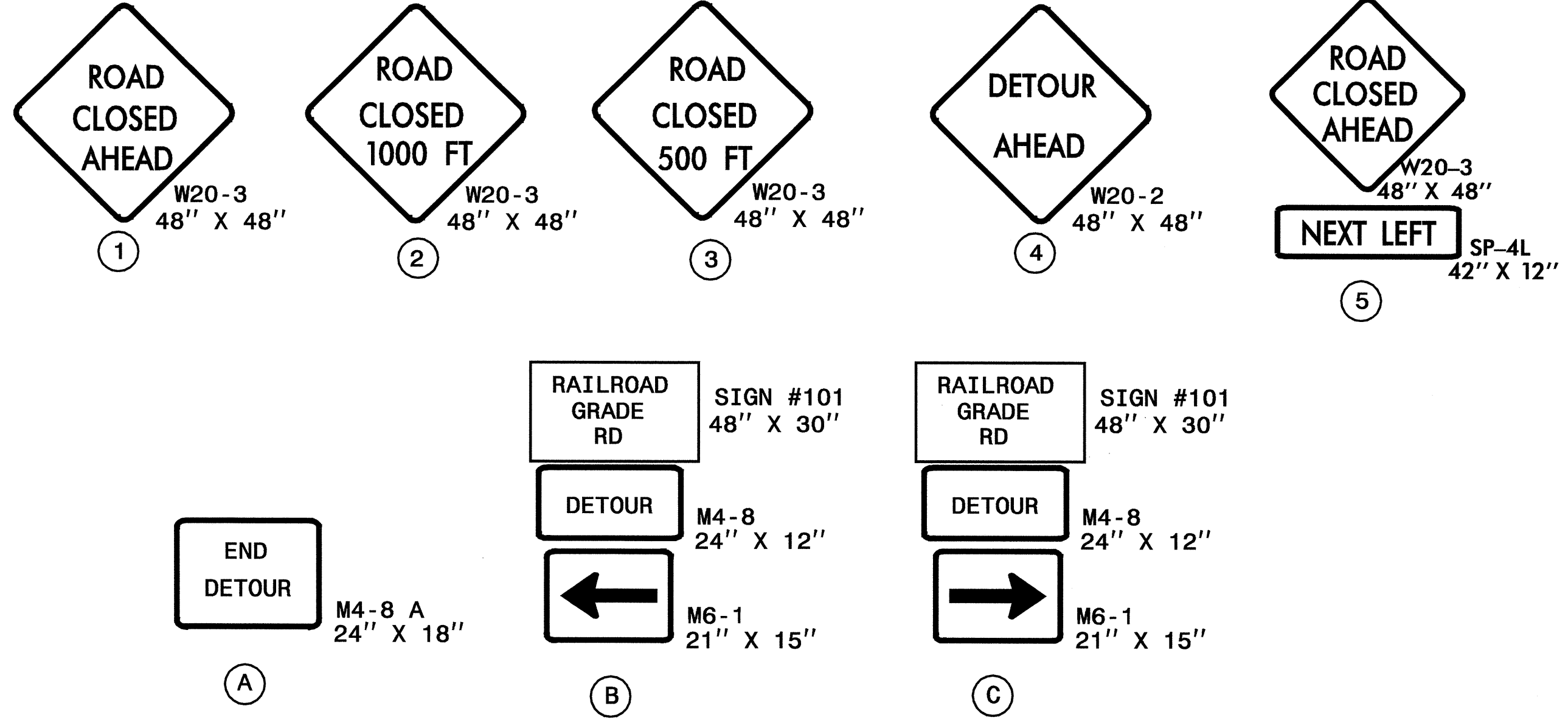

Final Pavement Marking Schedule

SYMBOL	DESCRIPTION	TIP Project # B-4011		PAY ITEM QUANTITY BREAKDOWN		TOTAL QUANTITY
		FINAL PAVEMENT MARKINGS	PAINT(4")			
PA	WHITE EDGELINE (2X)		2200	LF		
PI	YELLOW DOUBLE CENTER (2X)		2200	LF		
					TOTAL	4400 LF

NOTE: FOR EACH PAINT PAVEMENT MARKING ITEM, 1X IMPLIES A SINGLE APPLICATION, 2X IMPLIES TWO APPLICATIONS, AND 3X IMPLIES THREE APPLICATIONS.

REFER TO RSD 1101.03 FOR SIGNS SPACING

APPROVED:	DATE: Oct 26, 2007	PHASING, DETOUR SIGNING AND FINAL PAVEMENT MARKING SCHEDULE	
SCALE: NONE	DATE: OCT. 07		REVISIONS
DWG. BY: JLF	DESIGN BY: JLF		
REVIEWED BY: HAL			

26-OCT-2007 12:30 \\s04\p01\proj\1101\traffic\trafficcontrol\tcp\det.dgn