

T.I.P. NO.	SHEET NO.
B-4279	UC-1

STATE OF NORTH CAROLINA
DIVISION OF HIGHWAYS

**UTILITY CONSTRUCTION PLANS
STANLY COUNTY**

LOCATION: BRIDGE NO. 120 ON SR 1963 (ST. MARTIN ROAD) OVER SCALY BARK CREEK
TYPE OF WORK: UTILITIES

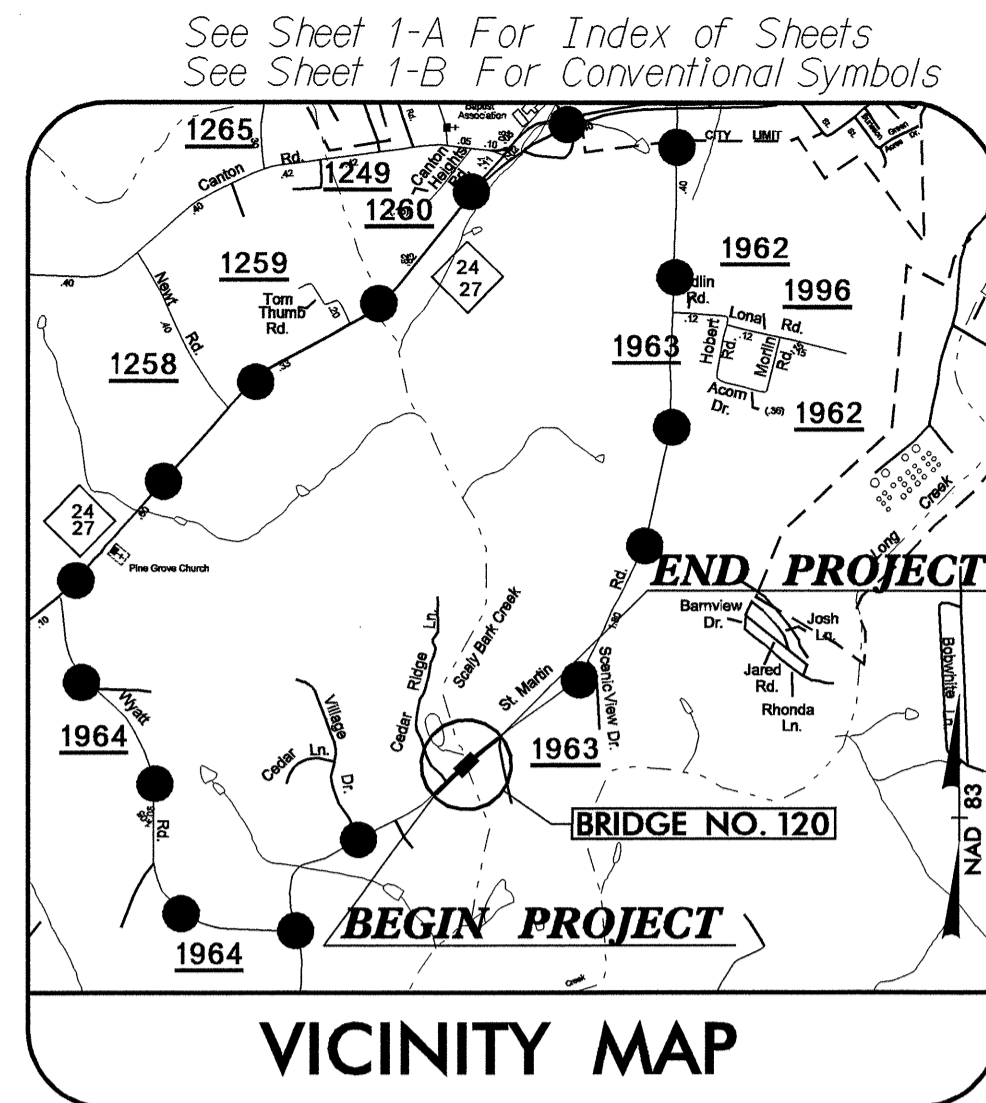

VICINITY MAP

(THIS PROJECT IS NOT INCLUDED WITHIN ANY MUNICIPAL BOUNDARIES)

●●● OFFSITE DETOUR

** DESIGN EXCEPTION FOR VERTICAL ALIGNMENT AND VERTICAL STOPPING SIGHT DISTANCE.

TIP: B-4279

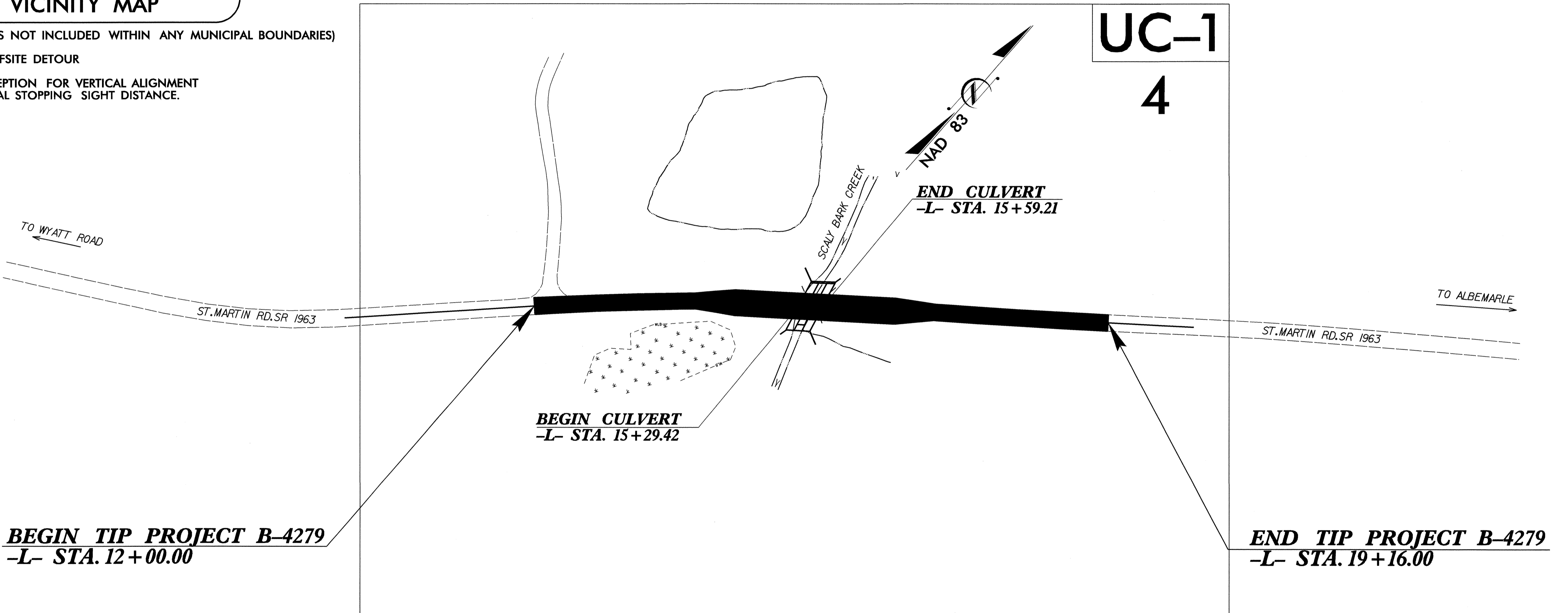

INDEX OF SHEETS	
SHEET NO.	DESCRIPTION
UC-1	TITLE SHEET
UC-2	UTILITY CONSTRUCTION PLAN SHEET
UC-2	PROFILE SHEET
UC-3	DETAILS SHEET

WATER AND SEWER OWNERS ON PROJECT

(1) TOWN OF OAKBORO

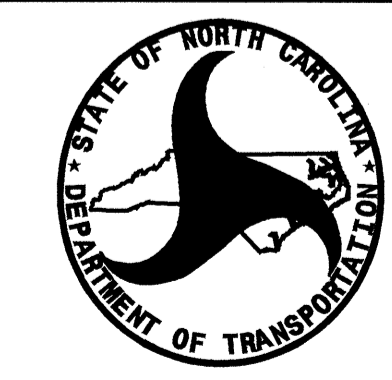
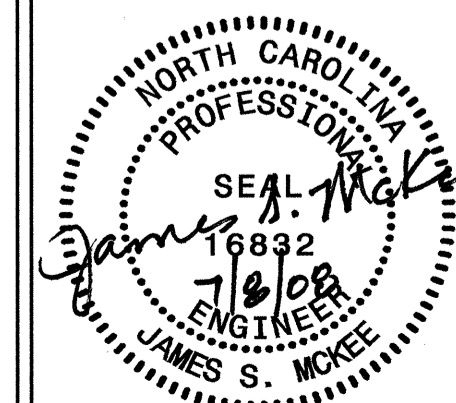

PREPARED IN THE OFFICE OF:
**DIVISION OF HIGHWAYS
PROJECT SERVICES
UTILITY SECTION**
1591 MAIL SERVICES CENTER
RALEIGH NC 27699-1591
PHONE (919) 250-4128
FAX (919) 250-4119

Roger Worthington, P.E. UTILITIES SECTION ENGINEER
Steve McKee, P.E. UTILITIES SQUAD LEADER PROJECT ENGINEER
Alonza Yancey UTILITIES PROJECT DESIGNER

01-JUL-2008 09:10
F:\Utilities\fdy\uf\proj\b4279-uf\lucL.tsh.dgn
\$\$\$\$\$USERNAME\$\$\$\$\$

ALL WATER LINES ON THIS PROJECT ARE OWNED BY THE TOWN OF OAKBORO.

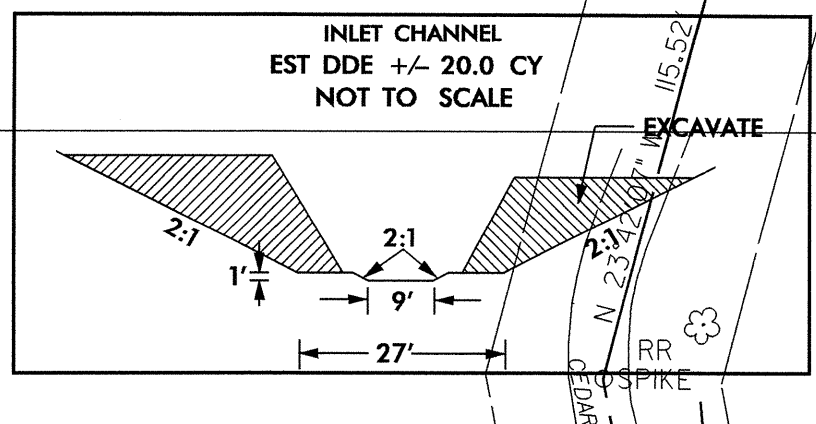
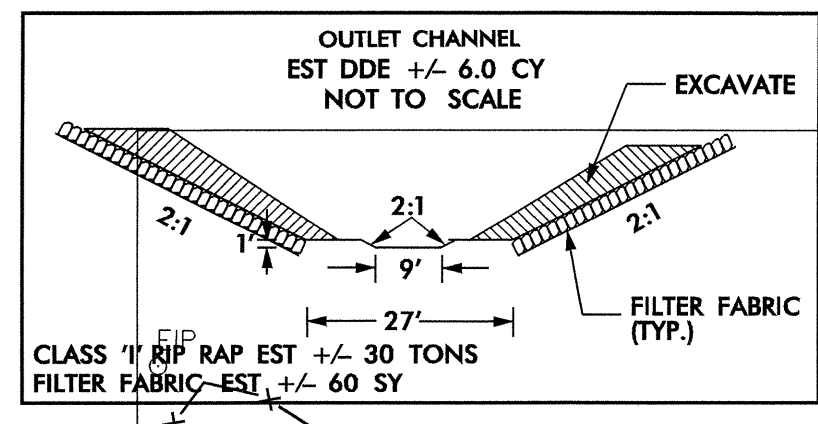
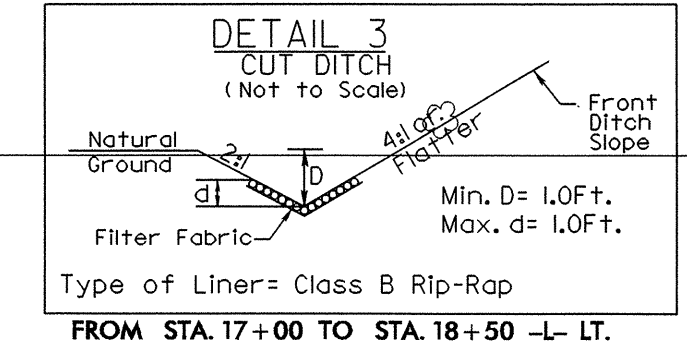

-L-
PI Sta 13+50.29
 $\Delta = 6' 27" 45.3' (RT)$
 $D = 2' 51" 53.2'$
 $L = 225.59'$
 $T = 112.91'$
 $R = 2,000.00'$
 $DS = 60 MPH$
 $e(max) = 0.04 FT/FT$

PROP. 190' OF 12" WATER LINE
95' TRENCHLESS INSTALLATION OF 12" IN SOIL
95' TRENCHLESS INSTALLATION OF 12" NOT IN SOIL

END TIP PROJECT B-4279
-L- POT STA. 19+16.00
END OVERLAY

BEGIN TIP PROJECT B-4279
-L- POT STA. 12+00.00
BEGIN OVERLAY

NOTE: THE CONTRACTOR'S ATTENTION IS DIRECTED TO SECTIONS 1550, 102 AND 107 OF THE STANDARD SPECIFICATIONS CONCERNING THE TRENCHLESS INSTALLATION. NO DAMAGE IS ALLOWED TO THE WETLANDS OR STREAM BY THE TRENCHLESS INSTALLATION. THE CONTRACTOR'S ENGINEER SHALL DESIGN THE INSTALLATION METHOD AND PROVIDE ON-SITE OVERSIGHT.

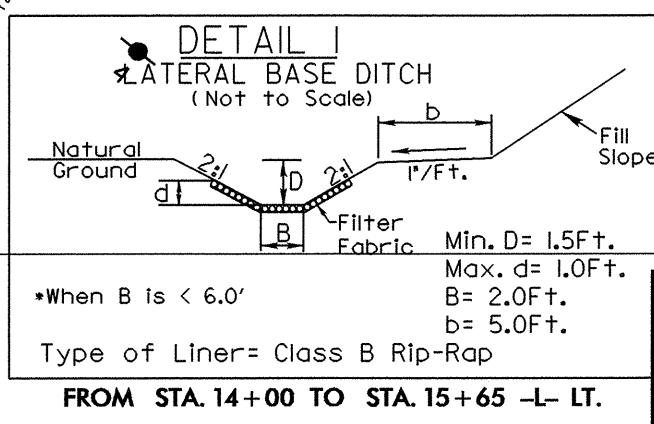

NOTE: 12" WATER LINE SHALL BE D.I.R.J., PC 350
THE CONTRACTOR WILL BE REQUIRED TO LIMIT INTERUPTION OF SERVICE TO WATER LINE TO A ONE TIME MAXIMUM 8 HOURS PERIOD.

PROP. 311' OF 12" WATER LINE

PROP. 1- RELOCATE WATER METER

PROP. 12" GATE VALVE

PROP. 12" GATE VALVE

PROP. 110'- ABANDON 12" WATER MAIN

PROP. 135'- ABANDON 12" WATER MAIN

REVISIONS

430
420
410
400
390
380
370
360

430
420
410
400
390
380
370
360

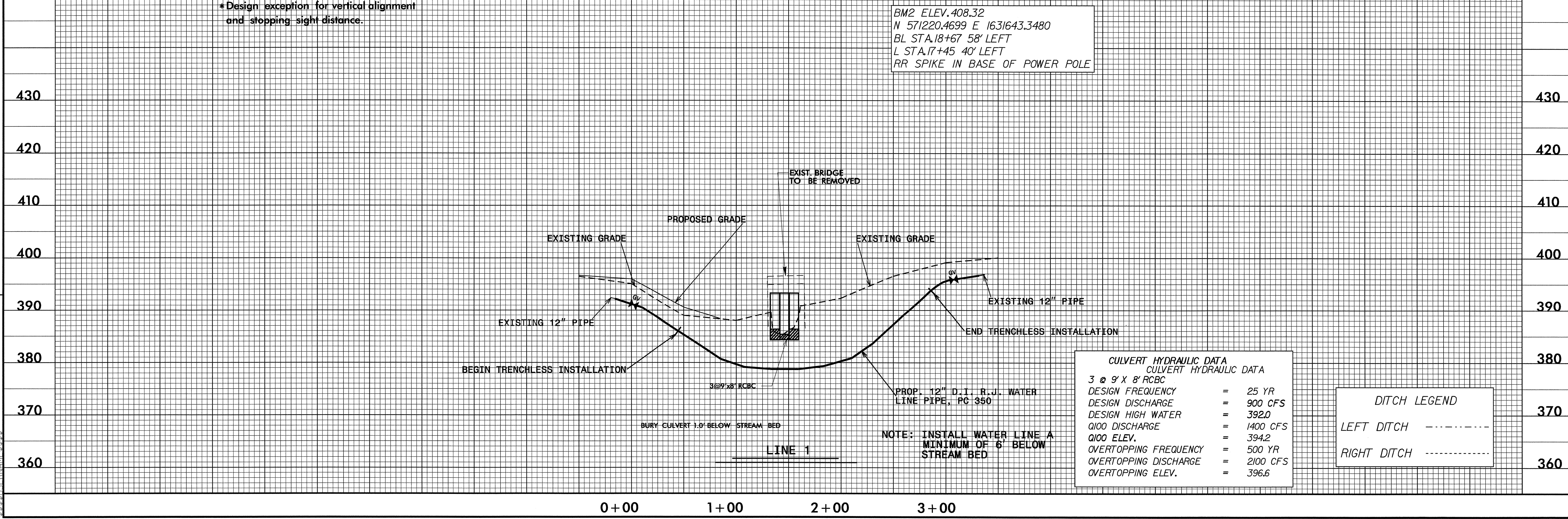

BM2 ELEV. 408.32
N 571220.4699 E 1631643.3480
BL STA. 18+67 58' LEFT
L STA. 17+45 40' LEFT
RR SPIKE IN BASE OF POWER POLE

CULVERT HYDRAULIC DATA		CULVERT HYDRAULIC DATA	
3 @ 9' X 8' RCBC		DESIGN FREQUENCY	= 25 YR
		DESIGN DISCHARGE	= 900 CFS
		DESIGN HIGH WATER	= 392.0
		Q100 DISCHARGE	= 1400 CFS
		Q100 ELEV.	= 394.2
		OVERTOPPING FREQUENCY	= 500 YR
		OVERTOPPING DISCHARGE	= 2100 CFS
		OVERTOPPING ELEV.	= 396.6

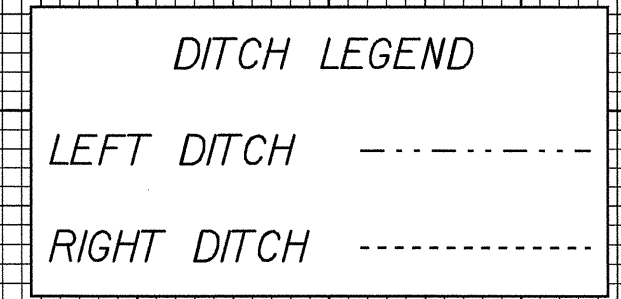

08-JUL-2008 12:32
r:\utilities\psh\d4279\util\uc2_psh.dgn

09/08/99

See Sheet 1-A For Index of Sheets
See Sheet 1-B For Conventional Symbols

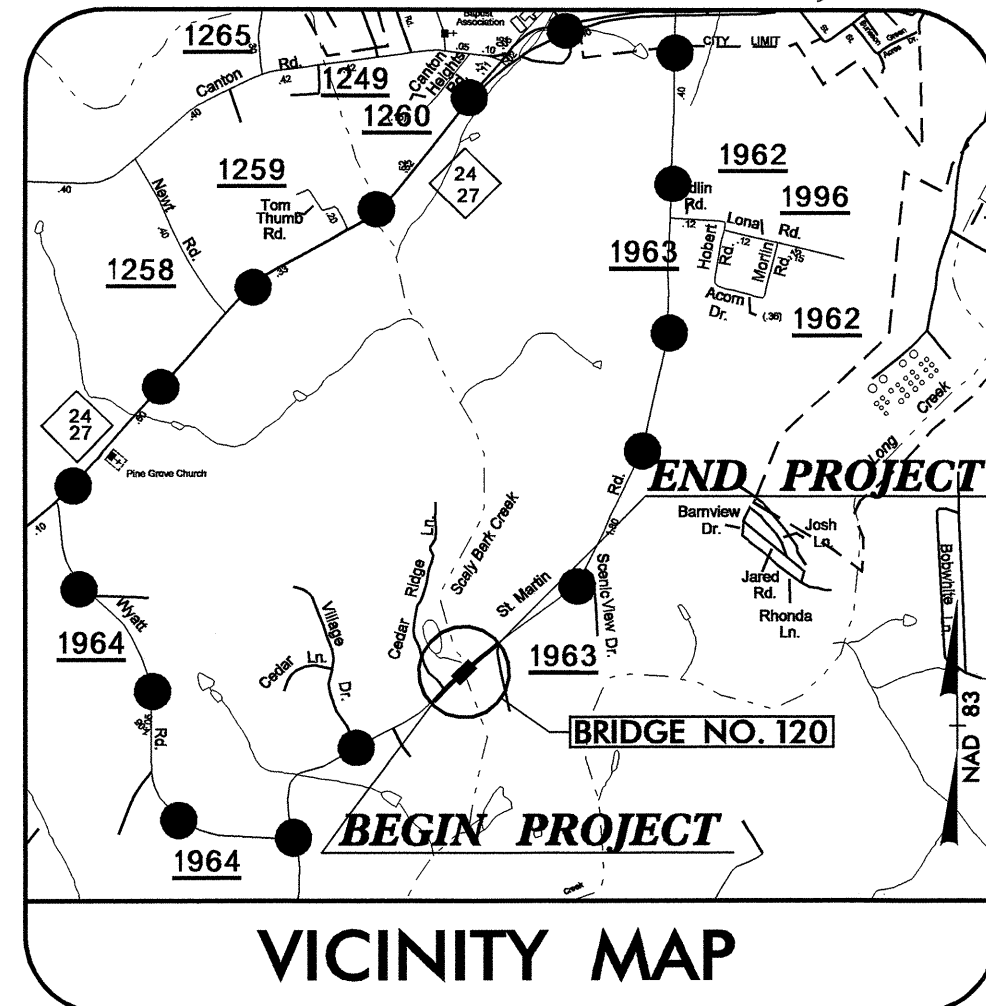

VICINITY MAP

(THIS PROJECT IS NOT INCLUDED WITHIN ANY MUNICIPAL BOUNDARIES)

●●● OFFSITE DETOUR

** DESIGN EXCEPTION FOR VERTICAL ALIGNMENT
AND VERTICAL STOPPING SIGHT DISTANCE.

STATE OF NORTH CAROLINA
DIVISION OF HIGHWAYS

**UTILITIES BY OTHERS PLANS
STANLY COUNTY**

**LOCATION: BRIDGE NO. 120 ON SR 1963 (ST.
MARTIN ROAD) OVER SCALY BARK CREEK**

TYPE OF WORK: UTILITIES

T.I.P. NO.	SHEET NO.
B-4279	U0-1

TIP: B-4279

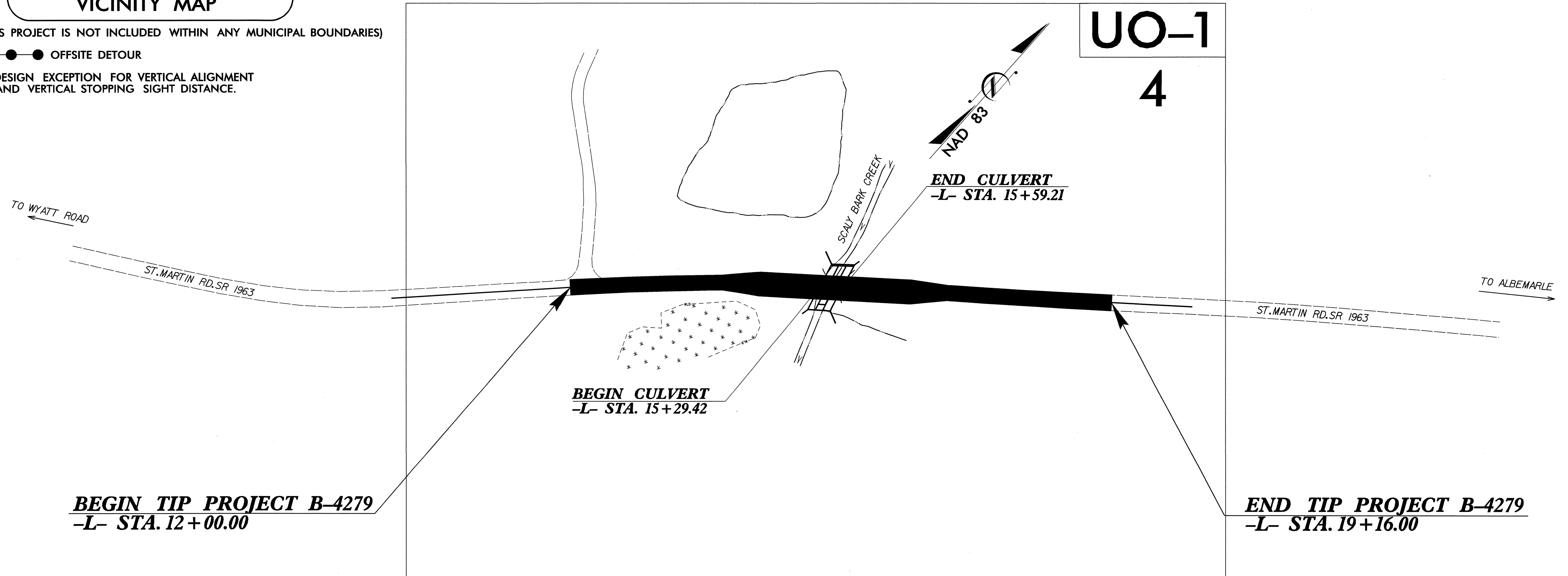

INDEX OF SHEETS	
SHEET NO.	DESCRIPTION
U0-1	TITLE SHEET
U0-2	UTILITIES BY OTHERS PLAN SHEET

UTILITY OWNERS ON PROJECT
(1) UNION POWER COOPERATIVE
(2) WINDSTREAM (TELEPHONE)
(3) TIME WARNER (CABLE)

PREPARED IN THE OFFICE OF:
**DIVISION OF HIGHWAYS
PROJECT SERVICES
UTILITY SECTION**

1591 MAIL SERVICES CENTER
RALEIGH NC 27699-1591
PHONE (919) 250-4128
FAX (919) 250-4119

<u>Roger Worthington, P.E.</u>	UTILITIES SECTION ENGINEER
<u>Steve McKee, P.E.</u>	UTILITIES SQUAD LEADER PROJECT ENGINEER
<u>Alonza Yancey</u>	UTILITIES PROJECT DESIGNER

UTILITIES BY OTHERS

NOTE:
ALL PROPOSED UTILITY WORK
SHOWN ON THIS SHEET WILL
BE DONE BY OTHERS

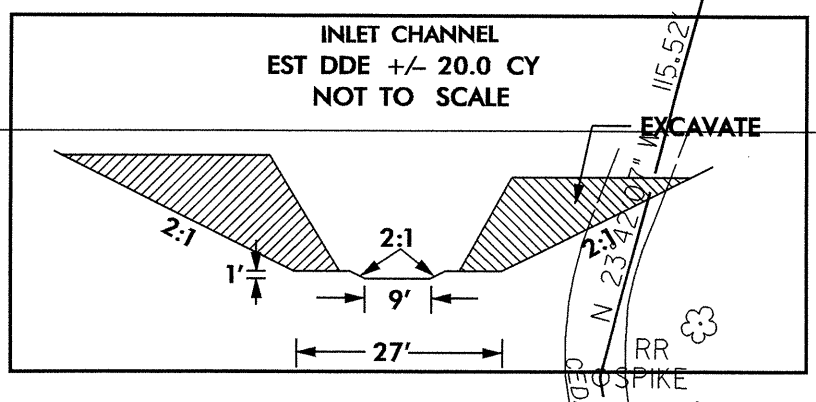
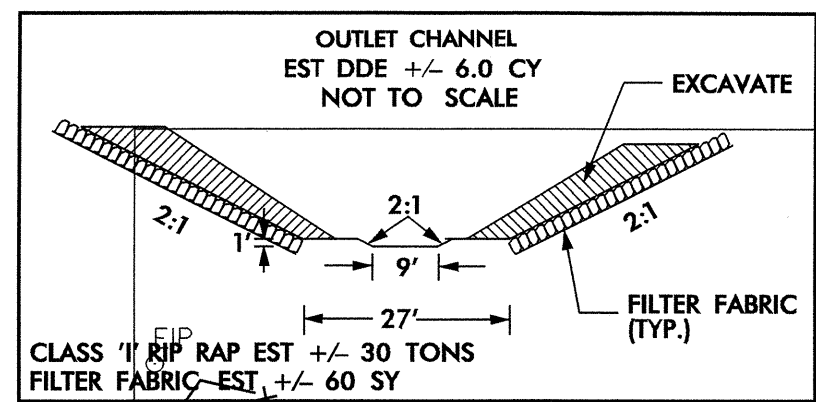
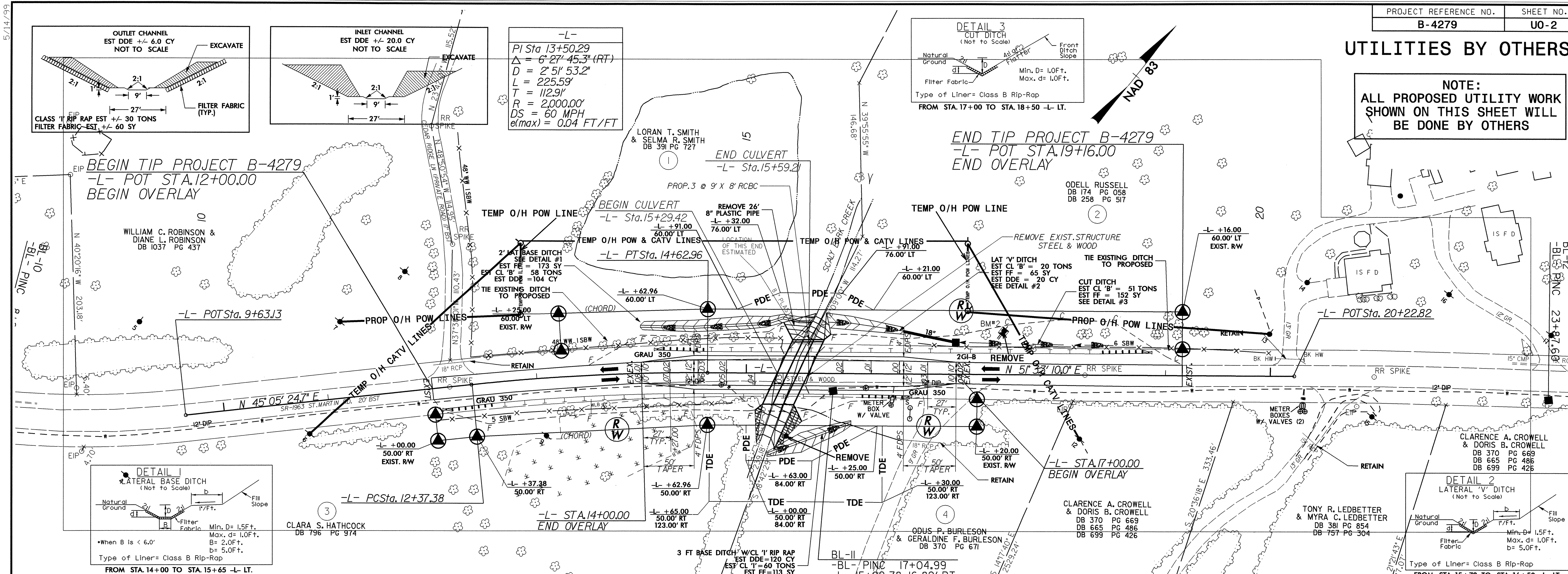

-L-
PI Sta 13+50.29
Δ = 6' 27" 45.3' (RT)
D = 2' 51" 53.2'
L = 225.59'
T = 112.91'
R = 2,000.00'
DS = 60 MPH
d(max) = 0.04 FT/FT

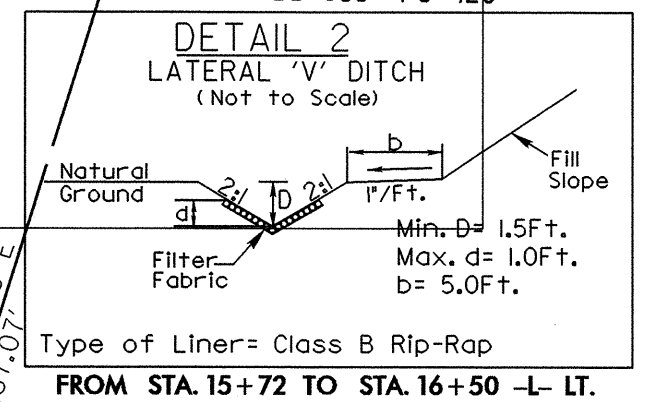
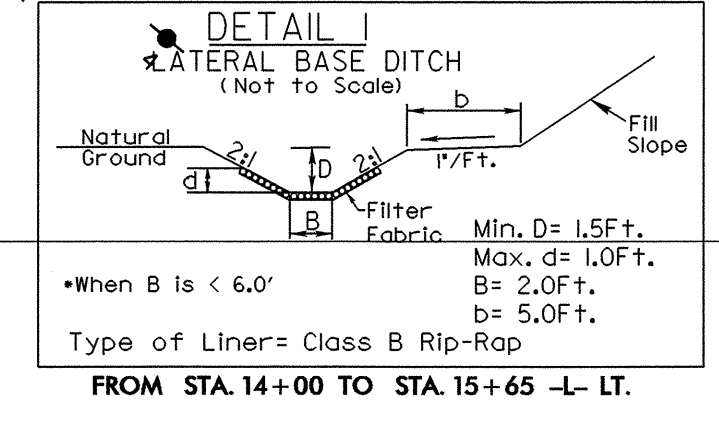
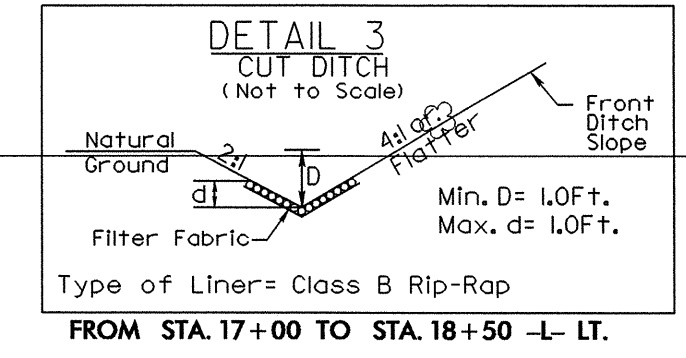

	*Design exception for vertical alignment and stopping sight distance.	
430		430
420		420
410		410
400		400
390		390
380	BMI ELEV. 431.54 N 570384.4520 E 1630574.9470 BL STA. 5+05 26' RIGHT RR SPIKE IN BASE OF POWER POLE	380
370	BM3 ELEV. 433.40 N 571640.3899 E 1632290.6490 BL STA. 26+34 31' RIGHT RR SPIKE IN BASE OF FENCE POST	370
360	NOTE: BENCH MARK 1 & BENCH MARK 3 ARE LOCATED OUTSIDE OF PROJECT LIMITS.	360

BM2 ELEV. 408.32
N 571220.4699 E 1631643.3480
BL STA. 18+67 58' LEFT
L STA. 17+45 40' LEFT
RR SPIKE IN BASE OF POWER POLE

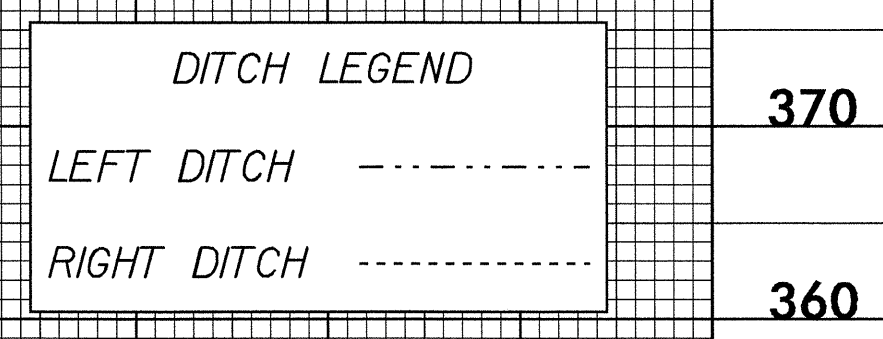

07-JUL-2008 14:11 r:\utilities\rd\psh\proj\B4279\util\uo2_psh.dgn