

TIP PROJECT: B-4665

STATE OF NORTH CAROLINA
DIVISION OF HIGHWAYS

PLAN FOR PROPOSED
HIGHWAY EROSION CONTROL

WARREN COUNTY

**LOCATION: Bridge No. 36 Over Hawtree Creek
on SR 1304 (Cole Farm Road)**

TYPE OF WORK: Grading, Paving, Drainage, Structure

STATE	STATE PROJECT REFERENCE NO.	SHEET NO.	TOTAL SHEETS
N.C.	B-4665	EC-1	
STATE PROJ. NO.	F.A. PROJ. NO.	DESCRIPTION	

EROSION AND SEDIMENT CONTROL MEASURES

Std. #	Description	Symbol
1630.03	Temporary Silt Ditch	--- rtd ---
1630.05	Temporary Diversion	--- td ---
1605.01	Temporary Silt Fence	
1606.01	Special Sediment Control Fence	--- / \ / \ / \ ---
1622.01	Temporary Berms and Slope Drains	--- T ---
1630.01	Riser Basin	--- R ---
	Silt Basin Type B	--- S ---
1633.01	Temporary Rock Silt Check Type-A	--- X ---
	Temporary Rock Silt Check Type-B	--- Y ---
	Wattle	--- W ---
1634.01	Temporary Rock Sediment Dam Type-A	--- A ---
1634.02	Temporary Rock Sediment Dam Type-B	--- B ---
1635.01	Rock Pipe Inlet Sediment Trap Type-A	--- C ---
1635.02	Rock Pipe Inlet Sediment Trap Type-B	--- D ---
1630.04	Stilling Basin	--- E ---
1630.06	Special Stilling Basin	--- F ---
	Rock Inlet Sediment Trap:	
1632.01	Type A	--- G ---
1632.02	Type B	--- H ---
1632.03	Type C	--- I ---
	Skimmer Basin	--- J ---
	Tiered Skimmer Basin	--- K ---
	Infiltration Basin	--- L ---

**THIS PROJECT CONTAINS
EROSION CONTROL PLANS
FOR CLEARING AND
GRUBBING PHASE OF
CONSTRUCTION.**

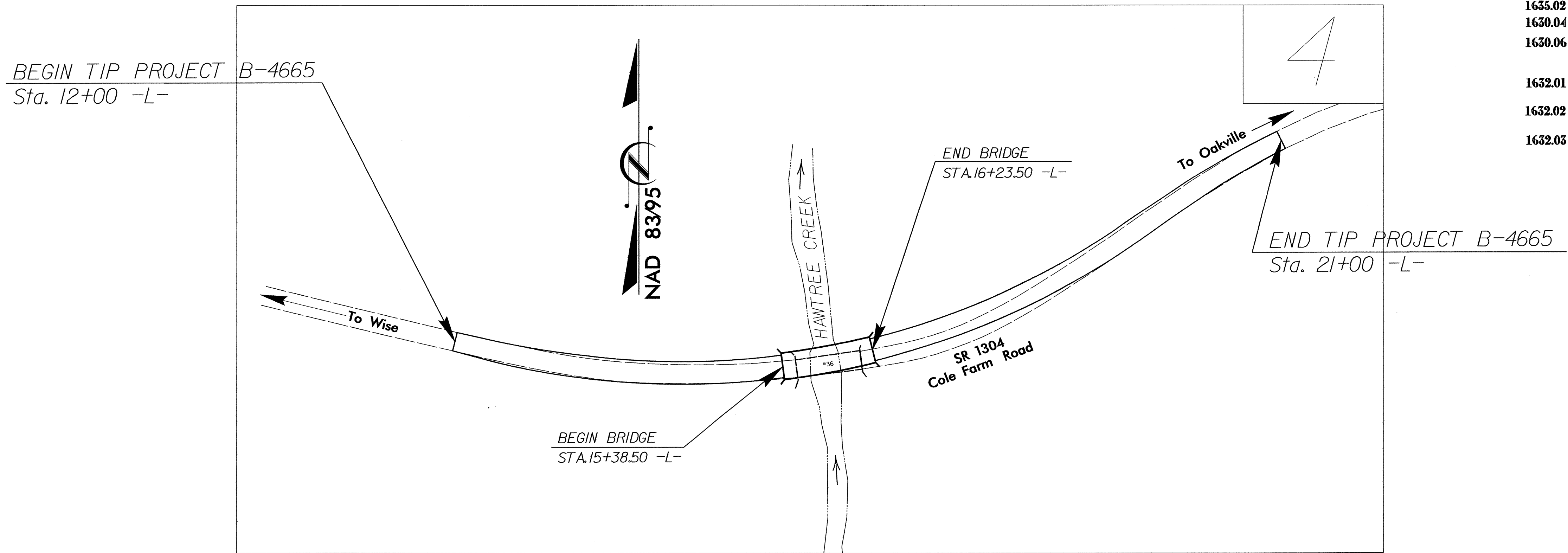

GRAPHIC SCALE

0
[Scale Bar]
PLANS

0
[Scale Bar]
PROFILE (HORIZONTAL)

0
[Scale Bar]
PROFILE (VERTICAL)

ROADSIDE ENVIRONMENTAL UNIT
DIVISION OF HIGHWAYS
STATE OF NORTH CAROLINA

Prepared In the Office of:
ROADSIDE ENVIRONMENTAL UNIT
1 South Wilmington St.
Raleigh, NC 27611
2006 STANDARD SPECIFICATIONS

Roadway Standard Drawings

The following roadway english standards as appear in "Roadway Standard Drawings"- Roadway Design Unit - N. C. Department of Transportation - Raleigh, N. C., dated July 18, 2006 and the latest revision thereto are applicable to this project and by reference hereby are considered a part of these plans.

1605.01 Temporary Silt Fence	1632.03 Rock Inlet Sediment Trap Type C
1607.01 Gravel Construction Entrance	1633.01 Temporary Rock Silt Check Type A
1622.01 Temporary Berms and Slope Drains	1634.02 Temporary Rock Sediment Dam Type B
1630.05 Temporary Diversion	

02 JUL 2008 09:55
projects\6\4665\roadside\environmental\details\4665-rdly-tsh.dgn
nchan 21 PLEN231812

PROJECT REFERENCE NO.	SHEET NO.
B-4665	EC-2
RW SHEET NO.	
ROADWAY DESIGN ENGINEER	HYDRAULICS ENGINEER

TEMPORARY ROCK SILT CHECK TYPE 'B' DETAIL

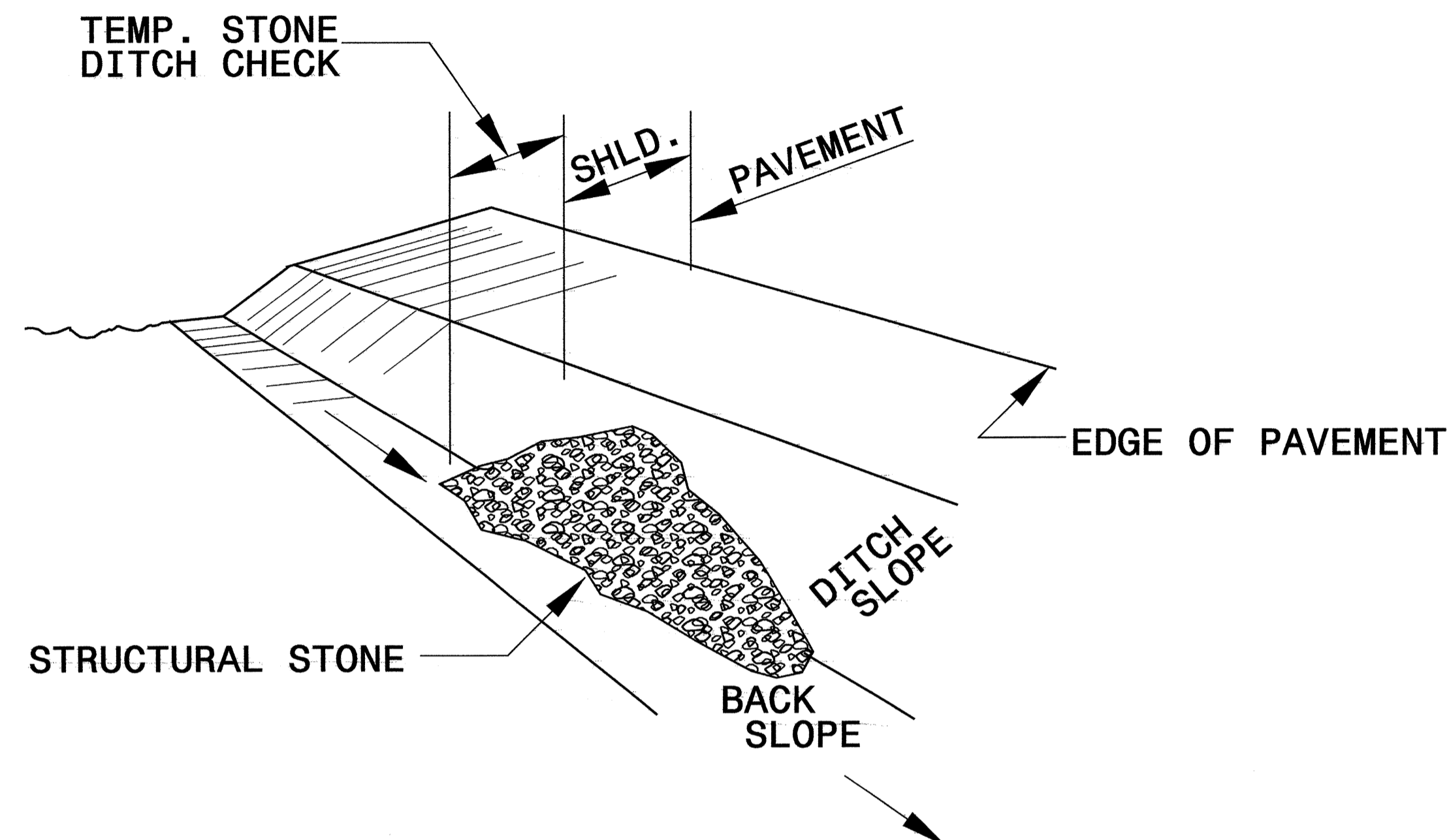

ISOMETRIC VIEW

NOTES:

USE CLASS 'B' EROSION CONTROL STONE FOR STRUCTURAL STONE.

THE ENGINEER MAY DIRECT THE OPTION OF CLASS "A" STONE FOR SITES HAVING LESS THAN ONE (1) ACRE DRAINAGE AREA AND A DITCH GRADE LESS THAN 3%.

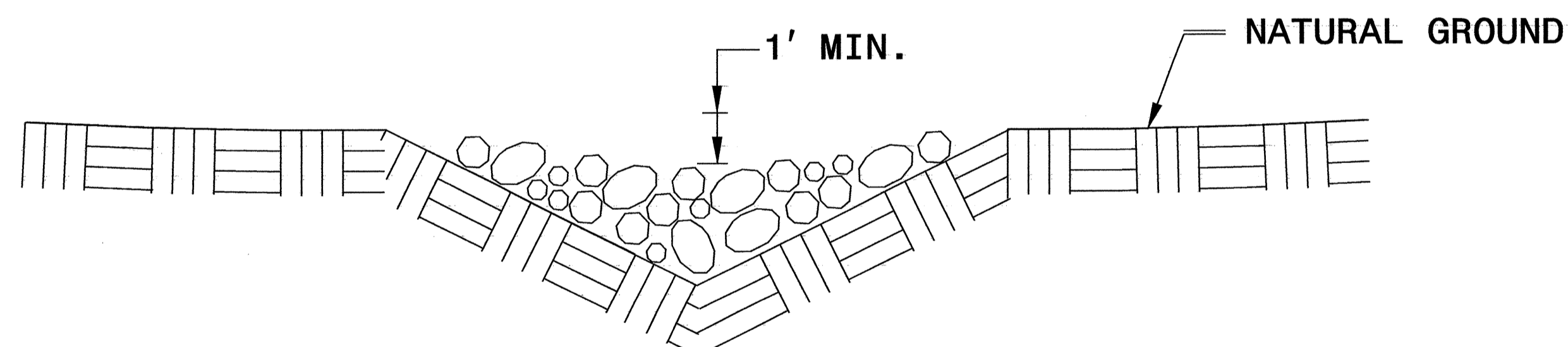

CROSS SECTION VEE DITCH

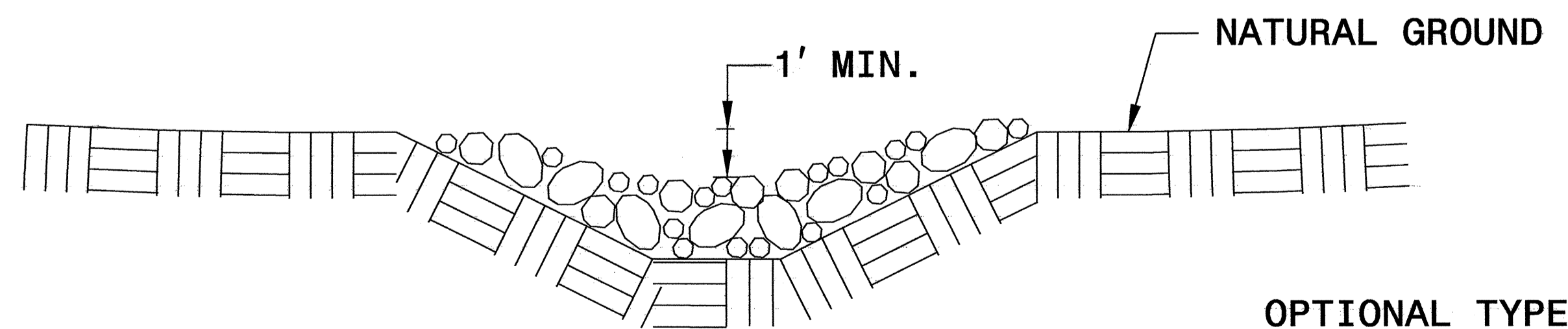

CROSS SECTION TRAPEZOIDAL DITCH

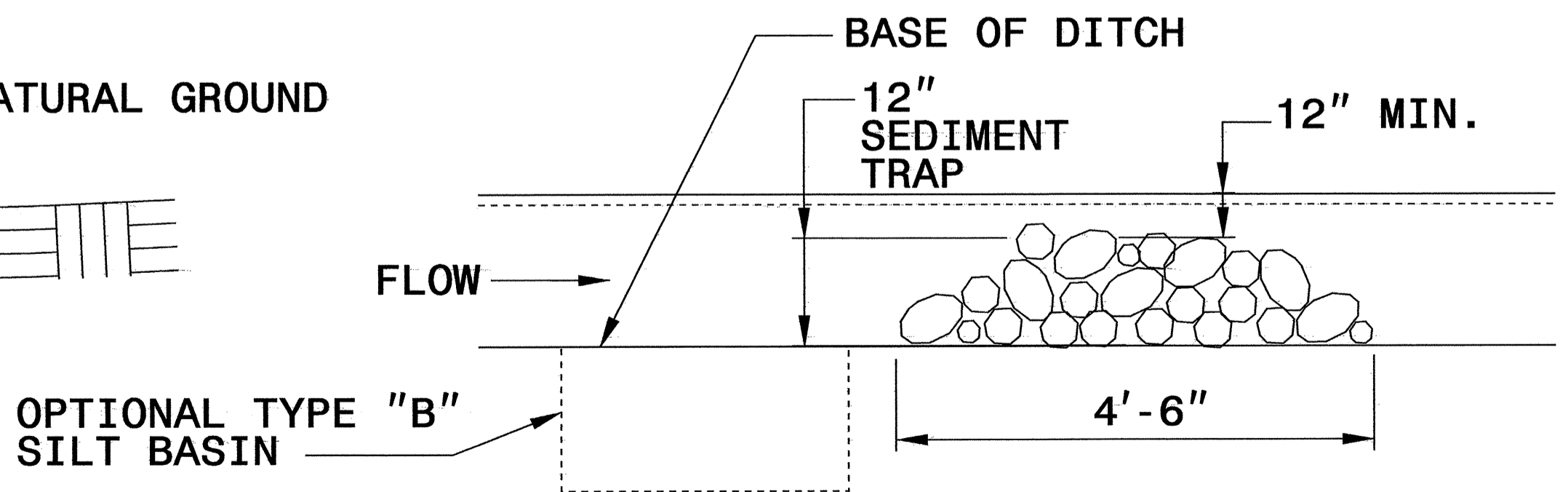

ELEVATION VIEW

PROJECT REFERENCE NO. B-4665	SHEET NO. EC-2A
RW SHEET NO.	
ROADWAY DESIGN ENGINEER	HYDRAULICS ENGINEER

COIR FIBER BAFFLE DETAIL

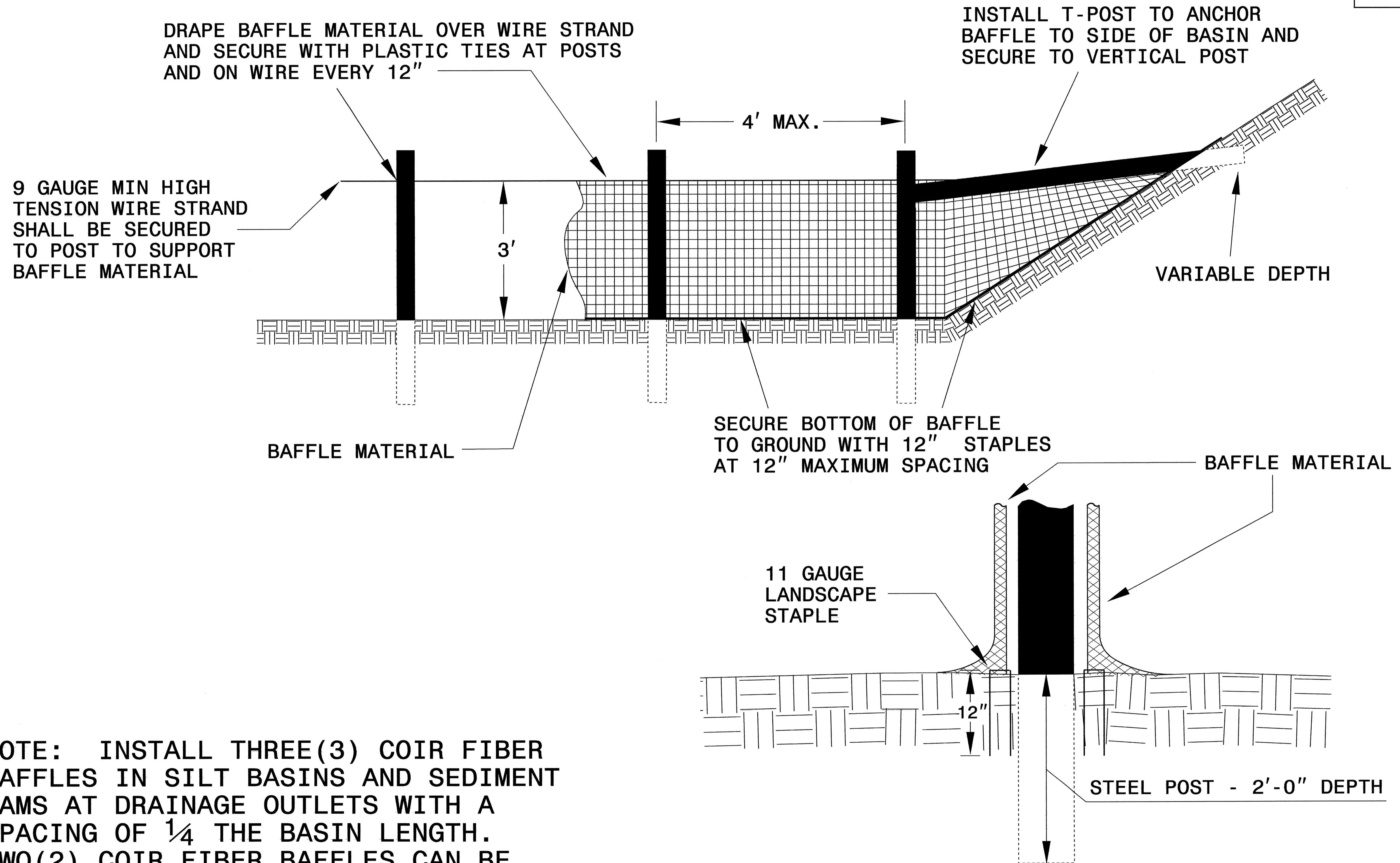

NOTE: INSTALL THREE(3) COIR FIBER BAFFLES IN SILT BASINS AND SEDIMENT DAMS AT DRAINAGE OUTLETS WITH A SPACING OF $\frac{1}{4}$ THE BASIN LENGTH. TWO(2) COIR FIBER BAFFLES CAN BE INSTALLED IN SILT BASINS AND DAMS LESS THAN 20 FT. IN LENGTH WITH A SPACING OF $\frac{1}{3}$ THE BASIN LENGTH.

BAFFLE MATERIAL SHALL BE SECURED TO THE BOTTOM AND SIDES OF BASIN USING 12" LANDSCAPE STAPLES

8/17/99

CLEARING AND GRUBBING
EROSION CONTROL FOR
CONSTRUCTION SHEET 4

NOTE:
UTILIZE TEMPORARY ROCK SEDIMENT DAM TYPE - B
AND TEMPORARY ROCK SILT CHECK TYPE - A
AS STILLING BASIN WHERE APPLICABLE.

NOTE:
PLACE TEMPORARY ROCK SEDIMENT DAMS TYPE - B
AND TEMPORARY ROCK SILT CHECKS TYPE - A AT
DRAINAGE OUTLETS.

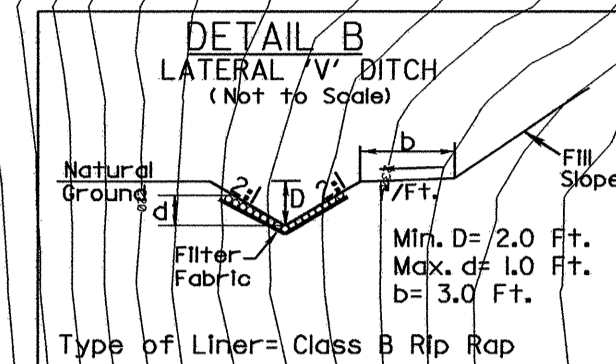
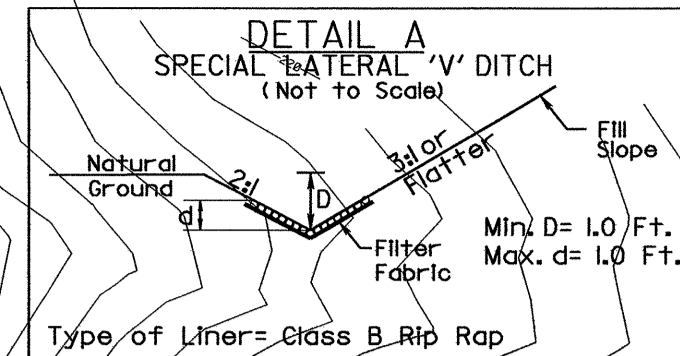
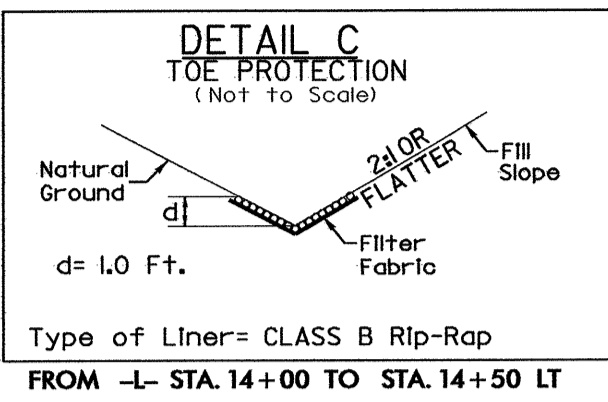

PROJECT REFERENCE NO. B-4665	SHEET NO. EC-4/CONST.4
ROADWAY DESIGN ENGINEER	HYDRAULICS ENGINEER

SBG=SHOULDER BERM GUTTER

POTSta. 24+00.84 -L-

End Tip Project B-4665
Sta. 21+00.00 -L-

34 x 16 x 3
5 ft. weir
ID 4.1B

45 x 16 x 3
5 ft. weir
ID 4.3B

END APPROACH SLAB
STA. 16+37.49 -L-

PTSta. 19+19.08 -L-

PTSta. 23+44.68 -L-

Begin Tip Project B-4665
Sta. 12+00.00 -L-

POTSta. 10+00.00 -L-

PCSta. 12+42.16 -L-

SEE DETAIL C
TOE PROTECTION
WCL B RIP RAP
-L- STA 14+00 - 14+50 LT
EST. 18 TONS
FILTER FABRIC
EST. 53 SY

CL B RIP RAP
EST. 1 TON
FILTER FABRIC
EST. 5 SY

CL B RIP RAP
EST. 1 TON
FILTER FABRIC
EST. 5 SY

SEE DETAIL A
SPECIAL LATERAL V DITCH WCL B RIP RAP
EST. 105 TONS, FILTER FABRIC EST. 314 SY
-L- STA 17+00 - 20+00 LT

END SBG
-L- STA 16+45 LT

SEE DETAIL A
SPECIAL LATERAL V DITCH WCL B RIP RAP
EST. 96 TONS, FILTER FABRIC EST. 288 SY
-L- STA 17+25 - 20+00 RT

SEE DETAIL B
LATERAL V DITCH WCL B RIP RAP
EST. 9 TONS, FILTER FABRIC EST. 27 SY
-L- STA 17+00 - 17+25 RT
DDE = 10 CY

+90.00 -L-
55.00', 65.00' RT

END BRIDGE
STA. 16+23.50 -L-

SEE DETAIL A
SPECIAL LATERAL V DITCH WCL B RIP RAP
EST. 18 TONS
FILTER FABRIC EST. 53 SY
-L- STA 14+00 - 14+50 RT

SEE DETAIL B
LATERAL V DITCH WCL B RIP RAP
EST. 25 TONS
FILTER FABRIC EST. 74 SY
-L- STA 14+50 - 15+20 RT
DDE = 25 CY

30 x 14 x 3
5 ft. weir
ID 4.2B

55 x 15 x 3
5 ft. weir
ID 4.4B

BEGIN BRIDGE
STA. 15+38.50 -L-

Note: Retained and redistribute existing
Rip Rap around existing interior bent
following removal.

Note: See sheet 5 for -L- profile.

Note: See sheets S-1 thru S- for Structure Plans.

02-JUN-2008 09:55
g:\tpprojects\ec-4\B-4665\environmental\design\b4665_rdy_psh04.dgn
chhan - B-4665-2312

8/17/99

NOTE: UTILIZE TEMPORARY ROCK SEDIMENT DAM TYPE - B AND TEMPORARY ROCK SILT CHECK TYPE - A AS STILLING BASIN WHERE APPLICABLE.

PROJECT REFERENCE NO.	SHEET NO.
B-4665	EC-5/CONST.4
RW SHEET NO.	
ROADWAY DESIGN ENGINEER	HYDRAULICS ENGINEER

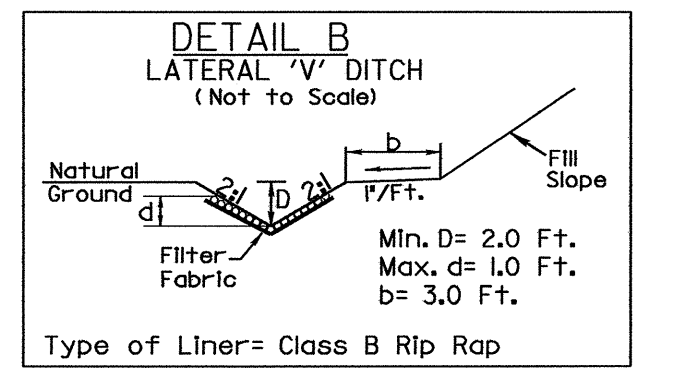
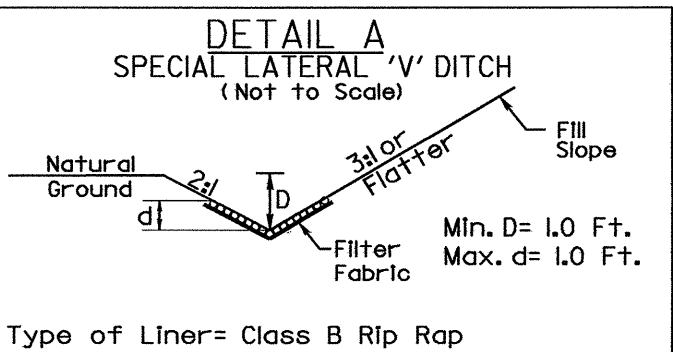
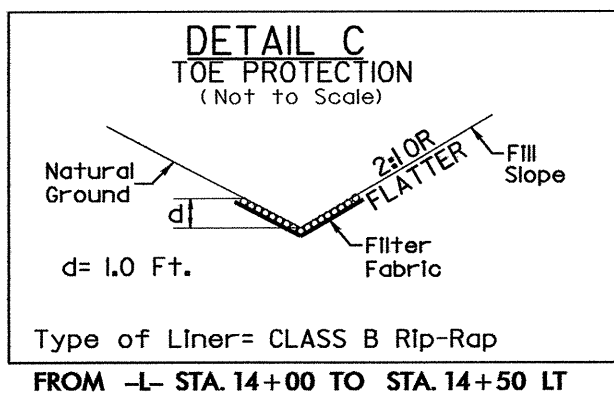

SBG = SHOULDER BERM GUTTER

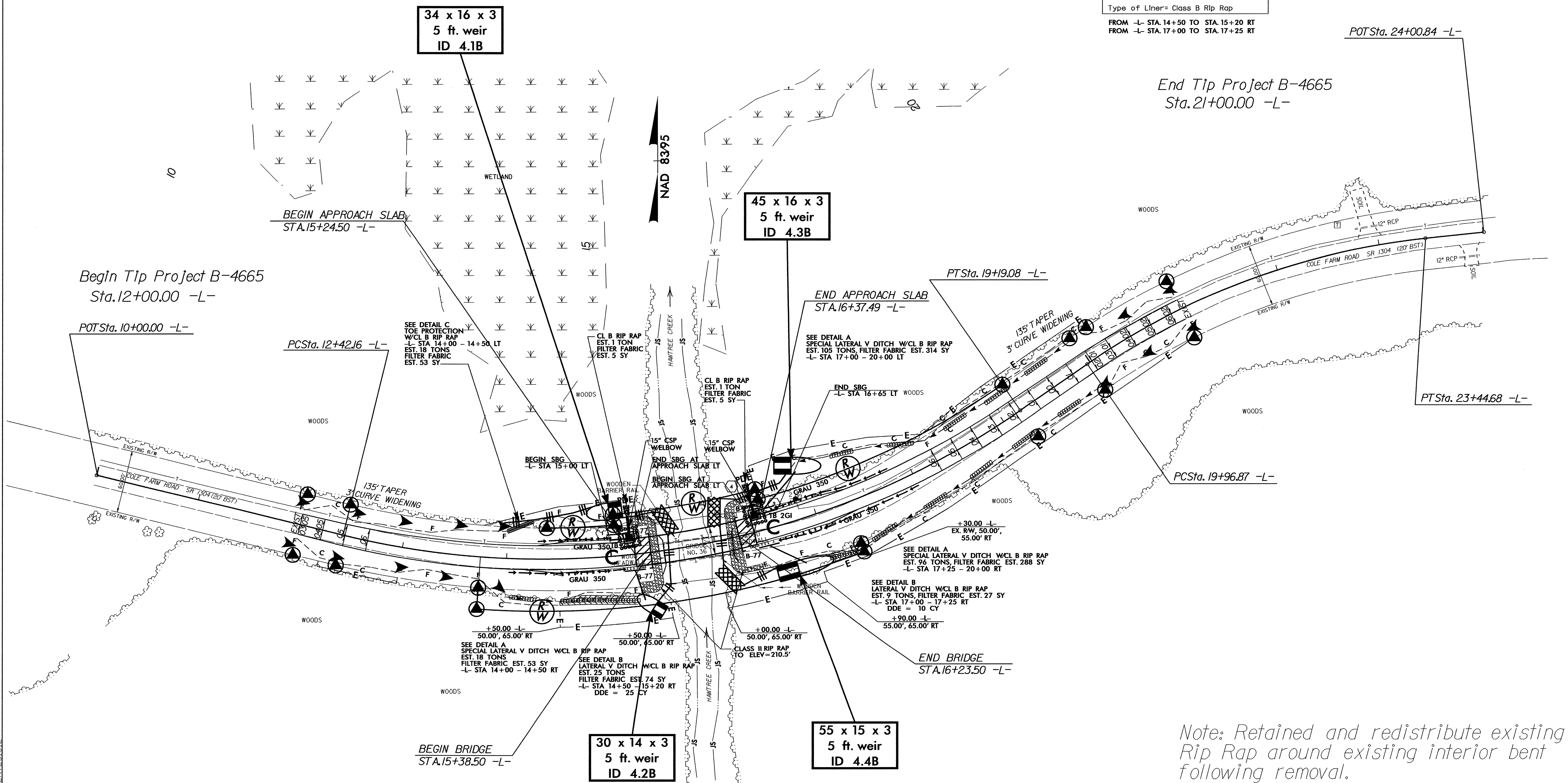

End Tip Project B-4665 Sta. 21+00.00 -L-

POT Sta. 24+00.84 -L-

Begin Tip Project B-4665 Sta. 12+00.00 -L-

POT Sta. 10+00.00 -L-

PC Sta. 12+42.16 -L-

END APPROACH SLAB STA. 16+37.49 -L-

PT Sta. 19+19.08 -L-

PT Sta. 23+44.68 -L-

PC Sta. 19+96.87 -L-

END BRIDGE STA. 16+23.50 -L-

BEGIN BRIDGE STA. 15+38.50 -L-

Note: Retained and redistribute existing Rip Rap around existing interior bent following removal.

Note: See sheet 5 for -L- profile. Note: See sheets S-1 thru S- for Structure Plans.

02-JUN-2008 09:55 g:\tppro\jeff\design\environmental\design\b4665-rdy-ps04.dgn AT: RENV23182