

**TIP PROJECT: B-4116**

STATE OF NORTH CAROLINA  
DIVISION OF HIGHWAYS

---

PLAN FOR PROPOSED  
HIGHWAY EROSION CONTROL

---

**GASTON COUNTY**

**LOCATION: BRIDGE NO. 148 OVER BEAVER DAM CREEK  
ON SR 1618**

**TYPE OF WORK: GRADING, PAVING, DRAINAGE, AND STRUCTURE**

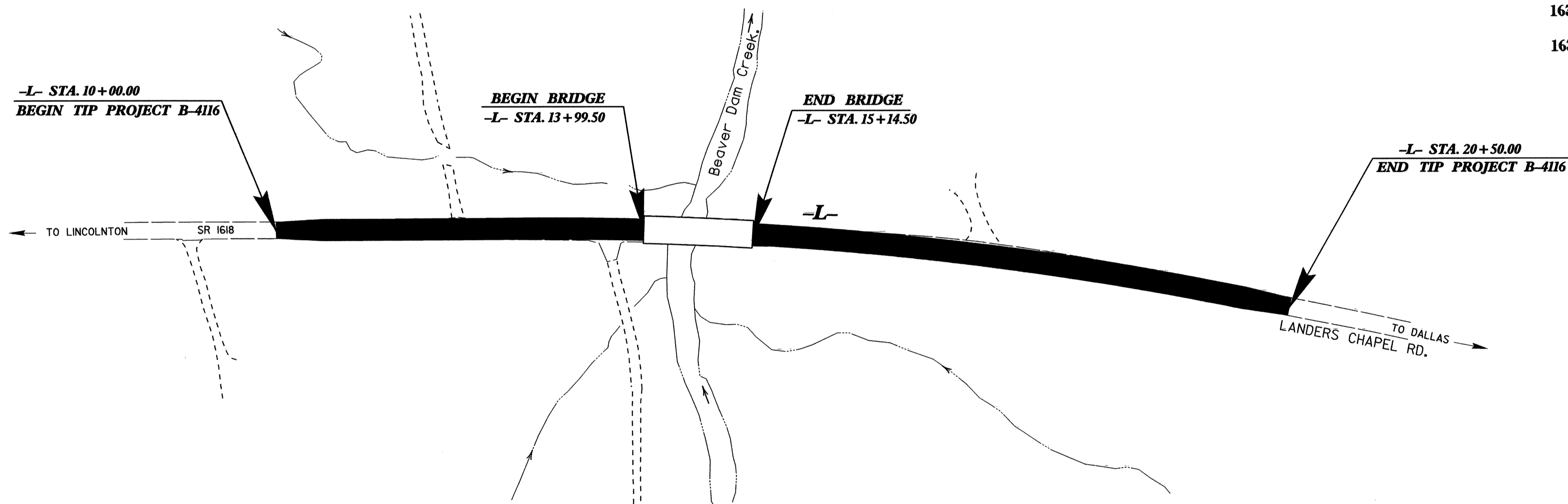
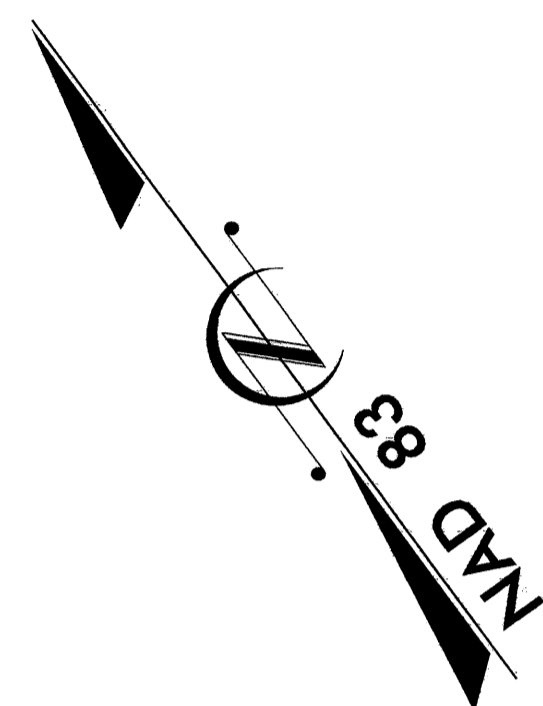

STATE	STATE PROJECT REFERENCE NO.	SHEET NO.	TOTAL SHEETS
N.C.	B-4116	EC-1	
STATE PROJ. NO.	F.A. PROJ. NO.	DESCRIPTION	

**EROSION AND SEDIMENT CONTROL MEASURES**

Std. #	Description	Symbol
1630.03	Temporary Silt Ditch	TSB
1630.05	Temporary Diversion	TD
1605.01	Temporary Silt Fence	III III III
1606.01	Special Sediment Control Fence	△△△△△△△△
1622.01	Temporary Berms and Slope Drains	— T —
1630.01	Riser Basin	⊙
1630.01	Silt Basin Type B	▨
1633.01	Temporary Rock Silt Check Type-A	⊗
1633.01	Temporary Rock Silt Check Type-B	▶
	Wattle	⌒
1634.01	Temporary Rock Sediment Dam Type-A	⊞
1634.02	Temporary Rock Sediment Dam Type-B	⊞
1635.01	Rock Pipe Inlet Sediment Trap Type-A	⊞
1635.02	Rock Pipe Inlet Sediment Trap Type-B	⊞
1630.04	Stilling Basin	⊞
	Rock Inlet Sediment Trap:	
1632.01	Type A	A ⊞
1632.02	Type B	B ⊞
1632.03	Type C	C ⊞
	Skimmer Basin	⊞
	Tiered Skimmer Basin	⊞
	Infiltration Basin	⊞

**THIS PROJECT CONTAINS  
EROSION CONTROL PLANS  
FOR CLEARING AND  
GRUBBING PHASE OF  
CONSTRUCTION.**

**GRAPHIC SCALE**

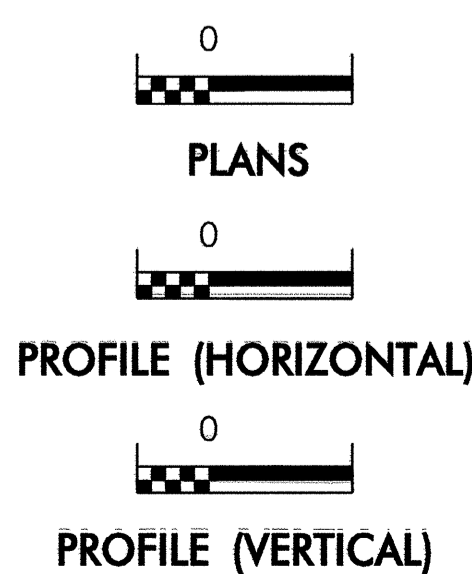

ROADSIDE ENVIRONMENTAL UNIT  
DIVISION OF HIGHWAYS  
STATE OF NORTH CAROLINA

Prepared In the Office of:  
**ROADSIDE ENVIRONMENTAL UNIT**  
1 South Wilmington St.  
Raleigh, NC 27611  
**2006 STANDARD SPECIFICATIONS**

**Roadway Standard Drawings**

The following roadway english standards as appear in "Roadway Standard Drawings"- Roadway Design Unit - N. C. Department of Transportation - Raleigh, N. C., dated July 18, 2006 and the latest revision thereto are applicable to this project and by reference hereby are considered a part of these plans.

- |  |  |
|--|--|
| 1605.01 Temporary Silt Fence             | 1632.03 Rock Inlet Sediment Trap Type C      |
| 1607.01 Gravel Construction Entrance     | 1633.01 Temporary Rock Silt Check Type A     |
| 1622.01 Temporary Berms and Slope Drains | 1634.02 Temporary Rock Sediment Dam Type B   |
| 1630.03 Temporary Silt Ditch             | 1635.02 Rock Pipe Inlet Sediment Trap Type B |
| 1630.05 Temporary Diversion              |  |

PROJECT REFERENCE NO. <i>B-4116</i>	SHEET NO. <i>EC-2</i>
RW SHEET NO.	
ROADWAY DESIGN ENGINEER	HYDRAULICS ENGINEER

# TEMPORARY ROCK SILT CHECK TYPE 'B' DETAIL

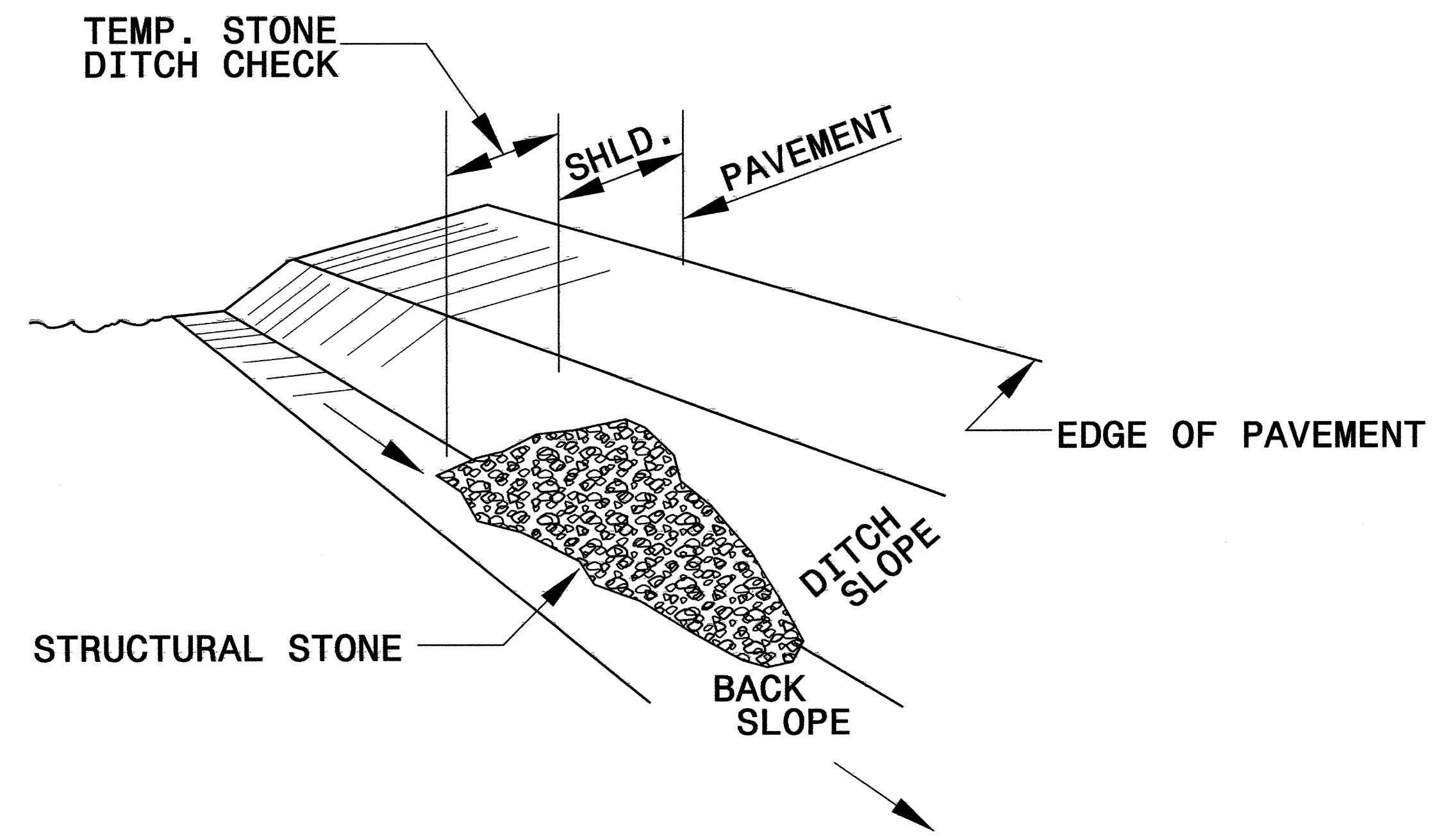

**ISOMETRIC VIEW**

NOTES:  
 USE CLASS 'B' EROSION CONTROL STONE FOR STRUCTURAL STONE.  
 THE ENGINEER MAY DIRECT THE OPTION OF CLASS "A" STONE FOR SITES HAVING LESS THAN ONE (1) ACRE DRAINAGE AREA AND A DITCH GRADE LESS THAN 3%.

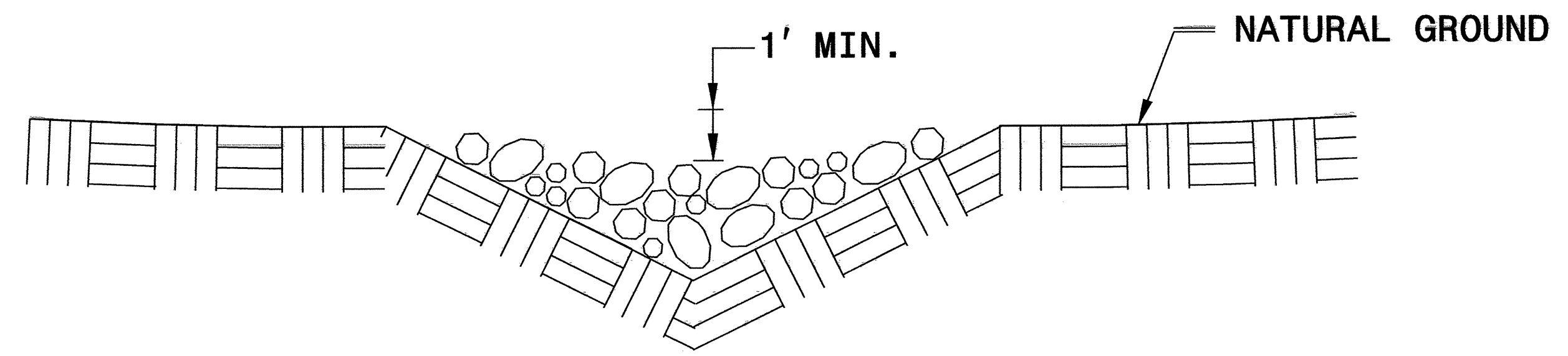

**CROSS SECTION VEE DITCH**

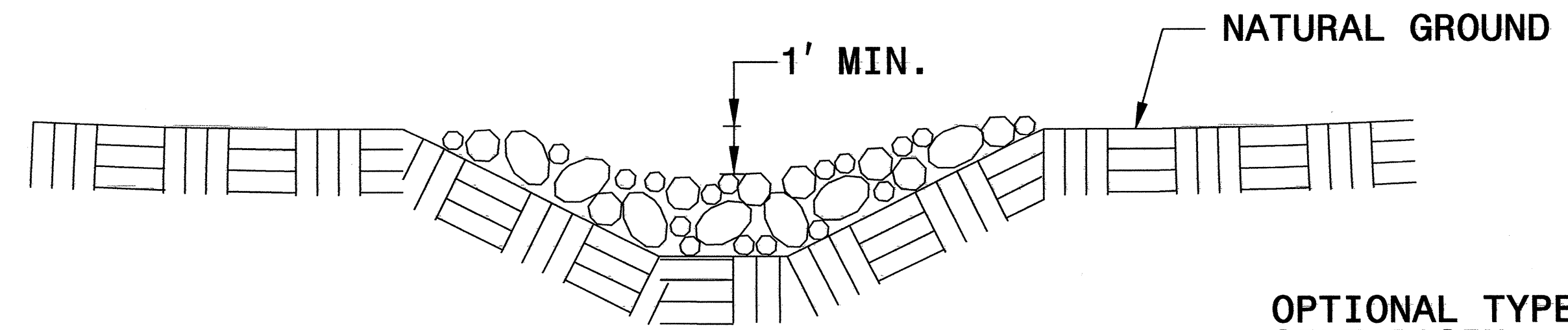

**CROSS SECTION TRAPEZOIDAL DITCH**

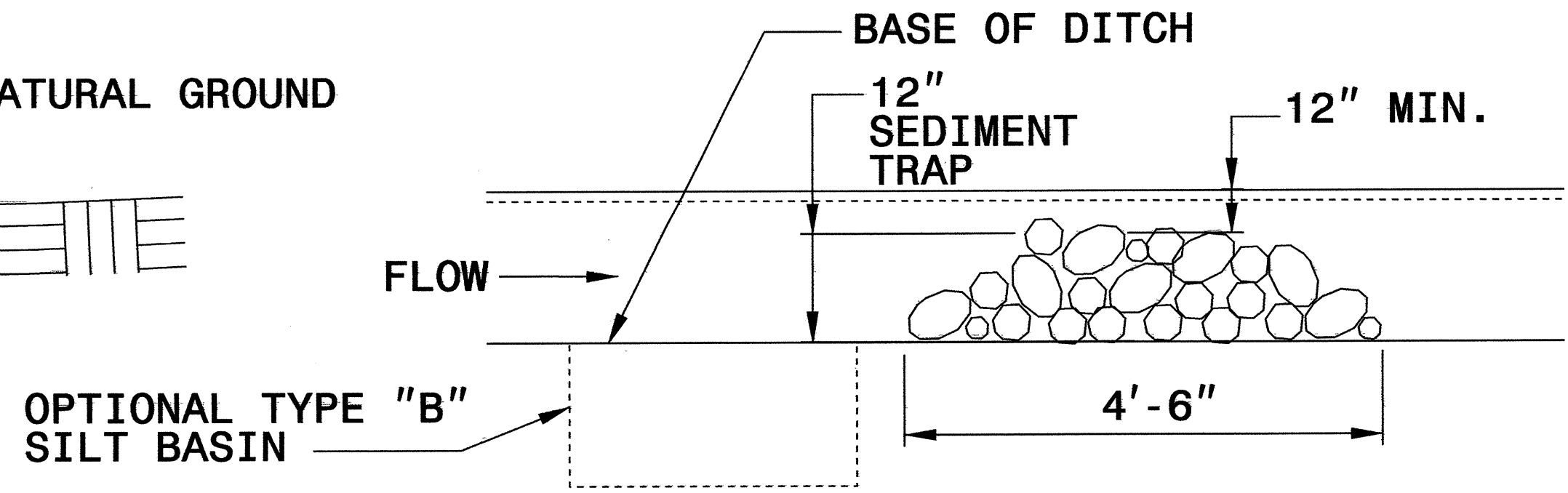

**ELEVATION VIEW**

PROJECT REFERENCE NO. B-4116	SHEET NO. EC-2A
RW SHEET NO.	
ROADWAY DESIGN ENGINEER	HYDRAULICS ENGINEER

# COIR FIBER BAFFLE DETAIL

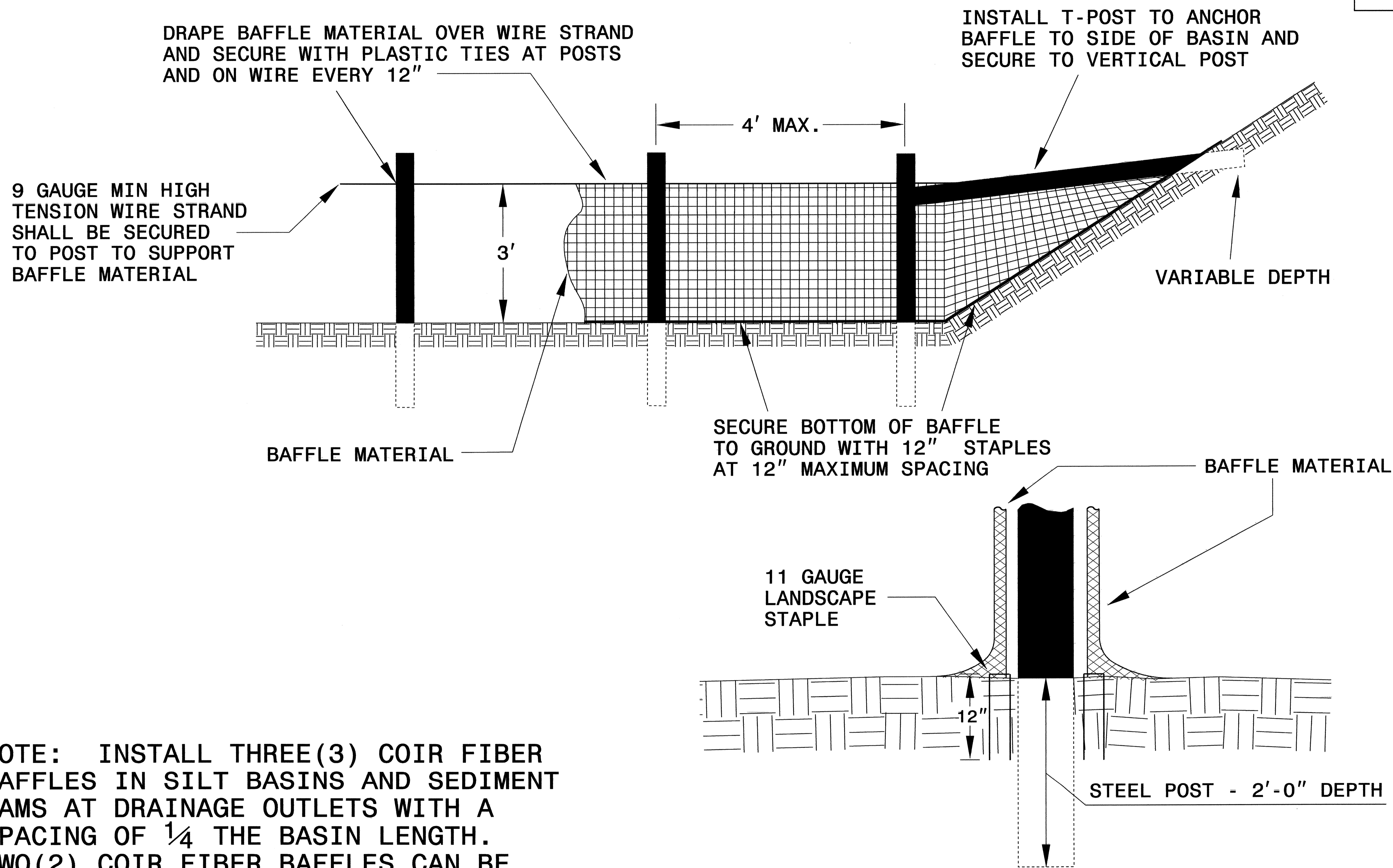

NOTE: INSTALL THREE(3) COIR FIBER BAFFLES IN SILT BASINS AND SEDIMENT DAMS AT DRAINAGE OUTLETS WITH A SPACING OF  $\frac{1}{4}$  THE BASIN LENGTH. TWO(2) COIR FIBER BAFFLES CAN BE INSTALLED IN SILT BASINS AND DAMS LESS THAN 20 FT. IN LENGTH WITH A SPACING OF  $\frac{1}{3}$  THE BASIN LENGTH.

BAFFLE MATERIAL SHALL BE SECURED TO THE BOTTOM AND SIDES OF BASIN USING 12" LANDSCAPE STAPLES

PROJECT REFERENCE NO.	SHEET NO.
B-4116	EC-2B
RW SHEET NO.	
ROADWAY DESIGN ENGINEER	HYDRAULICS ENGINEER

# SILT BASIN 'B' DETAIL

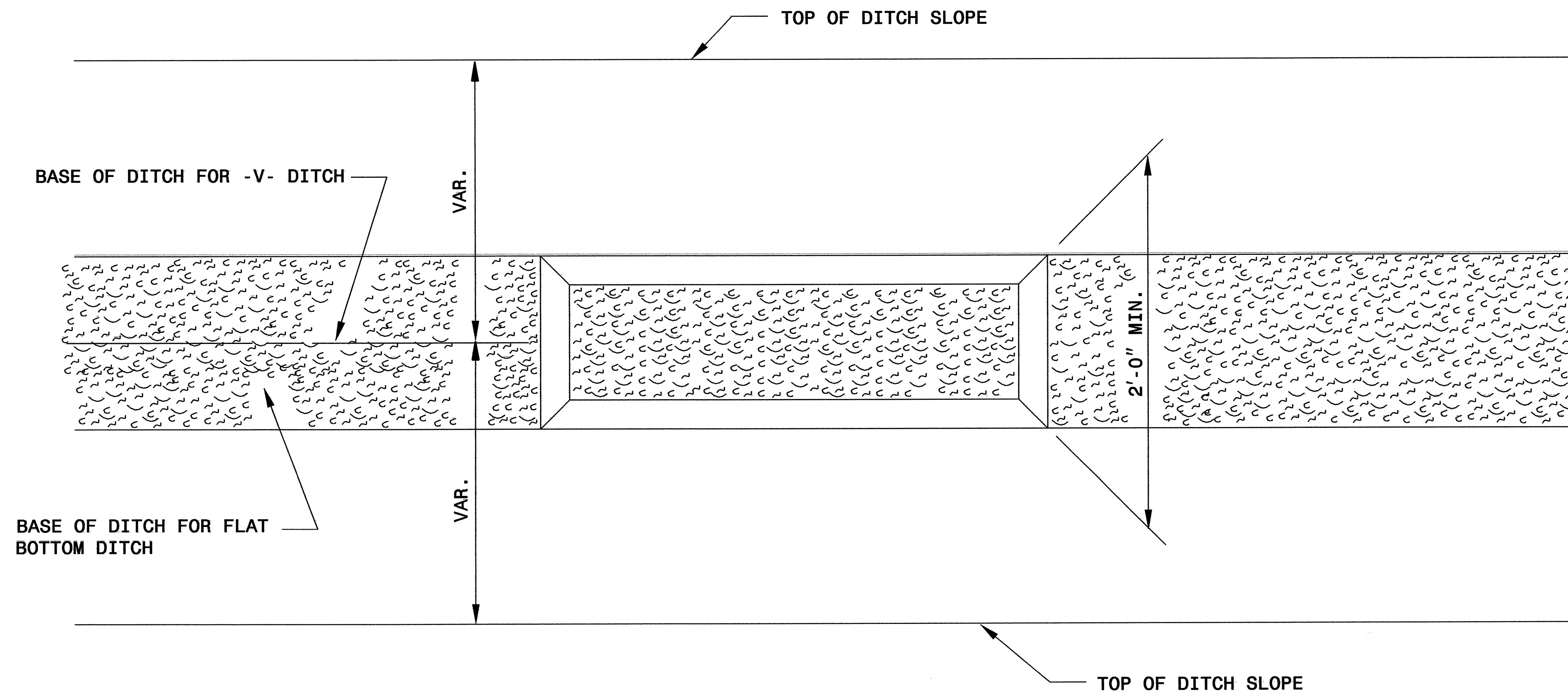

PLAN

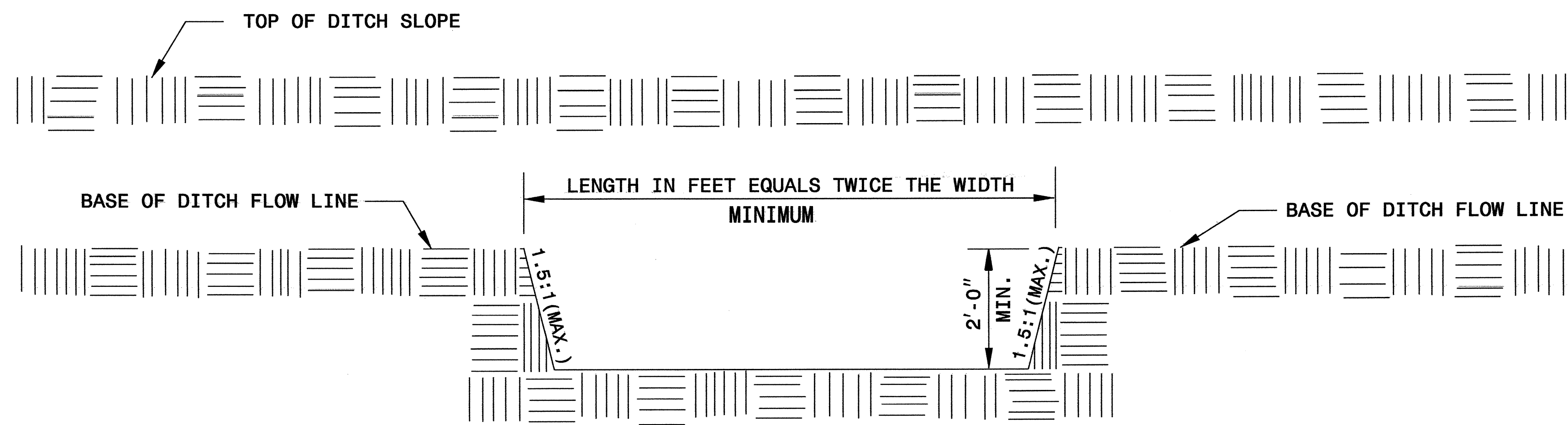

ELEVATION



PROJECT REFERENCE NO. B-4116	SHEET NO. EC-4/CONST.4
RW SHEET NO.	HYDRAULICS ENGINEER
ROADWAY DESIGN ENGINEER	

NOTE: UTILIZE TEMPORARY ROCK SEDIMENT DAM TYPE - B AND TEMPORARY ROCK SILT CHECK TYPE - A AS STILLING BASIN WHERE APPLICABLE.

CLEARING AND GRUBBING EROSION CONTROL FOR CONSTRUCTION SHEET 4

NOTE: PLACE TEMPORARY ROCK SEDIMENT DAMS TYPE - B AND TEMPORARY ROCK SILT CHECKS TYPE - A AT DRAINAGE OUTLETS.

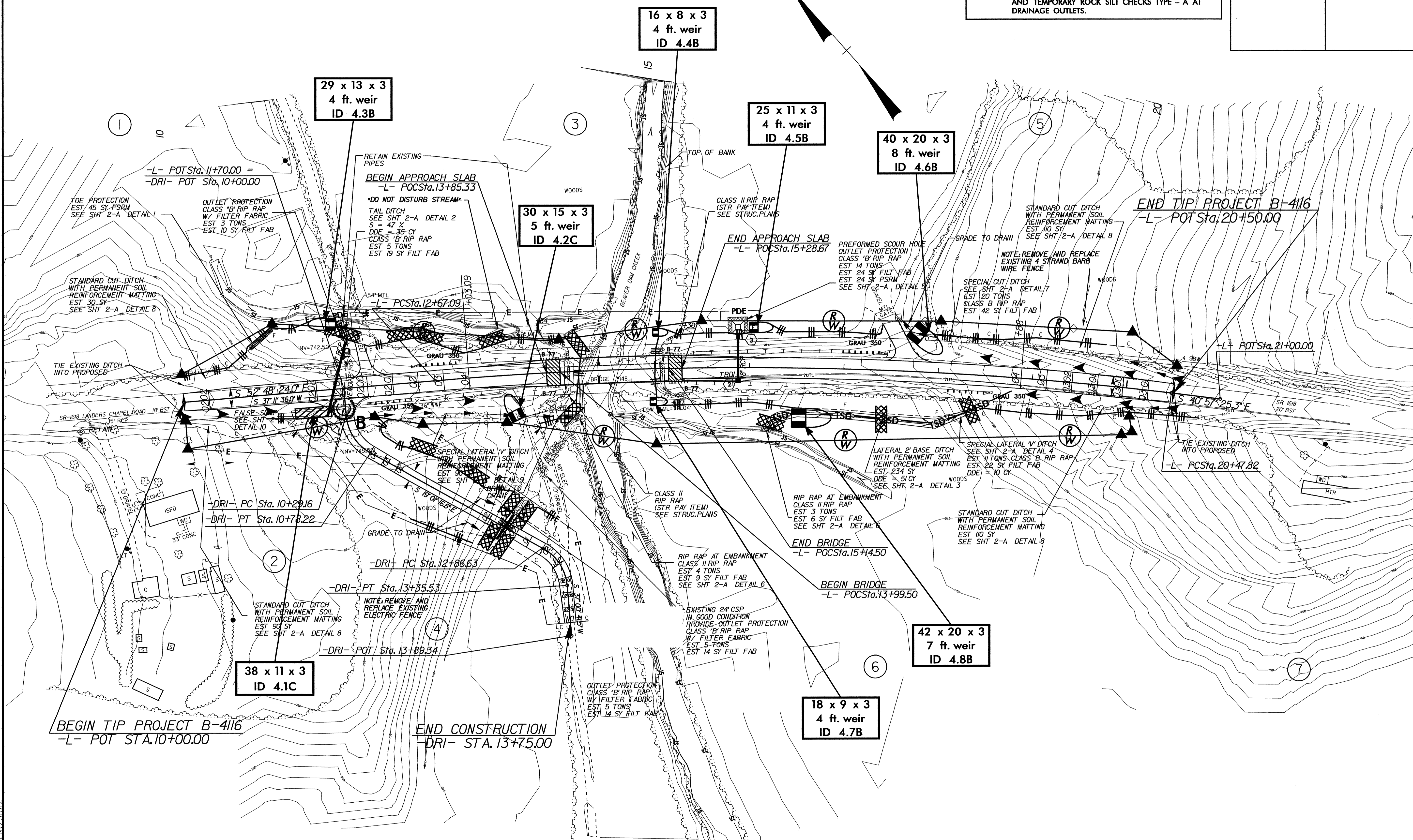

PROJECT REFERENCE NO.	SHEET NO.
B-4116	EC-5/CONST.4
RW SHEET NO.	
ROADWAY DESIGN ENGINEER	HYDRAULICS ENGINEER

NOTE:  
UTILIZE TEMPORARY ROCK SEDIMENT DAM TYPE - B  
AND TEMPORARY ROCK SILT CHECK TYPE - A  
AS STILLING BASIN WHERE APPLICABLE.

8/17/99  
02-MAY-2008 11:44  
g:\tpr\o\ec\eg\b\4116\environmental\design\b4116\_rdy\_psh4.dgn  
Benji

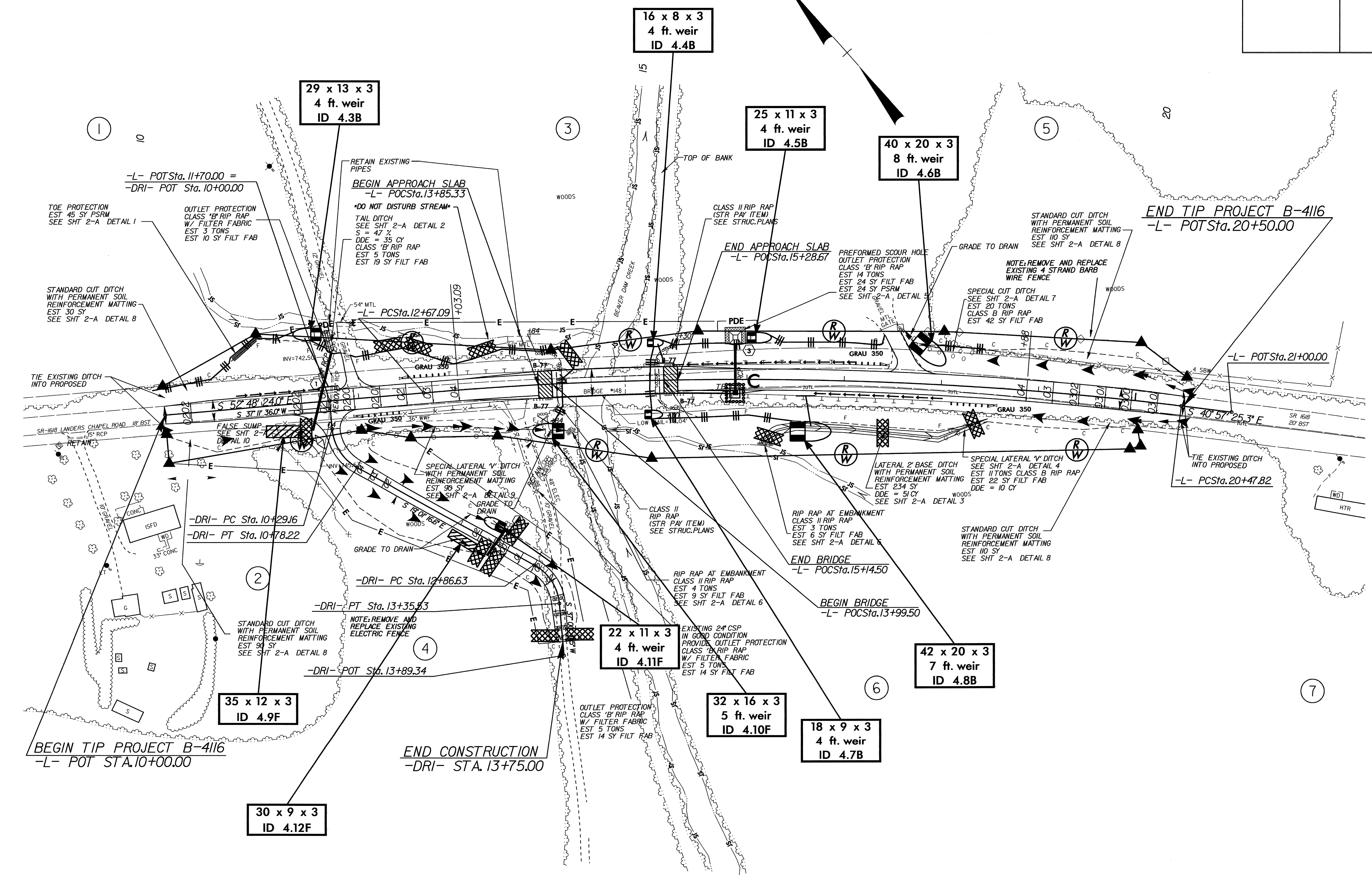

02-MAY-2008 11:44  
g:\tpr\o\ec\eg\b\4116\environmental\design\b4116\_rdy\_psh4.dgn  
Benji