

STATE	STATE PROJECT REFERENCE NO.	SHEET NO.	TOTAL SHEETS
N.C.	B-4059	EC-1	
STATE PROJ. NO.	F.A. PROJ. NO.	DESCRIPTION	

TIP PROJECT: B-4059

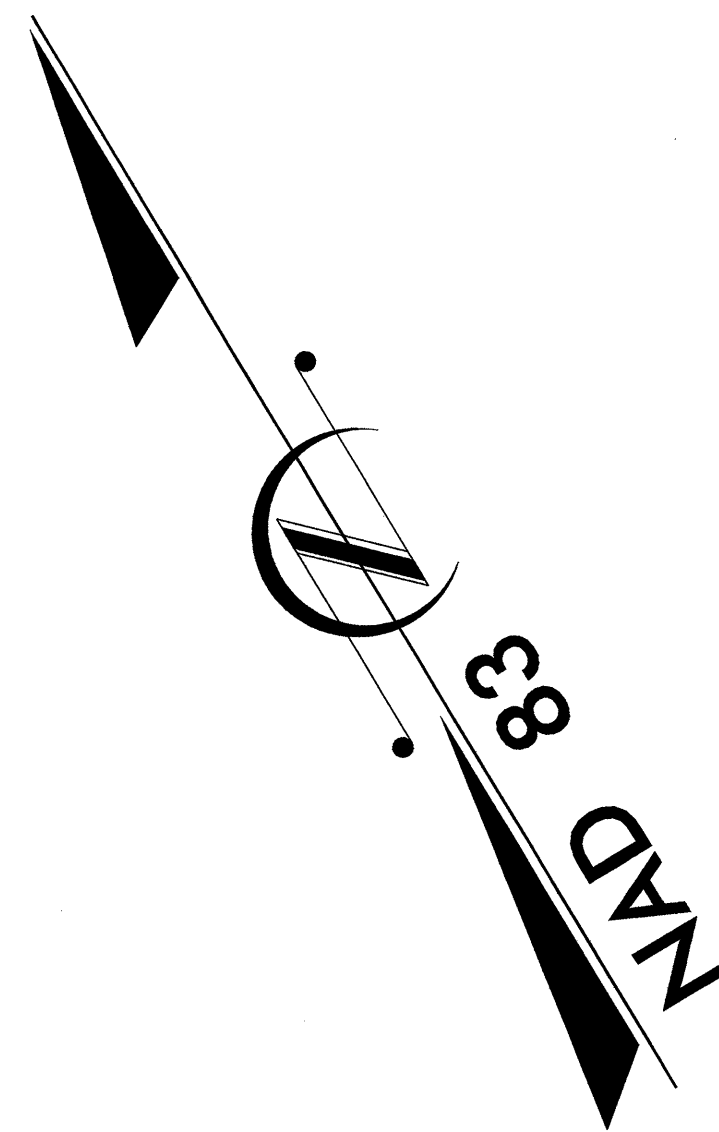

STATE OF NORTH CAROLINA
 DIVISION OF HIGHWAYS
 PLAN FOR PROPOSED
 HIGHWAY EROSION CONTROL
CATAWBA COUNTY

**LOCATION: BRIDGE NO. 79 OVER HILDEBRAN CREEK
 ON SR 1156 IN NEWTON**

TYPE OF WORK: GRADING, DRAINAGE, STRUCTURE, AND PAVING

STA. 21+00.00 -EL- END TIP PROJECT B-4059

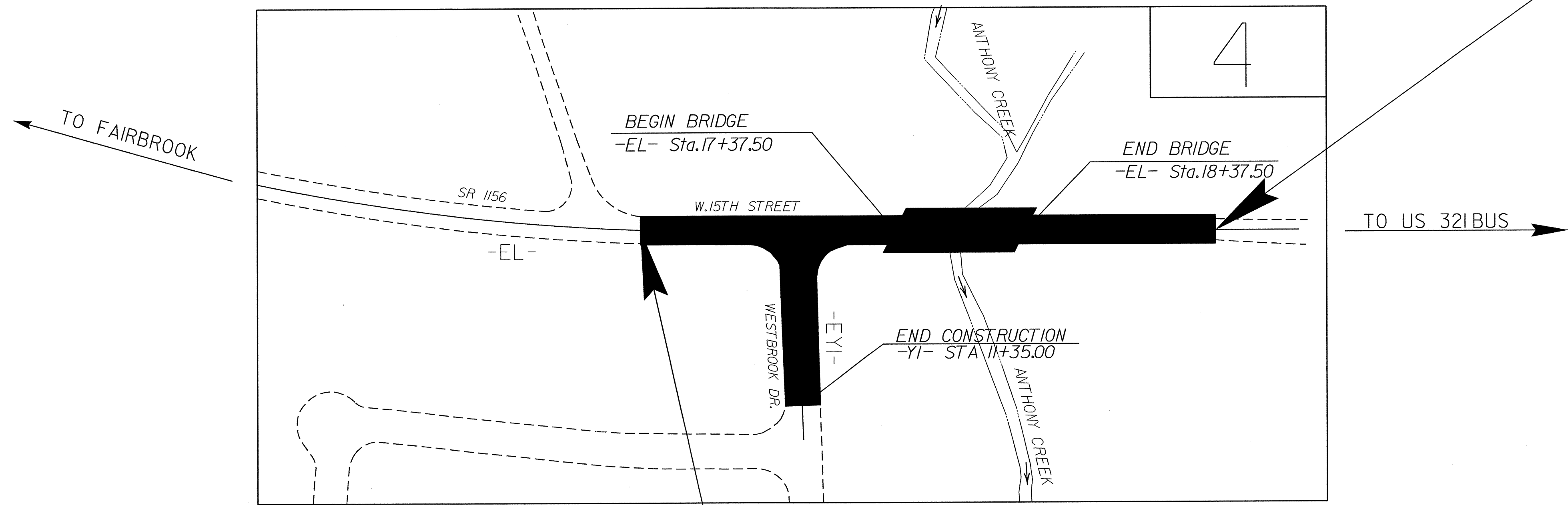

STA. 14+70.00 -EL- BEGIN TIP PROJECT B-4059

EROSION AND SEDIMENT CONTROL MEASURES

Std. #	Description	Symbol
	Streambank Reforestation.....	
1630.03	Temporary Silt Ditch.....	
1630.05	Temporary Diversion.....	
1605.01	Temporary Silt Fence.....	
1606.01	Special Sediment Control Fence.....	
1622.01	Temporary Berms and Slope Drains.....	
1630.01	Riser Basin.....	
1630.02	Silt Basin Type B.....	
1633.01	Temporary Rock Silt Check Type-A.....	
	Temporary Rock Silt Check Type-B.....	
1634.01	Temporary Rock Sediment Dam Type-A.....	
1634.02	Temporary Rock Sediment Dam Type-B.....	
1635.01	Rock Pipe Inlet Sediment Trap Type-A.....	
1635.02	Rock Pipe Inlet Sediment Trap Type-B.....	
1630.04	Stilling Basin.....	
	Rock Inlet Sediment Trap:	
1632.01	Type A.....	
1632.02	Type B.....	
1632.03	Type C.....	
	Skimmer Basin.....	
	Tiered Skimmer Basin.....	
	Infiltration Basin.....	

**THIS PROJECT CONTAINS
 EROSION CONTROL PLANS
 FOR CLEARING AND
 GRUBBING PHASE OF
 CONSTRUCTION.**

<p>GRAPHIC SCALE</p> <p>0 </p> <p>PLANS</p> <p>0 </p> <p>PROFILE (HORIZONTAL)</p> <p>0 </p> <p>PROFILE (VERTICAL)</p>	<p>ROADSIDE ENVIRONMENTAL UNIT DIVISION OF HIGHWAYS STATE OF NORTH CAROLINA</p>	<p style="text-align: center;">Prepared In the Office of: ROADSIDE ENVIRONMENTAL UNIT 1 South Wilmington St. Raleigh, NC 27611</p> <p style="text-align: center;">2006 STANDARD SPECIFICATIONS</p>	<p>Roadway Standard Drawings</p> <p>The following roadway english standards as appear in "Roadway Standard Drawings"- Roadway Design Unit - N. C. Department of Transportation - Raleigh, N. C., dated July 18, 2006 and the latest revision thereto are applicable to this project and by reference hereby are considered a part of these plans.</p> <p>1605.01 Temporary Silt Fence 1607.01 Gravel Construction Entrance 1622.01 Temporary Berms and Slope Drains 1630.03 Temporary Silt Ditch 1630.05 Temporary Diversion 1632.03 Rock Inlet Sediment Trap Type C 1633.01 Temporary Rock Silt Check Type A 1635.02 Rock Pipe Inlet Sediment Trap Type B</p>
--	---	---	---

PROJECT REFERENCE NO. B-4059	SHEET NO. EC-2
RW SHEET NO.	
ROADWAY DESIGN ENGINEER	HYDRAULICS ENGINEER

TEMPORARY ROCK SILT CHECK TYPE 'B' DETAIL

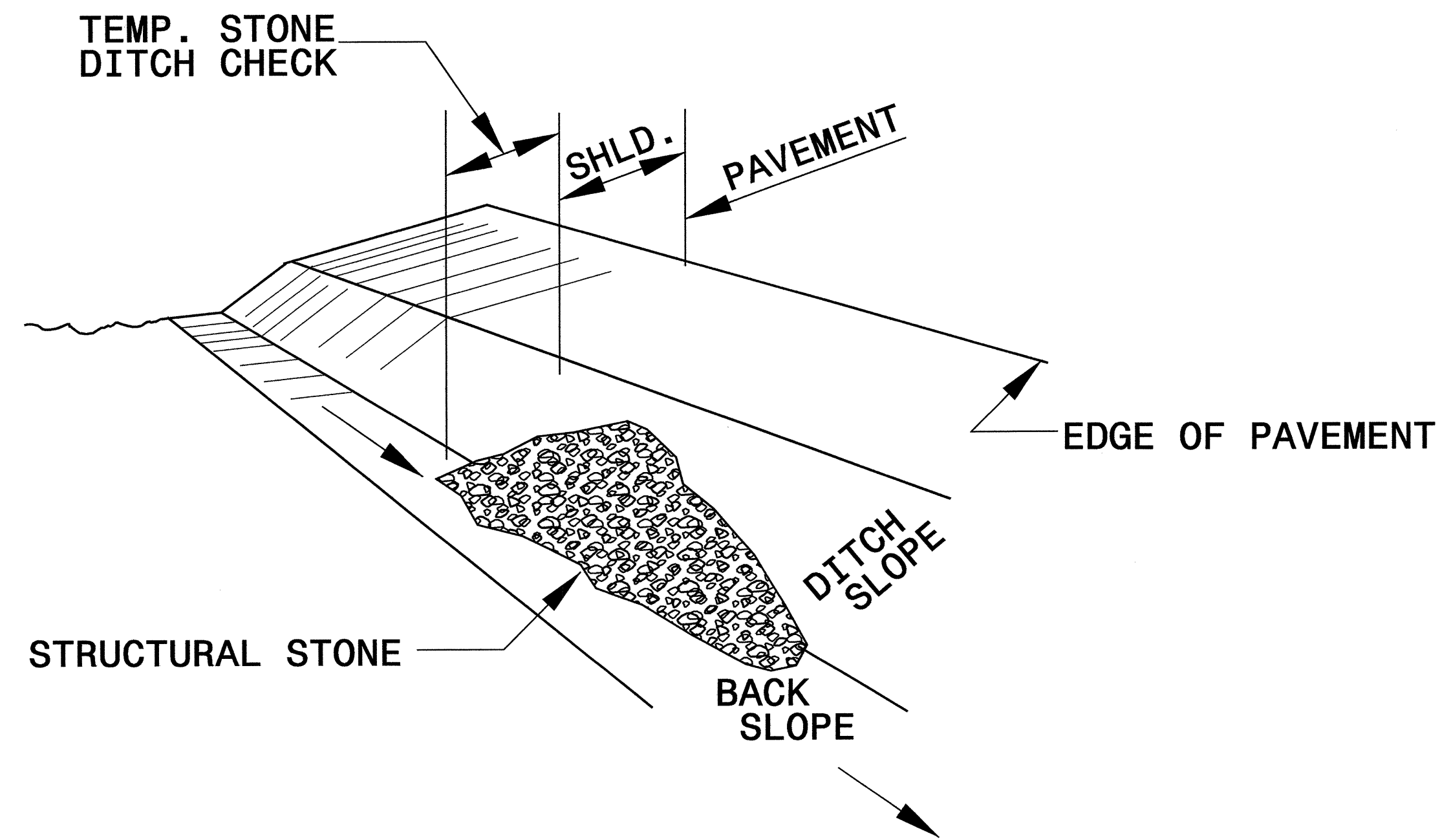

ISOMETRIC VIEW

NOTES:

USE CLASS 'B' EROSION CONTROL STONE FOR STRUCTURAL STONE.

THE ENGINEER MAY DIRECT THE OPTION OF CLASS "A" STONE FOR SITES HAVING LESS THAN ONE (1) ACRE DRAINAGE AREA AND A DITCH GRADE LESS THAN 3%.

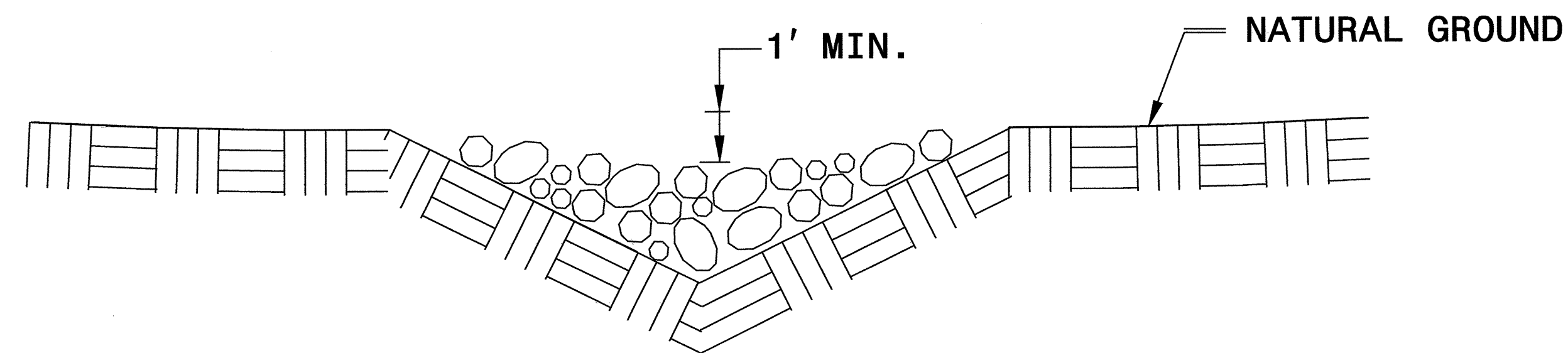

**CROSS SECTION
VEE DITCH**

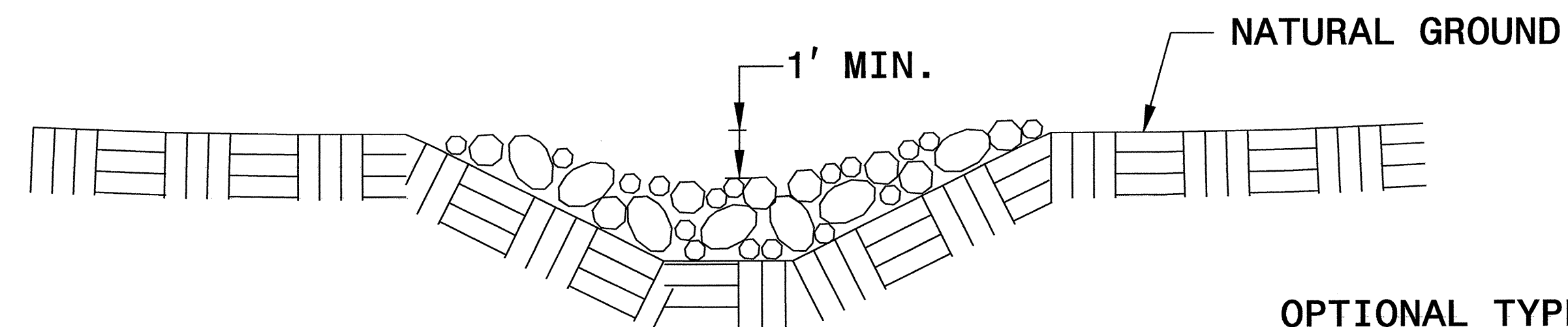

**CROSS SECTION
TRAPEZOIDAL DITCH**

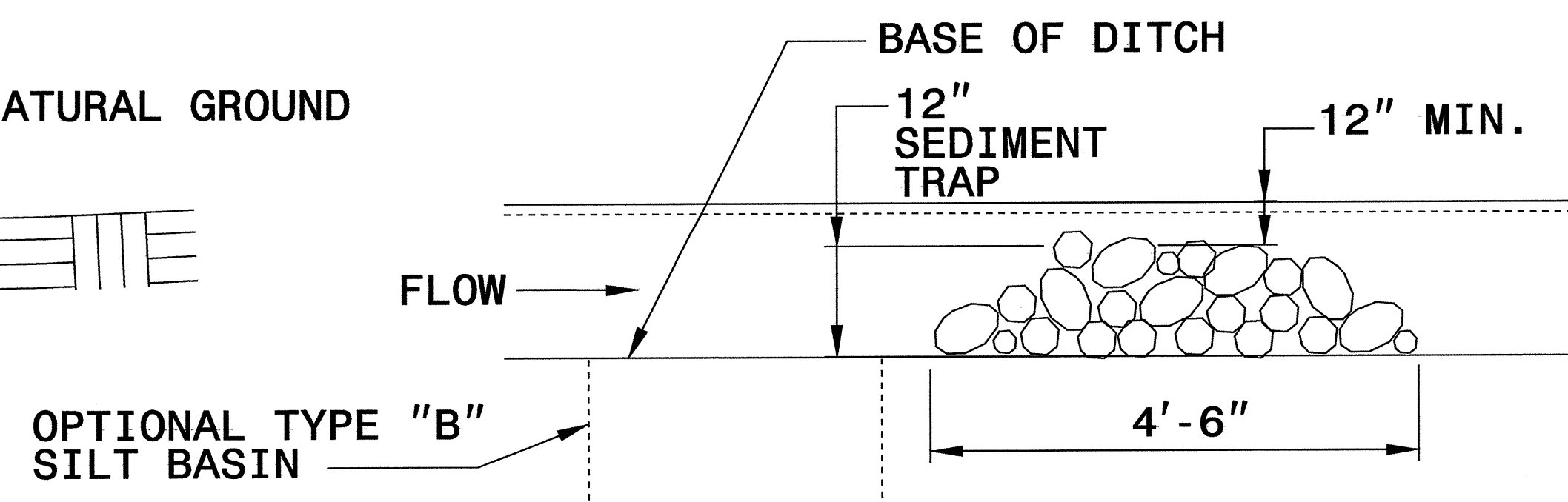

ELEVATION VIEW

PROJECT REFERENCE NO. B-4059	SHEET NO. EC-2A
RW SHEET NO.	
ROADWAY DESIGN ENGINEER	HYDRAULICS ENGINEER

COIR FIBER BAFFLE DETAIL

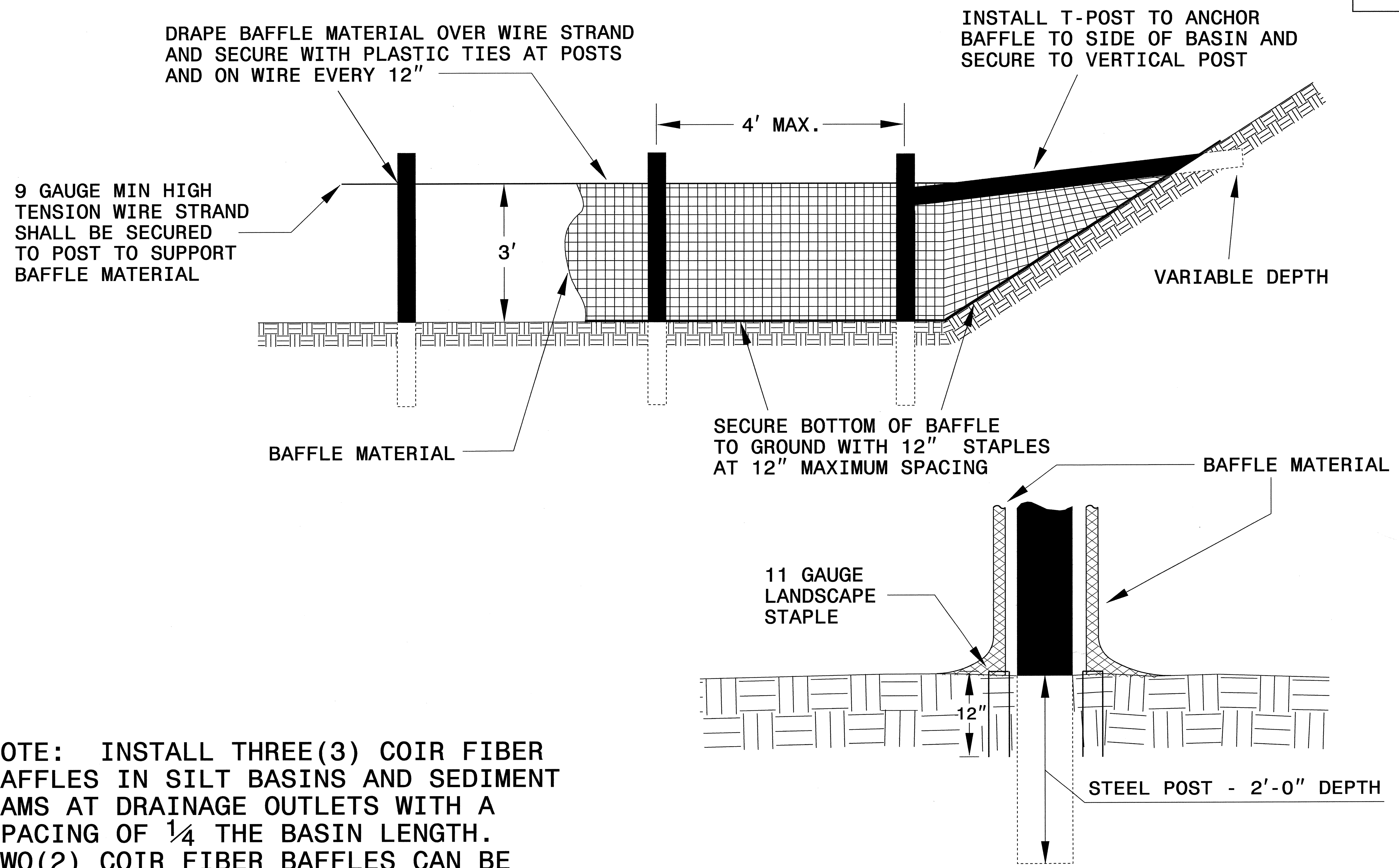

NOTE: INSTALL THREE(3) COIR FIBER BAFFLES IN SILT BASINS AND SEDIMENT DAMS AT DRAINAGE OUTLETS WITH A SPACING OF $\frac{1}{4}$ THE BASIN LENGTH. TWO(2) COIR FIBER BAFFLES CAN BE INSTALLED IN SILT BASINS AND DAMS LESS THAN 20 FT. IN LENGTH WITH A SPACING OF $\frac{1}{3}$ THE BASIN LENGTH.

BAFFLE MATERIAL SHALL BE SECURED TO THE BOTTOM AND SIDES OF BASIN USING 12" LANDSCAPE STAPLES

SKIMMER BASIN WITH BAFFLES DETAIL

PROJECT REFERENCE NO. B-4059	SHEET NO. EC-2B
RW SHEET NO.	
ROADWAY DESIGN ENGINEER	HYDRAULICS ENGINEER

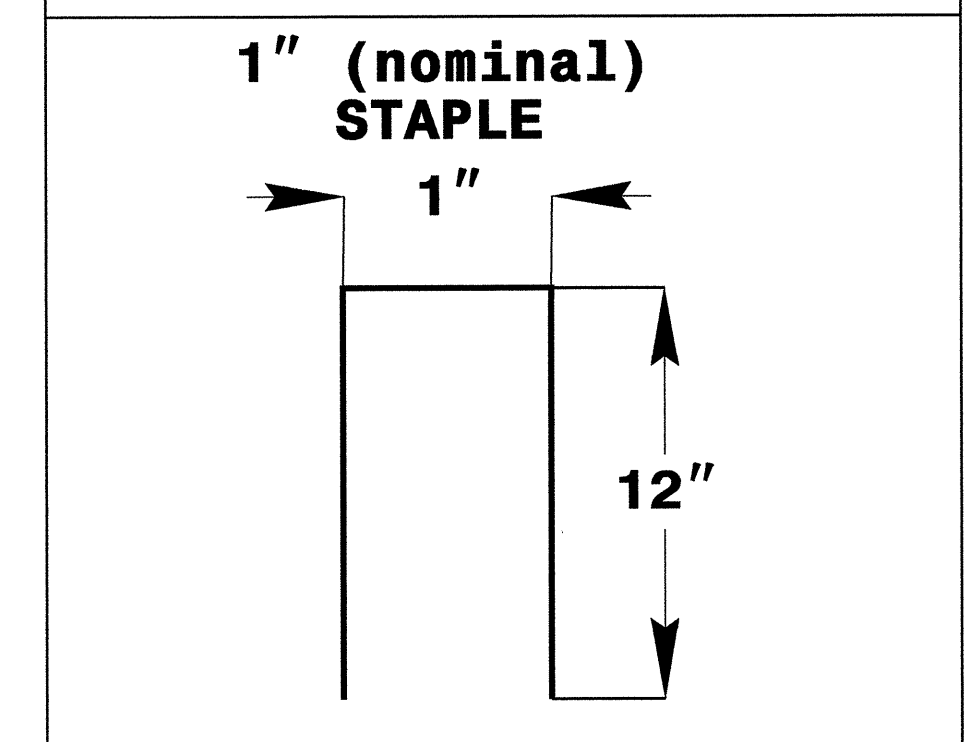
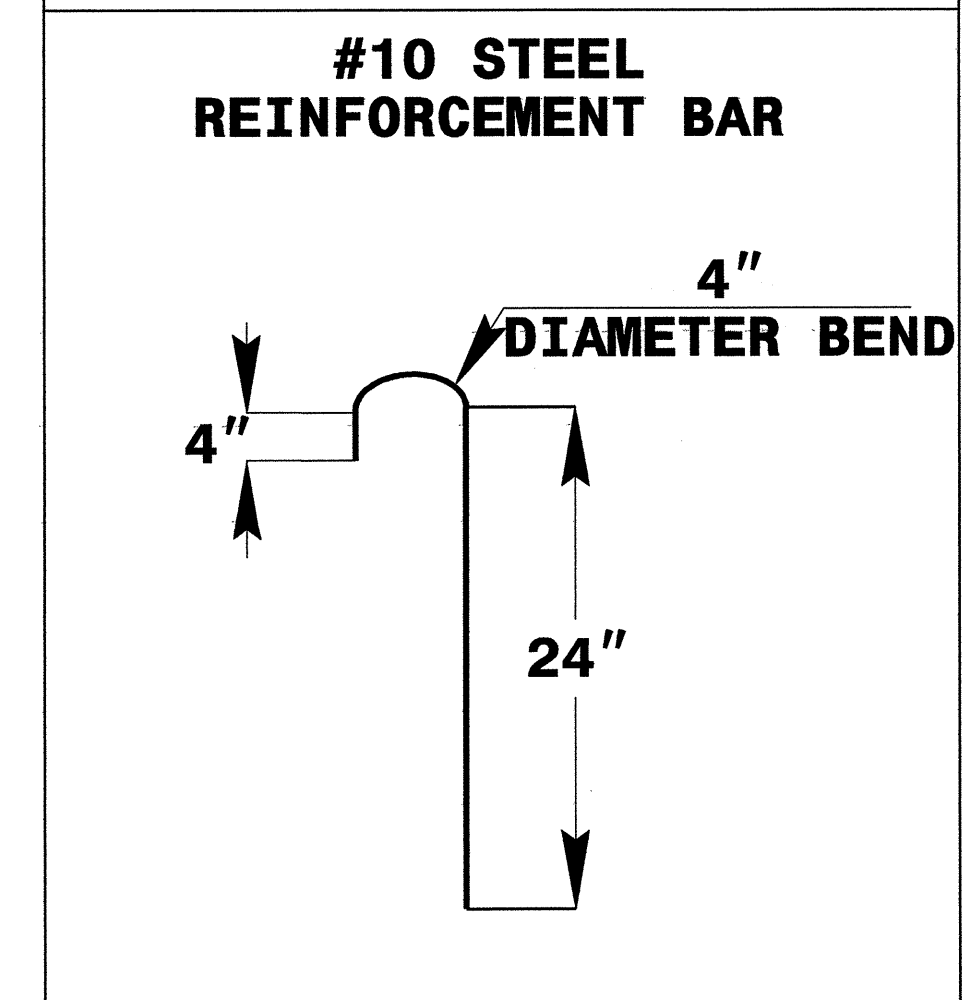
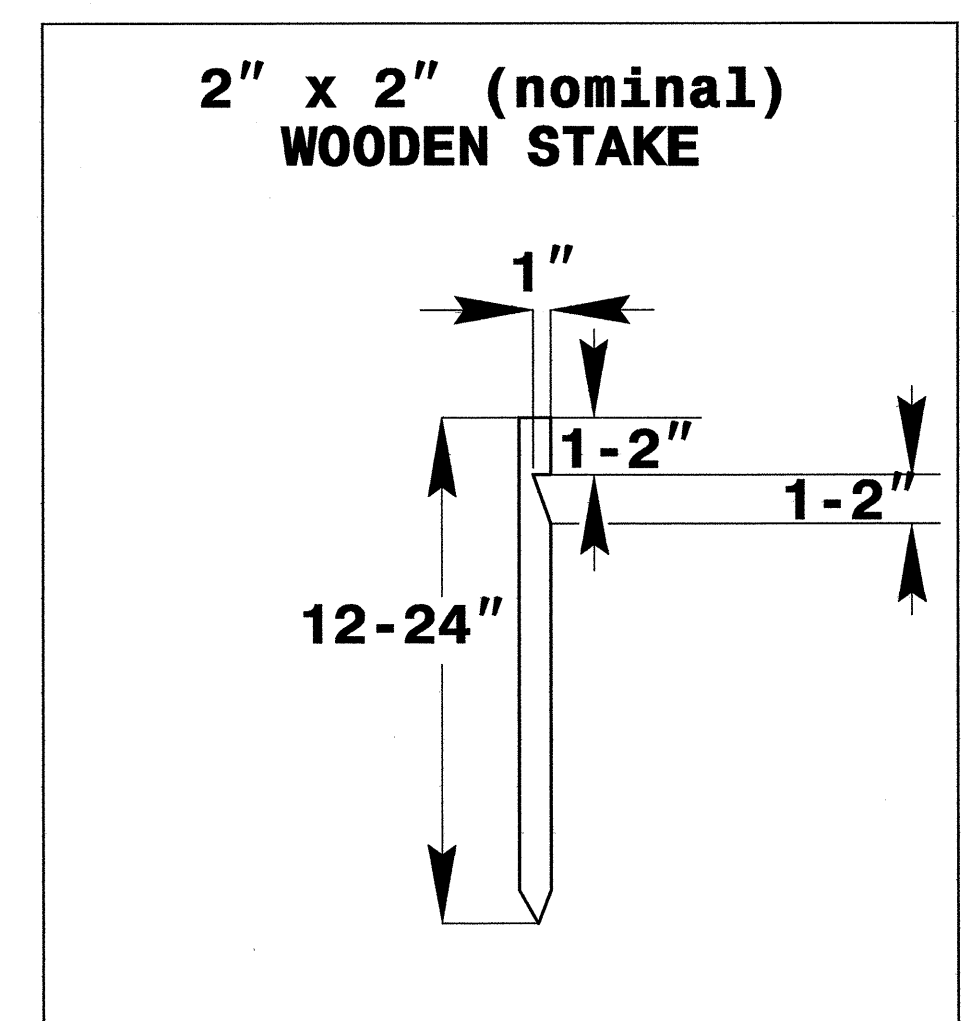
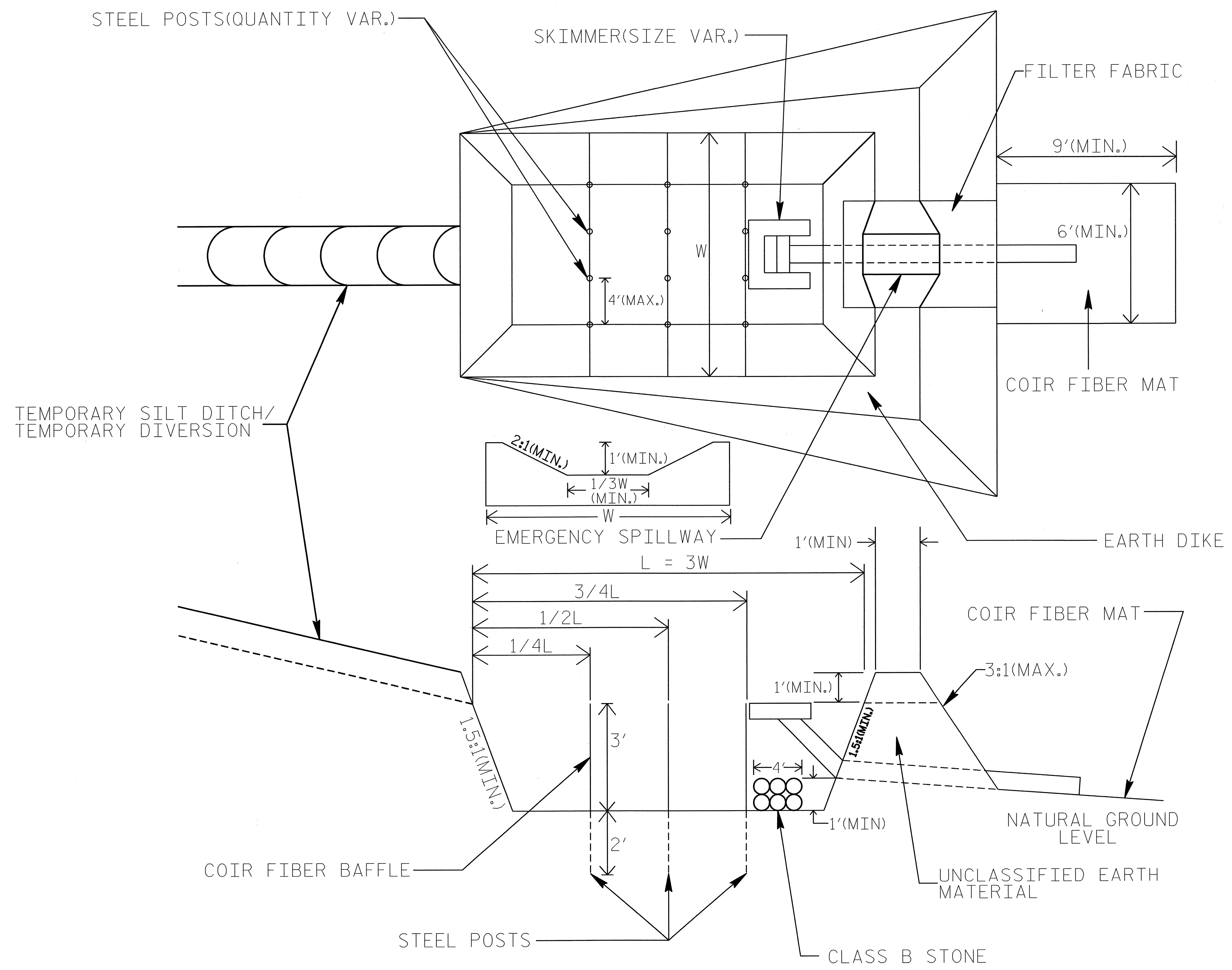

COIR FIBER MAT ANCHOR OPTIONS

- NOTES:**
1. SEED AND PLACE MATTING FOR EROSION CONTROL ON SIDESLOPES.
 2. LIMIT EARTH DIKE HEIGHT TO 5 FT.

PROJECT REFERENCE NO. B-4059		SHEET NO. EC-03/CONST.04	
RW SHEET NO.			
ROADWAY DESIGN ENGINEER		HYDRAULICS ENGINEER	

NOTE:
UTILIZE SKIMMER BASIN AS STILLING BASIN WHERE APPLICABLE.

NOTE:
PLACE TEMPORARY ROCK SEDIMENT DAMS TYPE - B AND TEMPORARY ROCK SILT CHECKS TYPE - A AT DRAINAGE OUTLETS.

CLEARING AND GRUBBING EROSION CONTROL FOR CONSTRUCTION SHEET 04

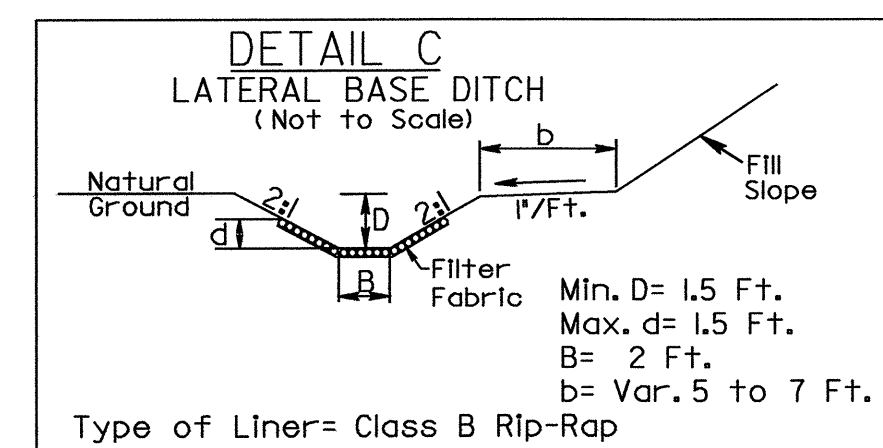
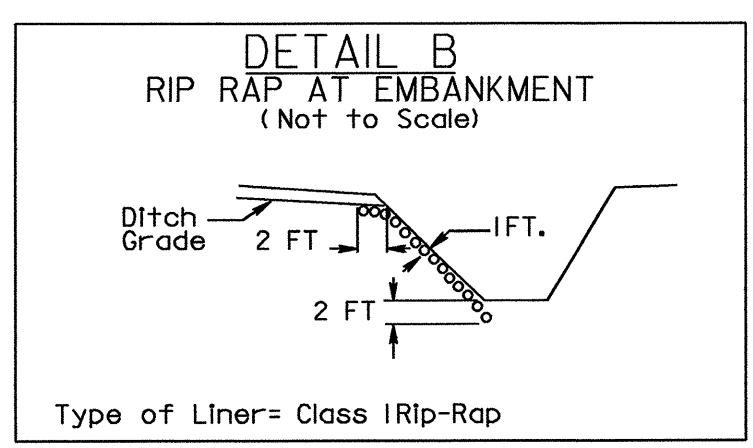
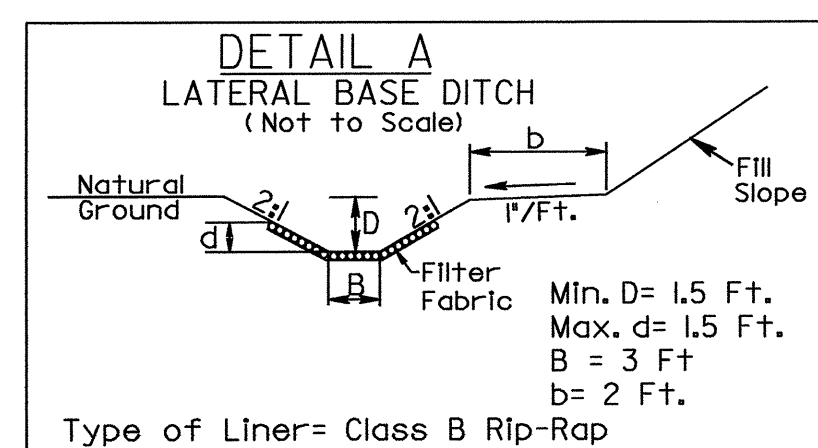

FROM STA. 17+71 TO STA. 17+81 -EL- RT, EST. 6 TONS
FROM STA. 18+00 TO STA. 18+08 -EL- LT, EST. 3 TONS

FROM STA. 16+83 TO STA. 17+71 -EL- RT

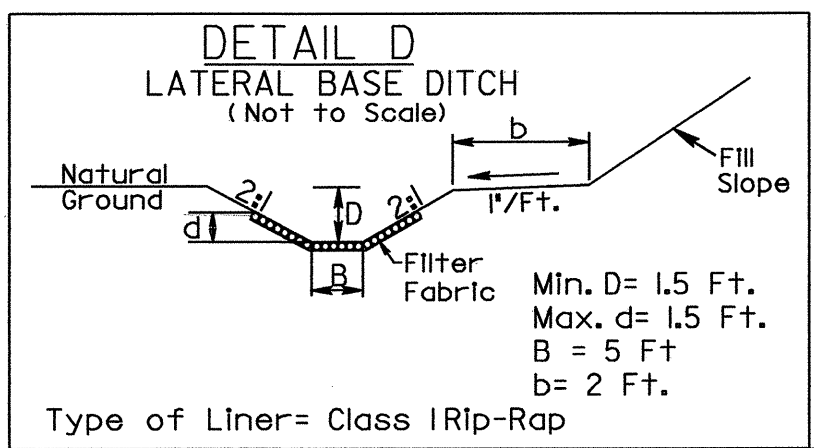
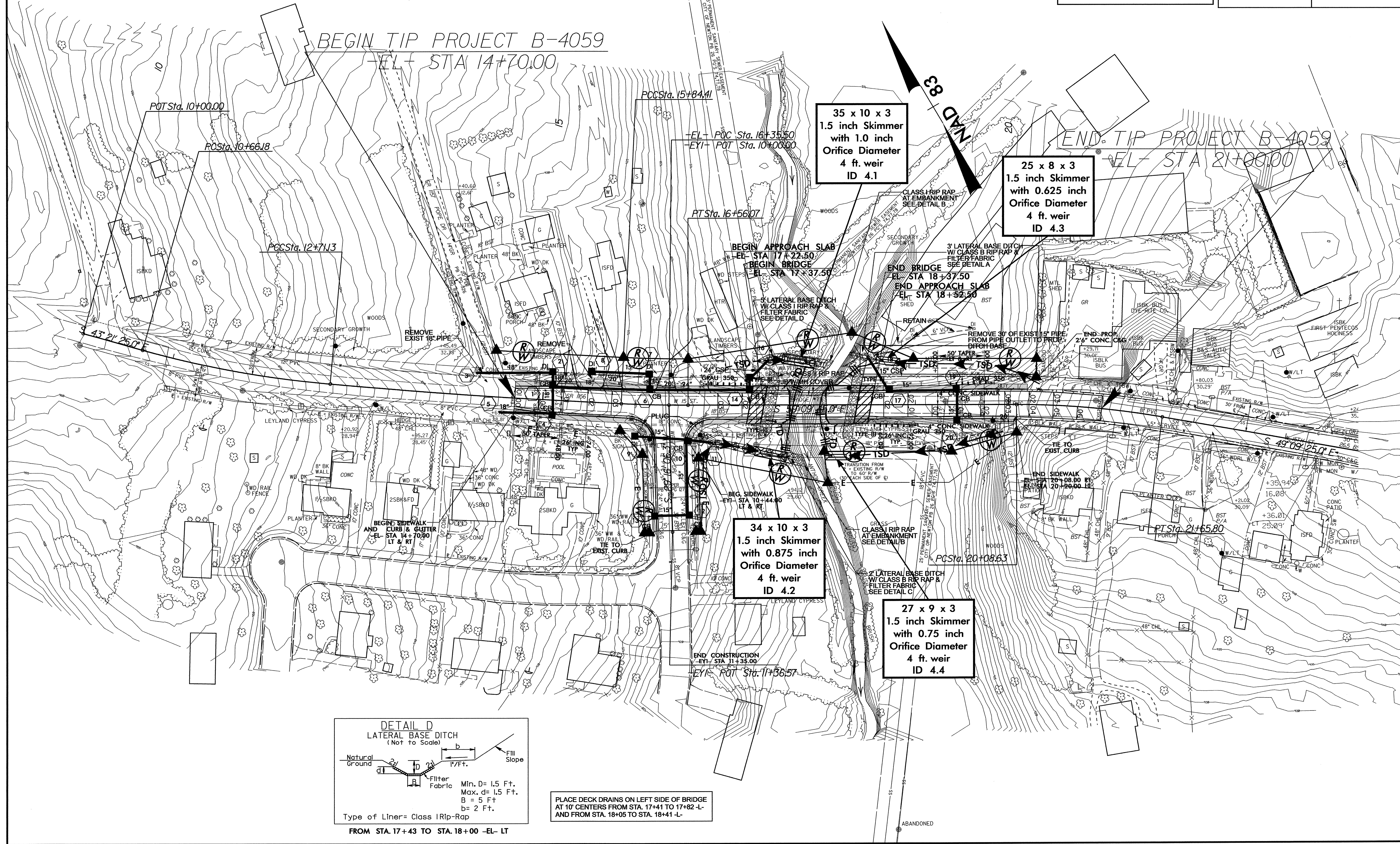

PLACE DECK DRAINS ON LEFT SIDE OF BRIDGE AT 10' CENTERS FROM STA. 17+41 TO 17+82 -L- AND FROM STA. 18+05 TO STA. 18+41 -L-

FROM STA. 17+43 TO STA. 18+00 -EL- LT

PROJECT REFERENCE NO.	SHEET NO.
B-4059	EC-04/CONST.04
RW SHEET NO.	
ROADWAY DESIGN ENGINEER	HYDRAULICS ENGINEER

NOTE: UTILIZE SKIMMER BASIN AS STILLING BASIN WHERE APPLICABLE.

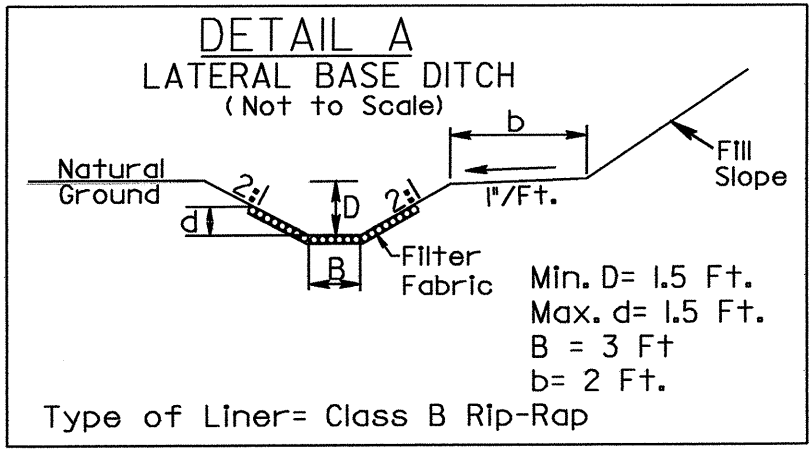

FROM STA. 18+27 TO STA. 18+50 -EL- LT

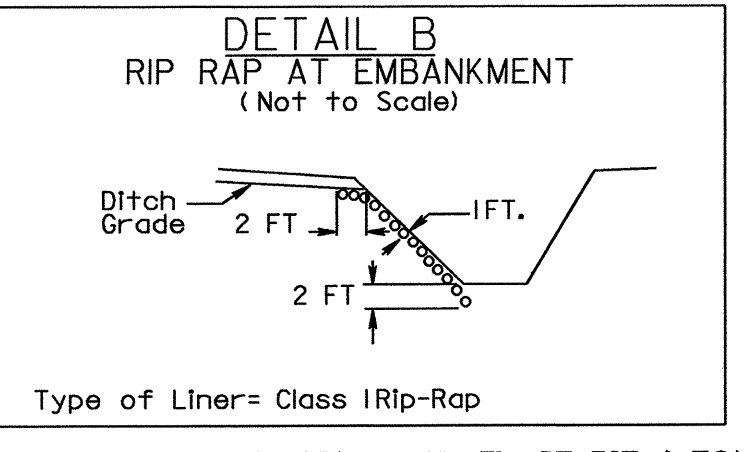

FROM STA. 17+71 TO STA. 17+81 -EL- RT, EST. 6 TONS
FROM STA. 18+00 TO STA. 18+08 -EL- LT, EST 3 TONS

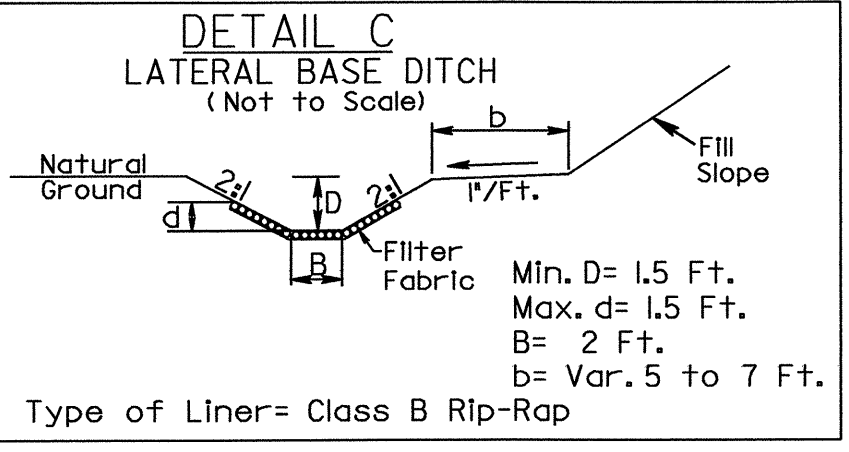

FROM STA. 16+83 TO STA. 17+71 -EL- RT

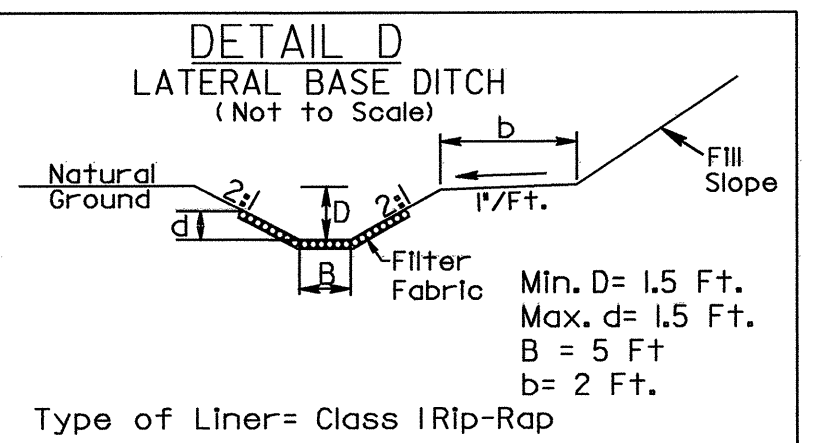
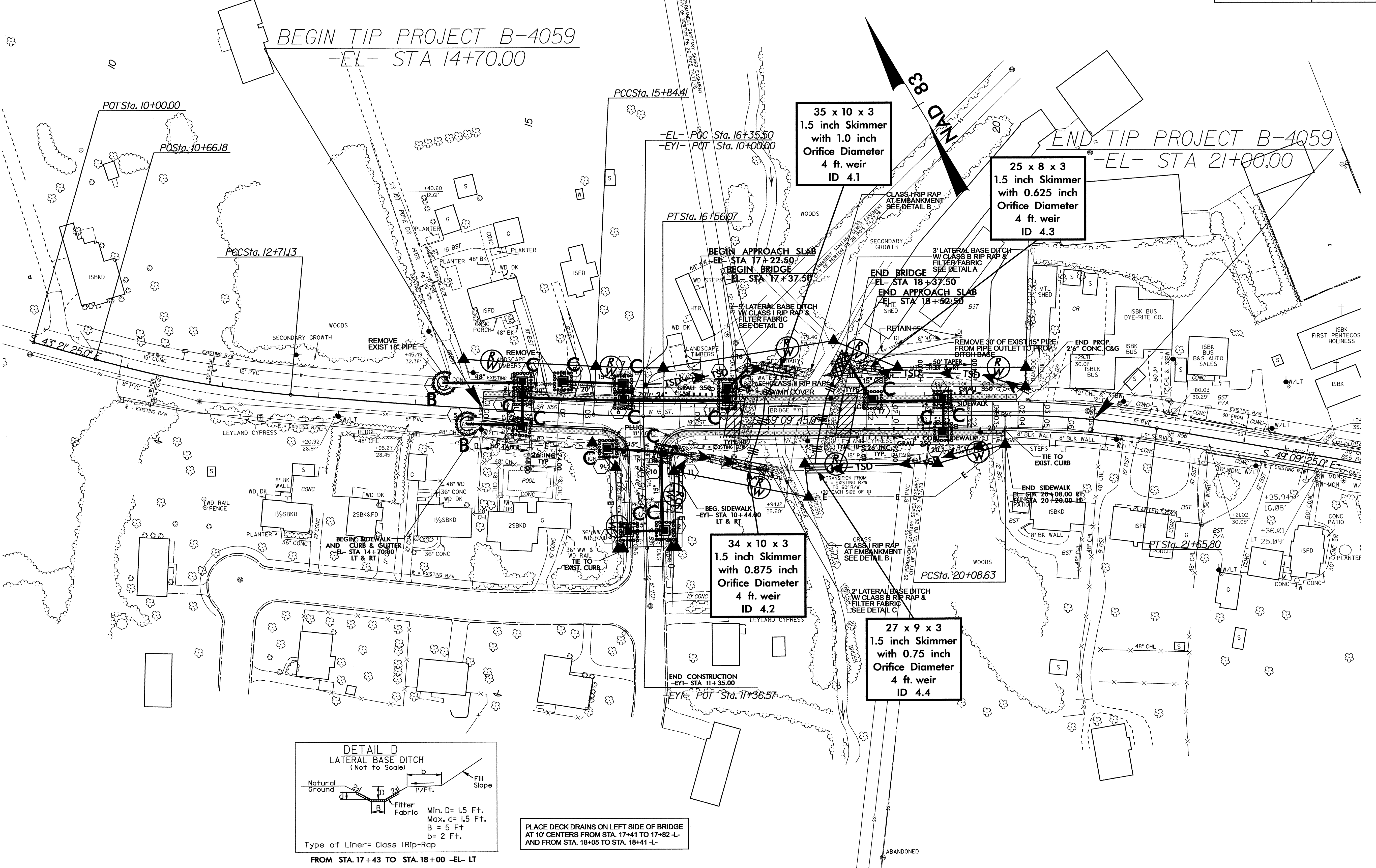

FROM STA. 17+43 TO STA. 18+00 -EL- LT

PLACE DECK DRAINS ON LEFT SIDE OF BRIDGE AT 10' CENTERS FROM STA. 17+41 TO 17+82 L- AND FROM STA. 18+05 TO STA. 18+41 L-