

**TIP PROJECT: B-4312**

STATE OF NORTH CAROLINA  
 DIVISION OF HIGHWAYS  
 PLAN FOR PROPOSED  
 HIGHWAY EROSION CONTROL  
**WARREN COUNTY**

**LOCATION: BRIDGE NO. 42 OVER SHOCCO CREEK AND  
 APPROACHES ON SR 1613 (SHOCCO SPRINGS ROAD)**

**TYPE OF WORK: GRADING, PAVING, DRAINAGE, AND STRUCTURE**

STATE	STATE PROJECT REFERENCE NO.	SHEET NO.	TOTAL SHEETS
N.C.	B-4312	EC-1	
STATE PROJ. NO.	F. A. PROJ. NO.	DESCRIPTION	

**EROSION AND SEDIMENT CONTROL MEASURES**

Sed. #	Description	Symbol
1630.05	Temporary Silt Ditch	TD
1630.05	Temporary Diversion	TD
1605.01	Temporary Silt Fence	III III III
1606.01	Special Sediment Control Fence	III III III
1622.01	Temporary Berms and Slope Drains	TBD
1630.01	Riser Basin	RB
1630.02	Silt Basin Type B	SB
1633.01	Temporary Rock Silt Check Type-A	TRSA
1633.01	Temporary Rock Silt Check Type-B	TRSB
	Wattle	W
1634.01	Temporary Rock Sediment Dam Type-A	TRSDA
1634.02	Temporary Rock Sediment Dam Type-B	TRSDB
1635.01	Rock Pipe Inlet Sediment Trap Type-A	RPIS
1635.02	Rock Pipe Inlet Sediment Trap Type-B	RPIS
1630.04	Stilling Basin	SB
	Rock Inlet Sediment Trap:	
1632.01	Type A	A
1632.02	Type B	B
1632.03	Type C	C
	Skimmer Basin	SKB
	Tiered Skimmer Basin	TSKB
	Infiltration Basin	IB

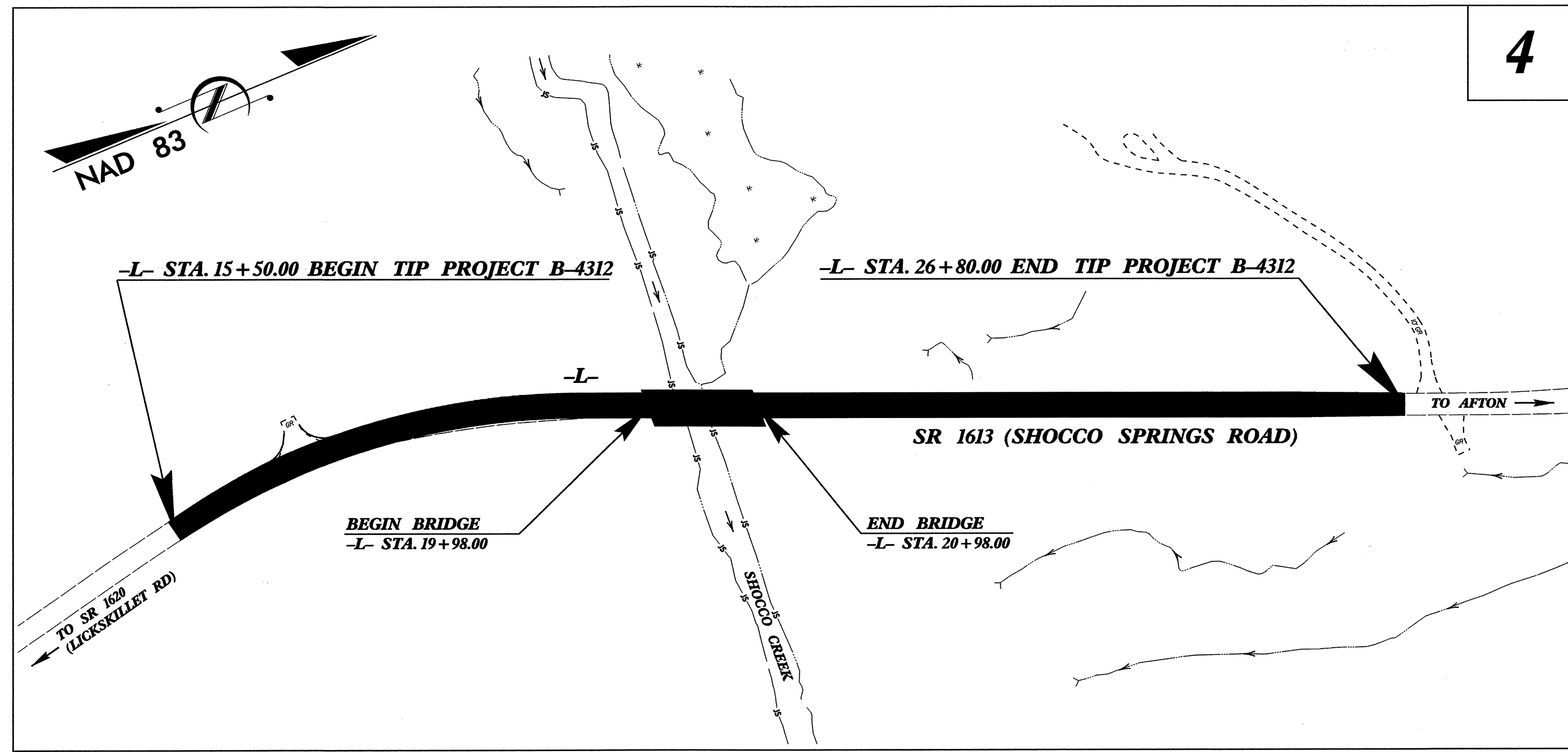

4

THIS PROJECT CONTAINS  
 EROSION CONTROL PLANS  
 FOR CLEARING AND  
 GRUBBING PHASE OF  
 CONSTRUCTION.

THIS PROJECT HAS  
 BEEN DESIGNED TO  
 SENSITIVE WATERSHED  
 STANDARDS.

ENVIRONMENTALLY  
 SENSITIVE AREA(S) EXIST  
 ON THIS PROJECT  
 Refer To E. C. Special Provisions  
 for Special Considerations.

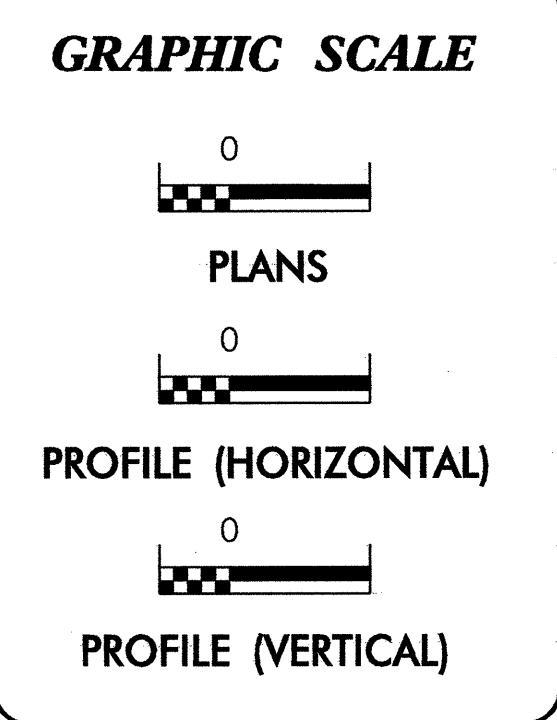

ROADSIDE ENVIRONMENTAL UNIT  
 DIVISION OF HIGHWAYS  
 STATE OF NORTH CAROLINA

Prepared In the Office of:  
**ROADSIDE ENVIRONMENTAL UNIT**  
 1 South Wilmington St.  
 Raleigh, NC 27611  
**2006 STANDARD SPECIFICATIONS**

Roadway Standard Drawings

The following roadway english standards as appear in "Roadway Standard Drawings"- Roadway Design Unit - N. C. Department of Transportation - Raleigh, N. C., dated July 18, 2006 and the latest revision thereto are applicable to this project and by reference hereby are considered a part of these plans.

1605.01 Temporary Silt Fence	1630.05 Temporary Diversion
1606.01 Special Sediment Control Fence	1632.03 Rock Inlet Sediment Trap Type C
1607.01 Gravel Construction Entrance	1634.02 Temporary Rock Sediment Dam Type B
1622.01 Temporary Berms and Slope Drains	1635.02 Rock Pipe Inlet Sediment Trap Type B
1630.03 Temporary Silt Ditch	

PROJECT REFERENCE NO. B-4312	SHEET NO. EC-2
RW SHEET NO.	
ROADWAY DESIGN ENGINEER	HYDRAULICS ENGINEER

# TEMPORARY ROCK SILT CHECK TYPE 'B' DETAIL

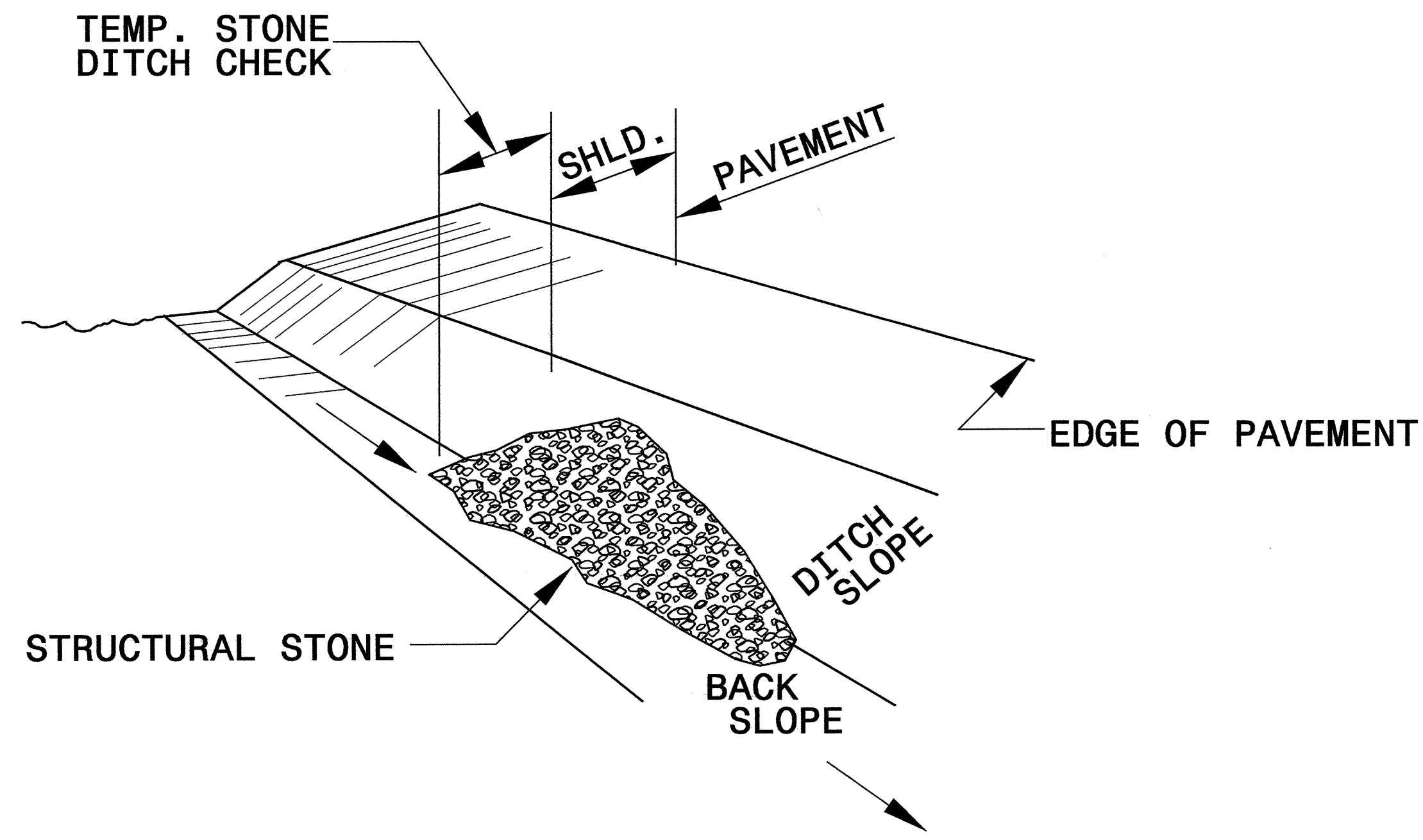

**ISOMETRIC VIEW**

**NOTES:**

USE CLASS 'B' EROSION CONTROL STONE FOR STRUCTURAL STONE.

THE ENGINEER MAY DIRECT THE OPTION OF CLASS "A" STONE FOR SITES HAVING LESS THAN ONE (1) ACRE DRAINAGE AREA AND A DITCH GRADE LESS THAN 3%.

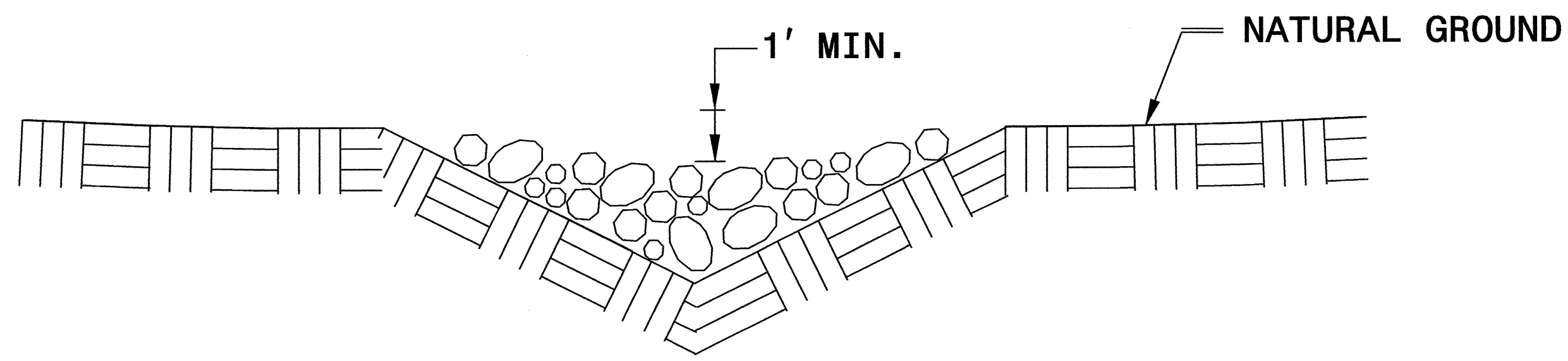

**CROSS SECTION VEE DITCH**

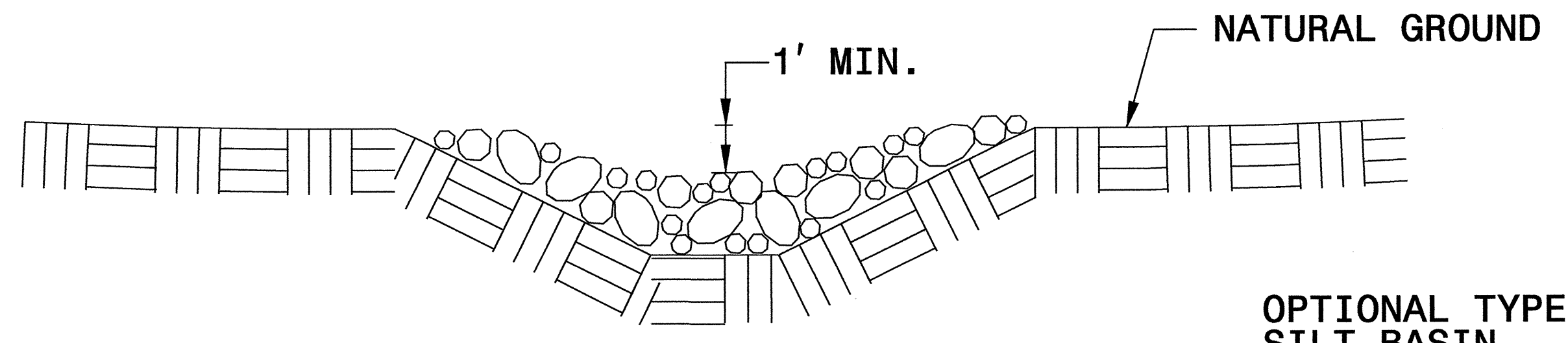

**CROSS SECTION TRAPEZOIDAL DITCH**

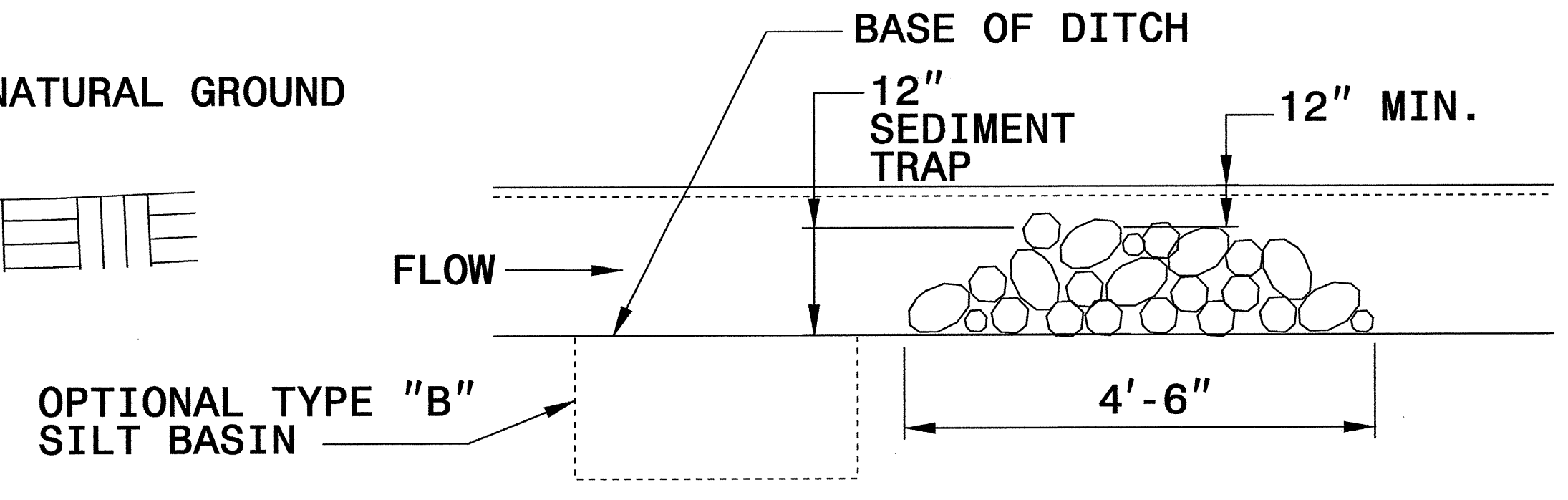

**ELEVATION VIEW**

PROJECT REFERENCE NO. B-4312	SHEET NO. EC-2A
RW SHEET NO.	
ROADWAY DESIGN ENGINEER	HYDRAULICS ENGINEER

# COIR FIBER BAFFLE DETAIL

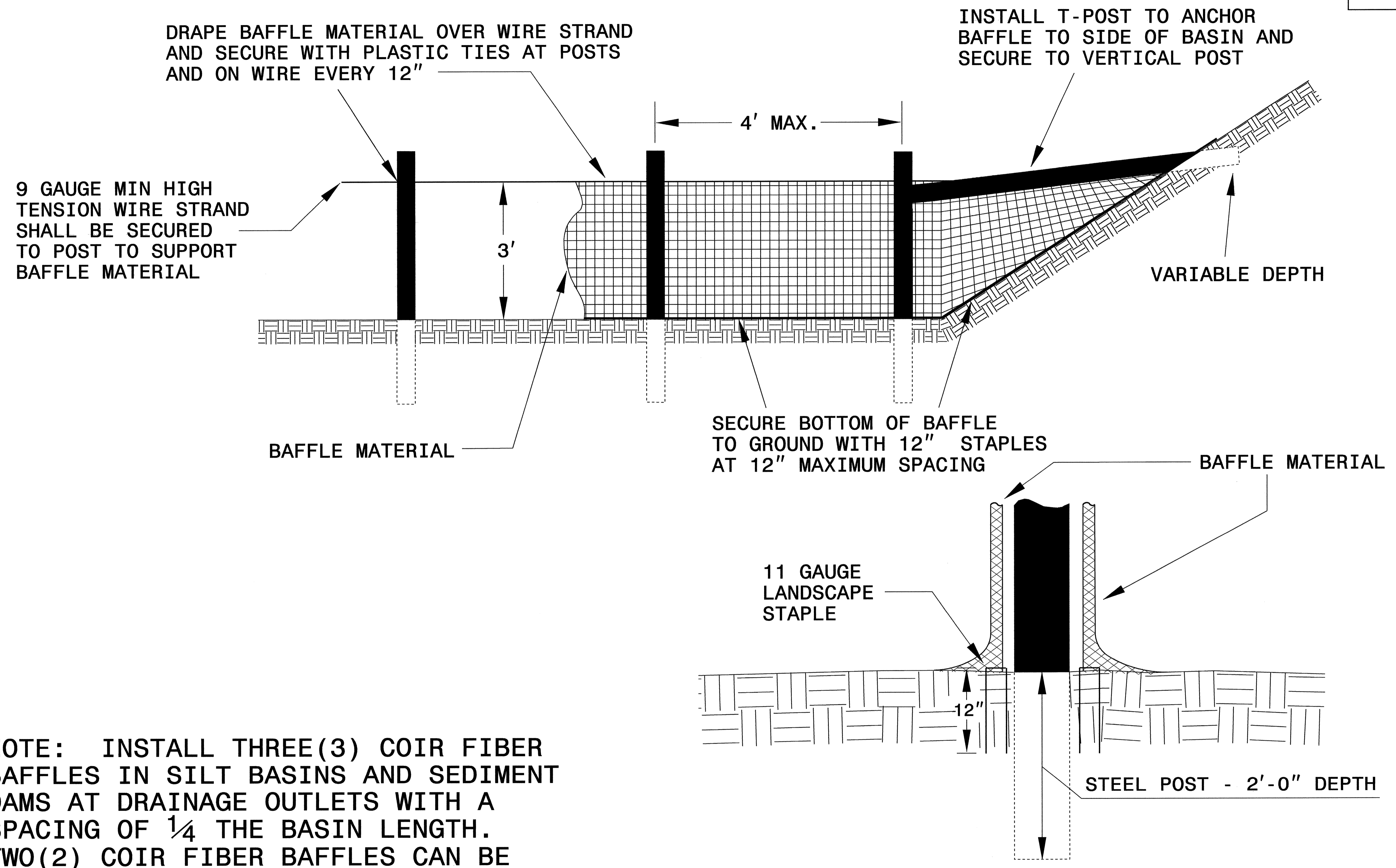

NOTE: INSTALL THREE(3) COIR FIBER BAFFLES IN SILT BASINS AND SEDIMENT DAMS AT DRAINAGE OUTLETS WITH A SPACING OF  $\frac{1}{4}$  THE BASIN LENGTH. TWO(2) COIR FIBER BAFFLES CAN BE INSTALLED IN SILT BASINS AND DAMS LESS THAN 20 FT. IN LENGTH WITH A SPACING OF  $\frac{1}{3}$  THE BASIN LENGTH.

BAFFLE MATERIAL SHALL BE SECURED TO THE BOTTOM AND SIDES OF BASIN USING 12" LANDSCAPE STAPLES

# SKIMMER BASIN WITH BAFFLES DETAIL

PROJECT REFERENCE NO. B-4312	SHEET NO. EC-2B
RW SHEET NO.	
ROADWAY DESIGN ENGINEER	HYDRAULICS ENGINEER

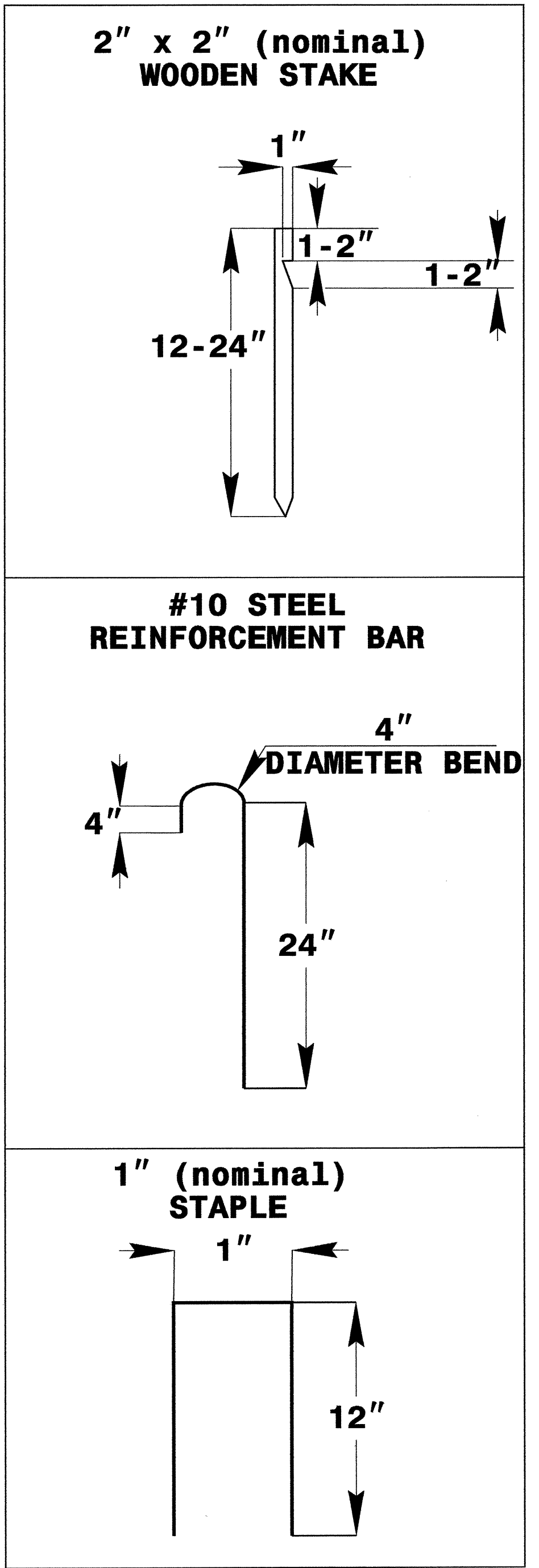
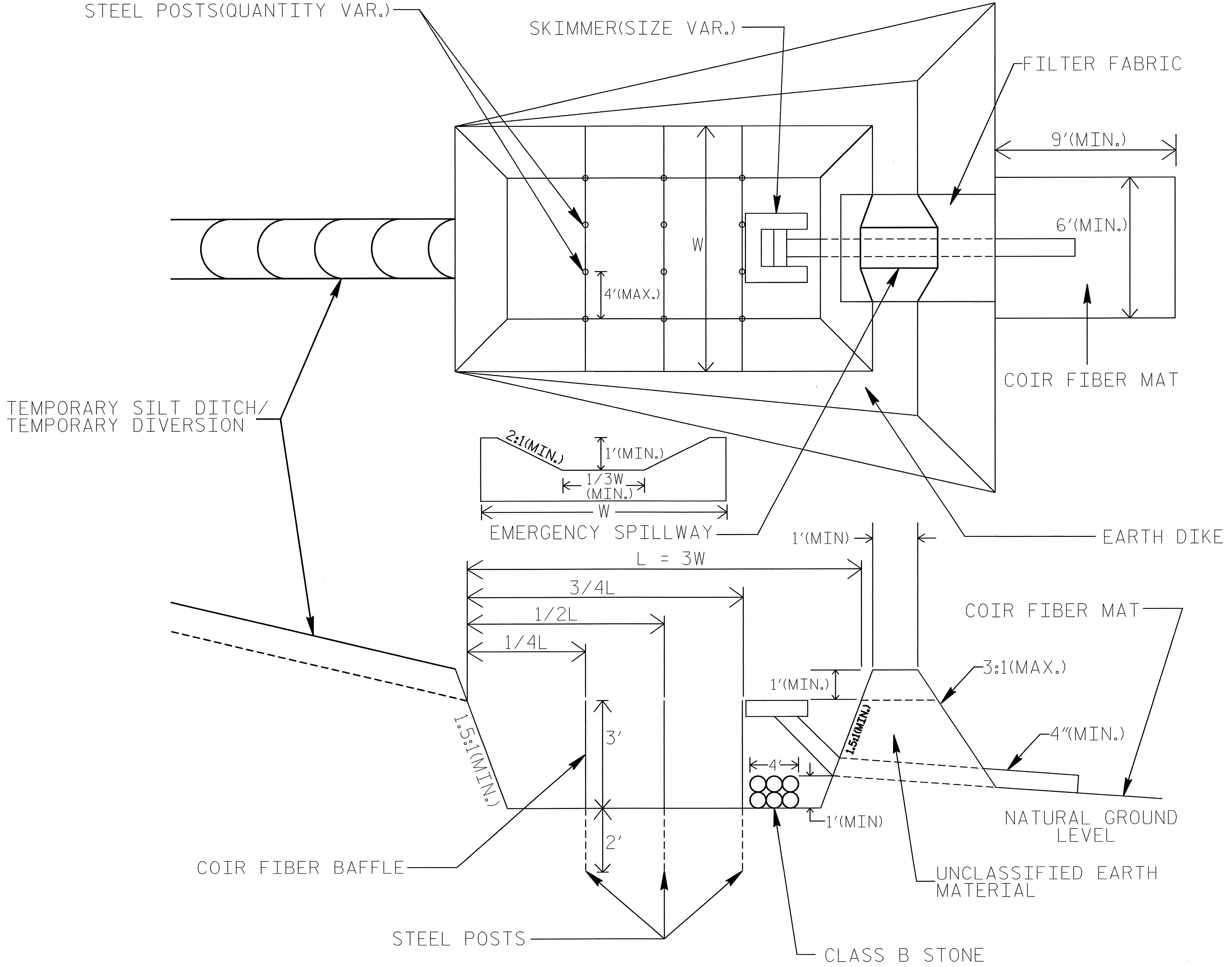

**COIR FIBER MAT ANCHOR OPTIONS**

- NOTES:**
1. SEED AND PLACE MATTING FOR EROSION CONTROL ON SIDESLOPES.
  2. LIMIT EARTH DIKE HEIGHT TO 5 FT.



PROJECT REFERENCE NO.	SHEET NO.
<b>B-4312</b>	EC-4/CONST.4
RW SHEET NO.	HYDRAULICS ENGINEER
ROADWAY DESIGN ENGINEER	

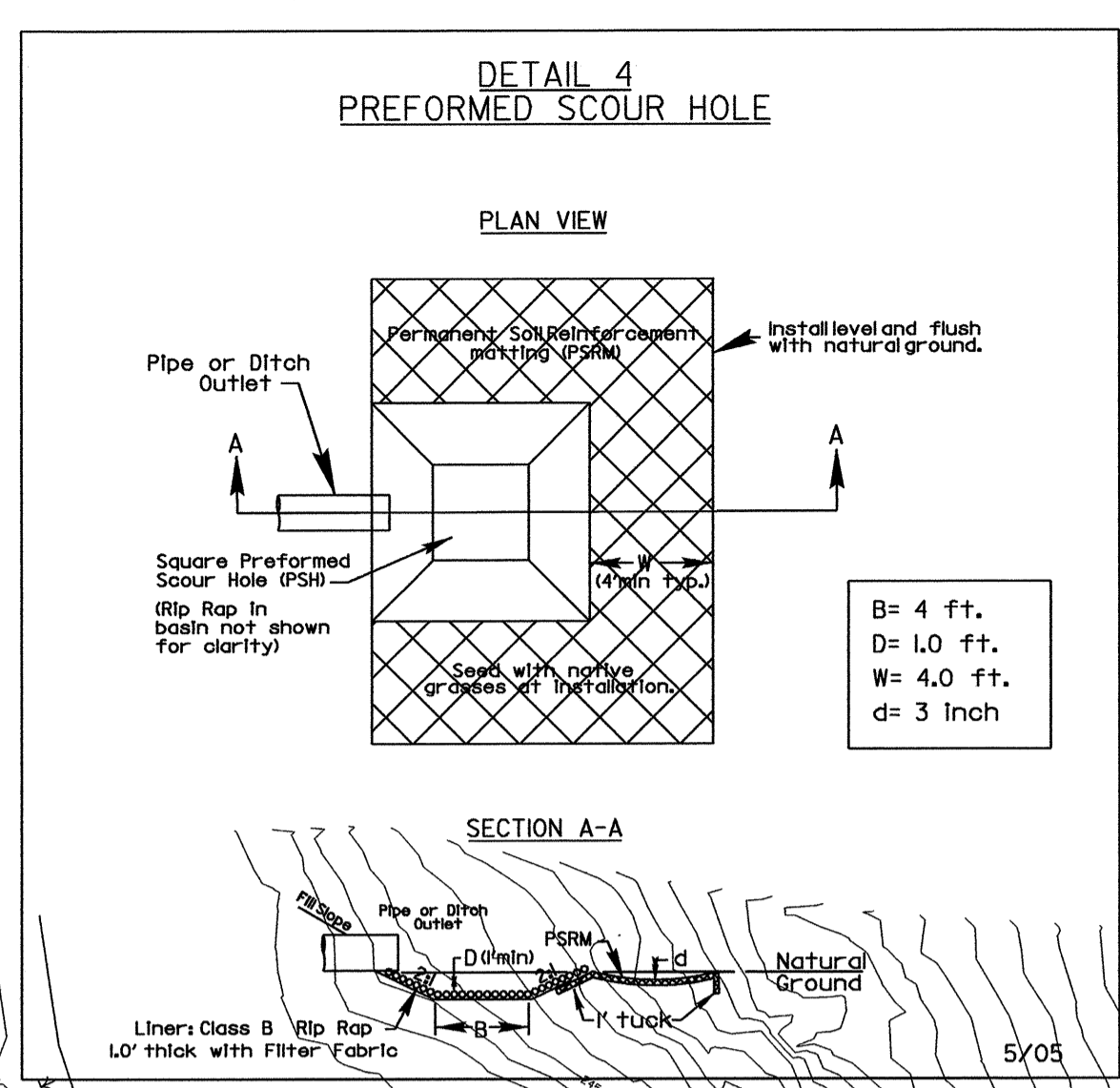
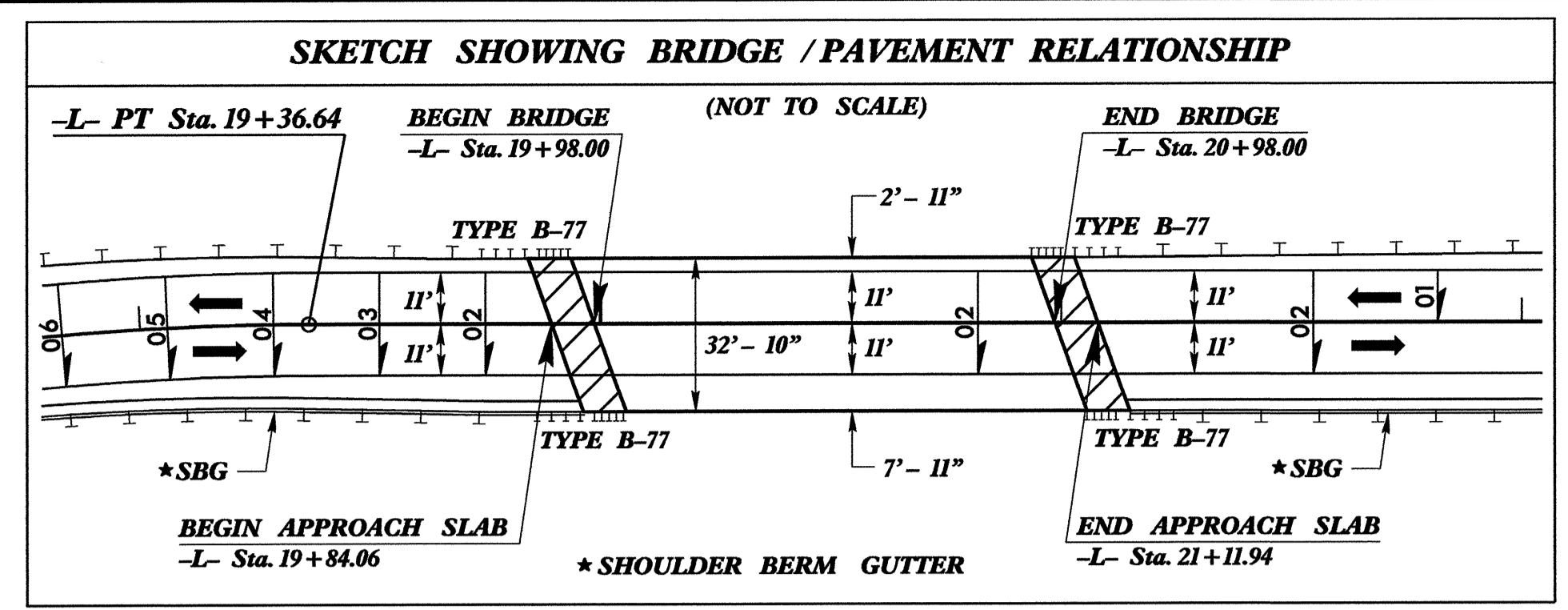

NOTE: PLACE TEMPORARY ROCK SEDIMENT DAMS TYPE - B AND TEMPORARY ROCK SILT CHECKS TYPE - A AT DRAINAGE OUTLETS.

CLEARING AND GRUBBING EROSION CONTROL FOR CONSTRUCTION SHEET 4

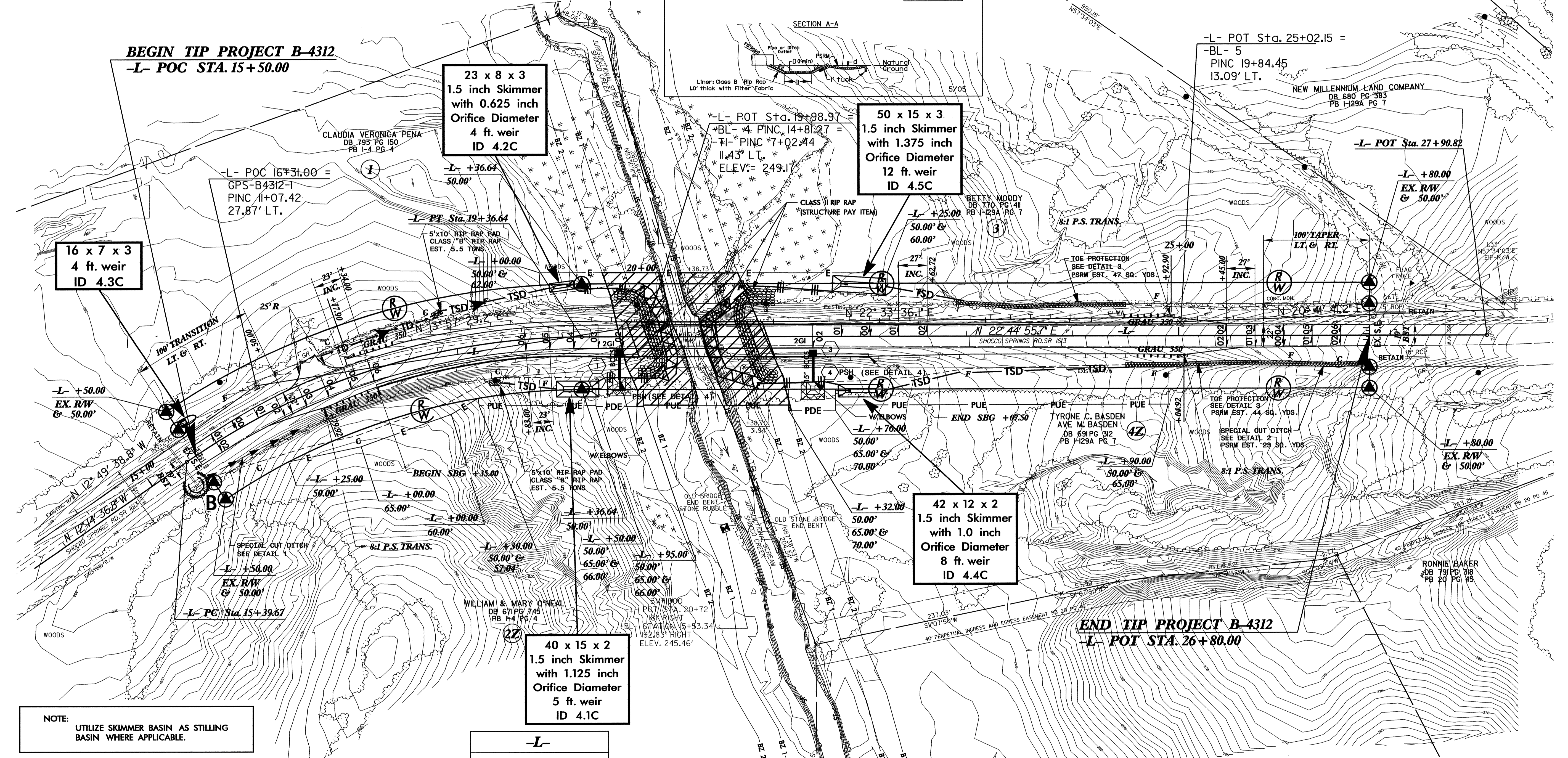

NOTE: UTILIZE SKIMMER BASIN AS STILLING BASIN WHERE APPLICABLE.

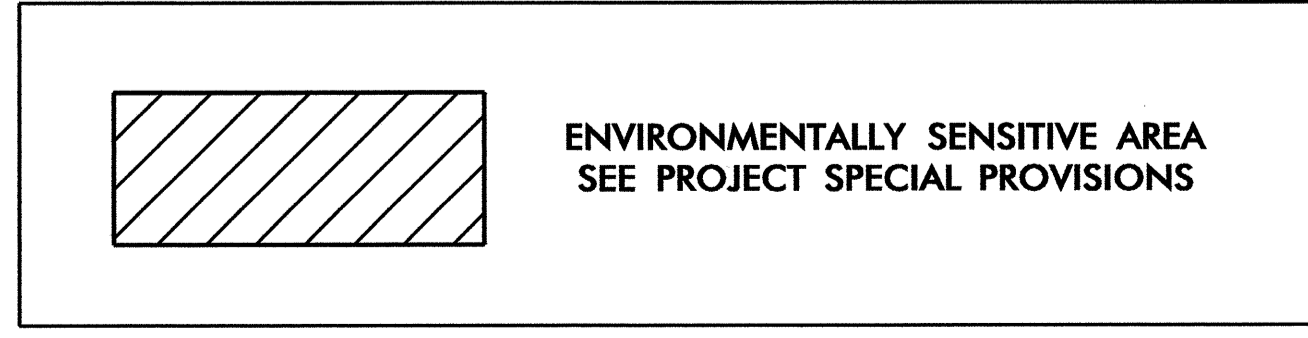

**-L-**  
 \* PI Sta 17+44.56  
 $\Delta = 34^{\circ} 59' 32.5''$  (RT)  
 $D = 8' 48'' 53.0''$   
 $L = 396.98'$   
 $T = 204.90'$   
 $R = 650.00'$   
 $SE = 0.06$   
 $RO = \text{SEE PLANS}$   
 $V_g = 45 \text{ MPH}$

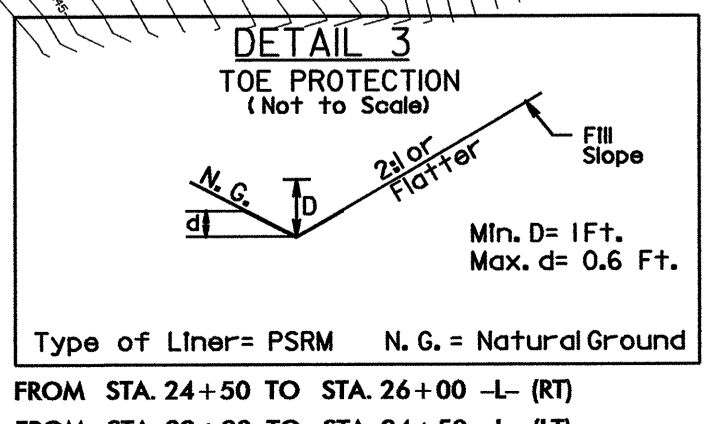
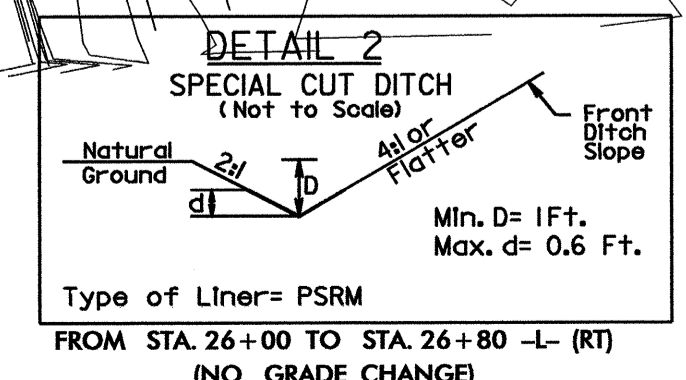
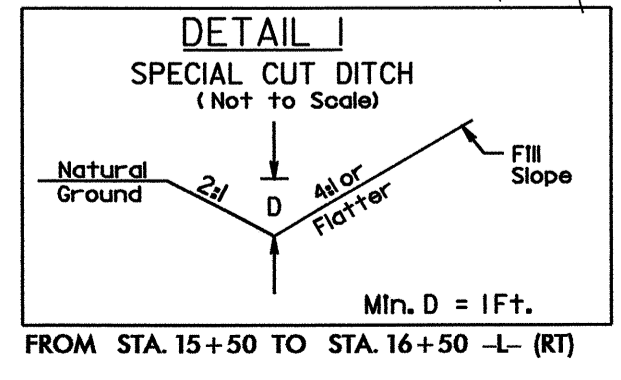

NOTES:  
 1.) FOR -L- PROFILE SEE SHEET 5.  
 2.) ALL DRIVEWAY RADII ARE 10' UNLESS NOTED OTHERWISE.  
 3.) FOR STRUCTURE PLANS SEE SHEETS S-1 THRU S-18.

PROJECT REFERENCE NO. <b>B-4312</b>	SHEET NO. EC-5/CONST.4
R/W SHEET NO.	HYDRAULICS ENGINEER
ROADWAY DESIGN ENGINEER	

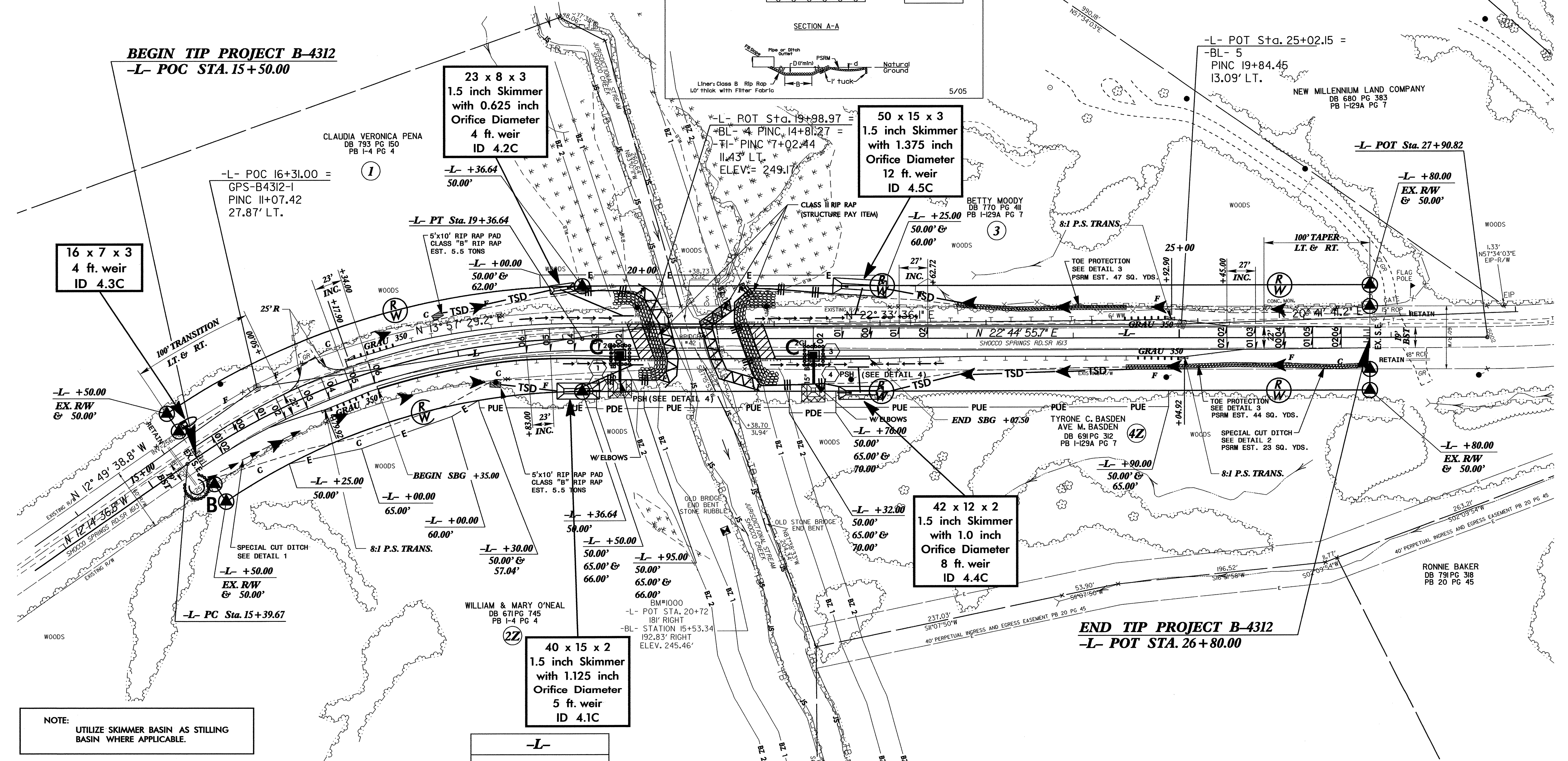
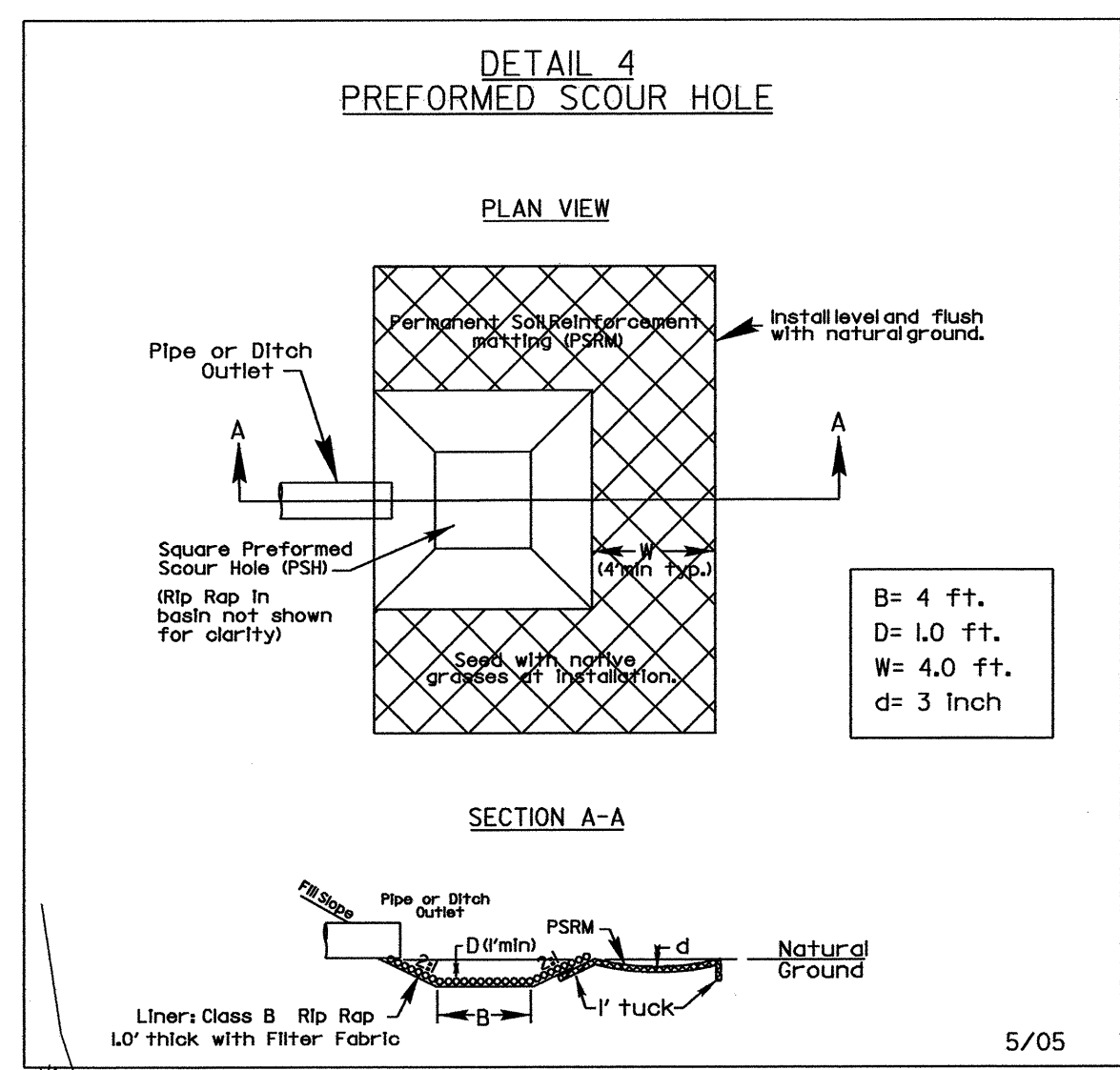
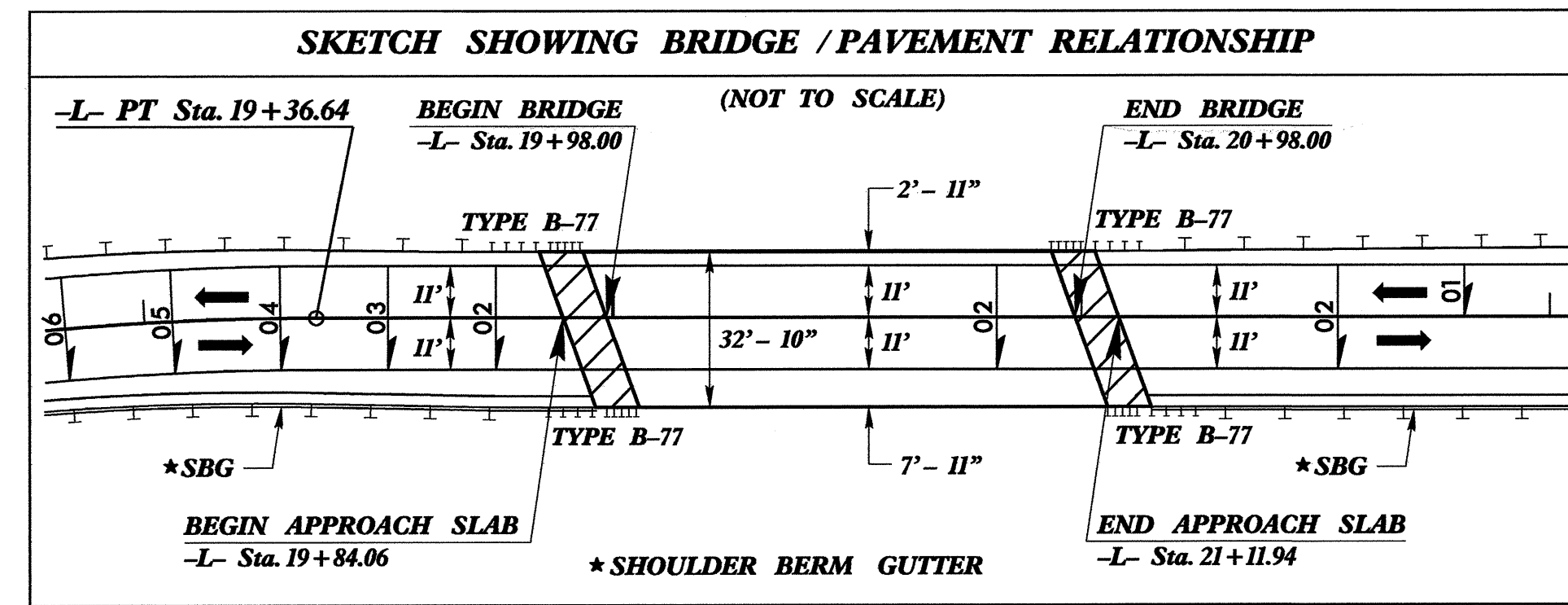

NOTE:  
UTILIZE SKIMMER BASIN AS STILLING BASIN WHERE APPLICABLE.

**-L-**  
\* PI Sta 17+44.56  
Δ = 34° 59' 32.5" (RT)  
D = 8' 48" 53.0"  
L = 396.98'  
T = 204.90'  
R = 650.00'  
SE = 0.06  
RO = SEE PLANS  
V<sub>g</sub> = 45 MPH

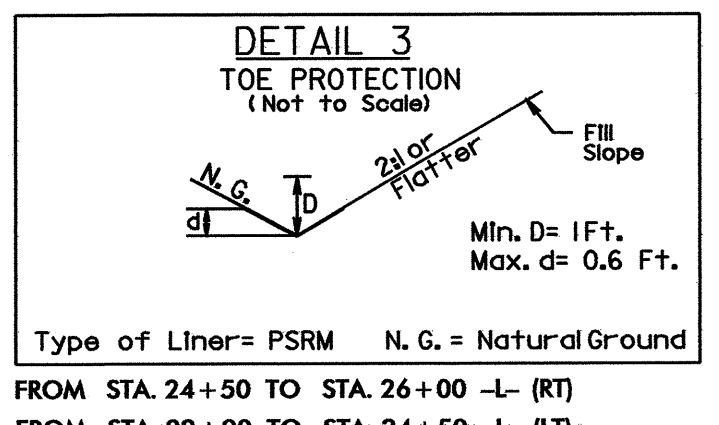
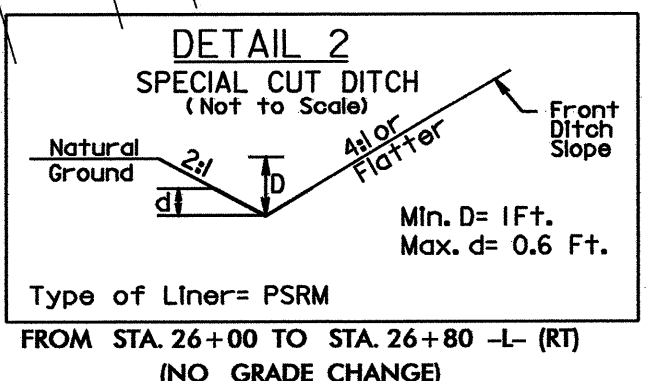
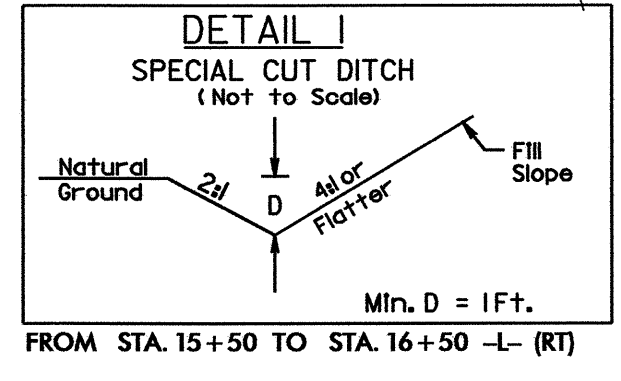

NOTES:  
1.) FOR -L- PROFILE SEE SHEET 5.  
2.) ALL DRIVEWAY RADII ARE 10' UNLESS NOTED OTHERWISE.  
3.) FOR STRUCTURE PLANS SEE SHEETS S-1 THRU S-18.