





COMPUTED BY: MRT      DATE: 2-6-2008  
 CHECKED BY: GSD      DATE: 4-5-2008

PROJECT REFERENCE NO. R-4425      SHEET NO. Scot-3

DIVISION OF HIGHWAYS  
 STATE OF NORTH CAROLINA

**GUARDRAIL SUMMARY**

"N" = DISTANCE FROM EDGE OF LANE TO FACE OF GUARDRAIL  
 TOTAL SHOULDER WIDTH = DISTANCE FROM EDGE OF TRAVEL LANE TO SHOULDER BREAK POINT  
 FLARE LENGTH = DISTANCE FROM LAST SECTION OF PARALLEL GUARDRAIL TO END OF GUARDRAIL  
 W = TOTAL WIDTH OF FLARE FROM BEGIN

G = GATING IMPACT ATTENUATOR TYPE 350  
 NG = NON-GATING IMPACT ATTENUATOR TYPE 350

Location (Scotland Co.)	Field Reference	LENGTH				"N" DIST. FROM E.O.L.	TOTAL SHOUL WIDTH	FLARE LENGTH		W		ANCHORS							IMPACT ATTENUATOR TYPE 350		REPLACE OFFSET BLOCKS	REMOVE EXISTING GUARDRAIL	REMOVE & STOCKPILE EXISTING GUARDRAIL	REMARKS																			
		STRAIGHT	SHOP CURVED		TRIPLE CORRUGATED			APPROACH END	TRAILING END	APPROACH END	TRAILING END	Type III MOD	B-77	B-83	M-350	GRAU 350	CAT-1	AT-1							G	NG																	
<b>US 401 NB</b>																																											
#74	US401ns01																																										
NB Outside Approach		300				4	7																																				
NB Outside Trail		137.5				4	7															Place New GR as per Std. 862.01																					
SB Outside Trail		137.5				4	7															Place New GR as per Std. 862.01																					
SB Outside Approach		300				4	7															Place New GR as per Std. 862.01																					
#75	US401ns02																																										
Outside Approach																																											
Outside Trail		50																				Replace End Unit																					
#76	US401ns03																					Remove End Unit, Extend GR and Replace End Unit																					
Outside Approach																																											
Median Area		137.5																				Replace Structural Anchor Unit																					
#77	US401ns04																					Add GR to Protect Piers																					
Outside Approach																																											
Median Approach																						Replace Structural Anchor Unit & End Unit																					
#78 (Off Ramp)	US401ns05																					Replace Structural Anchor Unit & End Unit																					
#79	US401ns 06																					Replace End Unit																					
Outside Trail																																											
Median Trail																						Replace Structural Anchor Unit																					
#80	US401ns 07 & 08																					Replace Structural Anchor Unit & End Unit																					
Outside Approach																																											
Outside Trail																						Replace Structural Anchor Unit & End Unit																					
Median Approach																						Replace Structural Anchor Unit																					
Median Trail																						Replace Structural Anchor Unit & End Unit																					
#82	US401ns09																					Replace Structural Anchor Unit & End Unit																					
#83	US401ns10																					Replace Structural Anchor Unit																					
#84	US401ns 11	50																				Replace Structural Anchor Unit & End Unit																					
#85 (On Ramp)	US401ns12																					Replace Structural Anchor Unit & End Unit																					
US 401 NB Total		1112.5	0																			0      0      243.75																					
<b>US 401 SB</b>																																											
#86	US401ss01																																										
#87	US401ss02																					Replace End Unit on Approach (Shop Curved)																					
#88	US401ss03																					Replace End Unit on Approach																					
Outside Approach																																											
Outside Trail																						Replace Structural Anchor Unit & End Unit																					
Median Approach																						Replace Structural Anchor Unit																					
Median Trail																						Replace Structural Anchor Unit & End Unit																					
#89	US401ss04																					Replace Structural Anchor Unit & End Unit																					
#90	US401ss05																					Replace End Unit on Approach																					
Outside Approach																																											
Median Approach																						Replace Structural Anchor Unit & End Unit																					
Median Trail																						Replace Structural Anchor Unit & End Unit																					
#91 (on Ramp)	US401ss06																					Replace Structural Anchor Unit & End Unit																					
#92	US401ss07																					Replace Approach End Unit																					
Outside Approach																																											
Median Area		137.5																				Replace Structural Anchor Unit																					
#93	US401ss08																					Add GR to Protect Piers																					
US 401 SB Total		137.5																				0      256.25																					
<b>US 401NB (2-Lane)</b>																																											
#95		300				4	7																																				
#96		300				4	7															Place New GR as per Std. 862.01. Sheet 9																					
#97		300				4	7															Place New GR as per Std. 862.01. Sheet 9																					
#98		300				4	7															Place New GR as per Std. 862.01. Sheet 9																					
#99		300				4	7															Place New GR as per Std. 862.01. Sheet 9																					
#100		400				4	7															Place New GR as per Std. 862.01. Sheet 9																					
Subtotal		1900																																									
Subtotal US 401		3150																																									
Less Deductions	GRAU 350 26 @ 50'	1300																				* ITEMS CALCULATED IN ANCHOR DEDUCTIONS																					
US 401 TOTAL		1850																				3      8      11      12      41      3      0      0      500																					



PROJECT REFERENCE NO. R-4425	SHEET NO. SCOT-5
RW SHEET NO.	
DIVISION 8 DDC ENGINEER	



REVISIONS

SEE SHEET SCOT-6

RICHMOND CO.

8/17/99  
 18-APR-2008 13:44  
 D:\RDY\4425\scot5\scot5.dgn  
 8/17/99

PROJECT REFERENCE NO. R-4425	SHEET NO. SCOT-6
RW SHEET NO.	
DIVISION & DDC ENGINEER	



SEE SHEET SCOT-5

SEE SHEET SCOT-7

REVISIONS



8/17/09  
 18-APR-2008 13:44  
 D:\PROJ-R-4425\SCOT\SCOT1\ENDUS74-2.dgn  
 G:\PROJ-R-4425\SCOT\SCOT1\ENDUS74-2.dgn

PROJECT REFERENCE NO.	SHEET NO.
R-4425	SCOT-7
R/W SHEET NO.	
DIVISION 8 DDC ENGINEER	



SEE SHEET SCOT-6  
Elmores  
Crossroads

SEE SHEET SCOT-8

REVISIONS

8/17/99

18-APR-2008 13:44  
D:\FDV\AR-4425\Scots\scot7.dgn  
Scot7.dwg

PROJECT REFERENCE NO. R-4425	SHEET NO. SCOT-8
RW SHEET NO.	
DIVISION 8 DDC ENGINEER	

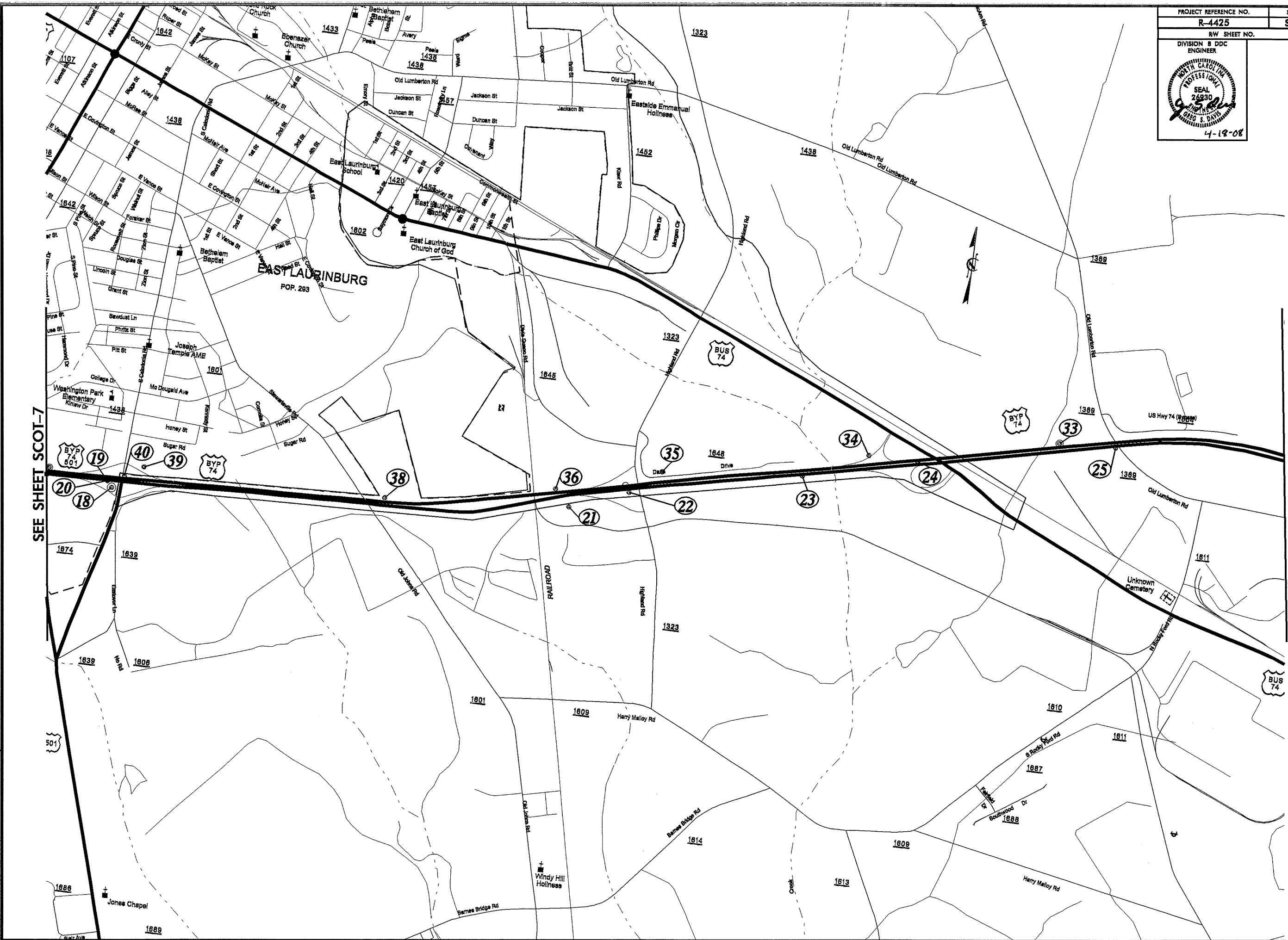

SEE SHEET SCOT-7

SEE SHEET SCOT-9

REVISIONS

6/17/09  
18-APR-2008 13:44  
D:\PROJ\4425\SCOT\Map\ScotLan\US74-4.dgn



PROJECT REFERENCE NO.	SHEET NO.
R-4425	SCOT-9
RW SHEET NO.	
DIVISION 8 DDC ENGINEER	
	
4-13-08	



REVISIONS

SEE SHEET SCOT-8

18-APR-2008 13:44  
 D:\RDY\4425\Scot\land\Scot1andUS74-5.dgn  
 8/17/99

PROJECT REFERENCE NO. R-4425	SHEET NO. SCOT-10
RW SHEET NO.	
DIVISION 8 DDC ENGINEER	
4-13-08	

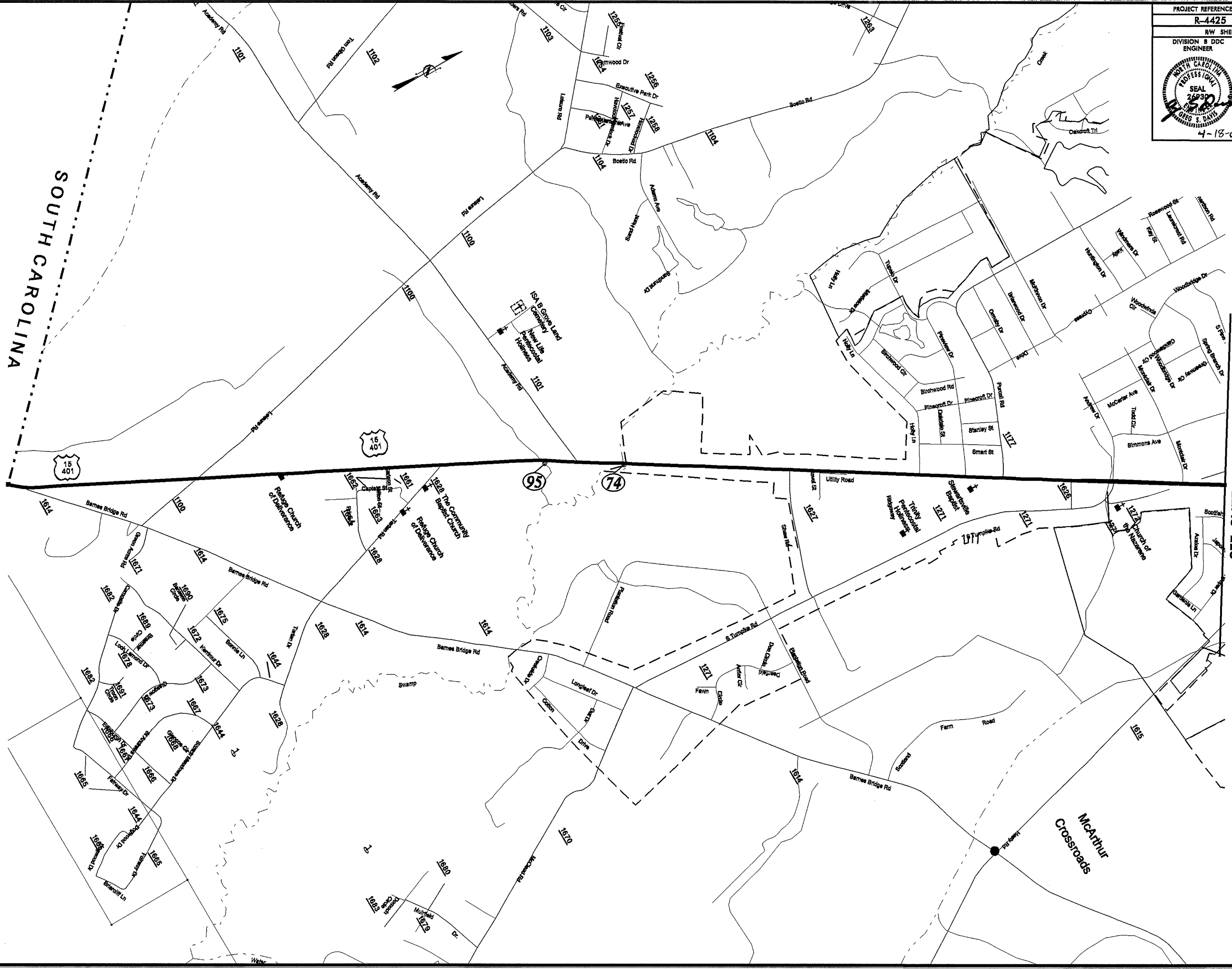

SOUTH CAROLINA

SEE SHEET SCOT-11

REVISIONS

8/17/99  
 18-APR-2008 13:44  
 D:\ROY-R-4425\scot10\scot10ndus401-6.dgn

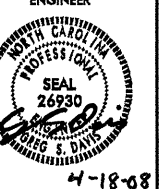
PROJECT REFERENCE NO. R-4425	SHEET NO. SCOT-11
RW SHEET NO.	
DIVISION 8 DDC ENGINEER	
	



SEE SHEET SCOT-10

SEE SHEET SCOT-12

REVISIONS

8/17/99  
 18-APR-2008 13:45  
 D:\ROY-RR-4425\SCOT11.dwg  
 4-18-08

PROJECT REFERENCE NO. R-4425	SHEET NO. SCOT-12
RW SHEET NO.	
DIVISION 8 DDC ENGINEER	

REVISIONS

SEE SHEET SCOT-11

SEE SHEET SCOT-13

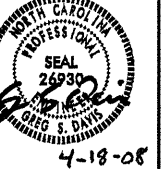

PROJECT REFERENCE NO. <b>R-4425</b>	SHEET NO. <b>SCOT-13</b>
RW SHEET NO.	
DIVISION 8 DDC ENGINEER	
	



McGee's  
AME Zion  
Shaw Elementary  
School

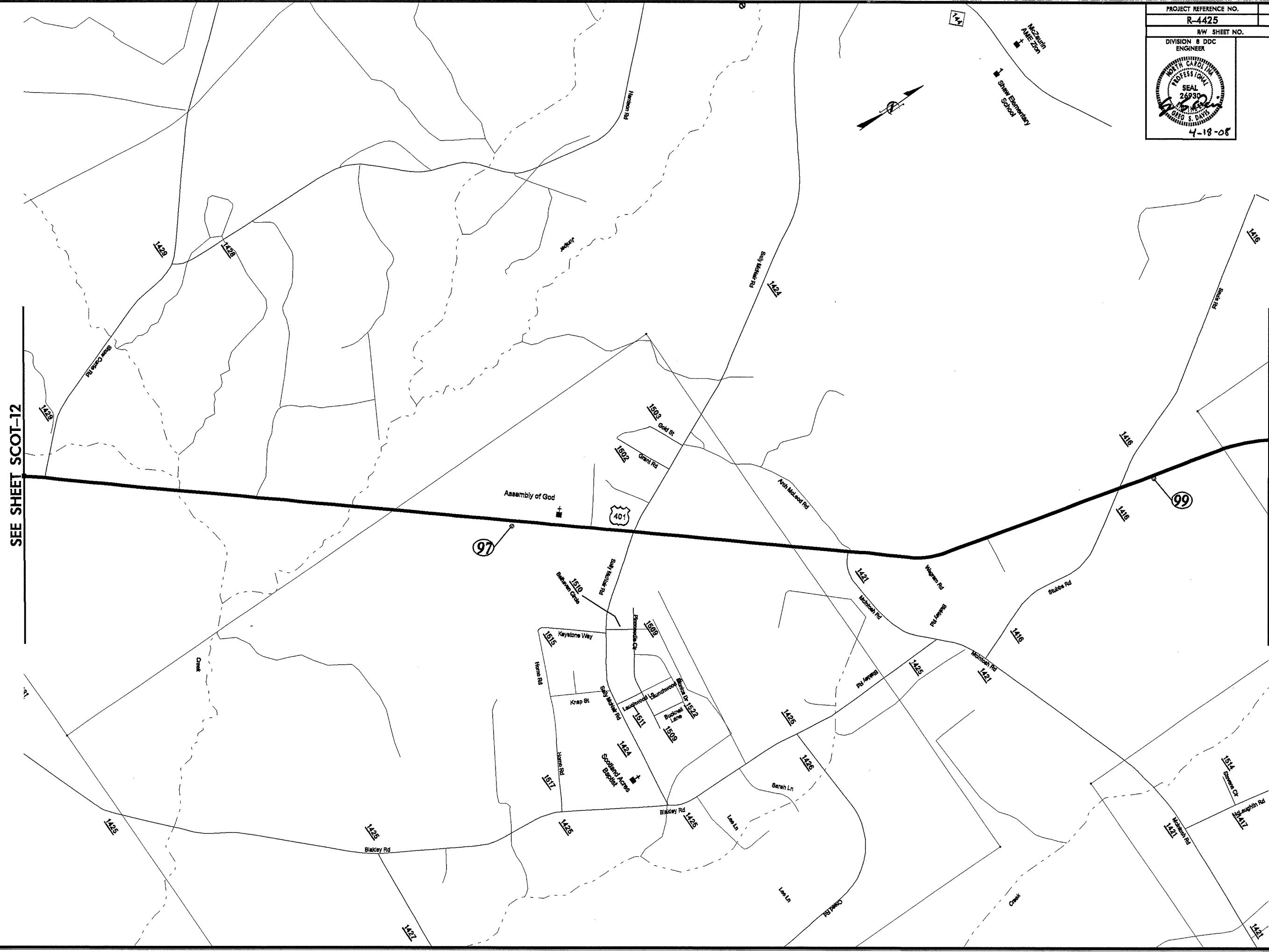

SEE SHEET SCOT-12

SEE SHEET SCOT-14

REVISIONS

8/17/99  
18-APR-2008 13:45  
D:\FDY\18-4425\SCOT\landUS\101-9.dgn  
scot13.dwg

PROJECT REFERENCE NO. R-4425	SHEET NO. SCOT-14
RW SHEET NO.	
DIVISION 8 DDC ENGINEER	

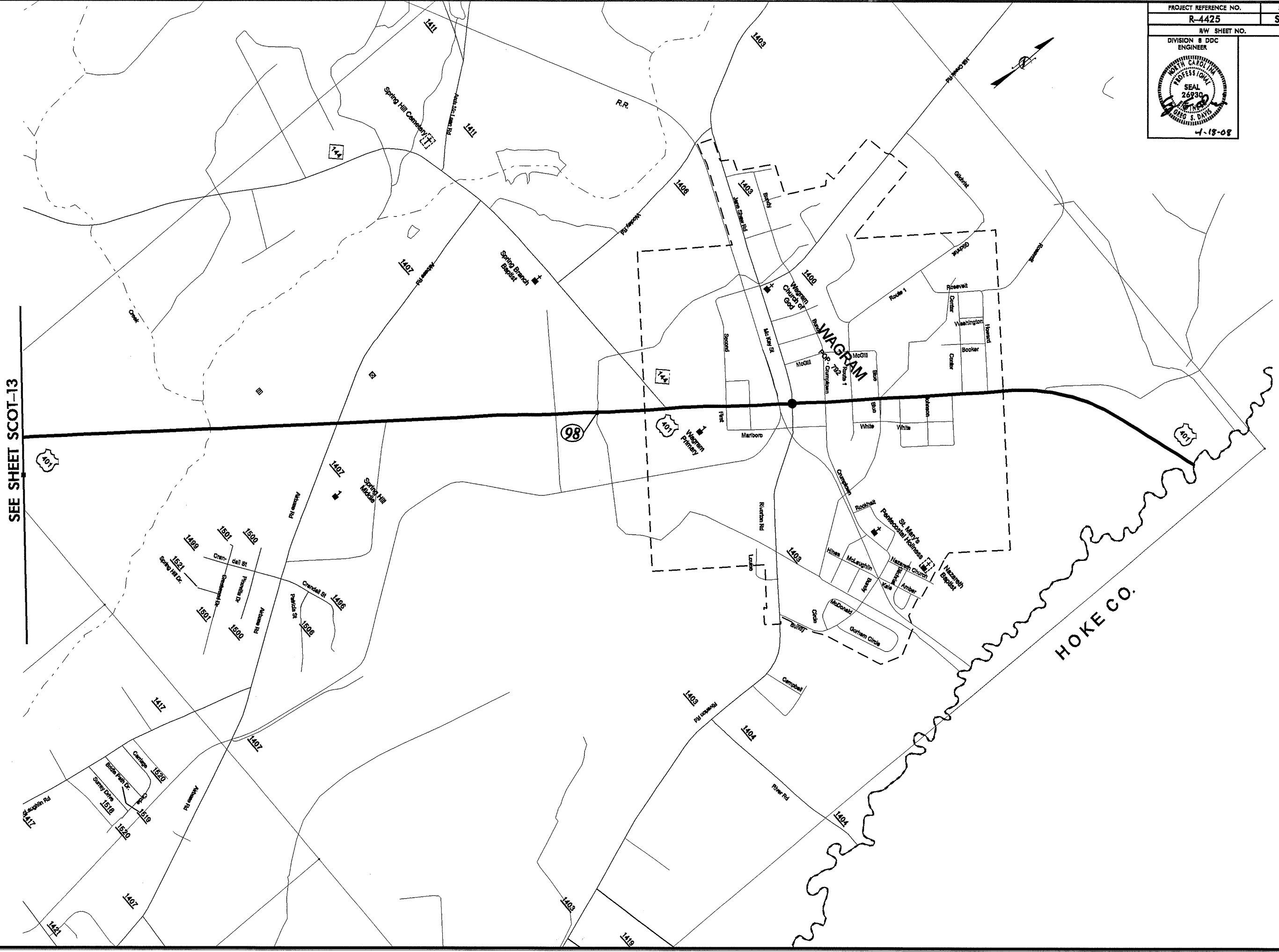

SEE SHEET SCOT-13

REVISIONS

8/17/99  
 18-APR-2008 13:45  
 Dr: FDR/R-4425/Scot1andUS401-10.dgn  
 18-APR-2008 13:45

HOKE CO.