

R:\Roadway\XSC\lear.log

| PROJ. REFERENCE NO. | SHEET NO. |
|---------------------|-----------|
| B-4210 | X-1A |

**STATE OF NORTH CAROLINA
DIVISION OF HIGHWAYS
CROSS-SECTION SUMMARY**

Approximate quantities only. Unclassified excavation, fine grading, clearing and grubbing, breaking of existing asphalt pavement, removal of existing asphalt pavement, and removal of existing concrete pavement will be paid for at the lump sum price for "Grading".

NOTE: EMBANKMENT COLUMN DOES NOT INCLUDE BACKFILL FOR UNDERCUT

| Station | Uncl. Exc. (cu. yd.) | Embt (cu. yd.) |
|----------------|-------------------------|-------------------|
| 10+00.00 | 0 | 0 |
| 10+50.00 | 2 | 51 |
| 11+00.00 | 3 | 113 |
| 11+50.00 | 2 | 130 |
| 12+00.00 | 2 | 159 |
| 12+50.00 | 3 | 184 |
| 13+00.00 | 4 | 187 |
| 13+03.80 | 1 | 7 |
| Station | Uncl. Exc. | Embt |
| L | (cu. yd.) | (cu. yd.) |
| 13+92.89 | 0 | 0 |
| 14+00.00 | 0 | 28 |
| 14+50.00 | 0 | 394 |
| 15+00.00 | 0 | 434 |
| 15+50.00 | 0 | 472 |
| 16+00.00 | 1 | 476 |
| 16+50.00 | 2 | 444 |
| 17+00.00 | 1 | 203 |
| Station | Uncl. Exc. | Embt |
| Dr1 | (cu. yd.) | (cu. yd.) |
| 10+00.00 | 0 | 0 |
| 10+50.00 | 0 | 233 |
| 10+53.72 | 0 | 18 |

Note: Earthwork quantities are calculated by the Roadway Design Unit. These earthwork quantities are based in part on subsurface data provided by the Geotechnical Engineering Unit.

8/23/99

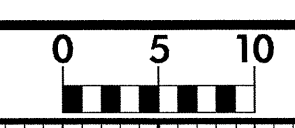

| | |
|---------------------|-----------|
| PROJ. REFERENCE NO. | SHEET NO. |
| B-4210 | X-1 |

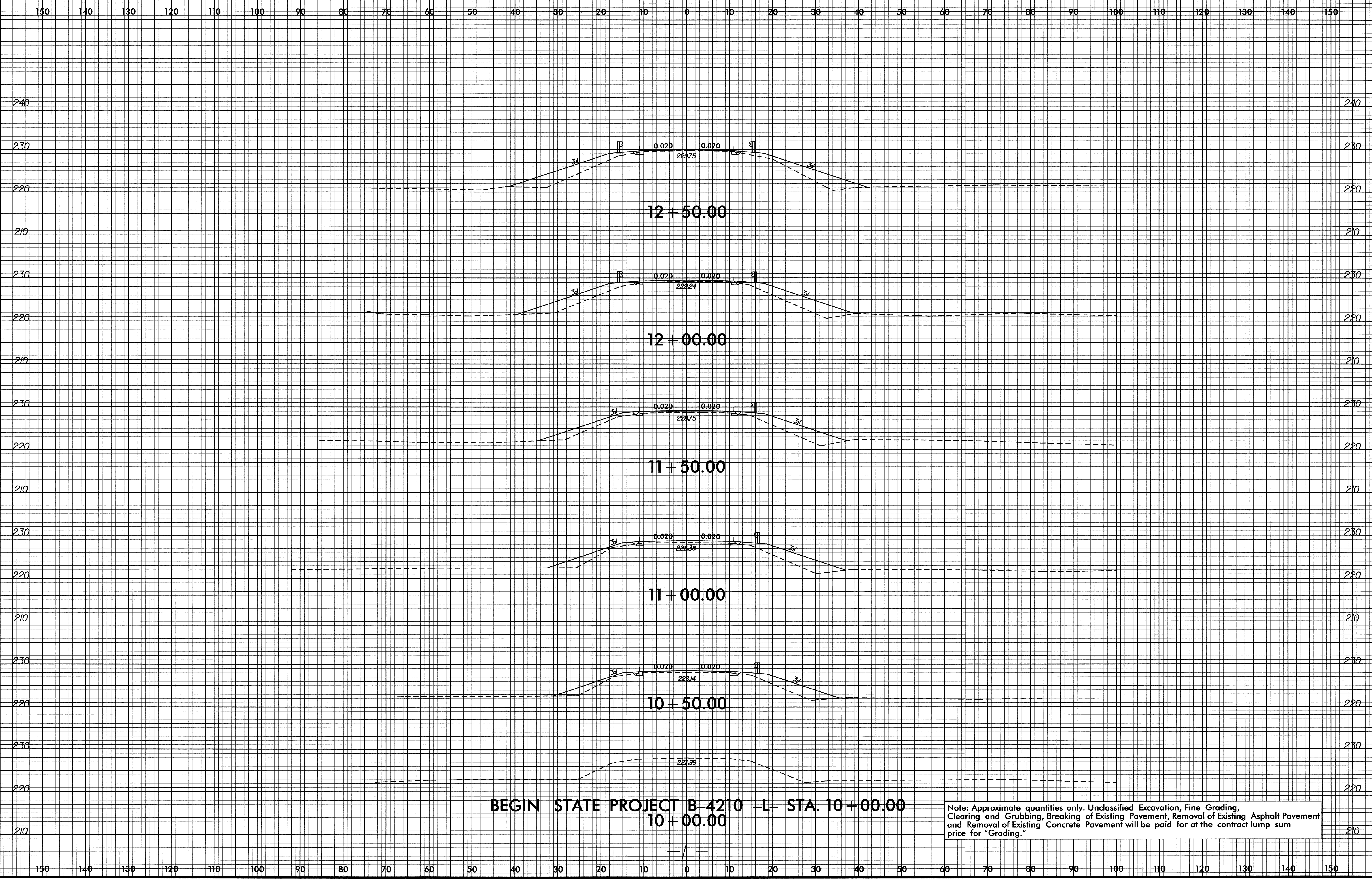

BEGIN STATE PROJECT B-4210 -L- STA. 10+00.00
10+00.00

Note: Approximate quantities only. Unclassified Excavation, Fine Grading, Clearing and Grubbing, Breaking of Existing Pavement, Removal of Existing Asphalt Pavement and Removal of Existing Concrete Pavement will be paid for at the contract lump sum price for "Grading."

18-MAR-2008 08:26
 P:\PROJECTS\B-4210-X-1\RDY\B4210-X-1.rdy_xpl.dgn
 \$\$\$USERNAME\$\$\$

8/23/99

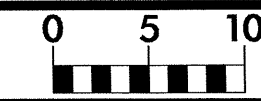

PROJ. REFERENCE NO.
B-4210

SHEET NO.
X-2

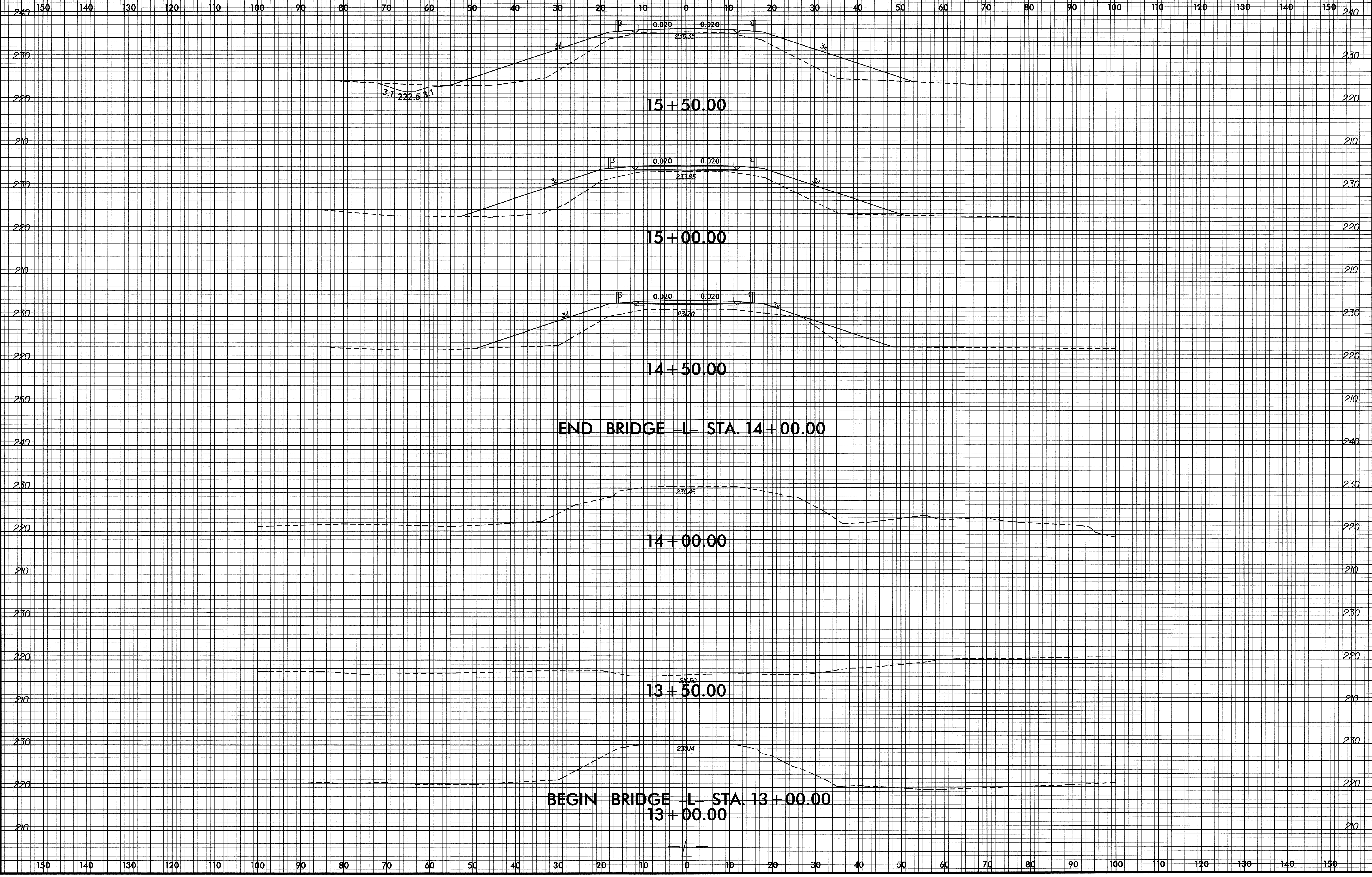

04-MAR-2008 14:22
R:\PROJECTS\B4210\B4210_rdy_xpl.dgn
3:33:58 USER:RCH

8/23/09



PROJ. REFERENCE NO.
B-4210

SHEET NO.
X-3

150 140 130 120 110 100 90 80 70 60 50 40 30 20 10 0 10 20 30 40 50 60 70 80 90 100 110 120 130 140 150

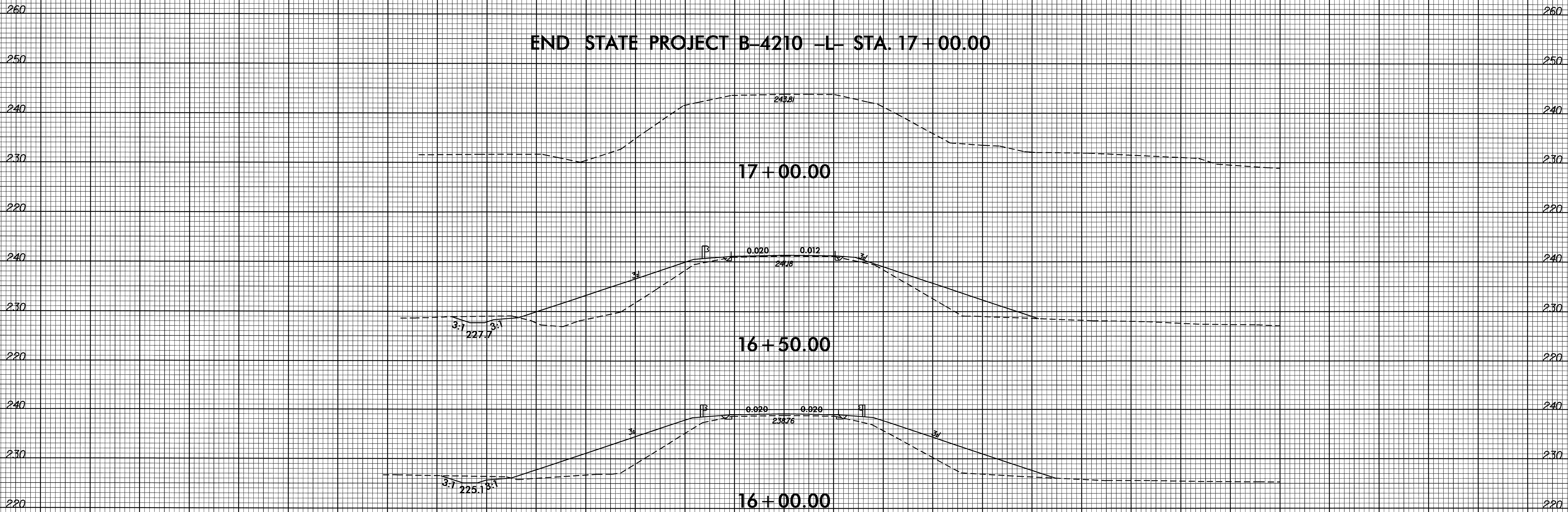

150 140 130 120 110 100 90 80 70 60 50 40 30 20 10 0 10 20 30 40 50 60 70 80 90 100 110 120 130 140 150

04-MAR-2008 14:22
P:\FORSEY\B-4210-rdy_xpl.dgn
B-4210-X-3

8/23/99

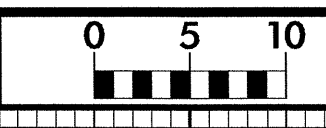

| | |
|---------------------|-----------|
| PROJ. REFERENCE NO. | SHEET NO. |
| B-4210 | X-4 |

150 140 130 120 110 100 90 80 70 60 50 40 30 20 10 0 10 20 30 40 50 60 70 80 90 100 110 120 130 140 150

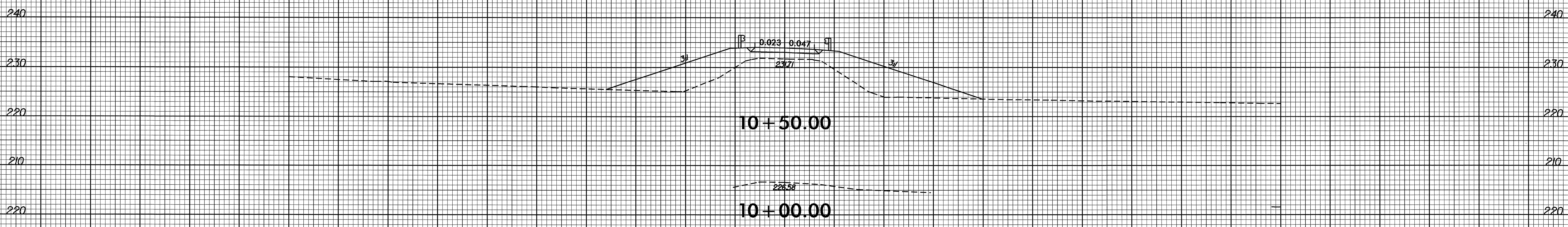

10+50.00

10+00.00

BEGIN CONST. -DRI- STA. 10+00.00

-DRI-

150 140 130 120 110 100 90 80 70 60 50 40 30 20 10 0 10 20 30 40 50 60 70 80 90 100 110 120 130 140 150

26-MAR-2008 14:27
F:\Projects\X\SCN\B4210_rdy_xpl_dr1.dgn
\$\$\$\$\$USERNAME\$\$\$\$\$