

09/08/99
09/08/99

See Sheet 1-A For Index of Sheets

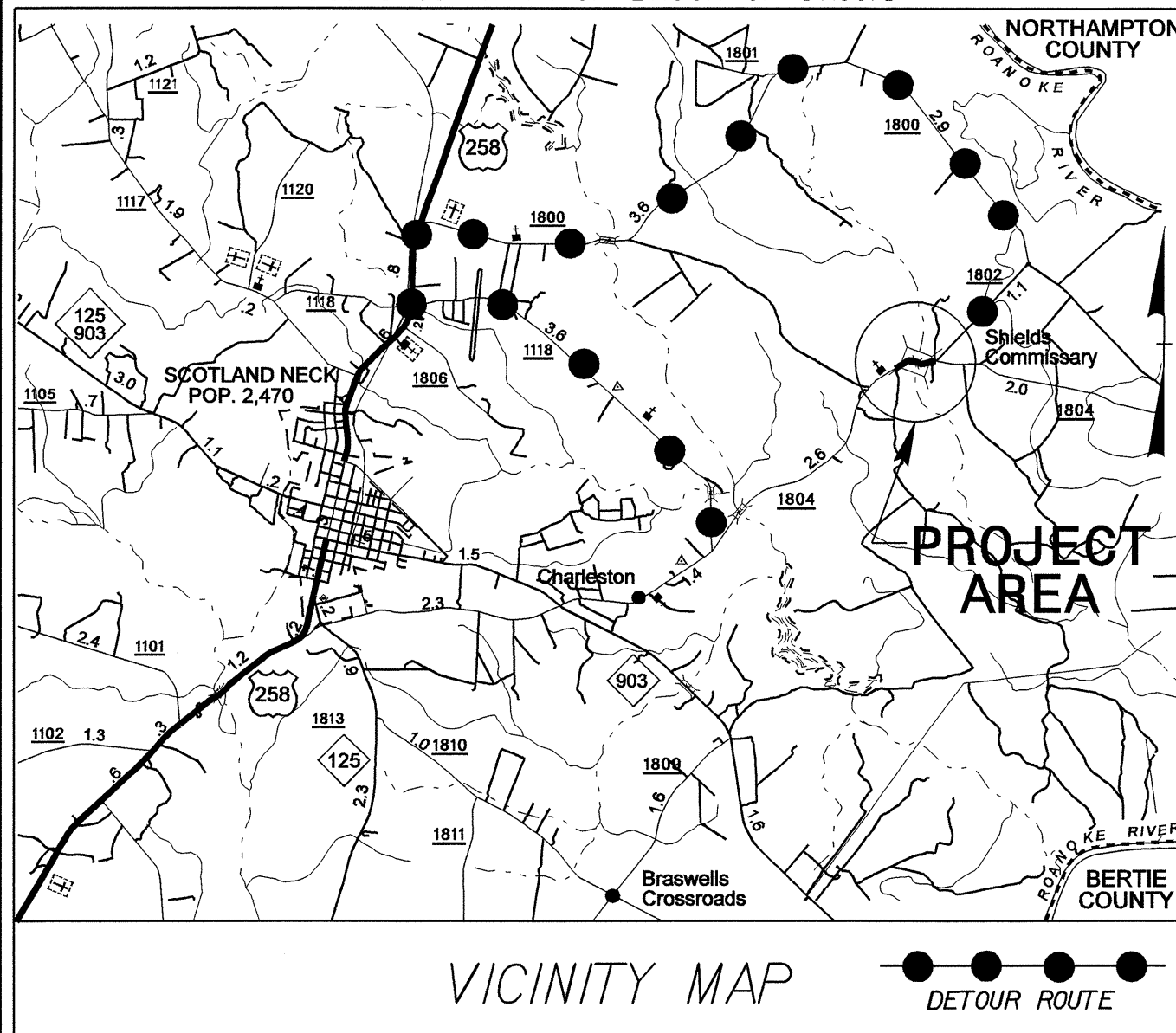

STATE OF NORTH CAROLINA
DIVISION OF HIGHWAYS

**UTILITIES BY OTHERS PLANS
HALIFAX COUNTY**

**LOCATION: BRIDGE NO. 72 OVER CYPRESS SWAMP
ON SR 1804**

TYPE OF WORK: UTILITIES

T.I.P. NO.	SHEET NO.
STATE PROJ. NO. B-4135	UO-1

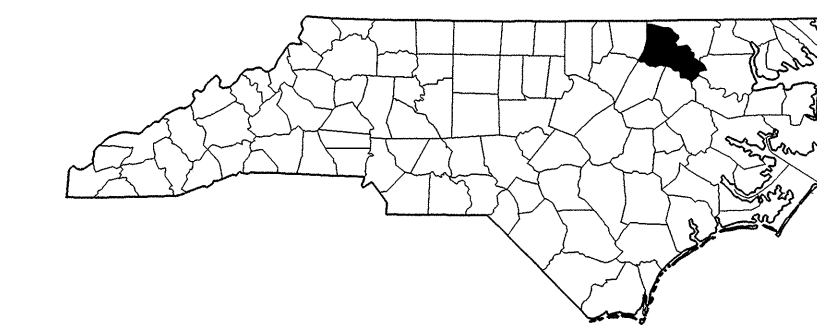

TIP B-4135

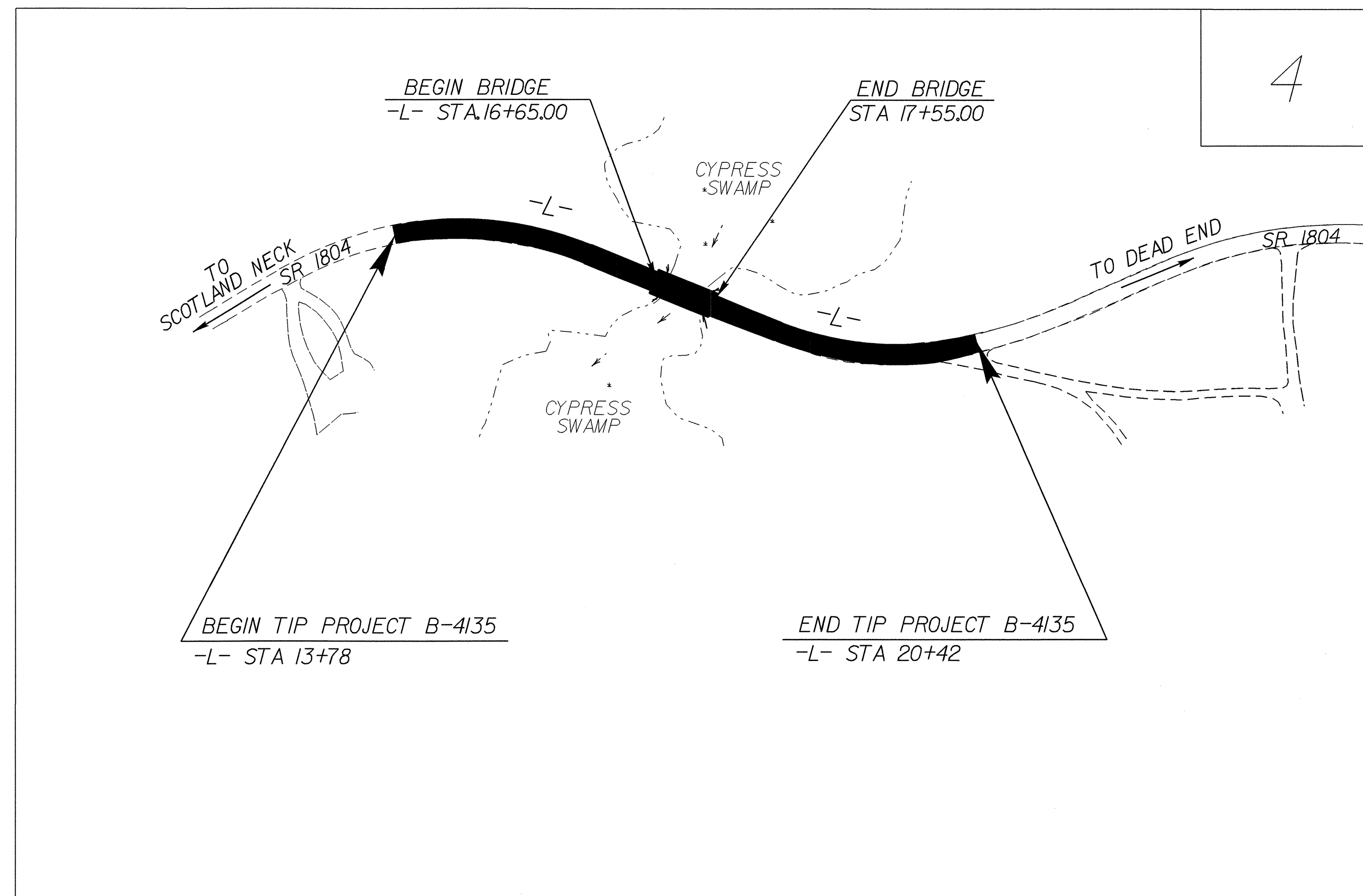

INDEX OF SHEETS	
SHEET NO.	DESCRIPTION
UO-1	TITLE SHEET
UO-2	UTILITIES BY OTHERS PLAN SHEETS

UTILITY OWNERS ON PROJECT
(1) EMBARQ

PREPARED IN THE OFFICE OF:
**DIVISION OF HIGHWAYS
DESIGN SERVICES
UTILITY SECTION**

1591 MAIL SERVICES CENTER
RALEIGH, NC 27699-1591
PHONE (919) 250-4128
FAX (919) 250-4119

Roger Worthington, P.E. UTILITIES SECTION ENGINEER

Steve McKee, P.E. UTILITIES SQUAD LEADER PROJECT ENGINEER

Alonza Yancey UTILITIES PROJECT DESIGNER

06-FEB-2008 15:02
r:\utilities\ydy_ut\proj\b-4135_ut_title_uo1_psh.dgn
\$\$\$\$\$USERNAME\$\$\$\$\$

UTILITIES BY OTHERS

NOTE:
 ALL PROPOSED UTILITY WORK
 SHOWN ON THIS SHEET WILL
 BE DONE BY OTHERS

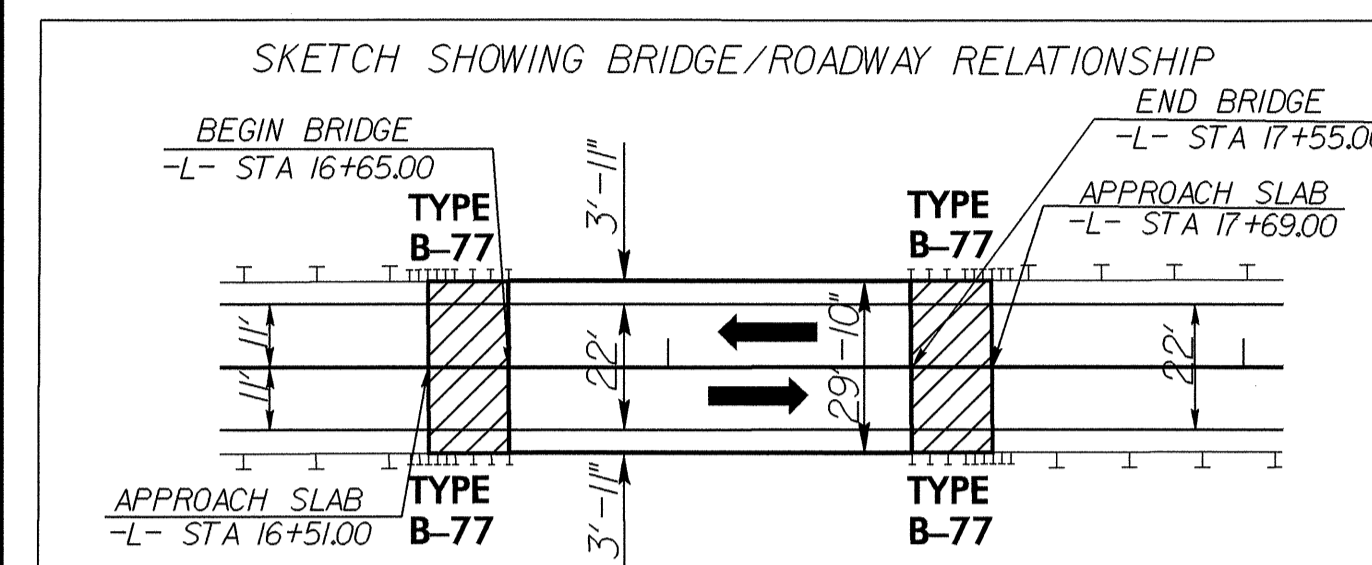

-L-	
PI Sta 14+30.00	PI Sta 19+63.62
$\Delta = 53^\circ 37' 15.9''$ (RT)	$\Delta = 44^\circ 46' 43.3''$ (LT)
$D = 15^\circ 04' 40.2''$	$D = 16^\circ 22' 12.8''$
$L = 355.63'$	$L = 273.54'$
$T = 192.04'$	$T = 144.18'$
$R = 380.00'$ **	$R = 350.00'$ **
$SE = 0.06$	$SE = 0.06$
$V = 35$ MPH	$V = 30$ MPH

JAMES G. SHIELDS, JR.
 DB & PG UNKNOWN

JAMES G. SHIELDS, JR.
 DB & PG UNKNOWN

BEGIN PROJECT B-4135
 -L- POC STA 13+78.00

** DESIGN EXCEPTION REQUIRED FOR MINIMUM HORIZONTAL CURVE
 RADIUS AND HORIZONTAL STOPPING SIGHT DISTANCE.

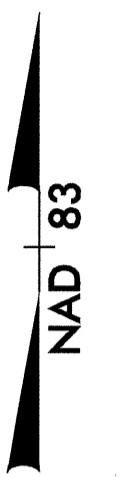
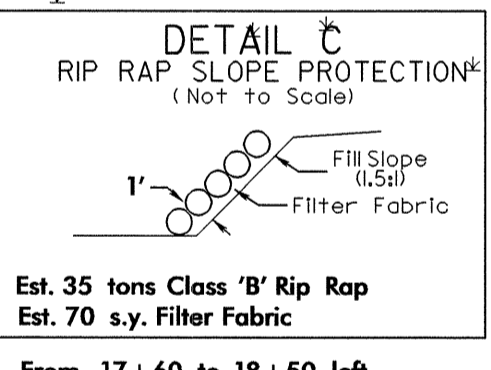
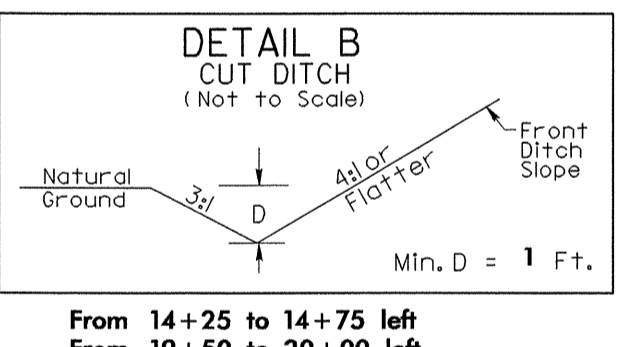
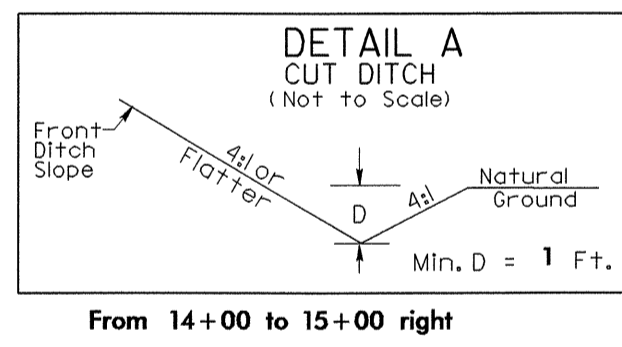
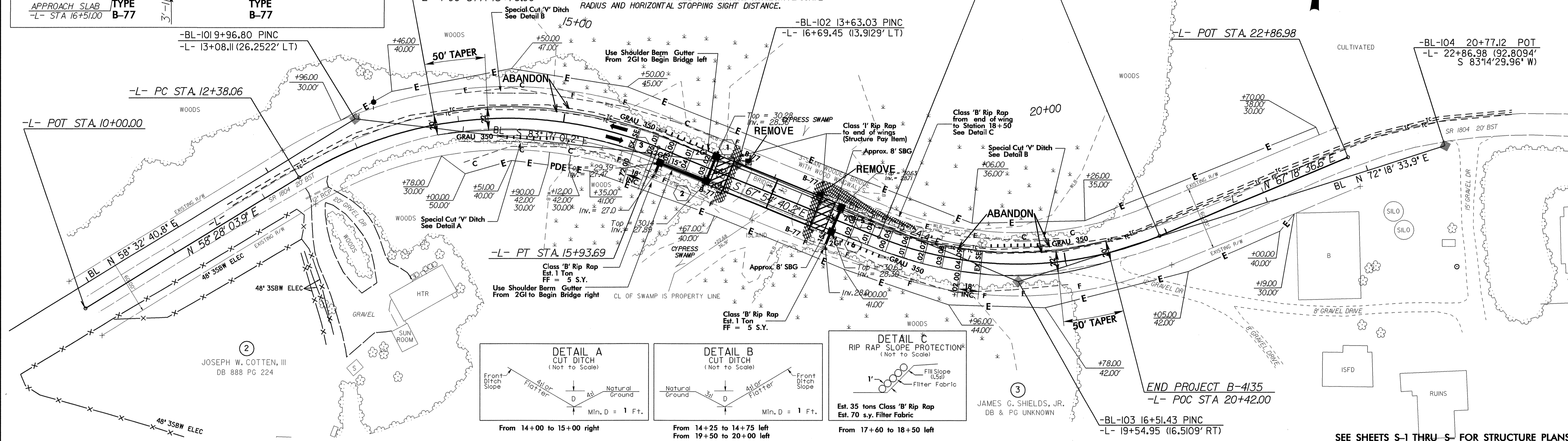

SEE SHEETS S-1 THRU S- FOR STRUCTURE PLANS

06-FEB-2008 10:26
 3d-ut-06-141-001-01-sh4-uo(1 by others shtuo-2)_psh.dgn
 5/14/99