

T.I.P. NO.	SHEET NO.
B-4103	UC-1

STATE OF NORTH CAROLINA
DIVISION OF HIGHWAYS

UTILITY CONSTRUCTION PLANS DAVIDSON COUNTY

**LOCATION: BRIDGE NO. 416 OVER BEAVER DAM CREEK
ON SR 2550 (BADIN LAKE ROAD)**

TYPE OF WORK: UTILITY CONSTRUCTION

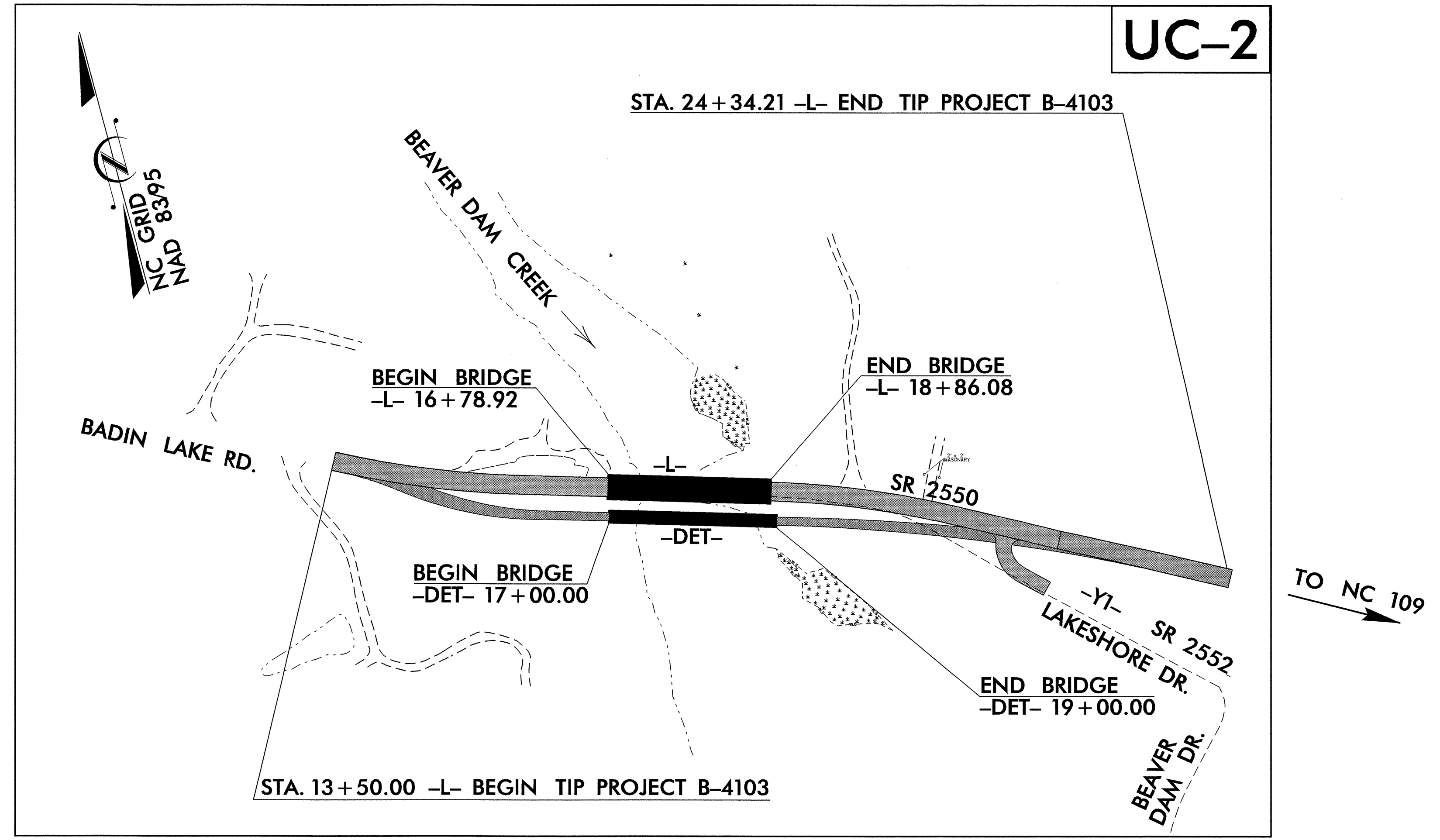
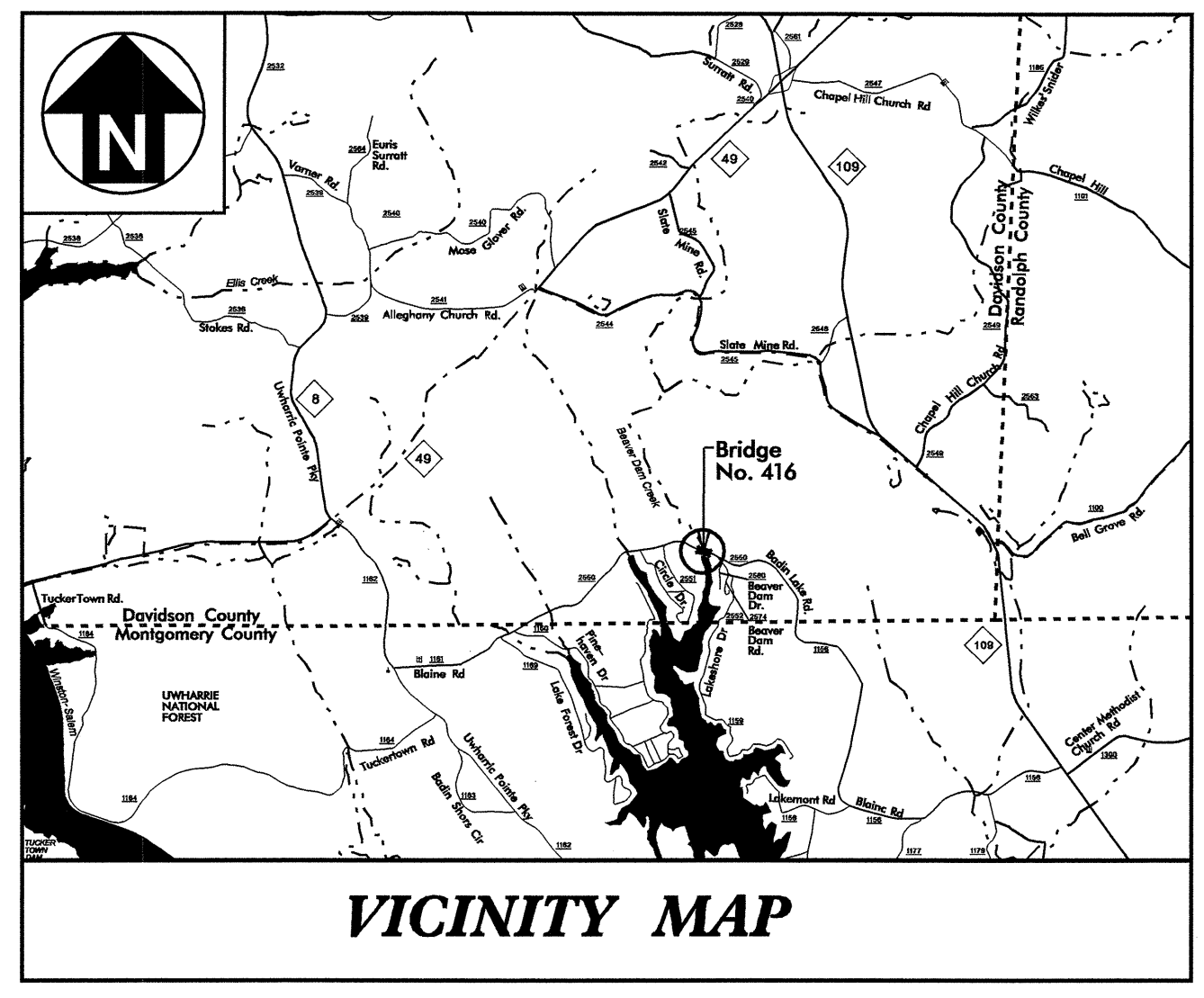

TIP PROJECT: B-4103

CONTRACT: C201713

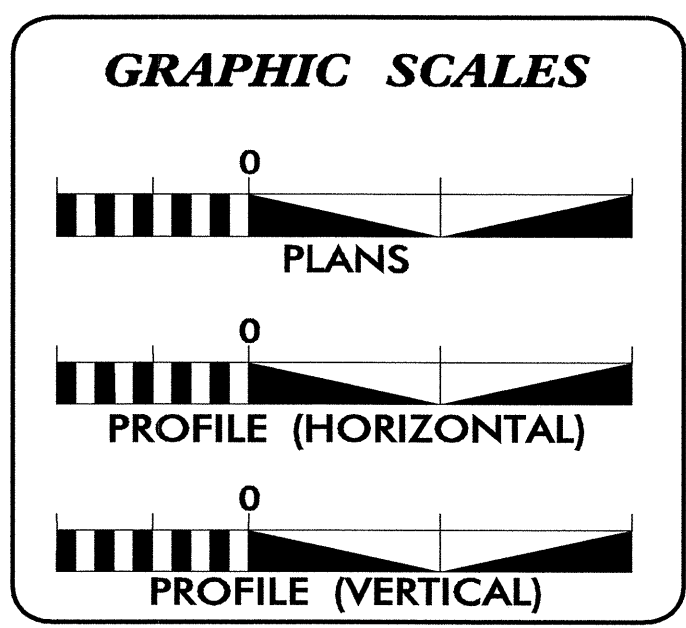

INDEX OF SHEETS	
SHEET NO.	DESCRIPTION
UC-1	TITLE SHEET
UC-2	UTILITY CONSTRUCTION PLAN SHEET

WATER AND SEWER OWNERS ON PROJECT
(1) WATER - HANDY SANITARY DISTRICT

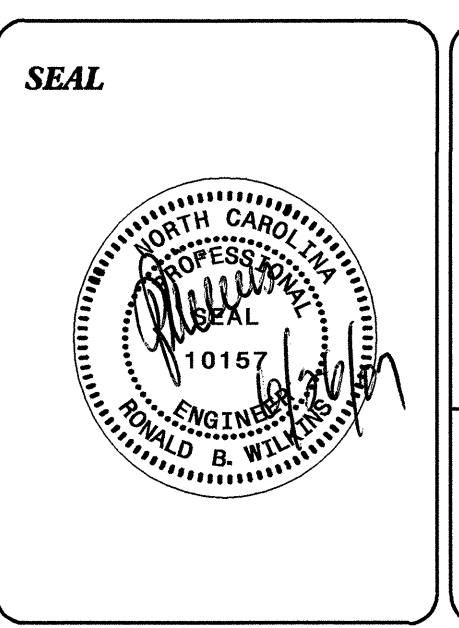



 PREPARED IN THE OFFICE OF:
DIVISION OF HIGHWAYS
PROJECT SERVICES
UTILITY SECTION
 1591 MAIL SERVICES CENTER
 RALEIGH, NC 27699-1591
 PHONE (919) 250-4128
 FAX (919) 250-4119

Roger Worthington, P.E. UTILITIES SECTION ENGINEER
R. B. WILKINS, P.E. UTILITIES SQUAD LEADER PROJECT ENGINEER
MICHAEL R. BRIGHT UTILITIES PROJECT DESIGNER

21-JUN-2007 11:44
 r:\utilities\pds\proj\b4103\ut_title_ucl.psh.dgn
 \$\$\$USERNAME\$\$\$

09/08/99

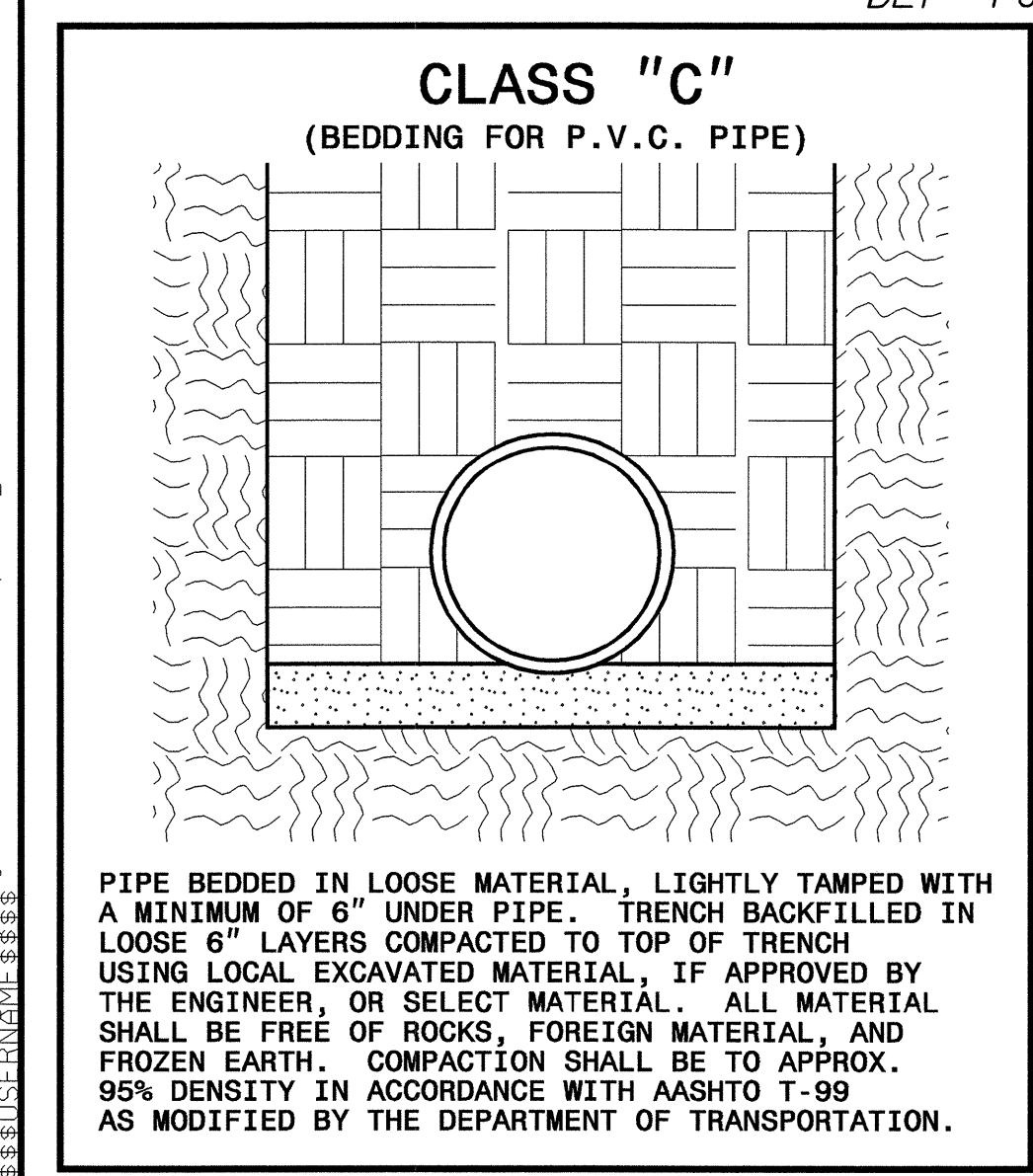
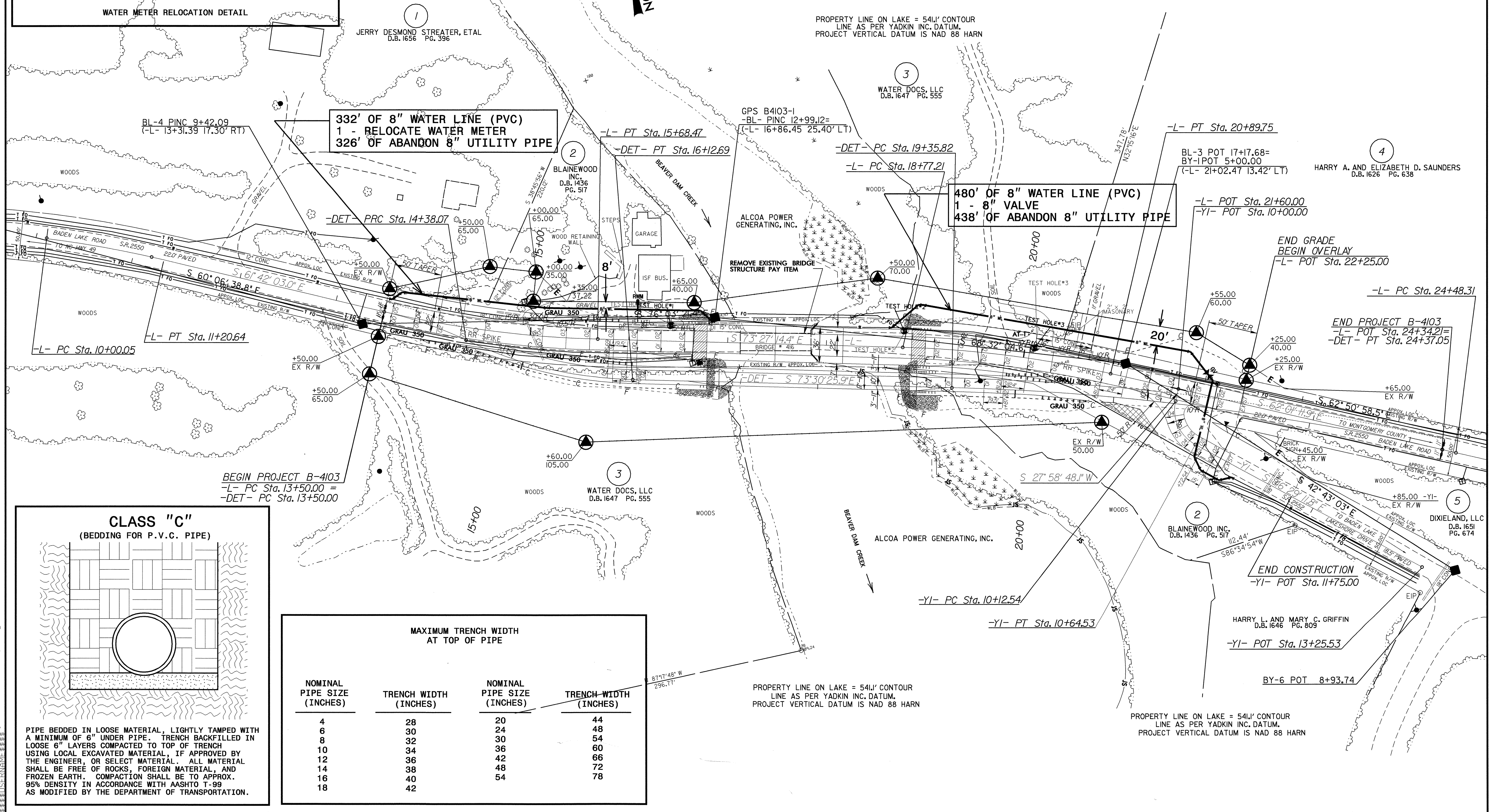
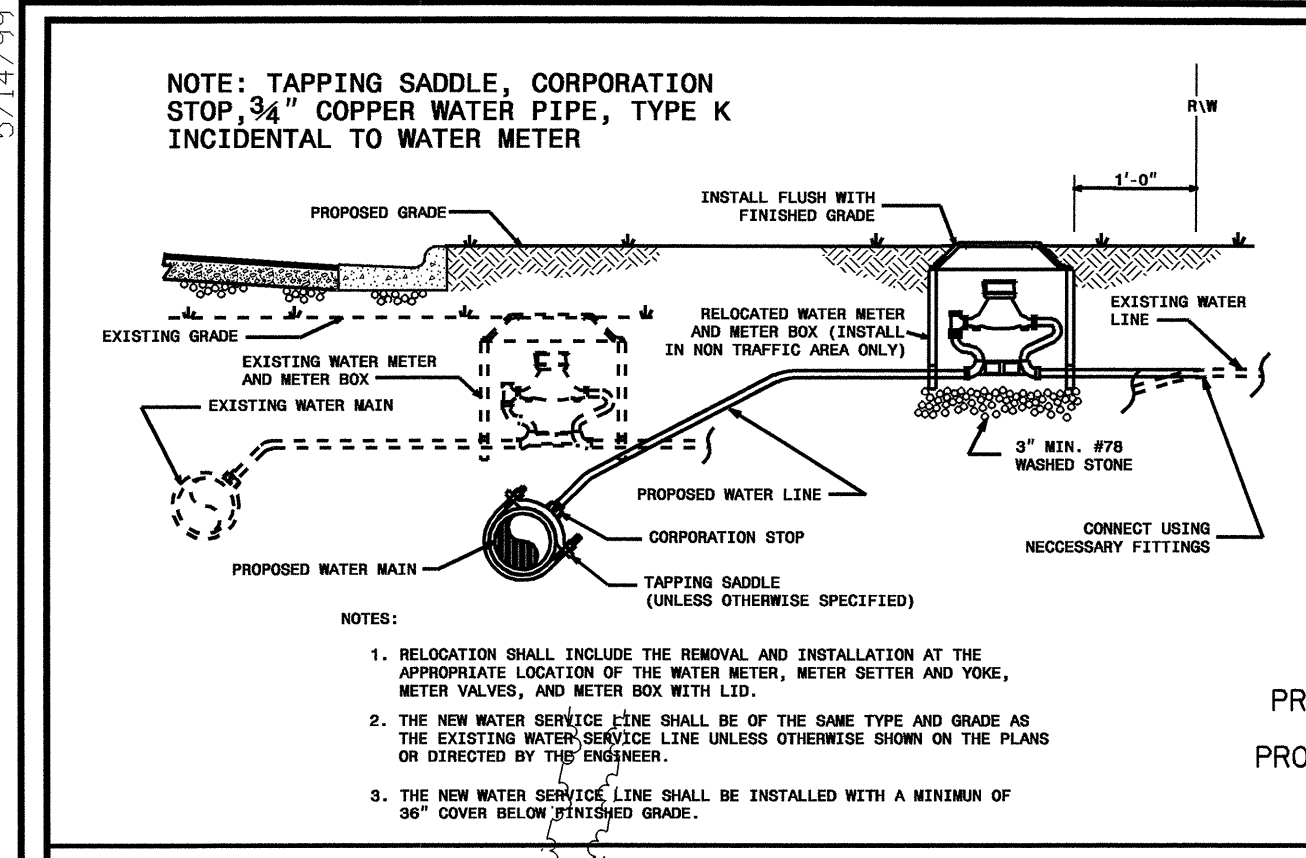
UTILITY CONSTRUCTION



MAXIMUM TRENCH WIDTH AT TOP OF PIPE

NOMINAL PIPE SIZE (INCHES)	TRENCH WIDTH (INCHES)	NOMINAL PIPE SIZE (INCHES)	TRENCH WIDTH (INCHES)
4	28	20	44
6	30	24	48
8	32	30	54
10	34	36	60
12	36	42	66
14	38	48	72
16	40	54	78
18	42		

5/14/99

21-JUN-2007 11:44
r:\1141131103-ENGINEERING\B-4103-ut-4_uc2.psh.dgn

STATE OF NORTH CAROLINA
DIVISION OF HIGHWAYS

UTILITY CONSTRUCTION PLANS DAVIDSON COUNTY

**LOCATION: BRIDGE NO. 416 OVER BEAVER DAM CREEK
ON SR 2550 (BADIN LAKE ROAD)**

TYPE OF WORK: UTILITIES BY OTHERS

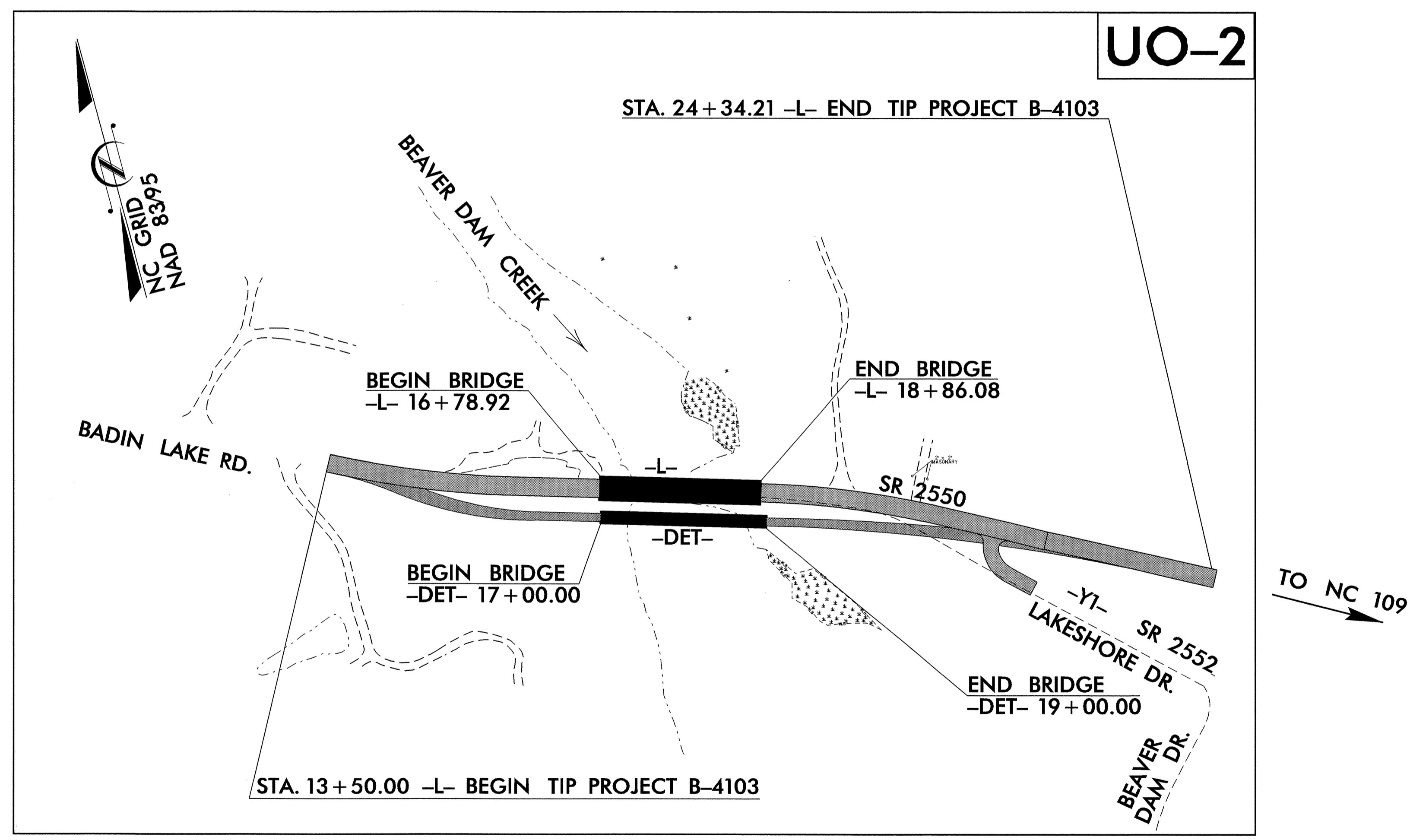
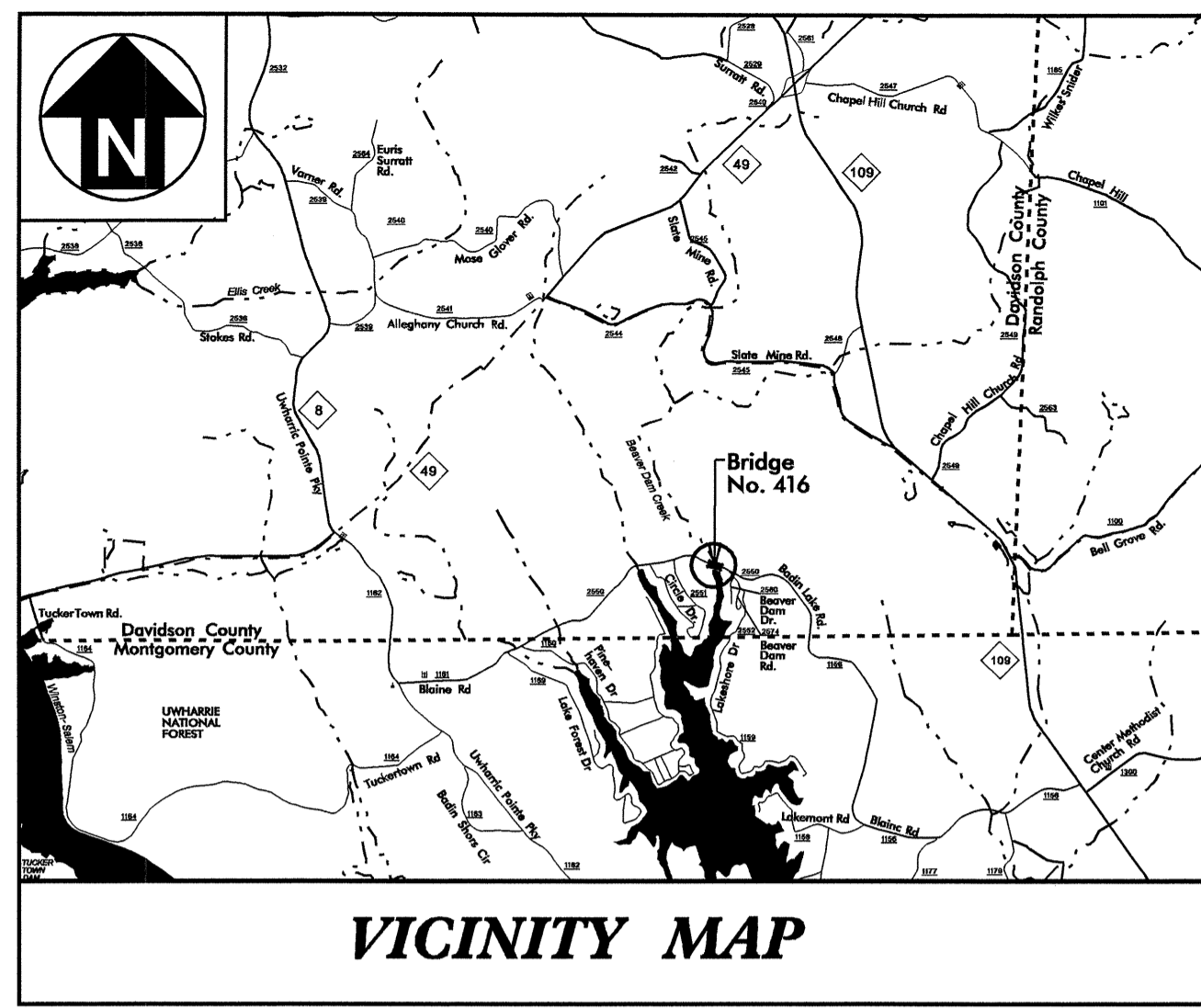

TIP PROJECT: B-4103

CONTRACT: C201713

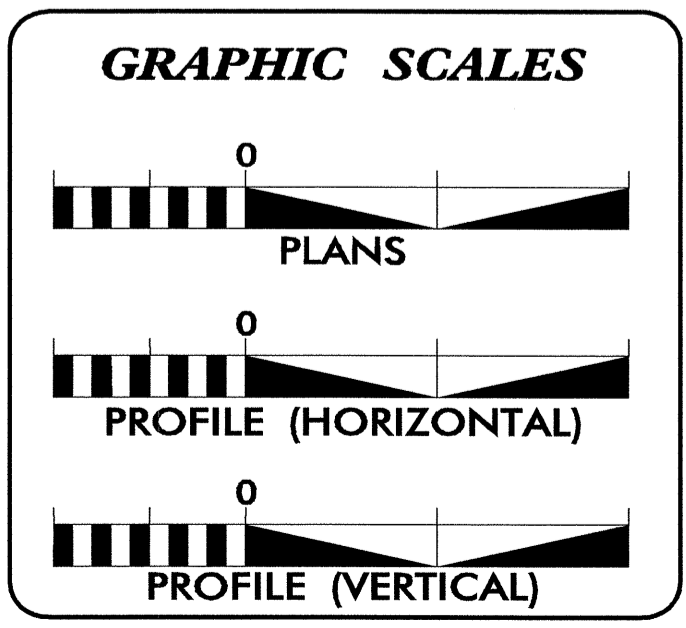

SHEET NO.	DESCRIPTION
UO-1	TITLE SHEET
UO-2	UTILITIES BY OTHERS PLAN SHEET

- UTILITY OWNERS ON PROJECT**
- (1) ENERGY UNITED (POWER DISTRIBUTION)
 - (2) RANDOLPH TMC (TELEPHONE)
 - (3) RANDOLPH TMC (CATV)

PREPARED IN THE OFFICE OF:
**DIVISION OF HIGHWAYS
PROJECT SERVICES
UTILITY SECTION**

1591 MAIL SERVICES CENTER
RALEIGH NC 27699-1591
PHONE (919) 250-4128
FAX (919) 250-4119

Roger Worthington, P.E. UTILITIES SECTION ENGINEER
R. B. WILKINS, P.E. UTILITIES SQUAD LEADER PROJECT ENGINEER
MICHAEL R. BRIGHT UTILITIES PROJECT DESIGNER

