

R:\Roadway\Xsc\B3814_RDY_EW_L.log

PROJ. REFERENCE NO.	SHEET NO.
B-3814	X-0

**STATE OF NORTH CAROLINA
DIVISION OF HIGHWAYS**

CROSS-SECTION SUMMARY

Station	Uncl. Exc.	Embt	DDE		Station	Uncl. Exc.	Embt	DDE												
L	(cu. yd.)	(cu. yd.)	(cu. yd.)		D1	(cu. yd.)	(cu. yd.)	(cu. yd.)												
10+50.00	0	0	0		10+40.00	0	0	0												
11+00.00	109	128	0		10+60.00	64	0	0												
11+50.00	69	211	0		10+80.00	152	0	0												
12+00.00	32	376	0		11+00.00	198	0	0												
12+50.00	24	555	11		11+20.00	204	0	0												
13+00.00	100	435	29		11+40.00	215	0	0												
13+50.00	231	219	47		11+60.00	197	0	0												
14+00.00	241	249	44		11+80.00	177	0	0												
14+50.00	155	408	43		12+00.00	157	0	0												
15+00.00	73	585	27		12+20.00	132	0	0												
15+50.00	73	743	0		12+40.00	117	0	0												
16+00.00	146	747	0		12+60.00	105	0	0												
16+50.00	0	0	0		12+80.00	67	0	0												
17+00.00	0	0	0																	
17+50.00	0	1024	0																	
18+00.00	0	959	0																	
18+50.00	0	660	0																	
19+00.00	0	328	0																	
19+50.00	128	119	0																	
20+00.00	290	44	0																	
20+50.00	349	22	0																	
21+00.00	360	14	0																	
21+50.00	381	8	0																	
22+00.00	403	11	0																	
22+50.00	381	26	0																	
23+00.00	358	37	0																	
23+50.00	304	32	0																	
24+00.00	215	20	0																	
24+50.00	86	7	0																	

Approximate quantities only. Unclassified excavation, borrow excavation, fine grading, clearing and grubbing, and removal of existing pavement will be paid for at the lump sum price for "Grading".

8/23/99

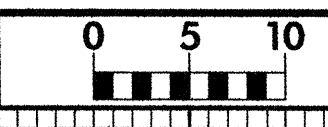

PROJ. REFERENCE NO. B-3814	SHEET NO. X-1
-------------------------------	------------------

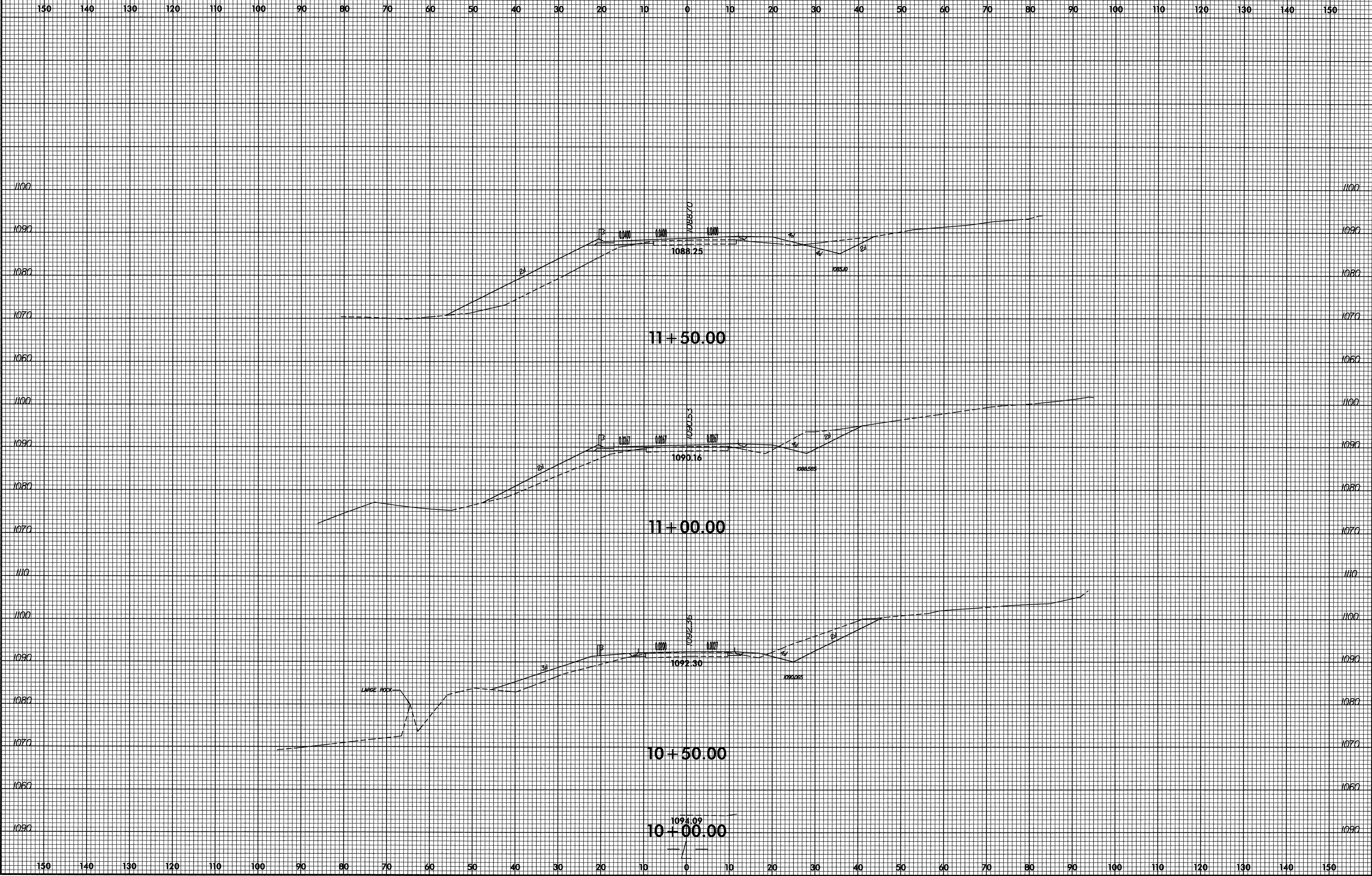

20-SEP-2007 09:41
 G:\Projects\NCDDOT\B3814\Roadway\Xsec\B3814_Rdy_xpl.dgn
 \$\$\$USFRMAME\$\$\$

8/23/99

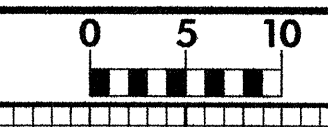

PROJ. REFERENCE NO.	SHEET NO.
B-3814	X-2

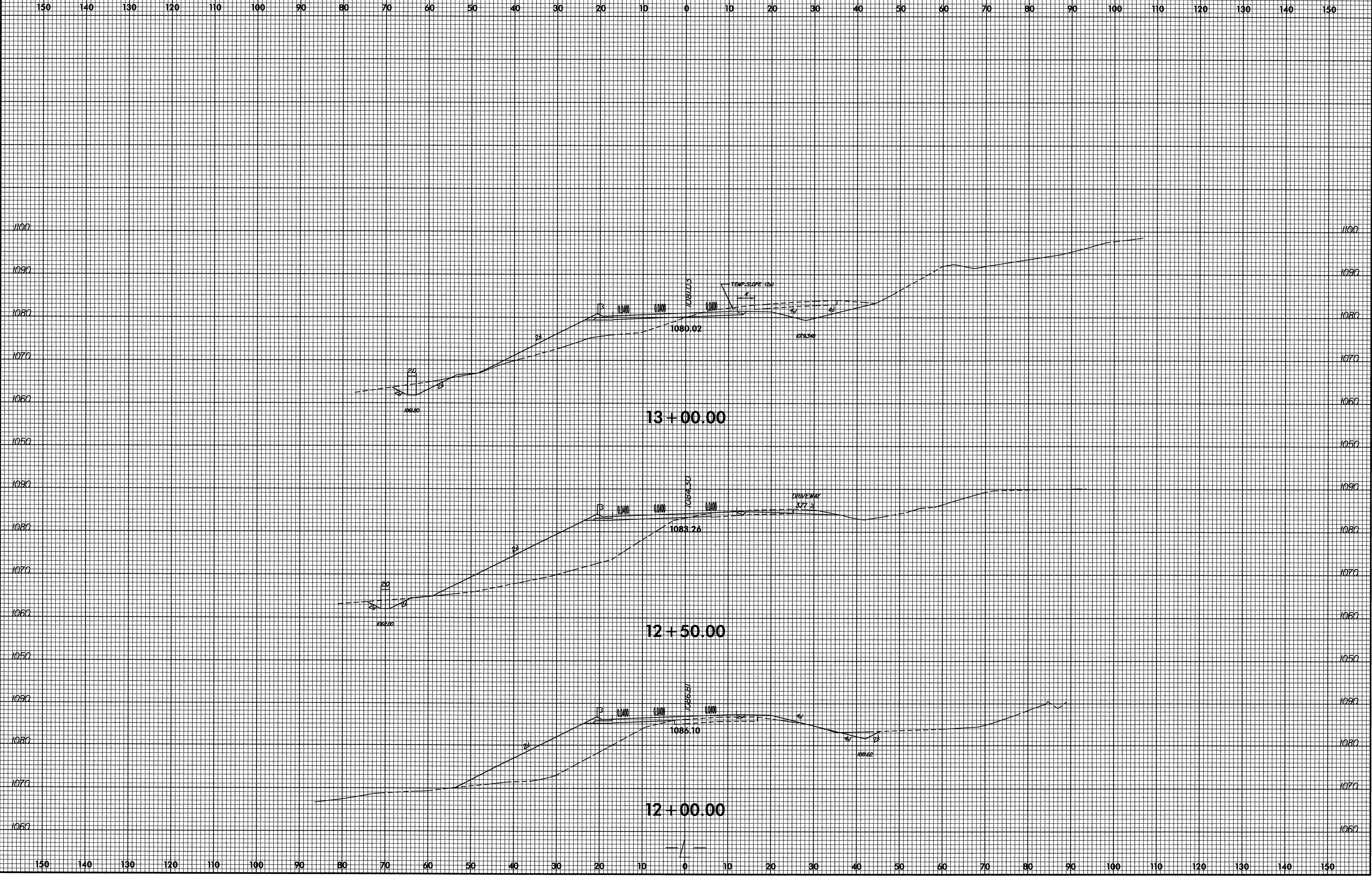

20-SEP-2007 09:11
 GA:\PROJECTS\2007\B3814_Roadway\Xsc\B3814_Rd1_xpl.dgn
 \$\$\$USERNAME\$\$\$

8/23/99

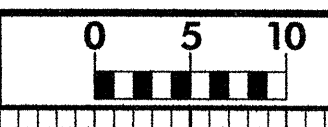

PROJ. REFERENCE NO. B-3814	SHEET NO. X-3
-------------------------------	------------------

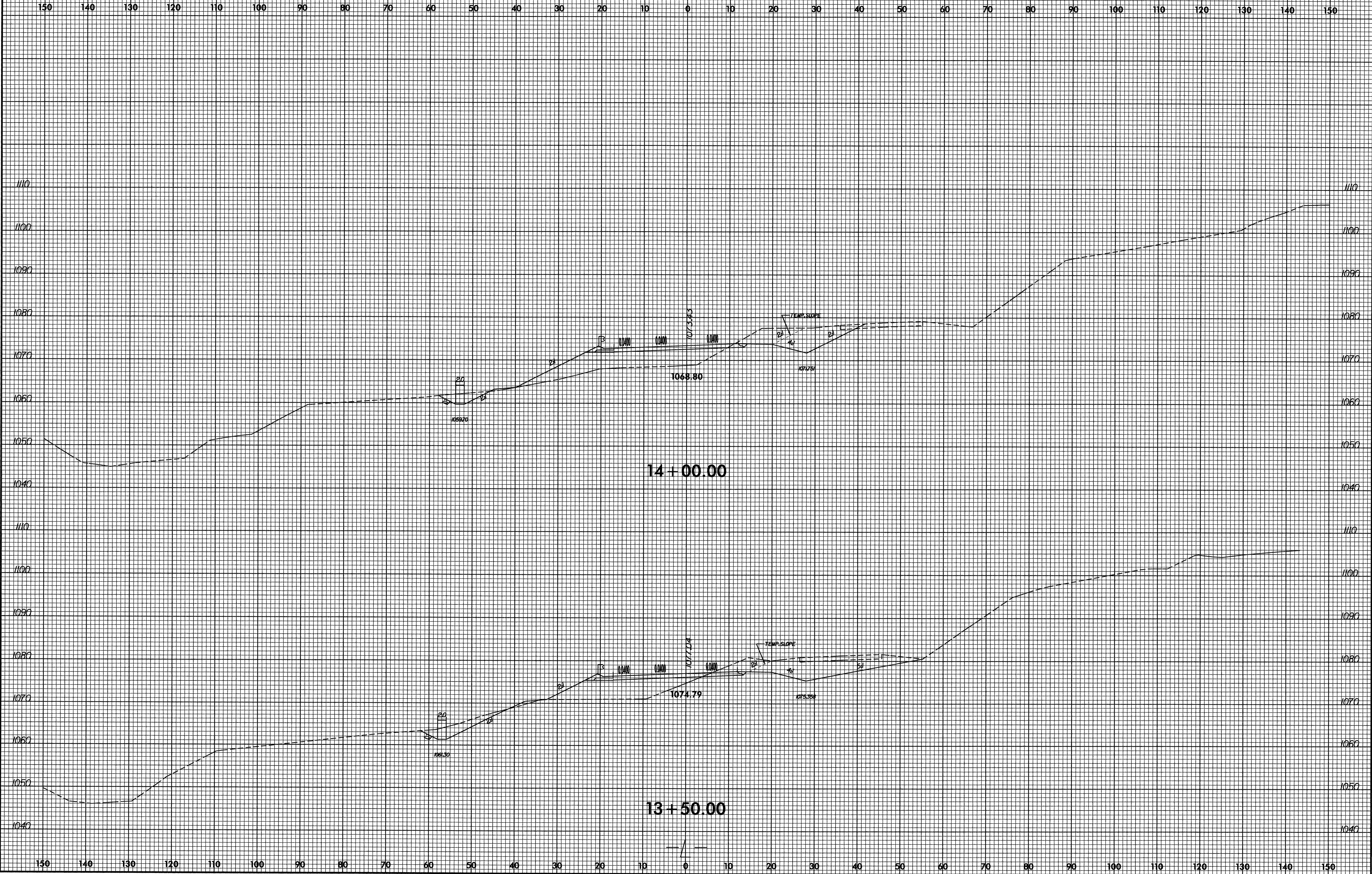

14 + 00.00

13 + 50.00

20-SEP-2007 09:11
 G:\Projects\NC\DOT\B3814\Roadway\Xsc\B3814_Rdy_xpl.dgn
 \$\$\$USERNAME\$\$\$

20-SEP-2007 09:11
G:\PROJECTS\NC\DOT\B3814\Roadway\Xsc\B3814_RdJ_xpl.dgn
\$\$\$\$\$USERNAME\$\$\$\$

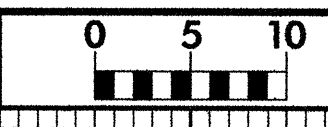

PROJ. REFERENCE NO.	SHEET NO.
B-3814	X-4

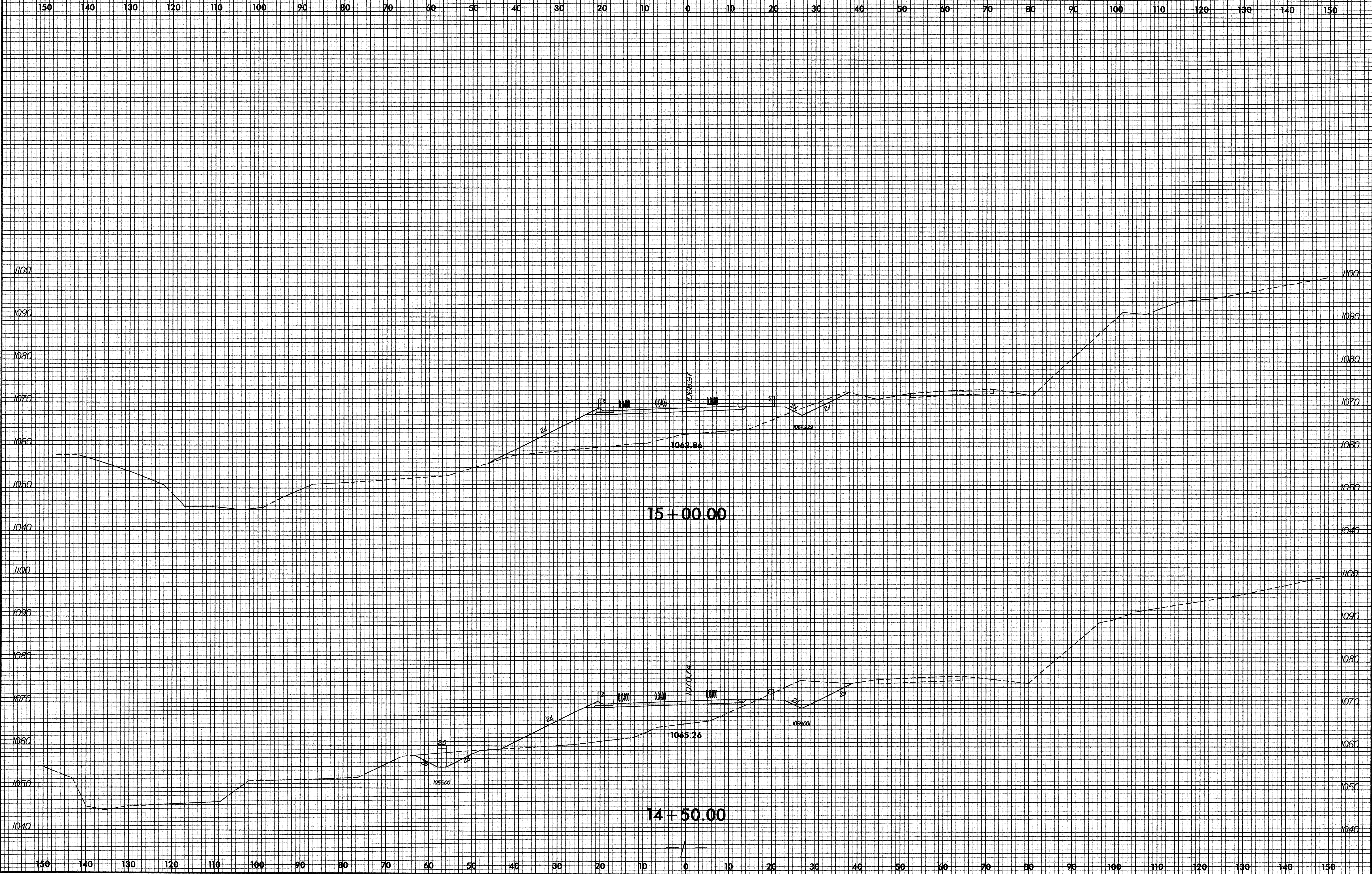

8/23/99

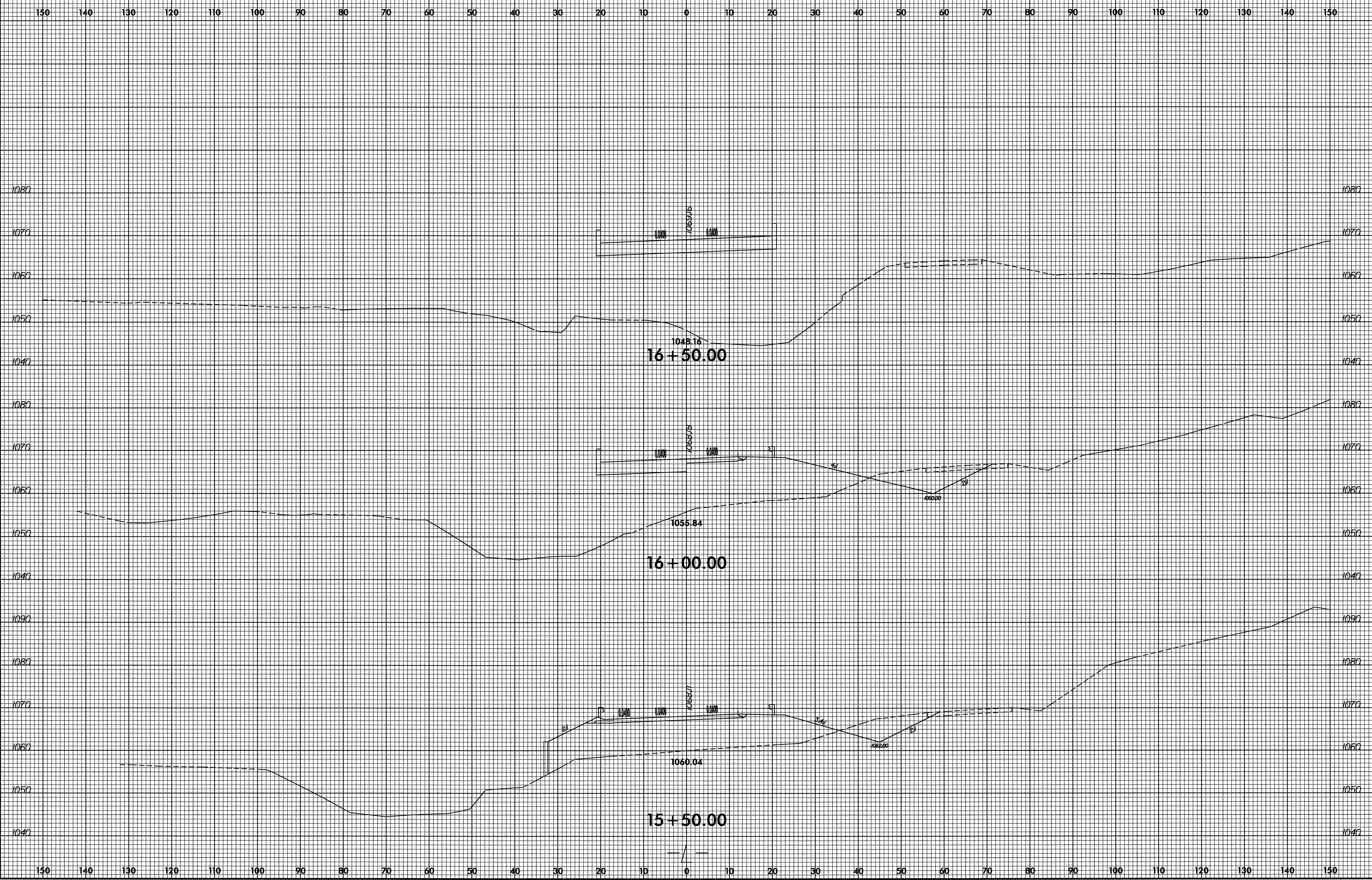

22-FEB-2008 09:02
R:\060549\XSS\3814_RdL_xp1.dgn
\$\$\$USERNAME\$\$\$

8/23/99

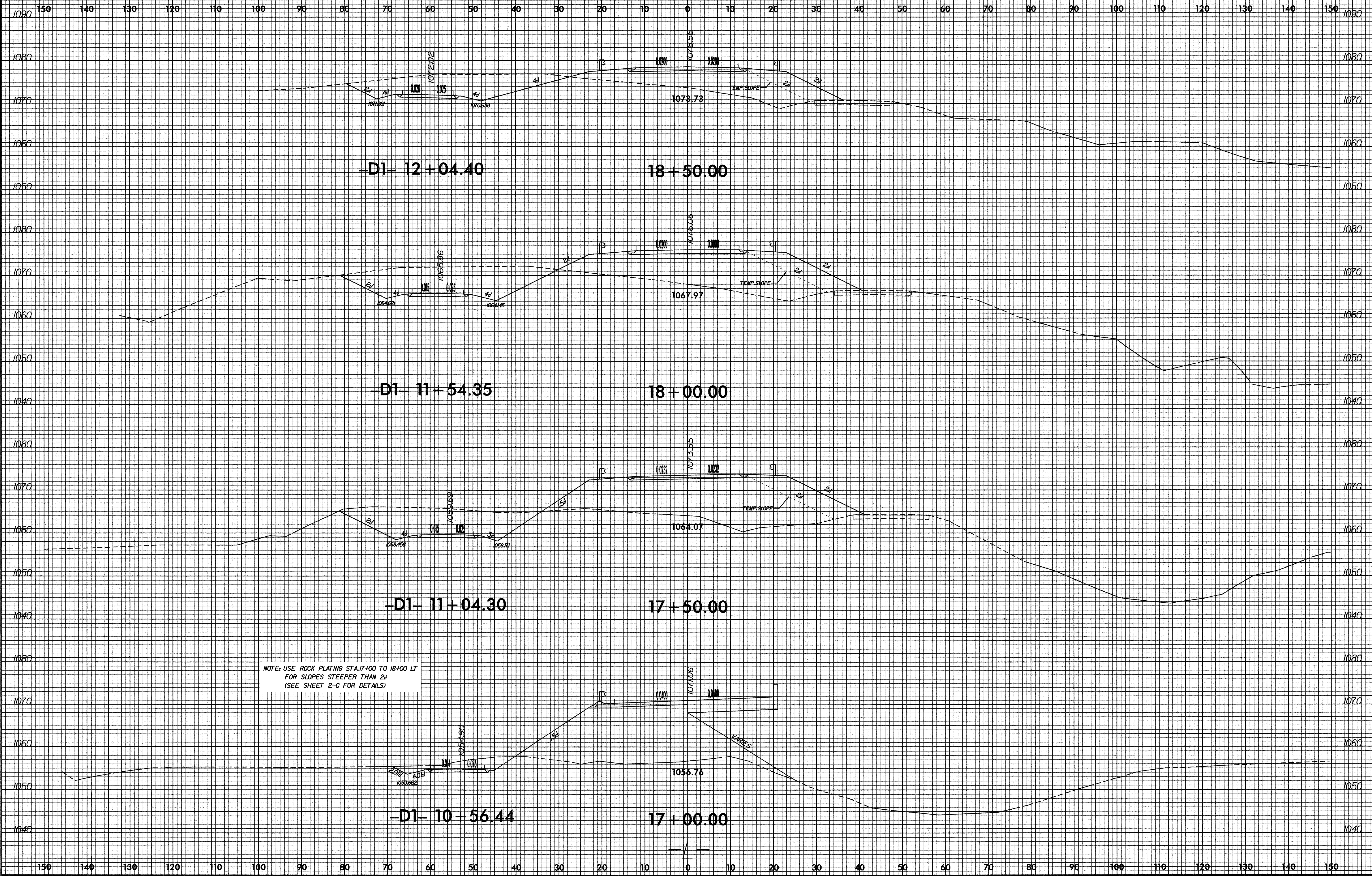

NOTE: USE ROCK PLATING STA. 17+00 TO 18+00 LT
FOR SLOPES STEEPER THAN 2:1
(SEE SHEET 2-C FOR DETAILS)

22-FEB-2008 09:02
R:\Roadway\sc\B3814_Rd\xp1.dgn
\$\$\$\$\$US\$R\$M\$E\$\$\$\$\$

8/23/99

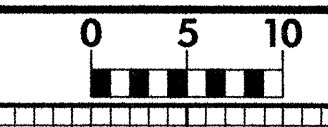

PROJ. REFERENCE NO. B-3814	SHEET NO. X-7
-------------------------------	------------------

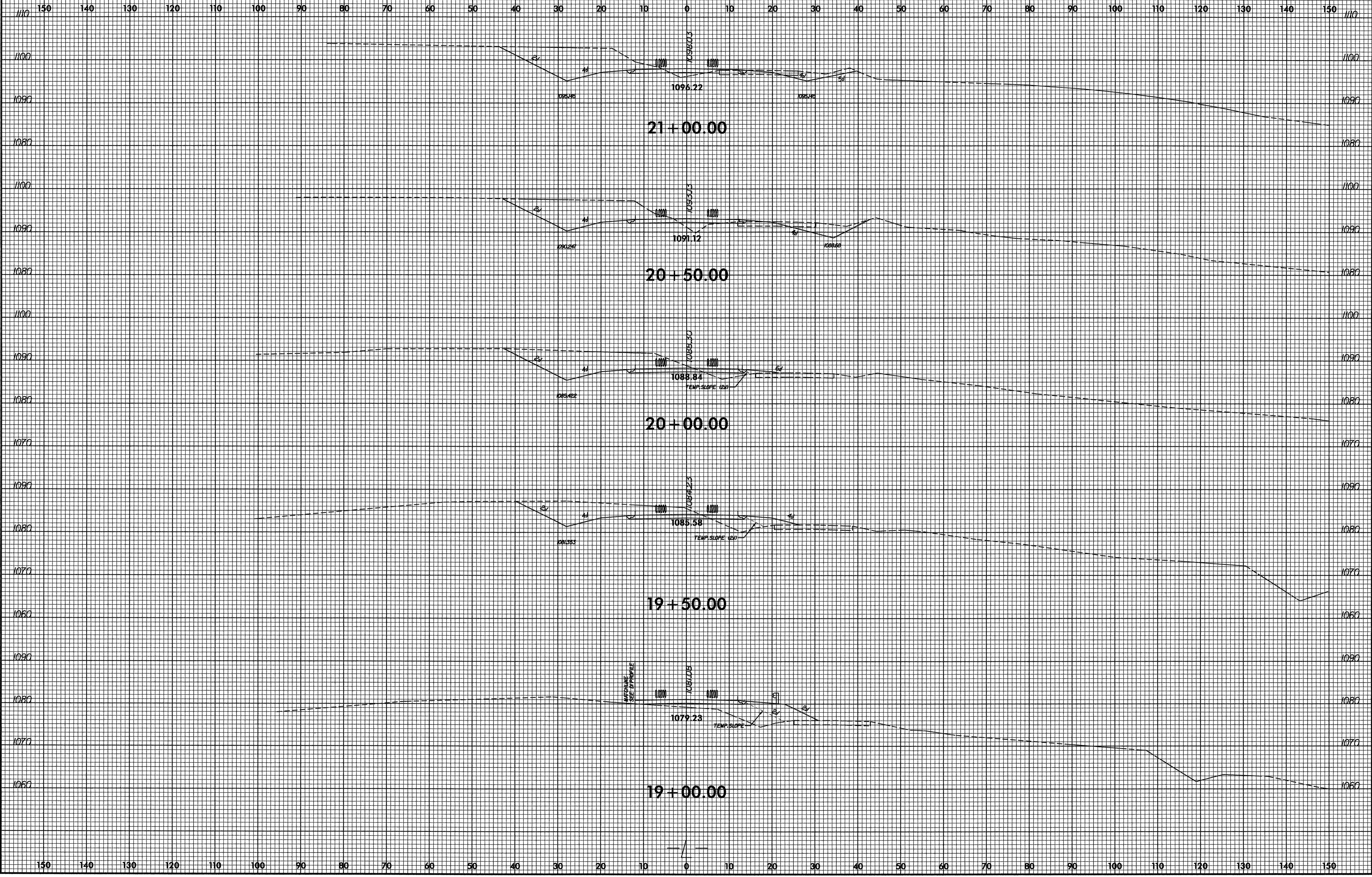

20-SEP-2007 09:42
 G:\Projects\N0001\B3814_Roadway\Xsc\B3814_Rdy_xpl.dgn
 \$\$\$USERNAM\$\$\$\$

150 140 130 120 110 100 90 80 70 60 50 40 30 20 10 0 10 20 30 40 50 60 70 80 90 100 110 120 130 140 150

8/23/99

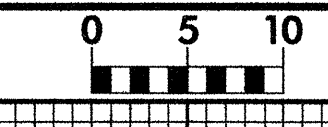

PROJ. REFERENCE NO.	SHEET NO.
B-3814	X-8

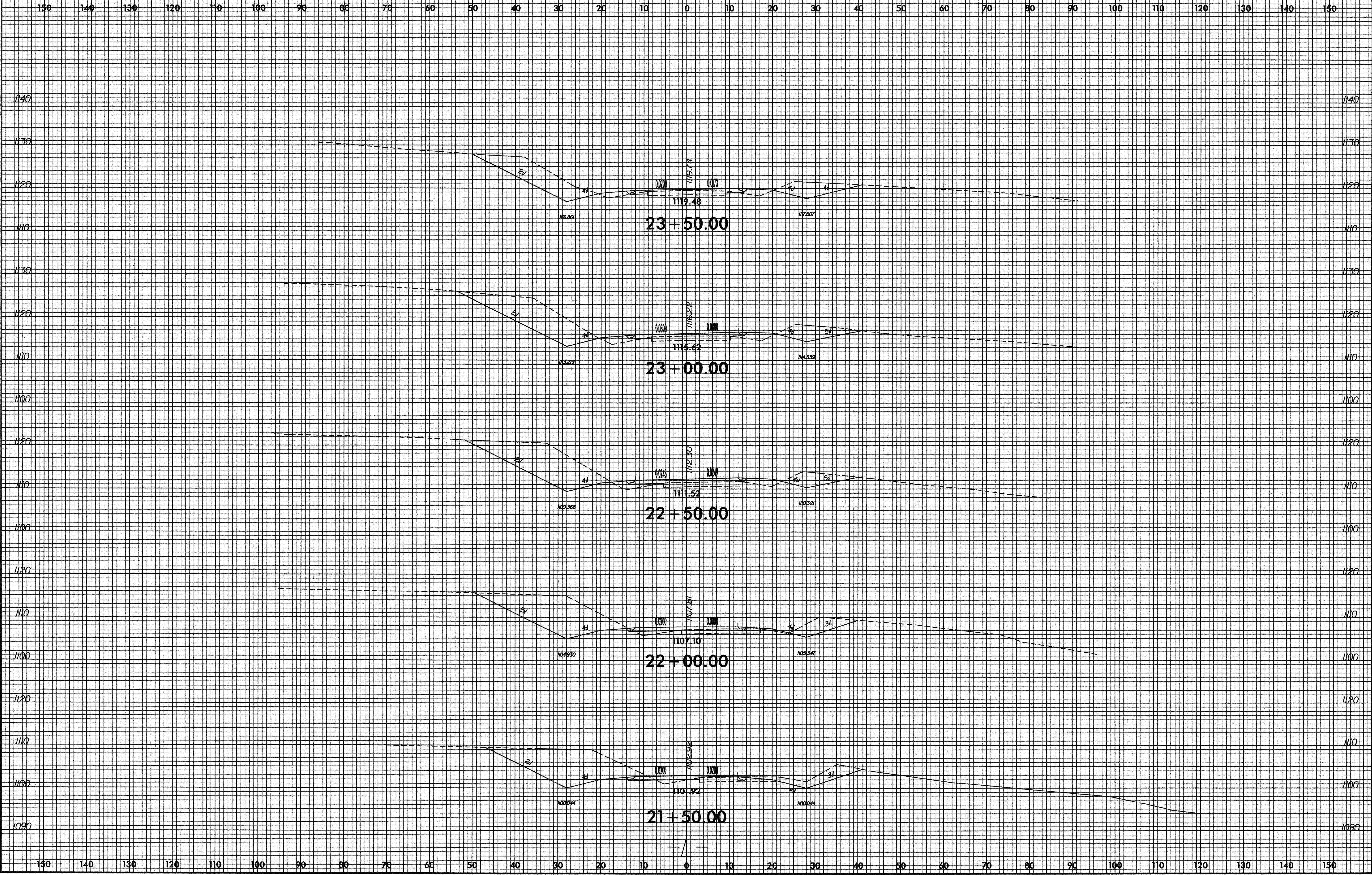

20-SEP-2007 09:42
 G:\Tran\N\001\B3814\Roadway\Xsc\B3814_Rdy-yp1.dgn
 \$\$\$USERNAME\$\$\$

8/22/99

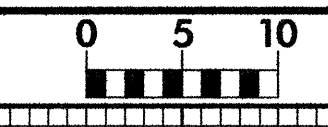

PROJ. REFERENCE NO.
B-3814

SHEET NO.
X-9

150 140 130 120 110 100 90 80 70 60 50 40 30 20 10 0 10 20 30 40 50 60 70 80 90 100 110 120 130 140 150

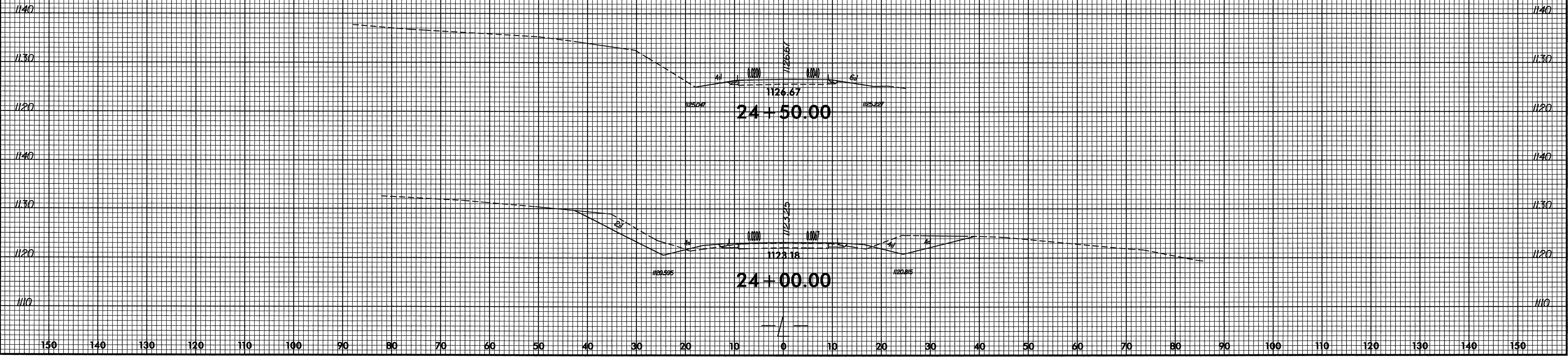

20-SEP-2007 09:42
G:\PROJECTS\2007\24\Roadway\Xsec\B3814_RdJ_xpl.dgn
\$\$\$\$USERNAME\$\$\$\$

150 140 130 120 110 100 90 80 70 60 50 40 30 20 10 0 10 20 30 40 50 60 70 80 90 100 110 120 130 140 150