

T.I.P.: B-4226

CONTRACT: C201808

**STATE OF NORTH CAROLINA
DEPARTMENT OF TRANSPORTATION**

**SIGNING PLANS
PERQUIMANS COUNTY**

LOCATION: BRIDGE NO. 62 OVER BEAR SWAMP CANAL ON SR 1110

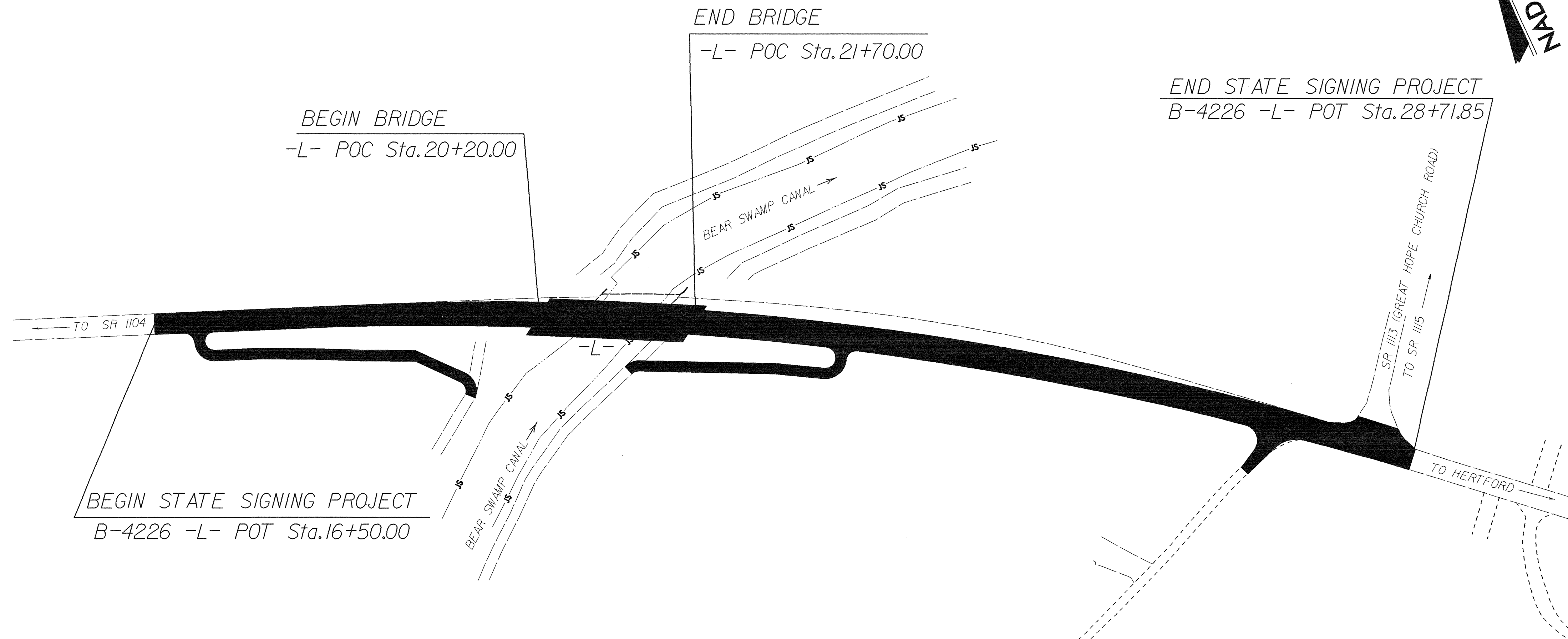

| | |
|---------------------------------|---------------------|
| TIP NO. B-4226 | SHEET NO. SIGN-1 |
| APPROVED: <i>Ayman Alqudwah</i> | |
| DATE: 12/10/07 | |
| SEAL | |
| | |

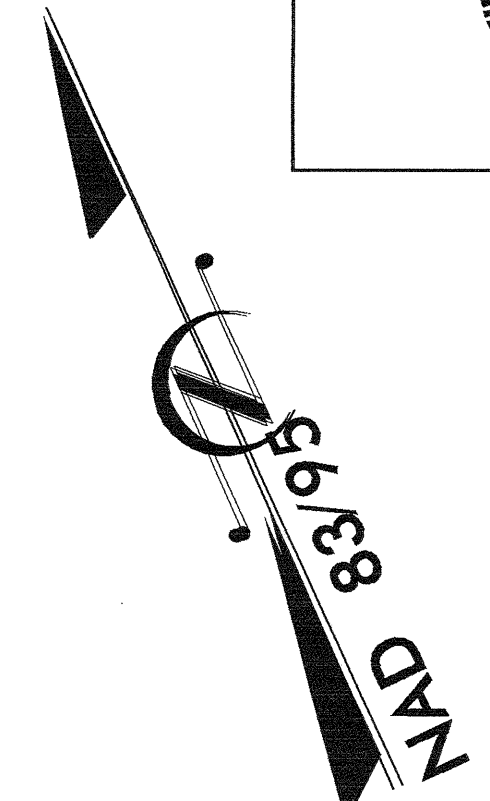

SUMMARY OF QUANTITIES



| ITEM NO. | | ITEM DESCRIPTION | QUANTITY | UNIT |
|------------|-----------|------------------------------------|----------|------|
| DESC. NO. | SECT. NO. | | | |
| 4025000000 | 901 | CONTRACTOR FURNISHED, TYPE E SIGN | 12.5 | S.F. |
| 4082000000 | 903 | SUPPORTS, WOOD | 27 | L.F. |
| 4102000000 | 904 | SIGN ERECTION, TYPE E | 2 | EA. |
| 4155000000 | 907 | DISPOSAL OF SIGN SYSTEM, U-CHANNEL | 4 | EA. |
| 4158000000 | 907 | DISPOSAL OF SIGN SYSTEM, WOOD | 2 | EA. |

INDEX

| SHEET NO. | DESCRIPTION |
|-----------|----------------------------------|
| 1 | TITLE SHEET |
| 2 | TYPE "E" SIGNS |
| 3 | EXISTING/PROPOSED ROADWAY |

| | |
|---|---------------------------------|
| PLAN PREPARED BY: N.C.D.O.T. SIGNING SECTION | |
| R. W. KING, PE | SIGNING ENGINEER |
| A. I. ALQUDWAH, PE | SIGNING PROJECT ENGINEER |
| D. M. EATON | SIGNING PROJECT DESIGN ENGINEER |
| R. R. HENNEIN | SIGNING DESIGNER |

**ROADWAY STANDARD DRAWINGS
APPLICABLE TO THESE SIGNING PLANS
903.20 904.10 904.50**

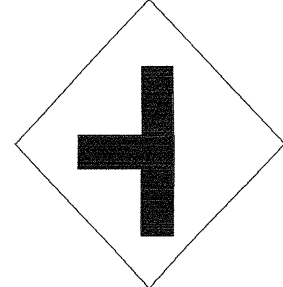
| | | | | | | |
|---|--|--|--|--|------------------------------|---|
| <p>408 QUANTITY REQ'D <u>1</u></p>  <p>30 X 30 R1-1</p> <p>ONE WOOD POST PER SIGN</p> | | | | | | <p>TIP NO. B-4226 SHEET NO. SIGN-2</p> <p>APPROVED: <i>Ayman Al-Qudus</i></p> <p>DATE: 12/10/07</p> <p>SEAL</p>  |
| <p>449 QUANTITY REQ'D <u>1</u></p>  <p>30 X 30 W2-2L</p> <p>ONE WOOD POST PER SIGN</p> | | | | | | |
| | | | | | | |
| | | | | | | |
| | | | | | <p>TYPE "E" SIGNS</p> | |

| | |
|------------------------------|---------------------|
| TIP NO. B-4226 | SHEET NO. SIGN-3 |
| APPROVED: <i>[Signature]</i> | |
| DATE: 12/10/07 | |
| SEAL | |
| | |

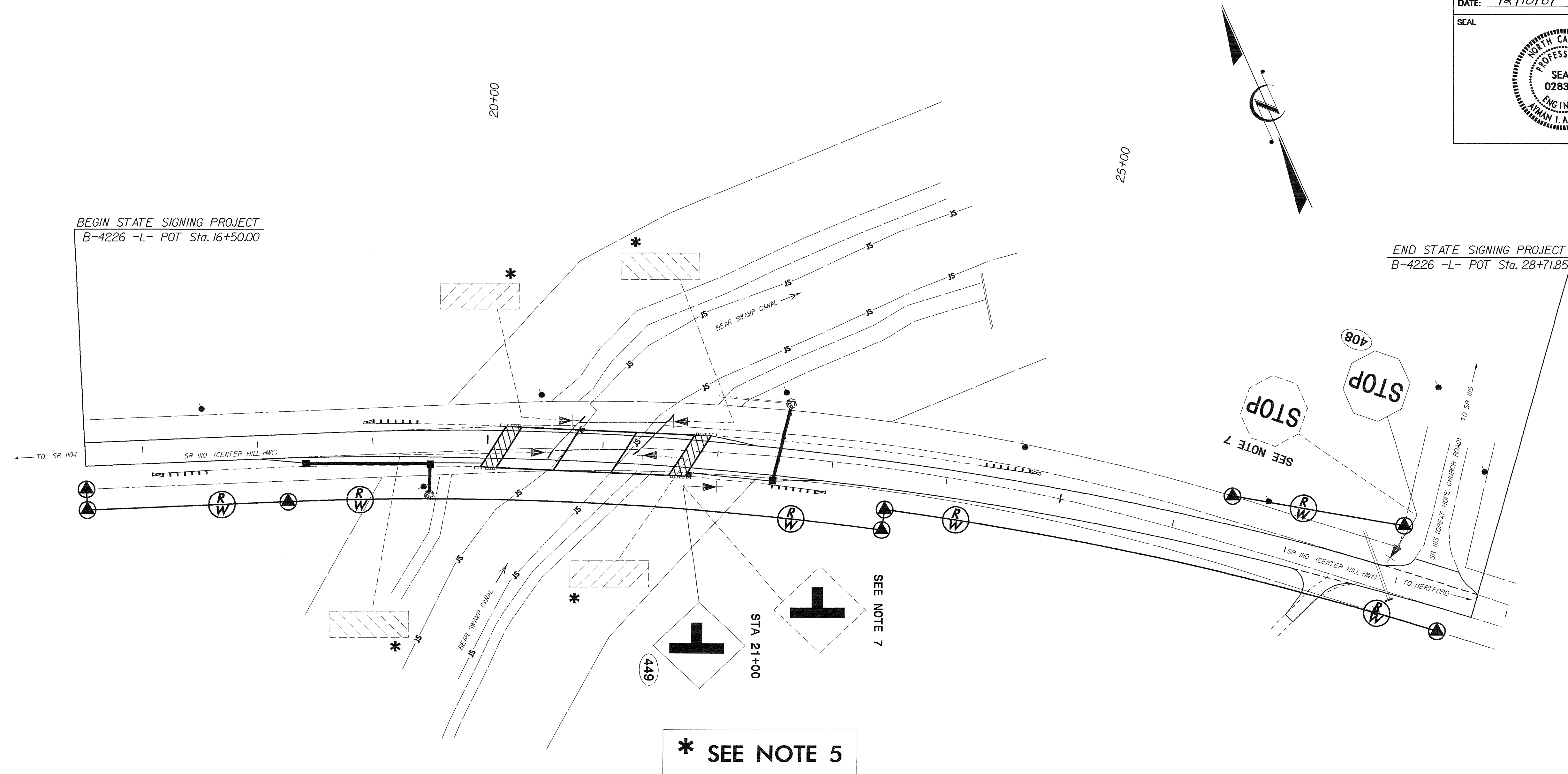

WARNING SIGNS PLACEMENT CHART

| POSTED OR 85TH PERCENTILE SPEED MPH (KMH) | MUTCD DISTANCE FT (M) | SUGGESTED LOCATION FT (M) | SUGGESTED MAXIMUM FT (M) |
|---|-----------------------|---------------------------|--------------------------|
| 30 (50) | 450 (140) | 475 (145) | 575 (175) |
| 35 (55) | 550 (170) | 575 (175) | 675 (205) |
| 40 (65) | 650 (200) | 675 (205) | 775 (235) |
| 45 (70) | 750 (230) | 775 (235) | 875 (270) |
| 50 (80) | 850 (260) | 875 (270) | 975 (300) |
| 55 (90) | 950 (290) | 975 (300) | 1075 (330) |
| 60 (95) | 1100 (335) | 1125 (345) | 1225 (375) |
| 65 (105) | 1200 (365) | 1225 (375) | 1325 (405) |
| 70 (115) | 1250 (380) | 1275 (390) | 1375 (420) |

1. SEE ROADWAY STANDARD NO. 904.50 FOR MOUNTING OF TYPE 'D', 'E', AND 'F' SIGNS ON 'U' CHANNEL POSTS.
2. SEE CHART FOR PLACEMENT OF WARNING SIGNS. DISTANCES SHOWN IN MINIMUM ROAD COLUMNS ARE FOR LEVEL ROADWAYS. MAKE CORRECTIONS FOR GRADES. IF 48-INCH (1219 MM) SIGNS ARE USED, THE LEGIBILITY DISTANCE MAY BE INCREASED TO 200 FEET (61 M). THIS WOULD ALLOW REDUCING THE CHART SPECIFIED DISTANCE BY 75 FEET (23 M).
3. IF THE BRIDGE IS OVER A MAJOR STREAM OR RIVER, A SIGN FOR THE NAME OF THE STREAM OR RIVER SHOULD BE INSTALLED AT EACH APPROACH. THESE DESIGNS WILL BE COMPLETED BY THE SIGNING SECTION UPON REQUEST.
4. SIGNS FURNISHED BY CONTRACTOR. BACKGROUND SHEETING SHALL BE TYPE III REFLECTIVE SHEETING.
5. DISPOSAL OF SIGN SYSTEM, U-CHANNEL.
6. SIGN ERECTION, RELOCATE SIGN TYPE D, E, OR F.
7. DISPOSAL OF SIGN SYSTEM, WOOD.
8. DISPOSAL OF SIGN, D, E, OR F.
9. DISPOSAL OF SUPPORT, U-CHANNEL.

STA 16+50 TO 29+00
SR 1110
EXISTING/PROPOSED ROADWAY