

**TIP PROJECT: B-4131**

STATE OF NORTH CAROLINA  
DIVISION OF HIGHWAYS

---

PLAN FOR PROPOSED  
HIGHWAY EROSION CONTROL

**GUILFORD COUNTY**

**LOCATION: BRIDGE NO. 11 OVER BIG ALAMANCE CREEK ON  
SR 3394 (COMPANY MILL ROAD)**

**TYPE OF WORK: GRADING, DRAINAGE, PAVING  
& STRUCTURE**

STATE	STATE PROJECT REFERENCE NO.	SHEET NO.	TOTAL SHEETS
N.C.	B-4131	EC-1	
STATE PROJ. NO.	F.A. PROJ. NO.	DESCRIPTION	

**EROSION AND SEDIMENT CONTROL MEASURES**

Std. #	Description	Symbol
	Streambank Reforestation.....	
1630.05	Temporary Silt Ditch.....	
1630.05	Temporary Diversion.....	
1605.01	Temporary Silt Fence.....	
1606.01	Special Sediment Control Fence.....	
1622.01	Temporary Berms and Slope Drains.....	
1630.01	Riser Basin.....	
1630.02	Silt Basin Type B.....	
1633.01	Temporary Rock Silt Check Type-A.....	
	Temporary Rock Silt Check Type-B.....	
1634.01	Temporary Rock Sediment Dam Type-A.....	
1634.02	Temporary Rock Sediment Dam Type-B.....	
1635.01	Rock Pipe Inlet Sediment Trap Type-A.....	
1635.02	Rock Pipe Inlet Sediment Trap Type-B.....	
1630.04	Stilling Basin.....	
	Rock Inlet Sediment Trap:	
1632.01	Type A.....	
1632.02	Type B.....	
1632.03	Type C.....	
	Skimmer Basin.....	
	Tiered Skimmer Basin.....	

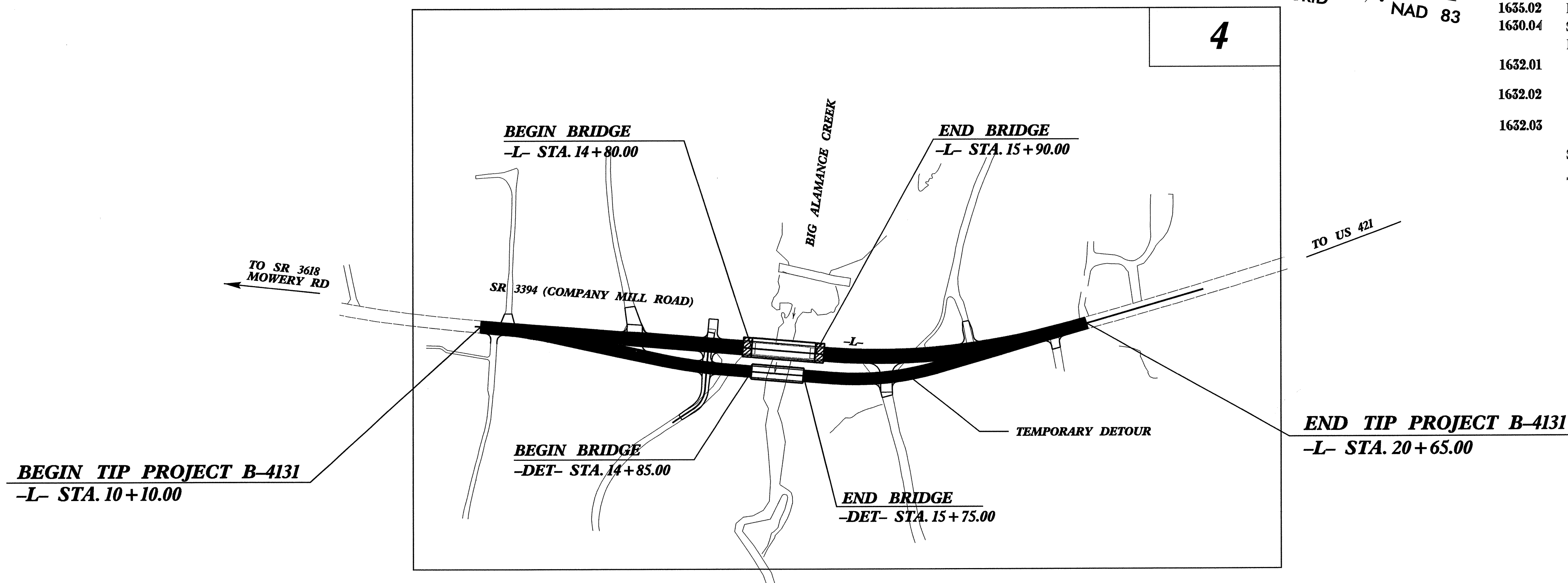
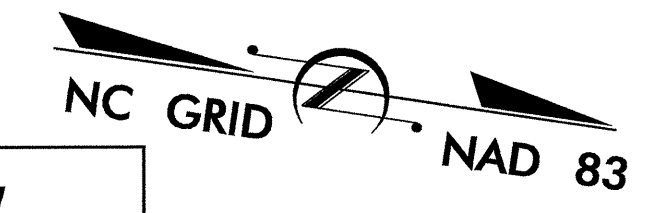

THIS PROJECT CONTAINS  
EROSION CONTROL PLANS  
FOR CLEARING AND  
GRUBBING PHASE OF  
CONSTRUCTION.

**GRAPHIC SCALE**

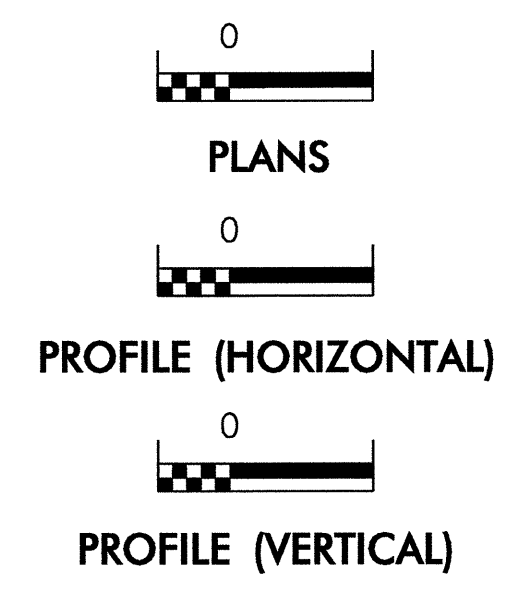

ROADSIDE ENVIRONMENTAL UNIT  
DIVISION OF HIGHWAYS  
STATE OF NORTH CAROLINA

Prepared In the Office of:  
**ROADSIDE ENVIRONMENTAL UNIT**  
1 South Wilmington St.  
Raleigh, NC 27611  
**2006 STANDARD SPECIFICATIONS**

Roadway Standard Drawings

The following roadway english standards as appear in "Roadway Standard Drawings"- Roadway Design Unit - N. C. Department of Transportation - Raleigh, N. C., dated July 18, 2006 and the latest revision thereto are applicable to this project and by reference hereby are considered a part of these plans.

1605.01 Temporary Silt Fence	1632.03 Rock Inlet Sediment Trap Type C
1607.01 Gravel Construction Entrance	1633.01 Temporary Rock Silt Check Type A
1622.01 Temporary Berms and Slope Drains	1634.02 Temporary Rock Sediment Dam Type B
1630.05 Temporary Diversion	1635.02 Rock Pipe Inlet Sediment Trap Type B

06-NOV-2007 10:07  
C:\projects\2007\0607\roadside\environmental\detaila\b4131\_r-dj\_tsh.dgn  
REVISIONS

PROJECT REFERENCE NO. <i>B-4131</i>	SHEET NO. <i>EC-2</i>
RW SHEET NO.	
ROADWAY DESIGN ENGINEER	HYDRAULICS ENGINEER

# TEMPORARY ROCK SILT CHECK TYPE 'B' DETAIL

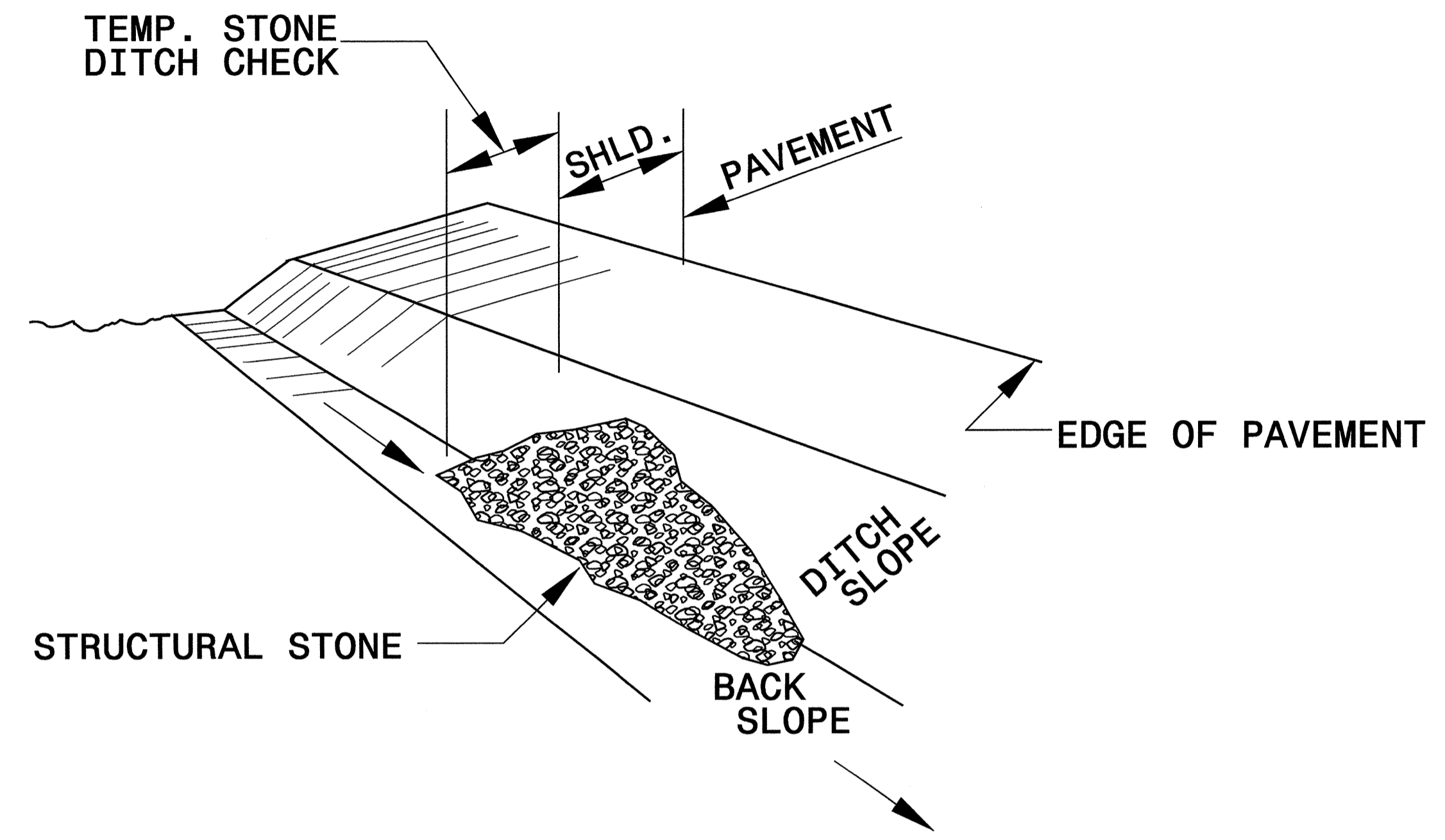

**ISOMETRIC VIEW**

**NOTES:**

USE CLASS 'B' EROSION CONTROL STONE FOR STRUCTURAL STONE.

THE ENGINEER MAY DIRECT THE OPTION OF CLASS "A" STONE FOR SITES HAVING LESS THAN ONE (1) ACRE DRAINAGE AREA AND A DITCH GRADE LESS THAN 3%.

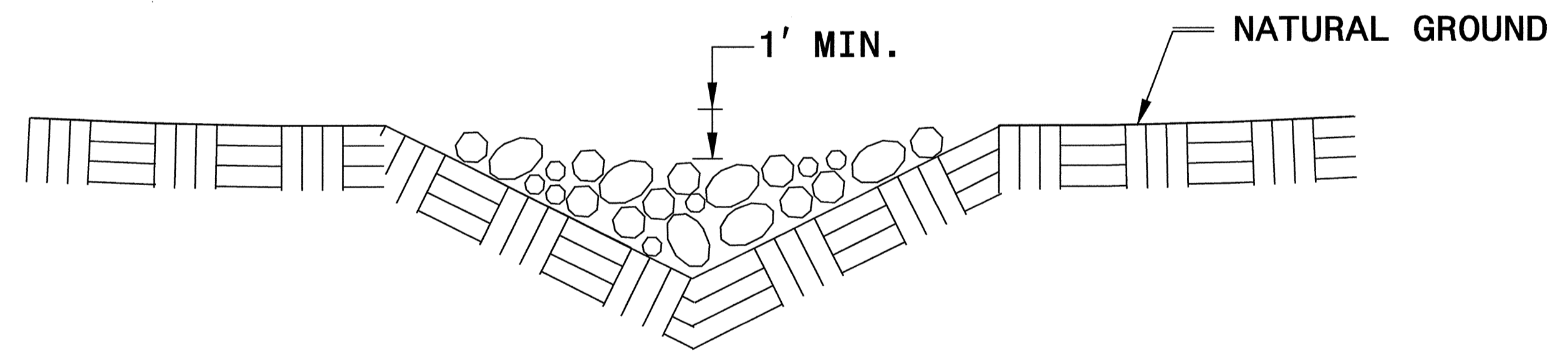

**CROSS SECTION VEE DITCH**

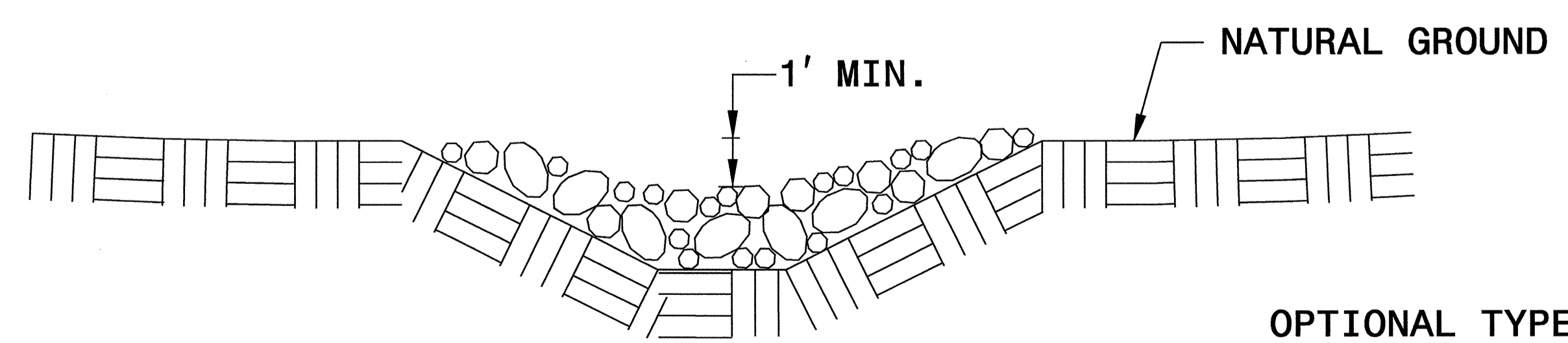

**CROSS SECTION TRAPEZOIDAL DITCH**

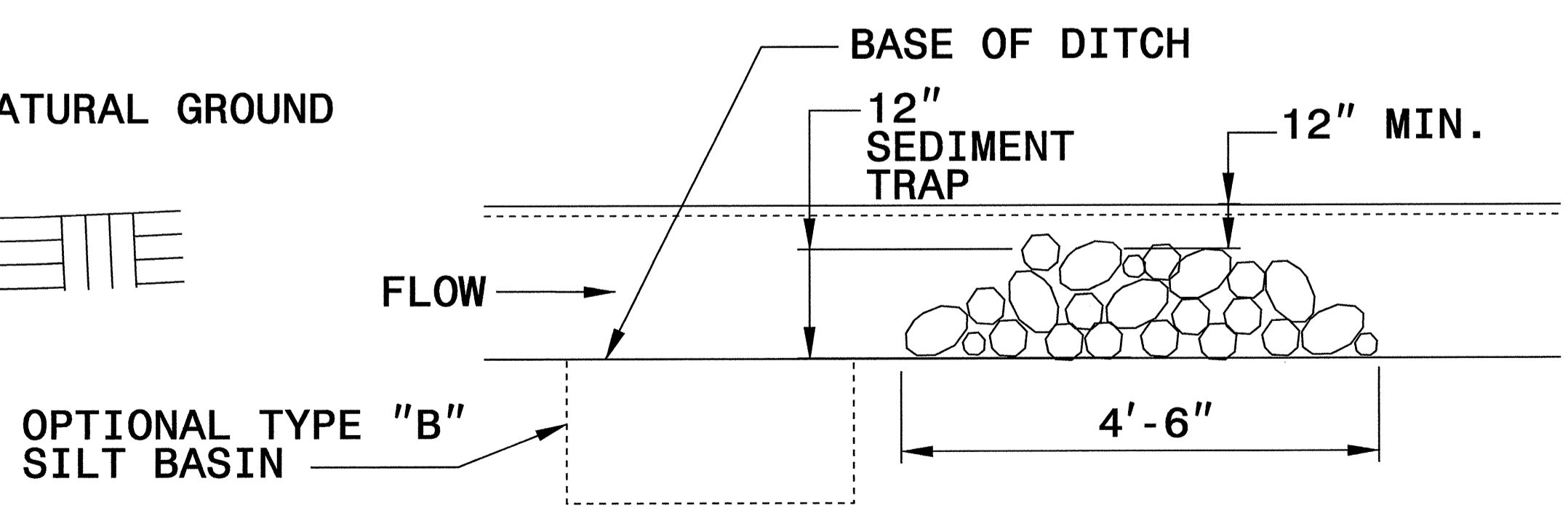

**ELEVATION VIEW**

PROJECT REFERENCE NO. B-4131	SHEET NO. EC-2A
RW SHEET NO.	
ROADWAY DESIGN ENGINEER	HYDRAULICS ENGINEER

# COIR FIBER BAFFLE DETAIL

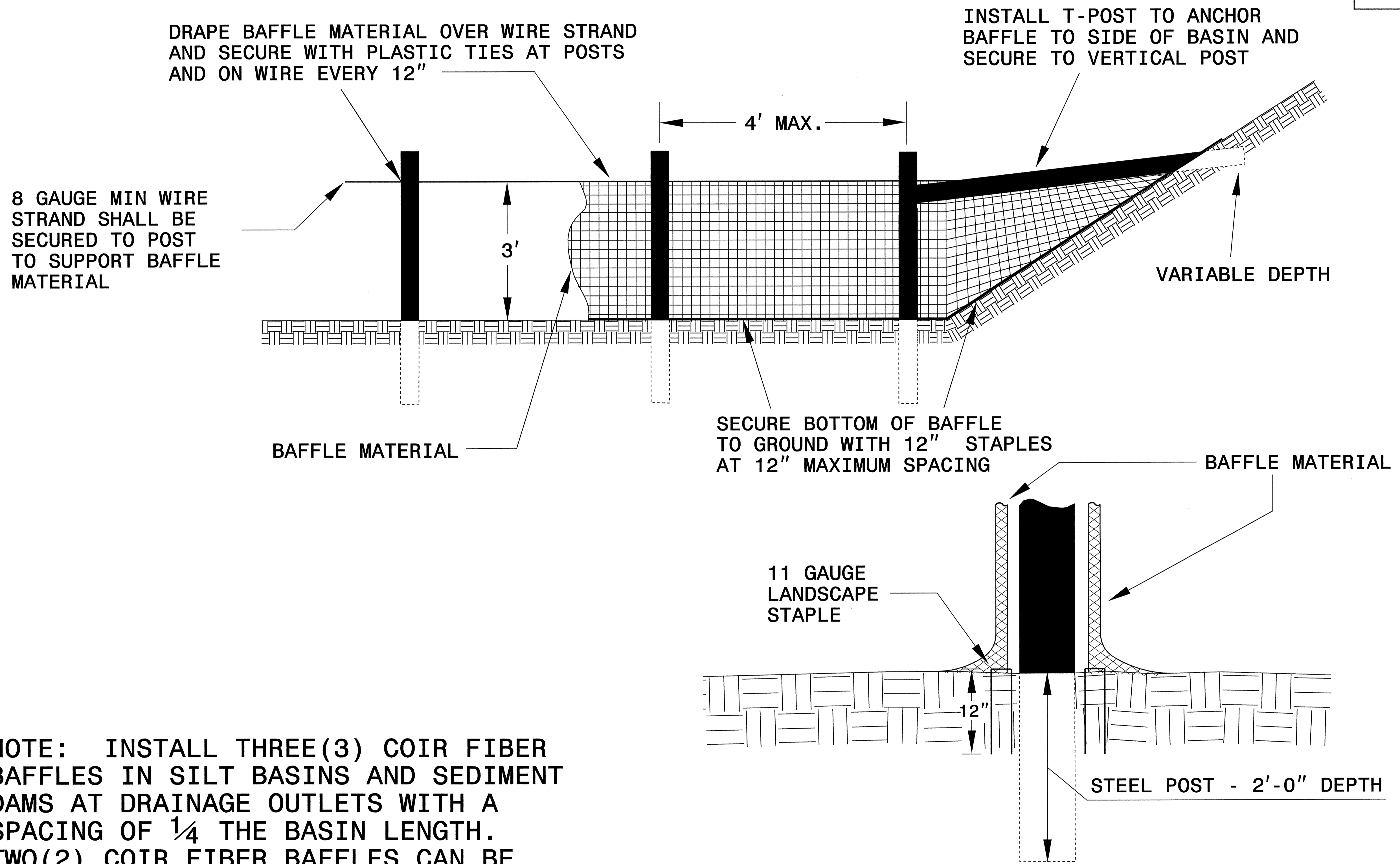

NOTE: INSTALL THREE(3) COIR FIBER BAFFLES IN SILT BASINS AND SEDIMENT DAMS AT DRAINAGE OUTLETS WITH A SPACING OF  $\frac{1}{4}$  THE BASIN LENGTH. TWO(2) COIR FIBER BAFFLES CAN BE INSTALLED IN SILT BASINS AND DAMS LESS THAN 20 FT. IN LENGTH WITH A SPACING OF  $\frac{1}{3}$  THE BASIN LENGTH.

BAFFLE MATERIAL SHALL BE SECURED TO THE BOTTOM AND SIDES OF BASIN USING 12" LANDSCAPE STAPLES



CLEARING AND GRUBBING  
EROSION CONTROL FOR  
CONSTRUCTION SHEET 4 AND 2B

INSTALL FILTER FABRIC UNDER  
TEMPORARY ROCK SILT CHECK(S)  
TYPE A IN PERMITTED WETLANDS.

NOTE:  
PLACE TEMPORARY ROCK SEDIMENT DAMS - B  
AND TEMPORARY ROCK SILT CHECKS - A AT  
DRAINAGE OUTLETS.

NOTE:  
UTILIZE TEMPORARY ROCK SEDIMENT DAM TYPE - B  
AS STILLING BASIN WHERE APPLICABLE.

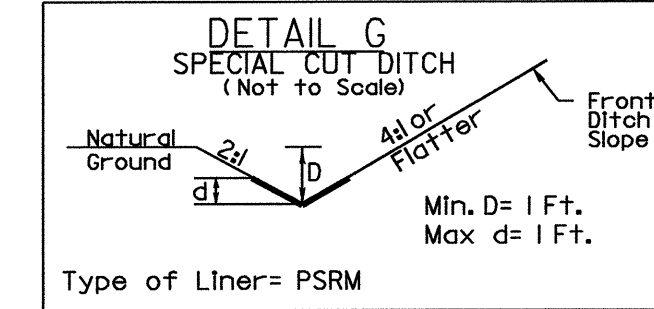
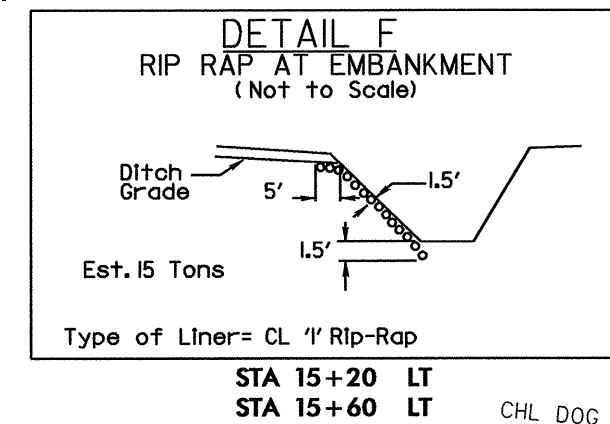
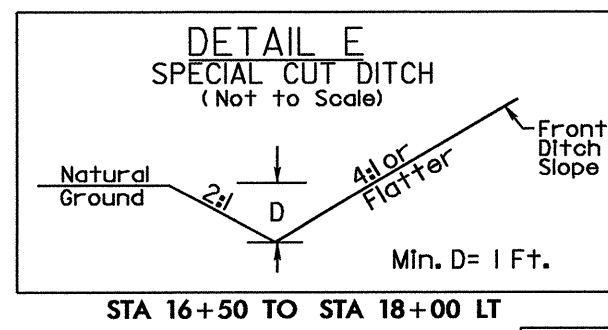
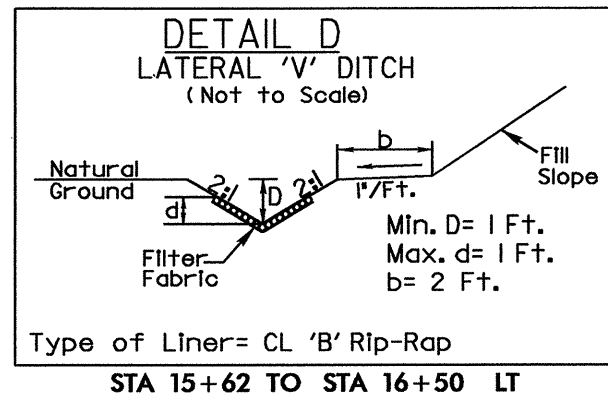
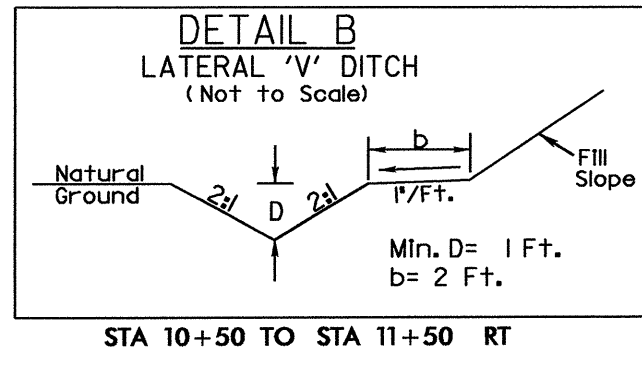

PROJECT REFERENCE NO. B-4131	SHEET NO. EC-4/CONST.4
RW SHEET NO.	
ROADWAY DESIGN ENGINEER	HYDRAULICS ENGINEER

BEGIN PROJECT B-4131  
-L- POT STA. 10+10.00

END PROJECT B-4131  
-L- POC STA. 20+65.00

38 x 18 x 3  
6' weir  
ID 4.2B

50 x 24 x 3  
8' weir  
ID 4.4C

51 x 25 x 3  
8' weir  
ID 4.1C

28 x 13 x 3  
4' weir  
ID 4.3B

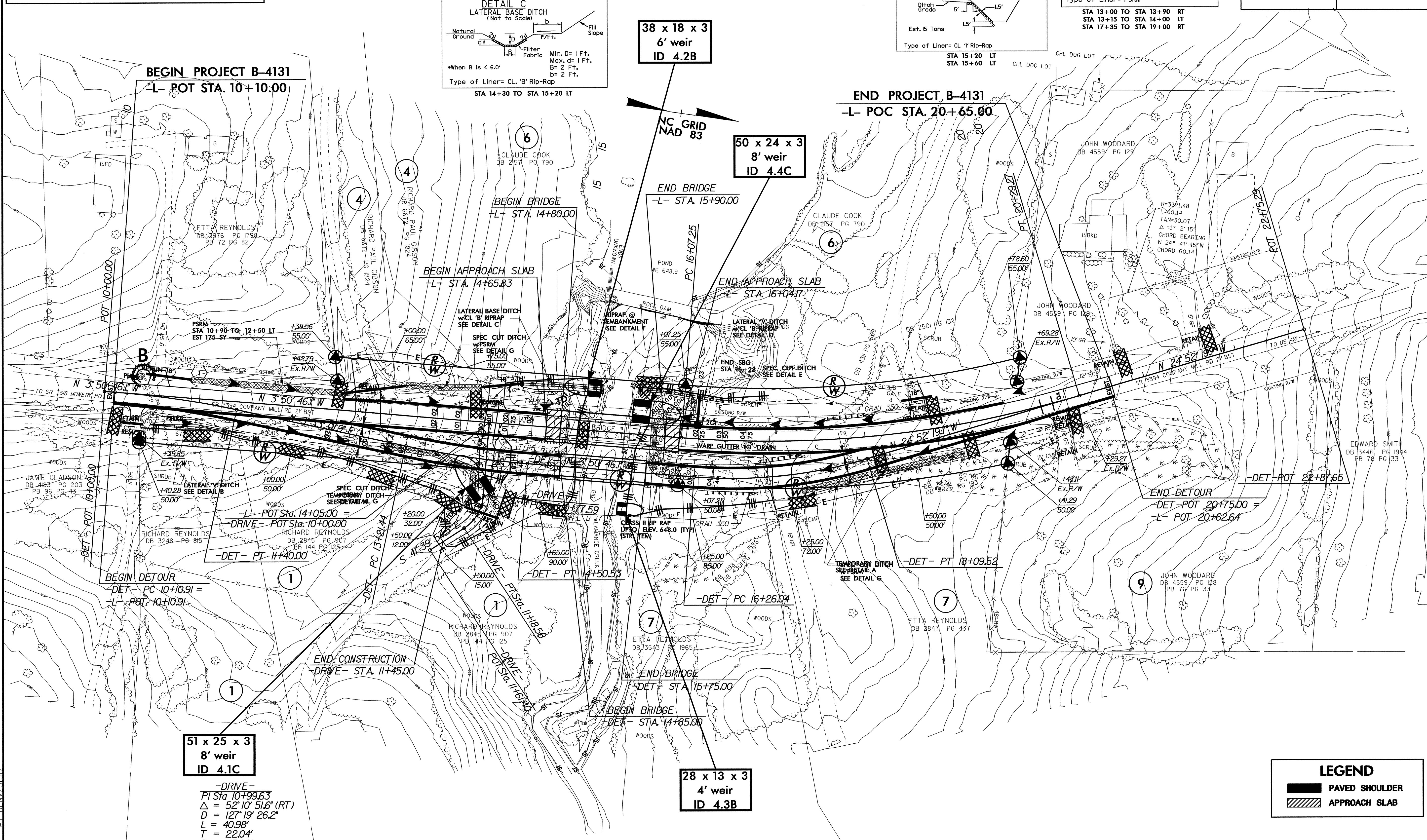

**LEGEND**

	PAVED SHOULDER
	APPROACH SLAB

INSTALL FILTER FABRIC UNDER TEMPORARY ROCK SILT CHECK(S) TYPE A IN PERMITTED WETLANDS.

NOTE:  
UTILIZE TEMPORARY ROCK SEDIMENT DAM TYPE - B AS STILLING BASIN WHERE APPLICABLE.

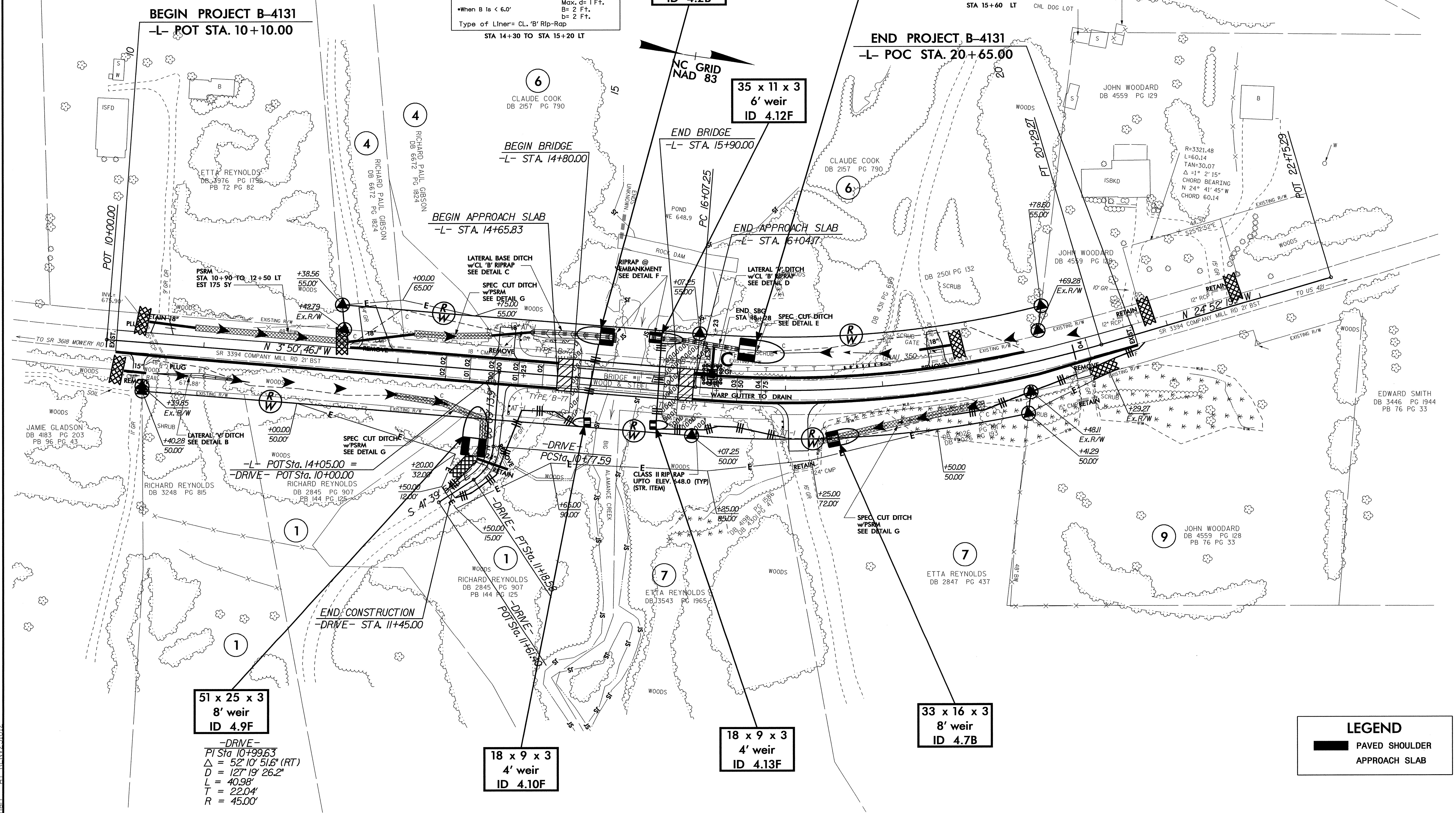
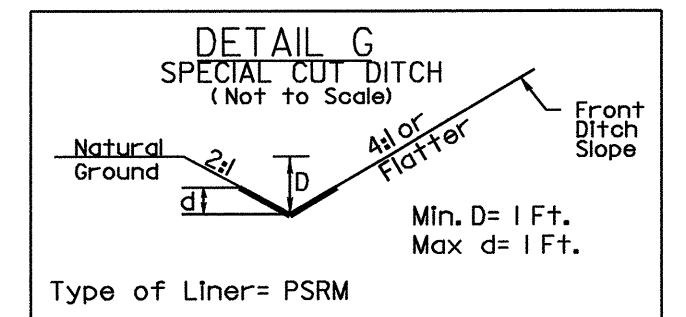
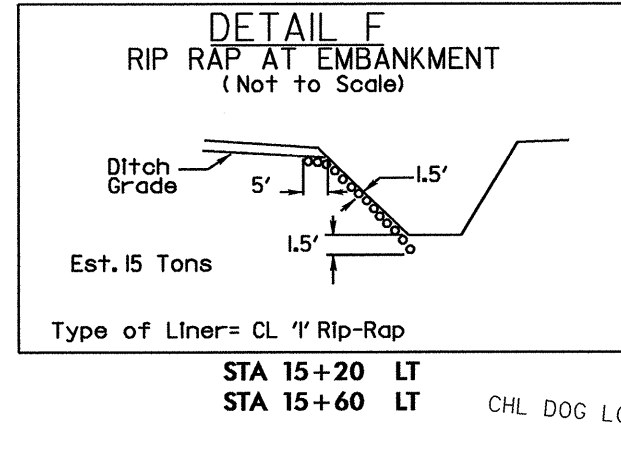
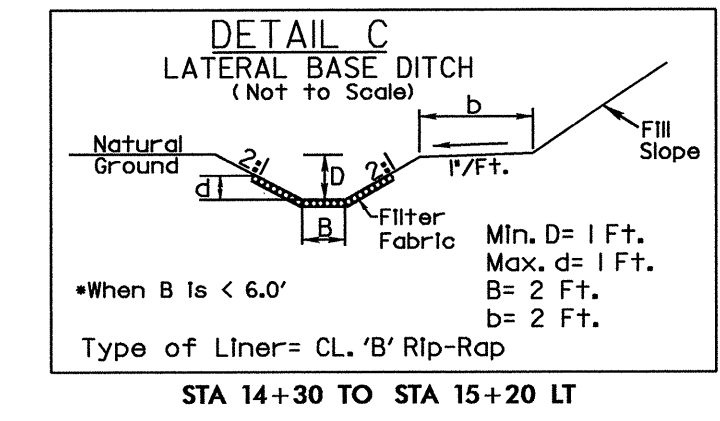
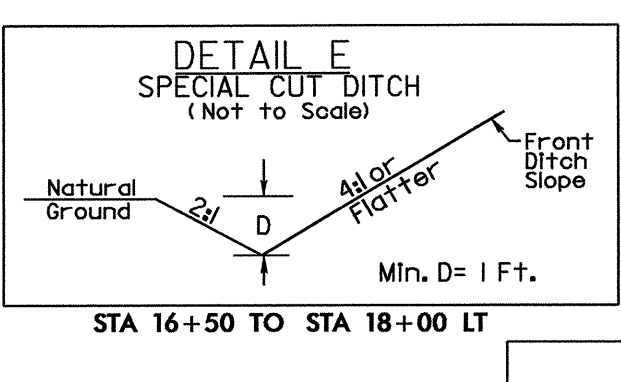
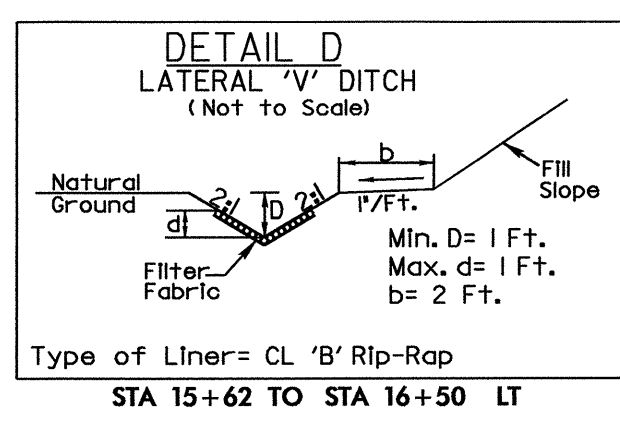
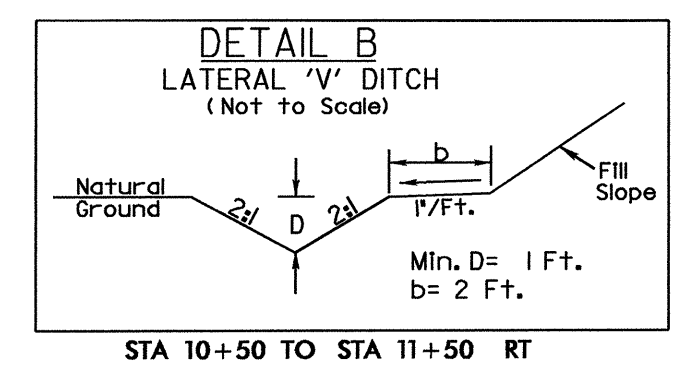

**LEGEND**  
 PAVED SHOULDER  
 APPROACH SLAB

06-NOV-2007 10:07  
 g:\tip\projects\b4131\environmental\design\b4131\_r-dj\_psh\_04.dgn  
 8/17/99  
 06-NOV-2007 10:07  
 g:\tip\projects\b4131\environmental\design\b4131\_r-dj\_psh\_04.dgn

PROJECT REFERENCE NO. B-4131	SHEET NO. EC-6/CONST.2-B
R/W SHEET NO.	HYDRAULICS ENGINEER
ROADWAY DESIGN ENGINEER	

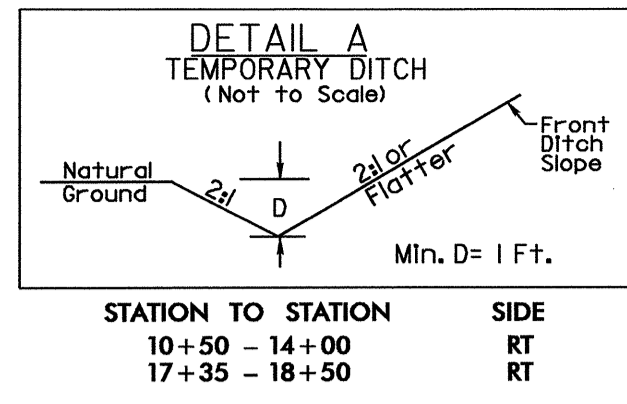

NOTE: UTILIZE TEMPORARY ROCK SEDIMENT DAM TYPE - B AS STILLING BASIN WHERE APPLICABLE.

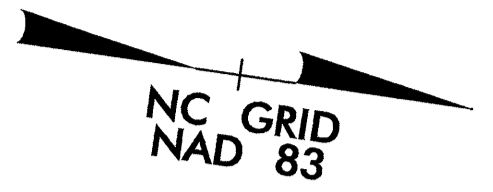

# DETOUR

## TEMPORARY DETOUR

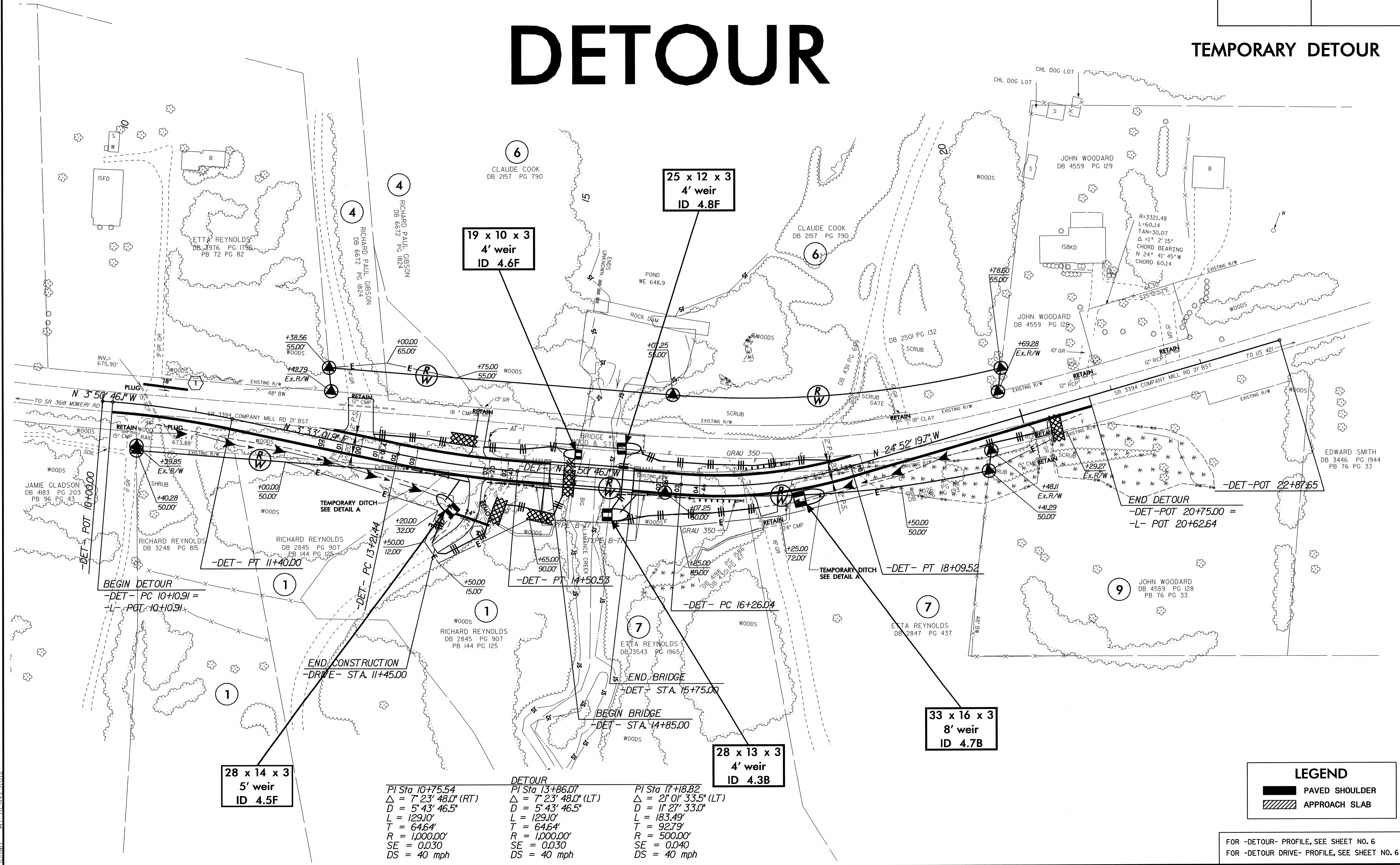

DETOUR		
PI Sta 10+75.54	PI Sta 13+86.07	PI Sta 17+88.22
$\Delta = 7^{\circ}23'48.0''$ (RT)	$\Delta = 7^{\circ}23'48.0''$ (LT)	$\Delta = 2^{\circ}01'33.5''$ (LT)
$D = 5^{\circ}43'46.5''$	$D = 5^{\circ}43'46.5''$	$D = 11^{\circ}27'33.0''$
$L = 129.10'$	$L = 129.10'$	$L = 183.49'$
$T = 64.64'$	$T = 64.64'$	$T = 92.79'$
$R = 1,000.00'$	$R = 1,000.00'$	$R = 500.00'$
$SE = 0.030$	$SE = 0.030$	$SE = 0.040$
$DS = 40$ mph	$DS = 40$ mph	$DS = 40$ mph

LEGEND	
	PAVED SHOULDER
	APPROACH SLAB

FOR -DETOUR- PROFILE, SEE SHEET NO. 6  
FOR -DETOUR DRIVE- PROFILE, SEE SHEET NO. 6

06-NOV-2007 10:07 g:\tjpr\p01\ecsb\64131\environmental\design\b4131\_rdy\_psh\_det.dgn