

STATE OF NORTH CAROLINA DIVISION OF HIGHWAYS

CROSS-SECTION SUMMARY

NOTE: EMBANKMENT COLUMN DOES NOT INCLUDE BACKFILL FOR UNDERCUT

Station	Uncl. Exc.	Embt
L	(cu. yd.)	(cu. yd.)
13+00.00	0.0	0.0
13+50.00	1.9	47.2
14+00.00	4.2	94.8
14+50.00	4.7	72.9
15+00.00	3.4	69.4
15+50.00	1.7	116.8
16+00.00	0.6	142.8
16+07.00	0.0	19.7

Approximate quantities only. Unclassified excavation, borrow excavation, fine grading, clearing and grubbing and removal of existing pavement will be paid for at the lump sum price for "Grading".

Station	Uncl. Exc.	Embt
L	(cu. yd.)	(cu. yd.)
17+07.00	0.0	0.0
17+50.00	0.0	173.9
18+00.00	0.1	144.7
18+50.00	165.6	66.9
19+00.00	241.2	32.3
19+50.00	83.8	10.5
20+00.00	8.1	1.4

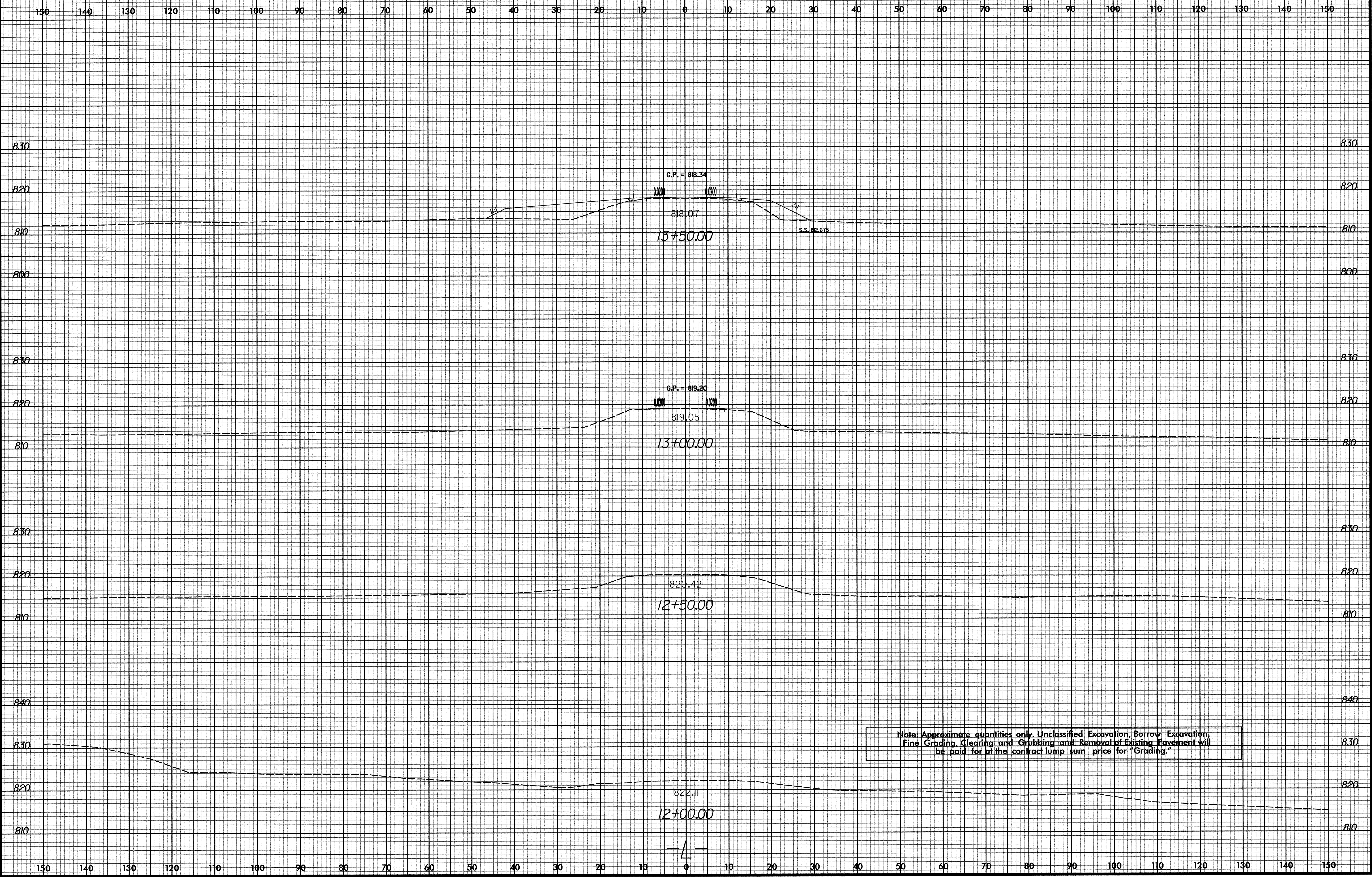

Note: Approximate quantities only. Unclassified Excavation, Borrow Excavation, Fine Grading, Clearing and Grubbing and Removal of Existing Pavement will be paid for at the contract lump sum price for "Grading."

8/23/99



PROJ. REFERENCE NO.	SHEET NO.
B-4112	X-3

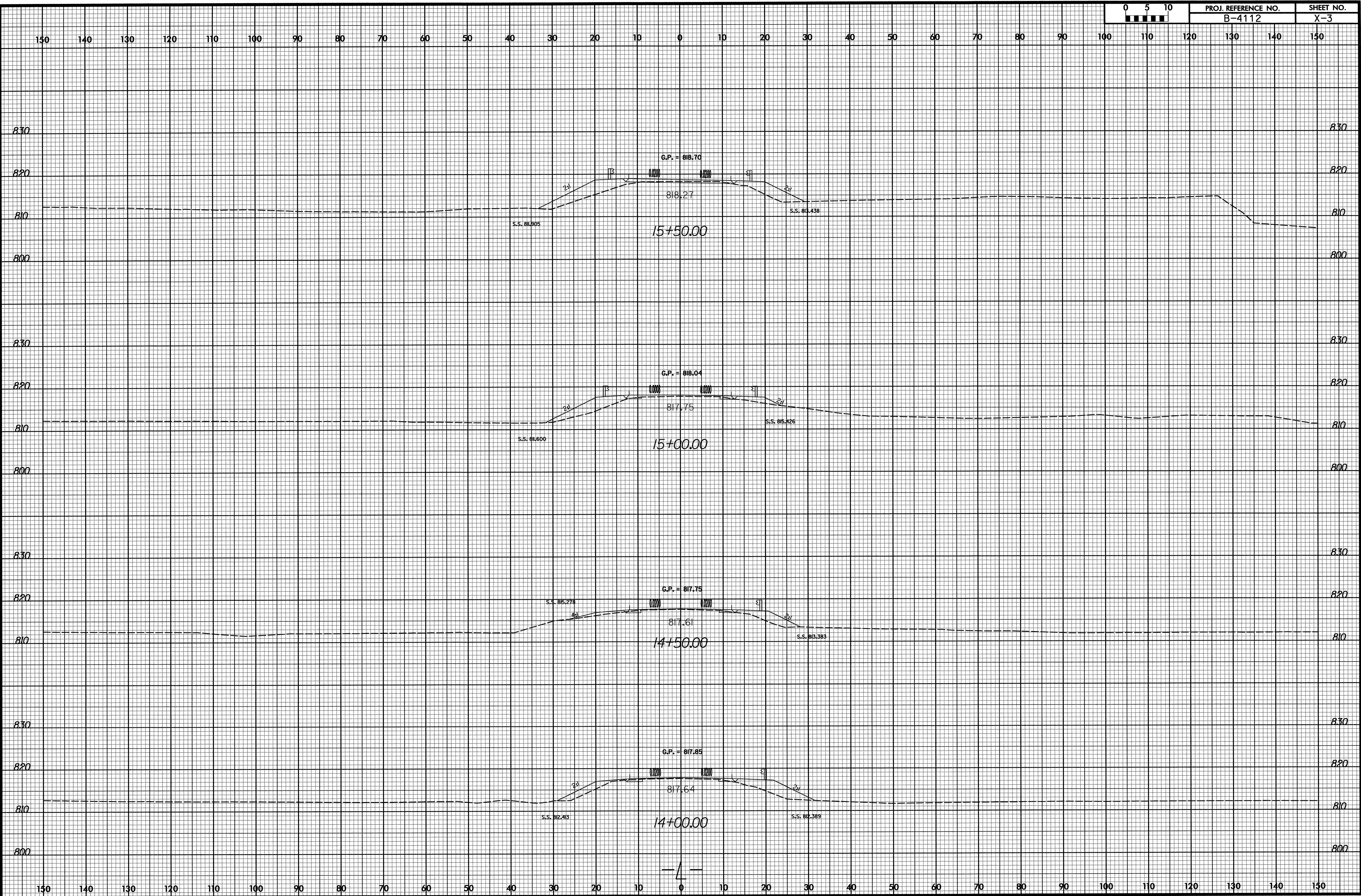

8/23/2007
 P:\Roadway\Proj\B4112_Fdu_xp1.dgn
 G & Associates, P.C.

8/23/99

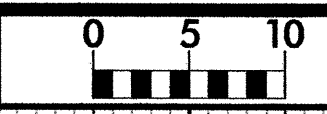

PROJ. REFERENCE NO.	SHEET NO.
B-4112	X-4

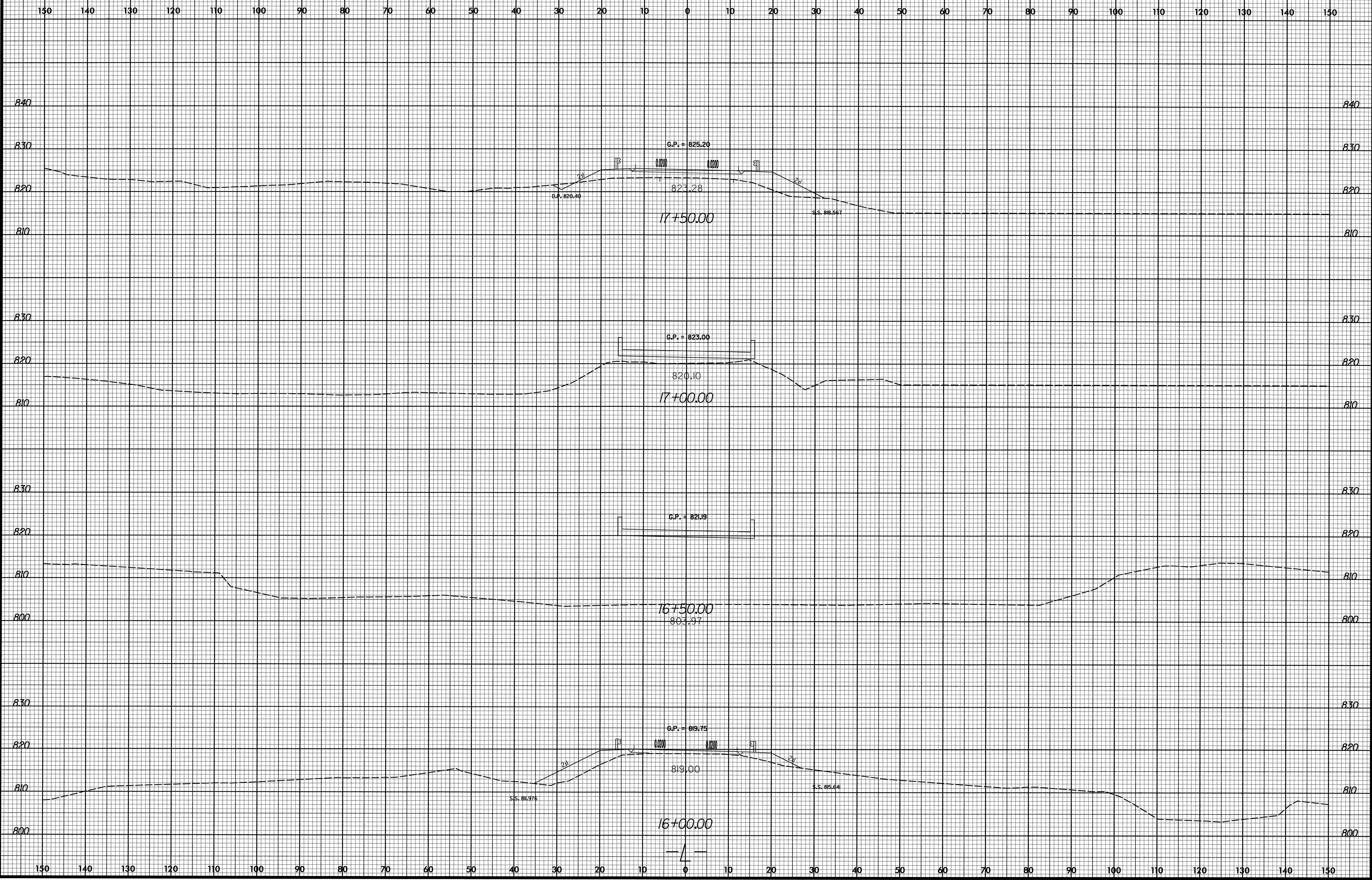

10/23/2007
P:\Roadway\Proj\B4112_Rdy_xpl.dgn
G & Associates, P.C.

8/23/99



PROJ. REFERENCE NO.	SHEET NO.
B-4112	X-5

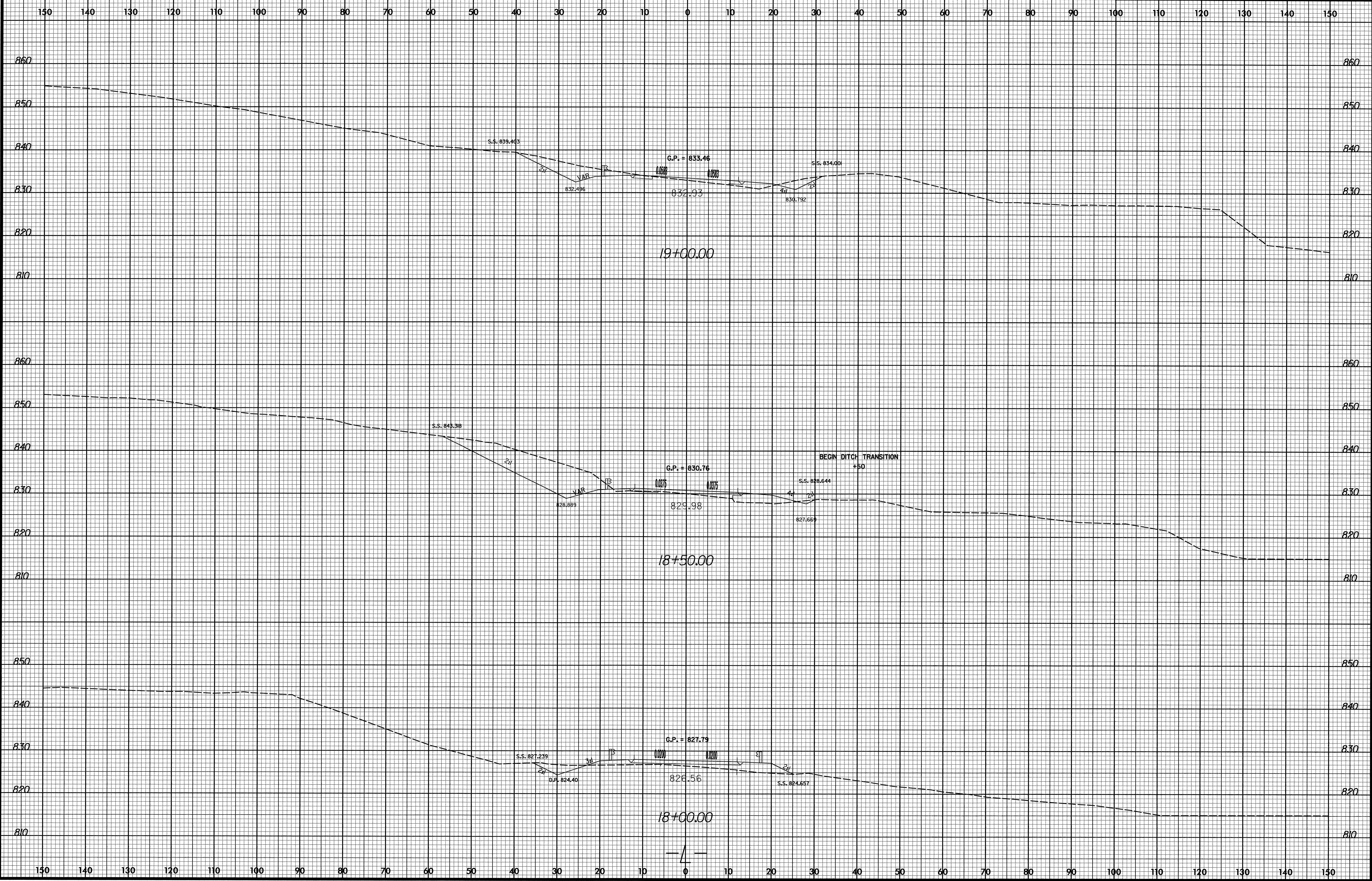

10/23/2007
R:\Roadway\Proj_B4112_Rdy_xpl_1.dgn
C & Associates, P.C.

8/23/99

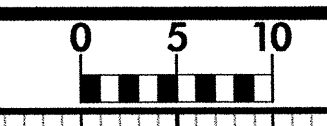

PROJ. REFERENCE NO.	SHEET NO.
B-4112	X-6

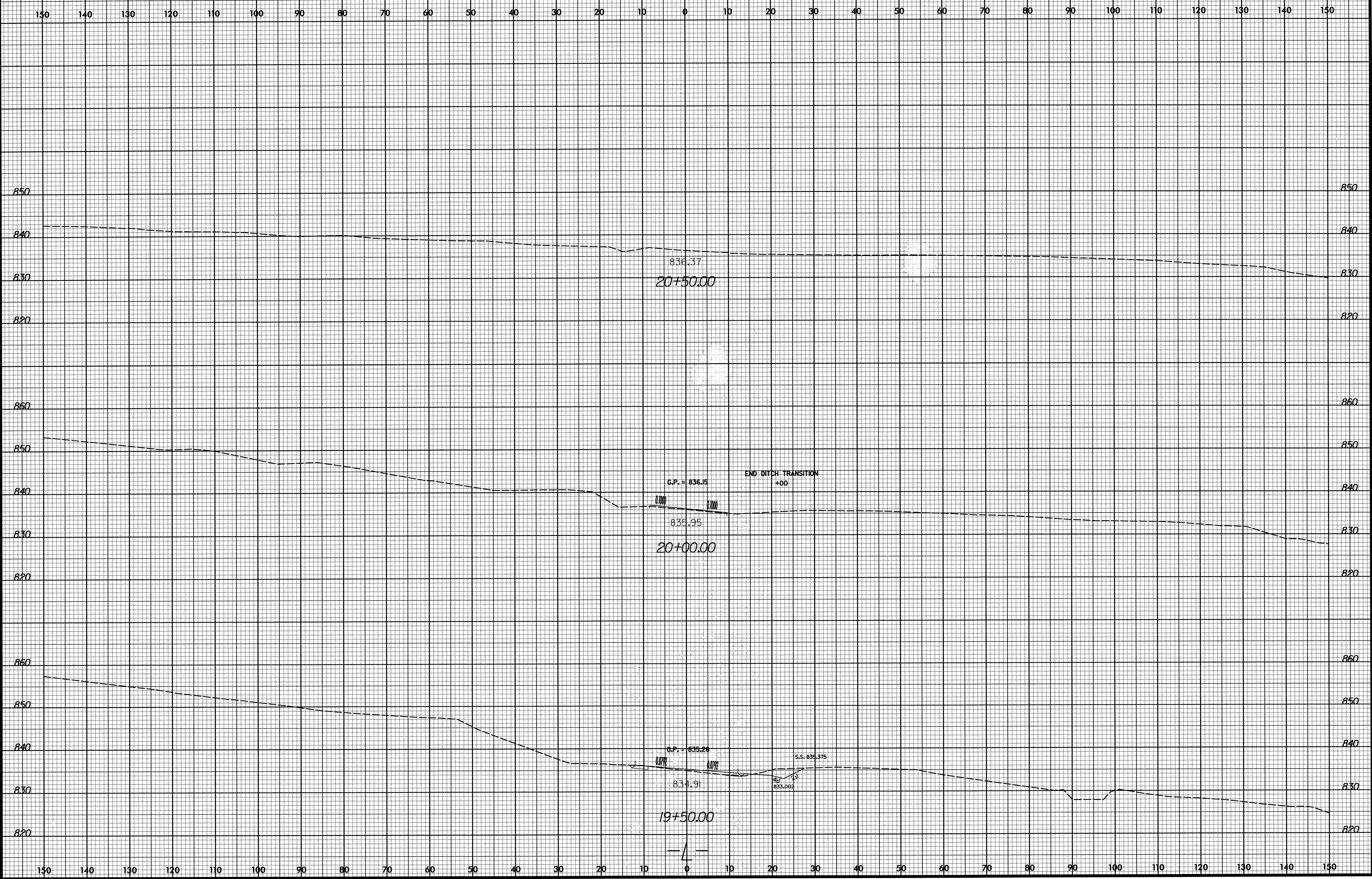

8/23/2007
R:\Roadway\Proj\B4112_Rdy_xpl.dgn
Co. & Associates, P.C.