

TIP PROJECT: B-4085

STATE OF NORTH CAROLINA
 DIVISION OF HIGHWAYS
 PLAN FOR PROPOSED
 HIGHWAY EROSION CONTROL
CRAVEN COUNTY

LOCATION: BRIDGE NO. 212 OVER BACHELOR CREEK ON SR 1005

STATE	STATE PROJECT REFERENCE NO.	SHEET NO.	TOTAL SHEETS
N.C.	B-4085	EC-1	
STATE PROJ. NO.	F.A. PROJ. NO.	DESCRIPTION	

EROSION AND SEDIMENT CONTROL MEASURES

Std. #	Description	Symbol
	Streambank Reforestation.....	
1630.03	Temporary Silt Ditch.....	
1630.05	Temporary Diversion.....	
1605.01	Temporary Silt Fence.....	
1606.01	Special Sediment Control Fence.....	
1622.01	Temporary Berms and Slope Drains.....	
1630.01	Riser Basin.....	
1630.02	Silt Basin Type B.....	
1633.01	Temporary Rock Silt Check Type-A.....	
	Temporary Rock Silt Check Type-B.....	
1634.01	Temporary Rock Sediment Dam Type-A.....	
1634.02	Temporary Rock Sediment Dam Type-B.....	
1635.01	Rock Pipe Inlet Sediment Trap Type-A.....	
1635.02	Rock Pipe Inlet Sediment Trap Type-B.....	
1630.04	Stilling Basin.....	
	Rock Inlet Sediment Trap:	
	Type A.....	
1632.01	Type B.....	
1632.02	Type C.....	
	Skimmer Basin.....	
	Tiered Skimmer Basin.....	

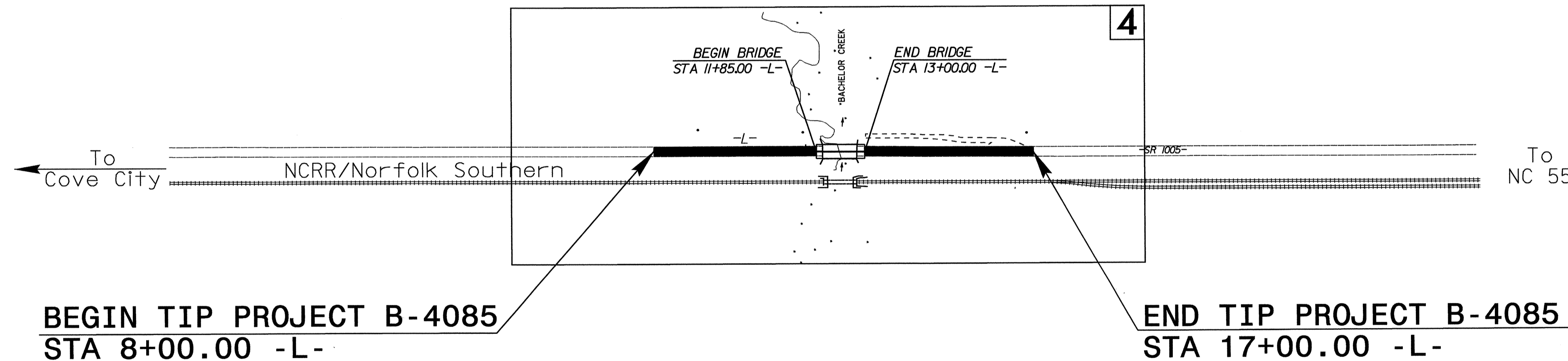

**THIS PROJECT CONTAINS
 EROSION CONTROL PLANS
 FOR CLEARING AND
 GRUBBING PHASE OF
 CONSTRUCTION.**

**THIS PROJECT HAS
 BEEN DESIGNED TO
 SENSITIVE WATERSHED
 STANDARDS.**

**ENVIRONMENTALLY
 SENSITIVE AREA(S) EXIST
 ON THIS PROJECT**
*Refer to E.C. Special Provisions
 for Special Considerations*

GRAPHIC SCALE

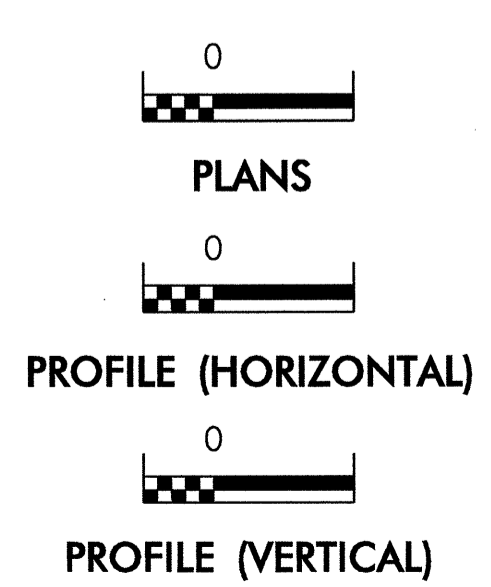

ROADSIDE ENVIRONMENTAL UNIT
 DIVISION OF HIGHWAYS
 STATE OF NORTH CAROLINA

Prepared In the Office of:
ROADSIDE ENVIRONMENTAL UNIT
 1 South Wilmington St.
 Raleigh, NC 27611
2006 STANDARD SPECIFICATIONS

Roadway Standard Drawings
 The following roadway english standards as appear in "Roadway Standard Drawings"- Roadway Design Unit - N. C. Department of Transportation - Raleigh, N. C., dated July 18, 2006 and the latest revision thereto are applicable to this project and by reference hereby are considered a part of these plans.

1605.01 Temporary Silt Fence	1632.03 Rock Inlet Sediment Trap Type C
1606.01 Special Sediment Control Fence	1633.01 Temporary Rock Silt Check Type A
1607.01 Gravel Construction Entrance	1634.02 Temporary Rock Sediment Dam Type B
1622.01 Temporary Berms and Slope Drains	
1630.03 Temporary Silt Ditch	

05-SEP-2007 15:49
 C:\ncor\comm\AT\REN21492\B4085-reu.ec.tsh.dgn
 bblabiburn

PROJECT REFERENCE NO. B-4085	SHEET NO. EC-2
RW SHEET NO.	
ROADWAY DESIGN ENGINEER	HYDRAULICS ENGINEER

TEMPORARY ROCK SILT CHECK TYPE 'B' DETAIL

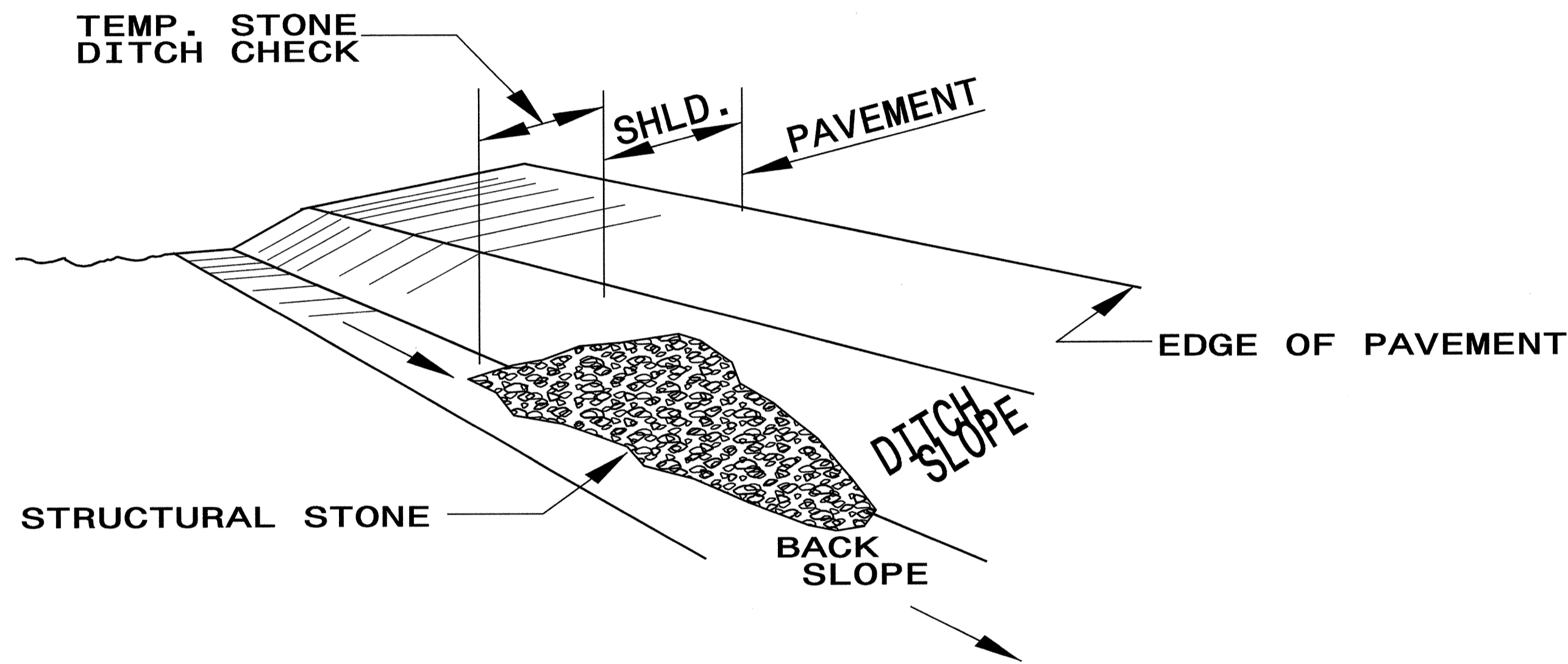

ISOMETRIC VIEW

NOTES:

USE CLASS 'B' EROSION CONTROL STONE FOR STRUCTURAL STONE.

THE ENGINEER MAY DIRECT THE OPTION OF CLASS "A" STONE FOR SITES HAVING LESS THAN ONE (1) ACRE DRAINAGE AREA AND A DITCH GRADE LESS THAN 3%.

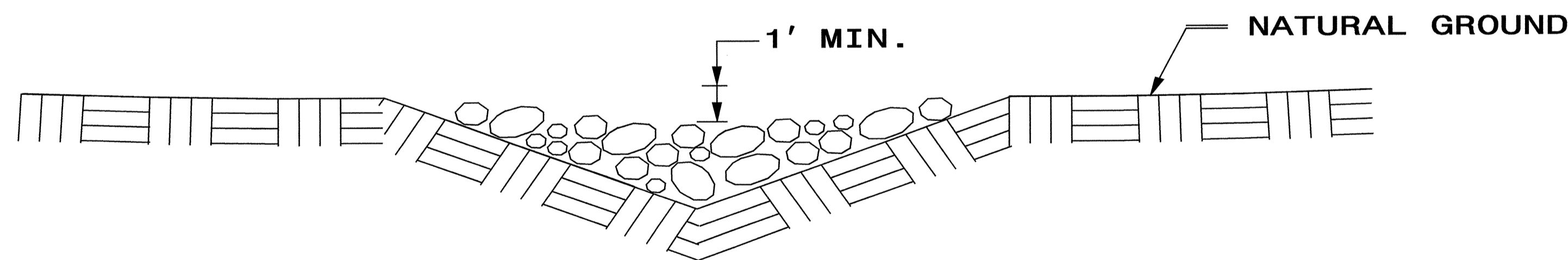

CROSS SECTION VEE DITCH

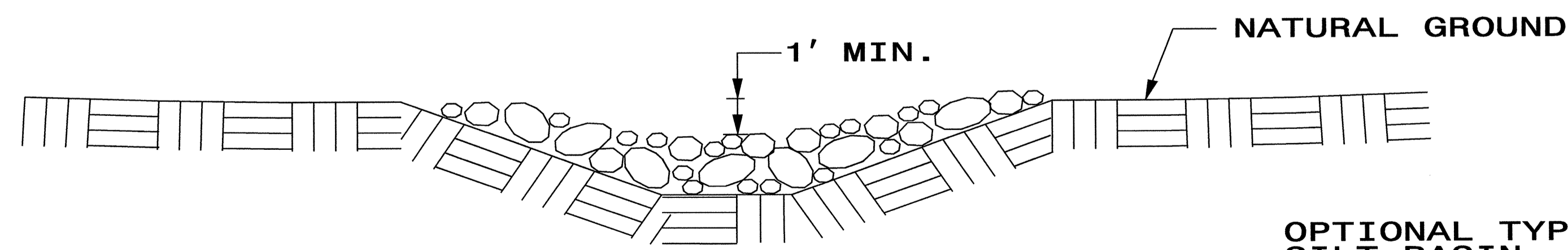

CROSS SECTION TRAPEZOIDAL DITCH

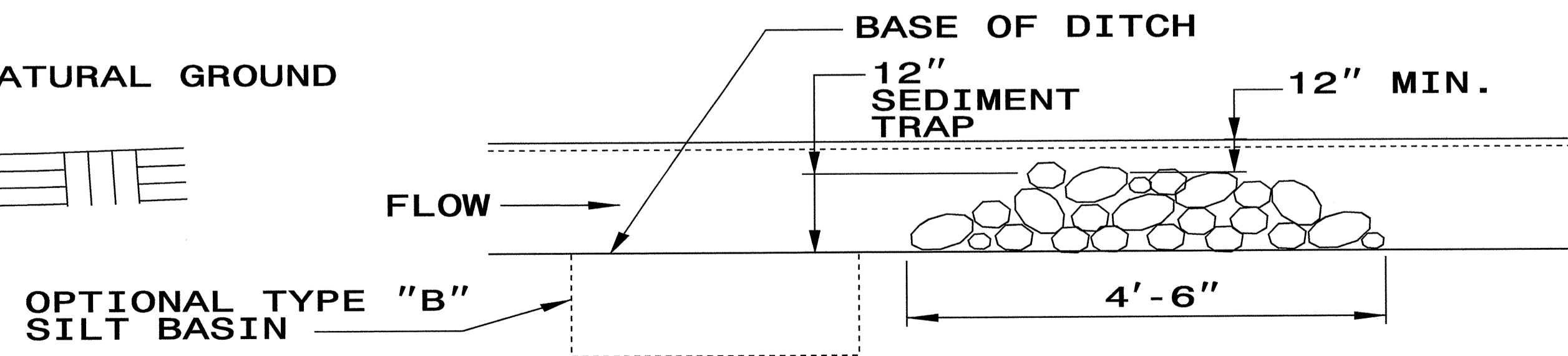

ELEVATION VIEW

PROJECT REFERENCE NO. B-4085	SHEET NO. EC-2A
RW SHEET NO.	
ROADWAY DESIGN ENGINEER	HYDRAULICS ENGINEER

COIR FIBER BAFFLE DETAIL

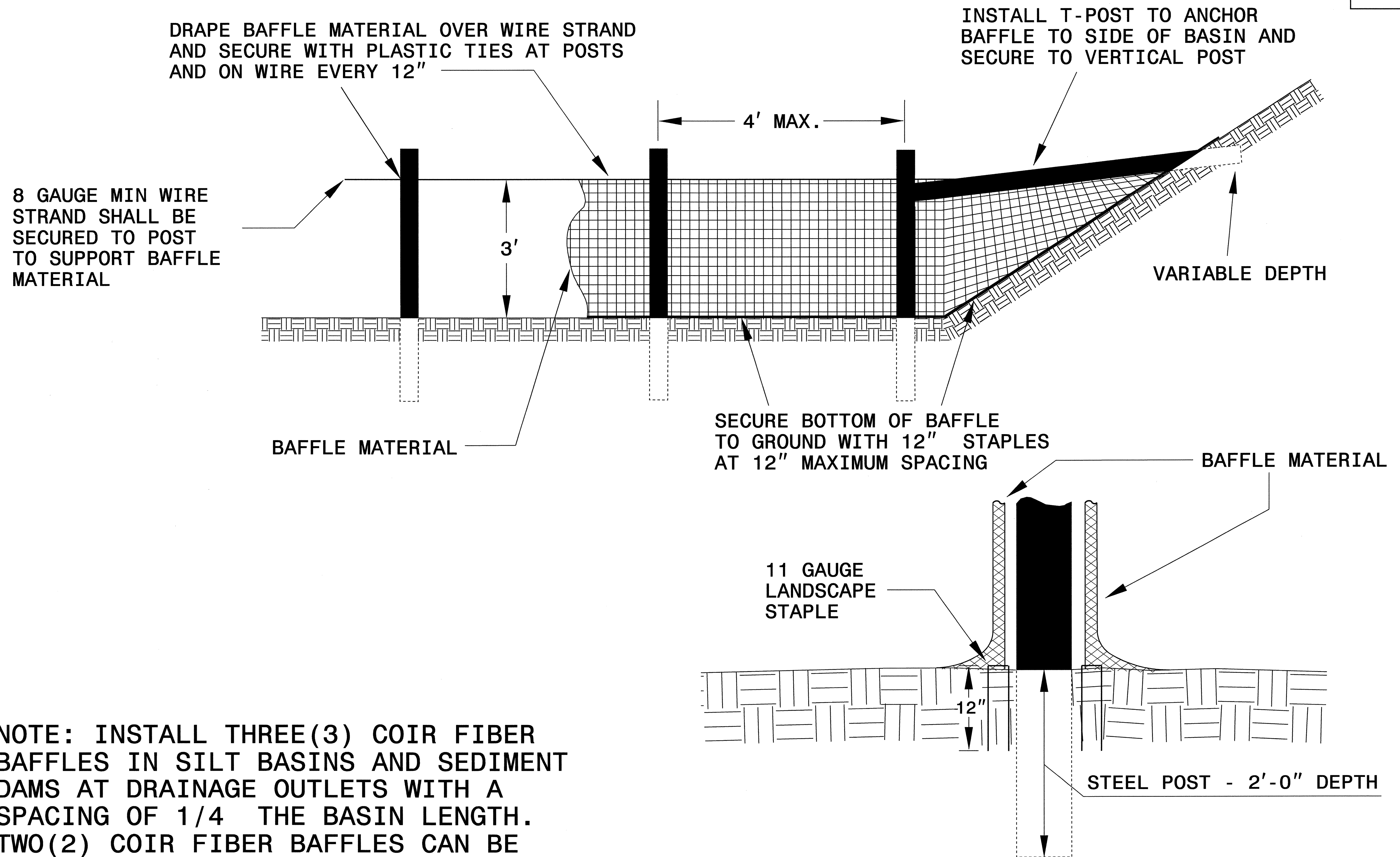

NOTE: INSTALL THREE(3) COIR FIBER BAFFLES IN SILT BASINS AND SEDIMENT DAMS AT DRAINAGE OUTLETS WITH A SPACING OF 1/4 THE BASIN LENGTH. TWO(2) COIR FIBER BAFFLES CAN BE INSTALLED IN SILT BASINS LESS THAN 20 FT. IN LENGTH WITH A SPACING OF 1/3 THE BASIN LENGTH.

BAFFLE MATERIAL SHALL BE SECURED TO THE BOTTOM AND SIDES OF BASIN USING 12" LANDSCAPE STAPLES

8/17/99

PROJECT REFERENCE NO. B-4085	SHEET NO. EC-4/CONST.4
ROADWAY DESIGN ENGINEER	HYDRAULICS ENGINEER

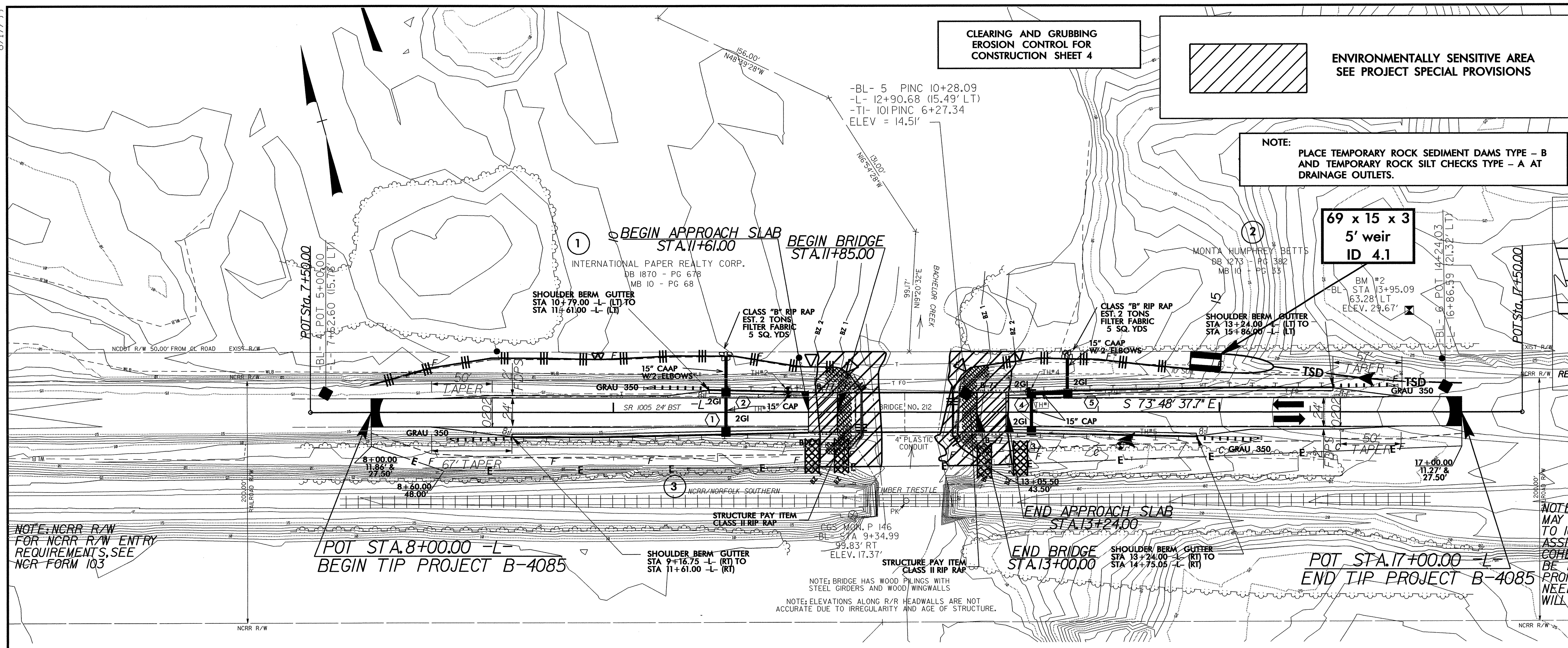

BRIDGE HYDRAULIC DATA

DESIGN DISCHARGE	= 3000 CFS
DESIGN FREQUENCY	= 50 YRS
DESIGN HW ELEVATION	= 13.4 FT
BASE DISCHARGE	= 3600 CFS
BASE FREQUENCY	= 100 YRS
BASE HW ELEVATION	= 14.2 FT
OVERTOPPING DISCHARGE	= 5400 CFS
OVERTOPPING FREQUENCY	= 500 YRS
OVERTOPPING ELEVATION	= 16.3 FT

DATE OF SURVEY = 1-18-05
 W.S. ELEVATION AT DATE OF SURVEY = 7.4 FT

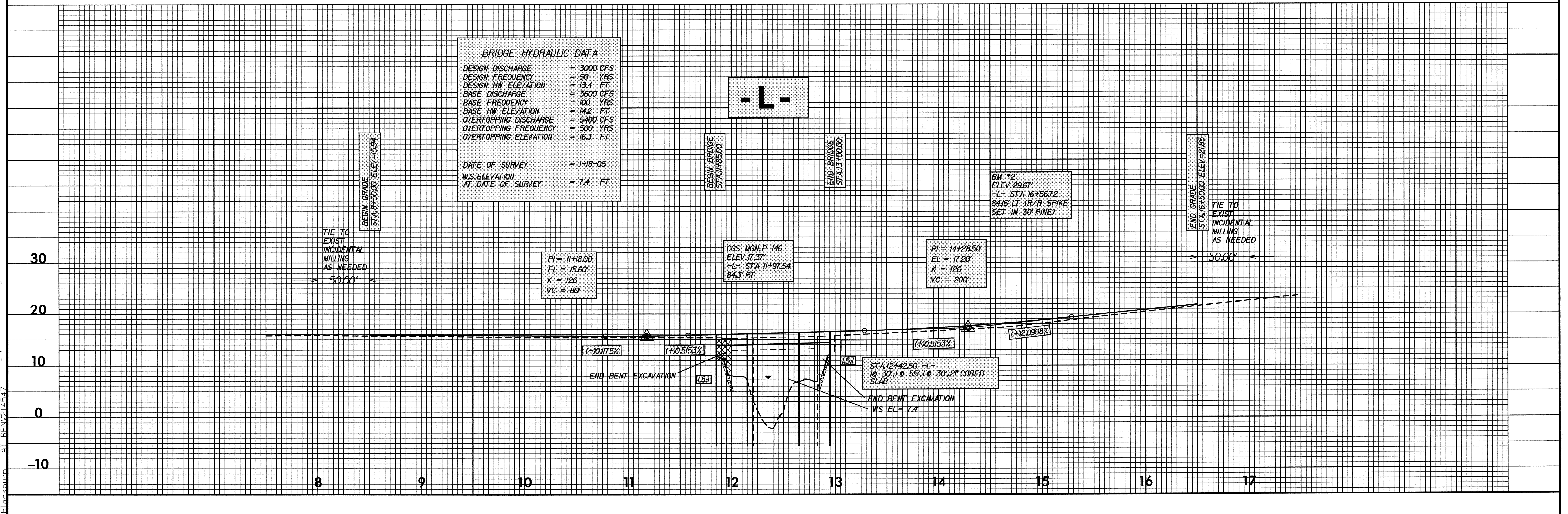

02-00T-2007 10:53
 f:\environmental\design\B-4085_rdy_psh04_040813.dgn
 B-4085.dwg

INSTALL FILTER FABRIC UNDER ENERGY DISSIPATOR PADS FOR SLOPE DRAIN IN PERMITTED WETLANDS.

Place Matting for Erosion Control on Slopes Adjacent to Permitted Wetlands as Work Allows.

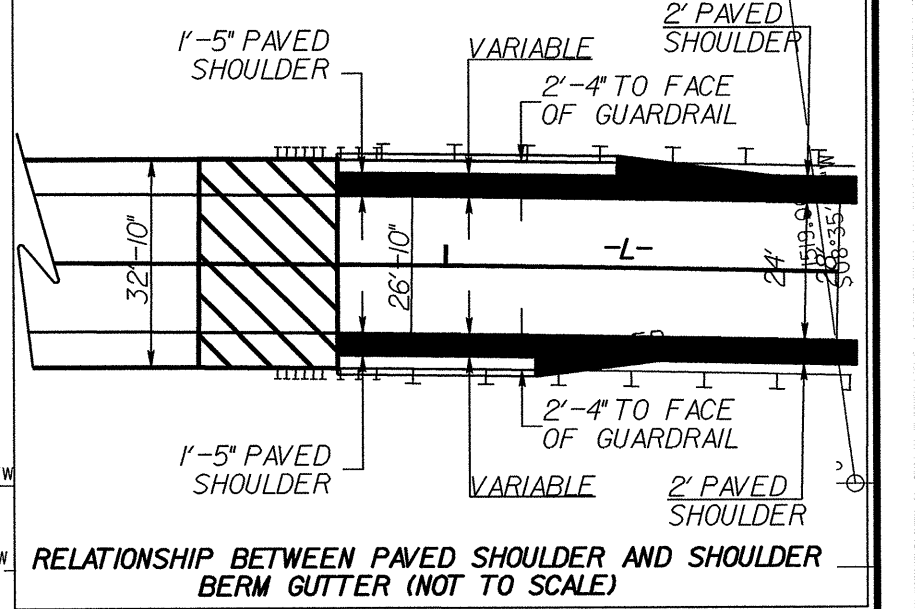

NOTE: FABRIC FOR SOIL STABILIZATION MAY BE USED FROM -L- STATION 15+30+/- TO 16+60+/- ALONG THE RIGHT SIDE TO ASSIST IN STABILIZING POTENTIALLY WEAK COHESIVE DEPOSITS. THE FABRIC SHOULD BE PLACED FROM EXISTING TOE OF FILL TO PROPOSED TOE OF FILL ALONG -L-. THE NEED FOR FABRIC FOR SOIL STABILIZATION WILL BE DETERMINED BY THE ENGINEER.

8/17/99

NOTE: NCRR R/W FOR NCRR R/W ENTRY REQUIREMENTS, SEE NCR FORM 103

NOTE: BRIDGE HAS WOOD PILING WITH STEEL GIRDERS AND WOOD WINGWALLS. NOTE: ELEVATIONS ALONG R/R HEADWALLS ARE NOT ACCURATE DUE TO IRREGULARITY AND AGE OF STRUCTURE.

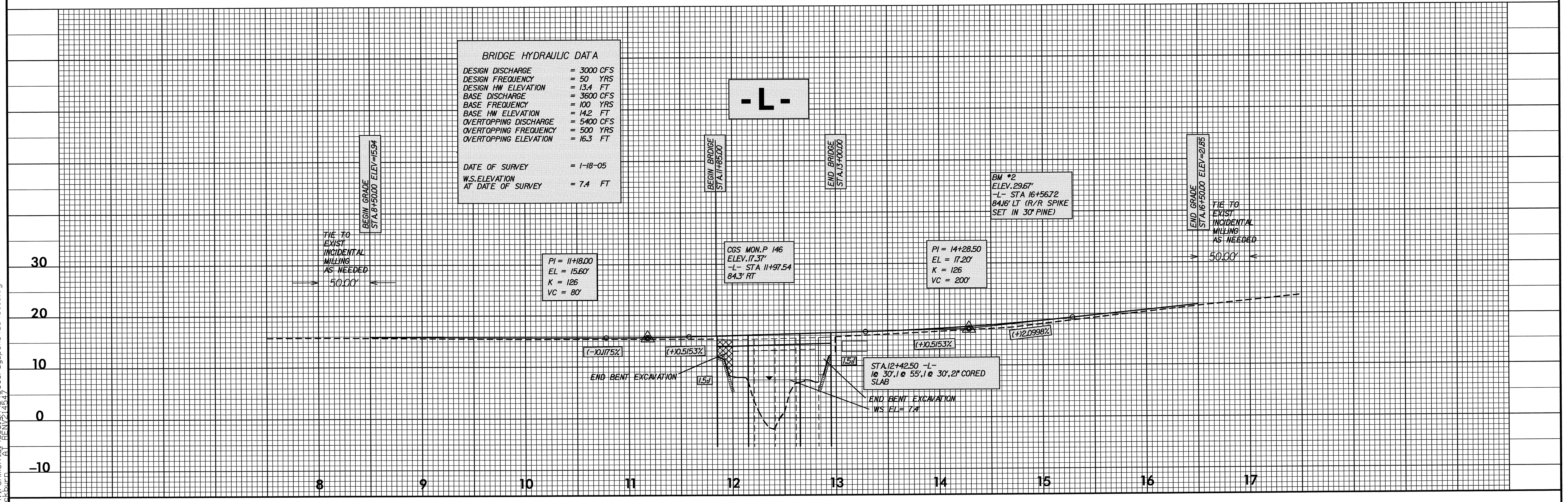

02-OCT-2007 10:53
 C:\environmental\design\4085_rdy_psh04_040813.dgn
 sbalckburn AT PENN2457