

FINAL PAVEMENT MARKING SCHEDULE

TEMP PAVEMENT MARKING SCHEDULE

SYMBOL	DESCRIPTION	PAY ITEM QUANTITY BREAKDOWN	TOTAL QUANTITY
<u>PAVEMENT MARKING LINES</u>			
<u>POLYUREA (4", 20 MILS)</u>			
VA	WHITE EDGELINE	244 LF	
VC	10' WHITE SKIP	689 LF	
VD	2' WHITE MINI SKIP	48 LF	
VE	WHITE SOLID LANE LINE	699 LF	
VI	YELLOW DOUBLE CENTER LINE	3968 LF	5648 LF
<u>POLYUREA (8", 20 MILS)</u>			
VQ	WHITE DIAGONALS	117 LF	
VT	YELLOW DIAGONALS	122 LF	239 LF
<u>POLYUREA SYMBOLS (20 MILS)</u>			
WA	LEFT TURN ARROW	3 EA	
WB	RIGHT TURN ARROW	7 EA	
WC	STRAIGHT ARROW	4 EA	14 LF
<u>POLYUREA CHARACTERS (20 MILS)</u>			
WI	ALPHA NUMERIC CHARACTER	12 EA	12 LF
<u>SNOWPLOWABLE RAISED MARKERS</u>			
ME	YELLOW/YELLOW	25 EA	
MF	CRYSTAL/RED	116 EA	141 LF

SYMBOL	DESCRIPTION	PAY ITEM QUANTITY BREAKDOWN	TOTAL QUANTITY
<u>PAVEMENT MARKING LINES</u>			
<u>PAINT (4")</u>			
PA	WHITE EDGELINE (2X)	6288 LF	
PC	10' WHITE SKIP (2X)	1377 LF	
PD	2' WHITE MINI SKIP (2X)	96 LF	
PE	WHITE SOLID LANE LINE (2X)	1398 LF	
PI	YELLOW DOUBLE CENTER LINE (2X)	13,736 LF	22,895 LF
<u>PAINT (8")</u>			
PS	WHITE DIAGONALS (2X)	234 LF	
PV	YELLOW DIAGONALS (2X)	244 LF	478 LF
<u>PAINT SYMBOLS</u>			
QA	LEFT TURN ARROW (2X)	6 EA	
QB	RIGHT TURN ARROW (2X)	14 EA	
QC	STRAIGHT ARROW (2X)	8 EA	28 EA
<u>PAINT CHARACTERS</u>			
QI	ALPHA NUMERIC CHARACTER (2X)	24 EA	24 EA
<u>TEMPORARY RAISED MARKERS</u>			
MH	YELLOW/YELLOW	86 EA	
MI	CRYSTAL/RED	116 EA	202 EA

NOTE: FOR EACH PAINT PAVEMENT MARKING ITEM, 1X IMPLIES A SINGLE APPLICATION, 2X IMPLIES TWO APPLICATIONS, AND 3X IMPLIES THREE APPLICATIONS.

30-AUG-2007 12:14 \\dot\dfsroot\01\Proj\Tipp\projects-b\4128\tr aff\trafficoontrol\top\b-4128.tc.pmp.01.dgn der\char\son AT WZTC224167

APPROVED: <i>Jessica Kuse</i> DATE: 8/31/07	PAVEMENT SCHEDULE									
	SCALE: NONE									
	DATE: 06/07									
	DWG. BY: DER									
	DESIGN BY: DER									
REVIEWED BY:		<table border="1" style="width: 100%; border-collapse: collapse;"> <tr> <th colspan="2">REVISIONS</th> </tr> <tr> <td style="width: 50%;"></td> <td style="width: 50%;"></td> </tr> <tr> <td></td> <td></td> </tr> <tr> <td></td> <td></td> </tr> </table>	REVISIONS							
REVISIONS										

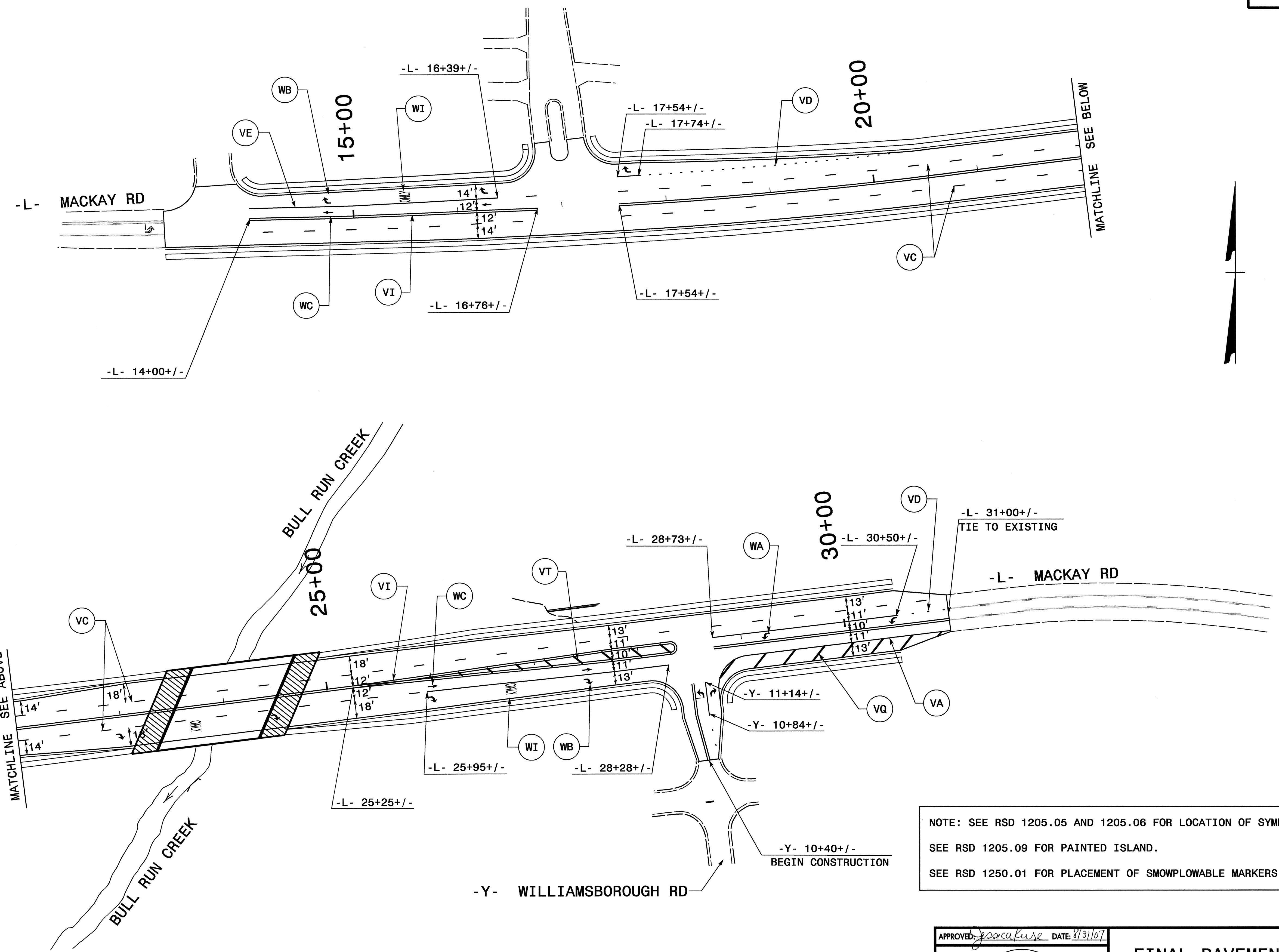

NOTE: SEE RSD 1205.05 AND 1205.06 FOR LOCATION OF SYMBOLS AND CHARACTERS.
 SEE RSD 1205.09 FOR PAINTED ISLAND.
 SEE RSD 1250.01 FOR PLACEMENT OF SNOWPLOWABLE MARKERS.

29-AUG-2007 16:23
 \\dot\dfsroot\01\Proj\p\projects-b\4128\traffic\trafficcontrol\top\4128.tc.pmp_02.dgn
 der\char\son AT WZTC224167

APPROVED: <i>Joscafuse</i> DATE: 8/31/07	FINAL PAVEMENT MARKINGS	
SCALE: NONE		REVISIONS
DATE: 06/07		
DWG. BY: DER		
DESIGN BY: DER		
REVIEWED BY:		CADD FILE