

09/08/99

See Sheet I-A For Index of Sheets
See Sheet I-B For Conventional Symbols

T.I.P. NO.	SHEET NO.
B-3852	UO-1

STATE OF NORTH CAROLINA
DIVISION OF HIGHWAYS

**UTILITIES BY OTHERS PLANS
GUILFORD COUNTY**

**LOCATION: BRIDGE NO. 449 OVER ALAMANCE CREEK AND
APPROACHES ON SR 3389 (WOODY MILL ROAD)**

TYPE OF WORK: UTILITIES

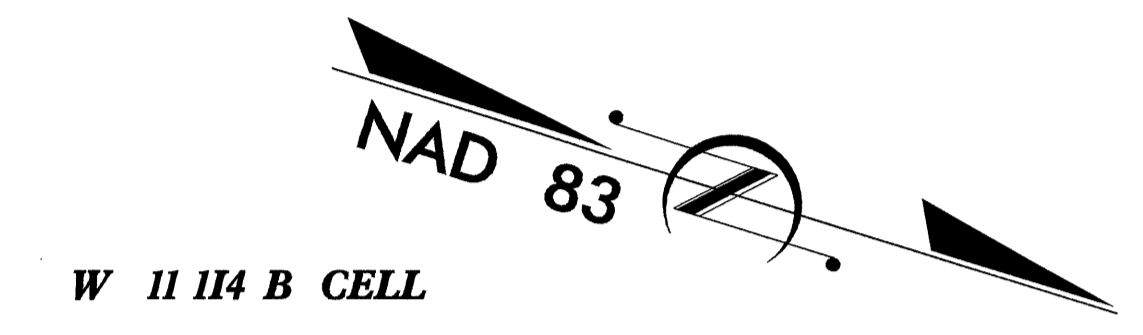
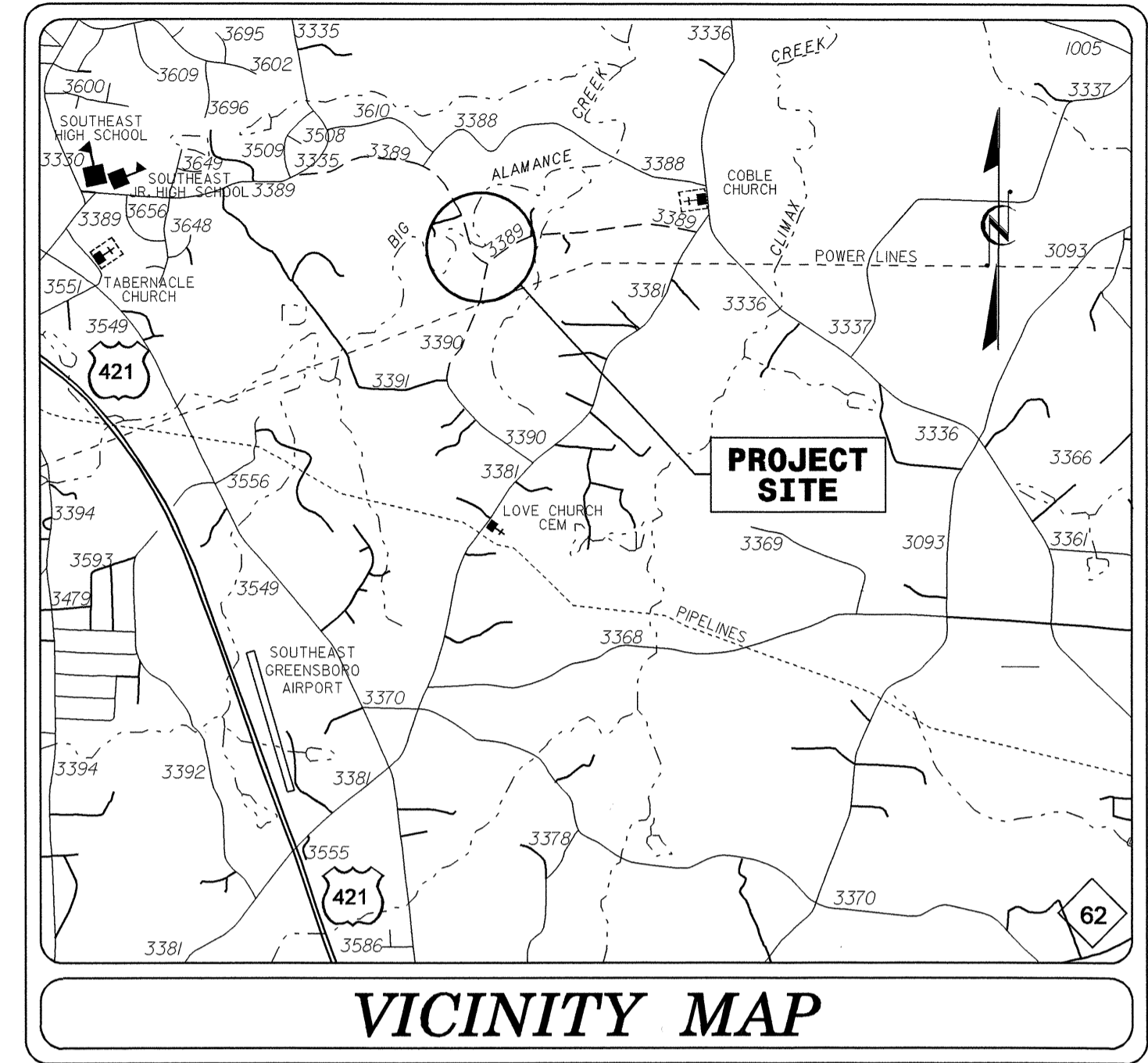

TIP B-3852

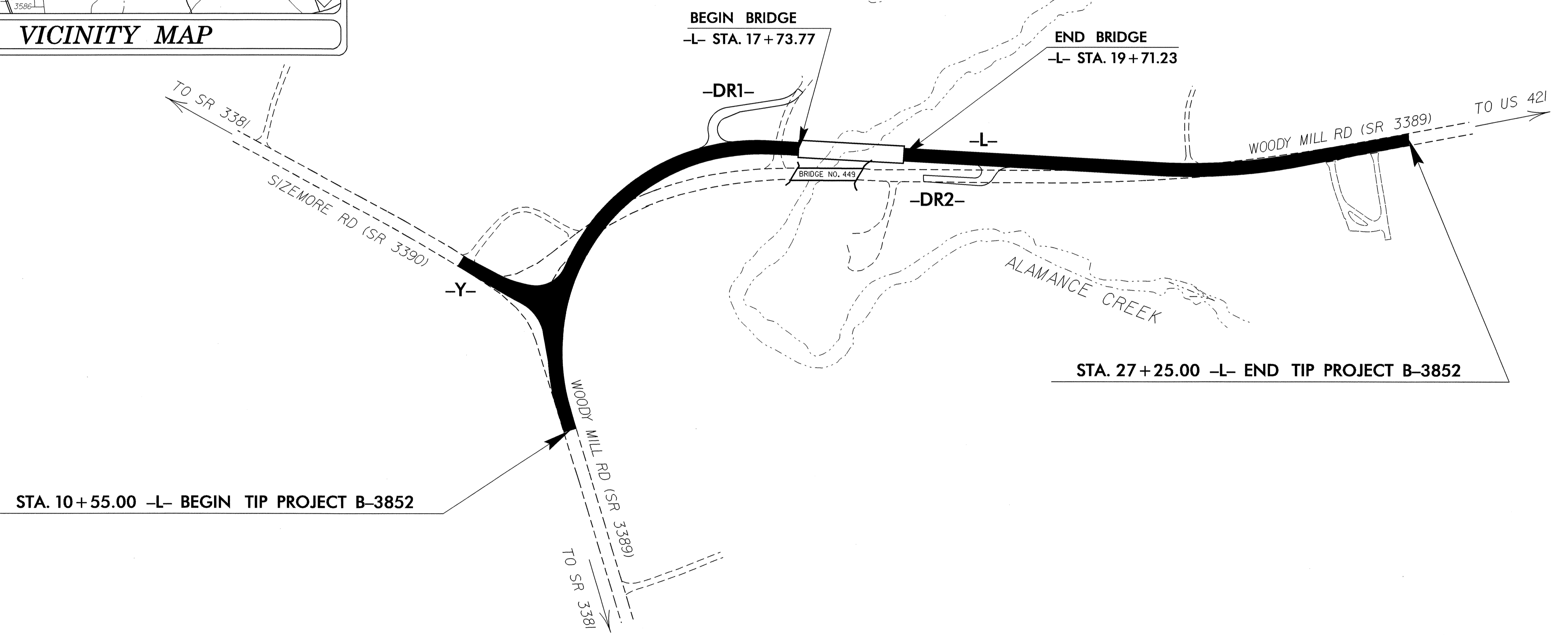

INDEX OF SHEETS	
SHEET NO.	DESCRIPTION
UO-1	TITLE SHEET
UO-2	UTILITIES BY OTHERS PLAN SHEET

UTILITY OWNERS ON PROJECT
(1) BELLSOUTH
(2) DUKE ENERGY
(3) TIME WARNER

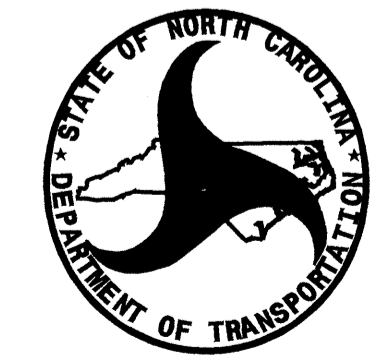

PREPARED IN THE OFFICE OF:
**DIVISION OF HIGHWAYS
DESIGN SERVICES
UTILITY SECTION**

1591 MAIL SERVICES CENTER
RALEIGH NC 27699-1591
PHONE (919) 250-4128
FAX (919) 250-4119

Roger Worthington, P.E. UTILITIES SECTION ENGINEER
Steve Mckee, P.E. UTILITIES SQUAD LEADER PROJECT ENGINEER
Alonza Yancey UTILITIES PROJECT DESIGNER

24-AUG-2007 08:44
F:\Utilities\fdy\ut\proj\b3852_ut_title_uol.psh.dgn
\$\$\$\$\$USERNAME\$\$\$\$\$

