

**STATE OF NORTH CAROLINA  
DEPARTMENT OF TRANSPORTATION**

**SIGNING PLANS  
WAKE COUNTY**

**LOCATION: BRIDGE NO. 311 OVER LAKE WHEELER (SWIFT CREEK) ON SR 1379 (PENNY ROAD)**

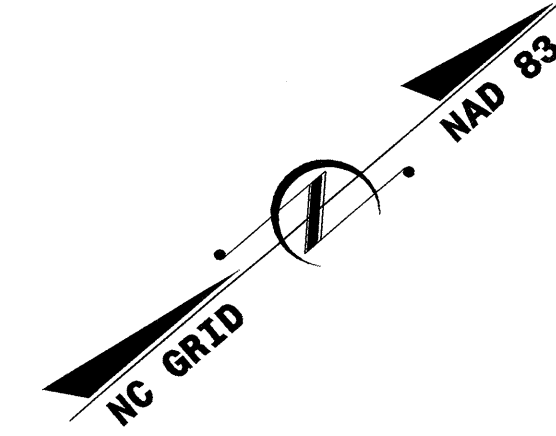

**CONTRACT NO.: C201619 T.I.P.: B-3917**

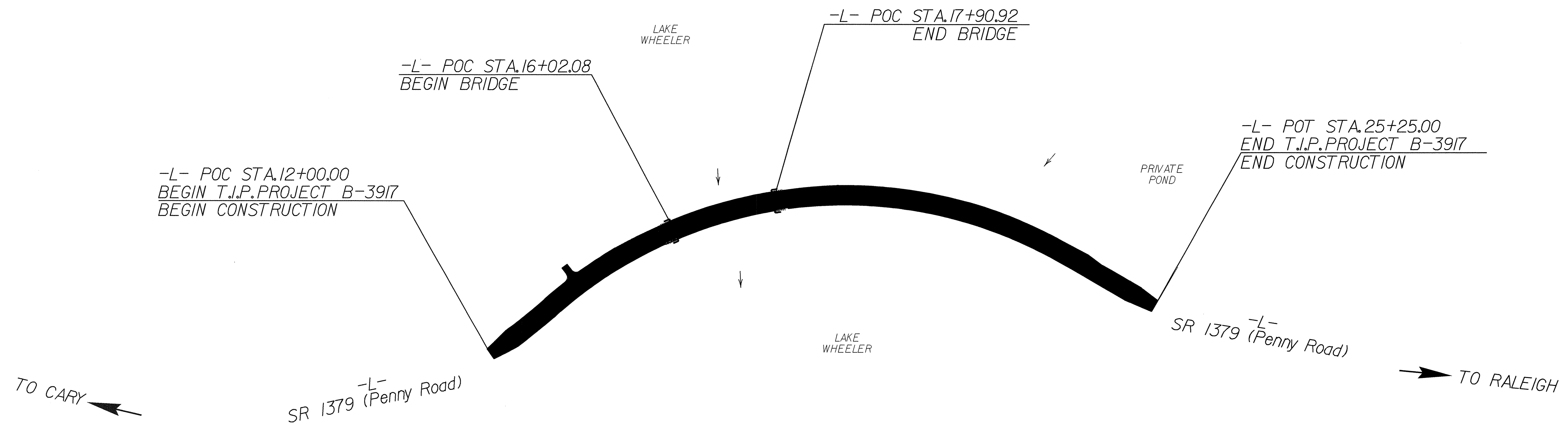

**SUMMARY OF QUANTITIES**

ITEM NO.		ITEM DESCRIPTION	QUANTITY	UNIT
DESC. NO.	SECT. NO.			
4025000000	901	CONTRACTOR FURNISHED, TYPE D SIGN	15.30	S.F.
4025000000	901	CONTRACTOR FURNISHED, TYPE E SIGN	15	S.F.
4072000000	903	SUPPORTS, 3 LB STEEL U-CHANNEL	132	L.F.
4096000000	904	SIGN ERECTION, TYPE D	2	EA.
4102000000	904	SIGN ERECTION, TYPE E	3	EA.
4116100000	904	SIGN ERECTION, RELOCATE SIGN TYPE E	2	EA.
4155000000	907	DISPOSAL OF SIGN SYSTEM, U-CHANNEL	12	EA.

**INDEX**

SHEET NO.	DESCRIPTION
1	TITLE SHEET
2	TYPE "D" SIGNS
3	TYPE "E" SIGNS
4	EXISTING/PROPOSED ROADWAY

PLAN PREPARED BY: N.C.D.O.T. SIGNING SECTION

R. W. KING, P.E. SIGNING ENGINEER

A. I. ALQUDWAH, P.E. SIGNING PROJECT ENGINEER

D. M. EATON SIGNING PROJECT DESIGN ENGINEER

R. R. HENNEIN SIGNING DESIGNER

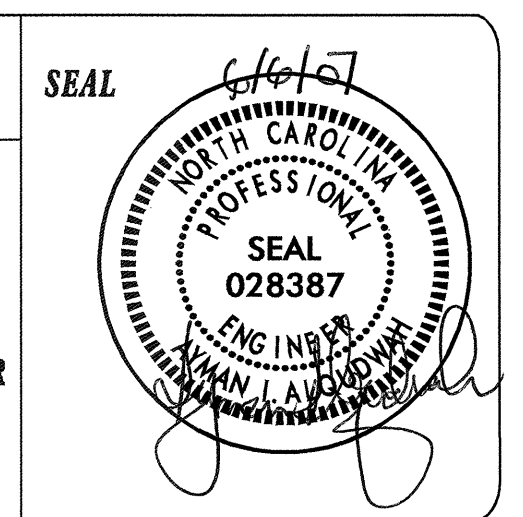

ROADWAY STANDARD DRAWINGS  
APPLICABLE TO THESE SIGNING PLANS  
904.10 904.50

<b>SIGN NUMBER:</b> 301 <b>TYPE:</b> D <b>QUANTITY:</b> 1 <b>SIGN WIDTH:</b> 42" <b>HEIGHT:</b> 18" <b>TOTAL AREA:</b> 5.3 Sq.Ft. <b>BORDER TYPE:</b> FLUSH <b>RECESS:</b> 0" <b>WIDTH:</b> 0.5" <b>RADII:</b> 3" <b>NO. Z BARS:</b> <b>LENGTH:</b>	<b>BACKG COLOR:</b> Green <b>COPY COLOR:</b> White <table border="1"> <tr> <th>SYMBOL</th> <th>X</th> <th>Y</th> <th>WID</th> <th>HT</th> </tr> <tr><td> </td><td> </td><td> </td><td> </td><td> </td></tr> <tr><td> </td><td> </td><td> </td><td> </td><td> </td></tr> <tr><td> </td><td> </td><td> </td><td> </td><td> </td></tr> <tr><td> </td><td> </td><td> </td><td> </td><td> </td></tr> <tr><td> </td><td> </td><td> </td><td> </td><td> </td></tr> <tr><td> </td><td> </td><td> </td><td> </td><td> </td></tr> <tr><td> </td><td> </td><td> </td><td> </td><td> </td></tr> </table>	SYMBOL	X	Y	WID	HT																																				<b>DESIGN BY:</b> R. HENNEIN <b>PROJECT ID:</b> B-3917 <b>CHECKED BY:</b> <b>DIV:</b> 5 <b>DATE:</b> May 21, 2007
SYMBOL	X	Y	WID	HT																																						

**BORDER**  
R=3"  
TH=0.5"

Spacing Factor is 1 unless specified otherwise

LETTER POSITIONS

Letter spacings are to start of next letter														Series/Size	Text Length	
S	W	I	F	T	C	R	E	E	K					C 2000	29.6	
6.2	2.6	3.6	1.4	2.3	2	4	3	2.9	2.7	2.7	2.2	6.2		C 2000	31.5	
F	I	R	E	D	I	S	T	R	I	C	T			D 2000	10.9	
5.2	2.6	1.4	2.9	2	4	3	1.2	2.6	2.6	2.9	1.4	2.7	2	5.2		
D	I	A	L	9	1	1										
15.6	1.8	0.6	2	1.2	2	1.8	0.9	0.5	15.6							

FILENAME: 9P07130\_watermill.rtd NORTH CAROLINA D.O.T. SIGN DETAIL

<b>SIGN NUMBER:</b> 302 <b>TYPE:</b> D <b>QUANTITY:</b> 1 <b>SIGN WIDTH:</b> 60" <b>HEIGHT:</b> 24" <b>TOTAL AREA:</b> 10.0 Sq.Ft. <b>BORDER TYPE:</b> FLUSH <b>RECESS:</b> 0" <b>WIDTH:</b> 0.5" <b>RADII:</b> 3" <b>NO. Z BARS:</b> <b>LENGTH:</b>	<b>BACKG COLOR:</b> Green <b>COPY COLOR:</b> White <table border="1"> <tr> <th>SYMBOL</th> <th>X</th> <th>Y</th> <th>WID</th> <th>HT</th> </tr> <tr><td> </td><td> </td><td> </td><td> </td><td> </td></tr> <tr><td> </td><td> </td><td> </td><td> </td><td> </td></tr> <tr><td> </td><td> </td><td> </td><td> </td><td> </td></tr> <tr><td> </td><td> </td><td> </td><td> </td><td> </td></tr> <tr><td> </td><td> </td><td> </td><td> </td><td> </td></tr> <tr><td> </td><td> </td><td> </td><td> </td><td> </td></tr> <tr><td> </td><td> </td><td> </td><td> </td><td> </td></tr> </table>	SYMBOL	X	Y	WID	HT																																				<b>DESIGN BY:</b> R. HENNEIN <b>PROJECT ID:</b> B-3917 <b>CHECKED BY:</b> <b>DIV:</b> 5 <b>DATE:</b> May 22, 2007
SYMBOL	X	Y	WID	HT																																						

**BORDER**  
R=3"  
TH=0.5"

Spacing Factor is 1 unless specified otherwise

LETTER POSITIONS

Letter spacings are to start of next letter														Series/Size	Text Length						
T	E	N	-	T	E	N								C 2000	17.3						
21.3	2.6	2.7	2.8	1.6	2.6	2.7	2.2	21.3						C 2000	31.5						
F	I	R	E	D	I	S	T	R	I	C	T			C 2000	46.9						
14.2	2.6	1.4	2.9	2	4	3	1.2	2.6	2.6	2.9	1.4	2.7	2	14.2	D 2000	10.9					
F	A	I	R	V	I	E	W	F	I	R	E	D	E	P	T						
6.6	2.3	3.1	1.4	2.6	3	1.4	2.4	3	4	2.6	1.4	2.9	2	4	3	2.7	2.7	2	6.6		
D	I	A	L	9	1	1															
24.6	1.8	0.6	2	1.2	2	1.8	0.9	0.5	24.6												

FILENAME: signdes.gns NORTH CAROLINA D.O.T. SIGN DETAIL

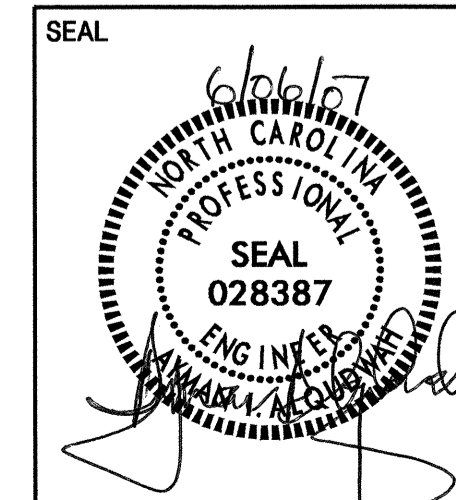

<b>TYPE "D" SIGNS</b>			
SCALE	1:1000	N. C. DEPARTMENT OF TRANSPORTATION DIVISION OF HIGHWAYS TRAFFIC ENGINEERING BRANCH	REVISIONS
DATE	JUNE 2007		
SIGNING TECHNICIAN	R. HENNEIN		
SIGNING PROJECT DGN ENG	M. EATON		
SIGNING PROJECT ENG	A. ALQUDWAH		

403 QUANTITY REQ'D 1

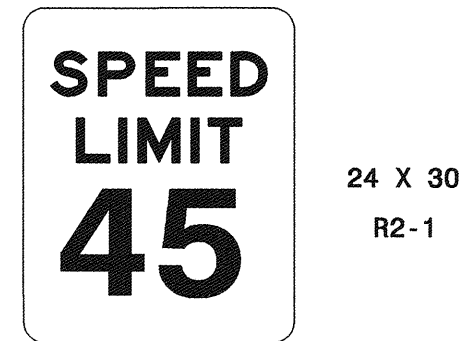

ONE "U" POST PER SIGN

464 QUANTITY REQ'D 2

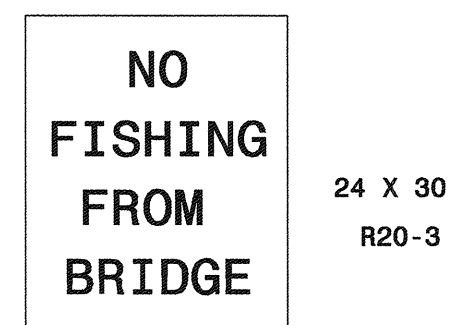

ONE "U" POST PER SIGN

NOTE: THIS DRAWING IS DIMENSIONED  
IN INCHES UNLESS OTHERWISE  
DEPICTED WITHIN THE DRAWING.

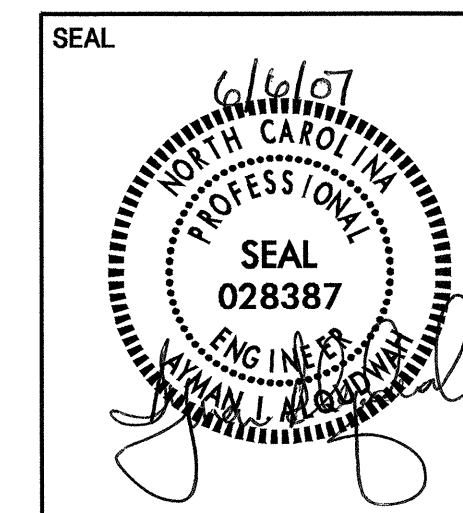

**TYPE "E" SIGNS**

SCALE	1:1000	N. C. DEPARTMENT OF TRANSPORTATION DIVISION OF HIGHWAYS TRAFFIC ENGINEERING BRANCH	REVISIONS	
DATE	JUNE 2007			
SIGNING TECHNICIAN	R. HENNEIN			
SIGNING PROJECT DGN ENG	M. EATON			
SIGNING PROJECT ENG	A. ALQUDWAH			

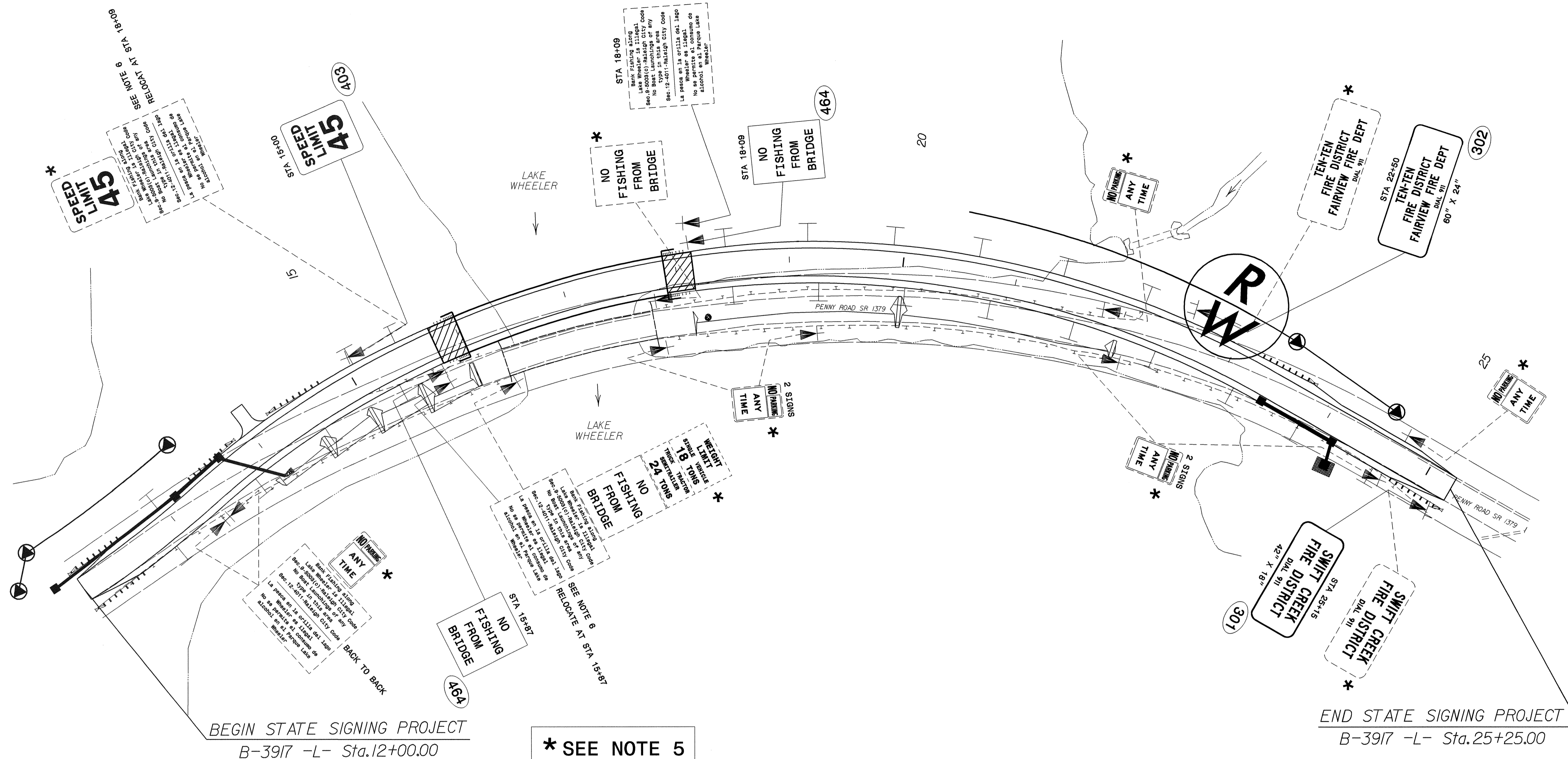

BEGIN STATE SIGNING PROJECT  
B-3917 -L- Sta.12+00.00

END STATE SIGNING PROJECT  
B-3917 -L- Sta.25+25.00

\* SEE NOTE 5

**WARNING SIGNS PLACEMENT CHART**

POSTED OR 85TH PERCENTILE SPEED MPH (KMH)	MUTCD DISTANCE FT (M)	SUGGESTED LOCATION FT (M)	SUGGESTED MAXIMUM FT (M)
30 (50)	450 (140)	475 (145)	575 (175)
35 (55)	550 (170)	575 (175)	675 (205)
40 (65)	650 (200)	675 (205)	775 (235)
45 (70)	750 (230)	775 (235)	875 (270)
50 (80)	850 (260)	875 (270)	975 (300)
55 (90)	950 (290)	975 (300)	1075 (330)
60 (95)	1100 (335)	1125 (345)	1225 (375)
65 (105)	1200 (365)	1225 (375)	1325 (405)
70 (115)	1250 (380)	1275 (390)	1375 (420)

1. SEE ROADWAY STANDARD NO. 904.50 FOR MOUNTING OF TYPE 'D', 'E', AND 'F' SIGNS ON 'U' CHANNEL POSTS.
2. SEE CHART FOR PLACEMENT OF WARNING SIGNS. DISTANCES SHOWN IN MINIMUM ROAD COLUMNS ARE FOR LEVEL ROADWAYS. MAKE CORRECTIONS FOR GRADES. IF 48-INCH (1219 MM) SIGNS ARE USED, THE LEGIBILITY DISTANCE MAY BE INCREASED TO 200 FEET (61 M). THIS WOULD ALLOW REDUCING THE CHART SPECIFIED DISTANCE BY 75 FEET (23 M).
3. IF THE BRIDGE IS OVER A MAJOR STREAM OR RIVER, A SIGN FOR THE NAME OF THE STREAM OR RIVER SHOULD BE INSTALLED AT EACH APPROACH. THESE DESIGNS WILL BE COMPLETED BY THE SIGNING SECTION UPON REQUEST.
4. SIGNS FURNISHED BY CONTRACTOR. BACKGROUND SHEETING SHALL BE TYPE III REFLECTIVE SHEETING.
5. DISPOSAL OF SIGN SYSTEM, U-CHANNEL.
6. SIGN ERECTION, RELOCATE SIGN TYPE D, E, OR F.
7. DISPOSAL OF SIGN SYSTEM, WOOD.
8. DISPOSAL OF SIGN, D, E, OR F.
9. DISPOSAL OF SUPPORT, U-CHANNEL.

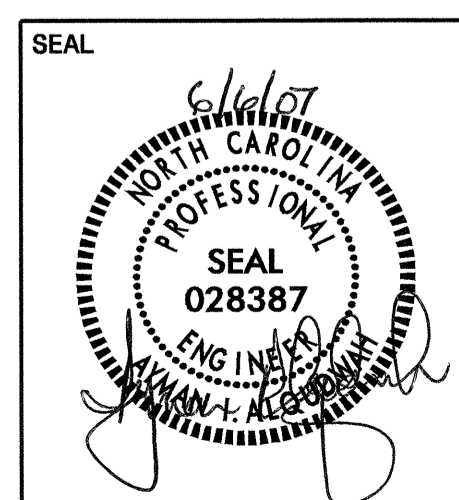

**EXISTING/PROPOSED ROADWAY**  
**SR 1379**  
**STA 12+00 TO 26+00**

SCALE	1:1000	N. C. DEPARTMENT OF TRANSPORTATION DIVISION OF HIGHWAYS TRAFFIC ENGINEERING BRANCH	REVISIONS
DATE	JUNE 2007		
SIGNING TECHNICIAN	R. HENNEIN		
SIGNING PROJECT DGN ENG	M. EATON		
SIGNING PROJECT ENG	A. ALQUDWAH		