

See Sheet 1-A For Index of Sheets
See Sheet 1-B For Conventional Symbols

T.I.P. NO.	SHEET NO.
B-3337	UC-1

STATE OF NORTH CAROLINA DIVISION OF HIGHWAYS

UTILITY CONSTRUCTION PLANS GUILFORD COUNTY

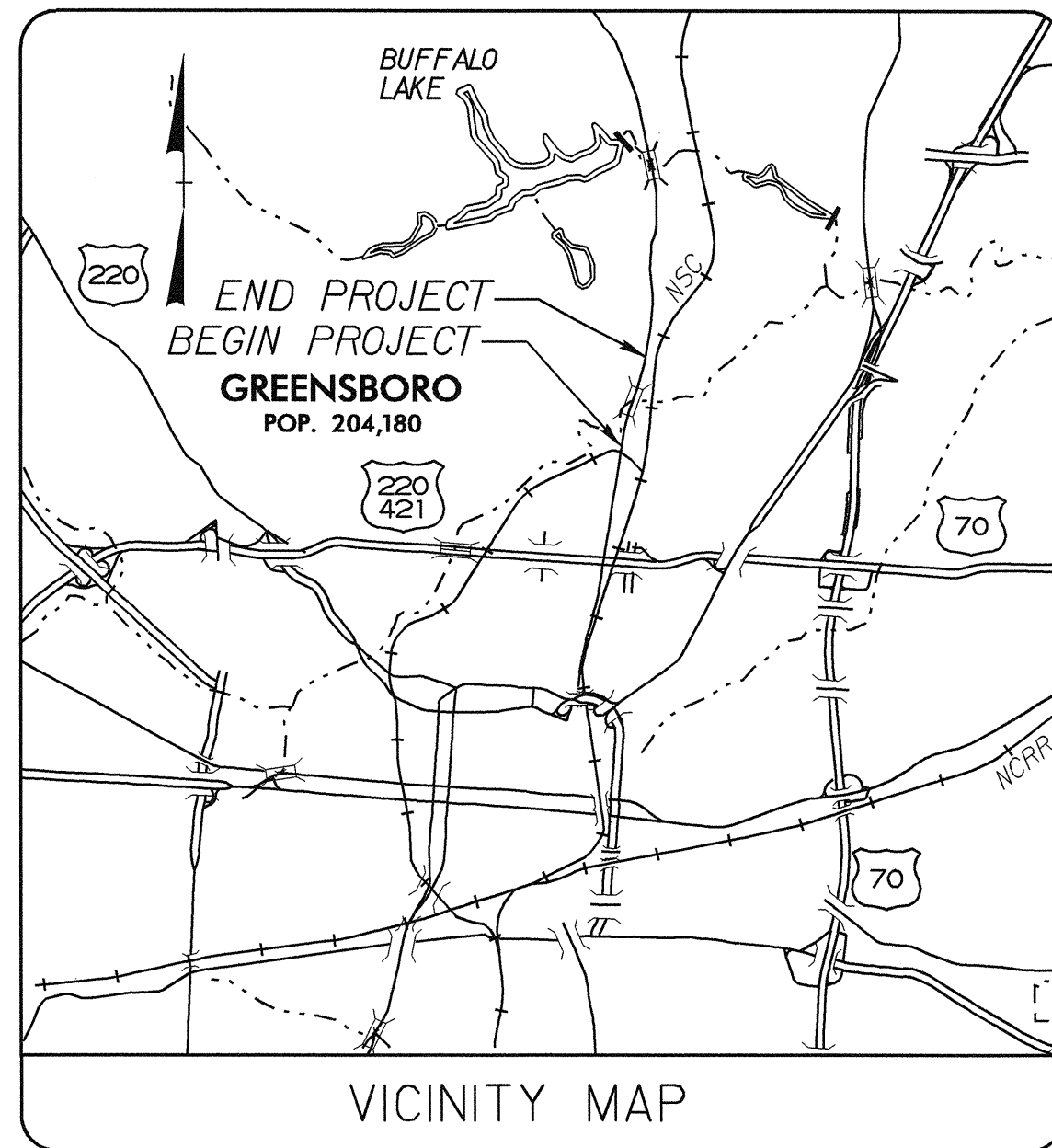

90% PLANS SUBMITTAL

**LOCATION: BRIDGE NO. 527 OVER NORTH BUFFALO
CREEK ON SR 1001 (CHURCH STREET)**

TYPE OF WORK: UTILITIES

TIP B-3337

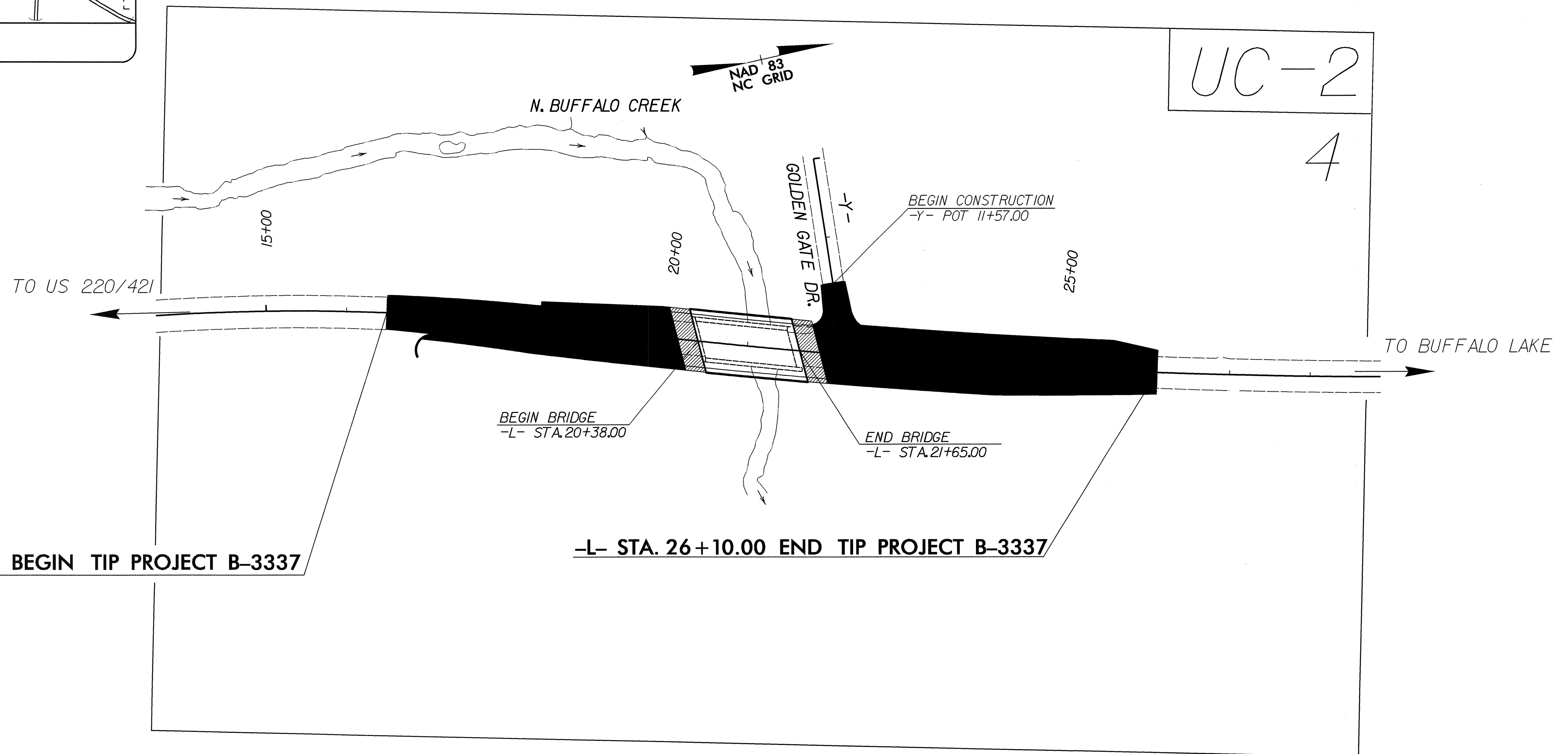

-L- STA 16+50.00 BEGIN TIP PROJECT B-3337

-L- STA. 26+10.00 END TIP PROJECT B-3337

INDEX OF SHEETS	
SHEET NO.	DESCRIPTION
UC-1	TITLE SHEET
UC-2	UTILITY CONSTRUCTION PLAN SHEETS

WATER AND SEWER OWNERS ON PROJECT
(1) CITY OF GREENSBORO (WATER & SEWER)

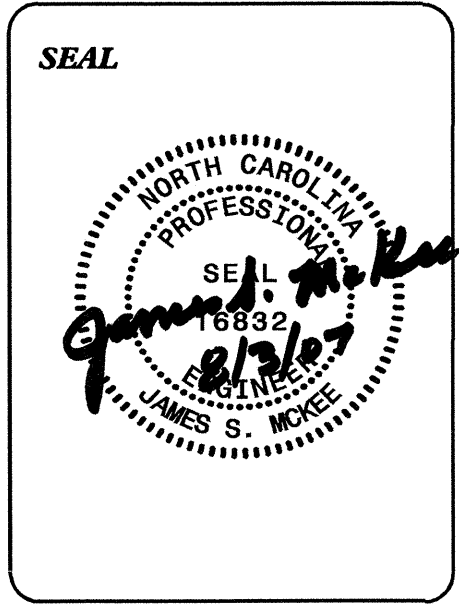

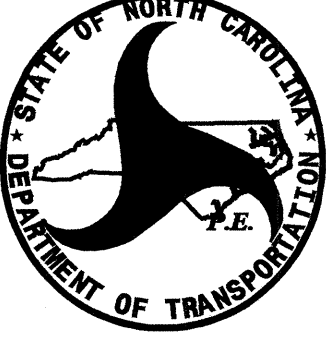

 PREPARED IN THE OFFICE OF:
DIVISION OF HIGHWAYS
PROJECT SERVICES
UTILITY SECTION
 1591 MAIL SERVICES CENTER
 RALEIGH NC 27699-1591
 PHONE (919) 250-4128
 FAX (919) 250-4119

Roger Worthington, P.E. UTILITIES SECTION ENGINEER
Steve Mckee, P.E. UTILITIES SQUAD LEADER PROJECT ENGINEER
Alonza Yancey UTILITIES PROJECT DESIGNER

03-AUG-2007 10:00
r:\utilities\rdy\proj\of_b3337_ut_title_uc1_psh.dgn
r:\utilities\rdy\proj\of_b3337_ut_title_uc1_psh.dgn



NOTE: PIPE FOR RELOCATING FIRE HYDRANT SHALL BE 6" DUCTILE IRON, PC 350

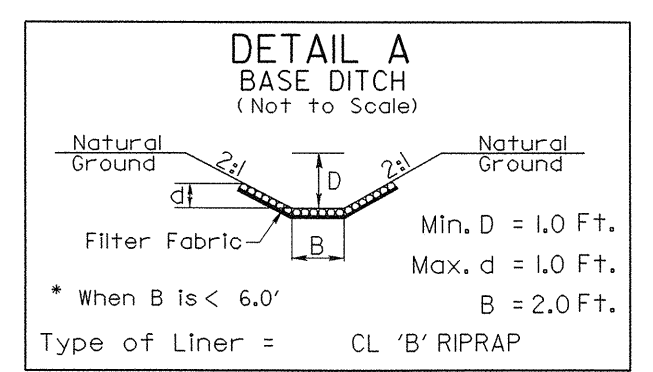

NAD 83 NC GRID

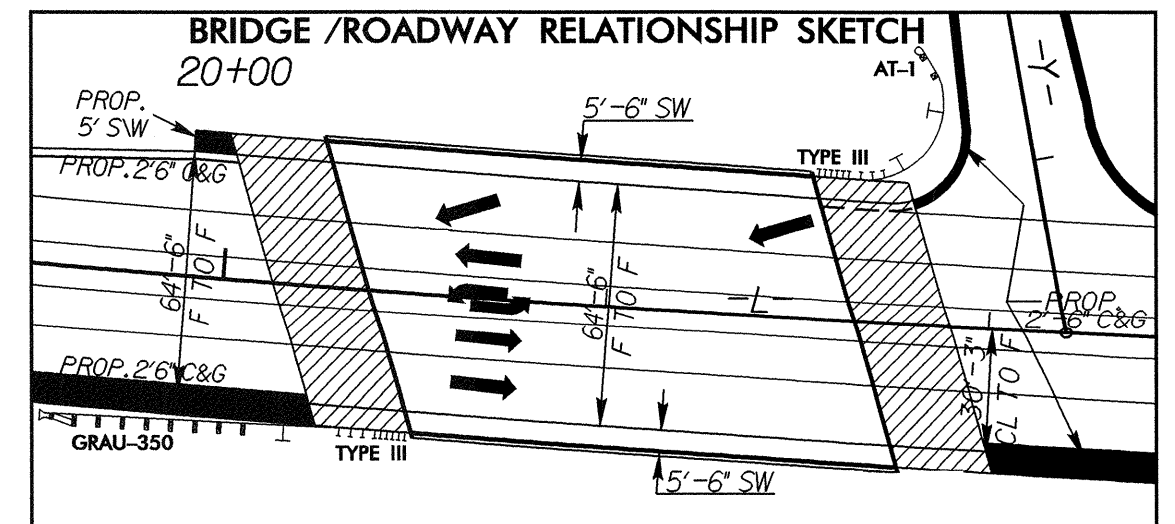
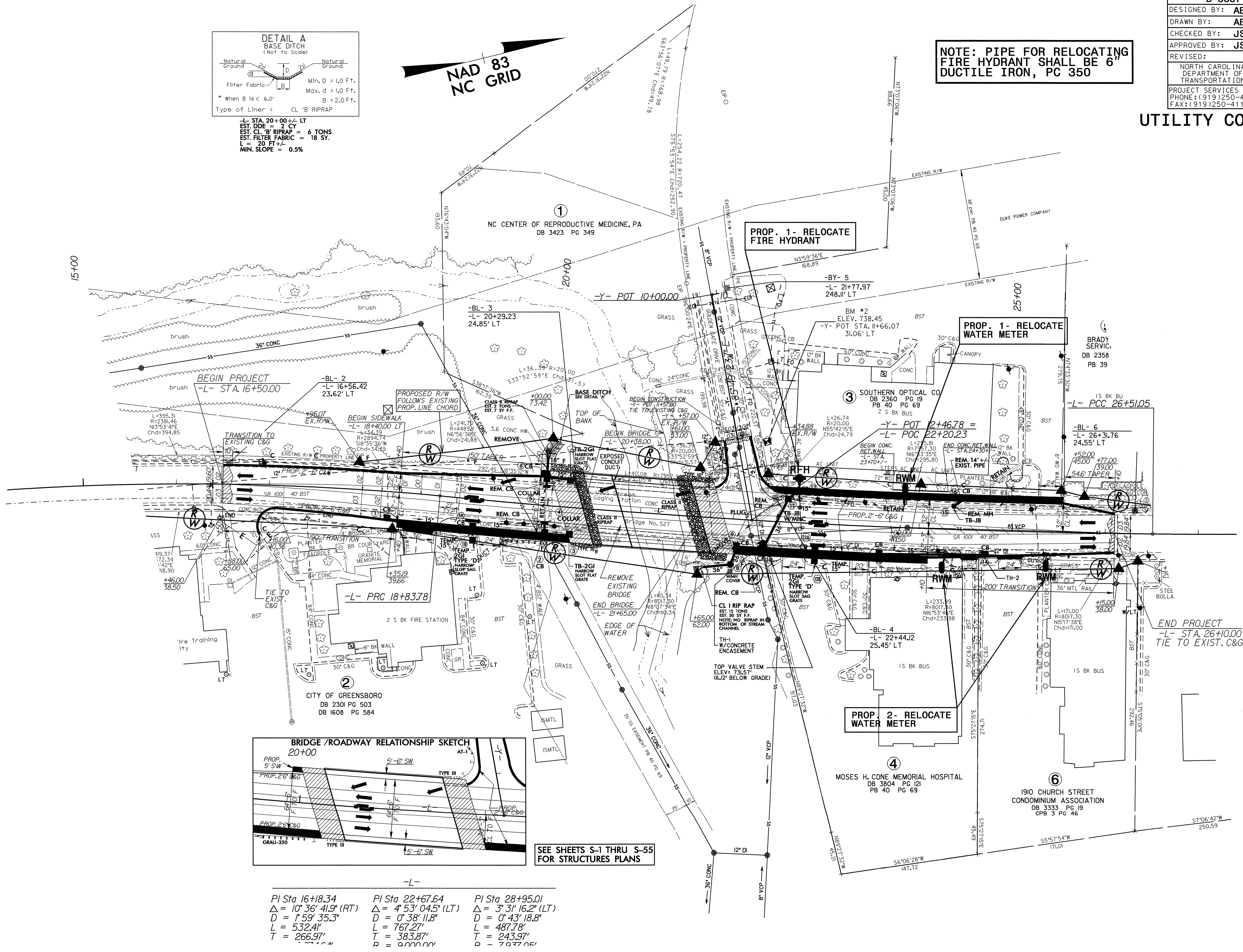

-L-	-L-	-L-
PI Sta 16+18.34	PI Sta 22+67.64	PI Sta 28+95.01
$\Delta = 10' 36' 41.9'$ (RT)	$\Delta = 4' 53' 04.5'$ (LT)	$\Delta = 3' 31' 16.2'$ (LT)
D = 1' 59' 35.3"	D = 0' 38' 11.8"	D = 0' 43' 18.8"
L = 532.41'	L = 767.27'	L = 487.78'
T = 266.97'	T = 383.87'	T = 243.97'
R = 0.00000	R = 0.00000	R = 7.63705'

5/14/99
 20-AUG-2007 11:27
 vrdy:\ut\20-AUG-2007 11:27\rdy_sht4_uc(utl const shtuc-2)_psh.dgn

5/14/99

PROJECT REFERENCE NO.	SHEET NO.
B-3337	UC-3
DESIGNED BY: ABY	
DRAWN BY: ABY	
CHECKED BY: JSM	
APPROVED BY: JSM	
REVISED:	
NORTH CAROLINA DEPARTMENT OF TRANSPORTATION PROJECT SERVICES UNIT PHONE: (919) 250-4128 FAX: (919) 250-4119	

UTILITY CONSTRUCTION

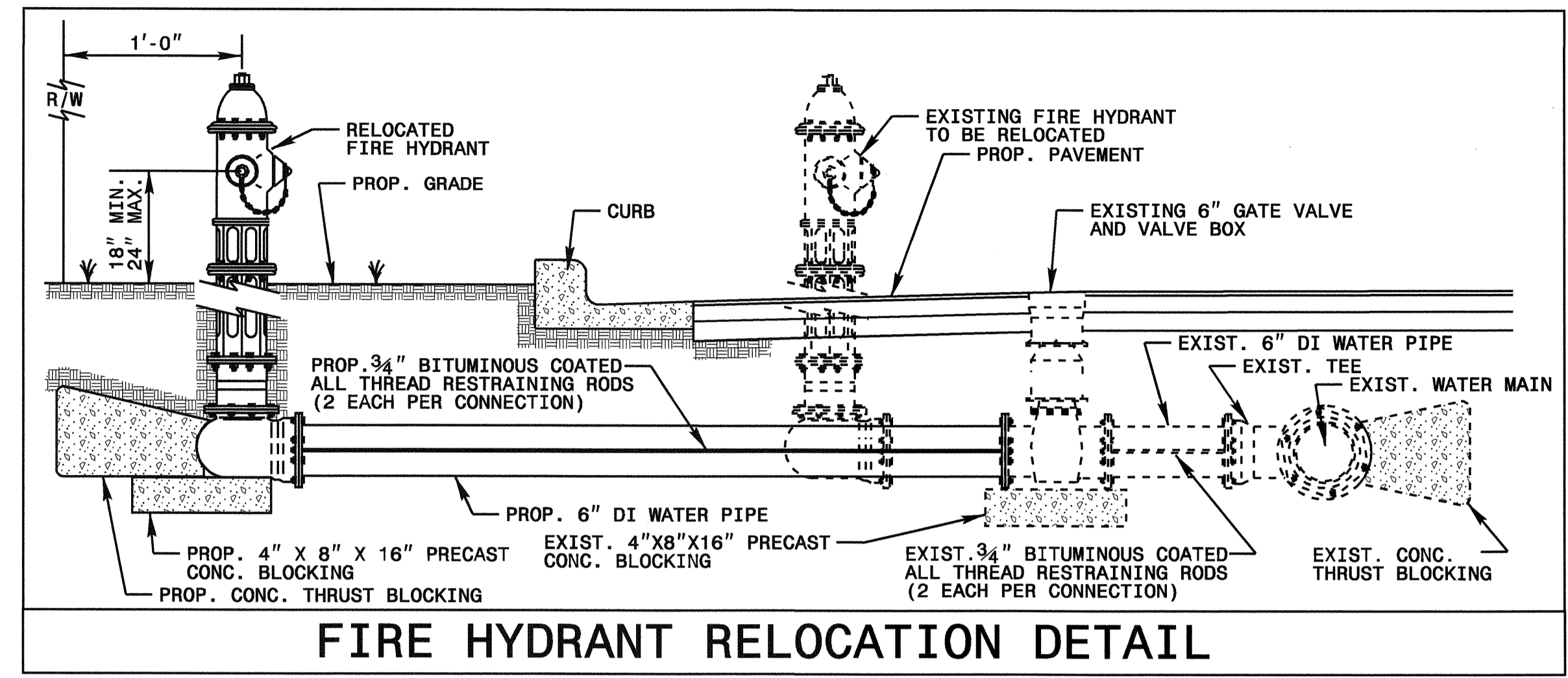

MAXIMUM TRENCH WIDTH AT TOP OF PIPE

NOMINAL PIPE SIZE (INCHES)	TRENCH WIDTH (INCHES)	NOMINAL PIPE SIZE (INCHES)	TRENCH WIDTH (INCHES)
4	28	20	44
6	30	24	48
8	32	30	54
10	34	36	60
12	36	42	66
14	38	48	72
16	40	54	78
18	42		

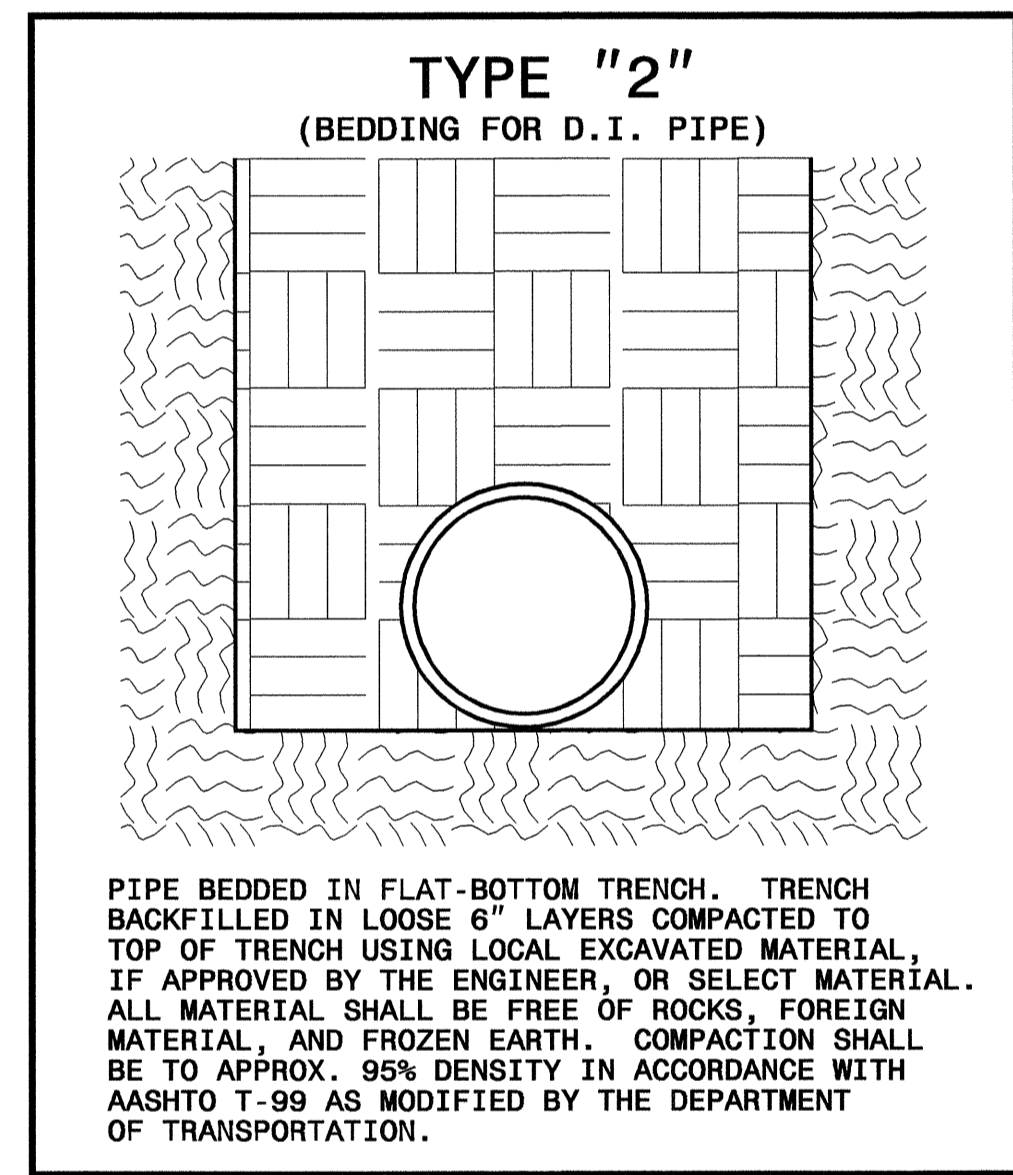
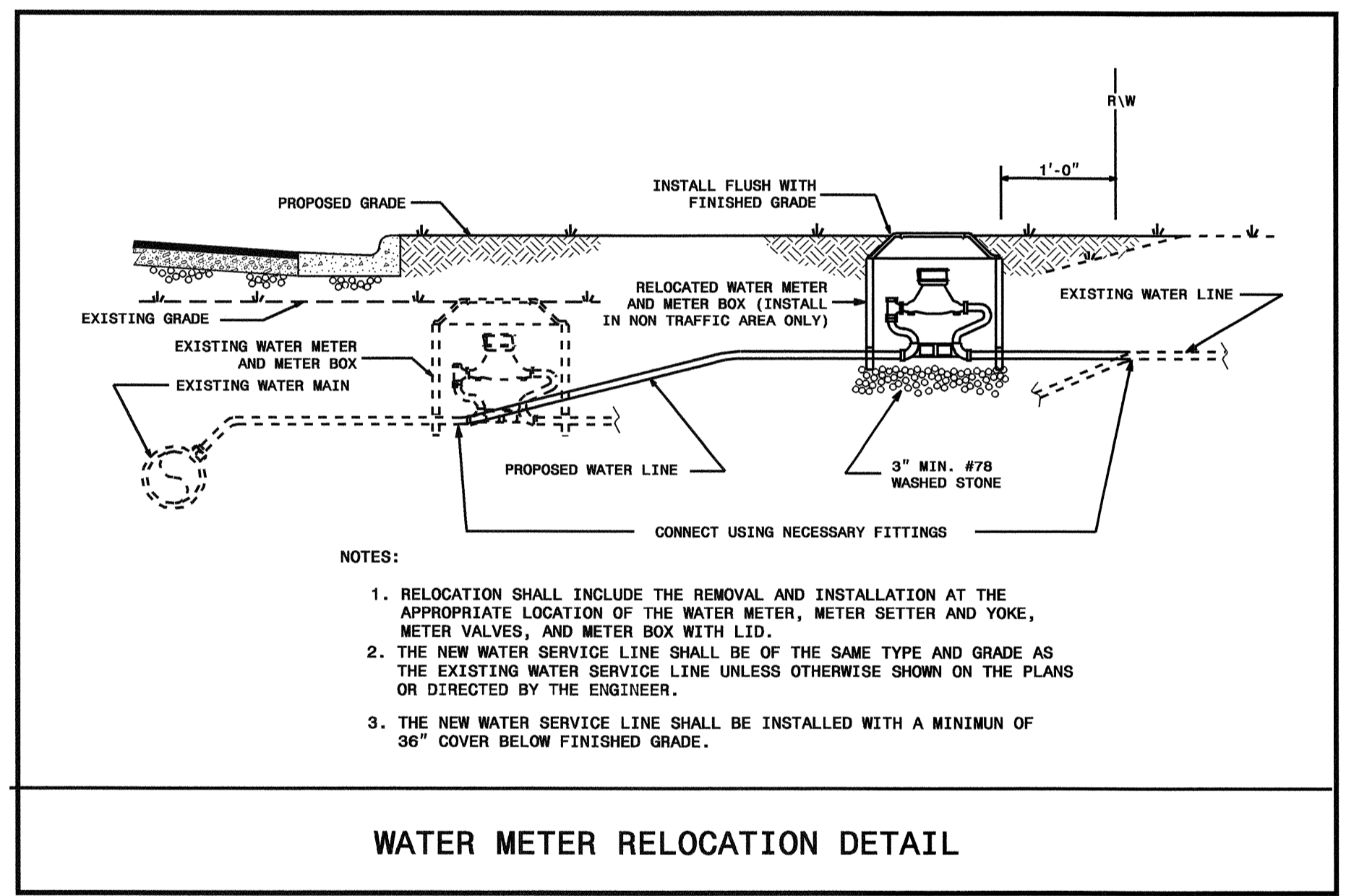

03-AUG-2007 09:58
 r-dy-ut-uc-proj-b3337-ut-(rdy sht4)_uc(utl const shtuc-2)-psh.dgn
 \$\$\$\$

See Sheet 1-A For Index of Sheets
See Sheet 1-B For Conventional Symbols

T.I.P. NO.	SHEET NO.
B-3337	UO-1

STATE OF NORTH CAROLINA
DIVISION OF HIGHWAYS

**UTILITY BY OTHERS PLANS
GUILFORD COUNTY**

**LOCATION: BRIDGE NO. 527 OVER NORTH BUFFALO
CREEK ON SR 1001 (CHURCH STREET)**

TYPE OF WORK: UTILITIES

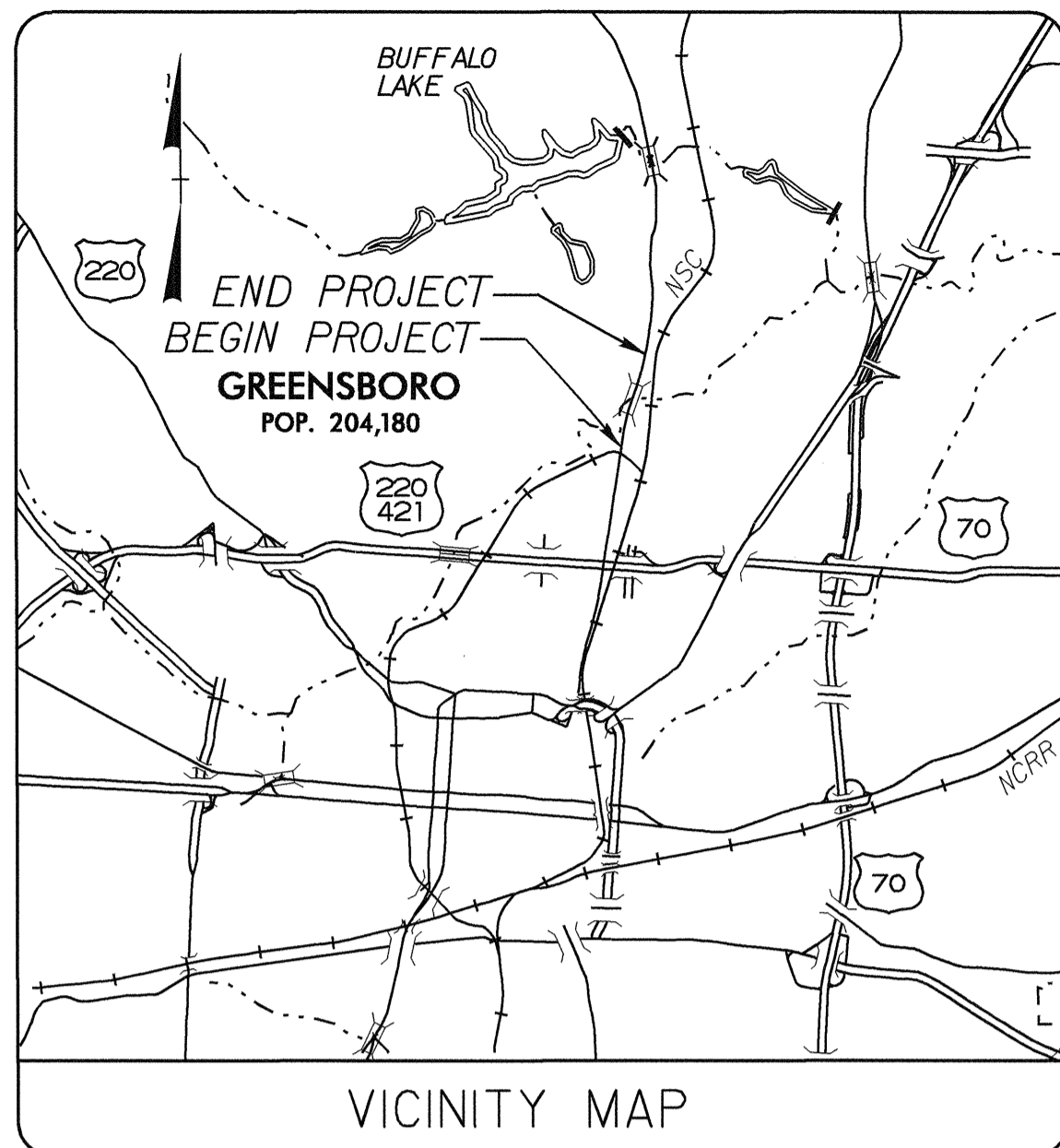

TIP B-3337

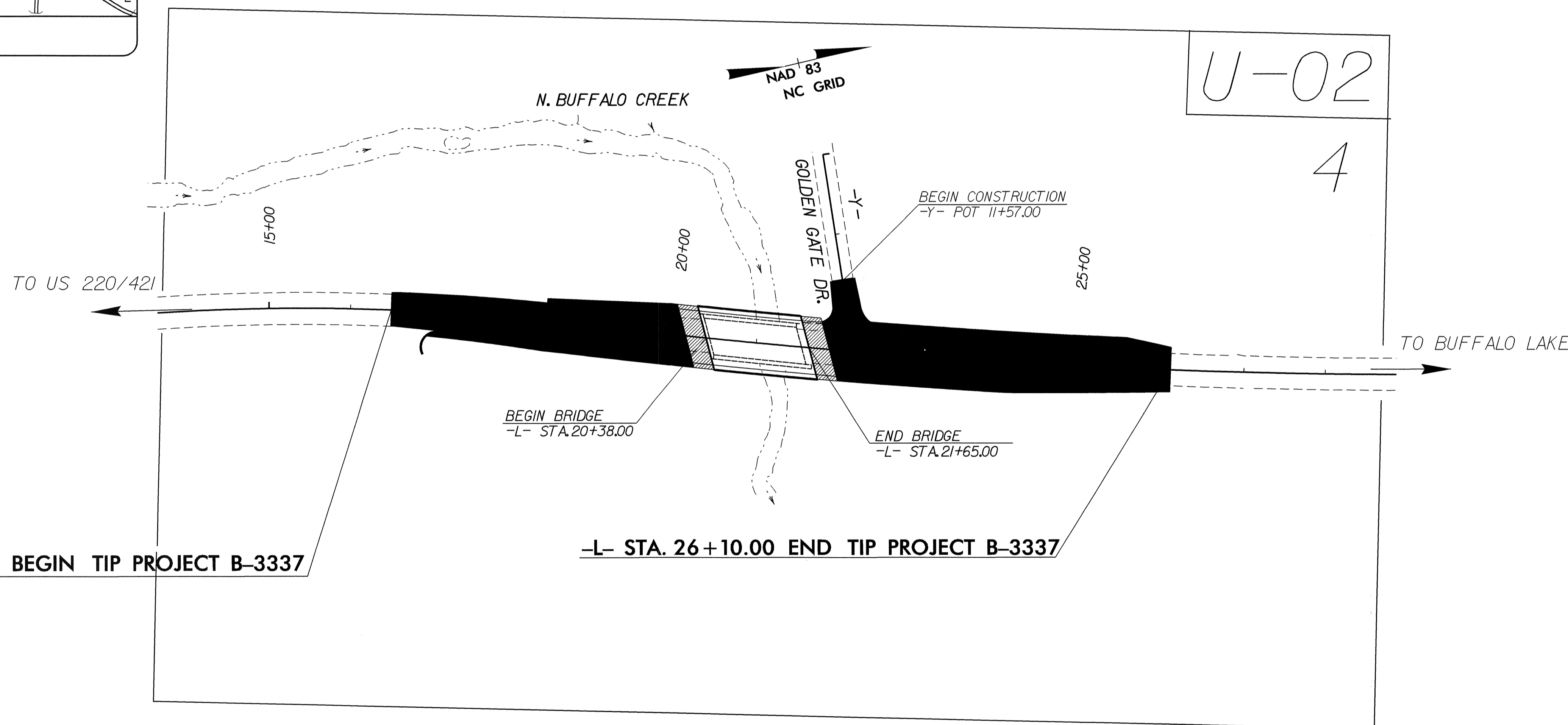

INDEX OF SHEETS	
SHEET NO.	DESCRIPTION
UO-1	TITLE SHEET
UO-2	UTILITY BY OTHERS PLAN SHEETS

UTILITY OWNERS ON PROJECT
(1) DUKE ENERGY
(2) BELL SOUTH
(3) TIME WARNER
(4) PIEDMONT NATURAL GAS
(5) CITY OF GREENSBORO (54" SEWER LINE)

PREPARED IN THE OFFICE OF:
**DIVISION OF HIGHWAYS
DESIGN SERVICES
UTILITY SECTION**

1591 MAIL SERVICES CENTER
RALEIGH NC 27699-1591
PHONE (919) 250-4128
FAX (919) 250-4119

<u>Roger Worthington, P.E.</u>	UTILITIES SECTION ENGINEER
<u>Steve Mckee, P.E.</u>	UTILITIES SQUAD LEADER PROJECT ENGINEER
<u>Alonza Yancey</u>	UTILITIES PROJECT DESIGNER

03-AUG-2007 12:33
F:\utilities\yrdy_ut\proj\b3337_ut_title_uo1_psh.dgn
\$\$\$\$\$USERNAME\$\$\$\$\$

UTILITIES BY OTHERS

NOTE:
ALL PROPOSED UTILITY WORK
SHOWN ON THIS SHEET WILL
BE DONE BY OTHERS

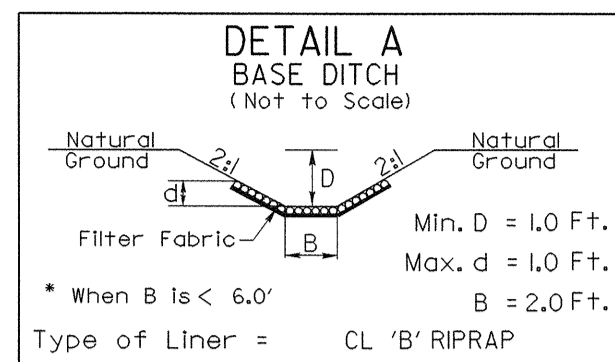

-L- STA. 20+00 +/- LT
EST. DDE = 2 CY
EST. CL 'B' RIPRAP = 6 TONS
EST. FILTER FABRIC = 18 SY.
L = 20 FT +/-
MIN. SLOPE = 0.5%

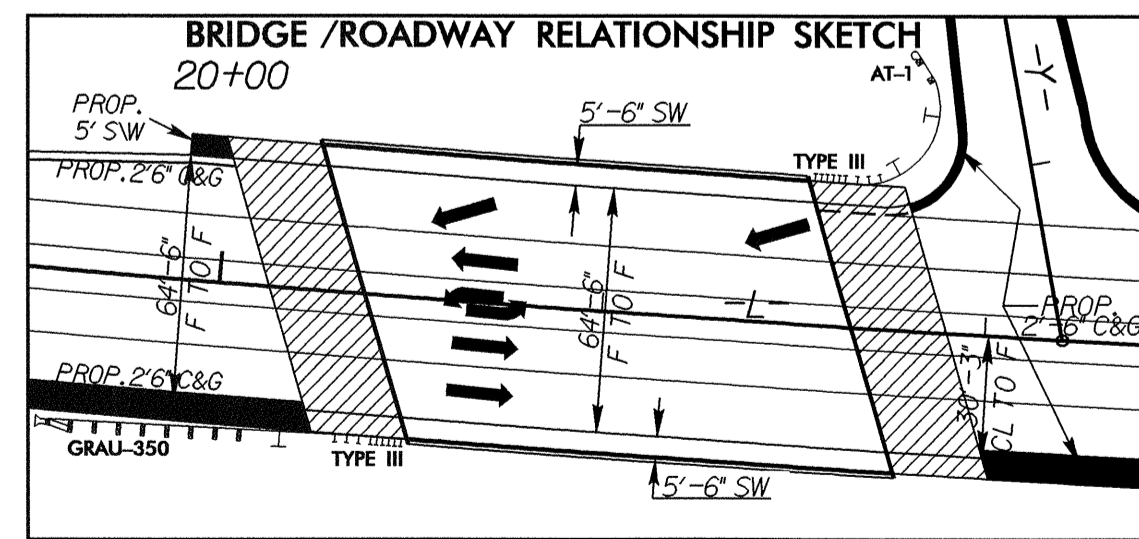
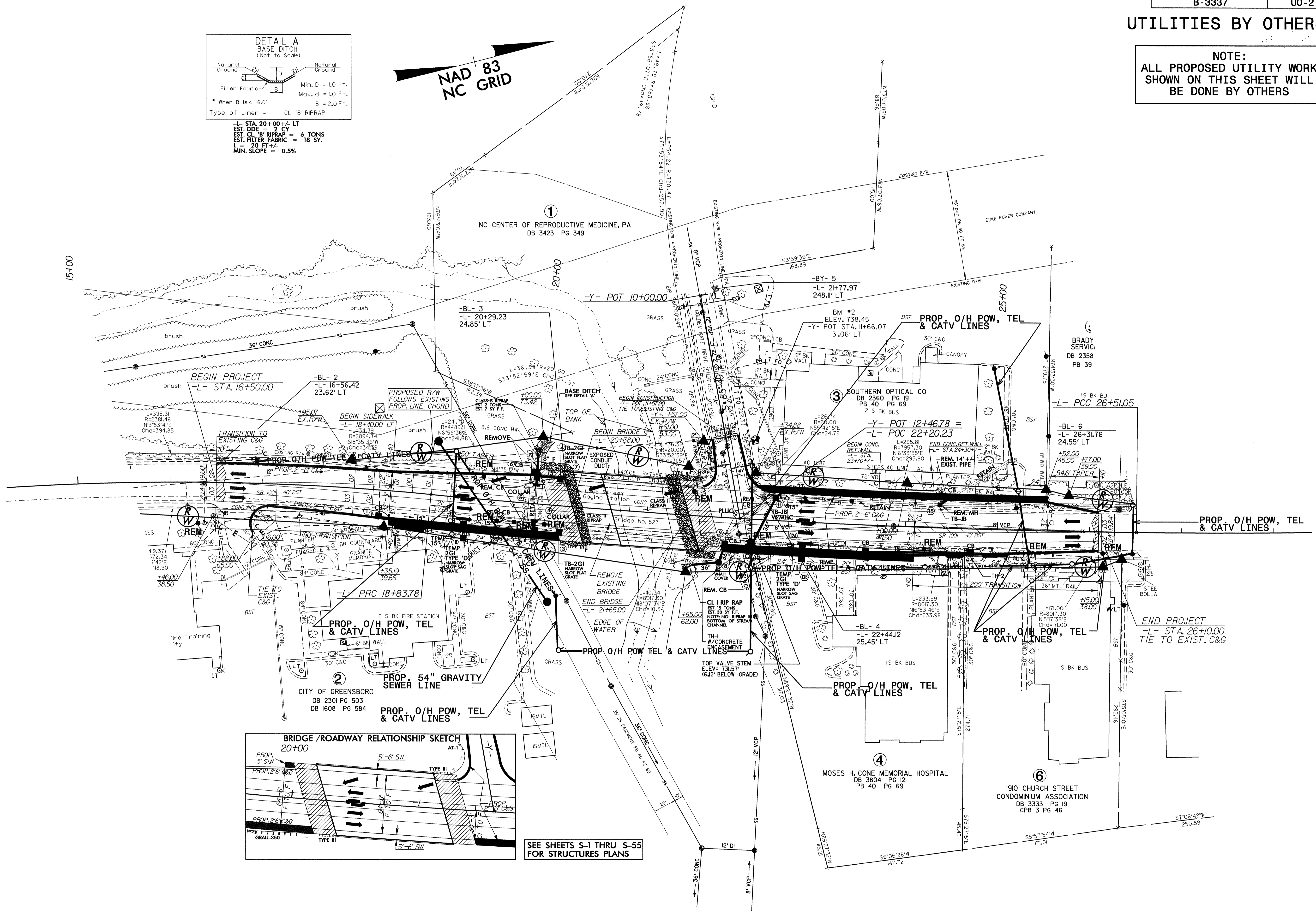

SEE SHEETS S-1 THRU S-55
FOR STRUCTURES PLANS

5/14/99
 20-AUG-2007 12:43
 dy-utl by others shtuo-2)_psh ayancey PS-Oce34dtboud