

T.I.P. NO.	SHEET NO.
B-4006	UO-1

STATE OF NORTH CAROLINA  
DIVISION OF HIGHWAYS

**UTILITY BY OTHERS PLANS  
ALEXANDER COUNTY**

LOCATION: BRIDGE 8 OVER ROCKY CREEK ON SR 1446

TYPE OF WORK: UTILITY CONSTRUCTION BY OTHERS

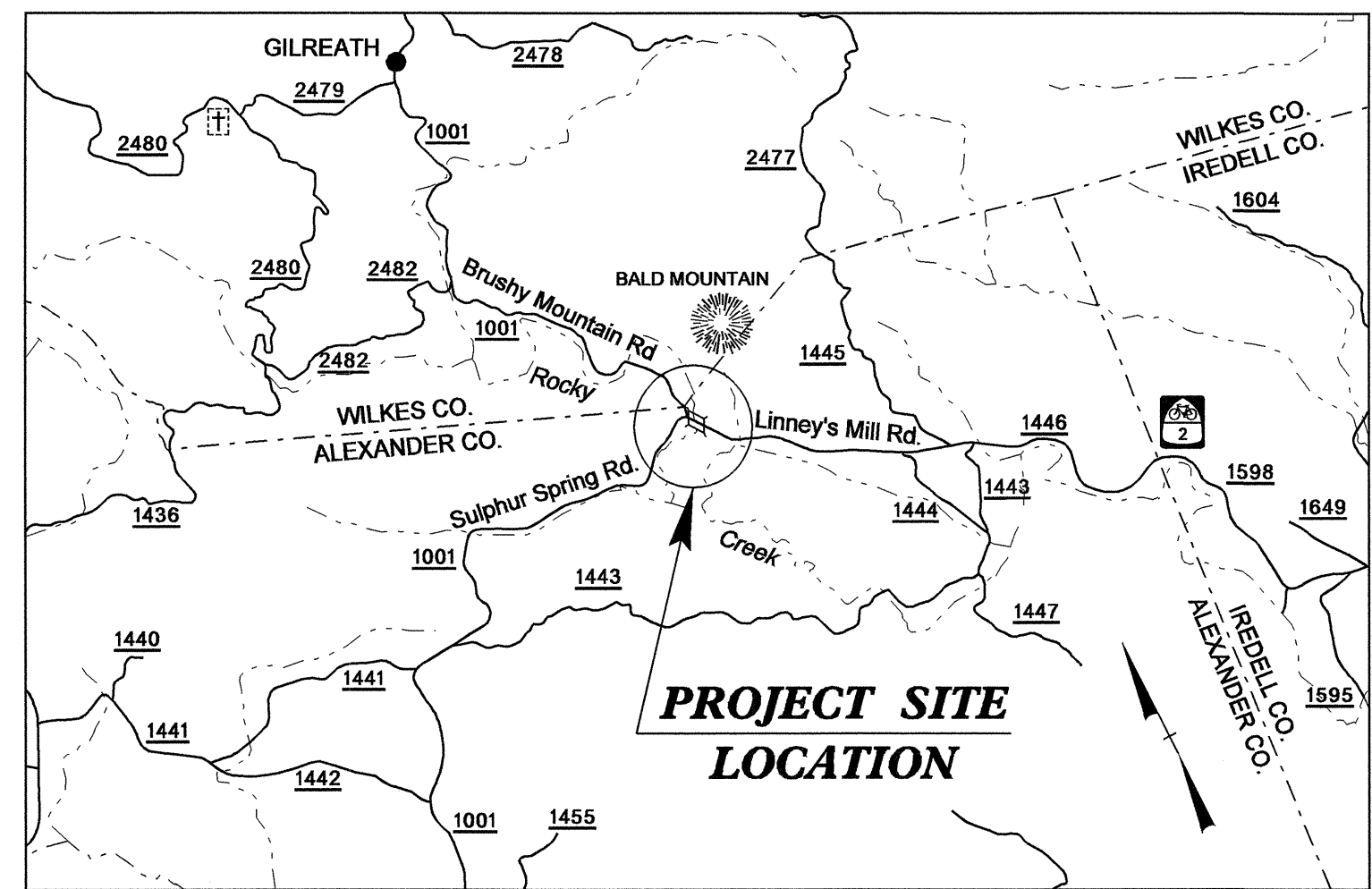
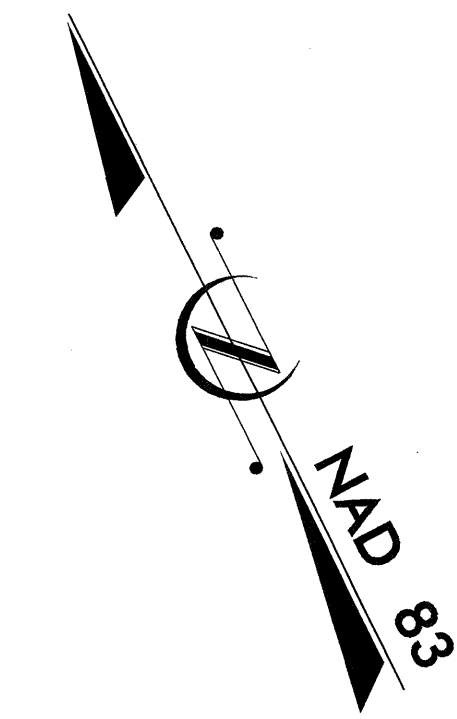

**VICINITY MAP**

TIP PROJECT: B - 4006

CONTRACT: C201584

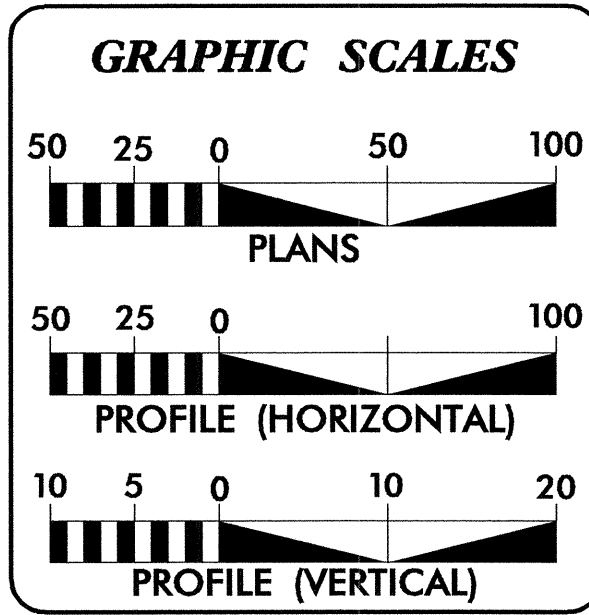
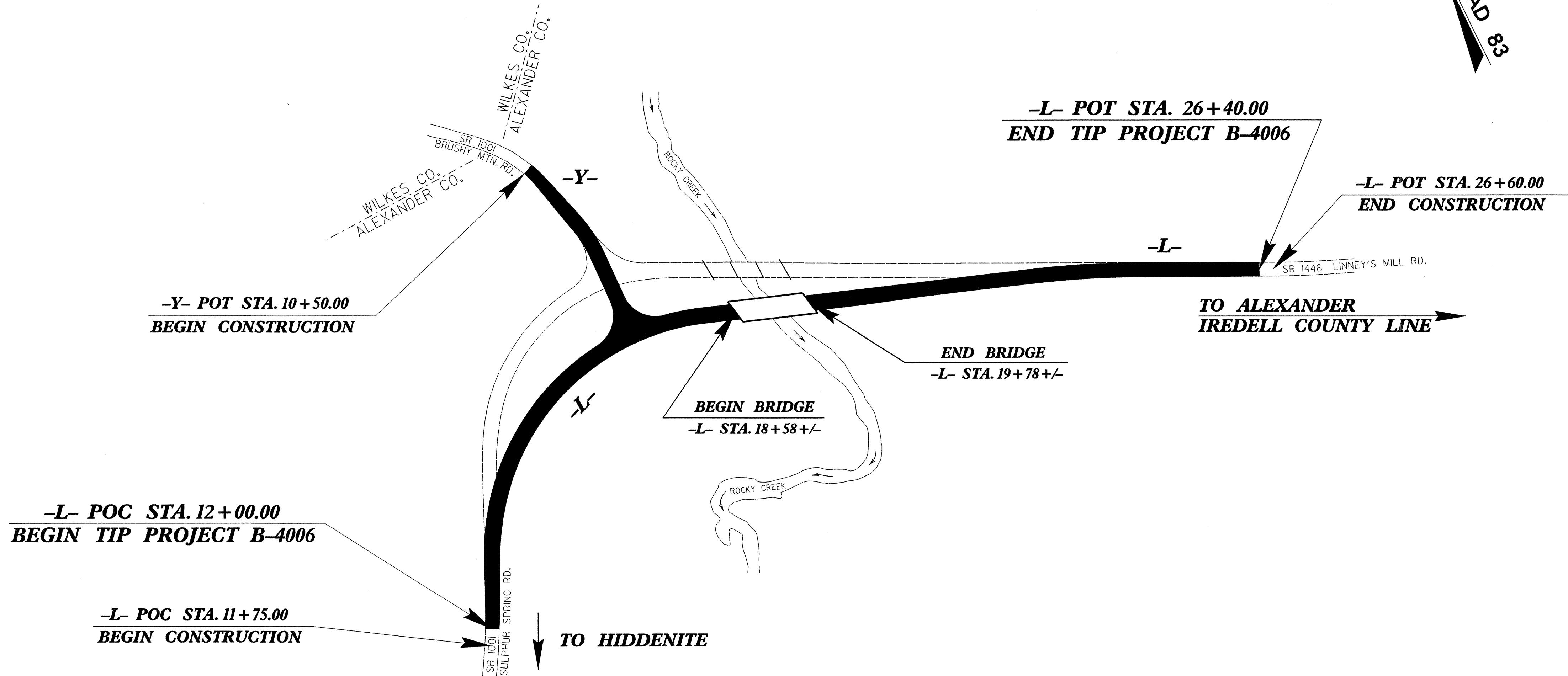

**INDEX OF SHEETS**

SHEET NO.	DESCRIPTION
UO-1	TITLE SHEET
UO-2	UTILITY BY OTHERS PLAN SHEET

**UTILITY OWNERS ON PROJECT**

- ENERGY UNITED - POWER
- YADKIN VALLEY TMC - TELEPHONE

PREPARED IN THE OFFICE OF:  
**DIVISION OF HIGHWAYS  
PROJECT SERVICES  
UTILITY SECTION**

1591 MAIL SERVICES CENTER  
RALEIGH NC 27699-1591  
PHONE (919) 250-4128  
FAX (919) 250-4119

**Roger Worthington, P.E.** UTILITIES SECTION ENGINEER  
**R. B. Wilkins, P.E.** UTILITIES SQUAD LEADER PROJECT ENGINEER  
**John A. Nigro, P.E.** UTILITIES PROJECT DESIGNER

07-FEB-2007 16:05  
F:\UT\TIP\proj\4006\ut\_title\_uo1\_psh.dgn  
\$\$\$\$\$USERNAME\$\$\$\$\$

UTILITIES BY OTHERS

NOTE:  
ALL PROPOSED UTILITY WORK  
SHOWN ON THIS SHEET WILL  
BE DONE BY OTHERS

RALPH J. ANDERSON  
DB 528 PG 413  
DB 169 PG 542

-Y- POT Sta. 10+00.00  
-Y- PC Sta. 10+11.85

**BEGIN CONSTRUCTION**  
-Y- POC Sta. 10+50.00

BY-7 12+10.16 PINC  
-Y- Sta. 10+39.68  
(29.43' LT.)  
JOHN E. POOLE  
DB 468 PG 2245  
PB 9 PG 57

**END CONSTRUCTION**  
-DW2- POT Sta. 11+25.00

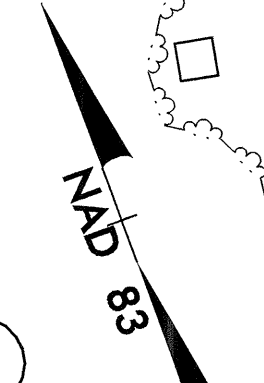

3  
CLAY E. POOLE  
DB 245 PG 140  
PB 9 PG 57

-Y- PT Sta. 10+76.28

-Y- PC Sta. 11+54.58

-Y- PT Sta. 12+13.29

-BL- GPS 4006-2 11+89.24 PINC  
-BY8- Sta. 14+04.10  
-L- Sta. 16+91.33 (16.15 LT.)

**BEGIN BRIDGE**  
-L- Sta. 18+58+/-

**END BRIDGE**  
-L- Sta. 19+78+/-

**END TIP PROJECT B-4006**  
-L- POT Sta. 26+40.00

**END CONSTRUCTION**  
-L- POT Sta. 26+60.00

JOHN E. POOLE  
DB 468 PG 2245  
PB 9 PG 57

END EXPRESSWAY GUTTER  
-L- STA. 13+50

-Y- POT Sta. 13+41.04  
-L- POC Sta. 17+15.00

-L- PT Sta. 18+20.59

JOHN E. POOLE  
DB 468 PG 2245  
PB 9 PG 57

-DW1- POT Sta. 10+00.00  
-DW2- POT Sta. 10+00.00  
-L- POT Sta. 21+35.00

BEGIN EXPRESSWAY GUTTER  
-L- STA. 12+50

**BEGIN TIP PROJECT B-4006**  
-L- POC Sta. 12+00.00

**BEGIN CONSTRUCTION**  
-L- POC Sta. 11+75.00

-L- PC Sta. 10+00.00

-L- PT Sta. 12+48.43

**END CONSTRUCTION**  
-DW1- POT Sta. 12+30.00

-BL- GPS B4006-1 5+00.00 POT  
-L- Sta. 10+49.36  
(17.82' RT.)

07-FEB-2007 16:08  
rt:\projects\2007\4006\proj\4006\ut\_4\_w02\_psh.dgn