

**TIP PROJECT: U-5009**

STATE OF NORTH CAROLINA  
 DIVISION OF HIGHWAYS  
 PLAN FOR PROPOSED  
 HIGHWAY EROSION CONTROL

STATE	STATE PROJECT REFERENCE NO.	SHEET NO.	TOTAL SHEETS
N.C.	U-5009	EC-1	
STATE PROJ. NO.	F.A. PROJ. NO.	DESCRIPTION	

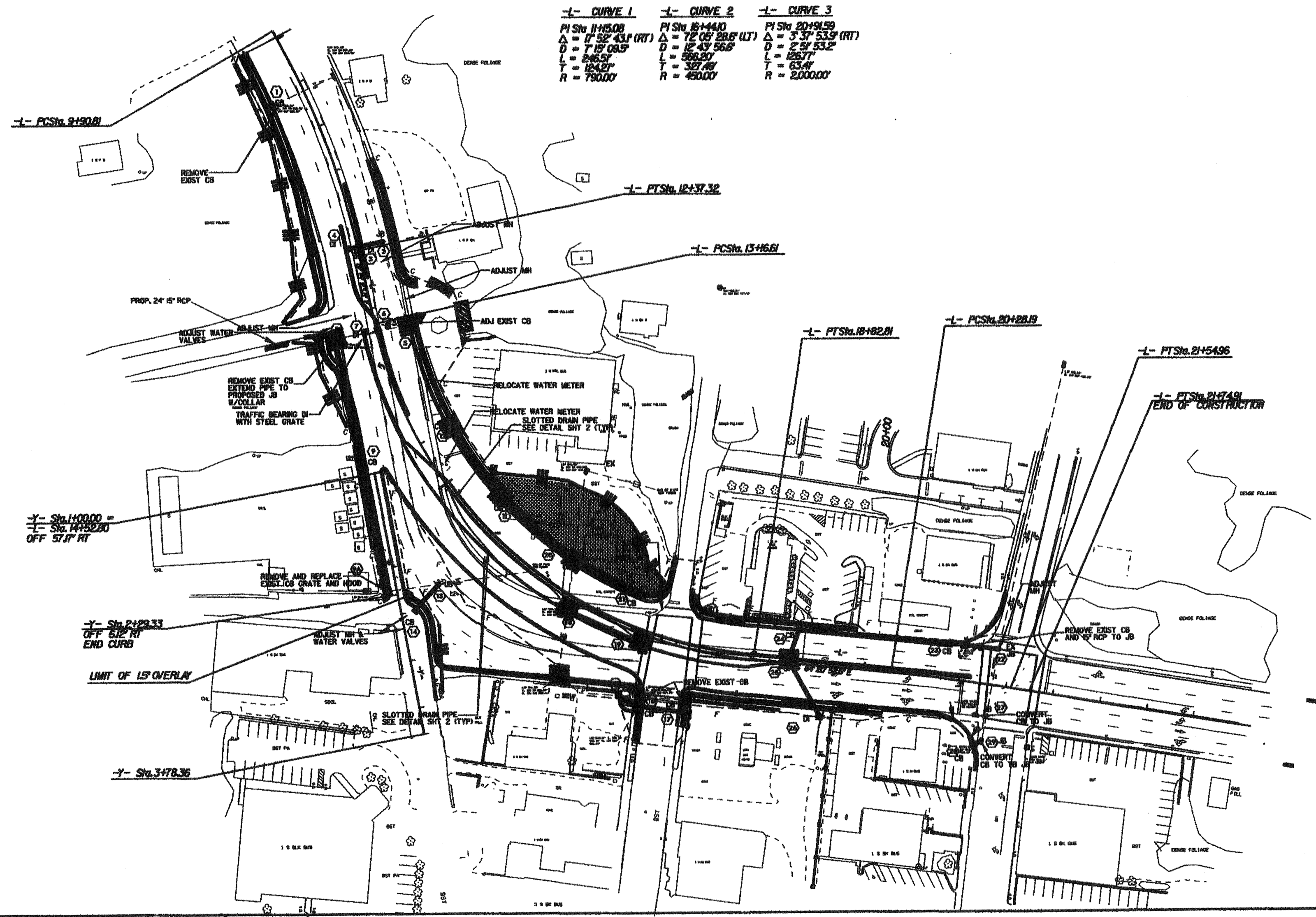

**EROSION AND SEDIMENT CONTROL MEASURES**

Std. #	Description	Symbol
	Streambank Reforestation	XXXXXX
1630.03	Temporary Silt Ditch	TD
1630.05	Temporary Diversion	TD
1605.01	Temporary Silt Fence	
1606.01	Special Sediment Control Fence	
1622.01	Temporary Berms and Slope Drains	— T —
1630.01	Riser Basin	⊙
1630.02	Silt Basin Type B	▨
1633.01	Temporary Rock Silt Check Type-A	XXXX
	Temporary Rock Silt Check Type-B	XXXX
1634.01	Temporary Rock Sediment Dam Type-A	▨
1634.02	Temporary Rock Sediment Dam Type-B	▨
1635.01	Rock Pipe Inlet Sediment Trap Type-A	D
1635.02	Rock Pipe Inlet Sediment Trap Type-B	C
1630.04	Stilling Basin	▭
	Rock Inlet Sediment Trap:	
1632.01	Type A	A
1632.02	Type B	B
1632.03	Type C	C
	Skimmer Basin	▭
	Tiered Skimmer Basin	▭

**GRAPHIC SCALE**

0  
  
 PLANS

0  
  
 PROFILE (HORIZONTAL)

0  
  
 PROFILE (VERTICAL)

ROADSIDE ENVIRONMENTAL UNIT  
 DIVISION OF HIGHWAYS  
 STATE OF NORTH CAROLINA

Prepared in the Office of:  
**DIVISION DESIGN CONSTRUCT UNIT**  
 1 South Wilmington St.  
 Raleigh, NC 27611  
**2006 STANDARD SPECIFICATIONS**

Roadway Standard Drawings

The following roadway English standards as appear in "Roadway Standard Drawings"- Roadway Design Unit - N. C. Department of Transportation - Raleigh, N. C., dated July 18, 2006 and the latest revision thereto are applicable to this project and by reference hereby are considered a part of these plans.

1604.01 Railroad Erosion Control Detail	1630.06 Special Stilling Basin
1605.01 Temporary Silt Fence	1632.01 Rock Inlet Sediment Trap Type A
1606.01 Special Sediment Control Fence	1632.02 Rock Inlet Sediment Trap Type B
1607.01 Gravel Construction Entrance	1632.03 Rock Inlet Sediment Trap Type C
1622.01 Temporary Berms and Slope Drains	1633.01 Temporary Rock Silt Check Type A
1630.01 Riser Basin	1634.01 Temporary Rock Sediment Dam Type A
1630.02 Silt Basin Type B	1634.02 Temporary Rock Sediment Dam Type B
1630.03 Temporary Silt Ditch	1635.01 Rock Pipe Inlet Sediment Trap Type A
1630.04 Stilling Basin	1635.02 Rock Pipe Inlet Sediment Trap Type B
1630.05 Temporary Diversion	

5/14/99

PROJECT REFERENCE NO. U-5009	SHEET NO. EC-2
RW SHEET NO.	
ROADWAY DESIGN ENGINEER	HYDRAULICS ENGINEER

-L- PCSta. 9+95.97  
BEGIN CONSTRUCTION  
LIMIT OF 1.5" MILL & OVERLAY

-L- CURVE 1	-L- CURVE 2	-L- CURVE 3
PI Sta 11+15.08	PI Sta 16+44.10	PI Sta 20+91.59
$\Delta = 17^\circ 52' 43.1" (RT)$	$\Delta = 72^\circ 05' 28.6" (LT)$	$\Delta = 3^\circ 37' 53.9" (RT)$
D = 7' 15" 09.5"	D = 12' 43" 56.6"	D = 2' 51" 53.2"
L = 246.51'	L = 566.20'	L = 126.77'
T = 124.27'	T = 327.49'	T = 63.41'
R = 790.00'	R = 450.00'	R = 2,000.00'

-L- PCSta. 9+90.81

REMOVE EXIST CB

-L- PTSta. 12+37.32

-L- PCSta. 13+66.61

PROP. 24' 15" RCP

ADJUST WATER VALVES

REMOVE EXIST CB  
EXTEND PIPE TO  
PROPOSED JB  
W/COLLAR  
TRAFFIC BEARING DI  
WITH STEEL GRATE

ADJ EXIST CB

-L- PTSta. 18+82.81

-L- PCSta. 20+28.19

-L- PTSta. 21+54.96

-L- PTSta. 21+74.91  
END OF CONSTRUCTION

-Y- Sta. 1+00.00 =  
-L- Sta. 14+52.80  
OFF 57.17' RT

REMOVE AND REPLACE  
EXIST CB GRATE AND HOOD

-Y- Sta. 2+29.33  
OFF 61.2' RT  
END CURB

LIMIT OF 1.5" OVERLAY

-Y- Sta. 3+78.36

SLOTTED DRAIN PIPE  
SEE DETAIL SH 2 (TYP)

REMOVE EXIST CB

CONVERT  
CB TO JB

CONVERT  
CB TO JB

18-APR-2001 14:01  
rdy\onsen\1011014...rdj\_esc.mchard.dgn

