

STATE OF NORTH CAROLINA
DIVISION OF HIGHWAYS

STATE PROJECT REFERENCE NO.	SHEET NO.
B-2950	TCP-01

**PLAN FOR PROPOSED
TRAFFIC CONTROL, MARKING & DELINEATION
CURRITUCK COUNTY**

B-2950

ROADWAY STANDARD DRAWINGS

THE FOLLOWING ROADWAY STANDARDS AS APPEAR IN "ROADWAY STANDARD DRAWINGS"- PROJECT SERVICES UNIT-N.C. DEPARTMENT OF TRANSPORTATION-RALEIGH, N.C., DATED JULY 2006 ARE APPLICABLE TO THIS PROJECT AND BY REFERENCE HEREBY ARE CONSIDERED A PART OF THESE PLANS:

STD. NO.	TITLE
1101.03	TEMPORARY ROAD CLOSURES
1101.05	WORK ZONE VEHICLE ACCESSES
1101.11	TRAFFIC CONTROL DESIGN TABLES
1110.01	STATIONARY WORK ZONE SIGNS
1110.02	PORTABLE WORK ZONE SIGNS
1145.01	BARRICADES
1205.01	PAVEMENT MARKINGS - LINE TYPES & OFFSETS
1205.02	PAVEMENT MARKINGS - 2 LANE & MULTILANE ROADWAYS
1205.12	PAVEMENT MARKINGS - BRIDGES
1250.01	PAVEMENT MARKER SPACING
1251.01	RAISED PAVEMENT MARKERS (TEMPORARY & PERMANENT)
1261.01	GUARDRAIL & BARRIER DELINEATOR SPACING
1261.02	GUARDRAIL & BARRIER DELINEATOR TYPES
1262.01	GUARDRAIL END DELINEATION

INDEX OF SHEETS

SHEET NO.	TITLE
TCP-01	LIST OF APPLICABLE ROADWAY STANDARD DRAWINGS, LEGEND, INDEX OF SHEETS AND FINAL PAVEMENT MARKING SCHEDULE
TCP-02	GENERAL NOTES, PHASING AND DETAIL A

LEGEND

- GENERAL**
- DIRECTION OF TRAFFIC FLOW
 - NORTH ARROW
 - PROPOSED PVMT. EXIST. PVMT.
 - WORK AREA
 - REMOVAL OF EXISTING PAVEMENT
- TRAFFIC CONTROL DEVICES**
- TYPE III BARRICADE
 - CONE
 - DRUM SKINNY DRUM
 - STATIONARY SIGN
 - PORTABLE SIGN
 - STATIONARY OR PORTABLE SIGN
 - WARNING FLAGS
 - FLAGGER

PAVEMENT MARKING SCHEDULE

DESCRIPTION	PAY ITEM	QUANTITY BREAKDOWN	TOTAL QUANTITY
WHITE EDGELINE YELLOW DOUBLE CENTER	COLD APPLIED PLASTIC, Type 3 (4")	610 LF 610 LF	TOTAL 1220 LF
YELLOW DOUBLE CENTER	THERMOPLASTIC(4", 120 MILS)	5400 LF	TOTAL 5400 LF
WHITE EDGELINE	THERMOPLASTIC(4", 90 MILS)	5400 LF	TOTAL 5400 LF
YELLOW & YELLOW	MARKERS PERMANENT RAISED PAVEMENT MARKERS	40 EA	TOTAL 40 EA

APPROVED: DATE: February 20, 2007	PLAN PREPARED BY: N.C.D.O.T. WORK ZONE TRAFFIC CONTROL UNIT
SEAL	STUART BOURNE, P.E. TRAFFIC CONTROL ENGINEER
	J. STEVE KITE, P.E. TRAFFIC CONTROL PROJECT ENGINEER
	DON PARKER TRAFFIC CONTROL PROJECT DESIGN ENGINEER
	STEPHEN SYKES TRAFFIC CONTROL DESIGN ENGINEER / TECHNICIAN

TIP PROJECT:

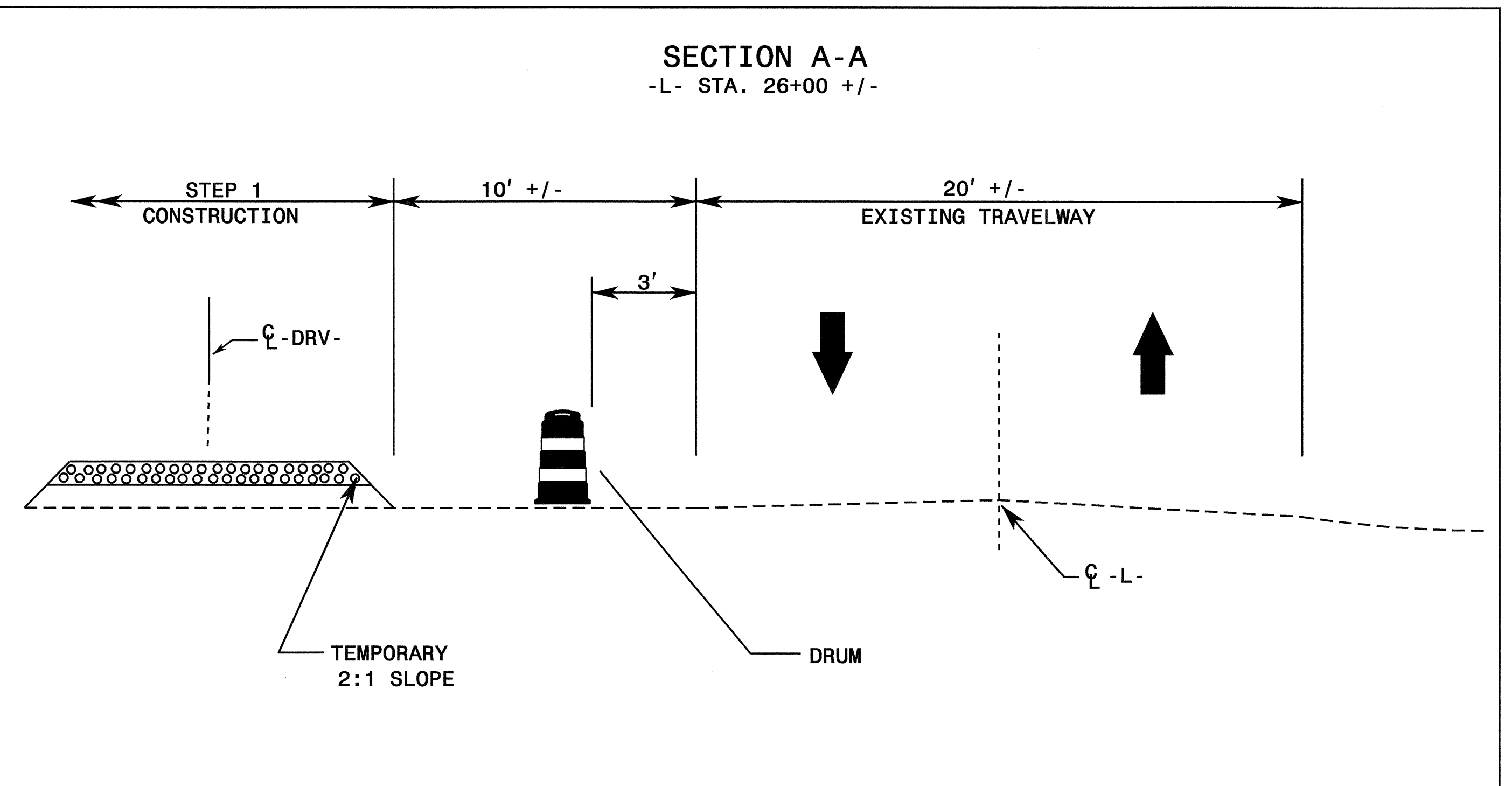
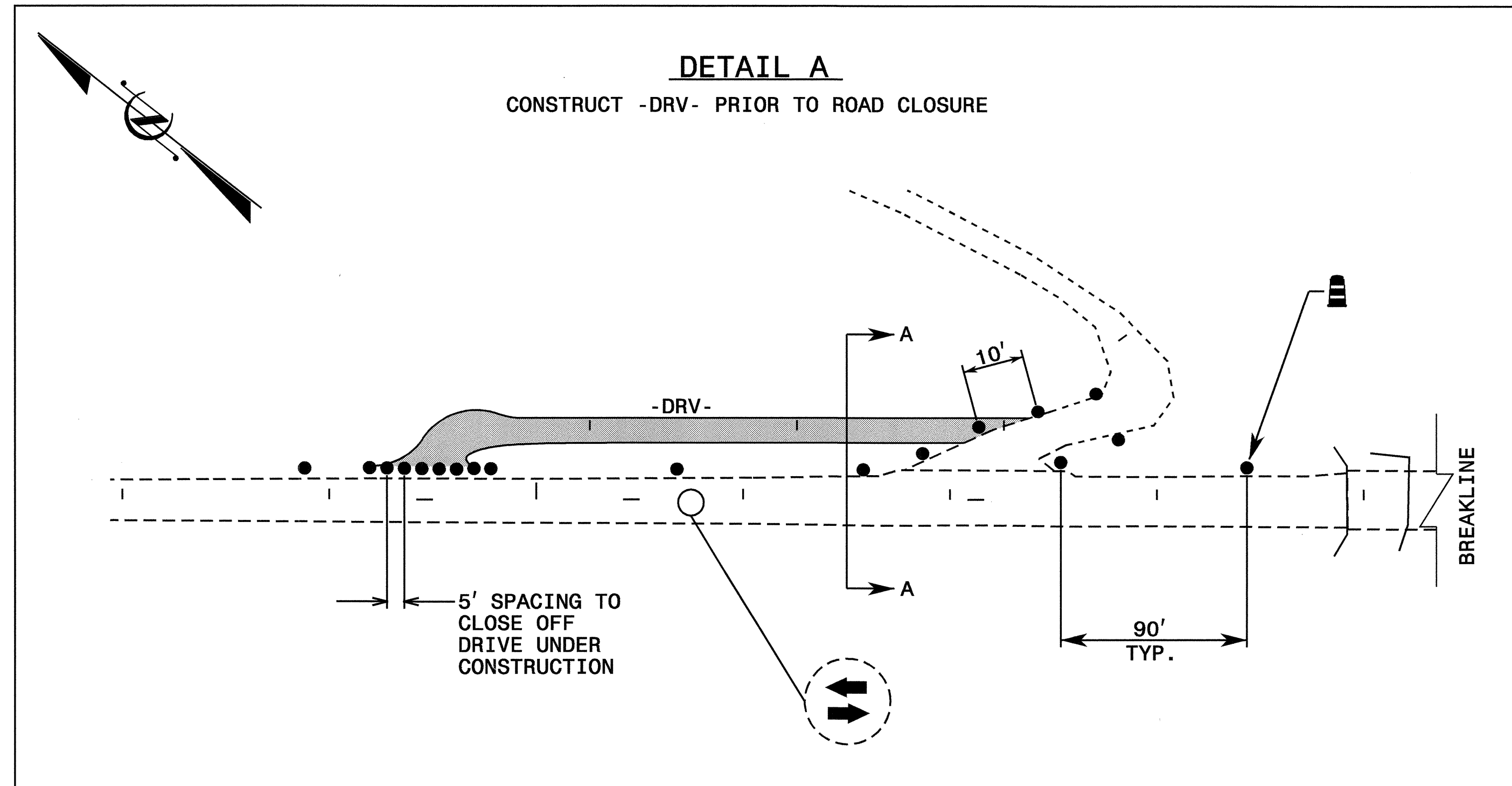

GENERAL NOTES

ADAPT THE TRAFFIC CONTROL PLANS, WHEN DIRECTED BY THE ENGINEER, TO MEET FIELD CONDITIONS TO PROVIDE SAFE AND EFFICIENT TRAFFIC MOVEMENT. CHANGES MAY BE REQUIRED WHEN PHYSICAL DIMENSIONS IN THE DETAIL DRAWINGS, STANDARD DETAILS AND ROADWAY DETAILS ARE NOT ATTAINABLE, OR RESULT IN DUPLICATE, OR UNDESIRABLE OVERLAPPING OF DEVICES. MODIFICATION MAY INCLUDE: MOVING, SUPPLEMENTING, COVERING OR REMOVAL OF DEVICES.

THE FOLLOWING GENERAL NOTES APPLY AT ALL TIMES FOR THE DURATION OF THE CONSTRUCTION PROJECT, EXCEPT WHEN OTHERWISE NOTED IN THE PLAN, OR DIRECTED BY THE ENGINEER.

LANE AND SHOULDER CLOSURE REQUIREMENTS

- A) REMOVE LANE CLOSURE DEVICES FROM THE LANE WHEN WORK IS NOT BEING PERFORMED BEHIND THE LANE CLOSURE OR WHEN A LANE CLOSURE IS NO LONGER NEEDED, OR AS DIRECTED BY THE ENGINEER.
- B) WHEN PERSONNEL AND/OR EQUIPMENT ARE WORKING ON THE SHOULDER ADJACENT TO A DIVIDED FACILITY AND WITHIN 10 FT OF AN OPEN TRAVEL LANE, CLOSE THE NEAREST OPEN TRAVEL LANE USING ROADWAY STANDARD DRAWING NO. 1101.02 UNLESS THE WORK AREA IS PROTECTED BY BARRIER OR GUARDRAIL.

TRAFFIC PATTERN ALTERATIONS

- C) NOTIFY THE ENGINEER TWENTY ONE (21) CALENDAR DAYS PRIOR TO ANY TRAFFIC PATTERN ALTERATION.

SIGNING

- D) STATE FORCES WILL BE RESPONSIBLE FOR PERMANENT SIGNING.
- E) PROVIDE DETOUR SIGNING WITHIN THE PROJECT LIMITS.
- F) THE CONTRACTOR WILL COVER OR REMOVE ALL DETOUR SIGNS WITHIN AND OFF THE PROJECT LIMITS WHEN A DETOUR IS NOT IN OPERATION.
- G) ENSURE ALL NECESSARY SIGNING IS IN PLACE PRIOR TO ALTERING ANY TRAFFIC PATTERN.

TRAFFIC CONTROL DEVICES

- H) WHEN USING ROADWAY STANDARD NO. 1101.02, CONES MAY BE USED IN LIEU OF DRUMS ON SR 1222 AND DRIVE
- I) PLACE TYPE III BARRICADES, WITH "ROAD CLOSED" SIGN R11-2 ATTACHED, OF SUFFICIENT LENGTH TO CLOSE ENTIRE ROADWAY. STAGGER OR OVERLAP BARRICADES TO ALLOW FOR INGRESS OR EGRESS.

PAVEMENT MARKINGS AND MARKERS

- J) INSTALL PAVEMENT MARKINGS AND PAVEMENT MARKERS ON THE FINAL SURFACE AS FOLLOWS:

ROAD NAME	MARKING	MARKER
SR 1222	THERMOPLASTIC	RAISED
SR 1222 (BRIDGE)	COLD APPLIED PLASTIC (TYPE III)	RAISED

- K) TIE PROPOSED PAVEMENT MARKING LINES TO EXISTING PAVEMENT MARKING LINES.

PHASING

NOTE: MAINTAIN ACCESS TO DRIVES AT ALL TIMES DURING PROJECT DURATION

- 1) USING FLAGGERS AS NECESSARY, CONSTRUCT -DRV- (SEE RSD 1101.02, SHEET 1 OF 9 AND DETAIL "A", THIS SHEET).
- 2) CLOSE SR 1222 (SEE RSD 1101.03, SHEET 1 OF 9).
- 3) AWAY FROM TRAFFIC, CONSTRUCT PROPOSED STRUCTURE AND APPROACHES INCLUDING THE FINAL LAYER OF SURFACE COURSE AND FINAL PAVEMENT MARKINGS.
- 4) REOPEN SR 1222 TO TRAFFIC.
- 5) REMOVE ALL TRAFFIC CONTROL DEVICES.

20-FEB-2007 12:22 c:\p01\sr1222\traffic\trafficcontrol\top\2950_tc_top02.gnotes.dgn sjs/kes AT 12/10/07

APPROVED: SEAL 	<h3>GENERAL NOTES, PHASING AND DETAIL</h3>	REVISIONS <table border="1" style="width: 100%; height: 40px;"> <tr><td> </td><td> </td></tr> <tr><td> </td><td> </td></tr> </table>				
SCALE: NONE DATE: 06/05 DWG. BY: SJS DESIGN BY: SJS REVIEWED BY: DAP						