

STATE OF NORTH CAROLINA  
DIVISION OF HIGHWAYS

**UTILITY BY OTHERS PLANS  
ROCKINGHAM COUNTY**

LOCATION: BRIDGE #165 OVER A CREEK ON SR 1376 (PAW PAW ROAD)

TYPE OF WORK: UTILITY RELOCATION

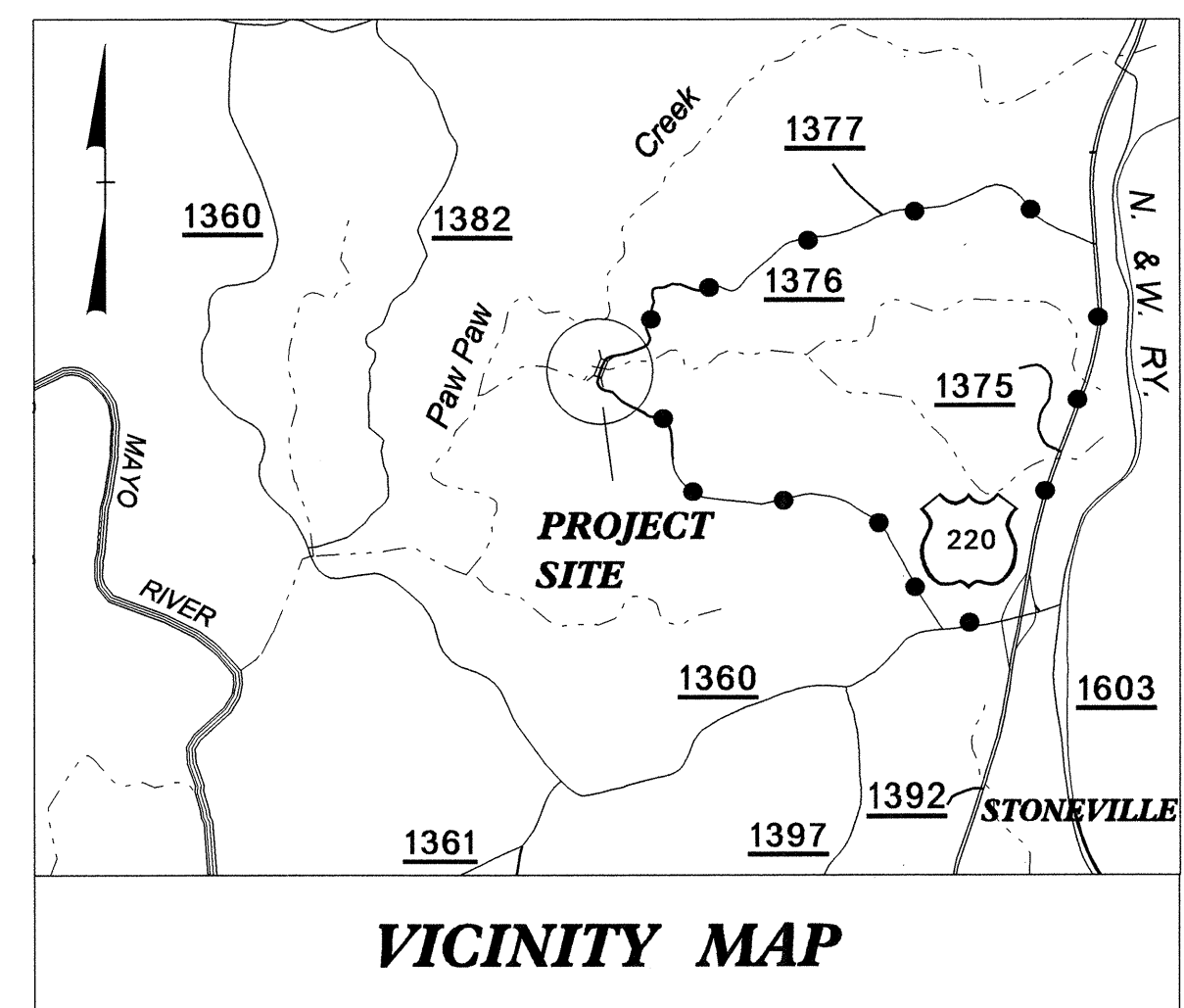
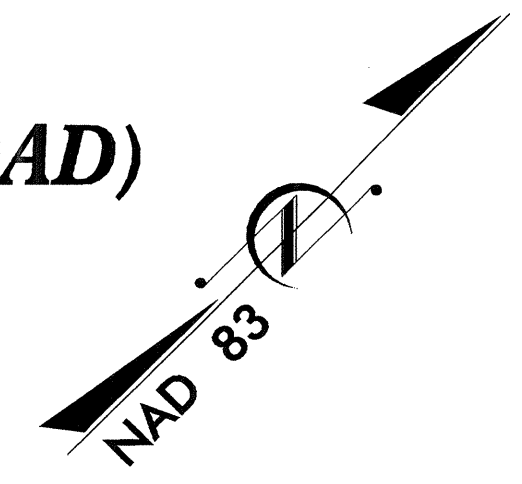

VICINITY MAP

--- DENOTES DETOUR

STA. 13+50.00 -L- BEGIN TIP PROJECT B-3900

STA. 20+50.00 -L- END TIP PROJECT B-3900

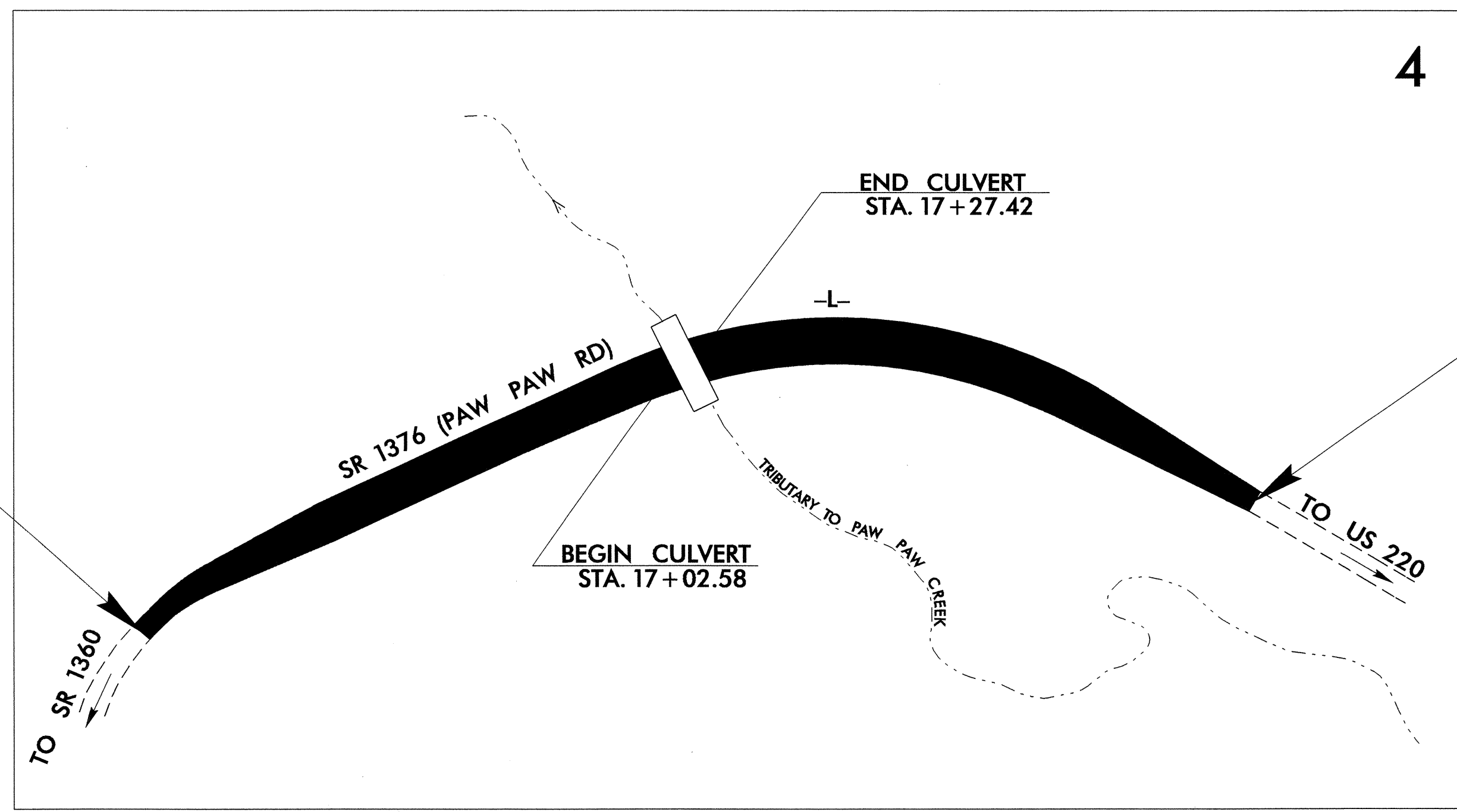

TIP PROJECT: B-3900

CONTRACT: C201583

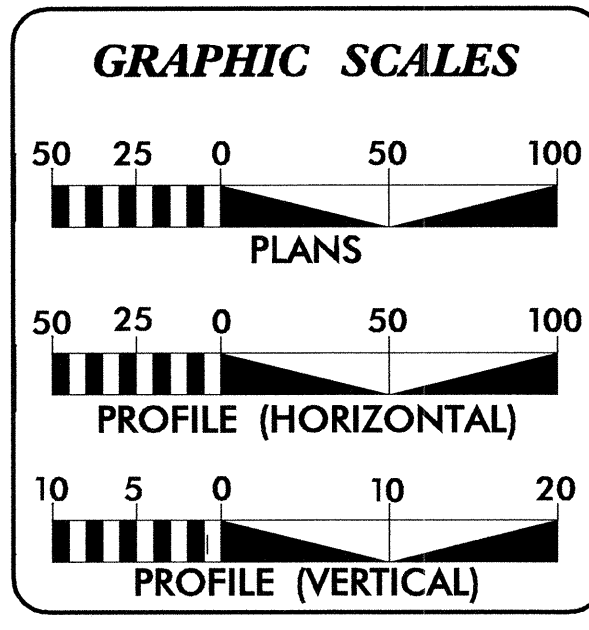

INDEX OF SHEETS	
SHEET NO.	DESCRIPTION
UO-1	TITLE SHEET
UO-2	UTILITY BY OTHERS PLAN SHEET

UTILITY OWNERS ON PROJECT
(1) ENERGY UNITED - ELECTRIC

PREPARED IN THE OFFICE OF:  
**DIVISION OF HIGHWAYS  
PROJECT SERVICES  
UTILITY SECTION**

1591 MAIL SERVICES CENTER  
RALEIGH, NC 27699-1591  
PHONE (919) 250-4128  
FAX (919) 250-4119

<u>Roger Worthington, P.E.</u>	UTILITIES SECTION ENGINEER
<u>Steve McKee, P.E.</u>	UTILITIES SQUAD LEADER PROJECT ENGINEER
<u>Donald Proper</u>	UTILITIES PROJECT DESIGNER

UTILITIES BY OTHERS

NOTE:  
ALL PROPOSED UTILITY WORK  
SHOWN ON THIS SHEET WILL  
BE DONE BY OTHERS

PI Sta 10+71.55 Δ = 23° 21' 00.5" (LT) D = 38' 11" 49.9" L = 61.3' T = 31.00' R = 150.00'	PI Sta 12+06.50 Δ = 43° 51' 33.9" (RT) D = 57' 17" 44.8" L = 76.55' T = 40.26' R = 100.00'	PI Sta 13+72.81 Δ = 62° 52' 52.9" (RT) D = 47' 44" 47.3" L = 131.70' T = 73.37' R = 120.00'	PI Sta 18+23.66 Δ = 55° 07' 36.2" (RT) D = 20' 50" 05.4" L = 264.59' T = 143.54' R = 275.00' ** V = 30mph SE = SEE PLANS	PI Sta 22+56.47 Δ = 7° 37' 26.4" (LT) D = 2' 51" 53.2" L = 266.13' T = 133.26' R = 2,000.00'	PI Sta 24+50.25 Δ = 8° 15' 26.7" (LT) D = 14' 19" 26.2" L = 57.65' T = 28.87' R = 400.00'
--	---	--	---	---	--

STA. 13+50.00 -L- BEGIN STATE PROJECT B-3900

STA. 20+50.00 -L- END STATE PROJECT B-3900

PROPOSED ENERGY UNITED  
UTILITY POLES  
CONNECT TO EXISTING ENERGY  
UNITED ELECTRIC LINE

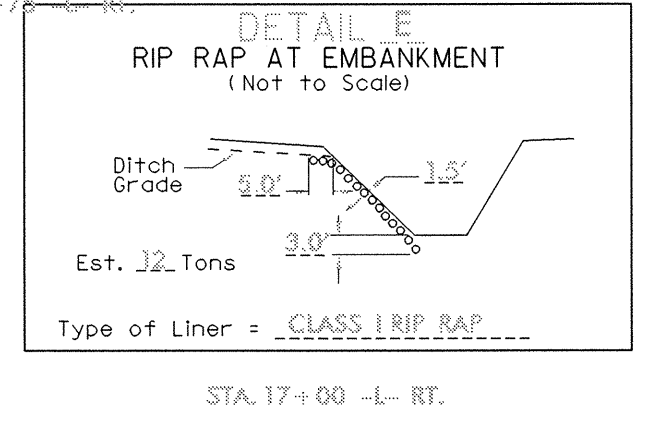
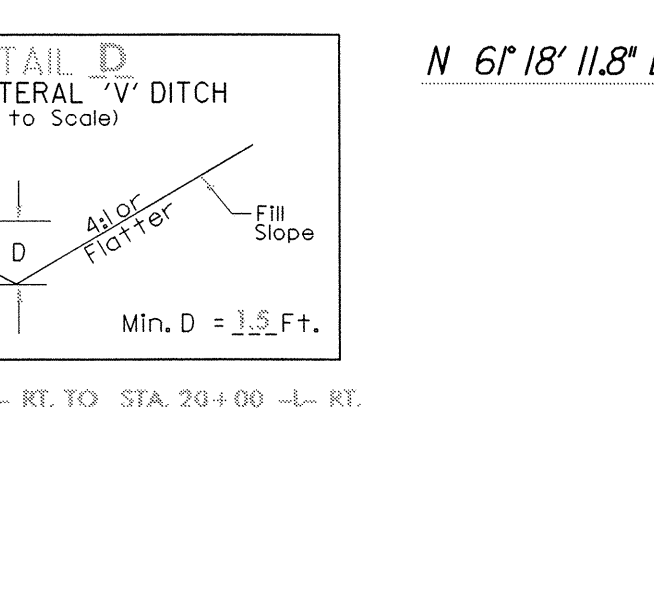
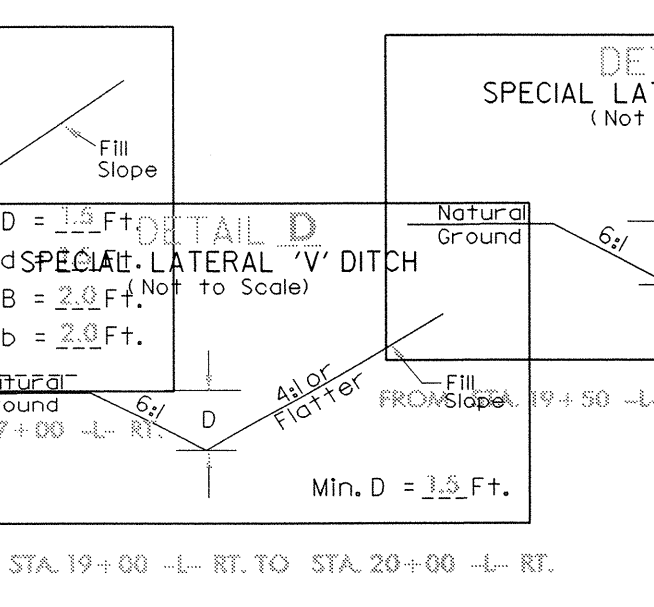
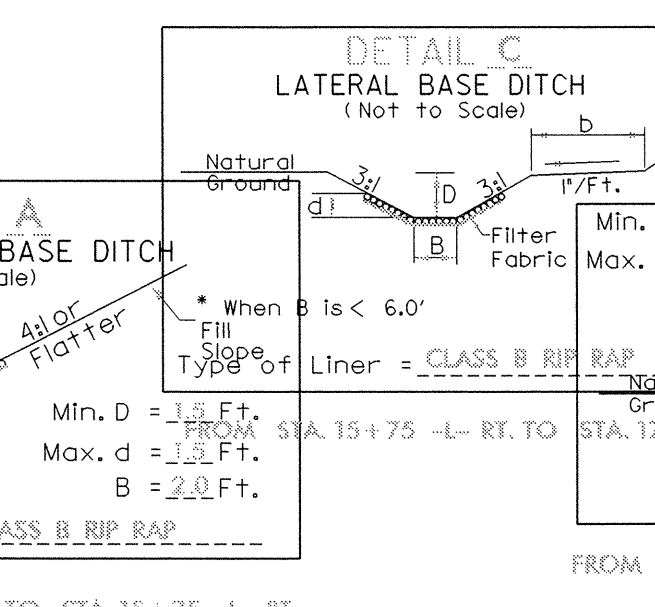
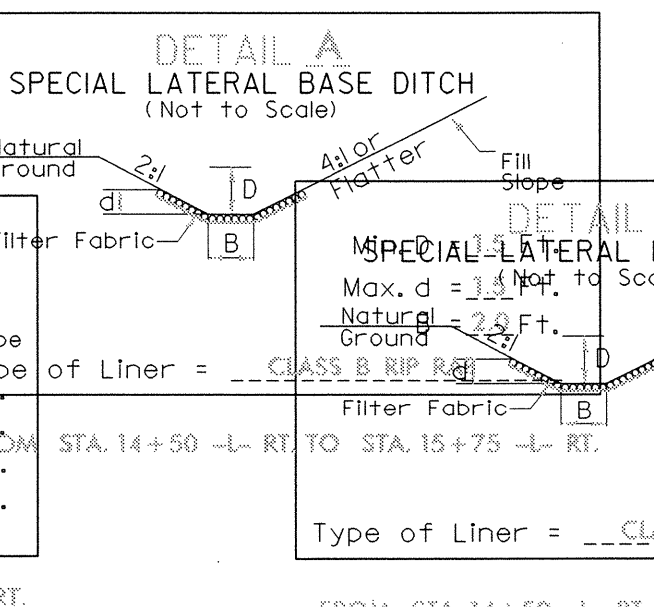
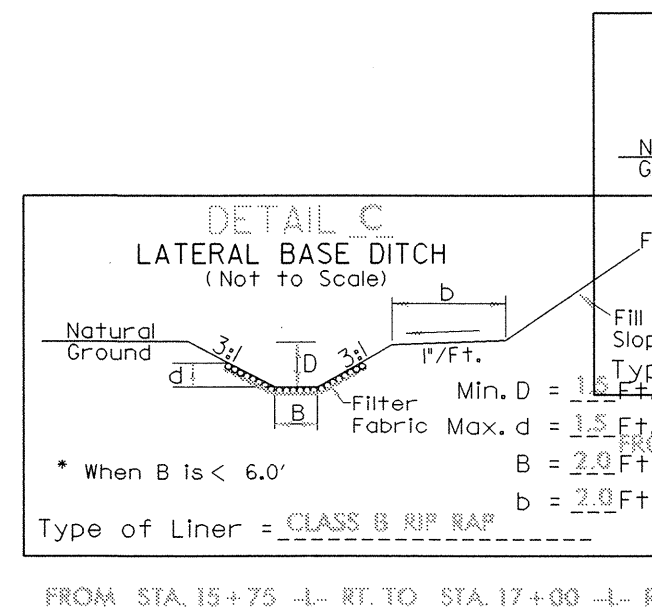
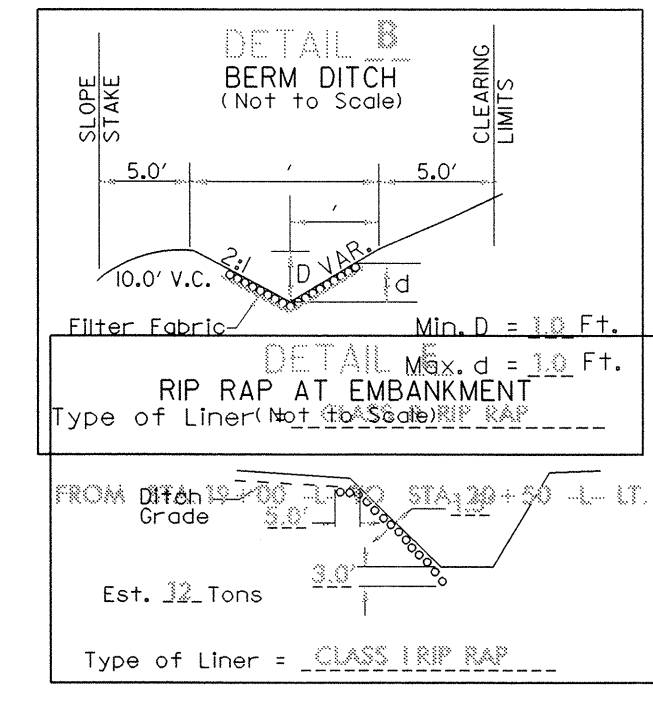
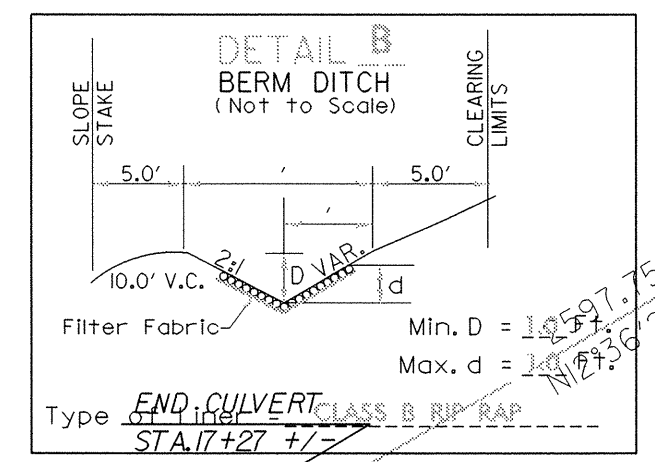
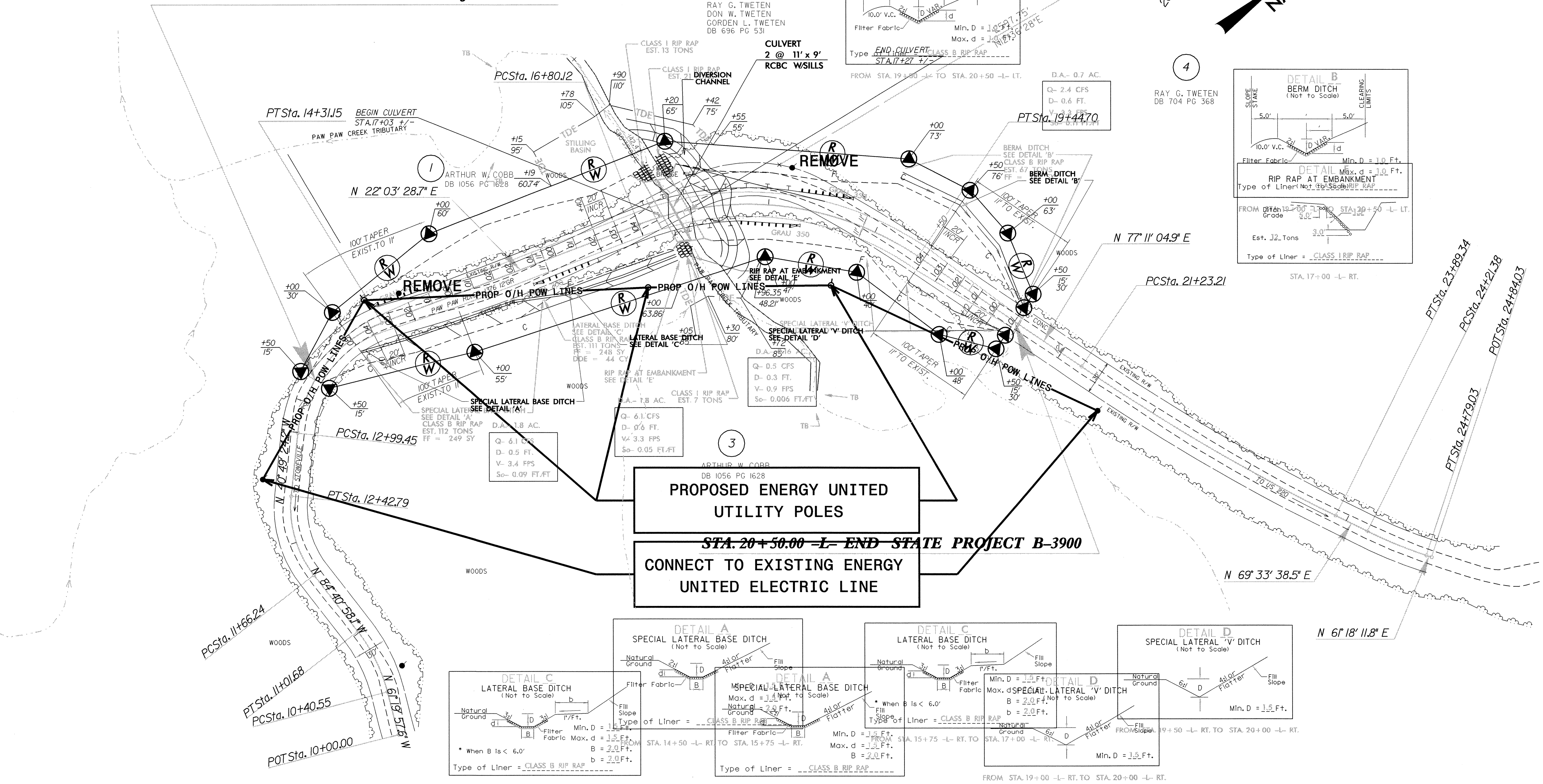

5/14/99  
0944PRR200712853  
\\s01\proj\14\B-3900\B-3900.dgn