

**STATE OF NORTH CAROLINA  
DIVISION OF HIGHWAYS  
CROSS-SECTION SUMMARY**

Station	Uncl. Exc.	Embt
L	(cu. yd.)	(cu. yd.)
10+00.0000	0	0
10+50.0000	8	16
11+00.0000	16	34
11+50.0000	23	30
12+00.0000	35	27
12+50.0000	75	45
13+00.0000	164	58
13+50.0000	192	28
14+00.0000	160	24
14+50.0000	89	62
15+00.0000	11	290
15+35.0000	0	958
15+81.9900	0	1049

**Notes:**

"Approximate quantities only. Unclassified Excavation, Fine Grading, Clearing, and Grubbing, and Removal of Existing Pavement will be paid for at the contract lump sum price for "Grading."

"Embankment Column Does Not Include Backfill For Undercut."

Station	Uncl. Exc.	Embt
L	(cu. yd.)	(cu. yd.)
16+82.1200	0	0
17+20.0000	0	1743
17+50.0000	147	2608
18+00.0000	361	3767
18+50.0000	117	2848
19+00.0000	0	1488
19+50.0000	0	459
20+00.0000	8	128
20+50.0000	69	59
21+00.0000	133	47
21+50.0000	314	116
22+00.0000	242	99



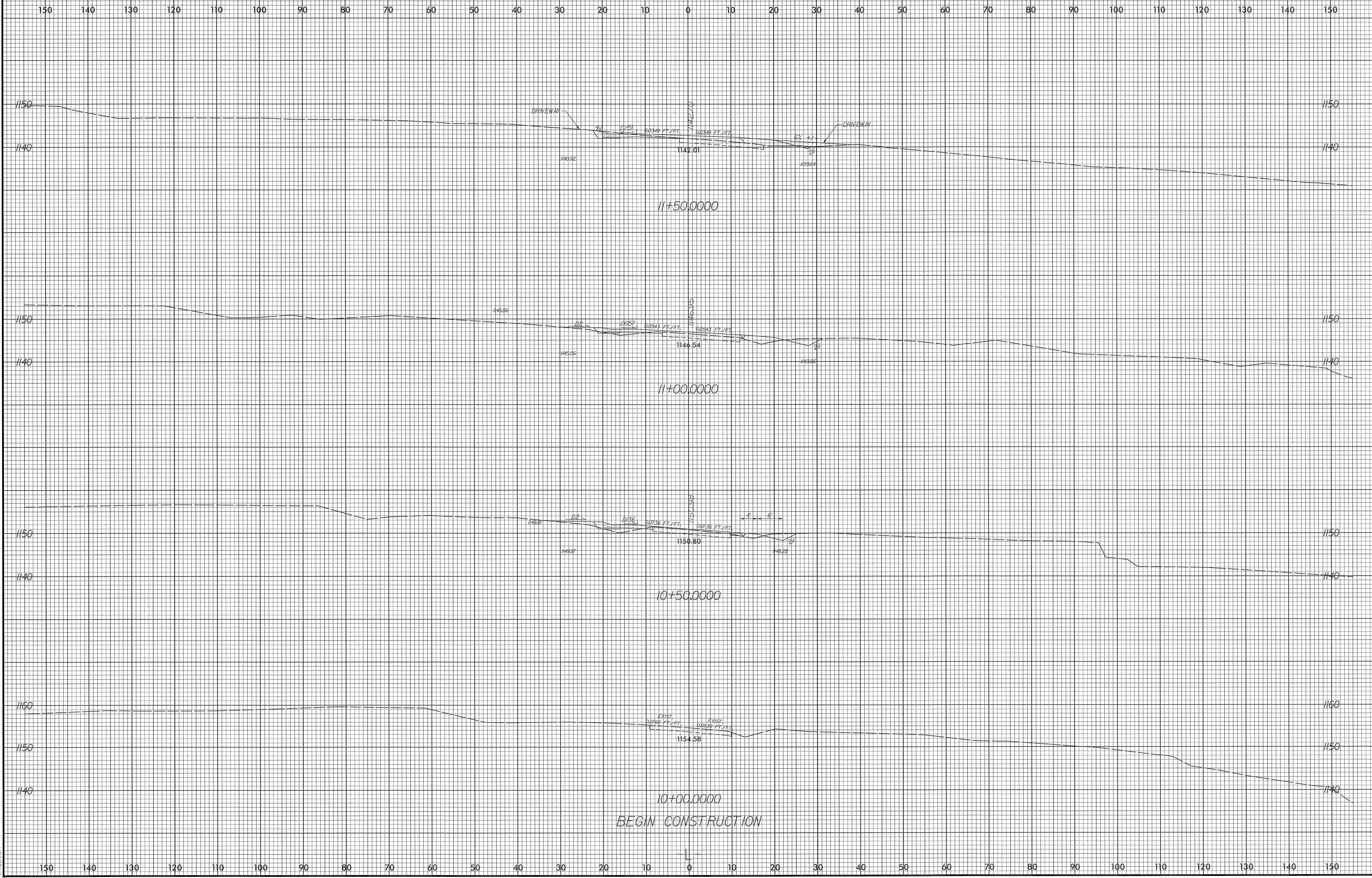



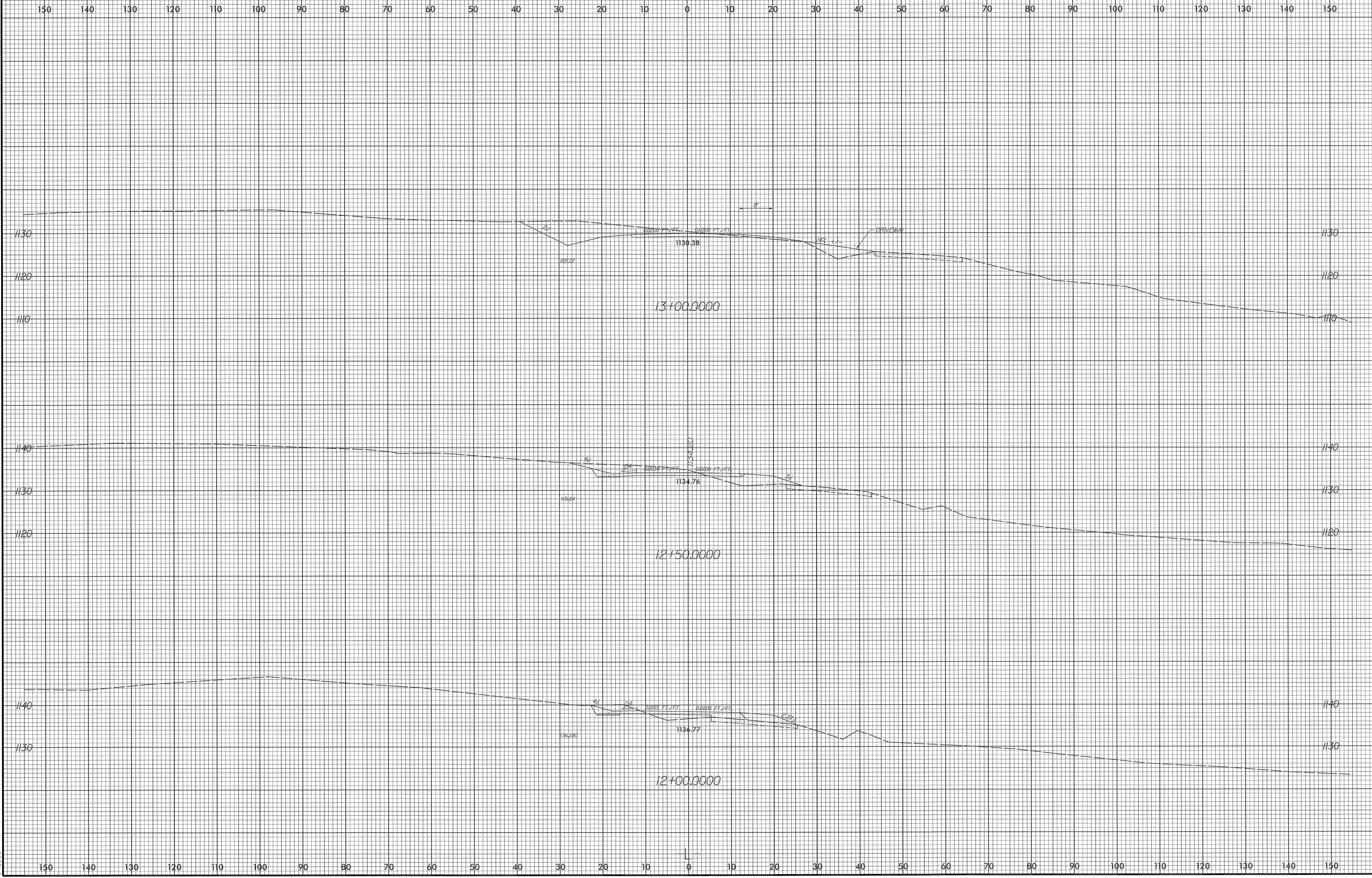



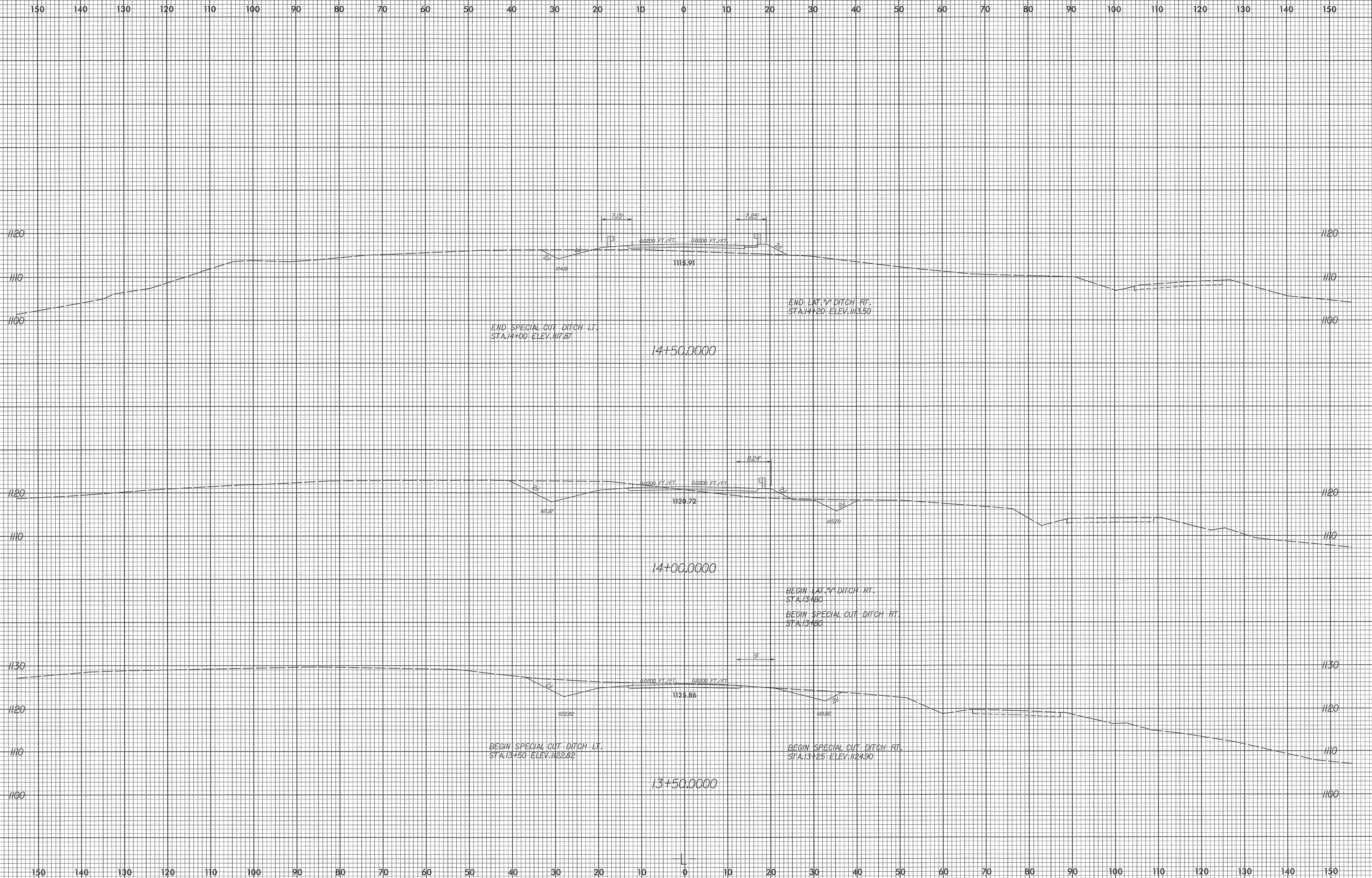
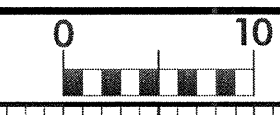



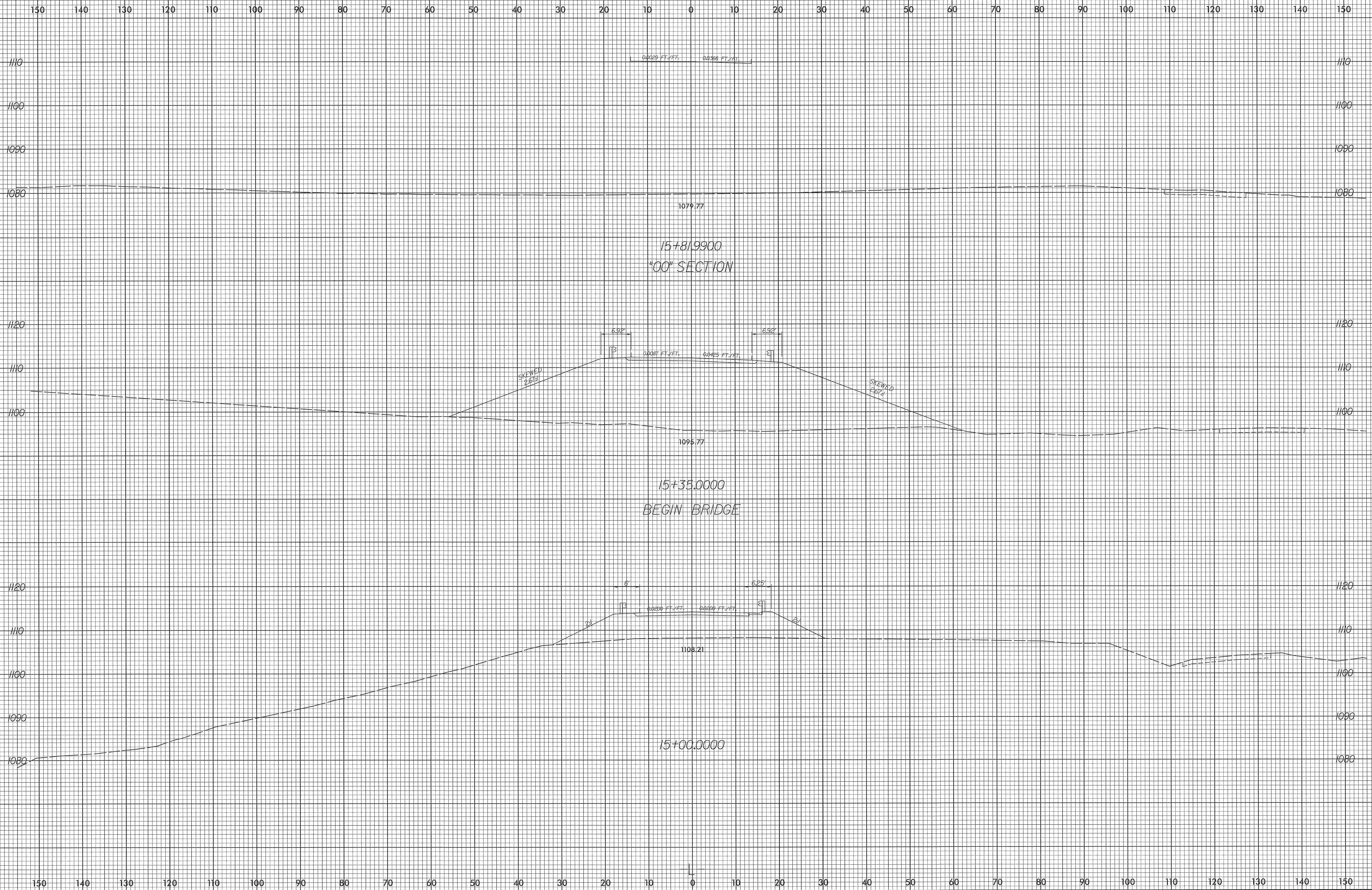



8/23/99

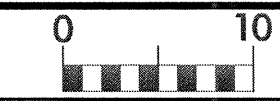

PROJ. REFERENCE NO.  
B-3126

SHEET NO.  
X-6

150 140 130 120 110 100 90 80 70 60 50 40 30 20 10 0 10 20 30 40 50 60 70 80 90 100 110 120 130 140 150

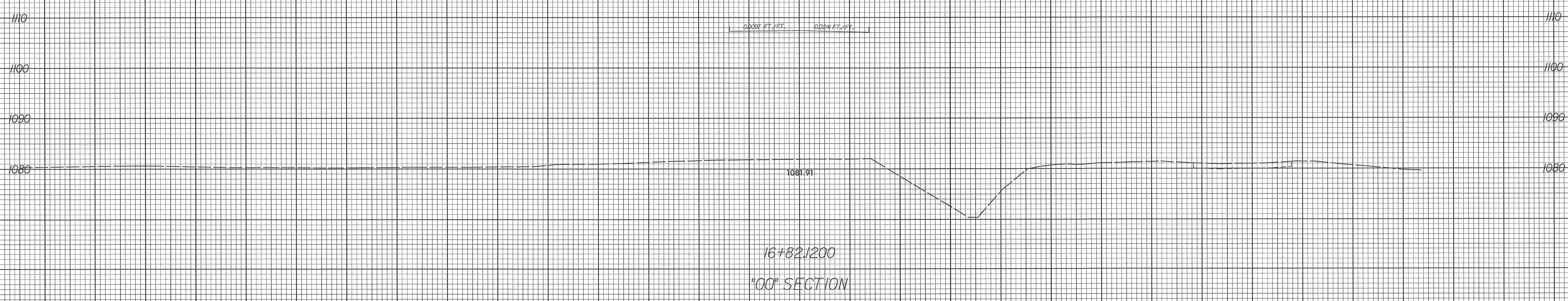
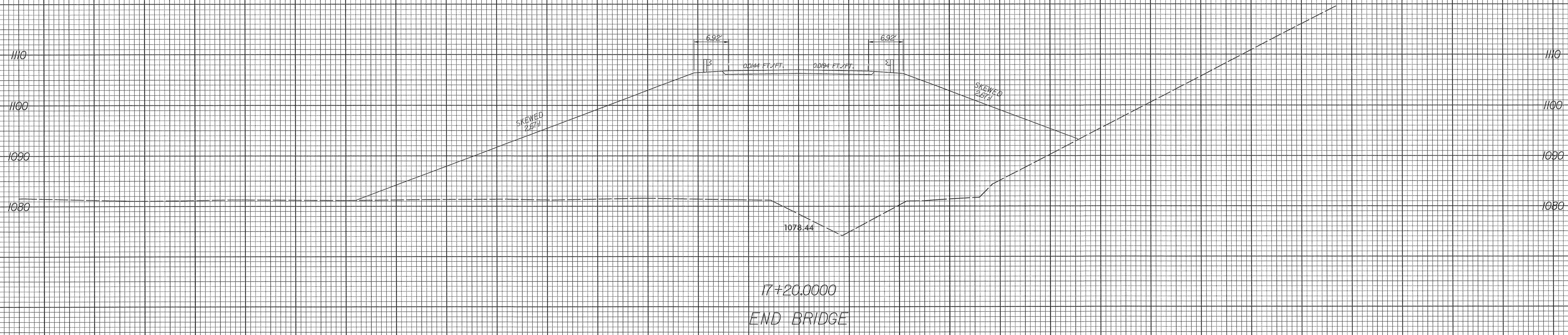

150 140 130 120 110 100 90 80 70 60 50 40 30 20 10 0 10 20 30 40 50 60 70 80 90 100 110 120 130 140 150

4/18/2007  
u:\Roadway\Xac\b3126\_R0Y\_XPL.dgn  
skoplan



8/23/99

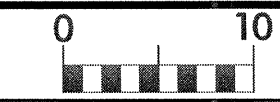

PROJ. REFERENCE NO.  
B-3126

SHEET NO.  
X-7

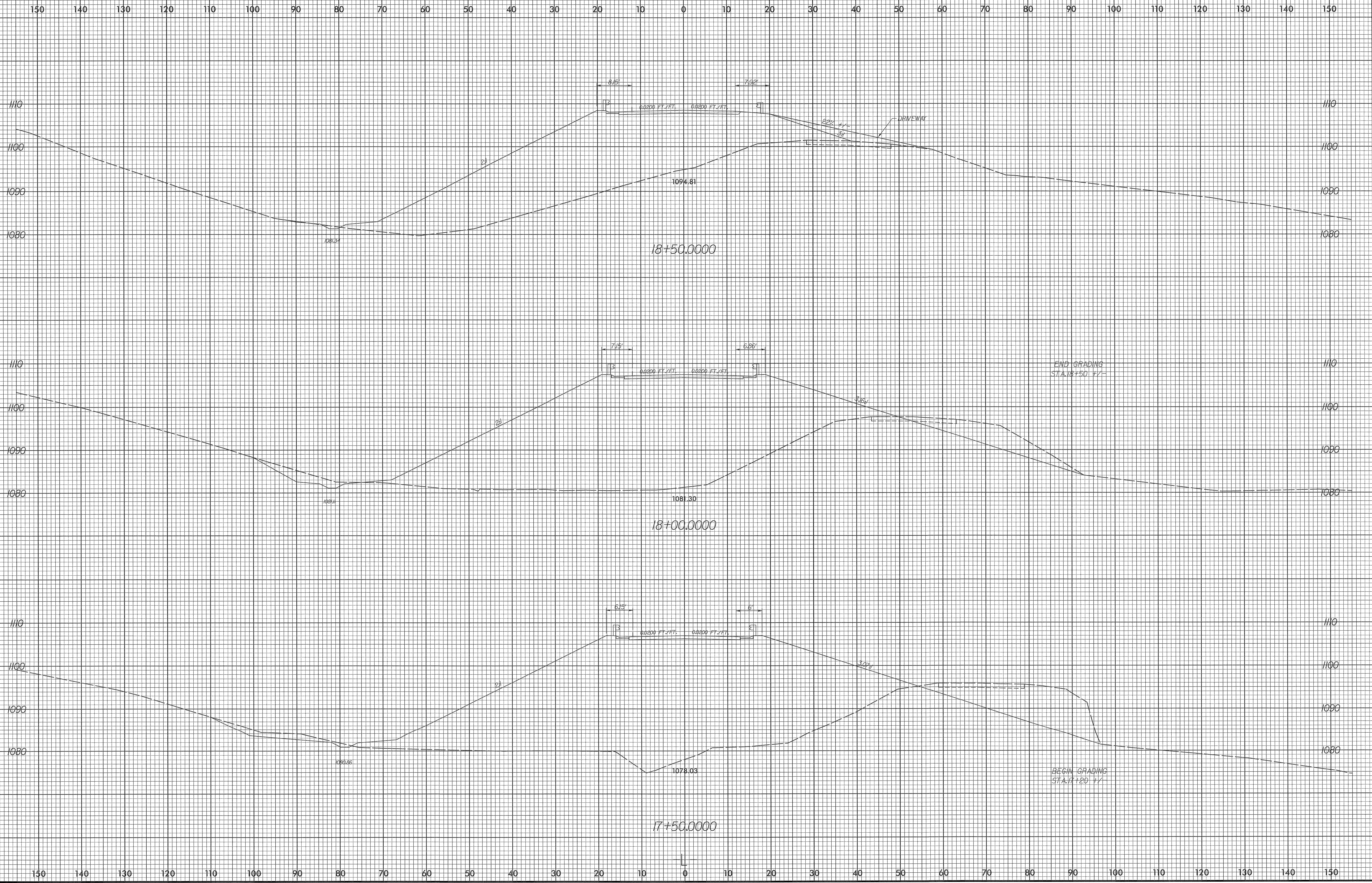

4/18/2007  
u:\Roadway\Xsc\B3126\_RDY\_XPL.dgn  
skp:lan



8/23/99

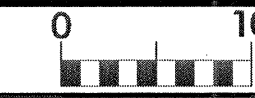

PROJ. REFERENCE NO.  
B-3126

SHEET NO.  
X-8

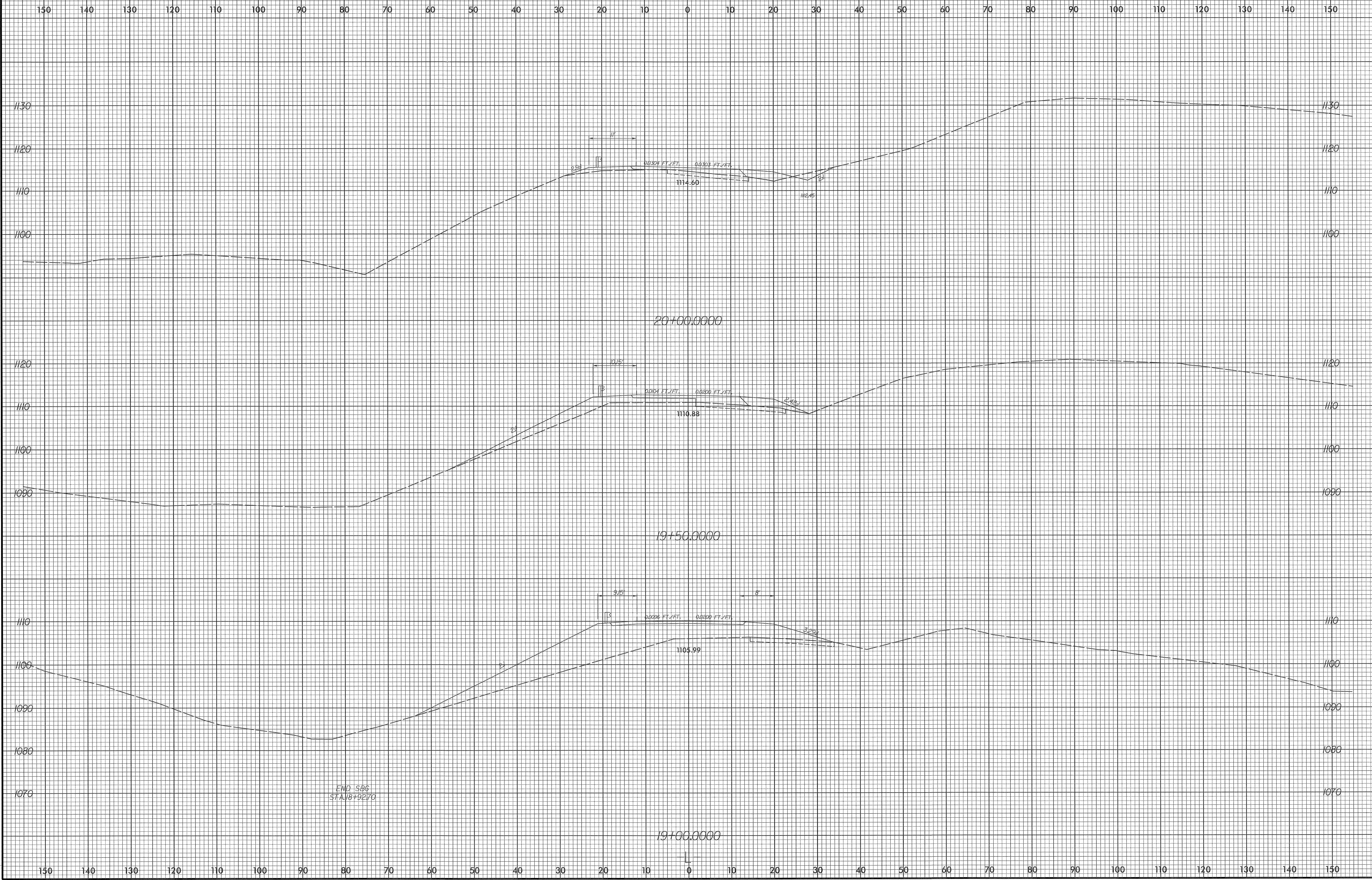

4/18/2007  
us:\Roadway\Xsc\3126\_RDY\_XPL.dgn  
s:\001



8/23/99



PROJ. REFERENCE NO. B-3126	SHEET NO. X-10
-------------------------------	-------------------

150 140 130 120 110 100 90 80 70 60 50 40 30 20 10 0 10 20 30 40 50 60 70 80 90 100 110 120 130 140 150



4/18/2007  
u:\Roadway\Xac\b3126\_RDY\_XPL.dgn  
skp1an

150 140 130 120 110 100 90 80 70 60 50 40 30 20 10 0 10 20 30 40 50 60 70 80 90 100 110 120 130 140 150



