

8/17/99

T.I.P.: U-3401

CONTRACT: C201276

| | |
|-------------------|-----------------------|
| TIP NO. U-3401 | SHEET NO. SIGN - 1 |
|-------------------|-----------------------|

**STATE OF NORTH CAROLINA
DEPARTMENT OF TRANSPORTATION**

**SIGNING PLANS
RANDOLPH COUNTY**

LOCATION: INTERSECTION AT US 64/NC 49 AND NC 42 IN ASHEBORO

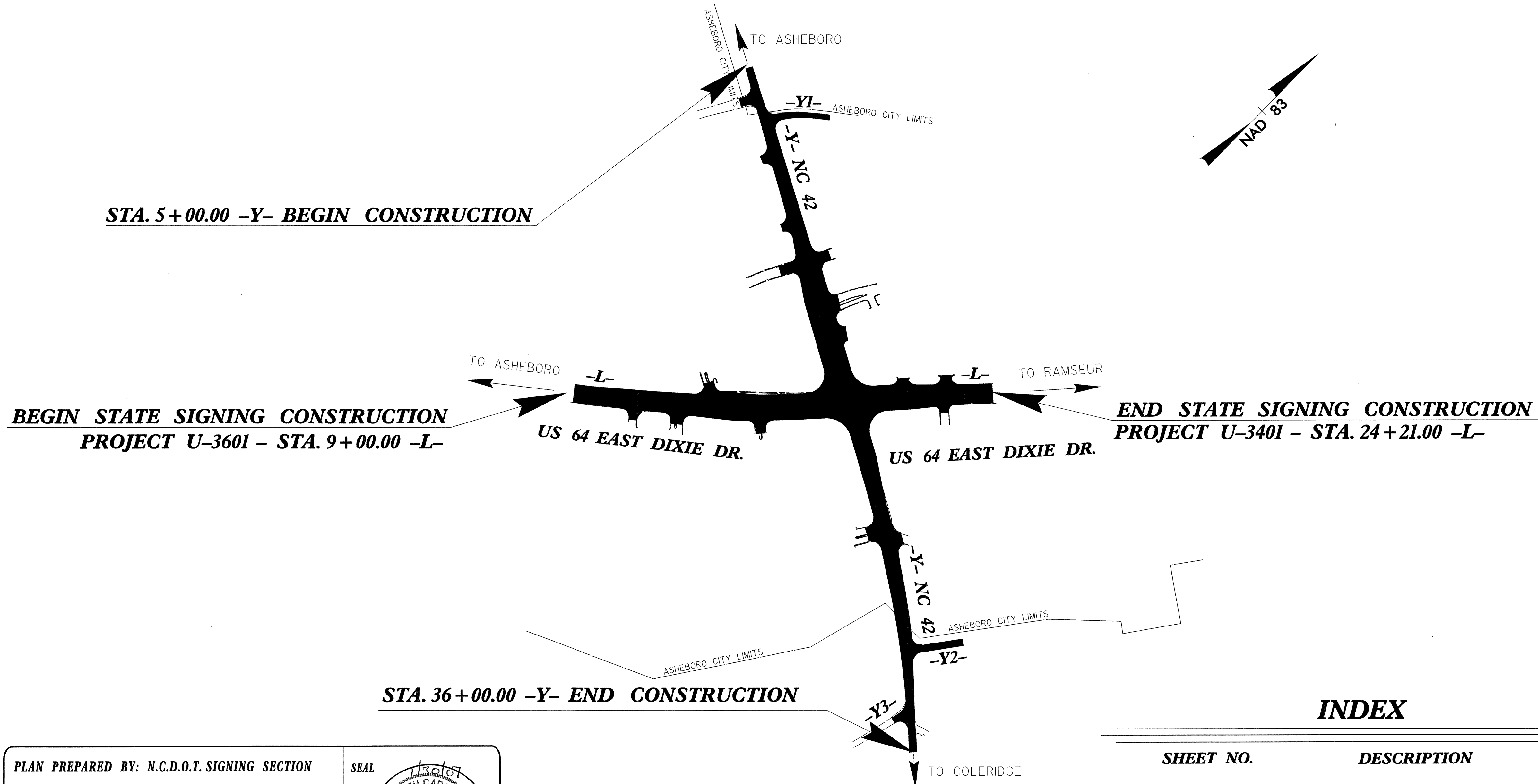

| | |
|--|------|
| PLAN PREPARED BY: N.C.D.O.T. SIGNING SECTION | SEAL |
| RON W. KING, PE SIGNING ENGINEER | |
| AYMAN I. ALQUDWAH, PE SIGNING PROJECT ENGINEER | |
| KELVIN JORDAN SIGNING PROJECT DESIGN ENGINEER | |
| STACEY W. JOHNS SIGNING DESIGN ENGINEER | |

INDEX

| SHEET NO. | DESCRIPTION |
|-----------|-------------------------------|
| 1 | TITLE SHEET |
| 2 | SUMMARY OF QUANTITIES & NOTES |
| 3 | E and F SHEET |
| 4-5 | SIGN DESIGN SHEETS |
| 6-8 | SIGN ROADWAY SHEETS |

| ITEM NO. | | ITEM DESCRIPTION | QUANTITY | UNIT |
|------------|-----------|---|----------|------|
| DESC. NO. | SECT. NO. | | | |
| 4072000000 | 903 | SUPPORTS, 3 LB STEEL U-CHANNEL | 1112 | L.F. |
| 4096000000 | 904 | SIGN ERECTION, TYPE D | 6 | EA. |
| 4102000000 | 904 | SIGN ERECTION, TYPE E | 21 | EA. |
| 4108000000 | 904 | SIGN ERECTION, TYPE F | 15 | EA. |
| 4116100000 | 904 | SIGN ERECTION, RELOCATE SIGN TYPE E | 4 | EA. |
| 4155000000 | 907 | DISPOSAL OF SIGN SYSTEM, U-CHANNEL | 31 | EA. |

Pay Item Notes:

| | |
|---|------------------------------------|
| 1 | RELOCATE SIGN, TYPE E |
| 2 | DISPOSAL OF SIGN SYSTEM, U-CHANNEL |

General Notes:

- . SIGNS FURNISHED BY STATE
- . ALL TYPE 'D' SIGNS SHALL BE MOUNTED ON TWO U-CHANNEL POSTS UNLESS OTHERWISE INDICATED ON THE PLANS.
- . IF REMOVAL OR RELOCATION OF SIGNS ON PRIVATE STREET (NON-STATE MAINTAINED) IS REQUIRED DUE TO CONSTRUCTION, THE CONTRACTOR SHALL INFORM THE ENGINEER. THE WORK WILL BE COMPLETED BY OTHERS.
- . SIGNING PLANS DO NOT INCLUDE TEMPORARY CONSTRUCTION SIGNING OR PAVEMENT MARKINGS. SEE TRAFFIC CONTROL PLANS.
- . WHEN NOT STATIONED OR DIMENSIONED ON PLANS, ALL 'E' AND 'F' SIGNS SHALL BE FIELD LOCATED BY THE ENGINEER
- . WHEN EXISTING SIGNS ARE REMOVED AND INSTALLED ON NEW SUPPORTS, THE RE-ERECTION SHALL IMMEDIATELY FOLLOW THE REMOVAL.
- . THE BACKGROUND FOR TYPE E & F SIGNS SHALL BE TYPE III REFLECTIVE SHEETING.

SEAL



SUMMARY OF QUANTITIES AND NOTES

| | | | |
|-------------------------|-------------|--|-----------|
| SCALE | 1:1000 | N. C. DEPARTMENT OF TRANSPORTATION DIVISION OF HIGHWAYS TRAFFIC ENGINEERING BRANCH | REVISIONS |
| DATE | XXX 2006 | | |
| SIGNING DESIGN ENG | X. XXXXXXX | | |
| SIGNING PROJECT DGN ENG | X. XXXXXXX | | |
| SIGNING PROJECT ENG | A. ALQUDWAH | | |

403 QUANTITY REQ'D 3

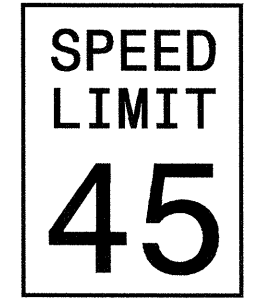

24 X 30
R2-1

ONE "U" POST PER SIGN

501

| | | |
|------|-------|------------|
| EAST | NORTH | 2 -24 X 12 |
| 64 | 49 | 2 -24 X 24 |
| ↑ | ↑ | 2 -21 X 15 |
| WEST | EAST | 2 -24 X 12 |
| 42 | 42 | 2 -24 X 24 |
| ← | → | 2 -21 X 15 |

TWO "U" POSTS

506

| | | |
|------|------|------------|
| EAST | WEST | 2 -24 X 12 |
| 42 | 42 | 2 -24 X 24 |
| ← | → | 2 -21 X 15 |

TWO "U" POSTS
MOUNTED BELOW SIGN 302

513

| | | |
|-----|------|--------------------------|
| TO | WEST | 2 -24 X 12 |
| 220 | 42 | 1 -30 X 24 1 -24 X 24 |
| ↙ | ↑ | 2 -21 X 15 |

TWO "U" POSTS

408 QUANTITY REQ'D 14

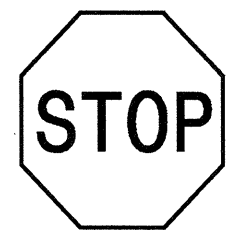

30 X 30
R1-1

ONE "U" POST PER SIGN

502

| | |
|------|------------|
| EAST | 1 -24 X 12 |
| 42 | 1 -24 X 24 |

ONE "U" POST PER SIGN

507

| | |
|------|------------|
| WEST | 1 -24 X 12 |
| 42 | 1 -24 X 24 |

ONE "U" POST PER SIGN

514

| | | |
|------|-----|--------------------------|
| EAST | TO | 2 -24 X 12 |
| 42 | 220 | 1 -24 X 24 1 -30 X 24 |
| ↑ | ↗ | 2 -21 X 15 |

TWO "U" POSTS

455 QUANTITY REQ'D 1

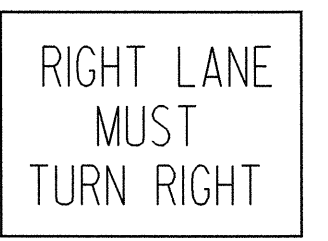

30 X 30
R3-7

ONE "U" POST PER SIGN

503
508

| | | |
|-----|-----|------------|
| JCT | JCT | 2 -21 X 12 |
| 64 | 49 | 2 -24 X 24 |

TWO "U" POSTS

509

| | | |
|-------|-------|------------|
| EAST | WEST | 2 -24 X 12 |
| 64 | 64 | 2 -24 X 24 |
| ← | → | 2 -21 X 15 |
| NORTH | SOUTH | 2 -24 X 12 |
| 49 | 49 | 2 -24 X 24 |
| ← | → | 2 -21 X 15 |

TWO "U" POSTS

515

| | | |
|-------|------------|--------------------------|
| SOUTH | 1 -24 X 12 | |
| 49 | 1 -24 X 24 | |
| ↑ | 1 -21 X 15 | |
| WEST | TO | 2 -24 X 12 |
| 64 | 220 | 1 -24 X 24 1 -30 X 24 |
| ↑ | ↑ | 2 -21 X 15 |

TWO "U" POSTS

458 QUANTITY REQ'D 1

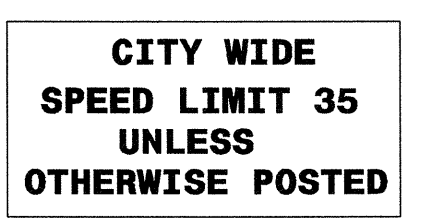

60 X 36
R2-27

MOUNT BELOW SIGN 303
IN 1 INSTALLATIONS

504

| | | |
|-------|-------|------------|
| WEST | EAST | 2 -24 X 12 |
| 64 | 64 | 2 -24 X 24 |
| ← | → | 2 -21 X 15 |
| SOUTH | NORTH | 2 -24 X 12 |
| 49 | 49 | 2 -24 X 24 |
| ← | → | 2 -21 X 15 |

TWO "U" POSTS

510

| | | |
|-------|------------|--------------------------|
| SOUTH | 1 -24 X 12 | |
| 49 | 1 -24 X 24 | |
| WEST | TO | 2 -24 X 12 |
| 64 | 220 | 1 -24 X 24 1 -30 X 24 |

TWO "U" POSTS

464 QUANTITY REQ'D 2

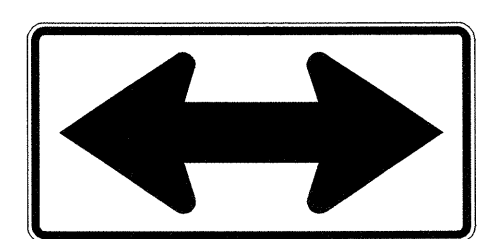

48 X 24
W1-7

TWO "U" POSTS PER SIGN

505

| | | |
|------|-------|------------|
| EAST | NORTH | 2 -24 X 12 |
| 64 | 49 | 2 -24 X 24 |

TWO "U" POSTS

511
512

| | |
|-----|------------|
| JCT | 1 -21 X 12 |
| 42 | 1 -24 X 24 |

ONE "U" POST PER SIGN

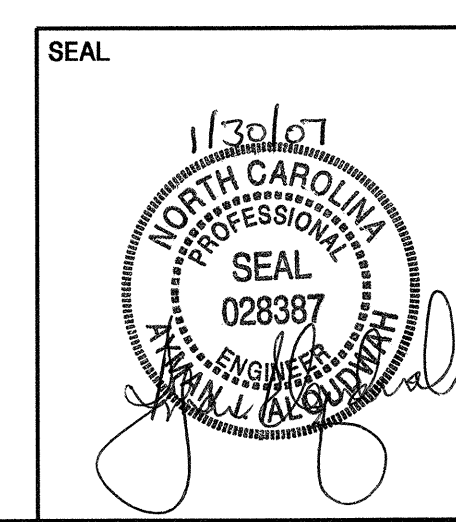

TYPE "E" & "F" SIGNS

| | | | |
|-------------------------|-------------|--|-----------|
| SCALE | 1:1000 | N. C. DEPARTMENT OF TRANSPORTATION DIVISION OF HIGHWAYS TRAFFIC ENGINEERING BRANCH | REVISIONS |
| DATE | OCT 2006 | | |
| SIGNING DESIGN ENG | S. JOHNS | | |
| SIGNING PROJECT DGN ENG | K. JORDAN | | |
| SIGNING PROJECT ENG | A. ALQUDWAH | | |

N. C. DEPARTMENT OF TRANSPORTATION
DIVISION OF HIGHWAYS
TRAFFIC ENGINEERING BRANCH
SIGNING DEPARTMENT

SIGN NUMBER: 301 BACKG COLOR: Green
TYPE: D COPY COLOR: White
QUANTITY: 1

| SYMBOL | X | Y | WID | HT |
|--------|---|---|-----|----|
| | | | | |
| | | | | |
| | | | | |
| | | | | |
| | | | | |
| | | | | |
| | | | | |
| | | | | |
| | | | | |
| | | | | |

SIGN WIDTH: 8'-0"
HEIGHT: 3'-0"
TOTAL AREA: 24.0 Sq.Ft.

BORDER TYPE: FLUSH
RECESS: 0.63"
WIDTH: 1"
RADII: 3.75"

NO. Z BARS: MAT'L: 0.125" (3.2 mm) ALUMINUM
LENGTH:

DESIGN BY: S. JOHNS CHECKED BY: AJA STD #:
PROJECT ID: U-3401 DIV: 8 DATE: Jan 26, 2007

USE NOTES: 1, 4
1. Legend and border shall be direct applied Type III reflective sheeting.
2. Legend and border shall be direct applied non-reflective sheeting.
3. Shields shall be Type III reflective sheeting on 0.032" (0.8mm) aluminum and demountable.
4. Background shall be Type III reflective sheeting.
5. Background shall be Type I reflective sheeting.
6. Center arrow(s) vertically on sign.
7. Bottom panel shall be yellow Type III sheeting. Legend shall be direct applied black non-reflective sheeting. Yellow panel is:

LETTER POSITIONS

| Letter locations are panel edge to lower left corner | | | | | | | | | | Series/Size | |
|--|------|------|------|------|------|------|------|------|--|-------------|---------|
| C | O | L | E | R | I | D | G | E | | Text Length | EM 2000 |
| 9.2 | 16.2 | 24.2 | 28.2 | 36 | 41.9 | 46 | 53.8 | 61.5 | | 58.6 | EM 2000 |
| 1 | 4 | | | | | | | | | | EM 2000 |
| 74.6 | 78.6 | | | | | | | | | | EM 2000 |
| B | E | N | N | E | T | T | | | | 49 | EM 2000 |
| 8.2 | 16.2 | 24 | 32.5 | 40.2 | 47.2 | 53.1 | | | | 14.7 | EM 2000 |
| 2 | 2 | | | | | | | | | | EM 2000 |
| 73 | 81.3 | | | | | | | | | | EM 2000 |

Spacing Factor is 1 unless specified otherwise
FILENAME: signdesign NORTH CAROLINA D.O.T. SIGN DETAIL

N. C. DEPARTMENT OF TRANSPORTATION
DIVISION OF HIGHWAYS
TRAFFIC ENGINEERING BRANCH
SIGNING DEPARTMENT

SIGN NUMBER: 303 BACKG COLOR: Green
TYPE: D COPY COLOR: White
QUANTITY: 1

| SYMBOL | X | Y | WID | HT |
|--------|---|---|-----|----|
| | | | | |
| | | | | |
| | | | | |
| | | | | |
| | | | | |
| | | | | |
| | | | | |
| | | | | |
| | | | | |
| | | | | |

SIGN WIDTH: 6'-0"
HEIGHT: 3'-0"
TOTAL AREA: 19.5 Sq.Ft.

BORDER TYPE: FLUSH
RECESS: 0.63"
WIDTH: 1"
RADII: 3.75"

NO. Z BARS: MAT'L: 0.125" (3.2 mm) ALUMINUM
LENGTH:

DESIGN BY: S. JOHNS CHECKED BY: AJA STD #:
PROJECT ID: U-3401 DIV: 8 DATE: Jan 26, 2007

USE NOTES: 1, 4
1. Legend and border shall be direct applied Type III reflective sheeting.
2. Legend and border shall be direct applied non-reflective sheeting.
3. Shields shall be Type III reflective sheeting on 0.032" (0.8mm) aluminum and demountable.
4. Background shall be Type III reflective sheeting.
5. Background shall be Type I reflective sheeting.
6. Center arrow(s) vertically on sign.
7. Bottom panel shall be yellow Type III sheeting. Legend shall be direct applied black non-reflective sheeting. Yellow panel is:

LETTER POSITIONS

| Letter locations are panel edge to lower left corner | | | | | | | | | | Series/Size | |
|--|------|------|------|------|------|------|------|------|------|-------------|---------|
| A | S | H | E | B | O | R | O | | | Text Length | EM 2000 |
| 10 | 19.1 | 28.9 | 34.6 | 42.4 | 48.4 | 57.4 | 62.6 | | | 58 | EM 2000 |
| C | I | T | Y | | L | I | M | I | T | 47.4 | EM 2000 |
| 15.3 | 21.6 | 23.6 | 28.6 | 35 | 40.7 | 46.3 | 48.9 | 56.1 | 58.2 | | EM 2000 |

Spacing Factor is 1 unless specified otherwise
FILENAME: signdesign NORTH CAROLINA D.O.T. SIGN DETAIL

N. C. DEPARTMENT OF TRANSPORTATION
DIVISION OF HIGHWAYS
TRAFFIC ENGINEERING BRANCH
SIGNING DEPARTMENT

SIGN NUMBER: 302 BACKG COLOR: Green
TYPE: D COPY COLOR: White
QUANTITY: 1

| SYMBOL | X | Y | WID | HT |
|--------|-----|----|-----|----|
| ARUP | 6.9 | 14 | 8 | 12 |
| | | | | |
| | | | | |
| | | | | |
| | | | | |
| | | | | |
| | | | | |
| | | | | |
| | | | | |
| | | | | |

SIGN WIDTH: 7'-6"
HEIGHT: 3'-0"
TOTAL AREA: 22.5 Sq.Ft.

BORDER TYPE: FLUSH
RECESS: 0"
WIDTH: 1"
RADII: 0"

NO. Z BARS: MAT'L: 0.125" (3.2 mm) ALUMINUM
LENGTH:

DESIGN BY: S. JOHNS CHECKED BY: AJA STD #:
PROJECT ID: U-3401 DIV: 8 DATE: Jan 26, 2007

USE NOTES: 1, 4, 6
1. Legend and border shall be direct applied Type III reflective sheeting.
2. Legend and border shall be direct applied non-reflective sheeting.
3. Shields shall be Type III reflective sheeting on 0.032" (0.8mm) aluminum and demountable.
4. Background shall be Type III reflective sheeting.
5. Background shall be Type I reflective sheeting.
6. Center arrow(s) vertically on sign.
7. Bottom panel shall be yellow Type III sheeting. Legend shall be direct applied black non-reflective sheeting. Yellow panel is:

LETTER POSITIONS

| Letter locations are panel edge to lower left corner | | | | | | | | | | Series/Size | |
|--|------|------|------|------|------|------|------|------|--|-------------|--------|
| C | O | L | E | R | I | D | G | E | | Text Length | D 2000 |
| 26.9 | 34 | 41.4 | 47.6 | 53.9 | 60.7 | 63.9 | 70.9 | 78.1 | | 56.2 | D 2000 |
| B | E | N | N | E | T | T | | | | 43.8 | D 2000 |
| 33.1 | 39.9 | 46.2 | 53.6 | 60.9 | 66.5 | 72 | | | | | D 2000 |

Spacing Factor is 1 unless specified otherwise
FILENAME: signdesign NORTH CAROLINA D.O.T. SIGN DETAIL

SEAL

SIGN DESIGNS

| | | | |
|-------------------------|-------------|--|-----------|
| SCALE | N/A | N. C. DEPARTMENT OF TRANSPORTATION DIVISION OF HIGHWAYS TRAFFIC ENGINEERING BRANCH | REVISIONS |
| DATE | 10 /2006 | | |
| SIGNING DESIGN ENG | S. JOHNS | | |
| SIGNING PROJECT DGN ENG | K. JORDAN | | |
| SIGNING PROJECT ENG | A. ALQUDWAH | | |

STATE OF NORTH CAROLINA
DEPARTMENT OF TRANSPORTATION
DIVISION OF HIGHWAYS
TRAFFIC ENGINEERING BRANCH
SIGNING DEPARTMENT

SIGN NUMBER: 304 BACKG COLOR: Green
TYPE: D COPY COLOR: White
QUANTITY: 1

| SYMBOL | X | Y | WID | HT |
|--------|------|----|-----|----|
| ARUP | 71.1 | 14 | 8 | 12 |

SIGN WIDTH: 7'-6"
HEIGHT: 3'-0"
TOTAL AREA: 22.5 Sq.Ft.

BORDER TYPE: FLUSH
RECESS: 0"
WIDTH: 1"
RADIUS: 6"

NO. Z BARS: N/A
LENGTH: N/A

MAT'L: 0.125" (3.2 mm) ALUMINUM

DESIGN BY: S. JOHNS CHECKED BY: AIA STD #:
PROJECT ID: U-3401 DIV: 8 DATE: Jan 26, 2007

USE NOTES: 1, 4, 6
1. Legend and border shall be direct applied Type III reflective sheeting.
2. Legend and border shall be direct applied non-reflective sheeting.
3. Shields shall be Type III reflective sheeting on 0.032" (0.8mm) aluminum and demountable.
4. Background shall be Type II reflective sheeting.
5. Background shall be Type I reflective sheeting.
6. Center arrow(s) vertically on sign.
7. Bottom panel shall be yellow Type III sheeting. Legend shall be direct applied black non-reflective sheeting. Yellow panel is:

LETTER POSITIONS

| Letter locations are panel edge to lower left corner | | | | | | | | | | Series/Size |
|--|------|------|------|------|------|------|------|------|--|-------------|
| C | O | L | E | R | I | D | G | E | | D 2000 |
| 6.9 | 14 | 21.4 | 27.6 | 33.9 | 40.7 | 43.9 | 50.9 | 58.1 | | 56.2 |
| B | E | N | N | E | T | | | | | D 2000 |
| 13.1 | 19.9 | 26.2 | 33.6 | 40.9 | 46.5 | 52 | | | | 43.8 |

Spacing Factor is 1 unless specified otherwise
FILENAME: signdesign NORTH CAROLINA D.O.T. SIGN DETAIL

STATE OF NORTH CAROLINA
DEPARTMENT OF TRANSPORTATION
DIVISION OF HIGHWAYS
TRAFFIC ENGINEERING BRANCH
SIGNING DEPARTMENT

SIGN NUMBER: 306 BACKG COLOR: Green/Green
TYPE: D COPY COLOR: White
QUANTITY: 1

| SYMBOL | X | Y | WID | HT |
|--------|------|------|-----|----|
| ARUP | 7.4 | 26.3 | 8 | 12 |
| ARUP | 68.6 | 4.8 | 8 | 12 |

SIGN WIDTH: 7'-6"
HEIGHT: 4'-0"
TOTAL AREA: 30.0 Sq.Ft.

BORDER TYPE: FLUSH
RECESS: 0"
WIDTH: 1"
RADIUS: 6"

NO. Z BARS: N/A
LENGTH: N/A

MAT'L: 0.125" (3.2 mm) ALUMINUM

DESIGN BY: S. JOHNS CHECKED BY: AIA STD #:
PROJECT ID: U-3401 DIV: 8 DATE: Jan 26, 2007

USE NOTES: 1, 4, 6
1. Legend and border shall be direct applied Type III reflective sheeting.
2. Legend and border shall be direct applied non-reflective sheeting.
3. Shields shall be Type III reflective sheeting on 0.032" (0.8mm) aluminum and demountable.
4. Background shall be Type III reflective sheeting.
5. Background shall be Type I reflective sheeting.
6. Center arrow(s) vertically on sign.
7. Bottom panel shall be yellow Type III sheeting. Legend shall be direct applied black non-reflective sheeting. Yellow panel is:

LETTER POSITIONS

| Letter locations are panel edge to lower left corner | | | | | | | | | | Series/Size |
|--|------|------|------|------|------|------|------|------|------|-------------|
| R | A | M | S | E | U | R | | | | D 2000 |
| 32.6 | 38.5 | 46.1 | 53.3 | 59.7 | 65.6 | 72.4 | | | | 45.2 |
| S | I | L | E | R | | C | I | T | Y | D 2000 |
| 27.4 | 33.8 | 36.4 | 42.2 | 48.2 | 53.9 | 61.6 | 68.3 | 70.4 | 75.7 | 55.1 |
| L | E | X | I | N | G | T | O | N | | D 2000 |
| 9.4 | 15.2 | 20.7 | 27.1 | 29.7 | 36.4 | 42.6 | 48.3 | 55.2 | | 51.2 |

Spacing Factor is 1 unless specified otherwise
FILENAME: signdesign NORTH CAROLINA D.O.T. SIGN DETAIL

STATE OF NORTH CAROLINA
DEPARTMENT OF TRANSPORTATION
DIVISION OF HIGHWAYS
TRAFFIC ENGINEERING BRANCH
SIGNING DEPARTMENT

SIGN NUMBER: 305 BACKG COLOR: Green/Green
TYPE: D COPY COLOR: White
QUANTITY: 1

| SYMBOL | X | Y | WID | HT |
|--------|------|------|-----|----|
| ARUP | 9.4 | 35.3 | 8 | 12 |
| ARUP | 70.6 | 11.8 | 8 | 12 |

SIGN WIDTH: 7'-6"
HEIGHT: 4'-0"
TOTAL AREA: 30.0 Sq.Ft.

BORDER TYPE: FLUSH
RECESS: 0"
WIDTH: 1"
RADIUS: 6"

NO. Z BARS: N/A
LENGTH: N/A

MAT'L: 0.125" (3.2 mm) ALUMINUM

DESIGN BY: S. JOHNS CHECKED BY: AIA STD #:
PROJECT ID: U-3401 DIV: 8 DATE: Jan 26, 2007

USE NOTES: 1, 4, 6
1. Legend and border shall be direct applied Type III reflective sheeting.
2. Legend and border shall be direct applied non-reflective sheeting.
3. Shields shall be Type III reflective sheeting on 0.032" (0.8mm) aluminum and demountable.
4. Background shall be Type III reflective sheeting.
5. Background shall be Type I reflective sheeting.
6. Center arrow(s) vertically on sign.
7. Bottom panel shall be yellow Type III sheeting. Legend shall be direct applied black non-reflective sheeting. Yellow panel is:

LETTER POSITIONS

| Letter locations are panel edge to lower left corner | | | | | | | | | | Series/Size |
|--|------|------|------|------|------|------|------|------|------|-------------|
| L | E | X | I | N | G | T | O | N | | D 2000 |
| 29.4 | 35.2 | 40.7 | 47.1 | 49.7 | 56.4 | 62.6 | 68.3 | 75.2 | | 51.2 |
| R | A | M | S | E | U | R | | | | D 2000 |
| 12.6 | 18.5 | 26.1 | 33.3 | 39.7 | 45.6 | 52.4 | | | | 45.2 |
| S | I | L | E | R | | C | I | T | Y | D 2000 |
| 7.4 | 13.8 | 16.4 | 22.2 | 28.2 | 33.9 | 41.6 | 48.3 | 50.4 | 55.7 | 55.1 |

Spacing Factor is 1 unless specified otherwise
FILENAME: signdesign NORTH CAROLINA D.O.T. SIGN DETAIL

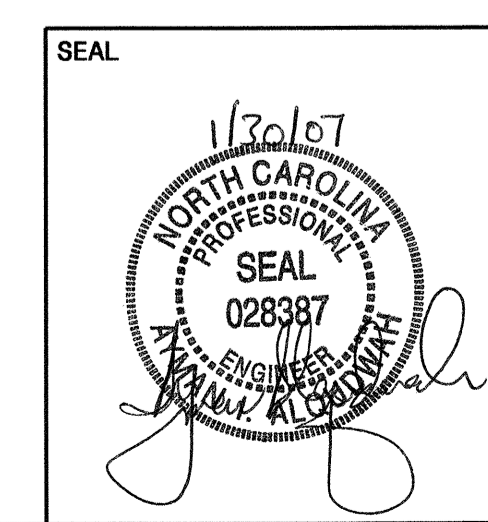

SIGN DESIGNS

| SCALE | NA | N. C. DEPARTMENT OF TRANSPORTATION DIVISION OF HIGHWAYS TRAFFIC ENGINEERING BRANCH | REVISIONS |
|-------------------------|-------------|--|-----------|
| DATE | 10 /2006 | | |
| SIGNING DESIGN ENG | S. JOHNS | | |
| SIGNING PROJECT DGN ENG | K. JORDAN | | |
| SIGNING PROJECT ENG | A. ALQUDWAH | | |

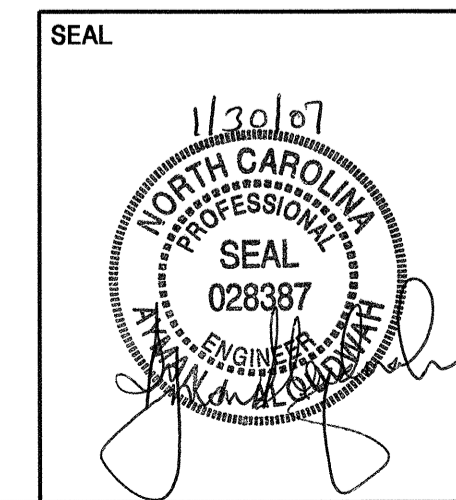
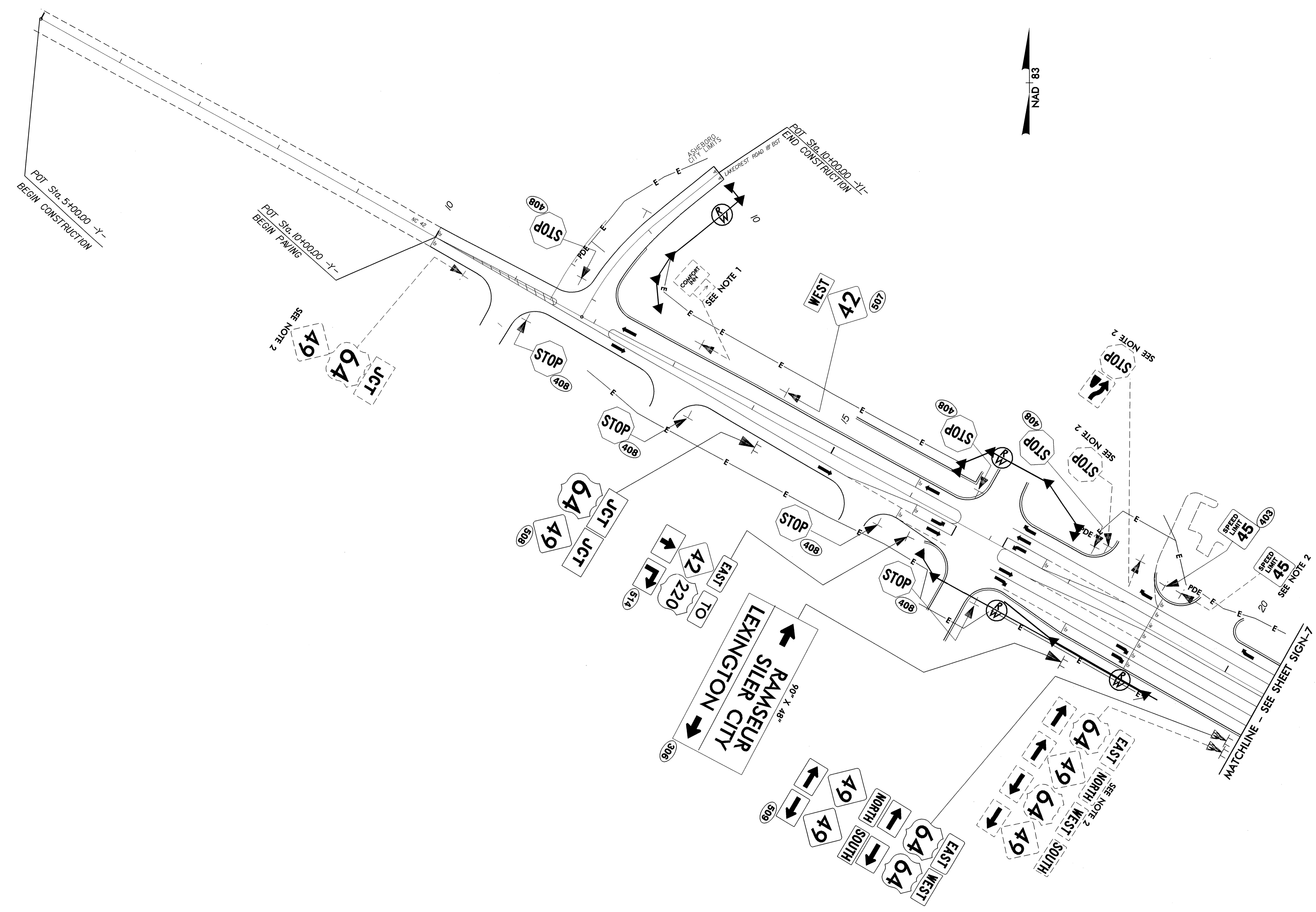

| EXISTING & PROPOSED SIGNS | | NC 42 | | STA. 5+00 (-Y-) TO STA. 20+50 (-Y-) | |
|---------------------------|-------------|------------------------------------|--|-------------------------------------|--|
| SCALE | N/A | N. C. DEPARTMENT OF TRANSPORTATION | | REVISIONS | |
| DATE | OCT 2006 | DIVISION OF HIGHWAYS | | | |
| SIGNING DESIGN ENG | S. JOHNS | TRAFFIC ENGINEERING BRANCH | | | |
| SIGNING PROJECT DGN ENG | K. JORDAN | | | | |
| SIGNING PROJECT ENG | A. ALQUDWAH | | | | |

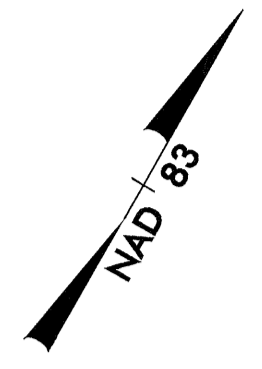

BEGIN STATE SIGNING CONSTRUCTION
PROJECT U-3401 - STA.9+00 (-L-)

END STATE SIGNING CONSTRUCTION
PROJECT U-3401 - STA.24+21 (-L-)

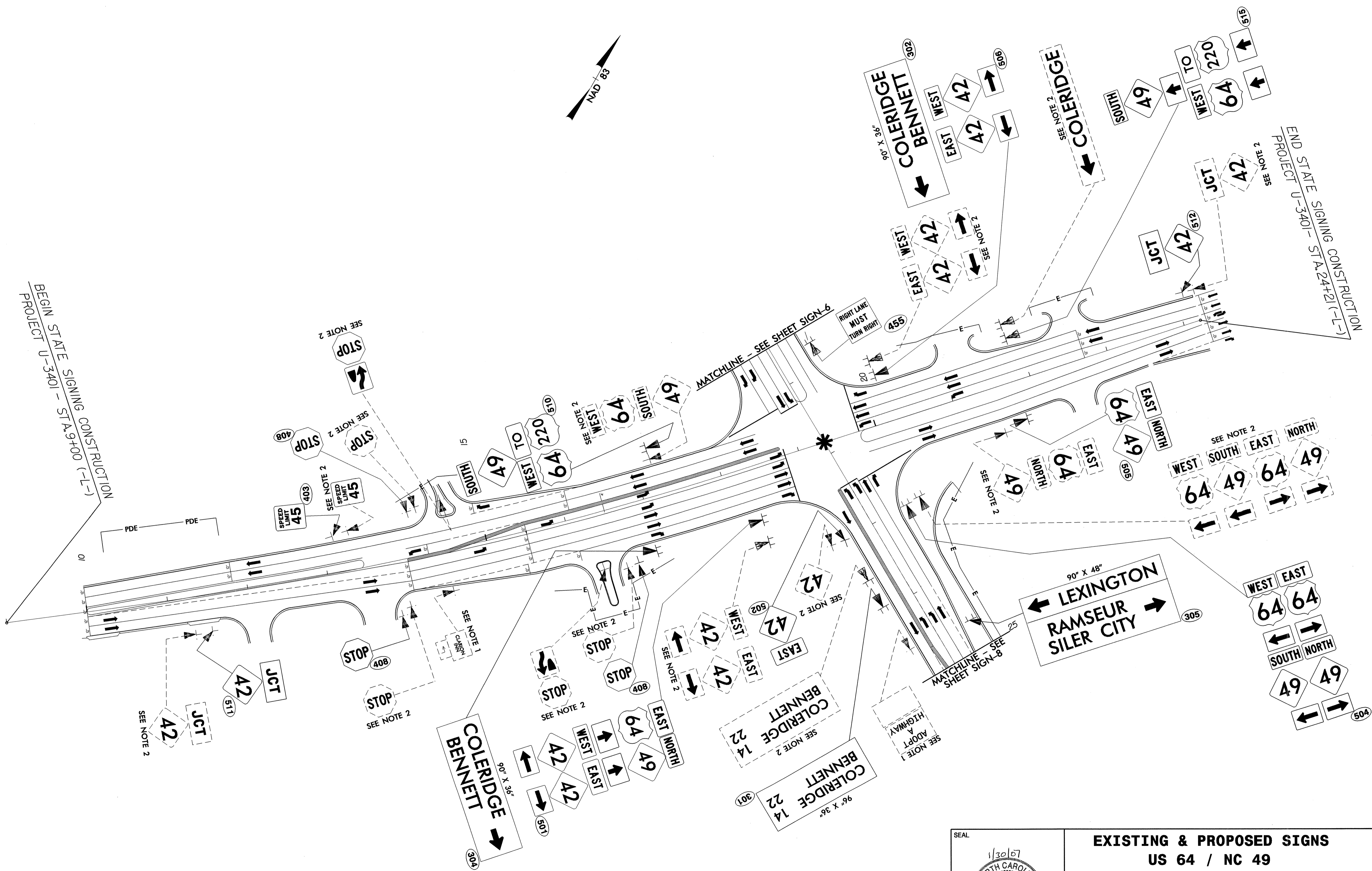

* SIGNALIZED

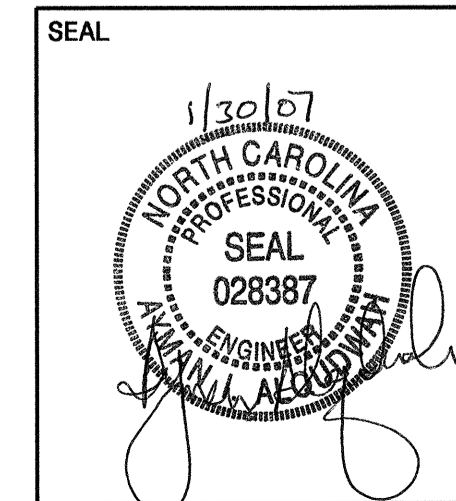

| EXISTING & PROPOSED SIGNS | | US 64 / NC 49 | |
|-----------------------------------|-------------|--|-----------|
| STA.9+00 (-L-) TO STA.24+21 (-L-) | | | |
| SCALE | N/A | N. C. DEPARTMENT OF TRANSPORTATION DIVISION OF HIGHWAYS TRAFFIC ENGINEERING BRANCH | REVISIONS |
| DATE | OCT 2006 | | |
| SIGNING DESIGN ENG | S. JOHNS | | |
| SIGNING PROJECT DGN ENG | K. JORDAN | | |
| SIGNING PROJECT ENG | A. ALQUDWAH | | |

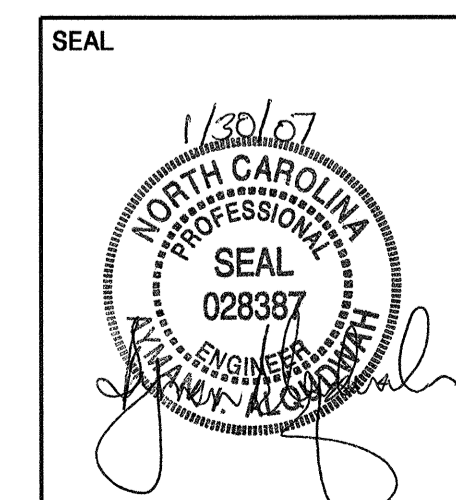
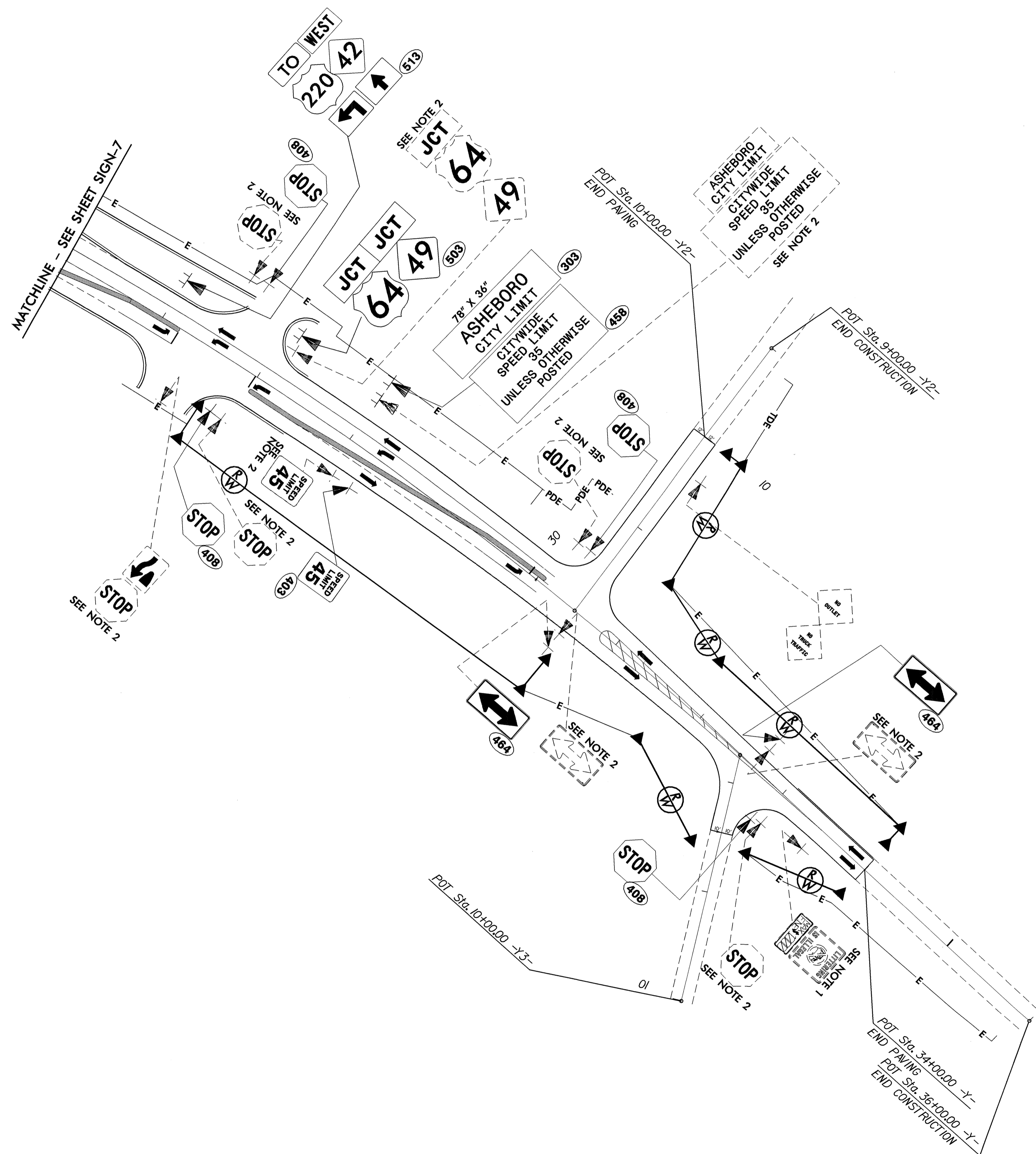

| EXISTING & PROPOSED SIGNS | | | |
|--------------------------------------|-------------|---------------------------------------|----------------------|
| NC 42 | | | |
| STA. 25+00 (-Y-) TO STA. 36+00 (-Y-) | | | |
| SCALE | NA | N. C. DEPARTMENT OF TRANSPORTATION | REVISIONS |
| DATE | OCT 2006 | | |
| SIGNING DESIGN ENG | S. JOHNS | | DIVISION OF HIGHWAYS |
| SIGNING PROJECT DGN ENG | K. JORDAN | | TRAFFIC ENGINEERING |
| SIGNING PROJECT ENG | A. ALQUDWAH | | BRANCH |